

QUARRY MINING

& CONSTRUCTION EQUIPMENT PTY LTD

QUALITY

EXPERTISE

COMMITMENT

**SMALL HOLE DRILLING
& PNEUMATIC EQUIPMENT**



EXPERTISE YOU CAN DEPEND ON

WWW.QUARRYMINING.COM

GENERAL INFORMATION

EXPERTISE. QUALITY. COMMITMENT.

QUARRY MINING has been setting the industry standard for almost 40 years in the design and manufacture of quality, custom made drilling consumables.

Over that time we have grown to become a preferred supplier to some of the biggest names in the Australian Mining, Construction and Tunnelling industries as well as exporting our equipment into Asia, South America and New Zealand.

We manufacture a wide range of products to meet all your hard rock and soft rock drilling challenges. Our products are made using the latest technology and the highest quality materials available, including Tungsten Carbide, Poly Crystalline Diamond and high grade steels to ensure you get the best results across a range of drilling conditions.

We work together with you to ensure you always get the exact part needed to get the job done efficiently and cost effectively. Our technical team is available to go on site and customise drilling equipment to meet the specific requirements of the job, to maximise the productivity and the cost effectiveness of your project.

GENERAL INFORMATION

UNDERGROUND MINING



CIVIL INFRASTRUCTURE



TUNNELLING

SMALL HOLE DRILLING

NEW SOUTH WALES

9/14 Yangan Drive,
 Beresfield NSW 2322
ph: +61 (0)2 4966 5028
e: orders@quarrymining.com

Distribution Warehouse - Sydney

Unit 1, No.1 Bearing Road,
 Seven Hills NSW 2147
ph: 0429 307 182
e: orders@quarrymining.com

QUEENSLAND

5/35 Iridium Drive,
 Mackay QLD 4740
ph: +61 (0)7 4998 5295
e: ordersqld@quarrymining.com



QMS Certification Services



QMS Certification Services



QMS Certification Services

CONTENTS

Integral Drill Steels.....	5	Top Mount Roofbolter.....	24
Taper Drill Rods and Bits.....	6	Clark Eagle MK2 Air Powered Drill.....	25
R25 Drill Rods and R25/R32 Shank Rods.....	8	Roof Bolting Spanners.....	26
R25 Drill Rods.....	9	Impact Wrench Spanners.....	27
R25 Drill Bits.....	10	Grouting Equipment.....	28
Reaming Tools.....	11	Grout Bowl Dust Mitigation System.....	30
Split Set Driver Tools.....	12	Grout Hose.....	31
Boar Series Rock Drills.....	13	Grout Packer.....	32
Airlegs.....	14	Wilden Pumps.....	33
Stoppers.....	15	Reflex Rubber Strainer.....	34
CP9 Drills and Tools.....	16	Ventilation Fans.....	35
Light Weight Hammer and Breakers.....	18	Venturi Extractors.....	36
Lubricators.....	19	The Cool Tube MKII.....	38
Percussive Rotary Drill and Tools.....	20	Hose Fitting and Accessories.....	39
Y-piece Hoses.....	22	Brattice Ventilation Sheeting.....	40
Rock Drill Spanners.....	23	Lubricator Adjustment Instructions.....	41

EXPERTISE YOU CAN DEPEND ON.

Quarry Mining has been providing a wide range of quality products, service and support to the construction and mining industries for 40 years. We are committed to delivering ongoing solutions including on-site support, product trialling and procedures training.

We have a diverse range of product lines to help you, whatever your field...

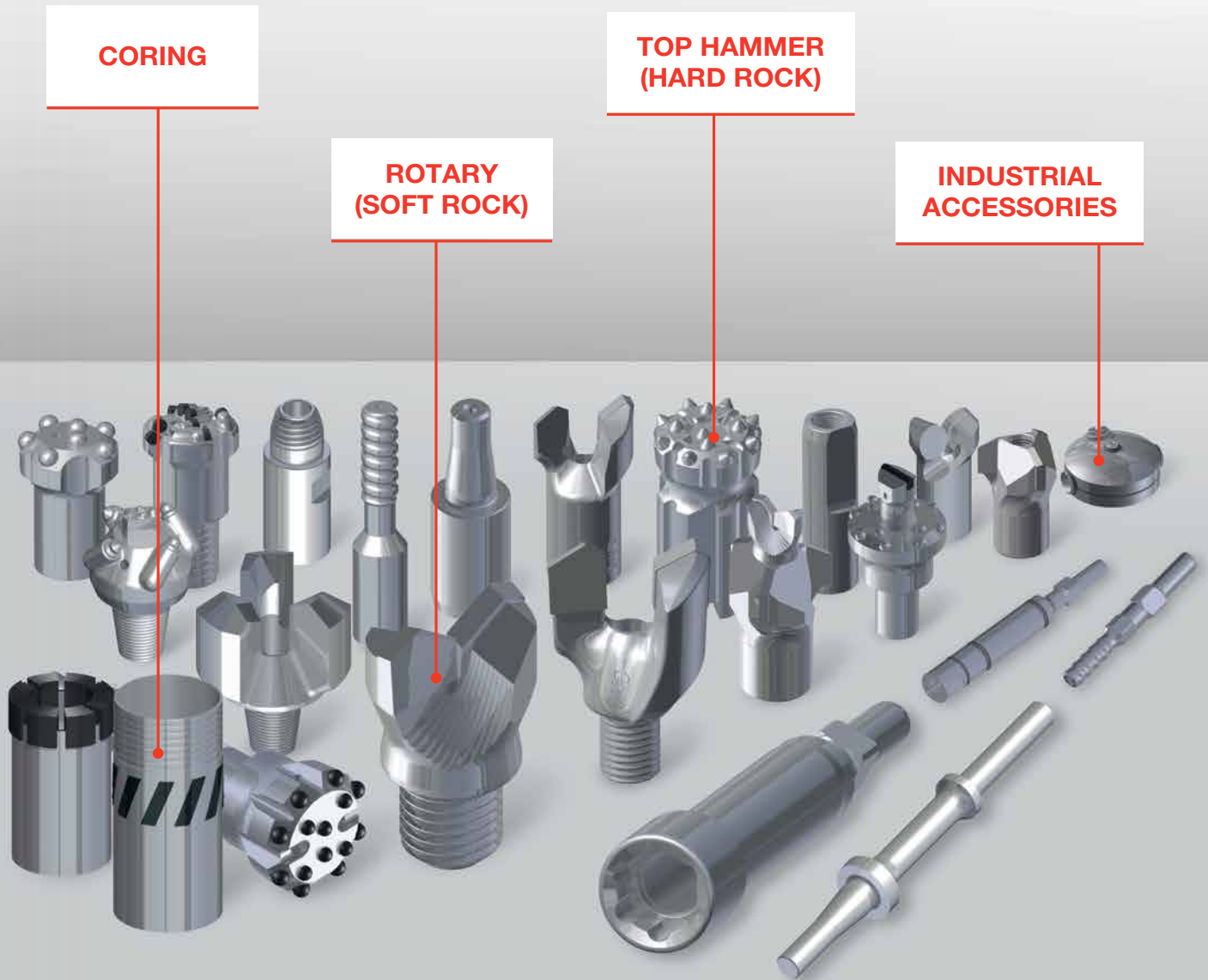

SHANK 22 x 108 mm

Part Number	Effective Length (L)	Diameter (D)
IDS-22108HM-0600-29	600 mm	29 mm
IDS-22108HM-0600-34	600 mm	34 mm
IDS-22108HM-0600-41	600 mm	41 mm
IDS-22108HM-0800-29	800 mm	29 mm
IDS-22108HM-0800-34	800 mm	34 mm
IDS-22108HM-0800-40	800 mm	40 mm
IDS-22108HM-1200-29	1200 mm	29 mm
IDS-22108HM-1200-34	1200 mm	34 mm
IDS-22108HM-1200-40	1200 mm	40 mm
IDS-22108HM-1600-28	1600 mm	28 mm
IDS-22108HM-1600-33	1600 mm	33 mm
IDS-22108HM-1800-28	1800 mm	28 mm
IDS-22108HM-1800-33	1800 mm	33 mm
IDS-22108HM-1800-38	1800 mm	38 mm
IDS-22108HM-2100-33	2100 mm	33 mm
IDS-22108HM-2200-28	2200 mm	28 mm
IDS-22108HM-2400-28	2400 mm	28 mm
IDS-22108HM-2400-32	2400 mm	32 mm
IDS-22108HM-2400-38	2400 mm	38 mm
IDS-22108HM-3200-28	3200 mm	28 mm
IDS-22108HM-3200-31	3200 mm	31 mm
IDS-22108HM-3200-37	3200 mm	37 mm
IDS-22108HM-4000-30	4000 mm	30 mm

**other sizes available on request*

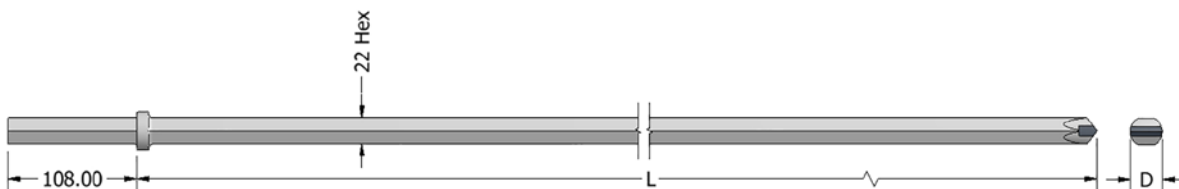

INTEGRAL DRILL STEELS

12° TAPER DRILL RODS: Shank 22 x 108 mm

Part Number	Effective Length (L)
TDS-22H-12D-0600	600 mm
TDS-22H-12D-0800	800 mm
TDS-22H-12D-0900	900 mm
TDS-22H-12D-1200	1200 mm
TDS-22H-12D-1500	1500 mm
TDS-22H-12D-1800	1800 mm
TDS-22H-12D-2100	2100 mm
TDS-22H-12D-2400	2400 mm
TDS-22H-12D-3000	3000 mm
TDS-22H-12D-3600	3600 mm
TDS-22H-12D-4000	4000 mm

* 11° Taper available on request.

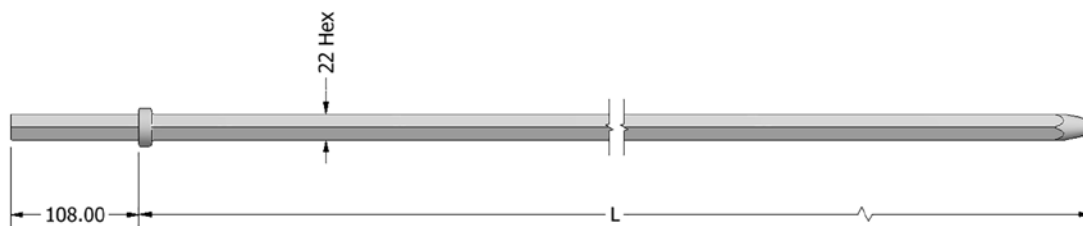

12° TAPER SPHERICAL BUTTON DRILL BITS

Part Number	Diameter (D)
BB-12D-28-H	28 mm
BB-12D-32-H	32 mm
BB-12D-35-H	35 mm
BB-12D-38-H	38 mm
BB-12D-45-H	45 mm

* 11° Taper available on request.

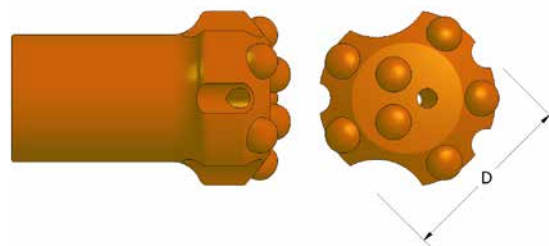

TAPER DRILL RODS AND BITS

12° TAPER BALLISTIC BUTTON DRILL BITS

Part Number	Diameter (D)
BB-12D-28-B	28 mm
BB-12D-32-B	32 mm
BB-12D-35-B	35 mm
BB-12D-38-B	38 mm
BB-12D-45-B	45 mm

* 11° Taper available on request.

*shims to suit

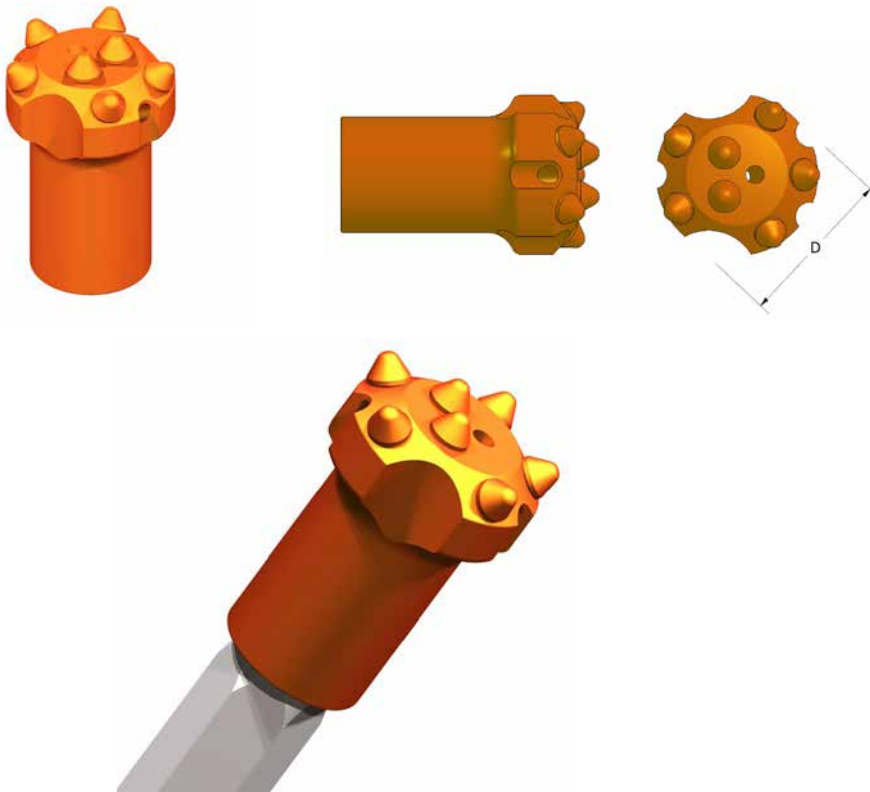

R25 DRILL RODS

R25 & R32 SHANK RODS



R25 SHANK RODS: Shank 22 x 108 mm

Part Number	Effective Length (L)
SR-22H-R25M-0300	300 mm
SR-22H-R25M-0600	600 mm
SR-22H-R25M-0900	900 mm
SR-22H-R25M-1200	1200 mm
SR-22H-R25M-1500	1500 mm
SR-22H-R25M-1800	1800 mm
SR-22H-R25M-2100	2100 mm
SR-22H-R25M-2400	2400 mm
SR-22H-R25M-3100	3100 mm
SR-22H-R25M-3600	3600 mm

* R32 Shank rods available on request.

R32 SHANK RODS

Part Number	Effective Length
SR-22H-R32M-0300	300mm
SR-22H-R32M-0600	600mm
SR-22H-R32M-1200	1200mm

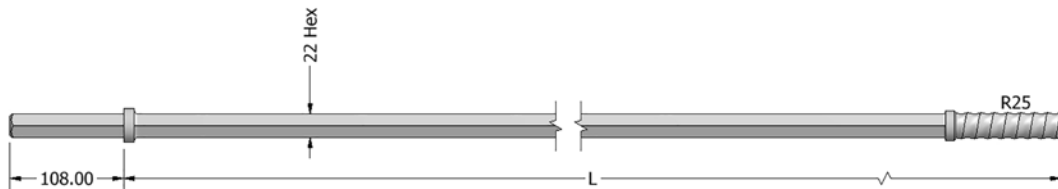

R25 MALE / FEMALE EXTENSION RODS

Part Number	Effective Length (L)
MF-R25-0600	600 mm
MF-R25-0900	900 mm
MF-R25-1200	1200 mm
MF-R25-1800	1800 mm

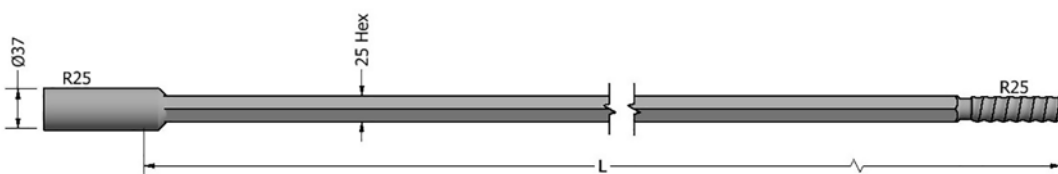

R25 AND R32 SHANK RODS

R25 DRILL BITS

R25 SPHERICAL BUTTON DRILL BITS

Part Number	Dimension (D)
BB-R25-33-H	33 mm
BB-R25-35-H	35 mm
BB-R25-38-H	38 mm
BB-R25-41-H	41 mm
BB-R25-43-H	43 mm
BB-R25-45-H	45 mm
BB-R25-48-H	48 mm
BB-R25-51-H	51 mm
BB-R25-57-H	57 mm



R25 BALLISTIC BUTTON DRILL BITS

Part Number	Dimension (D)
BB-R25-33-B	33 mm
BB-R25-35-B	35 mm
BB-R25-38-B	38 mm
BB-R25-41-B	41 mm
BB-R25-43-B	43 mm
BB-R25-45-B	45 mm
BB-R25-48-B	48 mm
BB-R25-51-B	51 mm
BB-R25-57-B	57 mm



R25 DRILL BITS

R25 CROSS DRILL BITS

Part Number	Dimension (D)
XB-R25-35	35 mm
XB-R25-38	38mm
XB-R25-41	41mm
XB-R25-45	45 mm
XB-R25-51	51 mm
XB-R25-57	57 mm

R32 CROSS DRILL BITS

Part Number	Dimension (D)
XB-R32-41	41mm
XB-R32-43	43mm
XB-R32-45	45mm
XB-R32-51	51mm
XB-R32-57	57mm

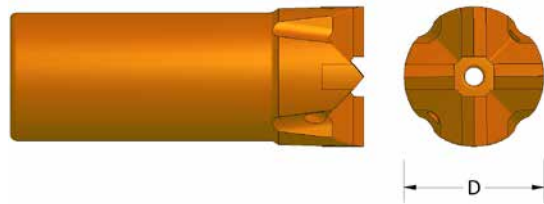

REAMING TOOLS

PILOT ADAPTORS

Part Number	Description
PA-R25F-06D-TC	Pilot adaptor – R25 Female – 6 degree
PA-R32F-06D-TC	Pilot adaptor – R32 Female – 6 degree
PA-R32F-12D-TC	Pilot adaptor – R32 Female – 12 degree

PERCUSSIVE REAMING BITS - 6° TAPER

Part Number	Diameter (D)
PRB-06D-64-H	64 mm
PRB-06D-76-H	76 mm
PRB-06D-89-H	89 mm

PERCUSSIVE REAMING BITS - 12° TAPER

Part Number	Diameter (D)
PRB-12D-89-H	89mm
PRB-12D-102-H	102mm
PRB-12D-115-H	115mm
PRB-12D-127-H	127mm

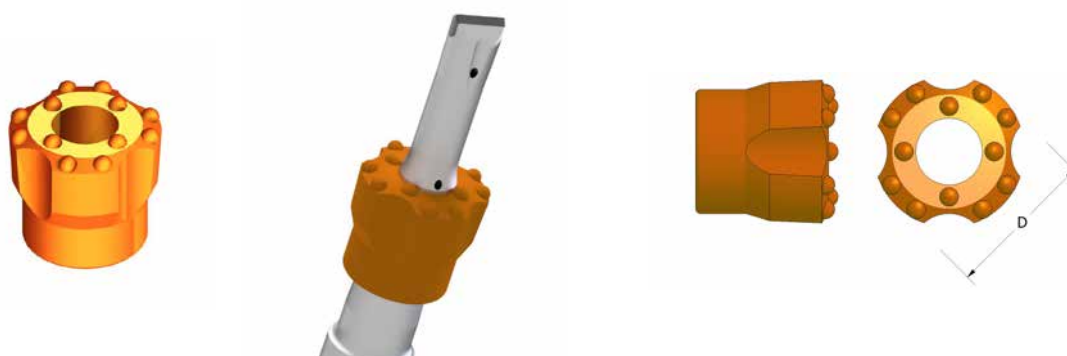

REAMING TOOLS

EXPERTISE YOU CAN DEPEND ON

SPLIT SET DRIVER TOOLS

AIRLEG DOLLIES

Part Number	Dimension (D)
SD-33-300-22R	33 mm
SD-39-300-22R	39 mm
SD-47-300-22R	47 mm

* Through water hole version available on request.

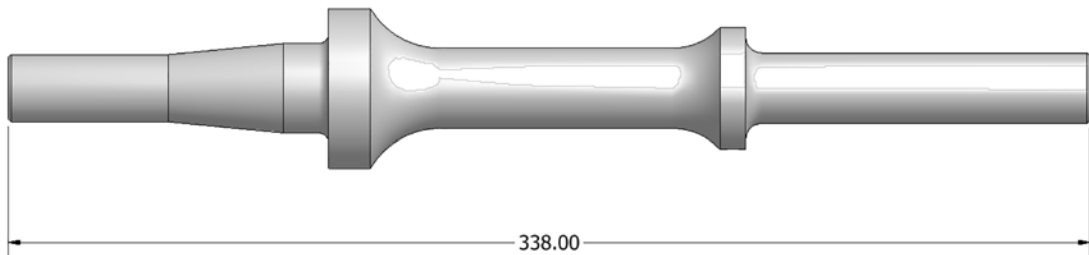

FEMALE THREADED DOLLIES

Part Number	Internal Thread	Split Set Size
SD-22HF-33	22 Hex	33 mm
SD-R25F-33	R25	33 mm
SD-R32F-33	R32	33 mm
SD-R32F-39	R32	39 mm
SD-R32F-46	R32	46 mm
SD-R38F-33	R38	33 mm
SD-R38F-39	R38	39 mm
SD-R38F-46	R38	46 mm
SD-T38F-33	T38	33 mm
SD-T38F-39	T38	39 mm
SD-T38F-46	T38	46 mm

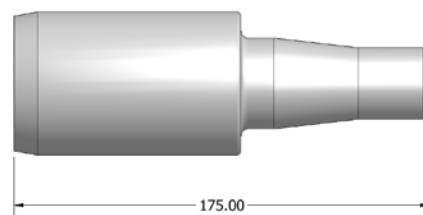

SALES – HIRE – SERVICE

The “BOAR” has a lightweight piston with large diameter, powerful rotation mechanism and flushing, assuring successful drilling output, even when drilling in poor rock and with low air pressure operation.

BOAR SERIES ROCK DRILLS - TECHNICAL SPECIFICATIONS

Model	Boar	Boar Max	Boar Max Plus
Part Number	DU-9-307-01-L	DU-9-307-05-L	DU-9-307-10-L
Boar	90 mm	90 mm	90 mm
Stroke	45 mm	60 mm	60 mm
Impact Rate	3100/min	2750/min	2650/min
Free Speed	320 RPM	300 RPM	265 RPM
Air Consumption	4.5 m ³ /min @ 6 bar	4.5 m ³ /min @ 6 bar	4.5 m ³ /min @ 6 bar
Operating Air Pressure	4-7 bar	4-7 bar	4-7 bar
Air Connection	1" BSP	1" BSP	1" BSP
Water Connection	1/2" Hose	1/2" Hose	1/2" Hose
Rock Drill Shank	22 x 108 mm Hex	22 x 108 mm Hex	22 x 108 mm Hex
Net Weight	30.5 kg	31 kg	31 kg
Length	685 mm	700 mm	700 mm



All models are available with sinker anti-vibration handle. When fitted, measured vibration* is reduced from 23 m/s to 7.5 m/s.

*Vibration levels were recorded @ 6 bar pressure.

SALES - HIRE - SERVICE

DT SERIES AIRLEGS - TWO STAGE

Type	Part Number	Retracted Length (A)	Stroke (B)	Extended Length (C)	Weight	Piston Diameter	Material
DT100 AL	DU-64-979-010-DM	1100 mm	1040 mm	2140 mm	13.3 kg	78/65 mm	AL
DT140 AL	DU-64-979-014-DM	1305 mm	1440 mm	2745 mm	15.0 kg	78/65 mm	AL
DT140 SS	DU-64-979-014-FP	1305 mm	1440 mm	2745 mm	22.0 kg	78/65 mm	SS
DT180 AL	DU-64-979-018-DM	1505 mm	1840 mm	3345 mm	16.6 kg	78/65 mm	AL

Other sizes may be available on request. Please enquire for lead times.

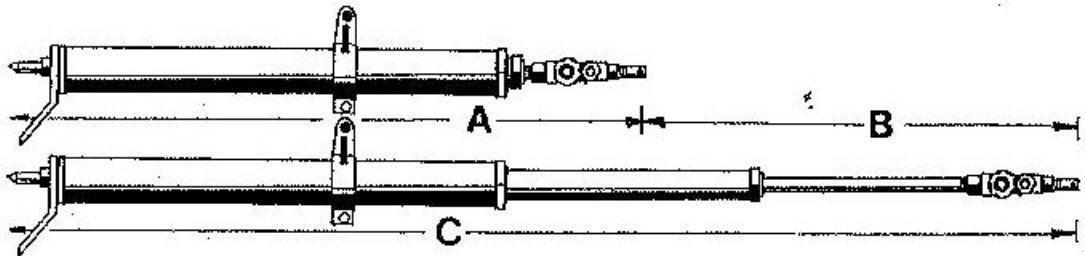

Features:

- Durable construction
- Independent controls – airleg mounted
- Double telescopic design
- Push button retraction – airleg mounted
- Minimum repositioning during drilling



The double telescopic design characteristic incorporating independent control and push-button retraction gives added flexibility and manoeuvrability in all conditions, minimising repositioning of the airleg during hole drilling.

The double telescopic extension allows for long hole drilling in one pass.

A full range of spare parts is available for all equipment.

SALES - HIRE - SERVICE

DT SERIES AIRLEGS - TWO STAGE

Models Number	Collapsed Length	Extended Length	Stroke	Rotation
DU-9-307-07-ST-150L - Double Telescopic	1520 mm (60")	3070 mm (121")	1550 mm (61")	Left
DU-9-307-07-ST-150R - Double Telescopic	1520 mm (60")	3070 mm (121")	1550 mm (61")	Right

Other sizes may be available on request. Please enquire for lead times.



Features:

- Unbeatable combination of both the Boar Series Rockdrill and DT Series Jackleg technologies
- Double telescopic design
- Adjustable drilling speed and feed pressure controls
- Very robust and extremely reliable
- High level of part interchangeability with standard rockdrills and airlegs

CP9 DRILLS AND TOOLS

ERGONOMIC LIGHT WEIGHT ROCK DRILLS

Part Number	Shank	Weight
AM-PL5 / CP9	CP9	5.5 kg



A full range of spare parts is available for all equipment.

* Available in Flame Proof version on request.

CP9 INTEGRAL DRILL STEELS

Part Number	Overall Length (L)	Diameter (D)
CP9-0200-16	200 mm	16 mm
CP9-0200-19	200 mm	19 mm
CP9-0200-22	200 mm	22 mm
CP9-0200-28	200 mm	28 mm
CP9-0330-25	330 mm	25 mm
CP9-0330-32	330 mm	32 mm
CP9-0330-35	330 mm	35 mm
CP9-0330-13	330 mm	13 mm
CP9-0330-16	330 mm	16 mm
CP9-0330-19	330 mm	19 mm
CP9-0330-28	330 mm	28 mm
CP9-0430-19	430 mm	19 mm
CP9-0430-22	430 mm	22 mm
CP9-0430-25	430 mm	25 mm
CP9-0430-32	430 mm	32 mm
CP9-0430-35	430 mm	35 mm
CP9-0450-14	450 mm	14 mm
CP9-0450-19	450 mm	19 mm
CP9-0450-24	450 mm	24 mm
CP9-0450-32	450 mm	32 mm
CP9-0450-35	450 mm	35 mm
CP9-0590-32	590 mm	32 mm

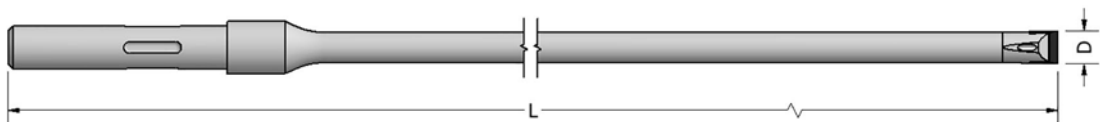

LIGHT WEIGHT HAMMER AND BREAKERS

CP9 DRILL STEELS - MOIL CHISEL AND SPADE

Part Number	Overall Length (L)	End Type
CP9-MP-250	250 mm	Moil
CP9-CH-250	250 mm	Chisel
CP9-CH-350	350 mm	Chisel
CP9-SP-60	250 mm	Spade

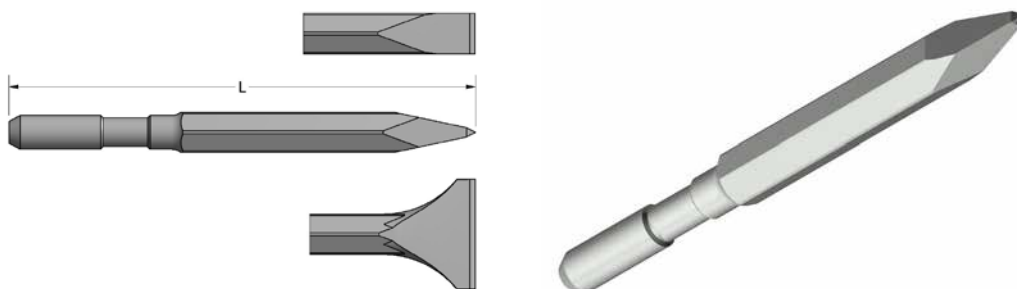

OTHER HAMMERS & BREAKERS AVAILABLE

A range of lightweight hammers, demolition hammers and pavement breakers are available on request.

LIGHT WEIGHT HAMMER AND BREAKERS

22 HEX MOIL, CHISEL AND SPADE

Part Number	Overall Length (L)	End Type
MP-22083HM-0380	380 mm	Moil
MP-22083HM-0460	450 mm	Moil
CHI-22083HM-0380	380 mm	Chisel
CHI-22083HM-0450	450 mm	Chisel
CHI-22083HM-0380-75W	460 mm	Spade

Note: Also available in 25mm, 28mm and 32mm hex.

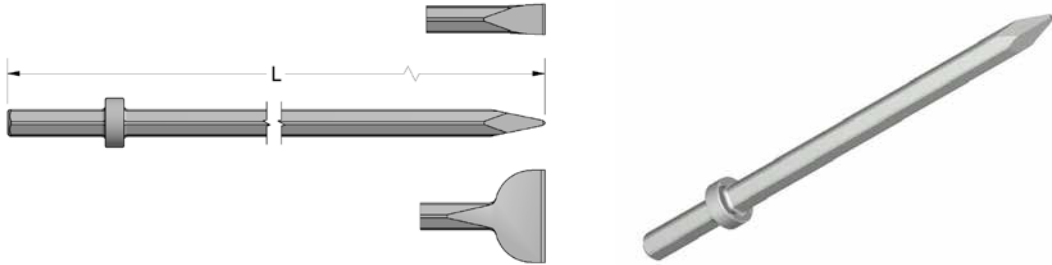

ROCK DRILL AIR LUBRICATORS: Air Operated Adjustable Oil Lubricators

Part Number	Thread	Oil Capacity	Max WP	Component Materials			
				Body	Venturi	Jet	Bundy Tubes
DX-08-066-02-000	1" BSP	1.2 L	300 PSI	Mild Steel	Cast Steel	Mild Steel	Copper
DX-08-066-02-000-C	1" BSP	1.2 L	300 PSI	Mild Steel	Cast Steel	Mild Steel	Copper
PRH-I-OILER	1" BSP	150ml					

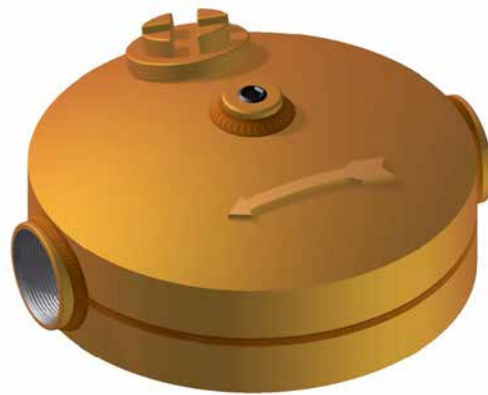

Air lubricator setup guide available on request.

*C denotes complete with claw couplings

IN-LINE LUBRICATORS

Small to large in-line lubricators suitable for air tools to jumbo drill rigs available on request.



***Range of Rock drill and air tool oils available.*

PERCUSSIVE ROTARY DRILL AND TOOLS

PERCUSSIVE ROTARY DRILL AND TOOLS

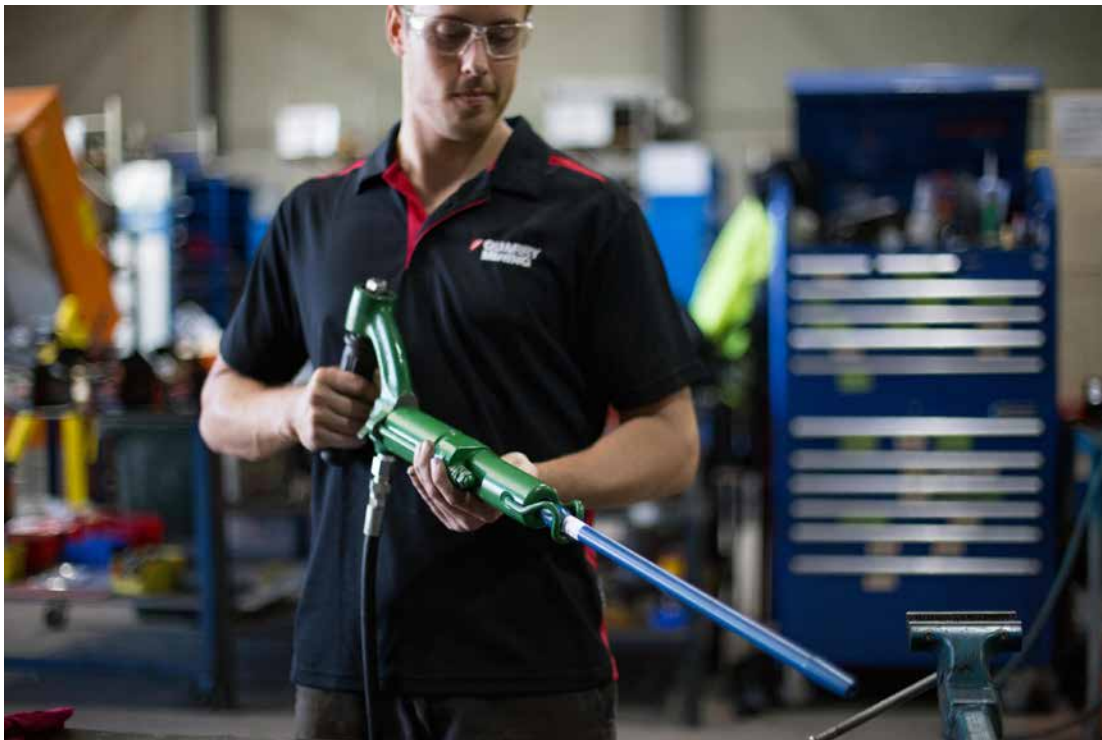

GH5 - ROTARY PERCUSSIVE DRILL

Part Number	Description
PRH-GH-5	Pneumatic rotary hammer GH-5
PRH-GH-5-AVH	GH5 - Anti vibration handle

TAPERED INTEGRAL DRILL RODS

Part Number	Overall Length (mm)
PRH-SR19-0300	300
PRH-SR19-0400	400
PRH-SR19-0500	500
PRH-SR19-0600	600
PRH-SR19-0700	700
PRH-SR19-0800	800
PRH-SR19-0900	900
PRH-SR19-1000	1000
PRH-SR19-1200	1200

*** 120mm lost on drill depth



PERCUSSIVE ROTARY DRILL AND TOOLS

TAPERED INTEGRAL DRILL BITS

Part Number	Diameter (mm)
PRH-SC19-1-24	24
PRH-SC19-1-26	26
PRH-SC19-1-28	28
PRH-SC19-1-30	30
PRH-SC19-1-32	32
PRH-SC19-1-34	34
PRH-SC19-1-36	36
PRH-SC19-1-38	38



TAPERED BUTTON DRILL BITS

Part Number	Diameter (mm)
PRH-BT19-1-24	24
PRH-BT19-1-26	26
PRH-BT19-1-28	28
PRH-BT19-1-30	30
PRH-BT19-1-32	32
PRH-BT19-1-34	34
PRH-BT19-1-36	36
PRH-BT19-1-38	38



Y-PIECE HOSES

ROCK DRILL Y-PIECES

Rock Drill Y-Pieces complete with minsup Type-A fittings. Available in both standard A/W and FRAS Delivery Hose.

Standard Y-Piece configuration:



ROCK DRILL Y-PIECES

Part Number	House Grade
Y-PIECE-HOSE	Standard A/W Delivery
Y-PIECE-HOSE-FR	FRAS Delivery

***surelock fittings available on request*

SWIVEL HOSE WITH OILER ASSEMBLIES

Part Number	Description
ACC-SW-HOSE12	Air Tool - Swivel Hose 1/2
ACC-SW-HOSE14	Air Tool - Swivel Hose 1/4
ACC-SW-HOSE38	Air Tool - Swivel Hose 3/8

ROCK DRILL SPANNERS

HAND HELD ROCK DRILL SPANNERS – 22 HEX DRIVE:

Shank 22 x 108 mm

Part Number	Overall Length (L)	Weight
SP-22HM-0300-36	300 mm	1.55 kg
SP-22HM-0500-36	500 mm	2.55 kg
SP-22HM-0600-36	600 mm	3.05 kg

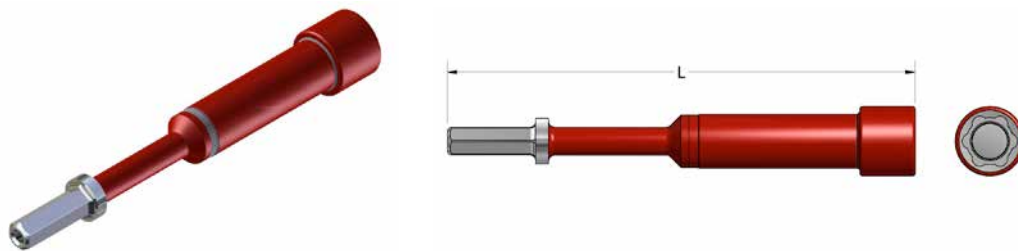

Other sockets sizes can be manufactured on request.

TOP MOUNT ROOFBOLTER

SUPERIOR UNIT - HIGH TORQUE, THRUST AND RELIABILITY

SALES - HIRE - SERVICE

- Simple operation
- Lightweight
- Fingertip control
- Reduced noise emissions
- Energy saving motor
- Cone and Cup bearing
- Advanced leg components

ALMINCO 
Gopher



TECHNICAL SPECIFICATIONS

GOPHER - Hitorque Extended	@80 PSI	@100 PSI
Motor Size	95 mm	95 mm
RPM (no load)	670	720
Air Consumption	3.7 m ³ /min	4.0 m ³ /min
Water Supply Pressure (recommended)	861-1206 kPa	861-1206 kPa
Water Flow Rate (subject to supply)	12 L/min	14 L/min
Stall Torque	250 Nm	280 Nm
Torque through clutch	339 Nm	339 Nm
Maxi Leg thrust		
Stage 1	903 kgf	1129 kgf
Stage 2	690 kgf	863 kgf
Stage 3	487 kgf	609 kgf
Noise level	84 dB(A)	90 dB(A)

3 Stage Models	Model No.	Collapsed Length (mm)	Extended Length (mm)
70-LDL-035 (short motor)	118	845	1330
70-LDL-045 (short motor)	200	1050	2140
70-LDL-055E	250	1185	2530
70-LDL-065E	310	1360	3215
70-LDL-075E	350	1520	3825

* An oiler should be fitted within 5m of the gopher

Refer to OEM of roofbolter operators guide and safety points for safe working practices.

NOTE: Other styles and sizes are available. A full range of spare parts is available for all equipment.

TOP MOUNT ROOFBOLTER

CLARK EAGLE MK2 AIR POWERED DRILL

- ✓ Reduced noise emission
- ✓ Energy saving motor
- ✓ Airleg attachment available

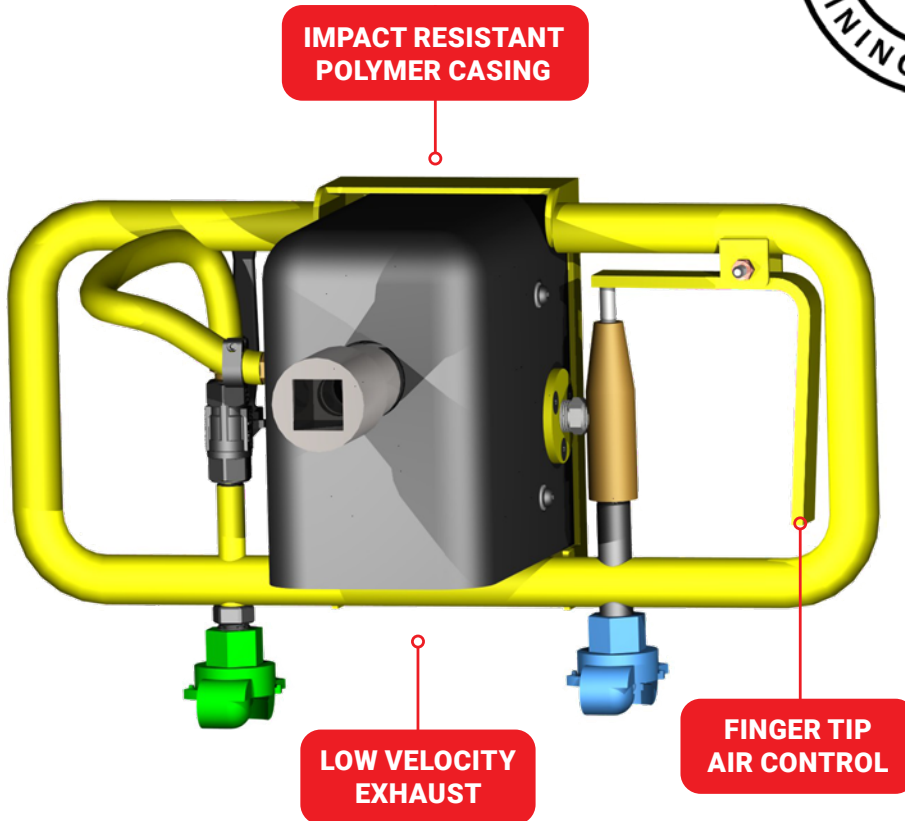

CLARK EAGLE MK2 AIR POWERED DRILL

RIB DRILL TECHNICAL SPECIFICATIONS

Dimensions:	Height	273 mm
	Width	450 mm
	Depth	316 mm
Weight:		9 kg
Stall torque:		68 Nm
Air consumption:		2.2 m ³
Air pressure max:		827 kPa
Drill chuck:		25 mm twist lock square

EXPERTISE YOU CAN DEPEND ON

ROOF BOLTING SPANNERS

SPANNERS

Strongest and safest available. All spanners have hardened steel sockets and heat treated drive ends. Other socket sizes can be manufactured upon request.

CONVENTION

SP - XXXX - XXXX - XX

SPANNER

DRIVE

LENGTH

SOCKET

STANDARD 25 SQUARE DRIVE WITH 36 AF SOCKET: NON FLUSH

PART NUMBER	Overall Length	Weight (kg)
SP-25SM-0300-36	300 mm	1.9
SP-25SM-0450-36	450 mm	2.8
SP-25SM-0500-36	500 mm	3.1
SP-25SM-0600-36	600 mm	3.7
SP-25SM-0800-36	800 mm	4.9
SP-25SM-1000-36	1000 mm	6.1



IMPACT WRENCH SPANNERS

FEMALE SQUARE DRIVE SPANNERS

Strongest and safest available. All spanners have hardened steel sockets and heat treated drive ends. Other socket sizes can be manufactured upon request.

CONVENTION

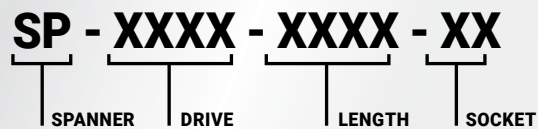

FEMALE SQUARE DRIVE SPANNERS

PART NUMBER	Overall Length	Socket	Drive
SP-12SF-0300-36	300 mm	36 AF	12 mm FM square
SP-19SF-0300-36	300 mm	36 AF	19 mm FM square
SP-25SF-0300-36	300 mm	36 AF	25 mm FM square

* Other lengths and sockets available on request.

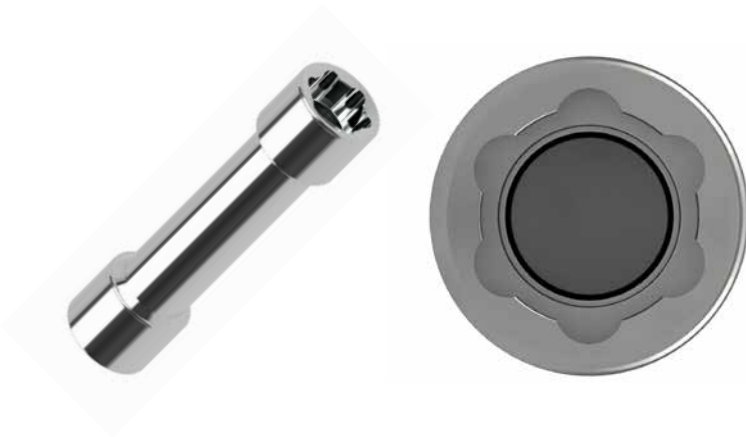

RATTLE GUNS

A range of rattle guns from ½" to 1" are available from a range of reputable brands. Flame proof options are available on request.

GROUT MIXERS AND PUMPS

GROUT MIXERS AND PUMPS

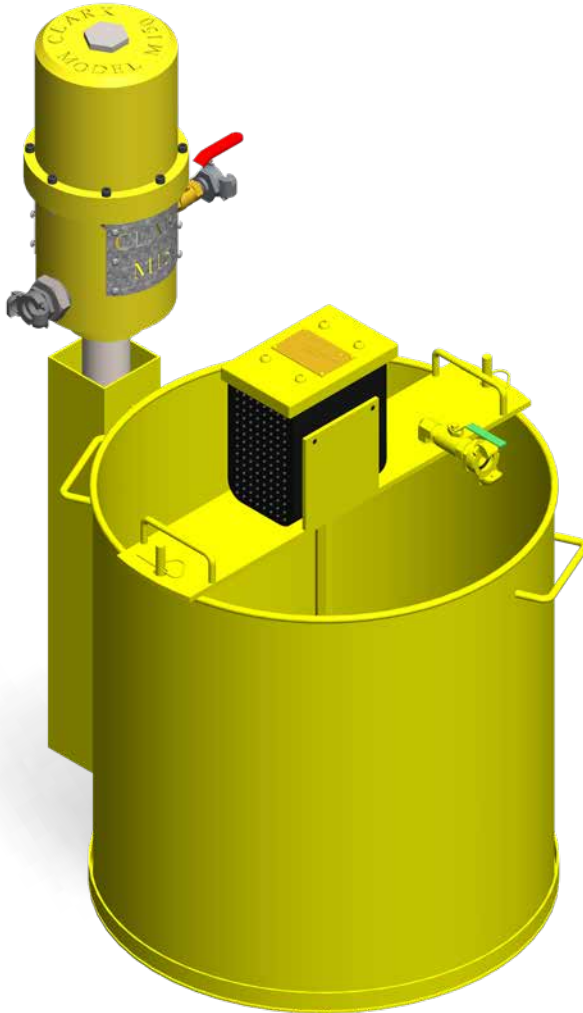

GROUT MIXERS AND PUMPS

- ✓ Versatile and easy to use
- ✓ Mesh guards fitted

OPTIONS:

- ✓ 150 and 500 litre capacities
- ✓ Thixotropic bowl or flat bottom
- ✓ Standard or high torque mixer
- ✓ Standard or high flow pumps

M150 & M150EQ Grout pump performance at 689 kPa air pressure, pumping water.
 M150P Grout pump performance at 600kPa air pressure pumping water.

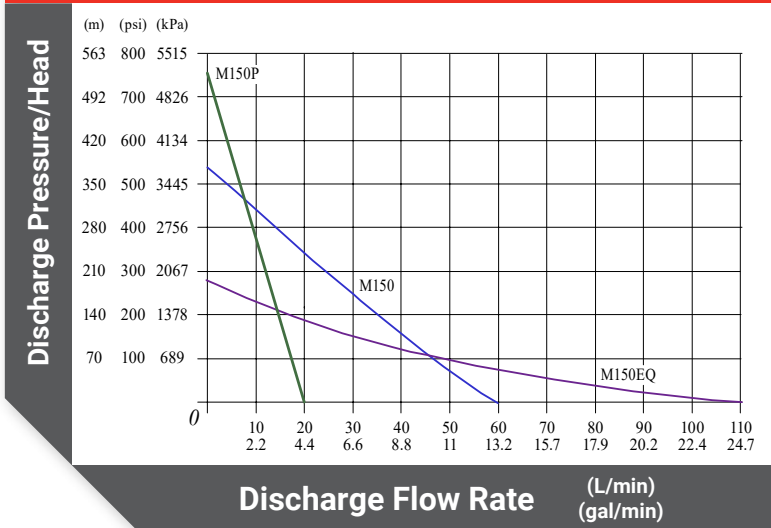

SPECIFICATIONS	M150P	M150	M150EQ
Motor Piston (Ømm)	150	150	150
Weight (kg)	16.6	17	19
Length (mm)	1056	1090	1095
Maximum Flow (L/min)	20	60	110
Maximum Pressure (kPa)	5100	3500	1900
Maximum Air Supply (m³/h)	50	50	50
Discharge Port (mm BSP)	25	25	40

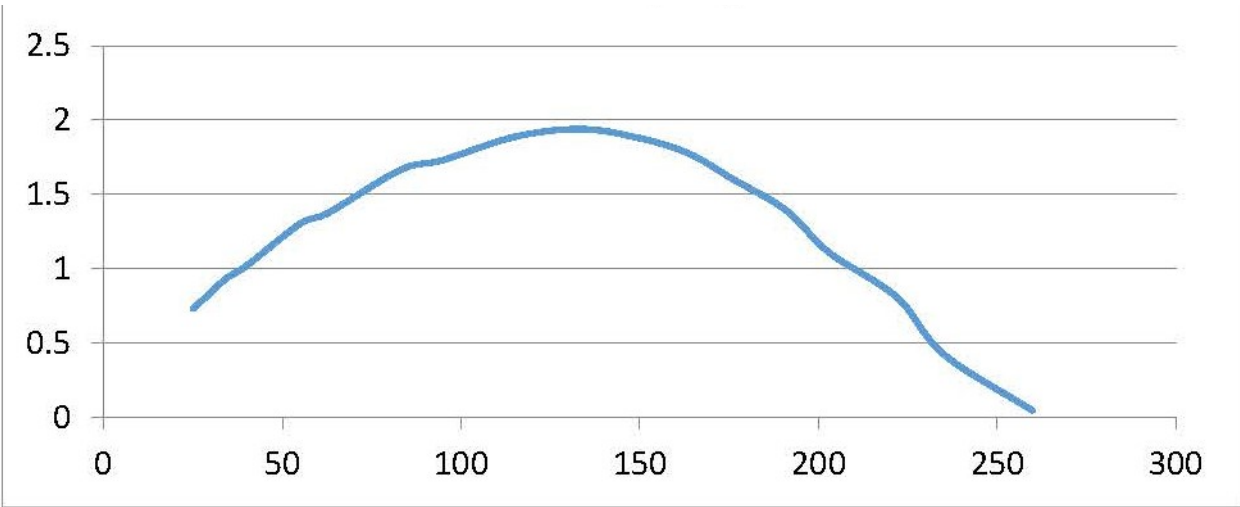

GROUT MIXERS AND PUMPS

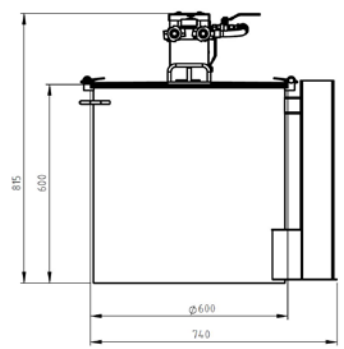
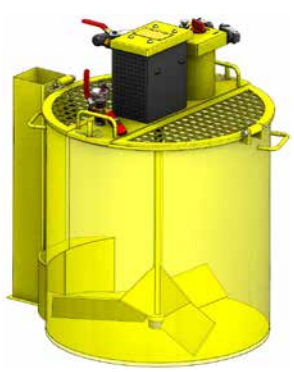

GP407 GROUT MIXER

- Power: 1.94 kW @ 133 rpm
- Maximum free speed: 260 rpm
- Starting torque: 279 Nm
- Stall torque: 501 Nm
- Air Consumption: 37 L/sec
- Weight: 49 kg

EXPERTISE YOU CAN DEPEND ON

GROUT BOWL DUST MITIGATION SYSTEM



EAT MY DUST

GROUT BOWL DUST MITIGATION SYSTEM

- ✓ Superior dust control - minimises risk to personnel, mess and product wastage
- ✓ Ergonomically improved - minimal bend and twist for operator
- ✓ Adapts to any make of 150 litre bowl unit



GROUT BOWL DUST MITIGATION SYSTEM

GROUT HOSE



SPECIFICATIONS:

35 bar (525 psi)

AS 2660/B

Tube: Black conductive SBR/NR

Reinforcement: High tensile textile cords

Cover: Black conductive SBR – abrasion, ozone and fire resistant

Use: Air, water and stone dust delivery in underground mines

Safety factor: 2,5:1

Temperature: -30 °C +80 °C (-22 °F + 176 °F)

Internal Diameter		Outside Diameter		Maximum Working Pressure		Minimum Bend Radius		Vacuum	Weight	
mm	inch	mm	inch	bar	psi	mm	inch	%	kg/m	lb/ft
13	1/2	23	0,91	35	525	78	3,00		0,390	0,265
19	3/4	31	1,22	35	525	114	4,50		0,520	0,350
25	1	37	1,46	35	525	150	6,00		0,660	0,445

GROUT HOSE

GROUT PACKER

Various sizes available

- Hole bore Ø35 to Ø110mm
- Lengths from 0.5m to 2m
- Special sizes made on request

Packer Length must be appropriate to the length of the hole and when expanded must be secure in the hole.

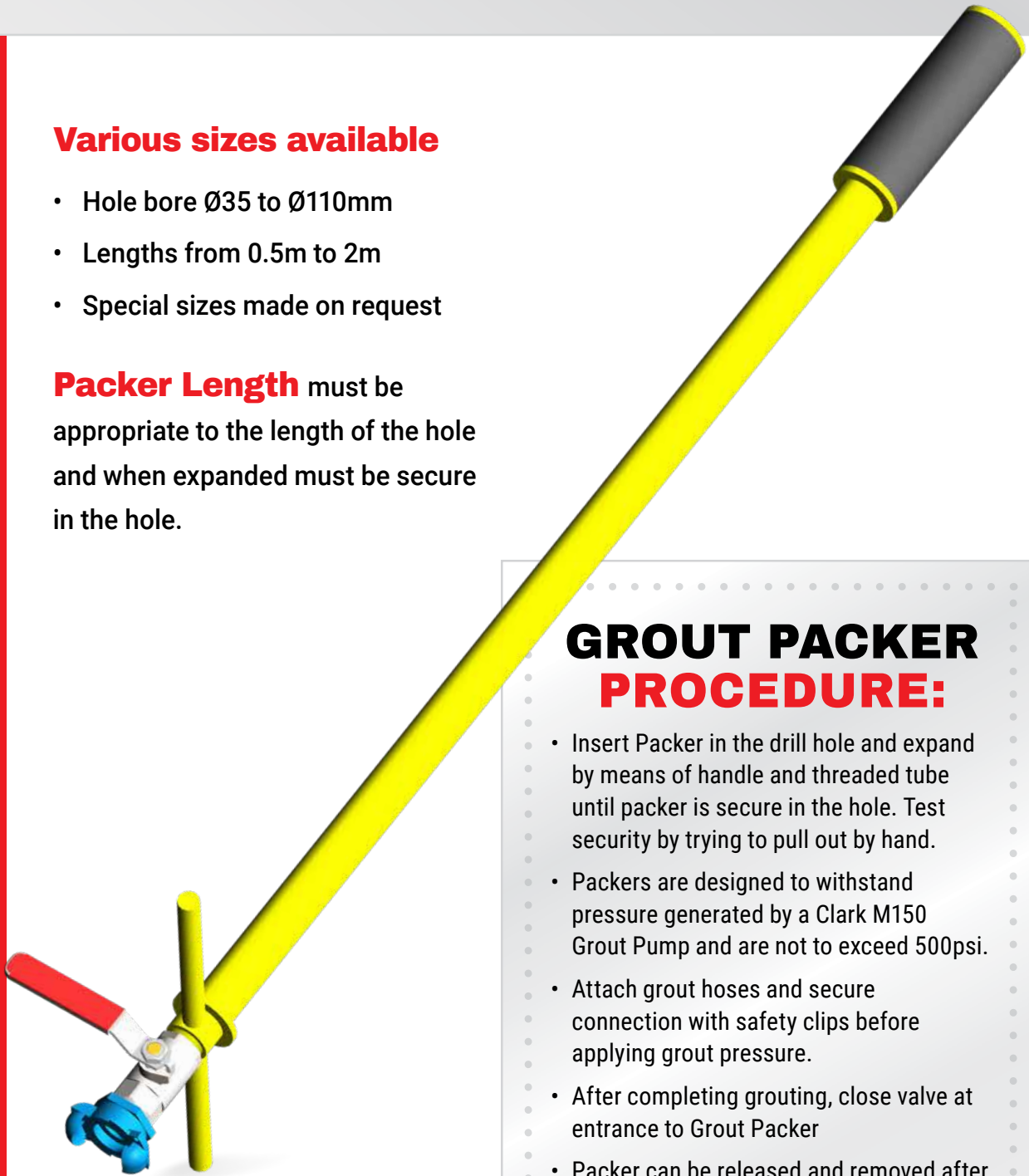

GROUT PACKER PROCEDURE:

- Insert Packer in the drill hole and expand by means of handle and threaded tube until packer is secure in the hole. Test security by trying to pull out by hand.
- Packers are designed to withstand pressure generated by a Clark M150 Grout Pump and are not to exceed 500psi.
- Attach grout hoses and secure connection with safety clips before applying grout pressure.
- After completing grouting, close valve at entrance to Grout Packer
- Packer can be released and removed after grout has set and while it is still green.

APPLICATIONS

- ✓ Grout Injection
- ✓ De-watering of strata
- ✓ Slab jacking
- ✓ Gas drainage

WILDEN PUMPS

WILDEN®

T810 FLAP VALVE 51mm (2") TURBO-FLO™ BRAHMA™ BOLTED METAL PUMP

SALES - SERVICE - REPAIR

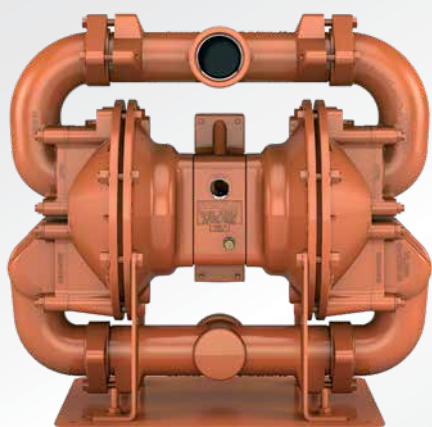

TECHNICAL SPECIFICATIONS

AIR INLET	3/4" FNPT
LIQUID INLET	51 mm
LIQUID DISCHARGE	51 mm
CONNECTION TYPE	NPT/BSPT (Threaded)
MAX SUCTION LIFT CAPABILITY	7.6 m Dry 9.3 m Wet
MAX FLOW RATE	617 lpm (163 gpm)
MAX PRESSURE	8.6 bar (125 psi)
MAX DIAMETER SOLIDS	51 mm
DISPLACEMENT PER STROKE*	1.7 L

*Cycle = 2 strokes

T8 BALL VALVE 51mm (2") TURBO-FLO™ CLAMPED METAL PUMP



TECHNICAL SPECIFICATIONS

AIR INLET	3/4" FNPT
LIQUID INLET	51 mm
LIQUID DISCHARGE	51 mm
CONNECTION TYPE	NPT/BSPT (Threaded)
MAX SUCTION LIFT CAPABILITY	Dry lift 6.4 m
MAX FLOW RATE	617 lpm (163 gpm)
MAX PRESSURE	8.6 bar (125 psi)
MAX DIAMETER SOLIDS	6.4 mm
DISPLACEMENT PER STROKE*	2.69 L

*Cycle = 2 strokes

WILDEN PUMPS

EXPERTISE YOU CAN DEPEND ON

REFLEX RUBBER STRAINER



Advanced Flexible Dewatering and Filtration Strainer for Harsh Environments

- ✓ Use on roadways open cut and underground subject to constant water inundation
- ✓ Strong, Lightweight and flexible
- ✓ Does not corrode – long lasting
- ✓ Quick and easy to clean
- ✓ No sharp edges reducing injuries
- ✓ No steel / sharp objects submersed reducing trip and cut hazards
- ✓ Easy to use inside boreholes
- ✓ Suction Hosetail attachment



Technical Specifications

Flow rate	850 litres per minute
Elongation	Safe capability 450%
Hole size	8mm
Length	370mm or 470mm with hosetail
Width	90mm
Weight	550g or 700g with hosetail
Hardness	90 shore A
Temperature range	Safe -66 °C to 100+ °C
Size	2" (51mm) standard. Other sizes available on request.

Assemblies made to length as requested.

REFLEX RUBBER STRAINER

VENTILATION FANS FOR HAZARDOUS ENVIRONMENTS

3 MODELS AVAILABLE:

AF250

- 9 kg
- Blade dia 250 mm
- Air Delivery 0.6 m³/sec
- Air Consumption 26 L/sec

AF500

- 11 kg
- Blade dia 500 mm
- Air Delivery 3.4 m³/sec
- Air Consumption 70 L/sec

18AF680

- 35 kg
- Blade dia 600 mm
- Air Delivery 5.5 m³/sec
- Air Consumption 80 L/sec



VENTILATION FANS

EXPERTISE YOU CAN DEPEND ON

VENTURI EXTRACTORS

- ✓ Available in FRAS or alloy and galvanised steel construction:
 - **FRAS Sizes:** 40mm or 100mm (throat size)
 - **Steel Sizes:** 75mm, 152mm, 203mm
- ✓ Air powered, suitable to remove fumes that may be poisonous, explosive or hazardous from process towers, tanks, large pipes or confined spaces
- ✓ Maintenance free
- ✓ No moving parts
- ✓ Can be reversed and used as a blower
- ✓ Trouble free and quiet
- ✓ Detailed specs available on request

**AVAILABLE IN;
ALUMINUM,
STAINLESS STEEL
OR FIBERGLASS**



VENTURI EXTRACTORS

ALUMINIUM VENTURIS: Specifications

PART NO.		OVERALL LENGTH (MM)	DIAMETER OF BASE (MM)	DIAMETER OF TOP (MM)	NPT SIZE (MM)	NET WEIGHT (KG)
WH-VEN-9518-03S	3" Aluminium Venturi	452	186	152	12.7	2.5
WH-VEN-9518-06	6" Aluminium Venturi	1124	286	317	25	10
WH-VEN-9518-08	8" Aluminium Venturi	1170	365	362	25	16

TOTAL AIR FLOW – exhaust rate (cubic feet per minute)

PART NO.	DESCRIPTION	40 PSI	60 PSI	80 PSI	100 PSI
WH-VEN-9518-03S	3" Aluminium Venturi	815	981	1182	1407
WH-VEN-9518-06	6" Aluminium Venturi	2385	2885	3347	4067
WH-VEN-9518-08	8" Aluminium Venturi	3152	4152	4929	5792

FIBREGLASS VENTURIS: Specifications

PART NO.		OVERALL LENGTH (MM)	DIAMETER OF BASE (MM)	DIAMETER OF TOP (MM)	NPT SIZE (MM)	NET WEIGHT (KG)
MAR001-M	8" FRAS Venturi	863	304	355	20	7.26
MAR002-M	6" FRAS Venturi	635	247	330	12	5.90
MAR003-M	4" FRAS Venturi	343	152	203	12	1.36

TOTAL AIR FLOW – exhaust rate (cubic feet per minute)

PART NO.	DESCRIPTION	40 PSI	60 PSI	80 PSI	100 PSI
MAR001-M	8" FRAS Venturi	-	2000	2700	3400
MAR002-M	6" FRAS Venturi	-	980	1800	2300
MAR003-M	4" FRAS Venturi	360	720	1250	1600

THE COOL TUBE MKII

THE COOL TUBE MKII



THE COOL TUBE[®] MKII

Operational testing traceable back to National Standards by the NATA certified laboratory, SIMTARS

Mine Spec, compressed air driven portable “air conditioners”, deliver super cooled air to the workspace to combat the environmental conditions of heat stress, and or assist in controlling the operation temperatures of equipment and infrastructure.

THE
COOL
TUBE
MKII

Developed and manufactured for the intended use of:

- ✓ Hot, humid underground mining activities that are low ventilation.
- ✓ Confined space locations such as vessels, dragline tubes, hoppers and tank compartments.
- ✓ Concealed areas, tunnels and shafts.
- ✓ Positive pressure air-conditioned refuge chambers, COBs and crib areas.
- ✓ Fixed equipment and infrastructure cooling - i.e. transformers, electric motors, gearboxes, radiators and bearings
- ✓ Any hot and or humid work area with sufficient compressed air available.

*With no moving or maintainable parts, **THE COOL TUBE[®] MKII** has a size to suit your application.*

HOSE FITTING AND ACCESSORIES

FULL RANGE OF VALVES

- Econo Valve
- Butterfly
- Swing Check
- Pressure Reducing



HOSES AND FITTINGS

- Air / Water
- FRAS
- Suction
- Delivery



WHIPCHECKS



STRAINERS

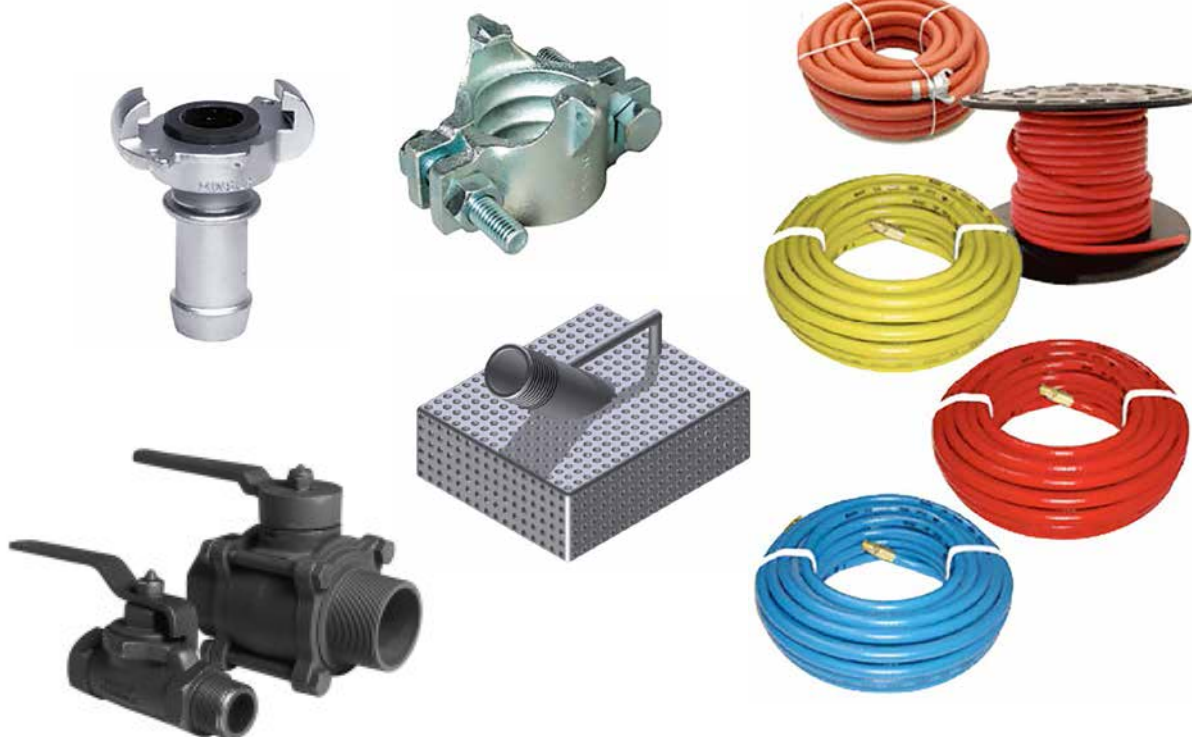

* Full catalogue available on request.

BRATTICE VENTILATION SHEETING

STRENGTH - DURABILITY - PERFORMANCE

BRATTICE

VENTILATION SHEETING

Superior performing ventilation sheeting for underground mining. Multiweave polypropylene fire retardant base material, complete with a fire retardant coating and an external printed anti static grid, specifically used for underground mining ventilation applications.



Brattice Ventilation Sheeting Advantages:

- ✓ Superior strength properties for greatly improved longevity once installed.
- ✓ Fire resistant base, coatings and printing combined with the anti static grid.
- ✓ Superior abrasion resistance
- ✓ Complete Australian Coal Board certifications.
- ✓ Environmentally safe.
- ✓ May be successfully converted into ducting, walls, lining, dust control, containment.
- ✓ Developed from studies involving miners, longwall personnel and ventilation orientated professionals.

MATERIAL

Scrim:	Fire Retardent PP	Tensile Strength:	Warp 936N x Weft 933N (certificates supplied)
Construction:	8x8	Australian and British Coal Board Minimum Requirements . (certificates already supplied)	
Yarn Size:	1500D	Electrical Resistance:	Av 53 ohms
Coating:	Fire Retardant PP 45 mic	Fire Resistance	Av 0.0 sec
Anti Static Grid:	Printed Both sides to standard of compliance to meet Australian and British coal board regulations	Air permeability:	Av 0.54 L.s ⁻¹ m ²
Weight:	180gsm		
Tear Strength:	Warp 198N x Weft 213N (certificates supplied)		

LUBRICATOR ADJUSTMENT INSTRUCTIONS

OIL LUBRICATOR ADJUSTMENT

The correct set-up and adjustment of the Oil Lubricator “Turtle” is critical to ensuring the performance and reliability of the pneumatic equipment. Too much oil is as bad as too little; oil is basically only required to provide some lubricant for the air motor. These instructions are for the ‘Minsup’ Oil Lubricator but the principles will be similar for other types.

Set-up of Lubricator

The lubricator should be installed in line of the air hose, no more than 5 m from the pneumatic rockdrill.

Safety clips must be used to ensure that high pressure air fittings cannot become accidentally disconnected.

The arrow marked on the top of the lubricator indicates the direction that the air should be flowing (should be pointing at the pneumatic rockdrill).



To check or fill the oil in the Lubricator, remove the filler cap by placing a large screwdriver across the cap and undoing anti-clockwise.

Most pneumatic drills are designed to be run using a light rockdrill oil 20-30 grade.

The lubricator should only be half filled (if you look inside the lubricator, oil should not be over the copper pipe) this should be sufficient for at least a full shift. Signs of over-oiling of a rockdrill include the following:

- Excessive oil vapour in the air
- Oil dripping out from the motor muffler
- Legs sticking (if applicable) and valves not dumping air



LUBRICATOR ADJUSTMENT INSTRUCTIONS



Adjustment of Oil Flow

To adjust the rate of oil flow, first remove the 1/4" BSP plug on top of the lubricator using a 6 mm Allen key. Next unscrew the locking nut using a straight blade screwdriver. (Note: this brass nut should not be confused with the adjustment screw which sits underneath).

To set up the lubricator, using a flat blade screwdriver first turn the adjustor fully clockwise, then turn back 1 1/3 turns.



Testing of Oil Flow

The adjustment of the Lubricator can be tested by setting up a piece of cardboard approx. 1 m from the air outlet of the lubricator. Carefully turn on the air supply (this should be 3000 LPM at 7 bar). The air should contain a fine mist of oil which will leave a damp mark on the cardboard, approximately 50 mm diameter. If running droplets of oil appear, this is evidence of over oiling.

Safety Points When Testing:

- Wear safety glasses & ear protection
- Beware of air blast from outlet hole, hold lubricator body firmly
- Test in a safe area, away from other personnel



QUARRY MINING

& CONSTRUCTION EQUIPMENT PTY LTD

New South Wales

9/14 Yangan Drive,
Beresfield NSW 2322

ph: +61 (0)2 4966 5028

fax: +61 (0)2 4910 9022

e: orders@quarrymining.com

Queensland

5/35 Iridium Drive,
Paget QLD 4740

ph: +61 (0)7 4998 5295

fax: +61 (0)7 4805 6126

e: ordersqld@quarrymining.com

Distribution Warehouse - Sydney

Unit 1, No.1 Bearing Road,
Seven Hills NSW 2147

ph: +61 (0) 499 707 553

e: orders@quarrymining.com



QMS Certification Services



QMS Certification Services



QMS Certification Services

CAT-SHDPE v12 2023



EXPERTISE YOU CAN DEPEND ON

WWW.QUARRYMINING.COM