

HOW TO USE

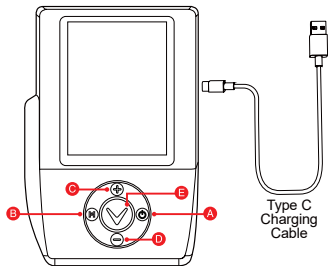

- A. [POWER] Button:** Press & hold to power ON/OFF
- B. [M] Mode Button:** Press to turn P.A.T. Mode ON/OFF. Press & Hold for 3 seconds to turn Slope ON/OFF. When in Settings menu, Press to return to play screen.
- C. [+] Button:** Press to magnify, and scroll up
- D. [-] Button:** Press to demagnify, and scroll down
- E. [✓] Select Button:** Press to select. Double-click to change between EZ & Regular Mode

SCREEN DISPLAY

- A.** Zero-In Aiming Square
- B.** Crosshairs
- C.** Laser Indicator Box
- D.** P.A.T. with Pulse
- E.** Distance
- F.** Unit of Measure
- G.** EZ / REG Mode
- H.** Magnification
- I.** Slope Mode
- J.** Slope Angle of Incline
- K.** Slope Adjusted Distance
- L.** Battery Level

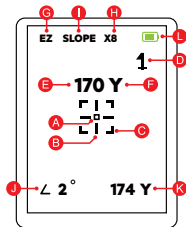

SLEEP MODE

The unit is programmed to “sleep” or darken the LCD screen after 10 seconds of inactivity. To “wake” the unit just press any button. There is a RED indicator light on the side of the unit that illuminates when the unit is ON and in “sleep” mode.

USING ON THE COURSE

There (2) Laser Firing Modes that can be used - EZ and Regular. To know what mode you're in, look in the upper left corner of the screen, either REG or EZ will show. To change between modes, double-click the **Select Button**.

1. **EZ MODE (default):** Put cross hairs to either right or left of the flag/target and **PRESS Select Button** once. Then move the cross hairs back and forth across the flag/target. The unit will scan for a couple seconds & the unit will Pulse when final yardage is determined.
2. **REG MODE:** Put cross hairs over flag/target and **PRESS Select Button** once. The unit will Pulse when the yardage is determined.

MEASUREMENT MODES

1. **Standard** - Standard Mode is recommended when measuring distances to larger objects.
2. **P.A.T. with Pulse Technology** - P.A.T. Mode is best used when measuring the distance to a flagstick or smaller objects. Device will provide a short vibration to confirm that the laser has locked on to the pin. To toggle between Standard & P.A.T Mode, quickly **PRESS Mode Button** once while device is powered on. When P.A.T. Mode is activated, the flagstick icon will appear on the upper right side of the LCD display. To turn Pulse ON/OFF, go to **Settings Menu**.

SETTINGS MENU

Once the unit is powered on, **PRESS** the **Power Button** to access **Settings Menu**. When you access the menu, you can do the following: adjust Brightness, change Font Color (RED, WHITE or BLACK), change between Meters & Yards, turn Pulse ON/OFF, turn Decimal point ON/OFF, turn Sound ON/OFF, change Language. **PRESS Mode Button** to return to play screen.

SLOPE YARDAGE

Slope adjusted yardage will show in the lower right corner of the screen. To turn feature ON/OFF **PRESS & HOLD** the **Mode Button** for 3 seconds.

PIN SEEKER

Pin Seeker feature will show as a Flag icon in the upper right of the screen. To turn feature ON/OFF **PRESS** the **Mode Button** once.

MAGNIFICATION

Unit will go from 4 – 8X magnification. **PRESS** the “+” and “-” buttons to increase/decrease the magnification.

MAGNAHOLD

The unit has a built-in magnet on the left side of the unit which can attached to any metal on either a riding or push cart for easy access.