



PROTECT PRODUCT



INCREASE CASTER LIFE



IMPROVE SAFETY  
AND ERGONOMICS



BOOST EFFICIENCY

## KEY SOLUTIONS

### NX WHEELS

- High capacity/easier-rolling Nylatron
- Resist corrosion, chemicals, and moisture
- Ergonomic crowned wheel face
- Sealed precision bearings – optional stainless precision bearing available
- V-Groove available (NV)



### ACCESSORIES FOR MOBILITY AND SAFETY

- Total lock brake option (select models)
- Toe guards: factory- or field-installable
- Swivel locks (field-installable)
- Ergonomic floor locks



### SPRING-LOADED CASTERS

- Reduce shock to expensive boat frames and molds
- Reduce noise and vibration during towing
- Protect flooring



## KINGPINLESS SOLUTIONS // Designed to Handle Shock & Impact and Provide Long Life



- Eliminates kingpin failure and made to handle shock and impact
- Ideal for more ergonomic hand-pushed requirements or power-towed applications
- Precision-machined raceway enhances ergonomics and safety
- Extended swivel leads available to improve ergonomics and reduce "chatter"
- Long-lasting
- 3-year warranty



### 110 CONTENDER SERIES CASTERS

Tread Width: 2"  
Capacity: Up to 2,000 lbs.

Wheel Diameters: 4", 5", 6", 8"  
Brake: Poly Lock (only available on 6" and 8"), Poly Cam, Face Contact  
Accessories: Field-Installable Swivel Lock, Factory-Installed Toe Guard



### 310/410 CONTENDER SERIES CASTERS

Tread Width: 3"  
Capacity: Up to 5,400 lbs.

Wheel Diameters: 6", 8", 10", 12"  
Brake: Poly Lock, Poly Cam, Face Contact  
Accessories: Field-Installable Swivel Lock, Factory-Installed Toe Guard



### 610 CONTENDER SERIES CASTERS

Tread Width: 3", 4"  
Capacity: Up to 9,500 lbs.

Wheel Diameters: 6", 8", 10", 12", 14"  
Brake: Poly Lock, Poly Cam, Face Contact  
Accessories: Field-Installable Swivel Lock, Factory-Installed Toe Guard

3D CAD MODELS  
AVAILABLE ONLINE

Visit website for details.

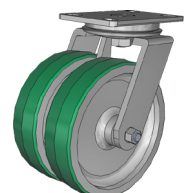

# SPRING-LOADED SOLUTIONS // Protect Your Products & Equipment



- Protects valuable product and flooring
- Reduces unwanted vibration
- Reduces operating noise
- Increases equipment life



## 141 SERIES CONTENDER KINGPINLESS POLY SPRING CASTERS

**Tread Width:** 2"  
**Capacity:** Up to 1,500 lbs.

**Wheel Diameters:** 5", 6", 8"  
**Brake:** Field Install Brake (6", 8")  
**Accessories:** Field-Installable Swivel Lock



## S310/S410 SERIES CONTENDER SPRING-LOADED KINGPINLESS CASTERS

**Tread Width:** 3"  
**Capacity:** Up to 3,000 lbs.

**Wheel Diameters:** 6", 8", 10", 12"  
**Brake:** Please consult factory.  
**Accessories:** Field-Installable Swivel Lock



## S610 SERIES CONTENDER SPRING-LOADED KINGPINLESS CASTERS

**Tread Width:** 3"  
**Capacity:** Up to 3,000 lbs.

**Wheel Diameters:** 6", 8", 10", 12"  
**Brake:** Please consult factory.  
**Accessories:** Field-Installable Swivel Lock

# DUAL WHEEL SOLUTIONS // Added Stability & Load Capacity



- Provides higher load ratings with lower overall heights
- Increases product stability for a safer footprint
- Can utilize softer wheels while maintaining higher load ratings



## 115 SERIES KINGPINLESS CASTERS

**Tread Width:** 2"  
**Capacity:** Up to 2,000 lbs.

**Wheel Diameters:** 4", 5", 6", 8"  
**Brake:** Please consult factory.  
**Accessories:** Field-Installable Swivel Lock, Factory-Installed Toe Guard



## 315/415 SERIES KINGPINLESS CASTERS

**Tread Width:** 3"  
**Capacity:** Up to 4,100 lbs.

**Wheel Diameters:** 6", 8", 10", 12"  
**Brake:** Poly Lock  
**Accessories:** Field-Installable Swivel Lock, Factory-Installed Toe Guard



## 615 SERIES KINGPINLESS CASTERS

**Tread Width:** 3", 4", 5"  
**Capacity:** Up to 12,000 lbs.

**Wheel Diameters:** 6", 8", 10", 12"  
**Brake:** Poly Lock  
**Accessories:** Field-Installable Swivel Lock, Factory-Installed Toe Guard

# WHEEL SOLUTIONS



CG-Max (AX) Poly on Aluminum 85A  
**Capacity:** 800–1,500 lbs.



CG-Max (AN) Poly on Aluminum 85A  
**Capacity:** 800–1,500 lbs.



PF: Polyurethane on Heavy Duty 95A  
**Capacity:** 2,000–10,500 lbs.



PM: Round Tread Poly on Aluminum 95A  
**Capacity:** 1,000–1,500 lbs.



PM: Round Tread Poly on Aluminum 80A  
**Capacity:** 1,000–1,500 lbs.



NX: Trionix™ High Impact Polymer 80D  
**Capacity:** 2,160–7,200 lbs.



NV: Trionix™ V-Groove  
**Capacity:** 2,160 lbs.



DT: Heavy Duty Glass-Filled Nylon 75-80D  
**Capacity:** 800–1,600 lbs.



PY: Polyurethane on Iron Core 95A  
**Capacity:** 420–10,800 lbs.



XS: Ultimate Extra Soft Flat Tread 75A  
**Capacity:** 400–675 lbs.

MANY OTHER MARINE INDUSTRY, MANUFACTURING, AND ERGONOMIC SOLUTIONS ARE AVAILABLE.

PLEASE VISIT OUR WEBSITE OR CONSULT OUR ENGINEERING TEAM FOR YOUR CASTER NEEDS.

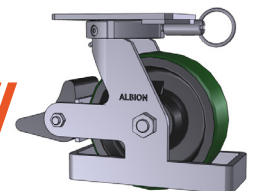

— A BRAND OF —  
**COLSON GROUP** THE GLOBAL LEADER  
IN CASTERS AND WHEELS

800 North Clark Street  
Albion, MI 49224  
Phone: 800-835-8911

**ALBION**®

© Copyright 2021 | Colson Group USA | AlbionCasters.com  
Specifications subject to change without notice.

[www.AlbionCasters.com](http://www.AlbionCasters.com)