

# ARCTICON

## AUTOMATIC BEV<sup>®</sup> FIREPLACE

*Net Zero fireplace with the BEV Technology<sup>®</sup>*

### AUTOMATIC BEV<sup>®</sup> BURNER

The automatic burner with the patented BEV Technology<sup>®</sup> is the most advanced product in the industry ensuring the cleanest burning process without any smoke, smell or ash. The flame is produced by combusting ethanol vapours and has no direct contact with the liquid fuel.

### FLAME CONTROL

Have control over the fire. Choose ECO mode for smaller, ambient flame or increase the height to experience the full beauty of fire.

### REMOTE CONTROL

Take full control over the fireplace with the intuitive and minimalistic remote in your hand.



### GLASS SCREENS

The dedicated toughened glass panel covers and stabilizes the flame. The three-sided fireplace brings a true panoramic fire so you can enjoy the flame from every angle.

### INTEGRATED CONTROL PANEL

The built-in control panel guarantees intuitive and easy control of the fireplace.

### EASY REFILLING SYSTEM

The system automatically supplies the fireplace with the necessary amount of fuel. When the tank is empty, all you have to do is insert a new one.



# Arcticon

(BEV Technology®)

|                         |                         |
|-------------------------|-------------------------|
| Fuel tank capacity      | 5.0 L                   |
| Maximum burn time       | 33 hours                |
| Maximum heat output     | 3.5 kW                  |
| Minimum room cubature   | 35 m <sup>3</sup>       |
| Flame height regulation | 2 stages                |
| Fuel type               | bioethanol 95 - 96,6%   |
| Weight                  | 36.5 kg                 |
| Flue                    | not required            |
| Air change rate         | 1 space volume per hour |
| Power supply            | 230 V                   |
| Finish                  | black paint coating     |
| Materials               | steel, toughened glass  |
| Application             | for indoor use only     |

## CONTROL OPTIONS



included

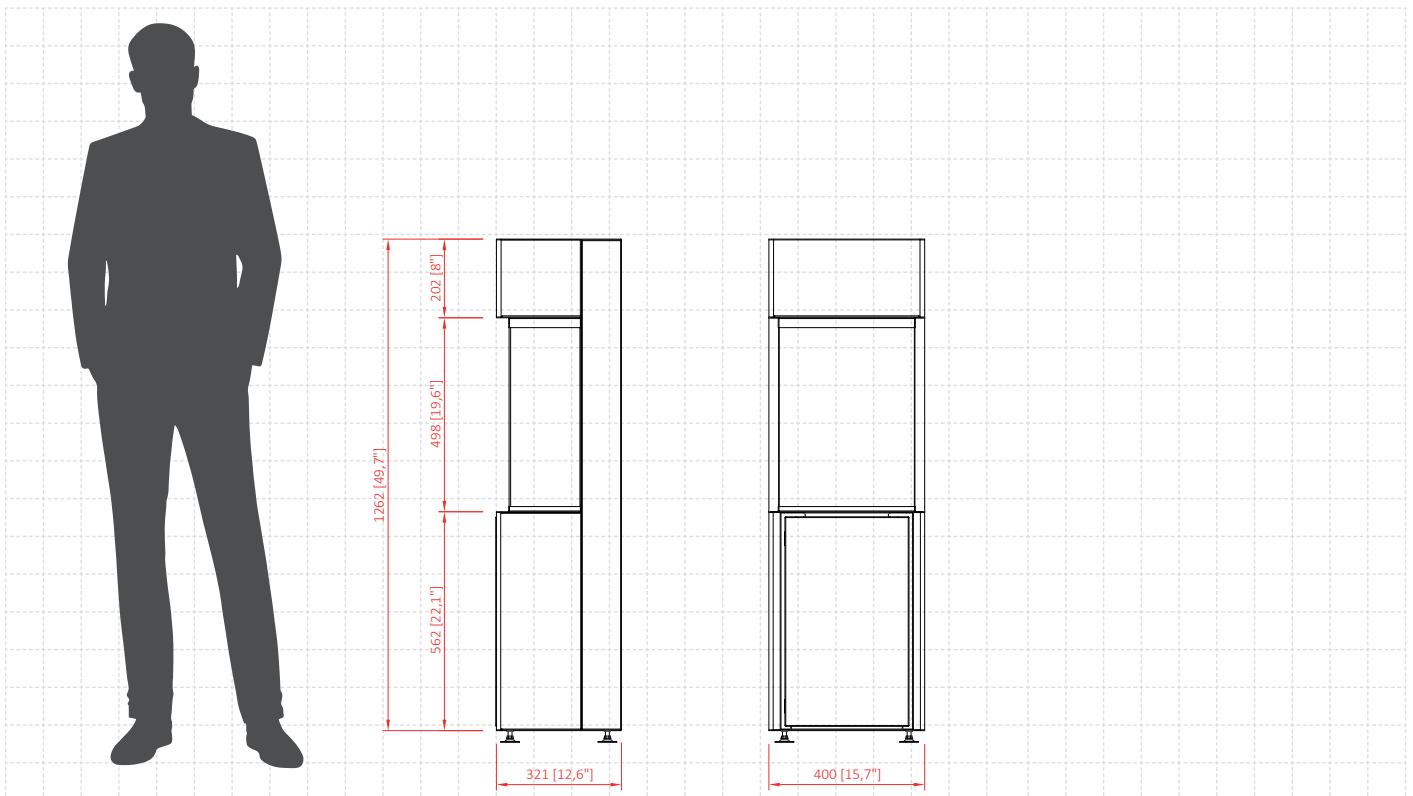

All product specifications and data are subject to change without notice and are believed to be accurate as of the date hereof. Planika Sp. z o.o., its affiliates, agents, and employees, and all persons acting on its or their behalf (collectively, "Planika Sp. z o.o."), disclaim any and all liability for any errors, inaccuracies or incompleteness contained in any document or in any other disclosure relating to any product. To the maximum extent permitted by applicable law, Planika Sp. z o.o. disclaims any and all liability arising out of the application or use of any product. No license, express or implied, by estoppel or otherwise, to any intellectual property rights is granted by this document or by any conduct of Planika Sp. z o.o.. Customers using or selling Planika Sp. z o.o.'s products not expressly indicated for use in such applications do so entirely at their own risk and agree to fully indemnify Planika Sp. z o.o. for any damages arising or resulting from such use or sale. The provided fuel consumption is based on laboratory testing on the lowest flame level. The actual consumption of individual devices may vary. The images are indicative only.