

**Terra 1 Short Articulating**



**MARZ DESIGNS**

info@marzdesigns.com  
+61 (02) 6680 4971

3/1 Boronia Place  
Byron Bay NSW 2481

www.marzdesigns.com



## Terra 1 Short Articulating

The Terra 1 Short Articulating light is available in a choice of three tones – Slate, Sage and Vanilla Bean. Each component is infused with subtle variations inherent in the handmade process, which is then made permanent in the firing.

### Details

Size (mm)	107Ø x 130d
Glass shade	60mm long
Lamp base	C9 push fit
Lamp	220-280V 5W 3000K 370lm LED 100-130V 4.5W 3000K 450lm LED
Voltage	220-280V or 100-130V
Dimmable	Lamp included is compatible with most brand name dimmers
Weight	Under 1kg
IP	IP20 or IP44
Certification	CE UK CA
Note 1	Articulation joint moves in one direction only
Note 2	Flat blade screwdriver required to fix light angle
Note 3	Light fixture can be installed on both walls and ceilings
Note 4	Ceramic pigments are mixed by hand and can vary up to 5% in colour tone and depth

### Finishes



Front view

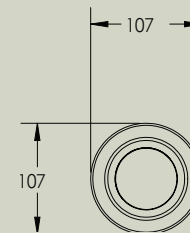

Side view

