

Thank you for choosing SDS ULTRA (Electric Drill).
Please read the instructions manual carefully.

Product description:

The SDS ULTRA is equipped with a 32-bit microprocessor and an OLED high-definition digital display screen . The four LED lights on the head automatically light up during operation.

The SDS ULTRA is designed with simplicity in mind, featuring only two buttons for effortless operation. Whether you are drilling or switching between various work modes, simply press the power button to complete the task at hand. Throughout the drilling process, the OLED screen displays animated visuals depicting the drill's current working status, while also providing a clear indication of the remaining battery power and charging status.

The SDS ULTRA also simplifies the process of changing bits, eliminating the need for additional tools. With just a simple loosening of the chuck, you can effortlessly remove or insert the drill bit, and then tighten the chuck for immediate use.

The SDS ULTRA features a square-shaped handle, optimized to make the best use of the product's internal space. The specially formulated high-capacity LiPo battery has a capacity of 500mAh, providing exceptional performance. With its Type-C charging design, the SDS ULTRA can be fully charged in just 80 minutes, providing up to 3 hours of continuous use. Additionally, the device boasts an impressive standby time of up to 90 days. Moreover, the LiPo battery used in the SDS ULTRA has passed the rigorous US TUV certification process, ensuring its safety and reliability.

The SDS ULTRA is accompanied by an aluminum alloy storage box, providing a convenient and organized storage solution for all accessories. This comprehensive kit includes 10 common sizes of replaceable HSS drill bits found in the market, all of which are CNC precision machined to ensure exceptional quality. With a concentricity of less than 0.03mm, every drilling job performed with the SDS ULTRA is accurate and precise, resulting in clean and neat outcomes.

Operation method:

Power On/Off: Press the "RPM selection button" for 2 seconds to turn it on, Press the "RPM selection button" for 2 seconds to turn it off, If you leave the tool unused, it will automatically shut off after 60 seconds.

Gear Setting: Press the "RPM selection button" for three consecutive times to enter the gear setting interface, and press the "RPM selection button" to set the working gear of the electric drill. After the selection is complete, let go and wait for two seconds, and automatically return to the standby interface after data is saved.

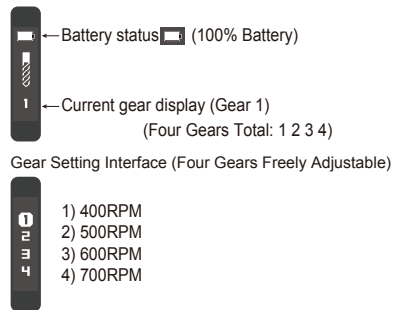

The charging interface

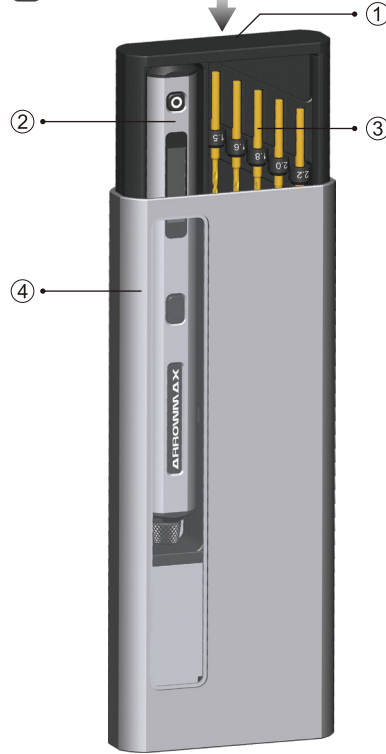
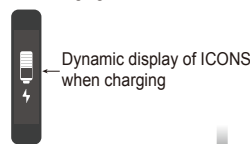

- ① - Inner Box
- ② - SDS ULTRA Mini Electric Drill Pen
- ③ - Drill Bits
- ④ - Storage Box

Storage Instructions:

- ✚ Press the top of the storage box, the inner box of the storage box pops out to open.
- ✚ Press the top of the inner box once more to close the storage box.

SDS ULTRA storage:

- ✚ The SDS ULTRA is fixed to the inner box of the storage box in the form of a buckle.
- ✚ After use, place the SDS ULTRA back into place.
- ✚ Drills are fixed in the inner box.
- ✚ After use, place the bit back into position.

Installation of bits:

- ✚ Take out the bit from the inner box of the storage box. ① Loosen the chuck. ② Place the bit. ③ Tight it up.

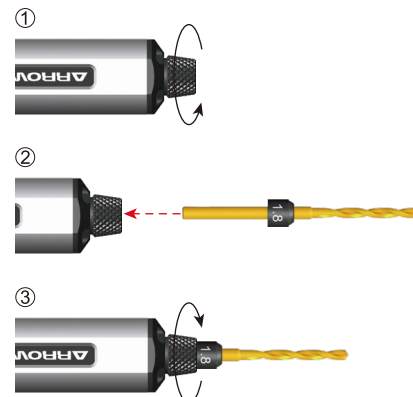

Working Status:

Press the power button, the drill bit turns right, the drill bit symbol on the OLED screen moves down, and the arrow symbol dynamically displays to the right; Press the power button again, the drill bit turns left, and the screw symbol on the OLED screen is displayed move up, while the arrow mark is dynamically displayed to the left; Press again to stop.

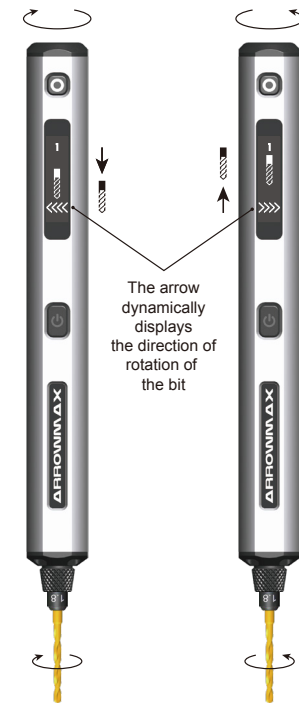

Product parameters:

Product model: SDS ULTRA
Battery voltage: 3.7V
Size: 15 x 15 x 137 mm
LiPo battery: 500 mAh
Weight: 55g
No-load speed: 700r/min
Electric maximum torque: 2.3kgf.cm
Charging time: 80 minutes

Product list:

- (1x) Mini Electric Drill Pen
- (1x) Aluminum alloy storage box
- (1x) Manual
- (1x) Type-C USB cable
- (10x) Drill Bits

Attention

Under drilling work, only right turn (forward direction) is preferred to drill different materials!



Users who purchased **SDS ULTRA PLUS**
Please follow the below steps to install the benchtop drill stand:

①

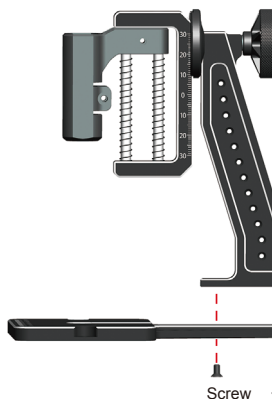

②

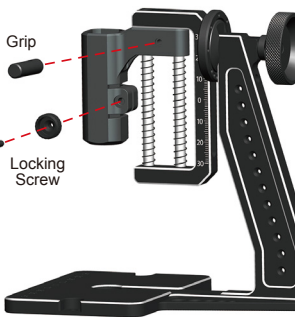

Warranty card:

Warranty regulations

1. The warranty period for this product is 12 months from the date of purchase.
2. Within 7 days of purchase, if a performance fault is found, the product can be returned, replaced, or maintained by contacting customer service.
3. For any questions, please contact your dealer.

The following situations are not covered by the warranty:

1. Product damage caused by improper use, maintenance, or storage.
2. Lack of after-sales vouchers and valid invoices.
3. Damage caused by force majeure.

The company reserves the right to modify the above provisions, without violating relevant national laws and regulations. We have the final right of interpretation.

Maintenance information

User name: _____
Telephone: _____
E-mail: _____
Address: _____
Purchase date: _____
Maintenance reasons: _____

Manufacturer Information

Manufacturer: Freemax Technology Co.,Ltd.
Address: Room 1203, 12/F, Wah Shing Centre, 11-13 Shing Yip Street, Kwun Tong, Hong Kong
T: + 852 3590 9790
E: hello@arrowmax-rc.com
www.am-smart.com



保修卡

保修條例

- 1.本產品自售出之日起, 保修期12個月;
- 2.自產品出售之日起7日內, 如發現產品性能故障, 可以選擇退貨、換貨或者維修;
- 3.如有疑問, 請聯繫購買供貨商。

下列情況不在保修範圍之內

- 1.消費者因使用、維護、保管不當造成損壞的;
- 2.無售後憑證及有效發票的;
- 3.因不可抗拒因素造成損壞的。

本公司保留修改以上規定的權利, 在不違反國家相關法規的情況下, 擁有最終解釋權。

售後信息

用戶名稱: _____

聯繫電話: _____

電子郵件: _____

用戶地址: _____

購買日期: _____

維修原因: _____

製造商信息

製造商: 飛馬仕科技有限公司
 地址: 香港九龍觀塘成業街11-13號
 華成工商中心12樓1203室
 電話: +852 3590 9790
 郵箱: hello@arrowmax-rc.com



SDS ULTRA

智能電鑽

說明書

ARROWMAX

SDS ULTRA 電鑽結構圖

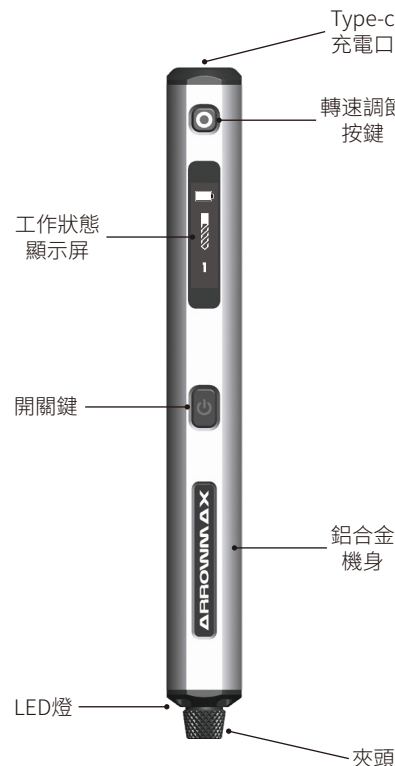

感謝您使用本公司的智能電鑽。為了讓您更好的體驗產品, 請仔細閱讀說明書。

產品描述

SDS ULTRA 配備了32位微計算芯片和OLED高清數字動態顯示屏, 頭部的四顆LED燈, 在工作的時候會自動亮起。

SDS ULTRA 的設計以簡潔易用為目標, 僅配備兩個按鈕, 方便輕鬆操作。無論您是在鑽孔還是在不同工作模式之間切換, 只需按下電源按鈕即可完成手頭的任務。在整個鑽孔過程中, OLED屏幕會顯示動畫視覺效果, 顯示鑽頭的當前工作狀態, 同時清晰顯示剩餘電池電量和充電狀態。

SDS ULTRA 在更換鑽頭時的操作也相當簡單, 不需要使用其它工具, 只要旋開夾頭即可輕鬆取出、置入鑽頭, 接著旋緊夾頭即可立即操作。

SDS ULTRA 手柄採用了方形帶圓弧面的形狀, 使得工作期間更好控制電鑽, 握感更舒適。特殊配製的高容量鋰電池, 更有效地利用了產品的內部空間, 鋰電池容量達到500mAh, 使得SDS ULTRA的工作時間比其他產品更長。採用Type-C型充電設計, 只要充電80分鐘即可使用3小時, 不用因電線影響發揮。待機更可長達90天, 所用鋰電池更通過了美國TUV認證。

SDS ULTRA附帶一個鋁合金儲物盒, 為所有配件提供便捷有序的存儲解決方案。該全面套裝包括市場上常見的10種尺寸的可更換HSS鑽頭, 所有鑽頭均經CNC精密加工, 確保卓越品質。憑藉小於0.03mm的同心率, 使用SDS ULTRA進行的每個鑽孔任務都準確無誤, 產生整潔的結果。

操作方法

電源開/關: 按下轉速調節按鍵2秒鐘啓動, 再按下轉速調節按鍵2秒鐘關閉。如果您不使用該工具, 它將在60秒後自動關閉。

檔位設置: 連續按三次轉速調節按鍵, 進入檔位設置界面, 單按轉速調節按鍵選擇電鑽的工作檔位, 選擇完成後, 鬆手等待兩秒, 數據保存後自動返回待機界面。

待機界面:

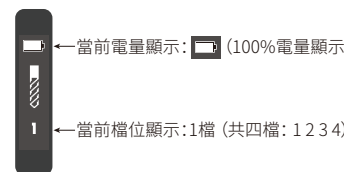

檔位設置界面: (四檔自由調節)

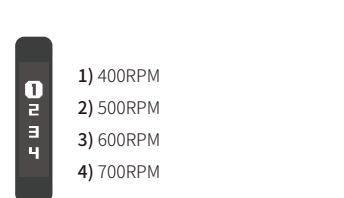

充電界面:

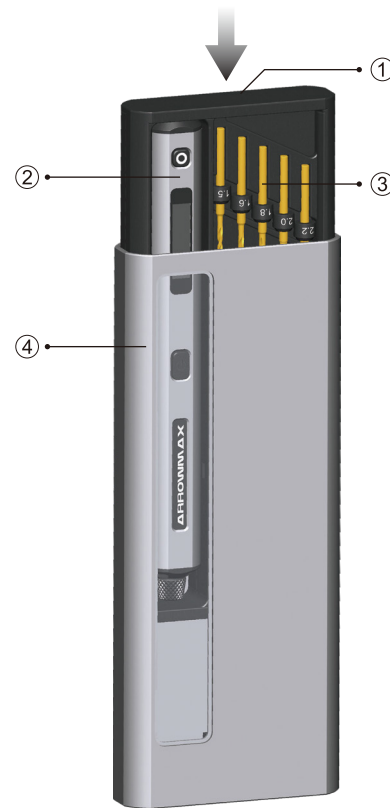

- ① - 收納盒內盒
- ② - 電鑽
- ③ - 鑽頭
- ④ - 收納盒外殼

收納盒開合

按壓收納盒頂部, 收納盒內盒彈出開啓。再次按壓收納盒內盒頂部, 收納盒閉合。
 注意: 按壓收納盒內盒後, 內盒彈出, 此時內盒易滑落。

電鑽收納

電鑽以卡扣形式固定於收納盒內盒。使用完畢後, 將電鑽按壓歸位。

鑽頭收納

鑽頭以卡扣形式固定於內盒中。使用完畢後, 將鑽頭按壓歸位。

鑽頭安裝

從收納盒內盒中取出鑽頭, ①向右邊旋開夾頭, ②置入鑽頭, ③接着向左邊旋緊夾頭即可立即操作。

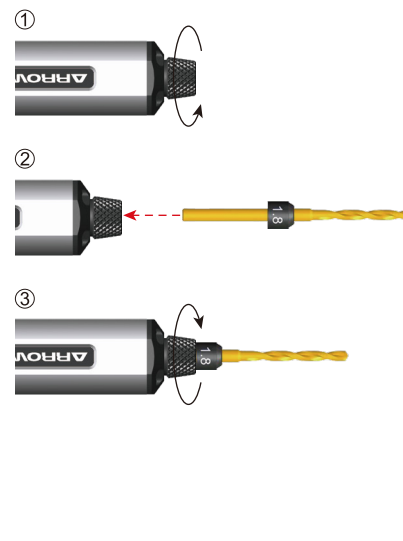

工作狀態

- 按開關鍵, 鑽頭右轉, OLED屏的鑽頭標誌圖往下移動, 同時箭頭標誌動態顯示向右;
- 再按開關鍵, 鑽頭左轉, OLED屏的鑽頭標誌圖往上移動, 同時箭頭標誌動態顯示向左;
- 再按開關鍵停止。



產品參數

產品型號: SDS ULTRA	電池電壓: 3.7V
尺寸: 15x15x137mm	鋰電池: 500mAh
重量: 55g	空載轉速: 700r/min
電動最大扭矩: 2.3kgf.cm	充電時長: 80分鐘

產品清單

- 電鑽x1
- 鋁合金收納盒x1
- 說明書x1
- Type-C數據線 x1
- 鑽頭x10

▲注意

工作狀態下, 只能以右轉(即正轉)鑽動物件!

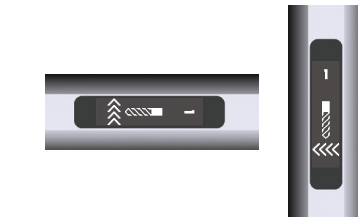

購買 SDS ULTRA PLUS 的用戶

請按以下步驟安裝臺式鑽架:

①

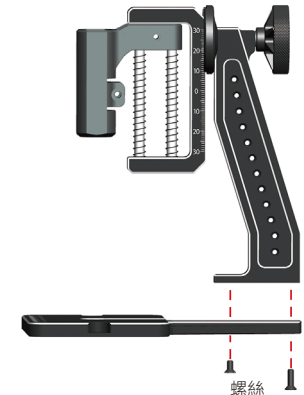

②

