

Ecowell™
LULU™
QUICK CLEAN

**WET/DRY
VACUUM
& WASH**

SKU#: P05
Model#: SC91



USER MANUAL

Read and understand this instruction manual thoroughly before using the product. It contains important information for your safety as well as operating and maintenance advice.



CONTENTS

Safety Instructions	2
Product View	4
Assembly & Disassembly	7
Filling the Clean Water Tank	7
Cleaning Your Floors	9
Emptying the Dirty Water Tank	10
Cleaning Filter	12
Cleaning Roller & Cover	13
Warning & Notice & Storage	14
Specifications	15
Disposing of the Batteries	15
Troubleshooting	16
Warranty	17

IMPORTANT SAFETY INSTRUCTIONS

When using an electrical appliance, basic precautions should be observed, including the following:

WARNING

TO REDUCE THE RISK OF FIRE, ELECTRIC SHOCK, OR INJURY:

- Use indoors only.
- Do not allow it to be used as a toy. Close attention is necessary when used by or near children.
- Do not use for any purpose other than described in this user guide. Use only the manufacturer's recommended attachments.
- Do not charge with a damaged cord or plug.
- Do not unplug by pulling on the docking station cord. To unplug, grasp the charger, not the cord.
- Do not handle docking station, charging plug, or appliance with wet hands
- Do not put any object into openings. Do not use with any opening blocked; keep openings free of dust, lint, hair, and anything that may reduce airflow.
- Keep hair, loose clothing, fingers, and all parts of body away from openings and moving parts of the appliance and its accessories.
- Use extra care when cleaning on stairs.
- Do not use to pick up flammable or combustible materials (lighter fluid, gasoline, kerosene, etc.) or use in areas where they may be present.
- Do not use the appliance in an enclosed space filled with vapors given off by oil-based paint, paint thinner, some moth-proofing substances, flammable dust, or other explosive or toxic vapors.
- Do not use to pick up toxic material (chlorine bleach, ammonia, drain cleaner, etc.).
- Do not pick up anything that is burning or smoking, such as cigarettes, matches, or hot ashes.
- Do not pick up hard or sharp objects such as glass, nails, screws, coins, etc.
- Do not carry the appliance while in use.
- Do not immerse. Use only on surfaces moistened by the cleaning process.
- Plastic film can be dangerous. To avoid the danger of suffocation, keep away from babies and children.
- Always connect to a proper electrical socket.
- Keep the cord away from heated surfaces.
- Do not use without filters in place.
- Do not charge the unit outdoors.
- Do not incinerate the appliance even if it is severely damaged. The batteries can explode in a fire.
- Recharge appliance only with the charger specified by the manufacturer. A adapter suitable for one type of battery pack may create a risk of injury and fire when used with another battery pack.
- Turn off all controls before unplugging.
- This appliance has a polarized plug (one blade is wider than the other). To reduce the risk of electric shock, this plug is intended to fit in a polarized outlet only one way. If the plug does not fit fully in the outlet, reverse the plug. If it still does not fit, contact a qualified electrician. Do not modify the plug in any way.

- When the battery pack is not in use, keep it away from other metal objects, like paper clips, coins, keys, nails, screws, or other small metal objects, that can make a connection from one terminal to another. Shorting the battery terminals together may cause burns or a fire.
- Do not immerse in water or liquid.
- Do not use a battery pack or appliance that is damaged or modified. Damaged or modified batteries may exhibit unpredictable behavior resulting in fire, explosion, or risk of injury.
- Do not expose a battery pack or appliance to fire or excessive temperature. Exposure to fire or temperature above 130 C / 265°F may cause an explosion.
- Follow all charging instructions and do not charge the battery pack or appliance outside of the temperature range 4-40 C / 40-104°F. Charging improperly or at temperatures outside this range may damage the battery and increase the risk of fire.
- Prevent unintentional starting. Ensure the switch is in the OFF position before connecting to battery pack, picking up, or carrying the appliance. Carrying the appliance with your finger on the switch or energizing an appliance that has the switch on invites accidents.
- Under abusive conditions, liquid may be ejected from the battery; avoid contact. If contact accidentally occurs, flush with water. If liquid contacts eyes, additionally seek medical help. Liquid ejected from the battery may cause irritation or burns.
- If the appliance is not working as it should, has been dropped, damaged, left outdoors, or dropped into water, return it to a service center.
- Have servicing performed by a qualified repair person using only identical replacement parts. This will ensure that the safety of the product is maintained.
- Do not turn ON your appliance until you are familiar with all instructions and operating procedures.
- Risk of injury from moving parts. The brush may start unexpectedly. Turn OFF before cleaning or servicing.
- Unplug the charger from the electrical socket when not in use, before cleaning, maintaining or servicing the appliance.
- Liquid must not be directed towards equipment containing electrical components.
- Use only on surface moistened by the cleaning process.
- Battery pack and charger base output terminals are not to be short-circuited.

* Notice: Use only floor cleaning formula intended for use with this appliance to prevent internal component damage.

Floor cleaning formula is prepared by users. See the Cleaning Formulas section of this guide. Use only the type and volume of liquids specified under the operations section of this guide.

SAVE THESE INSTRUCTIONS

PRODUCT VIEW

A.ECO/MAX

B.Large/Small Volume of Water

C.On/Off

D.Aluminum Alloy Handle

E.Digital Display

F.Body

G.Clean Water Tank (CWT)

H.Clean Water Tank Release

I. Dirty Water Tank (DWT)

J. Dirty Water Tank Release

K. Roller Cover

L. Charging Position

(Connect with Docking Station)

M. Roller

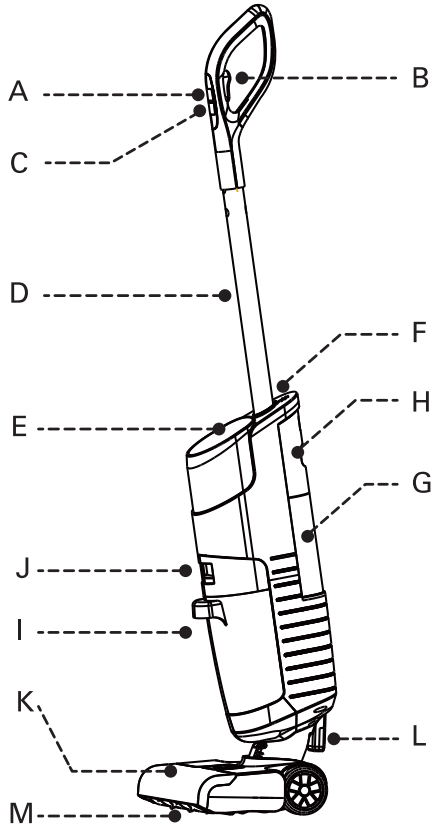

WHAT'S IN THE BOX

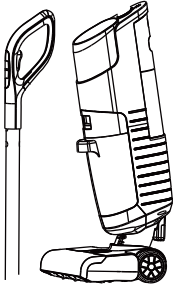

Handle & Body x 1

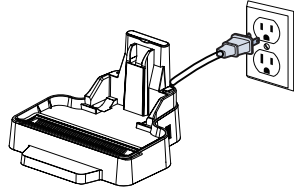

Docking Station with adapter x1

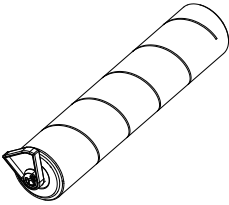

Roller x2

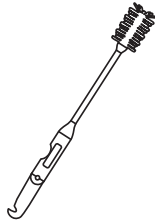

Cleaning Tool x 1

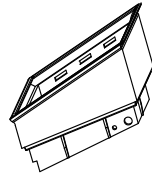

Filter x 2

DIGITAL DISPLAY

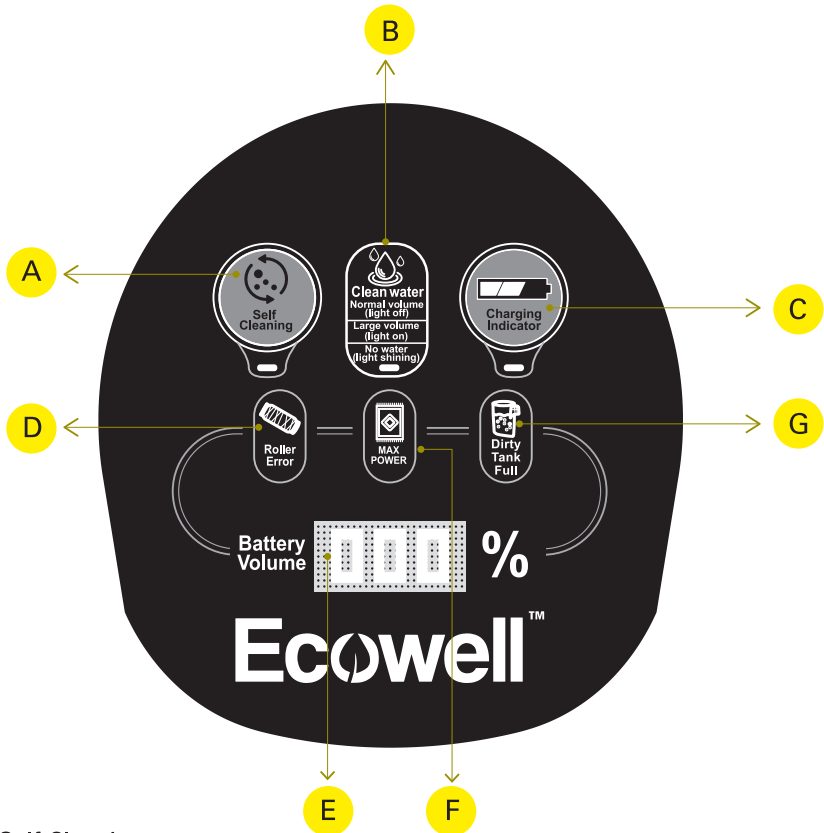

- A. Self-Cleaning
- B. Clean Water Status
- C. Charging Indicator
- D. Roller Error
- E. Battery Level Indicator
(e.g. 055 means 55% battery power)
- F. MAX Power
- G. Dirty WaterTank Full

*A. Care the buttons that can be pressed.

B.D.F. and G. prompt you only when a reminder appears.

ASSEMBLY & DISASSEMBLY

ASSEMBLY

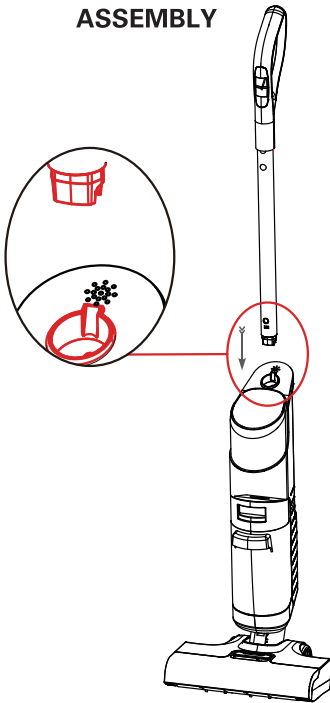

Insert handle into body of machine until you hear a “click”.

DISASSEMBLY

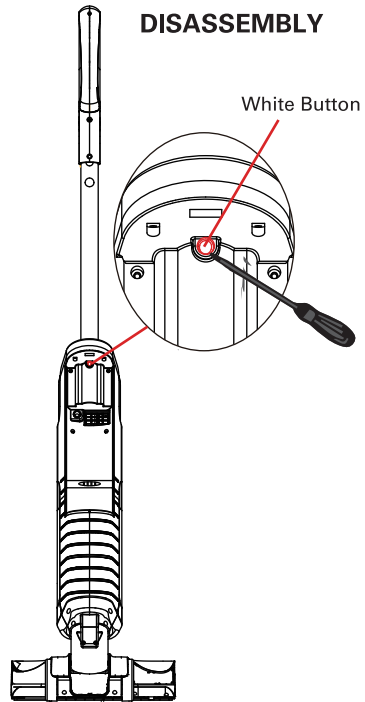

Press the white button on the back of the machine and pull the handle up at the same time.

FILLING THE CLEAN WATER TANK

①

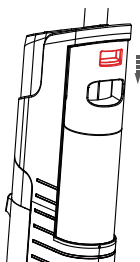

Clean Water Tank Release

The clean water tank is located on the back of the machine. To remove, use the finger groove at the top of the tank to grab and pivot the tank backwards.

②

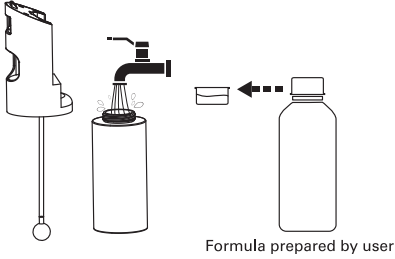

Unscrew the cap from the clean water tank. Use warm tap water (140°F/60 C max) and add floor cleaning formula. Also, can use the normal temperature clean water for floor cleaning. Formula use on: hardwood, laminate floor, short-haired carpet.

③

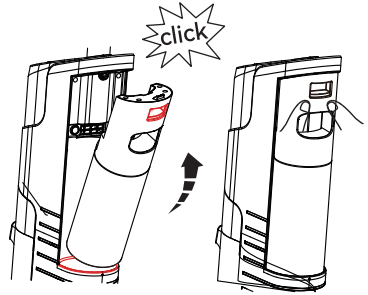

Align the bottom of the clean water tank with the grooves and push the tank until it "clicks" into place.

④

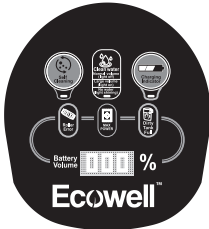

Check the battery level on the panel, charging fully before use each time.

⑤

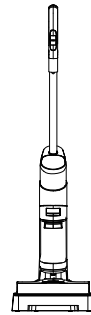

Place your machine onto the docking station to charge.

⑥

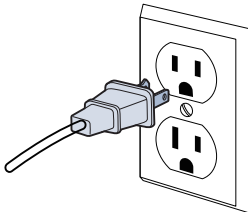

Plug the machine into a suitable wall outlet. For maximum run time, charge the machine for 4.5 hours.

CLEANING YOUR FLOORS

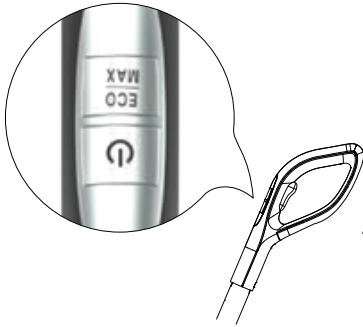

Press on the On/Off button and switch the ECO/MAX of the vacuum power for different types of floor. Comfy angle for use.

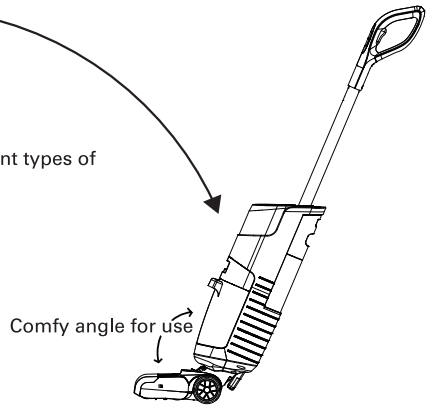

Recline the machine to start the roller spinning. Stand the machine upright to power off the roller spinning.

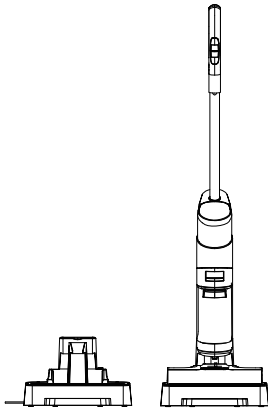

Check the battery level on the panel, charging full before use each time.

Note: Do not use high-temperature or strongly corrosive liquids. Do not sharply angle the machine, it will damage the machine itself and the washing effect will be affected.

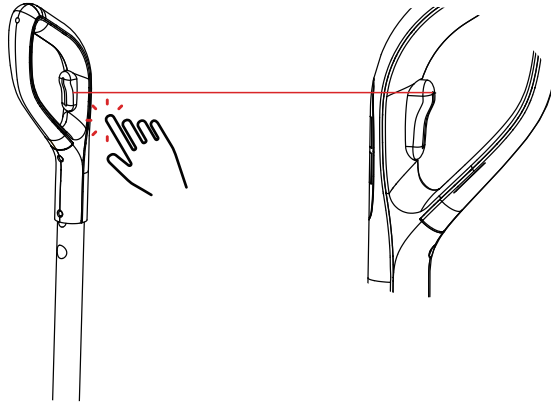

Press on the button inside the handle once to produce a large water volume, and press it again to return to the default water volume.

Notice: The button can only be used if the wet function is on.

EMPTYING THE DIRTY WATER TANK

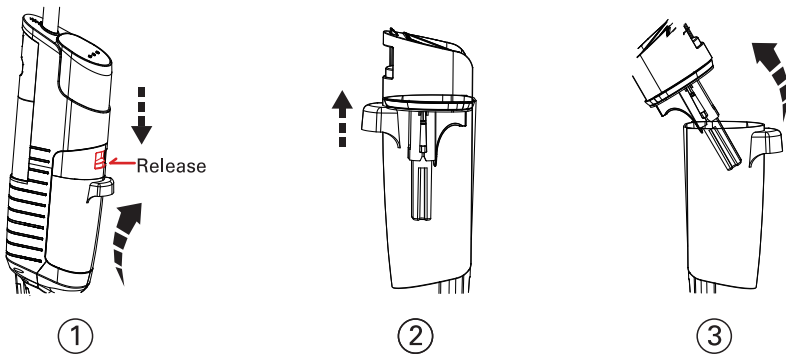

To remove the dirty water tank, press the release on top of the tank, grab the front handle and pull the tank cover out. (①②③)

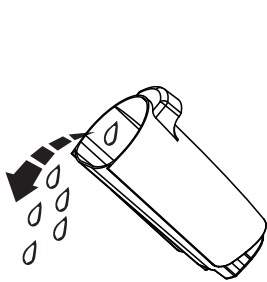

④

Pour the dirty water into the sink, and throw the debris into the trash. Remove the filter from the top of the dirty water tank by pulling it up.(④⑤)

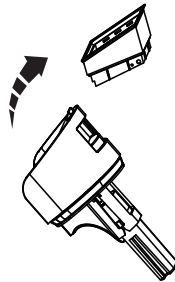

⑤

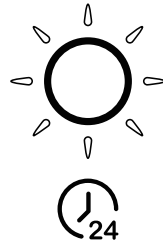

⑥

Hand wash the filter and screen with water and mild detergent. Rinse the bottom of the dirty water tank cover. Leave the parts out to dry completely before reassembling.(⑥)

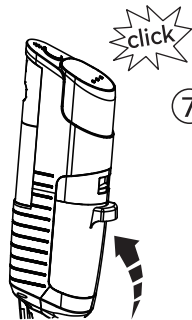

⑦

Angle the dirty water tank back into the body of the machine. Insert the bottom of the tank first, then pivot the top toward the machine until it "clicks" into place.(⑦)

Remove Roller Cover

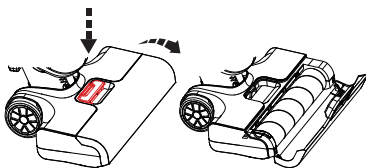

Press the slot of roller cover out and pull the cover up.

Remove Roller

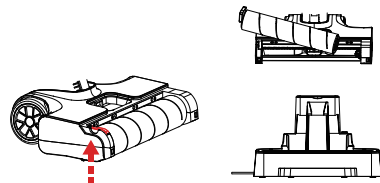

Pulling up on the roller tab to remove. Put the roller in the drying tray. The roller and cover can be hand washed.

Roller Assembly

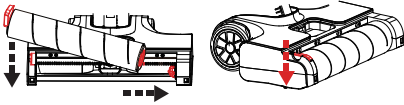

Once the roller is dry, place the end of the roller into the right side of the foot of the machine. Press the tab of the Roller down to lock into place.

Roller Cover Assembly

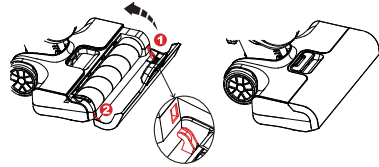

Replace the roller cover by lining up the cover tabs with the edges of the foot. Then, press the cover back into place until you hear a "click".

CLEANING FILTER

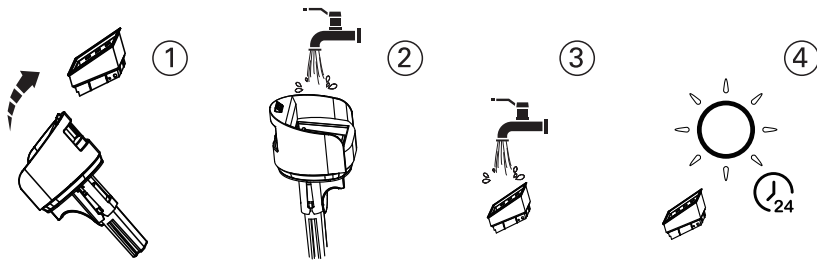

Pull the filter out on the top of the dirty water tank, clean it with water, dry it completely, and reinstall it into the dirty water tank.

CLEANING ROLLER COVER

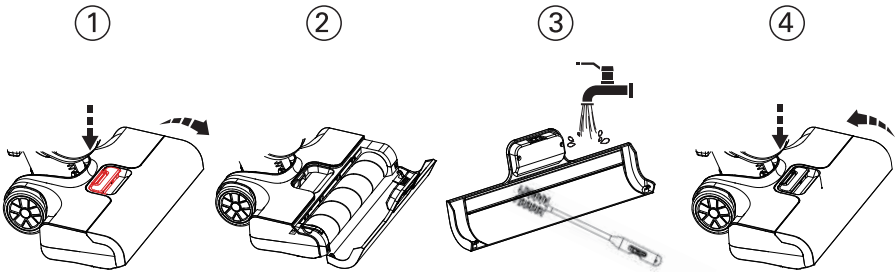

Press the cover tab and pull it up. Wash with water and brush tool if needed. Reinstall it after it is clean and dry.

SELF-CLEANING & SELF-DRYER

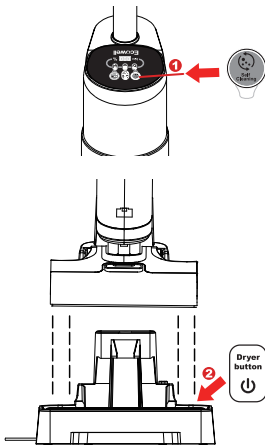

- ▶ Please empty the dirty water tank before starting self-cleaning.
- ▶ Press (1) self-cleaning and (2) self-drying buttons to clean and dry the roller, the cover, and the tunnel automatically.
- ▶ The self-drying process starts automatically after the self-cleaning process.
- ▶ The drying system will operate for 34 minutes to dry the roller and the tunnel.
- ▶ To manually dry the roller, cover, please check the manual instruction (Page 12,13).

* The drying system is at the charging base. Remember to press the self-drying on the charging base while starting self-cleaning.

* Please do not wash the base in the water.

* There will be a slight wind sound when the drying system is running, which is normal. Please feel free to use.

WARNING & NOTICE & STORAGE

WARNING

To reduce the risk of fire, electric shock or injury, turn power OFF and disconnect plug from electrical outlet before performing maintenance or troubleshooting on the dock.

NOTICE & STORAGE

- Empty dirty water after each use.
- Do not vacuum foamed liquid.
- Do not soak or rinse.
- To reduce the risk of a leaking condition, do not store machine where freezing may occur. Damage to internal components may result.
- Store machine in a protected, dry area. Since this product uses water, it must not be stored where there is danger of freezing. Freezing will damage internal components and may void the warranty.

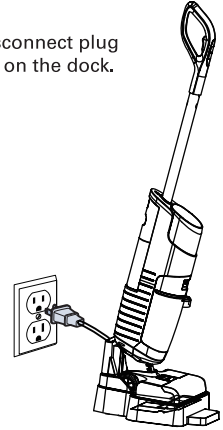

INDICATOR INFORMATION

Working	Working	Start by pressing  . Press MAX/ECO to switch power.
		Press the trigger inside of the handle to switch the small or large amount of water between different floors or short-haired carpets.
		Stop by standing it up vertically.
	Dirty Water Tank Full	The icon will flash if dirty water tank is full. It will close automatically after 10 seconds if no action is taken.
	Brush Roll Tangled	The icon will flash if brush roll tangled (hairs, debris etc.)
	Low on Water (Clean Water Tank)	The icon will flash when water level in the clean water tank is low.
Place into the Docking Station	Charging	The battery level number will stay on when charging, and display the percentage of battery power. For example, 037 means 37% battery.
	Self-Cleaning	Press the self-cleaning button; self-cleaning will start, automatically and stop after 4 minutes.

SPECIFICATIONS

Product	WET/DRY VACUUM WASH
Model	SC91
Operating Voltage(V)	22.2V
Rated Power(w)	220W
Battery Capacity(mAh)	4400 mAh
Charging station Input	120V 60Hz
Charging station Output	27V - 1300mA
Clean Water Tank Capacity(oz)	22 oz
Charging per time(H)	≈4.5H
Max Work Time(min)	≤ 32 mins
Weight(lbs)	≈10.03 lbs

DISPOSING OF THE BATTERIES

- The battery contains materials that are harmful to the environment and must be removed from the appliance before it is discarded.
- When removing the battery, the appliance must be powered off. -Batteries, chargers, accessories and packaging should be sorted for environmentally friendly recycling.
- Do not put them into fire, water or soil. Do not dispose of batteries and chargers in household waste.
- If battery leakage contacts skin or clothing, immediately flush with water to avoid irritation and seek medical help.

TROUBLESHOOTING

Problem	Possible cause	Solution
Not working	Low on battery power	Clean the brush roll
	Dirty water tank is full	Charging before use (100% battery is recommend)
	Debris blocking at the intake	Take out the tank and pour out the water
Lower suction	Filter is dirty	Clean the debris by the tube or intake up
	Debris or tangled hair	Clean the filter
Strange sound from motor	Hairs or debris tangled on the brush roll	Clean the debris by the tube or intake
	Dirty water tank is full	Pour the dirty water and trash out
No water coming out	Clean water tank is empty	Add water into clean water tank
	Clean water tank and assemble well	Reinstall clean water tank
Water leaking	Filter not installed	Install filter
	Filter not dried completely	Clean it up and dry it completely
Can not charge	Adapter is not plugged in well	Check and plug the adapter into a suitable wall outlet
	Charging base not connected with adapter well	Check and reconnect
Dirty water tank full indicator flashing	The dirty water in tank has reached the MAX line	Empty the dirty water and then reinstall the tank
Clean water tank empty indicator flashing	Clean water tank is empty	Refill clean water tank
Brush roll tangled indicator flashing	The brush roll is blocked or not nstalled	Remove blockages and install brush roll correctly
Motor malfunction	Contact customer service	

Warranty

2-YEAR LIMITED WARRANTY

- Only applies to purchases made from authorized retailers of Ecowell.
- Subject to adherence to the requirements outlined in this instruction manual and to further conditions outlined below.

WHAT IS COVERED?

- Our Ecowell appliance has a 2-years warranty against original defects in material and Ecowell workmanship when used for private household purposes in accordance with the Instruction Manual.
 - Motorized accessories and battery both come with a 2-year warranty as well.
 - This warranty provides, at no extra cost to you, all labor and parts necessary to ensure your appliance is in proper operating condition during the warranty period.
- This warranty will only be valid if the appliance is used in the country in which it was sold.

WHAT IS NOT COVERED?

Ecowell shall not be liable for costs, damages or repairs incurred as a result of:

- Appliances purchased from an unauthorized dealer.
- Careless operation or handling, misuse, abuse, and/or lack of maintenance or use not recommended by the Ecowell Instruction Manual.
- Use of the appliance other than for normal domestic purposes (e.g. for commercial or rental purposes).
- Use of parts and accessories other than those produced or recommended by Ecowell
- External factors are unrelated to product quality and use, such as weather, modifications, accidents, electrical outages, power surges, or acts of God.
- Repairs or alterations carried out by unauthorized parties or agents. Failing to clear blockage and other hazardous material from the appliance.
- Normal wear and tear, including normal wearing out of parts, such as clear bin, belt, filter, brush bar, and power cord (or where external damage or abuse is diagnosed), carpet or floor damage due to not following manufacturer's instructions or failure to turn the brush bar off when necessary.
- Reduction in battery discharge time due to battery age or use.

WARRANTY LIMITATIONS

- Any implied warranties relating to your appliance, including but not limited to the warranty of merchant ability or warranty of fitness for a particular purpose, are limited to the duration of this warranty.
- Warranty coverage applies to the original owner and to the original battery only and is not transferable. This limited warranty gives you specific legal rights. You may also have other rights which vary by region.
- Manufacturer's warranties may not apply in all cases, depending on factors such as the use of the product, where the product was purchased, or who you purchased the product from.

 **WARNING**

TO REDUCE THE RISK
OF INJURY, USER MUST READ
INSTRUCTION MANUAL BEFORE
OPERATING PRODUCT.

PLEASE DO NOT RETURN
TO STORE.
ALTON IS HERE TO HELP.

Helpline:
1-888-899-0146

Alton Industry Ltd. Group

Manufactured by: Alton Industry Ltd. Group
643 Innovation Dr., West Chicago, IL 60185

For more information, please visit

www.ecowell.com

MADE IN CHINA

