



AHOPEGARDEN

12 PODS INTELLIGENT PLANTER

Z235



Note: If there is any technical improvement in the product, we will make a new version of the manual without notice. The product appearance and color may vary according to different version, please refer to the actual product received.

www.ahopegarden.com

Tel: +1(855) 705-0808

E-mail: support@ahopegarden.com



Made in China



USER MANUAL

Please read, understand and follow this user manual before use, then keep it for future reference.





- It is recommended to grow seasonal plants. Seeds of non-seasonal plants may not sprout in the environment warmer than 25°C / 77°F.
- It is recommended to keep plants 10cm away from light tubes, so that the plants won't be scorched and can grow better.
- Plants like fresh water. After you added water for 3 times, salt will accumulate in the water tank, which may cause root rotting, you need to empty the water out of the tank and refill with fresh water and then add nutrients.

If you have any questions, please contact us: <https://ahopegarden.com>

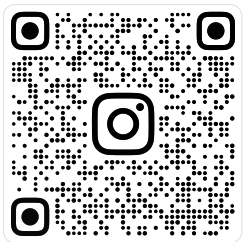

ahopegarden



852-53086213



ahopegarden

CONTENTS

IMPORTANT SAFETY INSTRUCTIONS	01
WHAT'S INCLUDED	02
KNOW YOUR INTELLIGENT PLANTER	03
HOW TO INSTALL	04
HOW TO PLANT	05
1. Prepare the Seed Pods	05
2. Add Water	06
3. Add Grow Domes	07
4. Connect to Power	07
5. Add Nutrients After Seeds Germination	08
FUNCTION OVERVIEW	10
Key Function	10
Lighting Function	11
SPECIFICATION	11
PLANTING TIPS	12
Germination	12
Planting	12
Pruning	12
Harvesting	12
Plant Herbs	13
Plant Salads	13
Plant Tomatoes & Peppers	13
Plant Flowers	13
FAQs	14
PLANTING NOTES	16

IMPORTANT SAFETY INSTRUCTIONS

- This device is not intended for use by persons(including children) with reduced physical, sensory or mental capabilities, unless they have been given supervision or instructions concerning use of the device by a person responsible for their safety.
- Children should be supervised to ensure they do not play with the device.
- To reduce the risk of electric shock, only use the power adapter we provided.
- Never use the planter if any parts get damaged, especially the cord or plug.
- If the planter is broken, please do not touch any inner part to avoid electric shock.
- Keep the electrical cord away from any heated surfaces.
- Do not allow water to contact hot LED grow lights.
- Do not pull the cord when unplugging the adapter. Do not plug or unplug carelessly.
- Do not attempt to repair the device yourself. If the device is malfunctioning, please contact us directly.
- Do not use the device outdoors.

NOTE:



We have no liability or responsibility for fires or electric shocks caused by improper operation or not adhering to above safety instructions.

WHAT'S INCLUDED

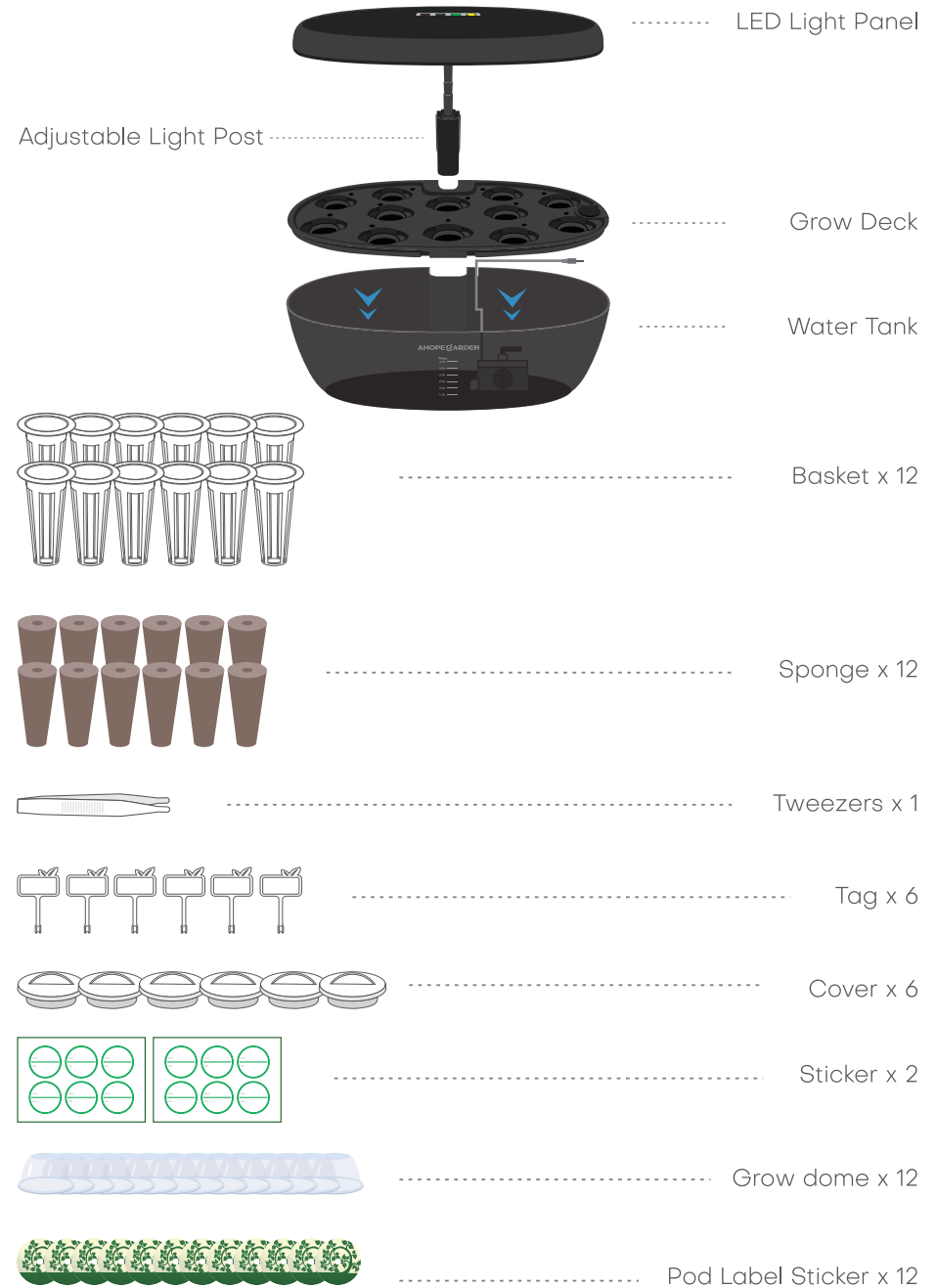

BOX 1

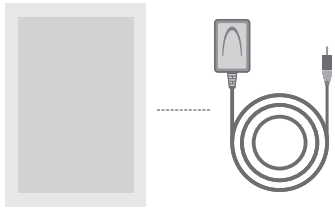

Power adapter x 1

BOX 2

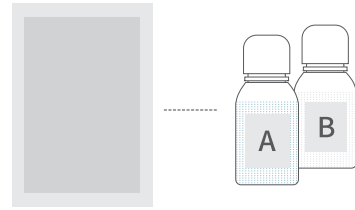

Fertilizer A&B x 1

KNOW YOUR INTELLIGENT PLANTER

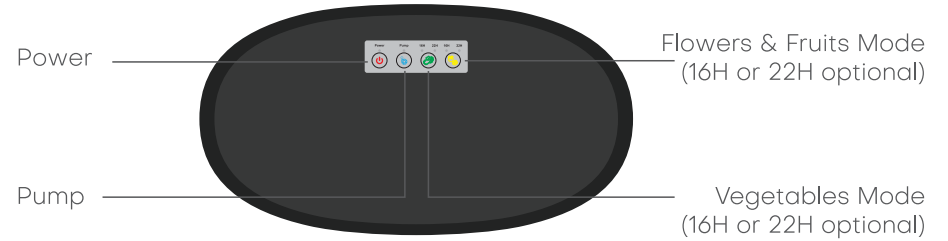

HOW TO INSTALL

Step 1
Remove the package and protective foam.



Step 2
Press the bottom of light post and lengthen the light post to a certain height. Take out all accessories from water tank.

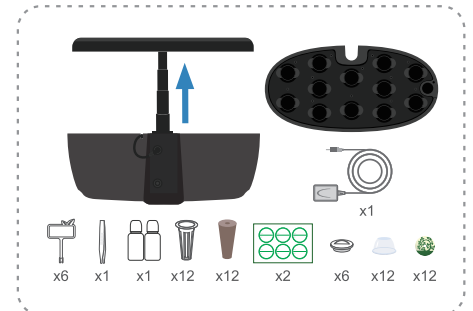

Step 3
Place the grow deck on water tank and make sure they are aligned properly.



HOW TO PLANT

1. Prepare the Seed Pods

IMPORTANT

The growth of plant is affected by temperature, light and humidity, please plant what is suitable for local season to get the best growing result.

Step 1

If you are going to grow large seeds, such as lettuce, basil, tomato, please soak seeds in water for 6-12 hours before planting.

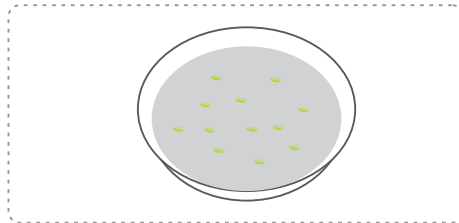

Step 2

Soak the sponges in water till they absorb water thoroughly.

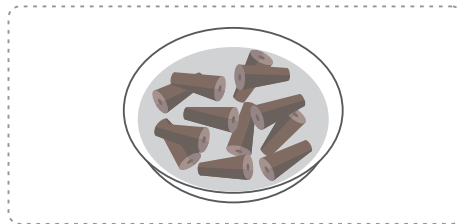

Step 3

Put soaked sponge into the basket.

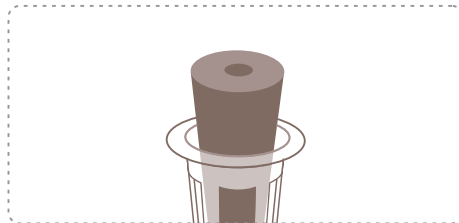

Step 4

Gently place 2 or 3 seeds into the soaked sponge with tweezers. Place the pod label.

Note:

Pod label helps to prevent the sponge from developing mold/algae.

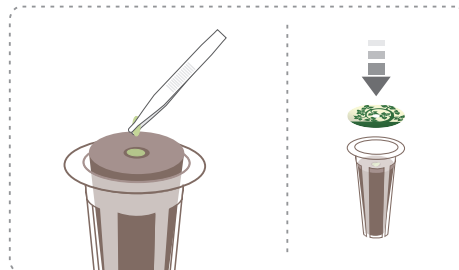

Step 5

Insert the seed pod into planting opening on the grow deck.

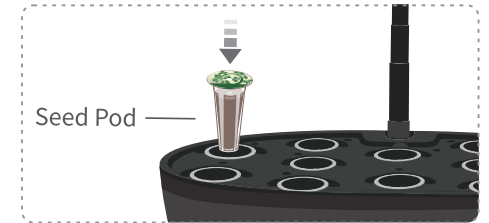

If you are going to grow small seeds, such as mint, petunia, dianthus, you can directly place seeds into soaked sponges with tweezers and drip a small quantity of water on seeds to keep them moist.

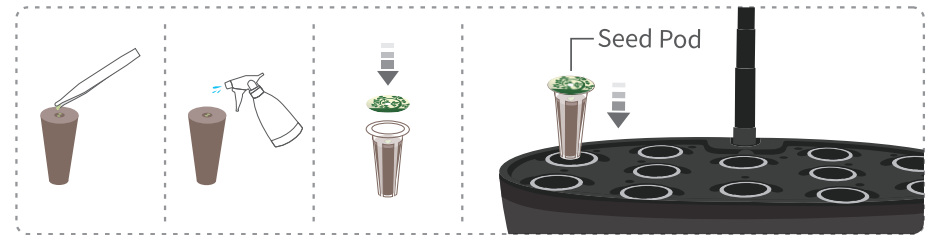

2. Add Water

Remove the water inlet cover and add 4L water into the water tank through water inlet.

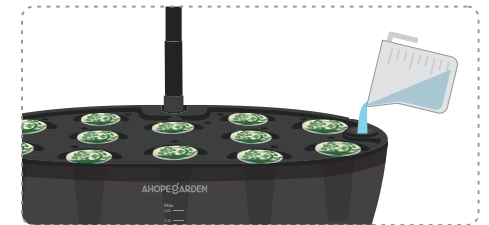

Note:

* To prevent mosquito breeding or water evaporation, it is recommended to seal the water inlet and empty planting openings with covers.



3. Add Grow Domes

Place one grow dome over each seed pod.



Note

- 1 The grow domes can create a warm and humid environment for seeds to root and help prevent pests invasion.
- 2 Please remove the grow domes in time after seeds germination

4. Connect to Power

Step 1

Connect the power adapter to power input and power supply.

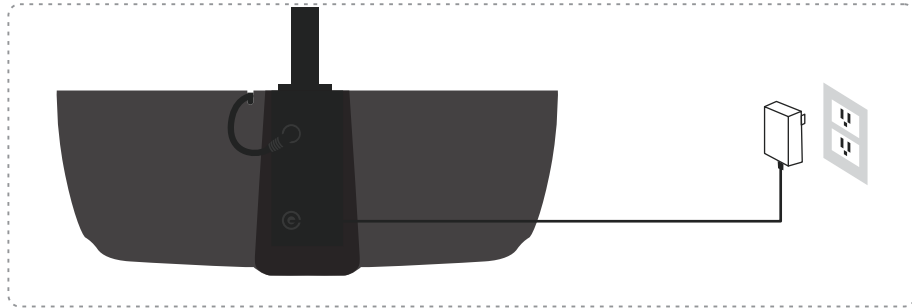

Step 2

Press power button to turn on the product, the planter will enter vegetables mode by default; meanwhile, the grow light will be on and water pump will start working.

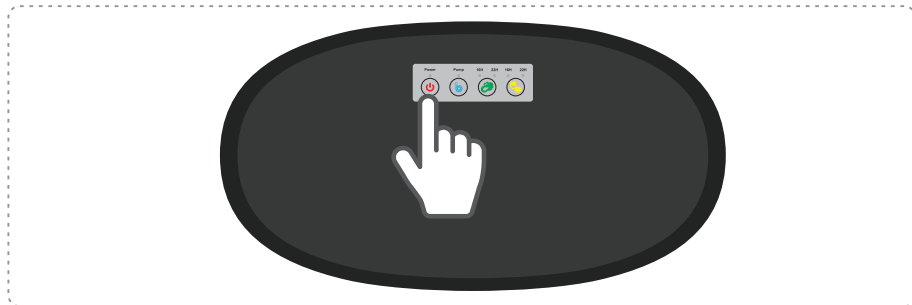

Notes:

- * The LED indicator of power will turn green while the LED indicators of water pump and vegetables mode will turn blue.
- * You may turn on the LED grow light before seeds germination; however, it is also a must to keep the LED grow light on after seeds germination and select the right growing mode.

5. Add Nutrients After Seeds Germination

Step 1

After seeds germination, remove the grow dome in time.



Step 2

Fill each bottle of fertilizer A and B with 100ml purified water, then shake the bottles until they are mixed well.

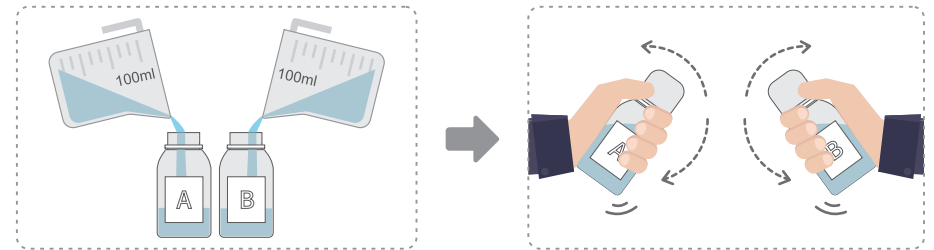

Step 3

Please refer to the scales on the bottles or caps to add 20ml nutrient A and 20ml nutrient B into water tank through the water inlet.

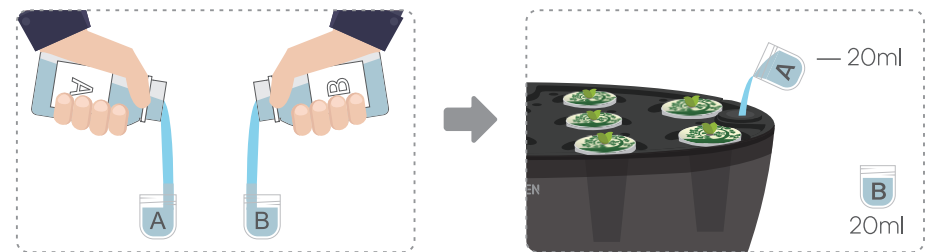

Notes:

- 1 It needs 5ml nutrient A and 5ml nutrient B for each 1L water.
- 2 The water tank can accommodate 4L water in total; therefore, we need 20ml nutrient A and 20ml nutrient B.
- 3 Please add water/nutrient according to the proportion sheet below.

Add Water	Nutrient
1L	5ml A+5ml B
2L	10ml A+10ml B
3L	15ml A+15ml B
4L	20ml A+20ml B

Step 4

Adjust the height of the light panel when the plants grow up.

Note: It is recommended to keep plants 10cm away from light panel, so that the plants won't be scorched and can grow better.



FUNCTION OVERVIEW

Key Function

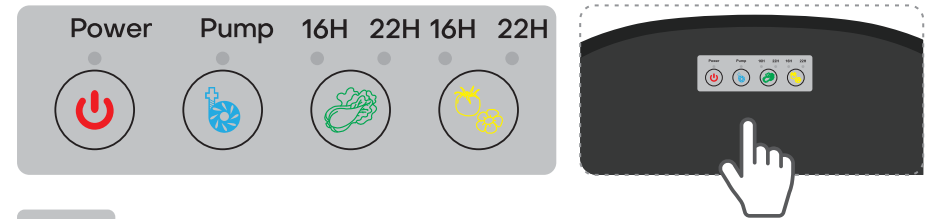

Power

Turn ON/OFF light and pump.



Pump

* Quiet pump. 30 minutes ON, 30 minutes OFF.

* The water pump will work by default after you power on the planter.

* It will automatically work for 30 minutes and stop for 30 minutes repeatedly to create a water circulation system so as to provide sufficient oxygen for the roots.

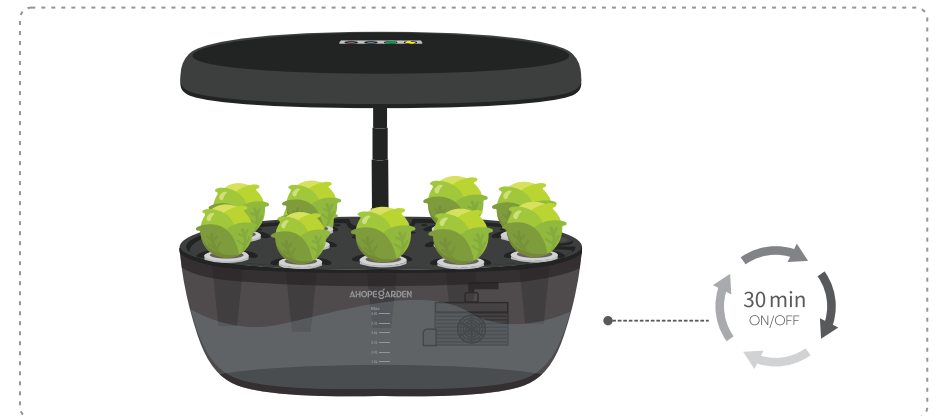

- 1 If you would like to turn off the water pump, please press the water pump button to manually turn it off.
- 2 To avoid entanglement with the water pump, please prune the root of your plants when it's necessary.
- 3 If the pump doesn't work, it may be under OFF state, you can press Pump key to turn it on and open grow deck to confirm.

Lighting Function



16H 22H

Vegetables Mode

For the period of germinating and sprouting.

16H—Light ON 16H, OFF 8H.(Recommend)

22H—Light ON 22H, OFF 2H.

You can turn off the light by pressing the button for 1.5s. The grow light will automatically turn on to supply lighting after 10 hours.

* If you are planting heliophilous vegetables that need more light application time, please choose 22H-Vegetables mode.

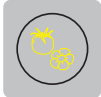
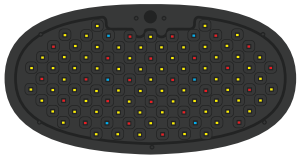

16H 22H

Flowers&Fruits Mode

For the period of blooming and fruiting.

16H—Light ON 16H, OFF 8H.(Recommend)

22H—Light ON 22H, OFF 2H.

You can turn off the light by pressing the button for 1.5s. The grow light will automatically turn on to supply lighting after 10 hours.

* If you are planting heliophilous flowers or fruits that need more light application time, please choose 22H-Flowers&Fruits mode.

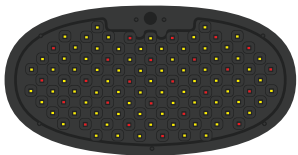

SPECIFICATION

Model No.	Z235
Input:	12V = 2000mA
Noise	< 40dB
Product Size	38(L) x 19(W) x 16-50(H) cm
Product weight	1.23 kg / 2.71 lb

PLANTING TIPS

Germination

* Dark environment is more beneficial to seed germination, so you have no need to turn on the grow light during the period of seed germination. Meanwhile, cover the seed with pod label can partly prevent mold breeding.

* The grow domes can create a warm and humid environment for seeds to root and help prevent pests invasion.

* Plant growth is affected by temperature. Please ensure that the environment temperature is suitable for your seeds to sprout and grow.

Planting

* If you plant different types of plants together, remember to prune faster-growing plants from the top.

* If you find some little bugs, spray your plants with water to wash them off. Make sure you spray under the leaves as bugs usually reside there. For more persistent pests, an insecticidal soap may be used.

* When plants are about 10cm tall, check each seed pod for multiple plants. Use shears gently snip the smallest plants at the stem, leaving just one healthy plant in each pod.

Pruning

* Pruning promote health and harvest, and grow beautiful plants. Always try to prune/harvest just above new leaves as shown in the picture.

* Do not raise the light panel but rather lower the plants. You may achieve more compact and bigger harvest if you prune the plants in time to keep a certain distance between light and all plants.

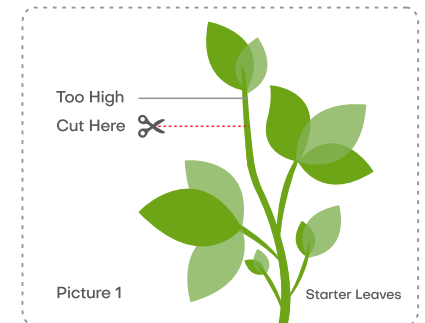

Harvesting

* Smaller harvests for the first month or two until the plants get mature and larger harvests are available after that.

* Harvest frequently to maintain a healthy garden, but take no more than 1/3 of any plant at a time.

Plant Herbs

- * Basil seeds sprout fast and grow rapidly. Harvest basil or any other fast-growing herbs to keep them 10cm below the light panel, and keep the height until all plants are well established.
- * Some herbs, such as chives, thyme, and oregano grow slowly and often get shaded by faster growing plants. Create space for slow-growing plants by pruning surrounding plants.

Plant Salads

- * Salads prefer cool temperatures below 72°F. When growing salads, take care to keep the planter away from sunny windows that might increase the temperature.
- * To harvest, remove whole leaves by cutting the base of leaves with scissors or shears, or by gently pinching off with fingers. Spread your harvest evenly across your planter.

Plant Tomatoes & Peppers

- * Tomatoes should not be mixed with other plants, as they spread out substantially as they grow. Other smaller plants will not get enough light and nutrient to grow well with tomatoes.
- * As your plants grow, it is perfectly normal to see some dead or brown leaves, especially at the lower part of the plant. Remove these leaves with scissors or pinch them off with fingers.
- * Start pollinating your plants regularly once they begin to flower. Gently shake plants from side to side. You may also pollinate by placing a fan in front of the plants.
- * Heavy fruits may cause plants to topple over, support them with wooden skewers or chopsticks.

Plant Flowers

- * When plants are about 2in tall, check each seed pod for multiple plants. Use shears gently snip the smallest plants at the stem, leaving just no more than 3 plants in each pod.
- * Wilted or dead flowers should be removed often for continued flower production.
- * Many flowers are slow to germinate, and some grow slowly once sprouted. Allow up to 3 weeks for seeds to sprout, and remember to keep the light panel 10cm away from the plants until all plants are well established.

FAQs

Q1. Why do the seeds fail to germinate?

- * It is recommended to grow seasonal plants. Seeds of non-seasonal plants may not sprout in the environment warmer than 25°C / 77°F.
- * Please soak the seeds at least 6 hours to soften the peels. The soaking time may vary according to different seeds.
- * The grow domes can create a warm and humid environment for seeds germination.

Q2. Why do the seeds become moldy during the seeds germination?

- * If the seeds fail to germinate at the appropriate time due to unsuitable temperature, they will rot and become moldy. In this case, it is recommended to replace the seeds with the new ones in time.
- * Moldy is a kind of photophilous algae that grow on the surface of sponge. For reducing the moldy breeding, please cover the seed pod with pod label sticker to shade.

*** The sponge is for single use, you can buy replacement grow sponges in our store.**

Q3. Why didn't I see the pump is working?

- * The pump will automatically turn ON/OFF every 30min, you may observe it during the period of OFF;
- * This appliance is equipped with quiet pump, won't make noise when working.
- * Please check if the root is entangled with the water pump; if yes, please remove the root in time; if not, please contact us directly.

Q4. How often should I add nutrients?

- * There is no need to add nutrients before seeds germination. After seeds germination, please ensure that the water is at MAX(4L) mark and add 20ml nutrient A and 20ml nutrient B for the first time.
- * You may observe the water level every week, then add water and nutrients again if the water level drops quickly.
- * For each 1L water you add, please pour 5ml nutrient A and 5ml nutrient B into the water tank.

Plant	Date of Sowing	Date of First Adding Water	Date of Adding Nutrients	Picking Records	Remarks	Recorder
						



深圳智汇创想科技有限责任公司

SHENZHEN WITOTHINK TECHNOLOGY CO., LTD.

12孔植物种植机黑色说明书

说明书尺寸: 210x140(mm) 24p (封面封底背面空白)

材质工艺: 128g铜版纸, 4色印刷, 骑马钉订成册

版本日期: 20230905 v5.0

设计师: 谢艳

备注: 请先打样寄到我司确认后方可生产大货. 大货需校色后做货。

注意: 请严格按照材质工艺要求做货, 如有严重色差和不符合要求公司拒绝收货。

所有内容, 包括文字、图片, 包装方式, 均为原创。对未经许可擅自使用者, 本公司保留追究其法律责任的权利。