



## XJ/MJ Track Bar Brace System

### Installation Instructions

Thank you for choosing Barnes 4WD!

#### Installation Notes:

- Refer to your factory service manual to remove any factory components.
- This product is designed to fit 1984-2001 Jeep XJ Cherokee and 1986-1992 Jeep MJ Comanche.  
**4.0 MODELS ONLY**
- This product is intended to be a starting point for custom suspension fabrication and welding is required.
- Adjustments to transmission cooler line location may be needed. This can typically be done by adjusting the mounting tab on the oil pan.
- An aftermarket or custom, adjustable, double shear track bar is required.
- This is precut with ½" bolt holes for the track bar. These will need to be drilled out to match your selected track bar.

#### Tools required:

- 3/8" Ratchet
- 18MM Socket
- 18MM Wrench
- 3/4" Socket
- 3/4" Wrench
- Welding machine with the capability to weld at least 1/4" thick steel

## CONTENTS OF THE BOX

Bill Of Materials for XJ/MJ Track Bar Brace System			
QTY	Part Number	Etch Number	Description
2	50CNNE0Y/GC		1/2"-13 Nylon Lock Nut
2	50C100HCS8Y		1/2-13 X 1 Hex Cap Screw Gr 8 Yellow Zinc
4	50NWSAFY		1/2" SAE Flat Washer Yellow Zinc
1	B4W188983	983	XJ Track Bar Brace
1	B4W250966	966	XJ Track Bar Mount
1	B4W250965	965	XJ Track Bar Flange

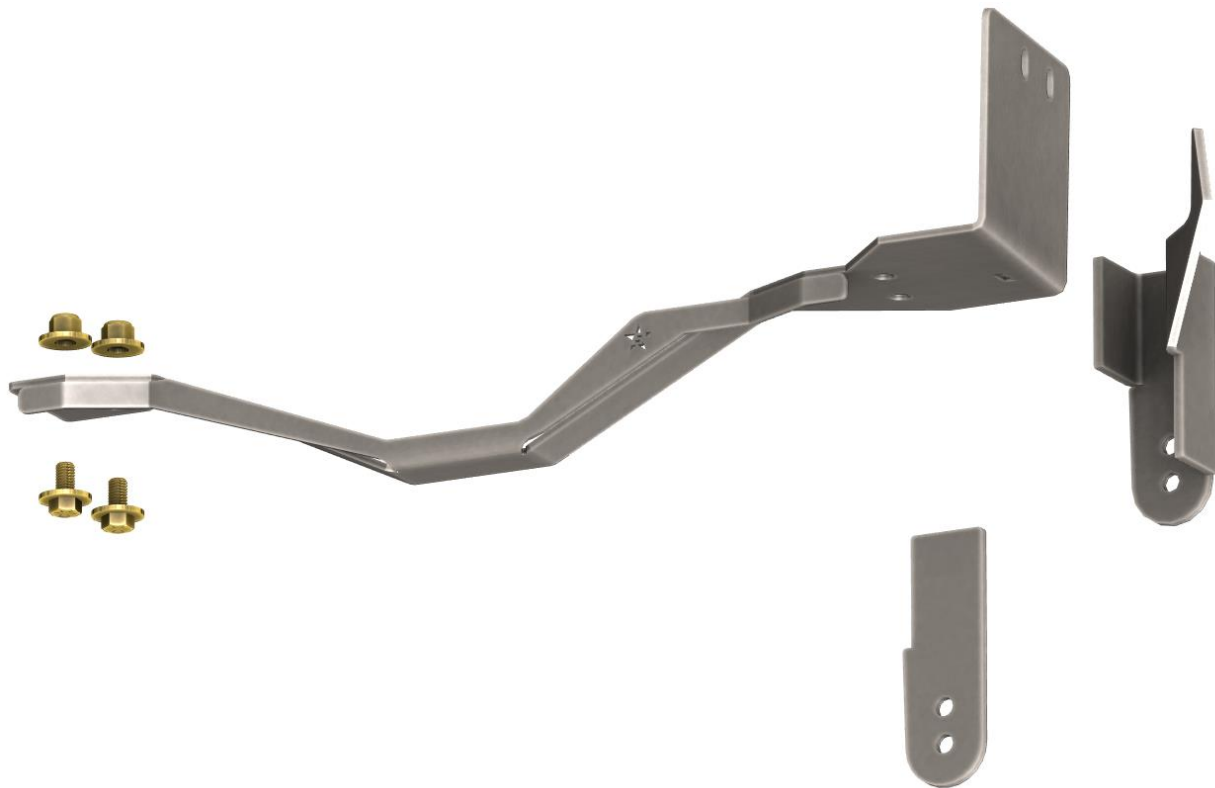

## Step 1:

Determine and drill the bolt holes to the size needed for the track bar if needed.

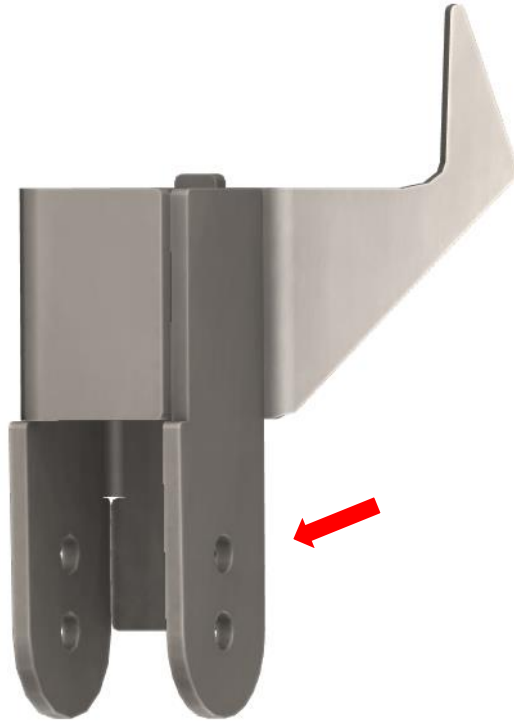

## Step 2:

Locate and tack weld the track bar bracket to the brace using the locating tab as shown below. In this step you will also set your mounting width using your selected track bar mounting width and tack weld the adjustable side plate in place.

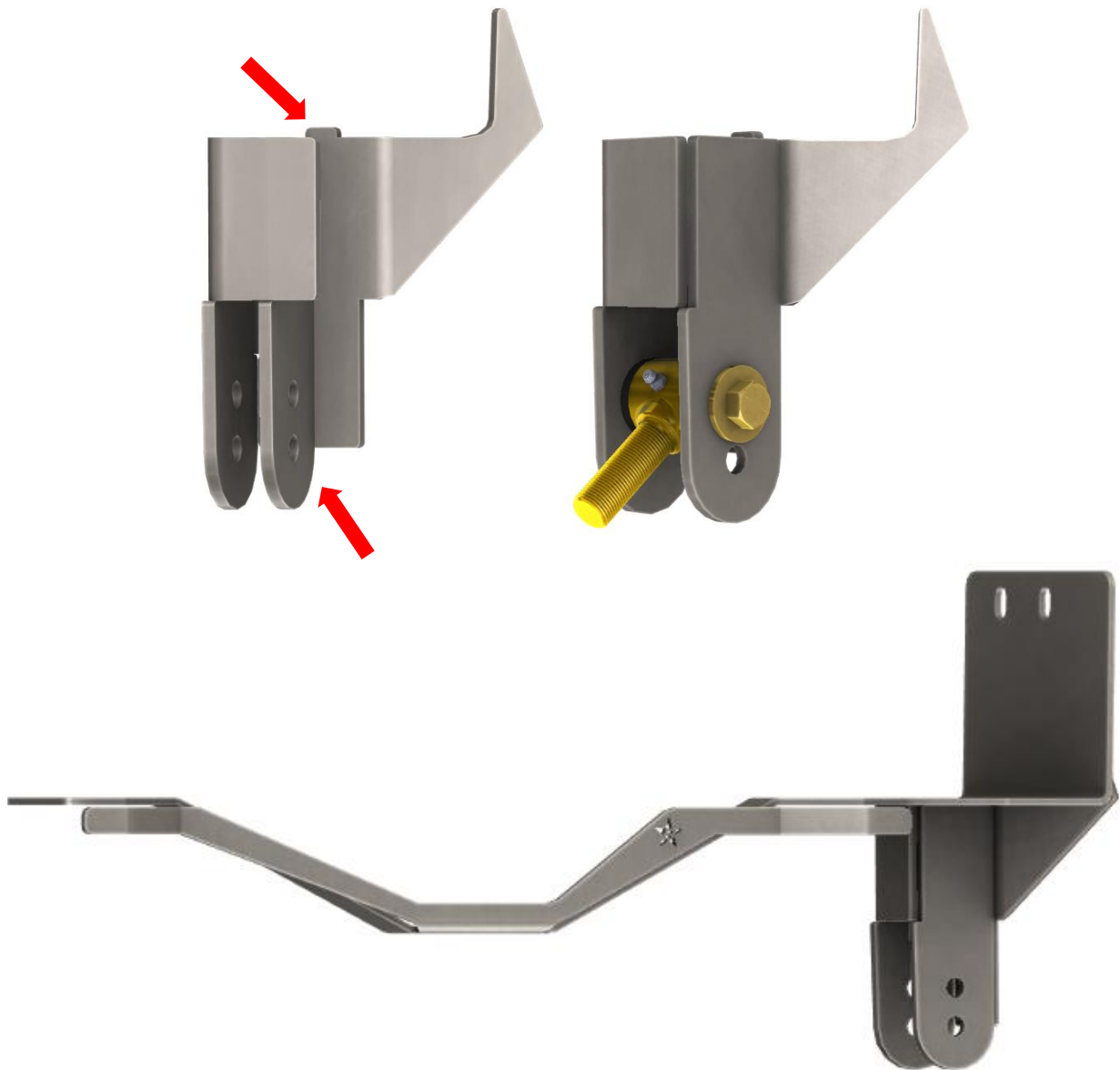

### Step 3:

Tack weld the brace in the locations shown below.



### Step 4:

Refer to your factory service manual and remove the front chassis side, track bar bracket.

### Step 5:

Install the track bar brace and bracket using the factory hardware on the driver side and the provided 1/2" hardware on the passenger side as shown below.



## **Step 6:**

After installation, the suspension will need to be cycled with the new track bar system in place. Depending on the steering, axle, and suspension setup, bump stop extensions may be needed. Once full bump, and droop have been established, the brace and bracket need to be removed, fully welded, painted and reinstalled on the vehicle.

## **Congratulations! You Have finished the installation of the Barnes4wd XJ/MJ Track Bar Brace System.**

### Professional Services Disclaimer:

The content of all pages of this website (collectively, the "Website"), such as text, graphics, images, information and other material (collectively, "Content") is for informational purposes only. Any information furnished on this Website is not intended nor implied to be automotive advice and is not intended to replace personal consultation with a qualified automotive service technician, mechanic, or similar automotive professional.

Barnes 4WD has not examined the Content for accuracy, timeliness, completeness, appropriateness, or helpfulness. Barnes 4WD does not endorse any specific tests, products, procedures, opinions, or other information that may be mentioned on this Website. Your reliance upon information and Content obtained by you at or through this Website is solely at your own risk. IN NO EVENT SHALL BARNES 4WD BE LIABLE OR OTHERWISE RESPONSIBLE FOR ANY DAMAGE OR INJURY (INCLUDING DEATH) TO YOU, OTHER PERSONS, OR PROPERTY ARISING FROM ANY USE OF ANY PRODUCT, INFORMATION, IDEA, OR INSTRUCTION CONTAINED IN THE CONTENT.

BARNES 4WD DOES NOT MAKE ANY REPRESENTATION OR WARRANTY, EXPRESS OR IMPLIED, AT LAW OR IN EQUITY, WITH RESPECT TO ANY PRODUCT FEATURED ON THE WEBSITE, INCLUDING WITHOUT LIMITATION WITH RESPECT TO MERCHANTABILITY, FITNESS FOR ANY PARTICULAR PURPOSE, VALUE, VALIDITY, OR ENFORCEABILITY, AND ANY AND ALL SUCH OTHER REPRESENTATIONS OR WARRANTIES ARE HEREBY EXPRESSLY DISCLAIMED.