



Jeep JL Pinch Weld Covers Installation Instructions

Thank you for purchasing our Jeep JL pinch weld covers!

Installation Notes:

- These panels are designed to fit a 2018-Current Jeep JL Wrangler 4 Door
- Refer to your factory service manual for removal of any part.

Tools required:

- 10mm Wrench
- 10mm Socket
- 4mm Allen Socket
- Ratchet

Contents of Kit

Bill Of Materials for B4WK12835		
QTY	Part Number	Description
2	B4W125158P	JL/JT Pinch Weld Cover Front Powder Coated
2	B4W125159P	JL Rear Pinch Weld Cover Powder Coated
12	HPN-M6-A2-BL	M6 Hexagon Nut Black Stainless Steel
12	HTW-M6-A2-BL	M6 Form B Flat Washer Black Stainless Steel
12	HRSW-M6-A1-BL	M6 Rectangular Profile Spring Washer Black Stainless Steel
16	SSB-M6-25-A2-BL	M6 x 25mm Socket Button Screw Black Stainless Steel

Step 1:

Park the Jeep on a level surface and remove any factory rocker panel or step that may be installed.

Step 2:

Remove the 2 bolts holding the bottom of the front fender to the pinch seam.

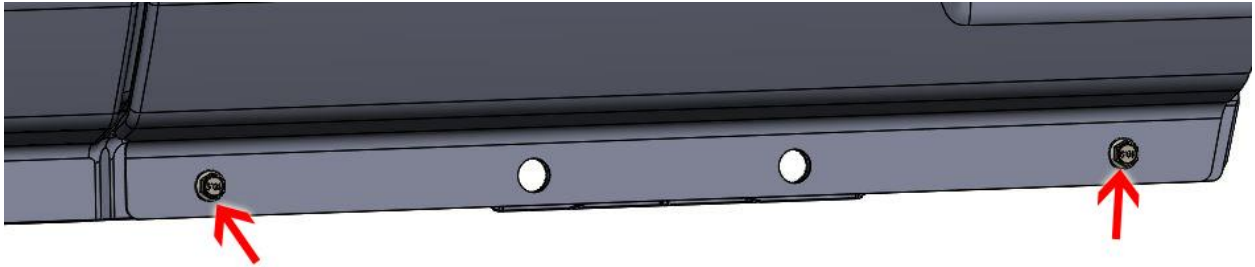

Step 3:

Place the front pinch weld cover on the Jeep. Install the 2 supplied M6 bolts into the holes where the bolts were removed in step 2.



Step 4:

Install the other supplied hardware into the pinch seam as shown below in the following order: washer, split washer, nut.

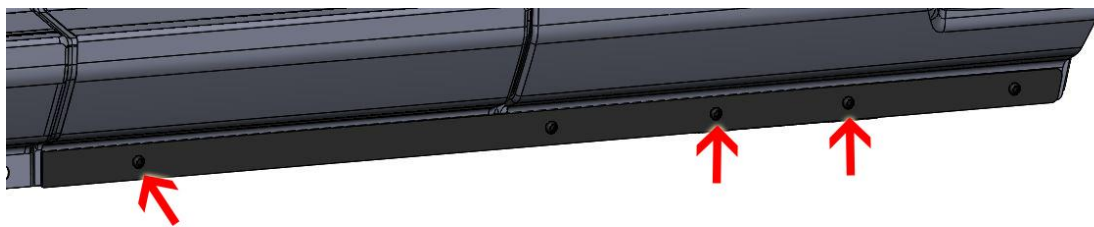
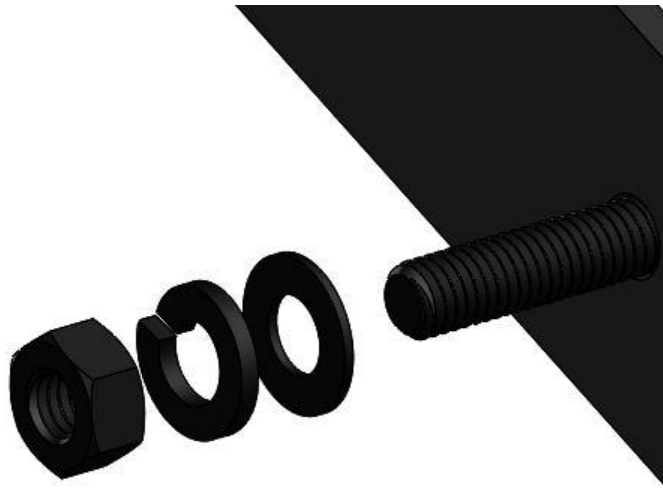

Step 5:

Install the rear pinch seam cover on the Jeep with the supplied hardware.

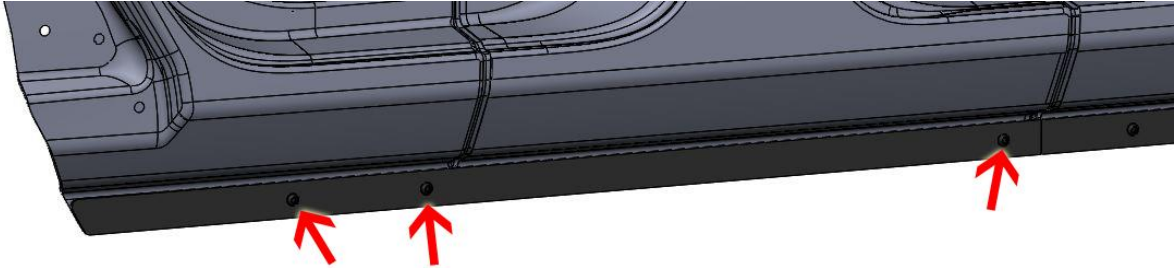

Step 6:

Repeat steps 2 through 5 on the opposite side of the vehicle.

Congratulations! You have finished the installation of the Barnes 4wd Jeep JL pinch weld covers.

Professional Services Disclaimer:

The content of all pages of this website (collectively, the "Website"), such as text, graphics, images, information and other material (collectively, "Content") is for informational purposes only. Any information furnished on this Website is not intended nor implied to be automotive advice and is not intended to replace personal consultation with a qualified automotive service technician, mechanic, or similar automotive professional.

Barnes 4WD has not examined the Content for accuracy, timeliness, completeness, appropriateness, or helpfulness. Barnes 4WD does not endorse any specific tests, products, procedures, opinions, or other information that may be mentioned on this Website. Your reliance upon information and Content obtained by you at or through this Website is solely at your own risk. IN NO EVENT SHALL BARNES 4WD BE LIABLE OR OTHERWISE RESPONSIBLE FOR ANY DAMAGE OR INJURY (INCLUDING DEATH) TO YOU, OTHER PERSONS, OR PROPERTY ARISING FROM ANY USE OF ANY PRODUCT, INFORMATION, IDEA, OR INSTRUCTION CONTAINED IN THE CONTENT.

BARNES 4WD DOES NOT MAKE ANY REPRESENTATION OR WARRANTY, EXPRESS OR IMPLIED, AT LAW OR IN EQUITY, WITH RESPECT TO ANY PRODUCT FEATURED ON THE WEBSITE, INCLUDING WITHOUT LIMITATION WITH RESPECT TO MERCHANTABILITY, FITNESS FOR ANY PARTICULAR PURPOSE, VALUE, VALIDITY, OR ENFORCEABILITY, AND ANY AND ALL SUCH OTHER REPRESENTATIONS OR WARRANTIES ARE HEREBY EXPRESSLY DISCLAIMED.