

TIOMOS 110/45A

+45° angle corner cabinet hinge (overlay)



- For 45° angled cabinets
- 110° opening angle
- With convenient depth adjustment via worm screw
- 3-dimensional adjustment with corresponding mounting plate
- Minimum reveals
- Surfaces: Nickel or Night (especially for dark cabinet materials and woods)

Available in three versions:

- With integrated damper (3 adjustable damping levels)
- Without integrated damper
- Without self-closing mechanism (without spring)

ORDER INFORMATION FOR DRILLING PATTERN 45/9.5, NICKEL

Door overlay		Damper		Without spring	Art. No.		
		With	Without		Click-on for screw fitting	Click-on for press fitting	Impresso tool-free
Overlay ¹		■	-	-	F028138533	F028138543	F017139339
		-	■	-	F045138471	-	F034139310
		-	■	■	F046138593	-	F035139367

¹ Cup material: steel, nickel-plated/Arm material: zamak, nickel-plated

ORDER INFORMATION FOR DRILLING PATTERN 45/9.5, NIGHT

Door overlay		Damper		Without spring	Art. No.		
		With	Without		Click-on for screw fitting		
Overlay ¹		■	-	-	F028140962		

¹ Cup material: steel, Night/Arm material: zamak, Night

PAGE REFERENCES

Tiomos mounting plates	86	Tipmatic	114		
Accessories	96	Assembly technology	637		
Technical information	100	Assembly aids	654		

PLANNING DIMENSIONS

All dimensions in millimetres

Overlay

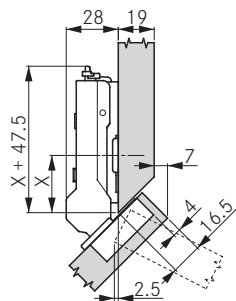

Mounting plate height 0

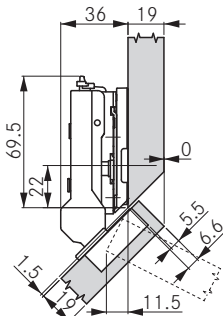

Mounting plate height 8

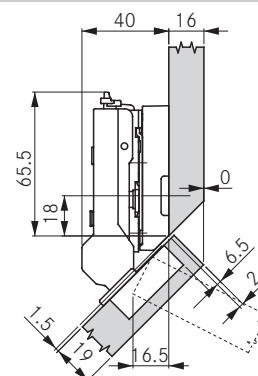

Mounting plate height 12

	Cup distance					
	3	4	5	6	7	
19.5					0	
19.0						
18.5				0		
18.0						
17.5			0			
17.0						
16.5		0			2	
16.0						
15.5	0			2		
15.0					3	
14.5			2			
14.0				3		
13.5		2				
13.0			3			
12.5	2					
12.0		3				
11.0	3				6	
10.0				6		
Door overlay	Mounting plate height					

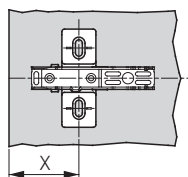

Cross mounting plates with mounting distance 37

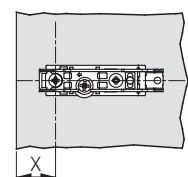

Linear mounting plates

	Mounting plate height				
	0	2	3	6	
X	30.5	28.5	27.5	24.5	
	Cross mounting plate position (X)				

	Mounting plate height			
	0	2	3	
X	13.5	11.5	10.5	
	Linear mounting plate position (X)			

MINIMUM GAP

	Cup distance					
	3	4	5	6	7	
24.0	1.0	1.0	1.0	1.2	2.1	
22.0	1.0	1.0	1.0	1.0	1.5	
21.0	1.0	1.0	1.0	1.0	1.2	
20.0	1.0	1.0	1.0	1.0	1.0	
19.0	1.0	1.0	1.0	1.0	1.0	
18.0	1.0	1.0	1.0	1.0	1.0	
17.0	1.0	1.0	1.0	1.0	1.0	
16.0	1.0	1.0	1.0	1.0	1.0	
Door thickness	Minimum gap					

MINIMUM REVEAL

	Cup distance					
	3	4	5	6	7	
24.0	2.4	2.1	2.1	2.1	2.0	
22.0	1.6	1.6	1.6	1.5	1.5	
21.0	1.4	1.3	1.3	1.3	1.3	
20.0	1.1	1.1	1.1	1.1	1.1	
19.0	0.9	0.9	0.9	0.9	0.9	
18.0	0.7	0.7	0.7	0.7	0.7	
17.0	0.6	0.6	0.6	0.6	0.6	
16.0	0.6	0.6	0.6	0.6	0.6	
Door thickness	Minimum reveal (F)					

NOTES

The minimum gap is the clearance required between the cabinet face and the closed door so that the door can be opened without hindrance.

Minimum reveal for doors with chamfered edges (R = 1 mm) with factory setting.

A trial fitting is recommended for door thicknesses from 24 mm.

DRILLING PATTERNS 45/9.5

For screw fitting

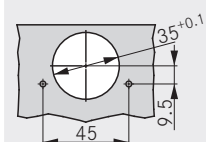

Impresso combination drilling pattern

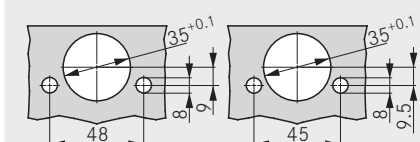

CUP DIMENSIONS

