

# TIOMOS 155

155° wide-angle hinge (door thicknesses up to 32 mm)

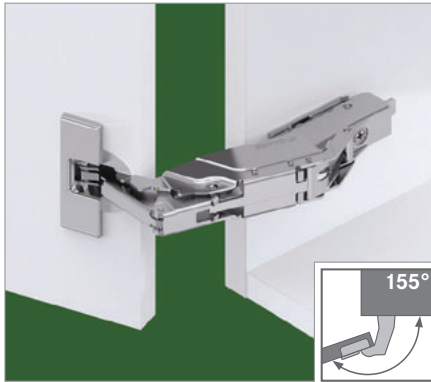

- 155° opening angle
- With convenient depth adjustment via worm screw
- For cabinets with inset drawers or pull-out shelves
- Optimal reveals for door thicknesses up to 32 mm
- 3-dimensional adjustment with corresponding mounting plate
- Minimum reveals
- Shallow cup depth
- Surfaces: Nickel or Night (especially for dark cabinet materials and woods)

### Available in three versions:

- With integrated damper (3 adjustable damping levels)
- Without integrated damper
- Without self-closing mechanism (without spring)

## ORDER INFORMATION FOR DRILLING PATTERN 45/9.5, NICKEL

Door overlay	Cranking	Damper		Without spring	Art. No.		
		With	Without		Click-on for screw fitting	Click-on for press fitting	Impresso tool-free
Full overlay <sup>1</sup>	0	■	-	-	F028138561	F028138564	F017139350
		-	■	-	F045138499	F045138502	F034139321
		-	■	■	F046138621	F046138624	-
Overlay <sup>1</sup>	3	■	-	-	F028138562	F028138565	F017139351
		-	■	-	F045138500	F045138503	F034139322
		-	■	■	F046138622	F046138625	-
Half overlay <sup>1</sup>	9.5	■	-	-	F028138563	F028138566	F017139352
		-	■	-	F045138501	F045138504	F034139323
		-	■	■	F046138623	F046138626	F035139380

<sup>1</sup> Cup material: zamak, nickel-plated/Arm material: zamak, nickel-plated

## ORDER INFORMATION FOR DRILLING PATTERN 45/9.5, NIGHT

Door overlay	Cranking	Damper		Without spring	Art. No.		
		With	Without		Click-on for screw fitting		
Overlay <sup>1</sup>	3	■	-	-	F028140944		
Half overlay <sup>1</sup>	9.5	■	-	-	F028140942		

<sup>1</sup> Cup material: zamak, Night/Arm material: zamak, Night

### MITRED APPLICATION (ON ALL SIDES)

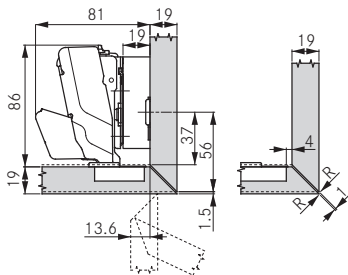

With 0 cranking, mounting plate height 19 mm and cup distance 4 mm, door and cabinet edges can meet at mitred angles on all 4 sides.

### ZERO PROTRUSION

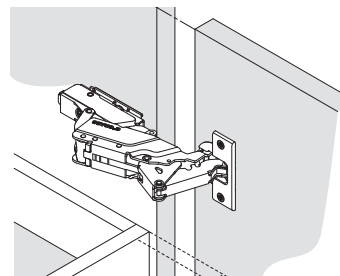

### For use with inset drawers.

At 0 cranking, and with all mounting plate thicknesses, the door protrudes inwards at 90°. With cranking size 3 and mounting plate height 3 mm, the door will be flush with the cabinet.

Door thickness (TS)	Mitre, all 4 sides	Mitre, side
	R (min.)	R (min.)
19-20	1.0	0
22	2.0	0
24	3.0	1.0
26	4.2	2.5
28	5.4	3.8
30	6.5	5.3

