

KINVARO

T-57 lift-up flap fitting



- Opening angle adjustable to 75° or 90°
- Easy to install
- Adjustable spring force
- Adjustable flap height ± 1.0 mm
- No hinges fitted to the top panel
- Allows additional cabinet installation above
- Can be used for wooden flaps
- Weight 1.0 to 6.2 kg
- Range of flaps:
 - Width: up to 1200 mm
 - Weight: 300–600 mm
- High-quality finish, nickel-plated

APPLICATION RANGE

Cabinet height	Flap weight incl. handle	
	Min.	Max.
300	1.0	6.2
350	1.2	4.9
400	1.4	3.8
450	1.5	3.6
500	1.7	2.9
550	1.9	2.7
600	2.1	2.5

ORDER INFORMATION

Kinvaro T-57 set			
Designation	Version for	Overlay	Art. No.
Kinvaro T-57, nickel-plated, adjustable springs on right and left	Wood	Variable	F151145224

ACCESSORIES

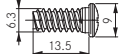
	Designation	Material	Art. No.
	Euro collar screws, nickel-plated, \varnothing 6.3 x 13.5 mm	-	F150145234

Kinvaro T-57 set comprises:

- 1** Fitting, right and left (1x)
- Paper template (1x)
- Installation instructions (1x)

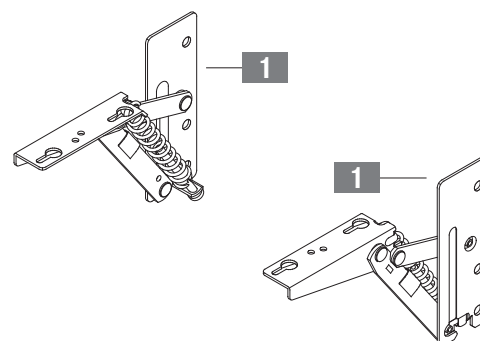

PAGE REFERENCES

Kinvaro T-57 adjustment options	281
Assembly aids	656

ASSEMBLY AND INSTALLATION INSTRUCTIONS

All dimensions in millimetres

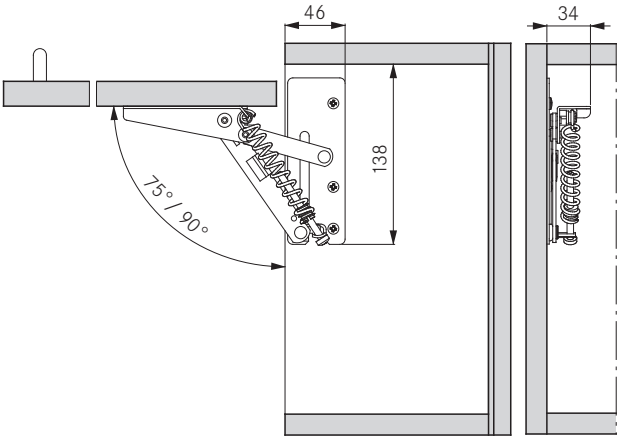
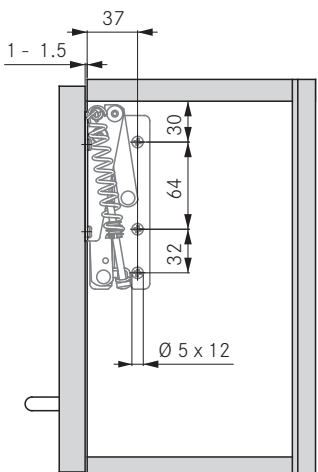
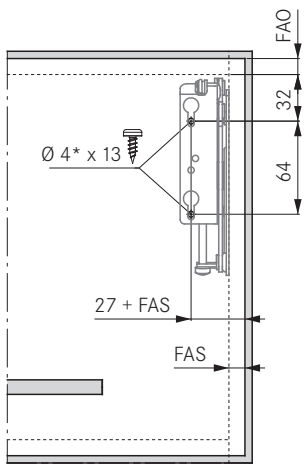
<p>Required space</p> 	<p>Side wall drilling positions</p> 
<p>Front installation for wooden and frame flaps (min. 55 mm width)</p>  <p style="text-align: right;">* Pre-drilling required Ø 2 mm</p>	<p>1</p> <p>2</p> <p>3</p> <p>4</p> <p>5</p>
<p>Calculation of flap weight</p> <p>Flap width x flap height x flap thickness x density ¹ + weight of handle ² = weight of flap</p> <p>¹ Densities: MDF board 0.85 kg/dm³, chipboard 0.65 kg/dm³, spruce/pine 0.45 kg/dm³</p> <p>² For bar handles, allow 0.1 kg per 100 mm of handle length. We recommend a trial fitting</p>	

WARNING

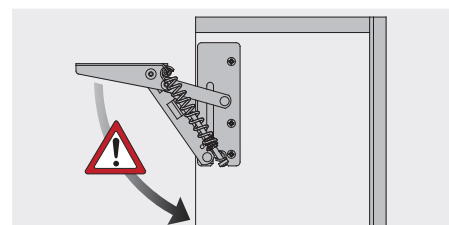

Important!
Caution – risk of injury!
Fitting is spring-tensioned!

LEGEND

F	Reveal
FAO	Front overlay, top
FAS	Front overlay, side
PH	Stamping height

