

Contents:

English User Manual	1
取扱説明書	13
Benutzerhandbuch	21
Manuale Utente	30
Guide Utilisateur	39
Manual de Usuario	48

Safety instructions

- Avoid dropping.
- Do not disassemble.
- Avoid extreme temperatures.
- Do not use the device outdoors during thunderstorms.
- Do not use any corrosive cleaner/oil to clean.

Specification

Bluetooth version: V5.0
Support: A2DP, AVRCP, HFP, HSP
Output power: 2 x 8W
Battery: 3.7V, 4400mAh
Battery charge time: 5 hour
Input: DC5V/1A
Dimension: 175 x 59 x 56 (mm)
Weight: 380g

What's in the box

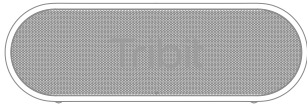

XSound Go



USB-C Cable



Lanyard



User Manual

Overview buttons & Indicators

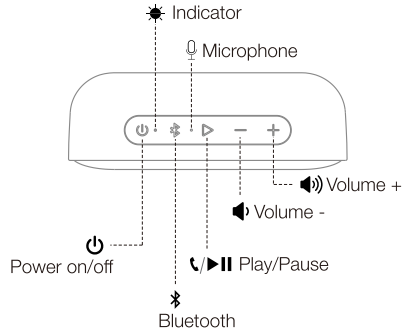

Connections

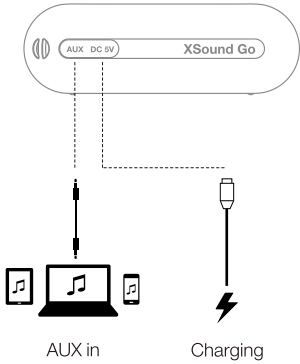

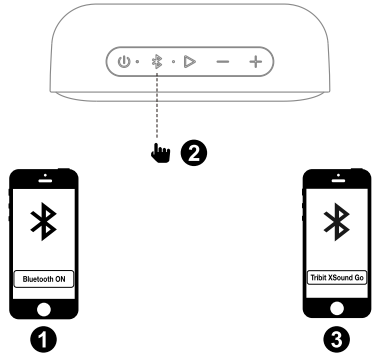

Bluetooth connection

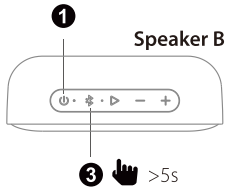
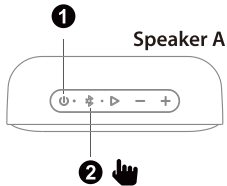

Stereo Mode

1. Make sure both speakers are on.



2. Press  on one of the speakers to enter pairing state.

3. Press  on the other speaker for 5s, then release the button to enter Stereo pairing when you hear the "Stereo mode". When you hear "Left channel" on the left speaker and "Right channel" on the right speaker, the "Stereo mode" is on.

Buttons

Button	Operation & Function
Power on/off	Press to turn on/off
Bluetooth	Press to enter pairing mode
Volume +	Press to increase the volume level
Volume -	Press to decrease the volume level
Play/Pause	<ul style="list-style-type: none"> • Press to play/pause Music and answer/end call • Long press to reject a call • Press twice to skip to next track • Press triple to skip to Previous track

Indicator

Indicator	Status
Blue indicator flashes slowly	Reconnection mode
Blue indicator flashes quickly	Bluetooth pairing mode
Blue indicator keeps on	Pairing has been successful
Red indicator flashes slowly	Low battery power (<15%), charge the speaker as required

Red indicator flashes quickly	Low battery power (<2%) and will automatically power off after 5s charge the speaker immediately
-------------------------------	--

Reset

If this speaker has some problem, you can try to press and hold “Volume +” and “Volume –” button simultaneously for 5 seconds to reset, and then pairing again (delete the old pairing in your device).

FCC Statement

Changes or modifications not expressly approved by the party responsible for compliance could void the user's authority to operate the equipment. This equipment has been tested and found to comply with the limits for a Class B digital device, pursuant to Part 15 of the FCC Rules. These limits are designed to provide reasonable protection against harmful interference in a residential installation.

This equipment generates uses and can radiate radio frequency energy and, if not installed and used in accordance with the instructions, may cause harmful interference to radio communications. However, there is no guarantee that interference will not occur in a particular installation. If this equipment does cause harmful interference to radio or television reception, which can be determined by turning the equipment off and on, the user is encouraged to try to correct the interference by one or more of the following measures:

- Reorient or relocate the receiving antenna.
- Increase the separation between the equipment and receiver.
- Connect the equipment into an outlet on a circuit different from that to which the receiver is connected.
- Consult the dealer or an experienced radio/TV technician for help

This device complies with part 15 of the FCC rules. Operation is subject to the following two conditions (1) this device may not cause harmful interference, and (2) this device must accept any interference received, including interference that may cause undesired operation.

* RF warning for Mobile device:

This equipment complies with FCC radiation exposure limits set forth for an uncontrolled environment. This equipment should be installed and operated with minimum distance 20cm between the radiator & your body.

Customer service

18-month limited warranty

- For FAQs and more information, please
- Email to:

support@tribitaudio.com

安全使用するためのご注意

- 製品を落下しないでください。
- 製品を分解しないでください。
- 高温な場所に置かないでください。
- 雷雨の天候に室外で本製品を使用しないでください。
- 腐食性のある洗剤やオイルで製品を洗淨しないでください。

仕様

Bluetooth バージョン: V5.0
サポート: A2DP, AVRCP, HFP, HSP
定格入力電力: 2 x 8W
バッテリーの種類: 3.7V, 4400mAh
バッテリー充電時間: 5 時間
入力: DC5V/1A
寸法: 170 x 59 x 56 (mm)
重量: 380g

パッケージの内容



XSound Go無線スピーカー本体



USB-C 充電ケーブル



付けひも



取扱説明書

ボタンとインジケータ—各部 のなまえ

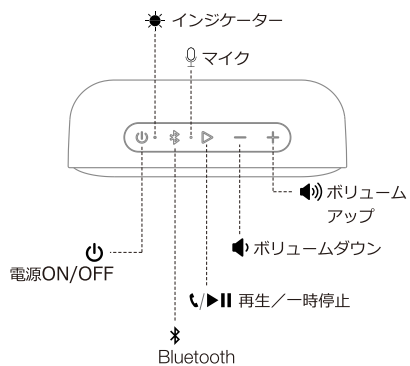

-14-

接続口

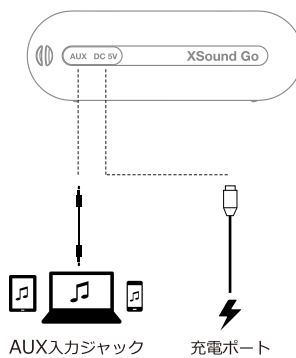

-15-

Bluetoothペアリング

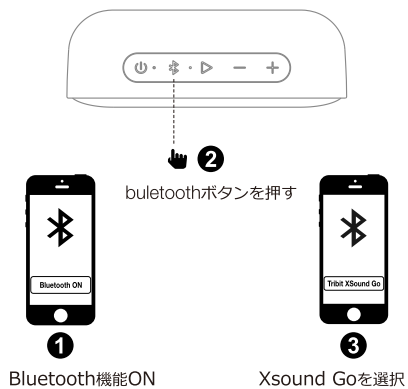

Stereoモード

1. スピーカーの をオンにします。

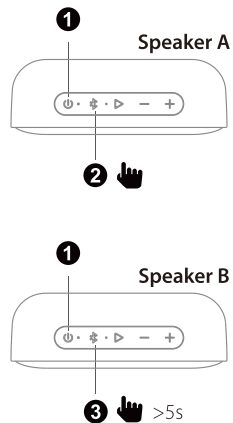

1、スピーカーAの  を短く押すと、ペアリングモードになります。

2、スピーカーBの  を5秒ほど長押しして、“Stereo mode” 提示音が鳴ったらBluetoothボタンから指を離します。左スピーカーで“Left channel”、右スピーカーで“Right channel”と聞こえたら、Stereoモードに入ります。

ボタン

ボタン	操作と機能
電源ON/OFF	押すと電源がオン/オフになる
Bluetooth	押すとペアリングモードに入る
ボリューム+	ボリュームアップ
ボリューム-	ボリュームダウン
再生/ 一時停止	音楽の再生/一時停止、電話を受ける/ 切る、長押しすると着信を拒否する/ 2回押すと曲送り/3回押すと曲戻し

インジケーター

インジケーター	状態
青色で遅い点滅	待ち受け
青色で速い点滅	Bluetoothペアリングモード
青色で常時点灯	接続完了
赤色が点灯する	充電中/バッテリー残量 15%以下、充電が必要

赤色で速い点滅

バッテリー残量2%以下、
5秒後自動的に電源
OFF、直ちに充電が必要

初期化をする

スピーカーの使用時、問題が発生してリセットが必要な場合、「ボリュウムアップ」と「ボリュウムダウン」ボタンを同時に5秒ぐらい長押しすると、初期化になります。再度ペアリングを行ってください。（デバイスにある以前のペアリングを消去してください。）

アフターサービス

- 18ヶ月間品質保証
- ご質問や不明なところがあれば、どうぞこちらにご連絡してください。
support@tribitaudio.com

Sicherheitshinweise

- Hinunterfallen vermeiden.
- Nicht zerlegen.
- Extreme Temperaturen vermeiden.
- Nicht während eines Gewitters im Freien verwenden.
- Keine ätzenden Reiniger oder Öl für die Reinigung verwenden.

Spezifikation

Bluetooth version: 5.0
Unterstützung: A2DP, AVRCP, HFP, HSP
Nennstromverbrauch: 2 x 8W
Batterie-Typ: 3.7V, 4400mAh
Batterieladezeit: 5 Std
Eingang: 5V/1A
Abmessungen: 170 x 59 x 56 (mm)
Gewicht: 380g

Lieferumfang

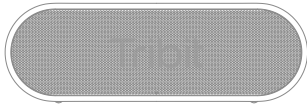

XSound Go



USB-C Kabel



Trageband



Benutzerhandbuch

Überblick über Tasten und Anzeigen

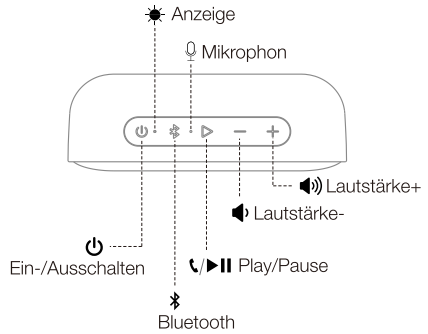

Anschlüsse

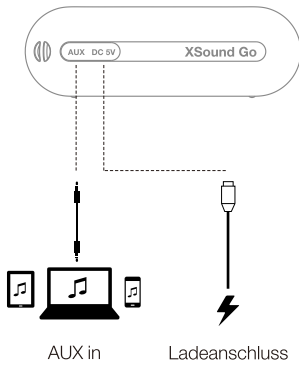

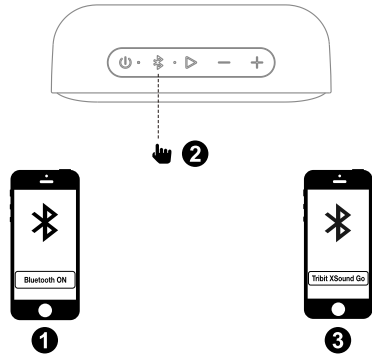

Bluetooth Verbindung

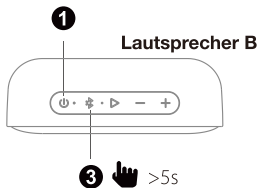
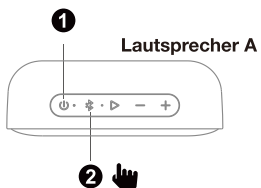

Stereo-Modus

1. Stellen Sie sicher, dass beide Lautsprecher eingeschaltet sind.



2. Drücken Sie die  an einem der Lautsprecher, um den Pairing-Status aufzurufen.

3. Drücken Sie die  auf dem anderen Lautsprecher für 5s, lassen Sie dann die Taste los, um in den Stereo-Pairing-Modus zu gelangen, anschließend hören Sie aus dem linken Lautsprecher die Ansage "Links" und aus dem rechten die Ansage "Rechts". Der Stereomodus ist aktiviert.

Tasten

Taste	Betrieb & Funktion
Ein-/Ausschalten	Drücken zum Ein-/Ausschalten
Bluetooth	Drücken um in den Verbindungsmodus zu gelangen
Lautstärke+	Drücken um die Lautstärke zu erhöhen
Lautstärke-	Drücken um die Lautstärke zu verringern
Play/Pause	<ul style="list-style-type: none"> • Drücken um Musik wiederzugeben/zu pausieren und um Anrufe zu beantworten/zu beenden • Lange Drücken um Anrufe abzuweisen • Zweimal Drücken um zum nächsten Titel zu wechseln • Dreimal Drücken um zum vorigen Titel zu wechseln

Anzeigen

Anzeige	Status
Blaue Leuchtanzeige blinkt langsam	Erneuter Verbindungsaufbau
Blaue Leuchtanzeige blinkt schnell	Bluetooth Verbindungsmodus
Blaue Leuchtanzeige bleibt an	Verbunden
Rote Leuchtanzeige leuchtet auf	Lademodus Niedriger Batteriestand(< 15%). Laden Sie den Lautsprecher nach Bedarf

-28-

Rote Leuchtanzeige blinkt schnell	Sehr niedriger Akkustand (<2%), der Lautsprecher schaltet sich nach 5 Sek. automatisch ab. Laden Sie den Lautsprecher umgehend
-----------------------------------	--

Zurücksetzen des Gerätes

Wenn der Lautsprecher nicht mehr problemlos funktioniert, können Sie die Tasten „Lautstärke+“ und „Lautstärke-“, gleichzeitig drücken und für 5 Sekunden gedrückt halten, um den Lautsprecher zurückzusetzen und erneut zu verbinden (löschen Sie die bestehenden Verbindungen auf Ihrem Gerät).

Kundenservice

- **18 Monate beschränkte Garantie**
- **Für Fragen und mehr Information, wenden Sie sich bitte an:**
support@tribitaudio.com

-29-

Istruzioni di sicurezza

- Evitare di far cadere a terra
- Non disassemblare
- Evitare temperature estreme
- Non usare il dispositivo all'aperto durante tempeste con tuoni
- Non usare pulitori corrosivi per pulire il dispositivo

Specificazione

Versione Bluetooth: 5.0

Supporta: A2DP, AVRCP, HFP, HSP

Alimentazione nominale in ingresso: 2 x 8W

Batteria: 3.7V, 4400mAh

Tempo di carica della batteria: 5 ore

Input: 5V/1A

Dimensioni: 170 x 59 x 56 (mm)

Peso: 380g

-30-

Cosa c'è nella scatola



XSound Go



Cavo USB-C



Cordino



Manuale Utente

-31-

Panoramica su pulsanti ed indicatori

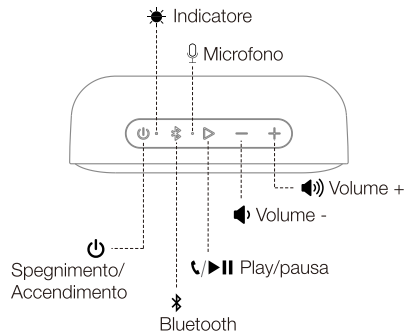

-32-

Connessioni

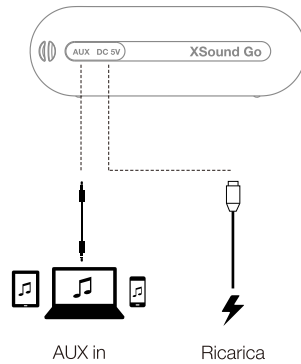

-33-

Connessione Bluetooth

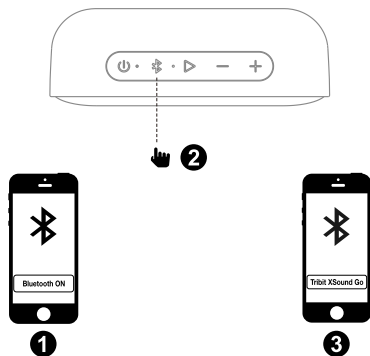

Modalità Stereo

1. Assicurarsi che entrambi gli altoparlanti siano attivi.

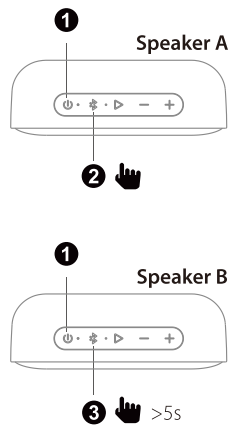

2. Premere il  su uno degli altoparlanti per accedere allo stato di associazione.

3. Premere il  sull'altro altoparlante per 5 secondi, quindi rilasciare il pulsante per accedere all'associazione stereo quando si sente la "modalità stereo". Quando si sente "Left channel" sull'altoparlante sinistro e "Right channel" sull'altoparlante destro, la "Modalità stereo" è attiva.

Pulsanti

Plusante	Operazione e Funzione
Accensione/ Spegnimento	Premere per accendere/spengere
Bluetooth	Premere per entrare in modalità abbinamento
Volume +	Premere per incrementare il volume
Volume -	Premere per decrementare il volume
Play/Pausa	<ul style="list-style-type: none">• Premere per riprodurre/mettere in pausa la musica e rispondere/terminare le chiamate• Premere a lungo per rifiutare la chiamata• Premere due volte per passare alla traccia successiva• Premere tre volte per tornare alla traccia precedente

Indicatori

Indicatore	Stato
L'indicatore blu emette un flash lentamente	Modalità riconessione
L'indicatore blu emette un flash velocemente	Modalità abbinamento Bluetooth
L'indicatore blu emette una luce fissa	Connessione
L'indicatore rosso si accende	Modalità ricarica Batteria quasi esaurita (<15%), sarà necessario ricaricare il dispositivo

L'indicatore rosso emette un flash velocemente

Batteria quasi esaurita (<2%), si spegnerà automaticamente dopo 5 secondi. Sarà necessario ricaricare il dispositivo

Reset

Se lo speaker ha qualche problema, è possibile tenere premuti i tasti Volume + e Volume - simultaneamente per 5 secondi per riavviare il dispositivo e poi provare ad abbinare nuovamente (eliminare l'ultimo abbinamento dal dispositivo)

Servizio Consumatori

- **18 mesi di garanzia limitata**
- **Per domande ed altre informazioni, contattare:**
support@tribitaudio.com

Consignes de sécurité

- Eviter de la faire tomber
- Ne pas démonter
- Eviter les températures extremes
- Ne pas utiliser l'enceinte en extérieur quand il y a de l'orage
- Ne pas utiliser un nettoyeur corrosif/huileux pour nettoyer

Caractéristiques

Version bluetooth: V5,0

Support: A2DP, AVRCP, HFP, HSP

Puissance de sortie: 2 x 8W

Batterie: 3,7V – 4400 mAh

Temps de charge de la batterie: 5 heures

Entrée: DC5V/1A

Taille: 175 x 59 x 56mm

Poids: 380g

Contenu de la boîte

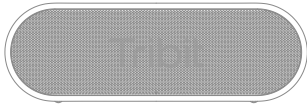

XSound Go



Cable USB-C



Cordon



Guide utilisateur

Vue du dessous, boutons et indicateurs

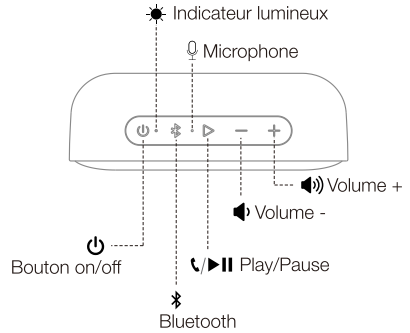

Connectique

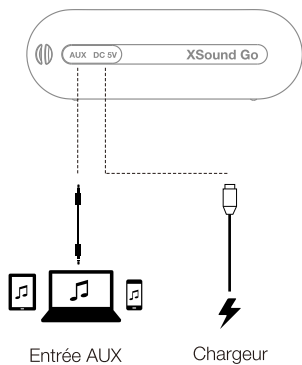

Connexion Bluetooth

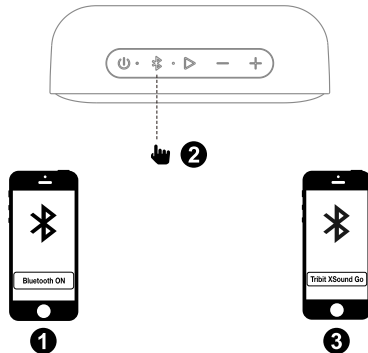

Mode Stéréo

1. Assurez-vous que les deux haut-parleurs sont allumés.

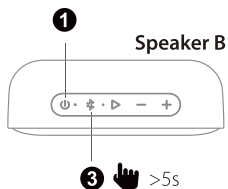
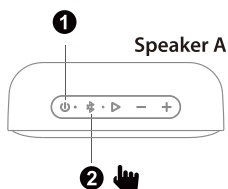

2. Appuyez sur le  de l'une des enceintes pour entrer dans l'état d'appairage.

3. Appuyez sur le  de l'autre haut-parleur pendant 5s, puis relâchez le bouton pour entrer dans le couplage stéréo lorsque vous entendez le "Stereo mode ". Lorsque vous entendez "Left channel" sur le haut-parleur gauche et "Right channel" sur le haut-parleur droit, le "Stereo mode " est activé.

Boutons

Bouton	Opération et fonction
Bouton on/off	Appuyer pour allumer ou éteindre
Bluetooth	Appuyer pour allumer le mode jumelage
Volume +	Appuyer pour augmenter le volume
Volume -	Appuyer pour diminuer le volume
Play/Pause	<ul style="list-style-type: none">• Appuyer play/pause• Appui long pour rejeter un appel• Appui deux fois pour la piste suivante• Appui trois fois pour la piste précédente

Indicateur Lumineux

Indicateur	Statut
Lumière bleue clignote lentement	Mode reconnexion
Lumière bleue clignote rapidement	Jumelage bluetooth en cours
Lumière bleue statique	Jumelage réussi
Lumière rouge clignote lentement	Batterie faible (<15%), Chargement requis

-46-

Lumière rouge clignote rapidement

Batterie très faible (<2%),
L'enceinte s'éteint automatiquement après 5s si pas
on ne charge pas immédiatement

Réinitialisation

Si l'enceinte à un problème, vous pouvez essayer d'appuyer simultanément sur le "volume+" et le "volume-" pendant 5 secondes pour réinitialiser, et ensuite ressayer le jumelage (efface le dernier jumelage de l'appareil)

Service client

- **18 month limited warranty**
- **for FAQs and more information, please email to : support@tribitaudio.com**

-47-

Instrucciones de seguridad

- Evite que se caiga. .
- No desmontar.
- No lo sumerja en agua.
- Evitar las temperaturas extremas. .
- No utilice el dispositivo al aire libre durante tormentas eléctricas
- No utilice limpiadores / aceites corrosivos para limpiar.

Especificaciones

Versión de Bluetooth: V5.0

Soporte: A2DP, AVRCP, HFP, HSP

Potencia de salida: 2 x 8W

Batería: 3.7V, 4400mAh

Tiempo de carga de la batería: 5 horas

Entrada: DC5V / 1A

Dimensión: 175 x 59 x 56 (mm)

Peso: 380 g

-48-

Qué hay en la caja

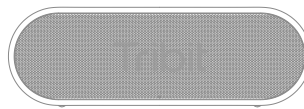

Altavoz Tribit XSound Go



Cable USB-C



Cordón



Manual de usuario

-49-

Vista previa e indicaciones

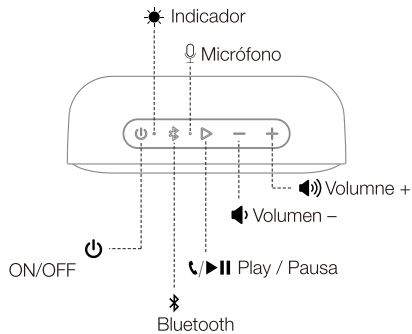

-50-

Conectores

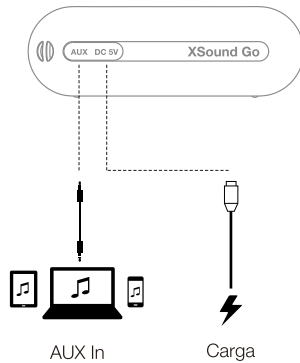

-51-

Conexión Bluetooth

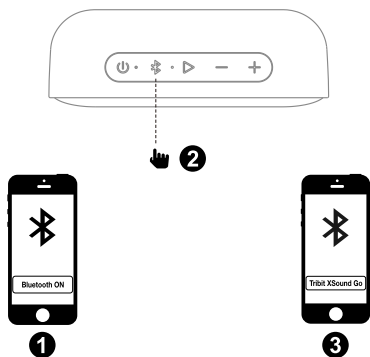

Modo stereo

1. Asegúrese de que ambos altavoces estén encendidos.

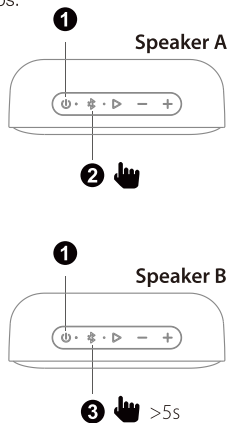

2. Presione el  en uno de los altavoces para ingresar al estado de emparejamiento.

3. Presione el  en el otro altavoz durante 5 segundos, luego suelte el botón para entrar al emparejamiento estéreo cuando escuche el "modo estéreo". Cuando escuche "Canal izquierdo" en el altavoz izquierdo y "Canal derecho" en el altavoz derecho, el "Modo estéreo" estará activado.

Botones

Botón	Función
ON/OFF	Encender/Apagar
Bluetooth	Emparejar
Volumen +	Incrementar el volumen
Volumen -	Reducir el volumen
Play/Pausa	<ul style="list-style-type: none">• Reproducir/Parar música o contestar/ finalizar llamada• Larga pulsación para rechazar llamada• 2 veces para pasar de canción• 3 veces para retroceder canción

Indicador

Indicador	Status
Flash azul lento	Reconexión
Flash azul rápido	Emparejamiento
Indicador azul estable	Emparejamiento exitosos
Indicador rojo lento	Baja batería (-15%). Cargue el altavoz

Flash rojo rápido	Baja batería (-2%). Se apagará en 5 segundos
-------------------	--

Reinicio

Si este altavoz tiene algún problema, puede tratar de presionar y mantener "Volumen +" y el botón "Volumen -" simultáneamente durante 5 segundos para reiniciar, y luego volver a vincularlo (eliminar el antiguo emparejamiento en su dispositivo).

Servicio de atención al cliente

- **Garantía limitada de 18 meses**
- **Para preguntas frecuentes y más información, envíe un correo electrónico a:**
support@tribitaudio.com