

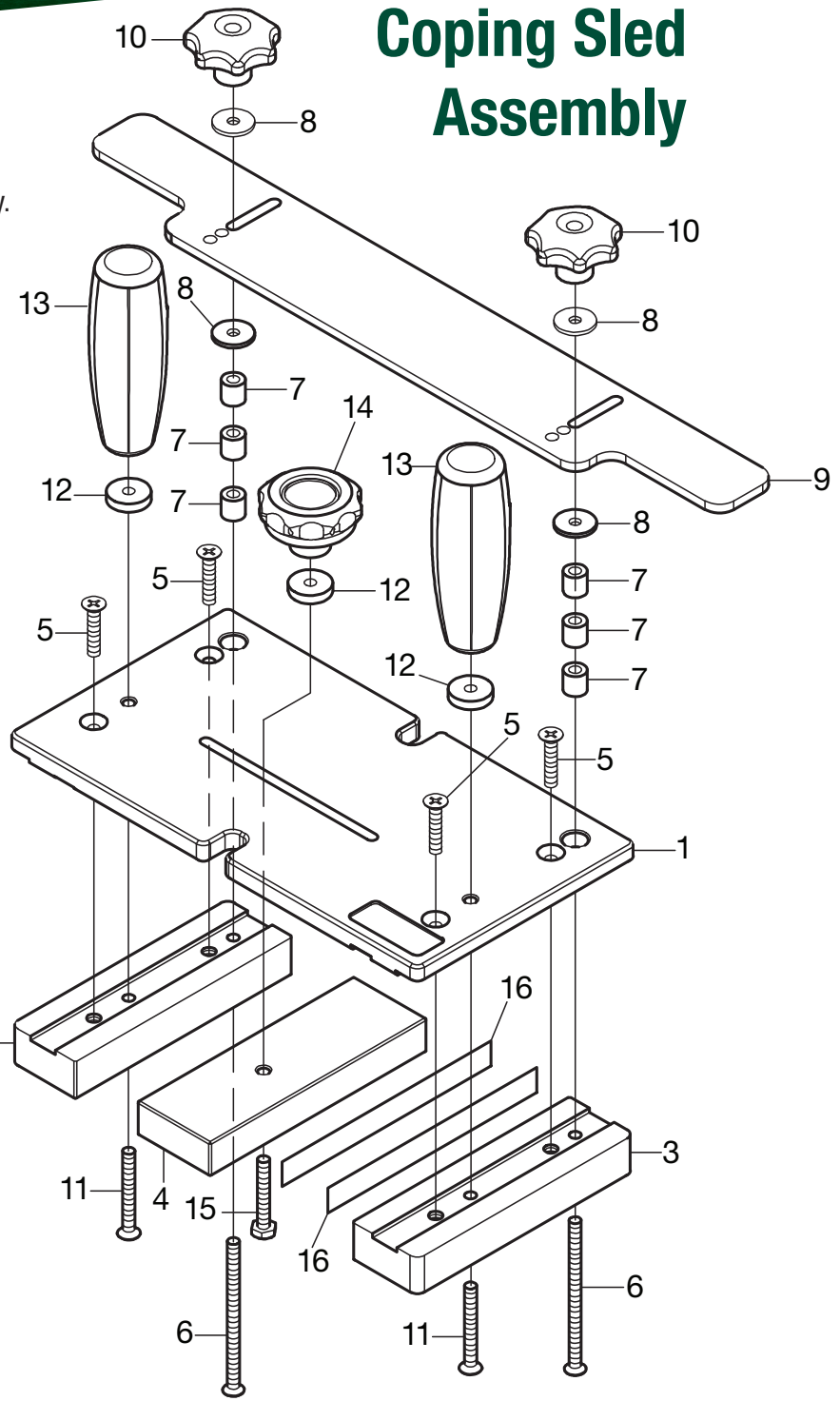

Coping Sled Assembly

Diagram #	Part #	Description	Size	Qty.
1	21310001	Base	-	1
2	21310002	Left Plate	-	1
3	21310003	Right Plate	-	1
4	21310004	Clamping Plate	-	1
5	905M06030	Flathead Screw	M6×30	4
6	905M06102	Flathead Screw	M6×102	2
7	21320007	Spacers Tubes	-	6
8	914M062025A	Nylon Washer	M6	4
9	21310009	Guide	-	1
10	939M06000B-2	Lock Knob	M6	2
11	905M06050	Flathead Screw	M6×50	2
12	914M062205A	Nylon Washer	M6	3
13	939M06015	Handle Knob	M6	2
14	939M06C33S	Lock Knob	M6	1
15	904M06050	Hex Cap Bolt	M6×50	1
16	21320016	Abrasive Strip	M15x145	2



Note: The fit of the Hex Cap Bolt (#15) into the Clamping Plate (#4) is an interference fit. So, during the initial assembly, you will turn the Lock Knob (#14) to pull the Hex Cap Bolt into the countersink hole on the Clamping Plate until it is fully seated.



Friction Strip Application

- 1.** Two 15mm x 145mm 60-grit abrasive strips have been provided to increase material grip on smooth workpieces. These will be applied to the right side of the (4) Clamping Plate and inside of the (3) Right Plate.
- 2.** Disassemble the Coping Sled according to the Parts Diagram on the reverse side of this page to free the (4) Clamping Plate and the (3) Right Plate for application of the Friction Strip.
- 3.** Peel and fold the backing from one of the abrasive strips, and center the strip on the inside face of the (3) Right Plate. Continue to peel the backing from the abrasive strip until it is fully applied to the (3) Right Plate. Repeat the process for the right side of the (4) Clamping Plate.
- 4.** Reassemble the Coping Sled according to the Parts Diagram on the reverse side of this page.

OPERATION

Always clamp the workpiece between the (4) Clamping Plate and the (3) Right Plate. If you choose to use a backer-board to prevent splintering of the workpiece that should be placed against the (3) Right Plate and the trailing edge of the workpiece. Rout material using the Coping Sled as you would a normal router table operation, feeding from right to left.

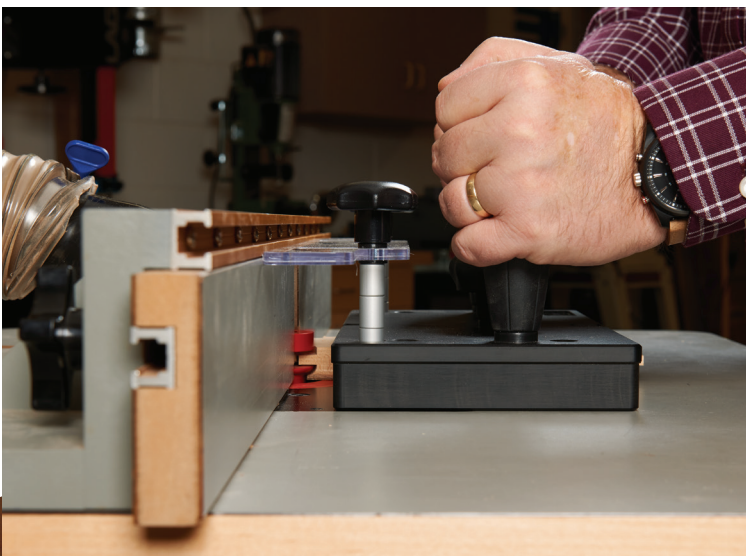

WoodRiver is distributed by Woodcraft Supply, LLC.
For Technical Product Support Call 1-800-535-4486.
For A Free Catalog Or To Find Your Local Woodcraft Store,
Visit woodcraft.com Or Call 800-225-1153.