

## WoodRiver® Pump-N-Grind Pepper Mill Turning Kit

Product #: 159013

12/18/2017



### From Setup To Sanding:

These are the supplies we suggest you have on hand to complete this kit:

- 1" Forstner Bit
- Forstner Bit Extension
- 1¼" x 1¼" x 3<sup>13</sup>/<sub>16</sub>" Blank
- 5 Minute Epoxy
- Sandpaper
- Eye & Ear Protection
- Dust Mask

### Cutting & Drilling Blanks:

Select a hardwood blank or manmade material of your choice and dimension it to 1¼" x 1¼" x 3<sup>13</sup>/<sub>16</sub>". After marking the centers of each end of the blank, mount the blank to the lathe using a 4 jaw scroll chuck and 60° live center. Use the live center to help center the blank. Once the blank has been mounted and secured, using the tailstock and a #1 or #2 MT drill chuck install a 1" forstner bit to bore completely through the blank.

### Mounting the Blank:

From 2" x 2" x 2½" stock create two jamb chucks to fit both ends of the turning blank (see diagram 1). These will be used to turn the body of the grinder. Once the jamb chucks have been turned and snugly fit into the ends of the blank we recommend mounting the material between centers using both a 4 jaw scroll chuck and a 60° cone live center to support the end.

Diagram 1

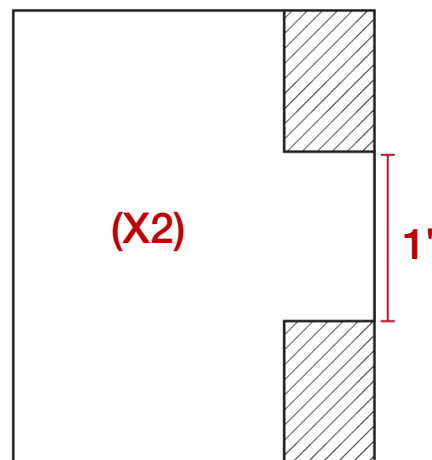

### Turning & Finishing the Blanks:

Once the blank has been properly mounted begin by rough turning the blank round using either a roughing or spindle gouge. Once the blank has been turned completely round begin turning the blank to your desired profile. If your profile incorporates the ends of the turning be flush with the hardware of the grinder the finished diameter should be no smaller than 1.082" or approximately 1<sup>5</sup>/<sub>64</sub>". Once completed sand the turning to 320 grit and apply a durable finish of your choice.

## WoodRiver® Pump-N-Grind Pepper Mill Turning Kit

Product #: 159013

12/18/2017

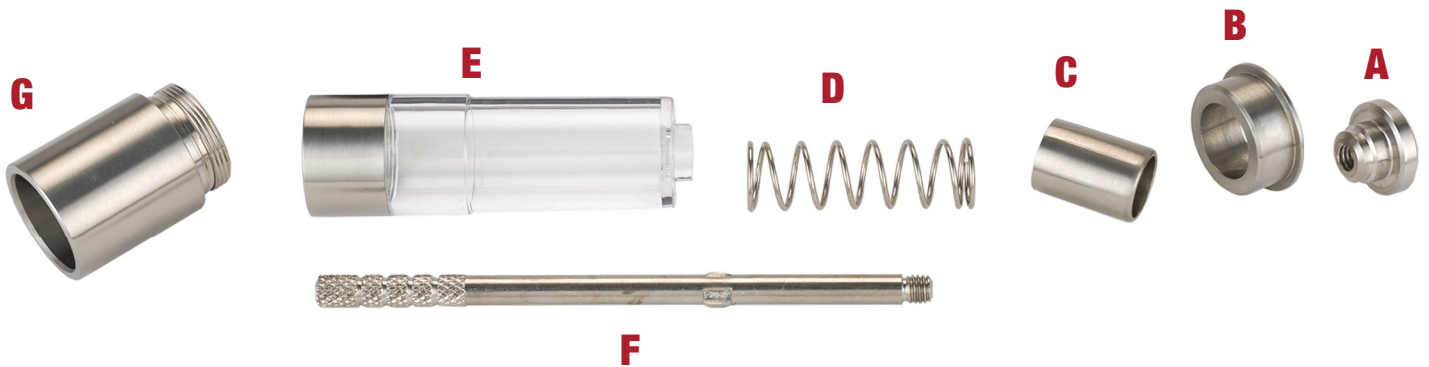

### Assembly:

❑ Unthread the Push Button Assembly consisting of Push Button (A) Spring (D) Trim Collar (C) and remove Trim Ring (B). Set the Push Button Assembly (A, D, C, B) off to the side.

❑ Next unthread the Base (G) and set off to the side with the Push Button Assembly.

❑ Remove the Grinding Rod (F) from the Storage Container (E) and set off to the side.

❑ Mixing up a small amount of epoxy, place a minimal amount around the stainless steel trim ring at the bottom of the Storage Container (E) and slide the lower end of the turning over the top of the container until flush with the bottom of the container. Next apply a minimal amount of epoxy to the outside of the Trim Ring (B) and press into the end of the body. Be sure to clean up any squeeze out that may occur immediately. Let the epoxy cure per the manufacturer's instructions before assembling the grinder.

❑ Once the epoxy has cured insert the Grinding Rod (F) threaded end first through the larger diameter end of the turning followed by threading the Base (G) into place.

❑ Next thread Spring Assembly (A, D, C, B) onto the threaded portion of the Grinding Rod.

❑ To fill the grinder unthread Base (G) and fill the Storage Container (E) followed by threading Base (G) back into place and enjoy freshly ground salt or pepper.