



Installation Instructions for K10611

Alternator and power steering pump bracket for LS truck engines with P-series power steering pump to route the belt below the water pump. Truck or car intake manifold can be used.

Kit contents:

- Mounting plates
- Spacer tubes
- Fasteners
- Idler pulley

Additional parts required:

- Alternator
- GM P-series power steering pump with pulley
- Belt. See chart below.

AC bracket being used	Belt when using "large" alternator	Belt when using "small" alternator
Kwik Performance K10291	89-1/2" K060888	88-1/8" K060875
Kwik Performance K10472	98-5/8" K060980	97-5/8" K060970
None. Use truck factory tensioner and water pump	79" K060785	78" K060775
None. Use LS3 Camaro factory tensioner and water pump	82-1/8" K060815	80-3/8" K060798

Installing the bracket in a crowded engine bay

The following pages describe the straight-forward method of installing the bracket onto the engine first, then adding the alternator and power steering pump to the bracket.

However, it may be desirable to do some pre-assembly of the front plate and components before attaching it to the engine. If you chose to do this, you can do steps 4, 5, 6, 7 and 8 first, which will fully attach the pump and idler to only the front plate itself. You can then go back to step 1 and begin adding the components to the engine.

Determining the alternator size

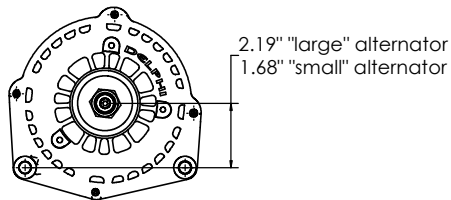

P-series power steering pump preparation

1. Using the proper tool, remove the pulley from the pump to allow access to the mounting bolts
2. Remove the 2 studs from the rear of the pump.

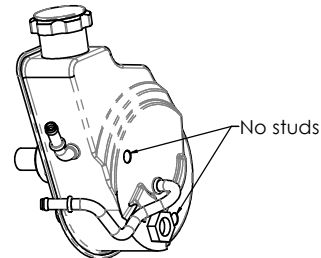

Installation Instructions for K10611

Alternator and P-series power steering pump bracket



1. Install front plate

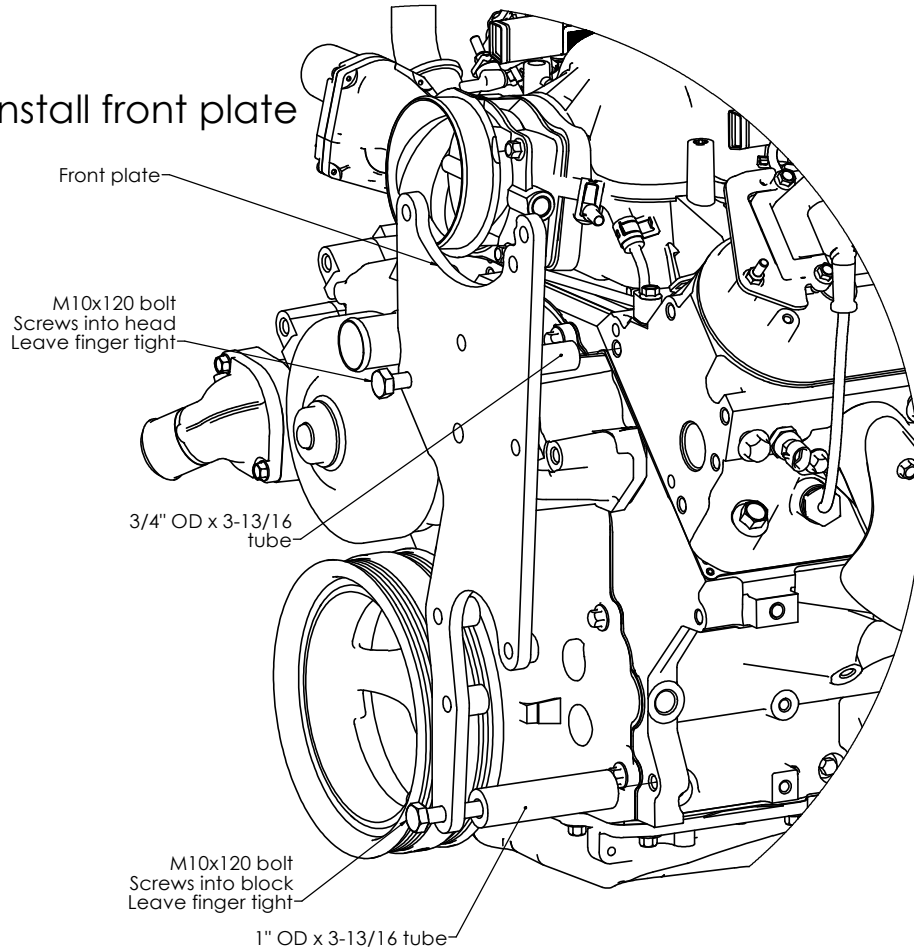

2. Install rear plate

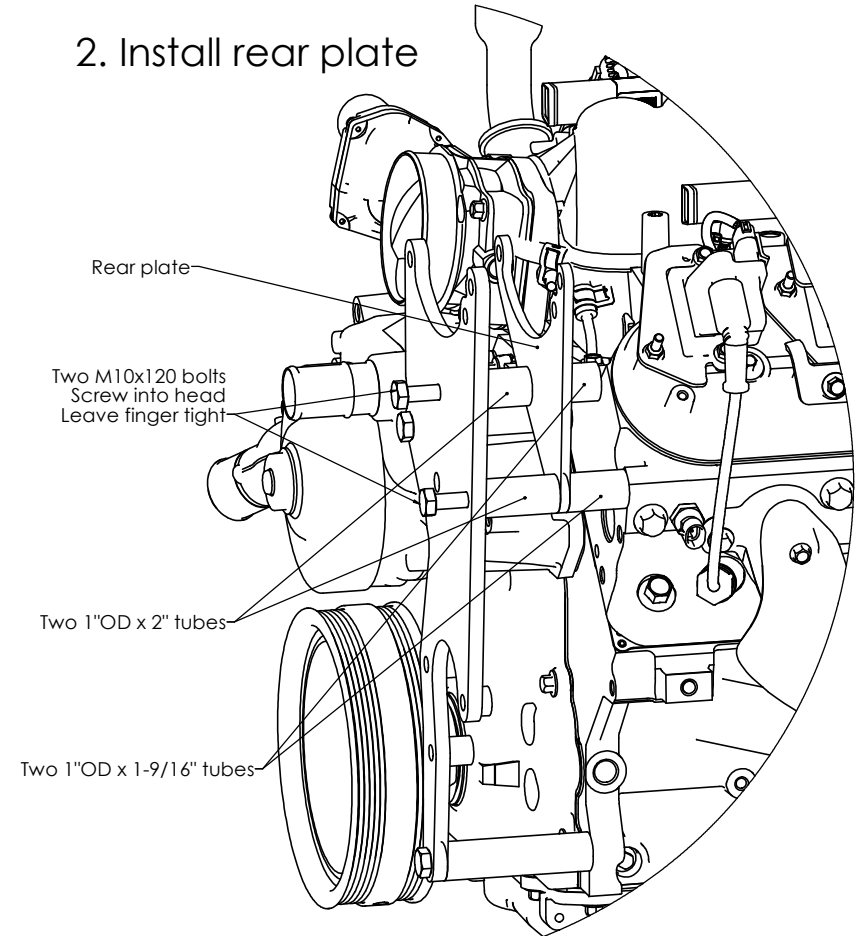

Installation Instructions for K10611

Alternator and P-series power steering pump bracket



3. Install alternator and tighten all 6 bolts to 37 ft-lbs

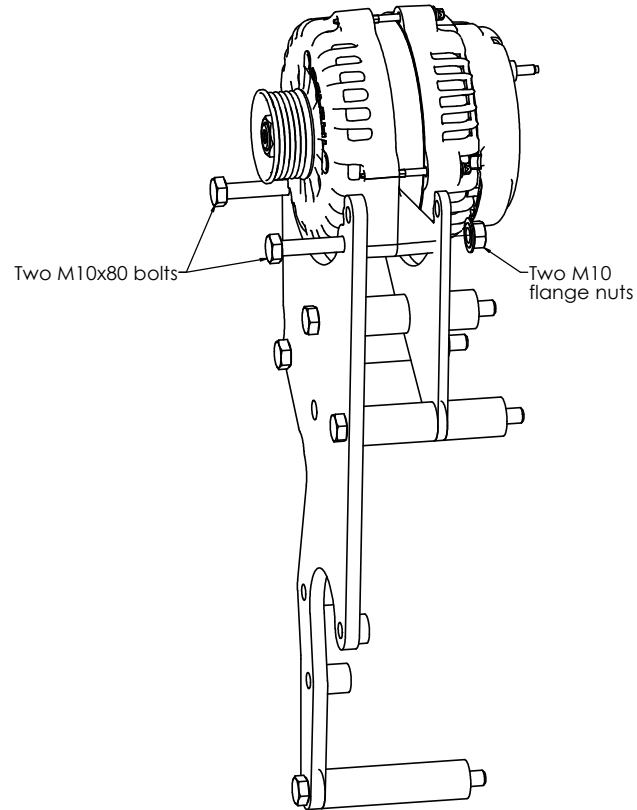

4. Install pump brace

Note: This plate **MUST** be installed before attaching power steering pump.

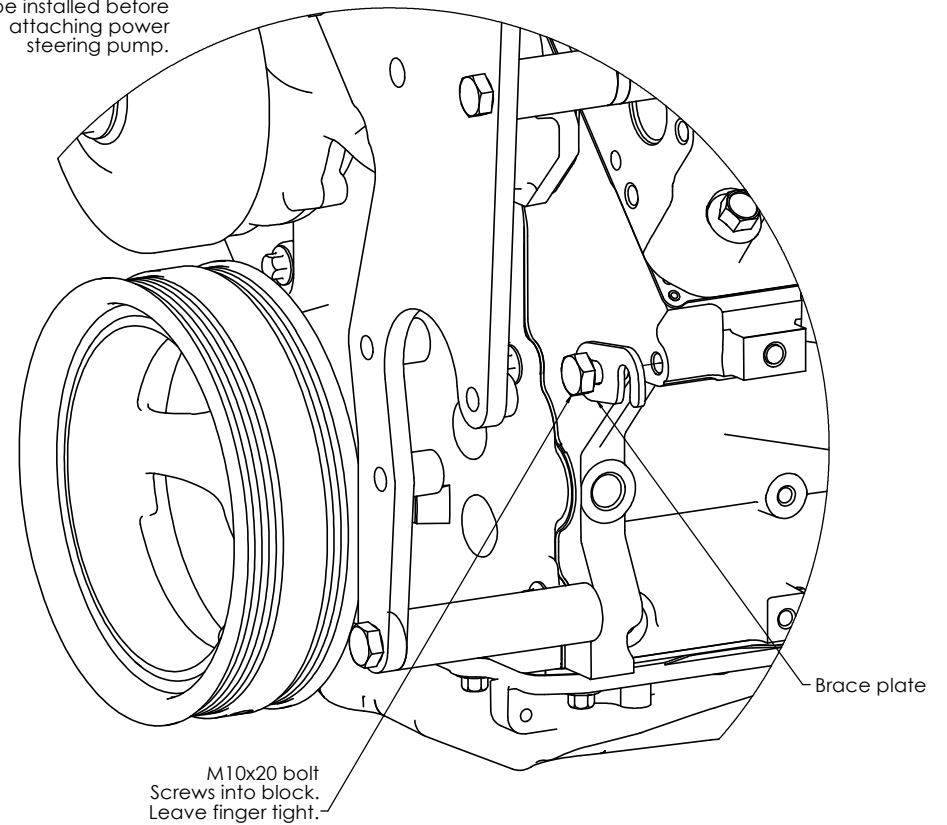

Installation Instructions for K10611

Alternator and P-series power steering pump bracket



5. Install idler pulley and tighten 12mm bolt to 50 ft-lbs

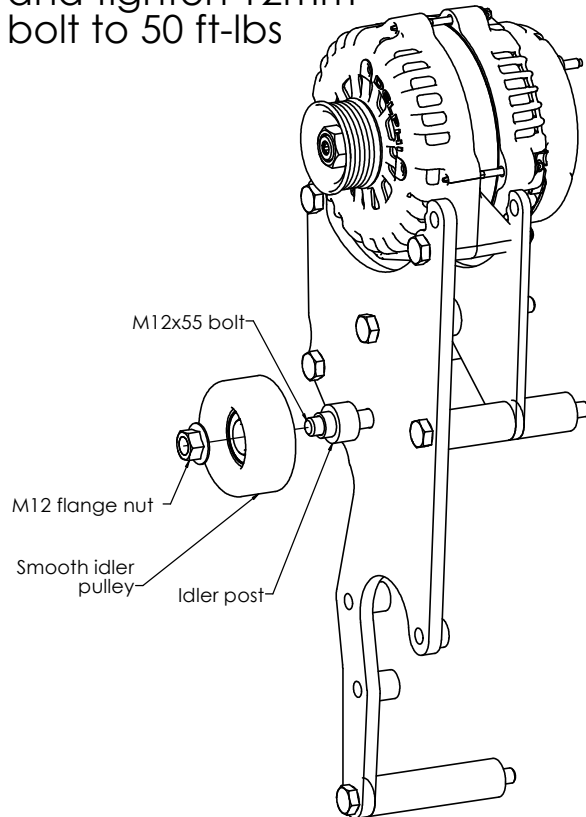

6. Attach power steering pump to front plate

Note: Studs on rear of pump **MUST** be removed before attaching power steering pump. See page 1.

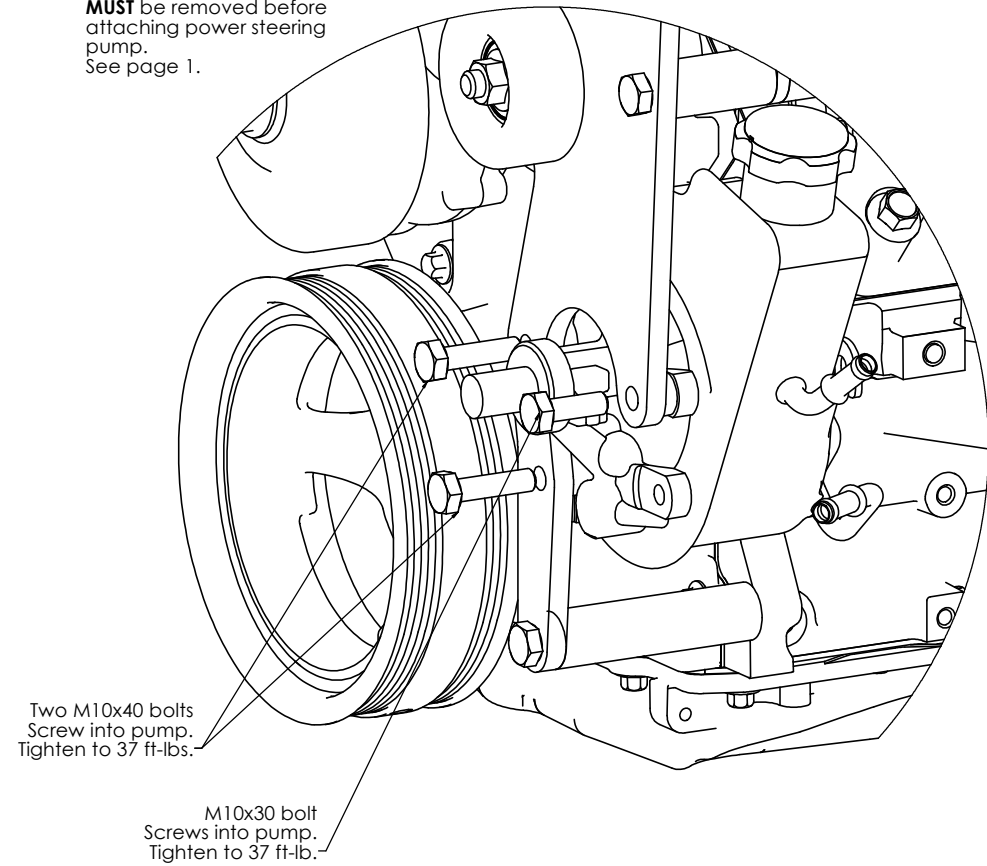

Installation Instructions for K10611

Alternator and P-series power steering pump bracket



7. Attach rear brace to power steering pump

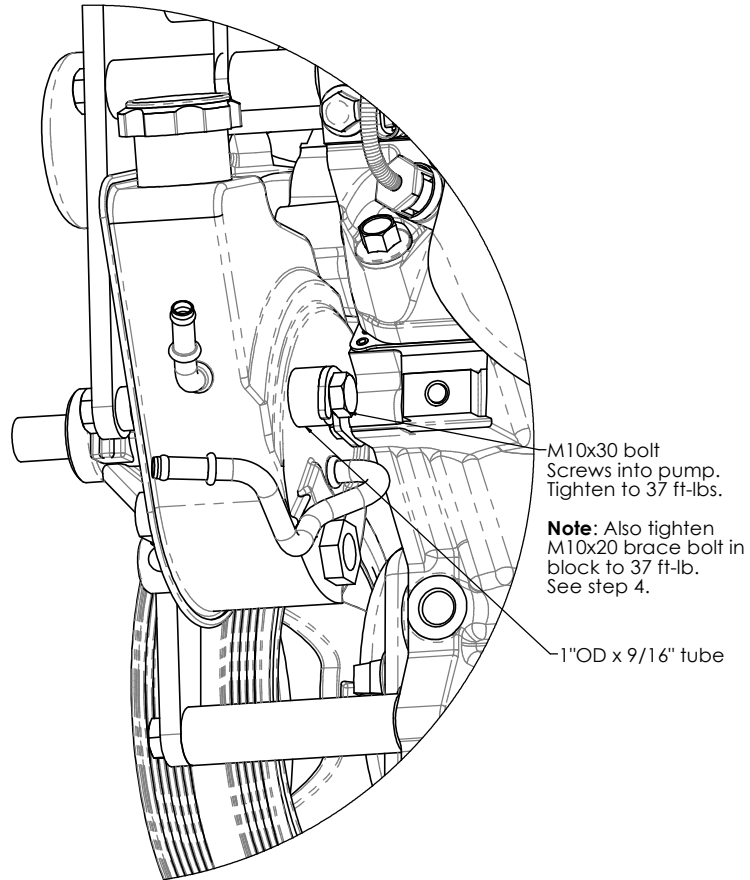

8. Using the proper tool, install the pulley onto the power steering pump

9. On the passenger side of the engine, install the desired AC bracket (K10291 or K10472) or tensioner.

Installation Instructions for K10611

Alternator and P-series power steering pump bracket



10. Install the belt

See page 1 for belt length suggestions.

Note:
Install belt in rear 6 grooves of 7 groove compressor.

Note: For best performance and longest life, the belt lengths suggested by Kwik Performance are the shortest belt that can be reasonably installed.

We recommend the following procedure:

1. When installing the serpentine belt, place the belt around all pulleys as shown in the diagram except for the water pump pulley.
2. Check to see that the belt is in the correct grooves of the AC compressor.
3. Check to make sure that the belt is seated all the way in the grooves of each grooved pulley.
4. Retract the tensioner all the way and slip the belt onto the water pump pulley.
5. Release the tensioner.

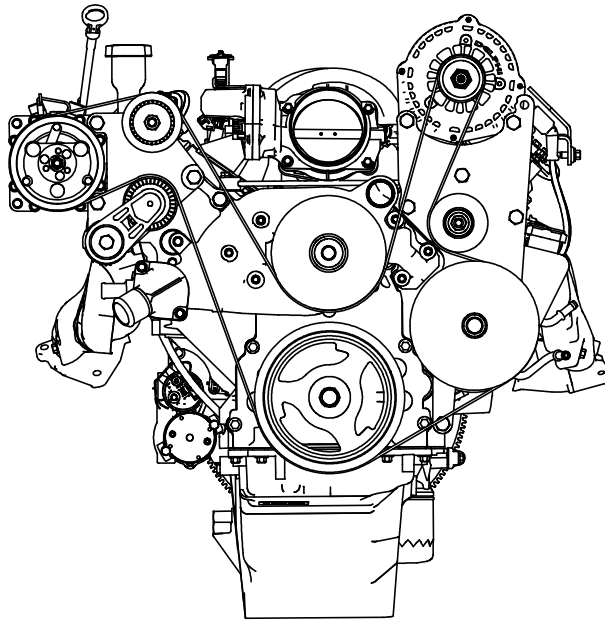

With K10472 AC

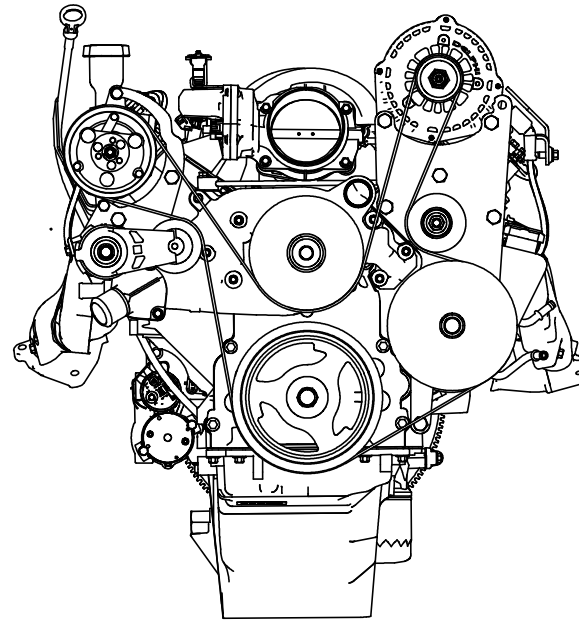

With K10291 AC