

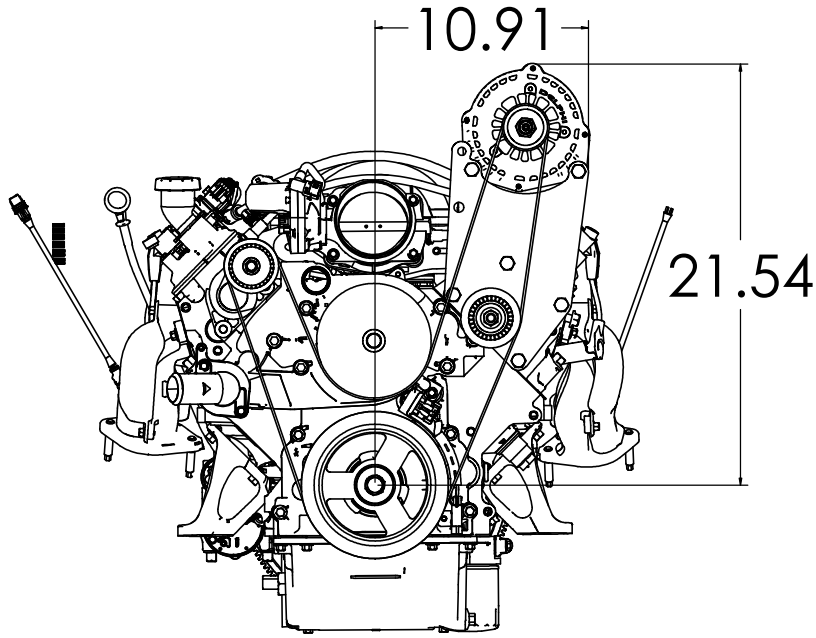

## Installation Instructions for K10182, K10183, & K10184 High-mount Alternator-only Bracket for LS engines



### Kit contents:

- Mounting plates
- Spacer tubes
- Fasteners
- Idler pulley

### Additional parts required:

- Belt. See chart below.
- Alternator
- Factory tensioner or Kwik Performance AC bracket

Suggested belt length and Gates part number			
Kwik Performance alternator only bracket when used with factory tensioner, no AC		Kwik Performance alternator only bracket when used with Kwik Performance AC bracket	
Corvette alternator or "large" alternators	PowerMaster alternators or "small" alternators	Corvette alternator or "large" alternators	PowerMaster alternators or "small" alternators
76" K060755	74-1/2" K060739	85-1/2" K060849	84-3/4" K060842

### Alternator identification

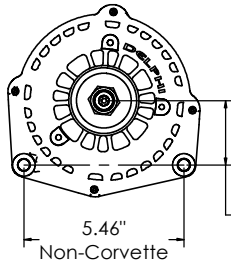
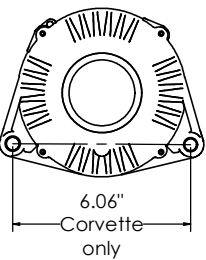

1.68" on "small" alternators  
2.19" on "large" alternators

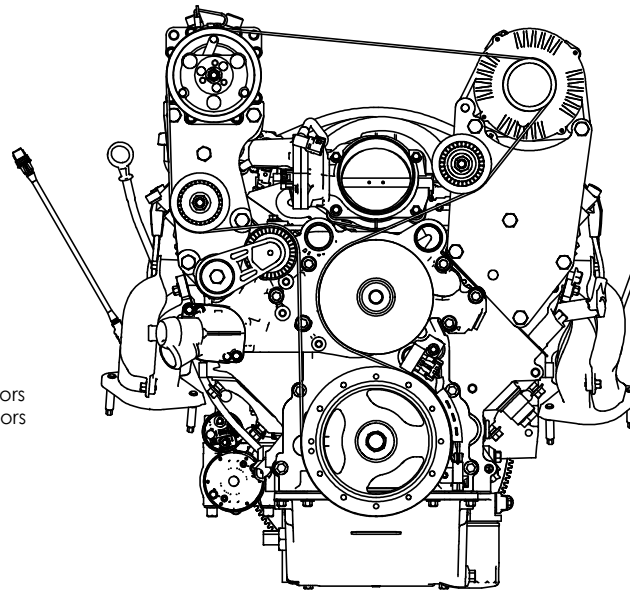

Belt routing with AC bracket

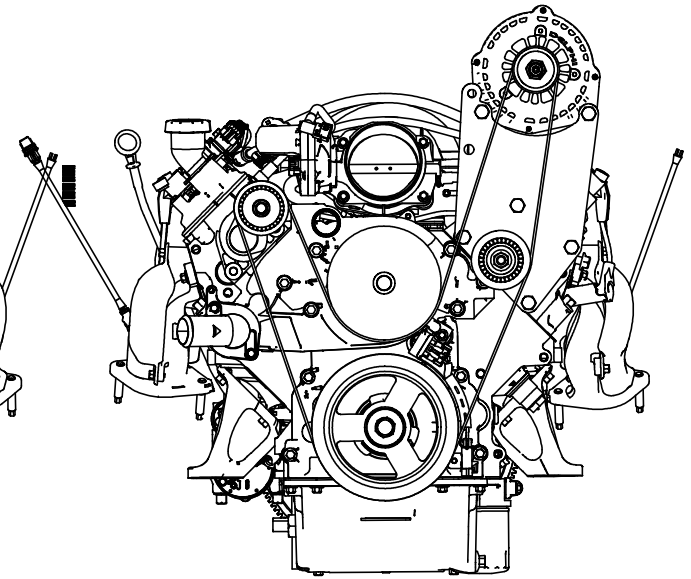

Belt routing without AC bracket

# Installation Instructions Alternator-only high mount bracket for LSx engines

- K10182 for Corvette
- K10183 for Gen 4 F-Body
- K10184 for truck and Gen 5 Camaro



## 1. Mount front plate to engine

Leave all bolts finger tight  
to allow for adjustment

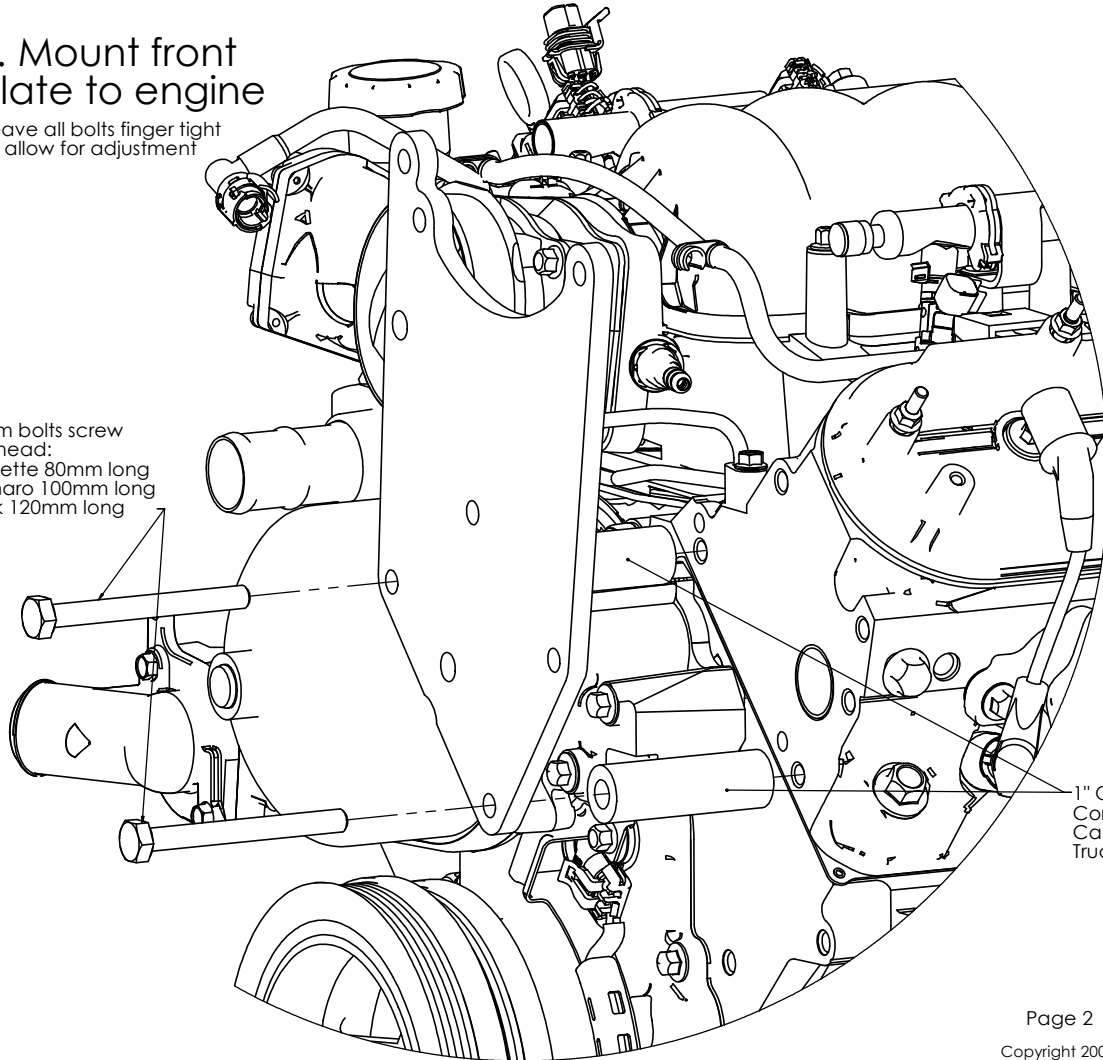

10mm bolts screw  
into head:  
Corvette 80mm long  
Camaro 100mm long  
Truck 120mm long

1" OD tubes:  
Corvette 2 1/4" long  
Camaro 3 1/8" long  
Truck 3 13/16" long

## 2. Mount rear plate to engine

Leave all bolts finger tight  
to allow for adjustment

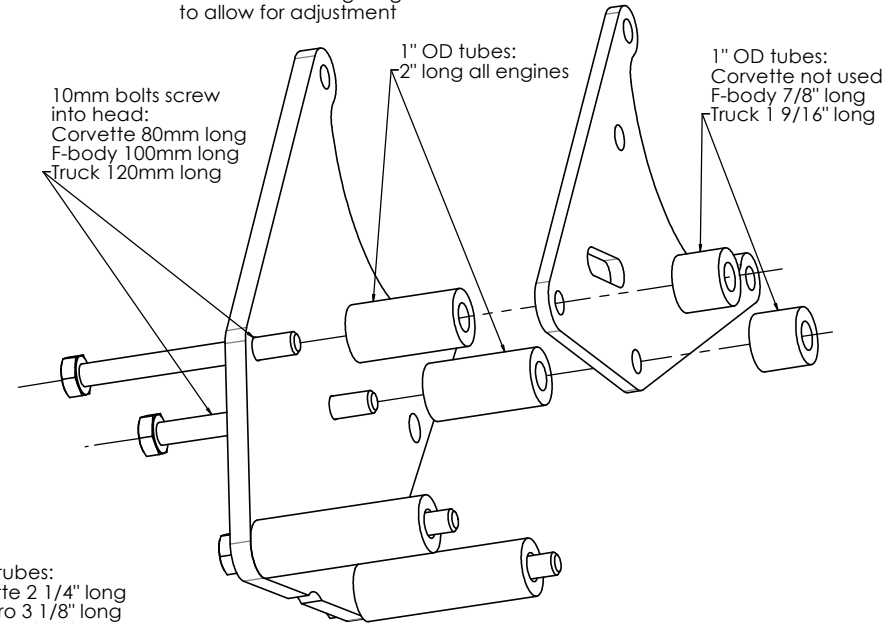

10mm bolts screw  
into head:  
Corvette 80mm long  
F-body 100mm long  
Truck 120mm long

1" OD tubes:  
2" long all engines

1" OD tubes:  
Corvette not used  
F-body 7/8" long  
Truck 1 9/16" long

# Installation Instructions

## Alternator-only high mount bracket for LSx engines

- K10182 for Corvette
- K10183 for Gen 4 F-Body
- K10184 for truck and Gen 5 Camaro



### 3. Mount alternator

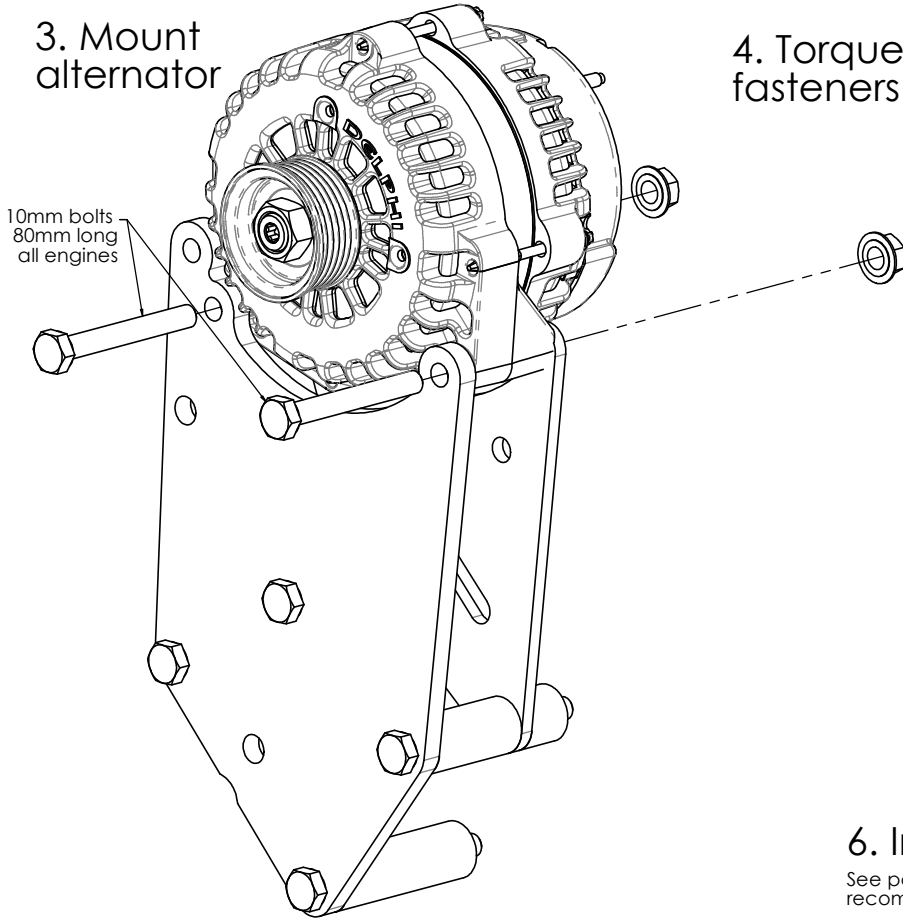

### 4. Torque all 10mm fasteners to 37 ft-lbs

### 5. Mount idler pulley. Torque 12mm nut to 50 ft-lbs

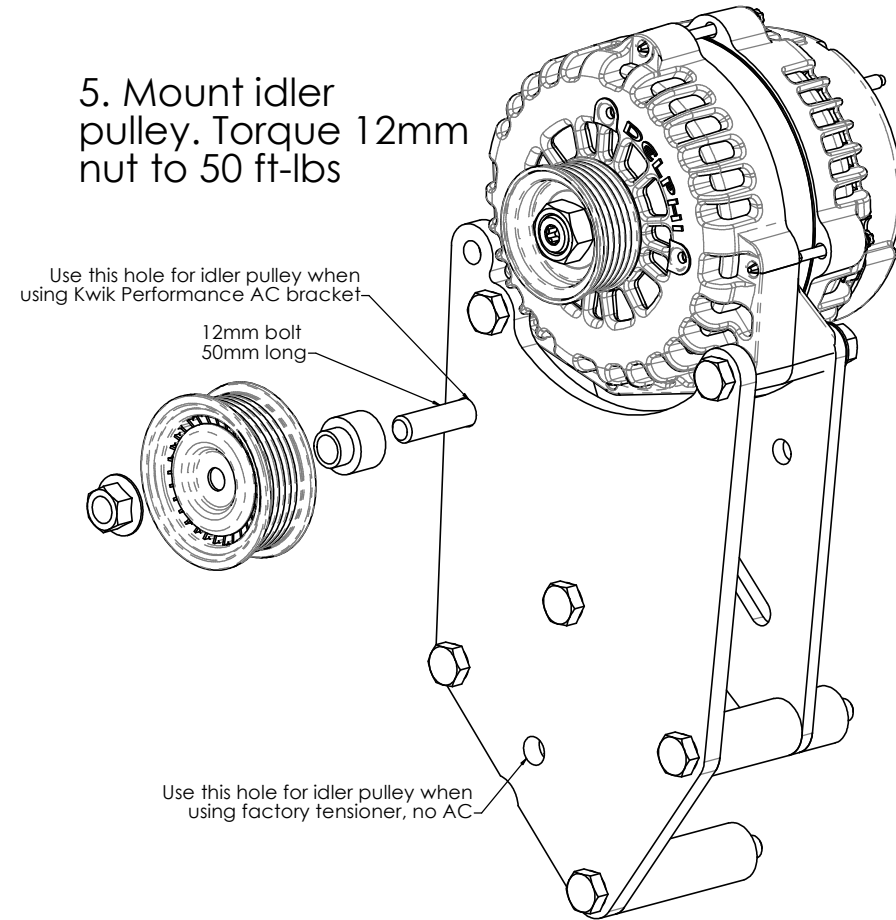

### 6. Install belt

See page 1 for belt length recommendations

Note:  
Install belt in rear 6 grooves of 7 groove compressor.