

# 6S-SLIM

## Assembly Documentation

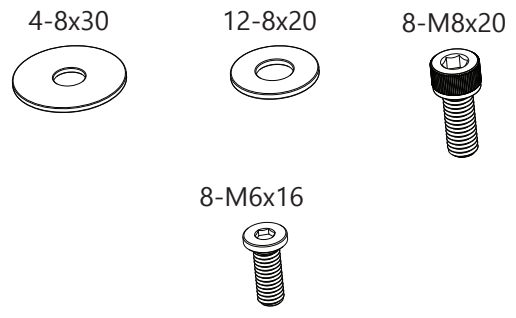

# PARTS

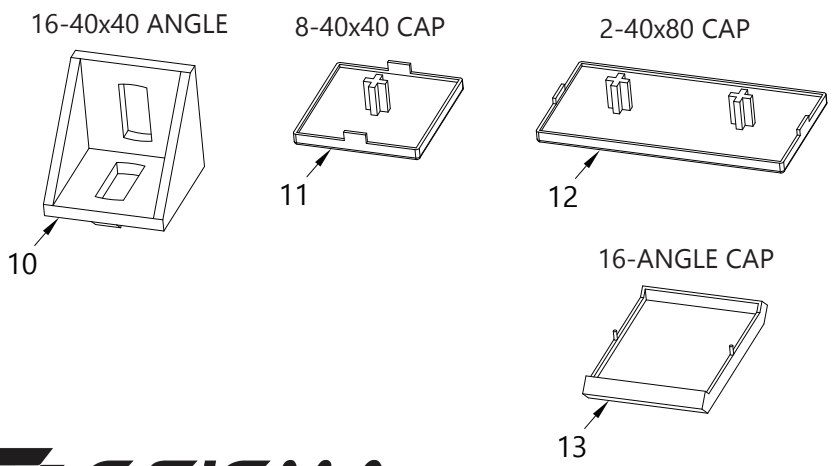
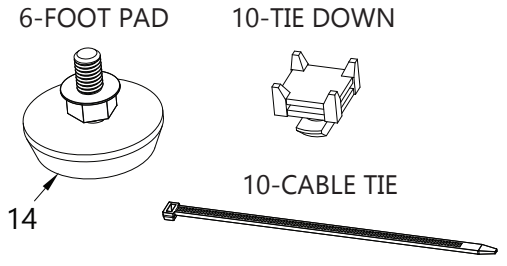
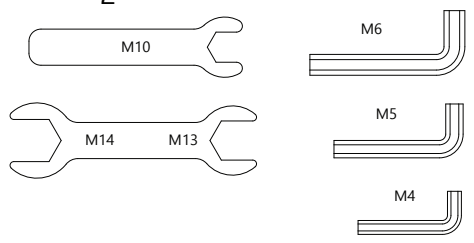
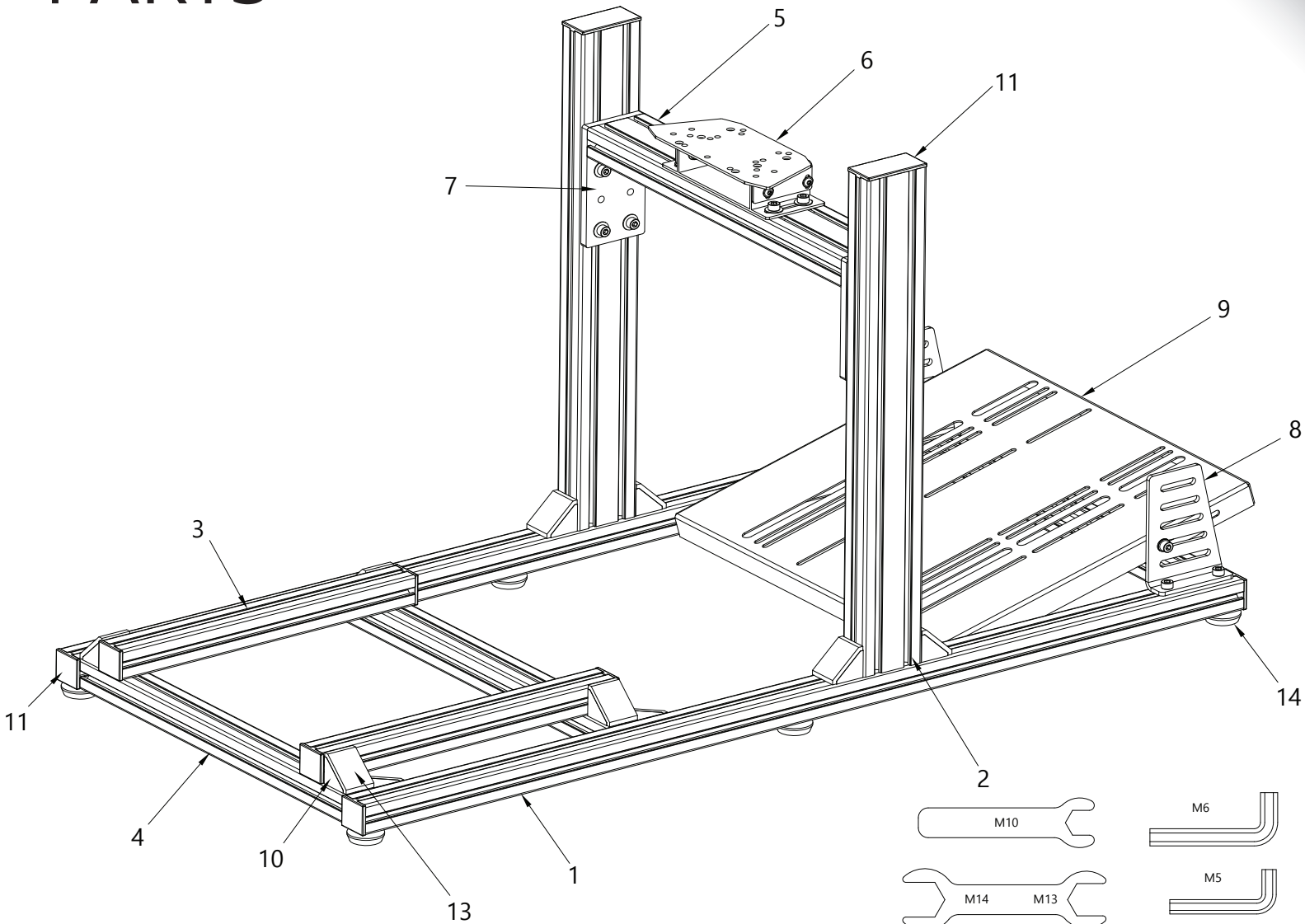

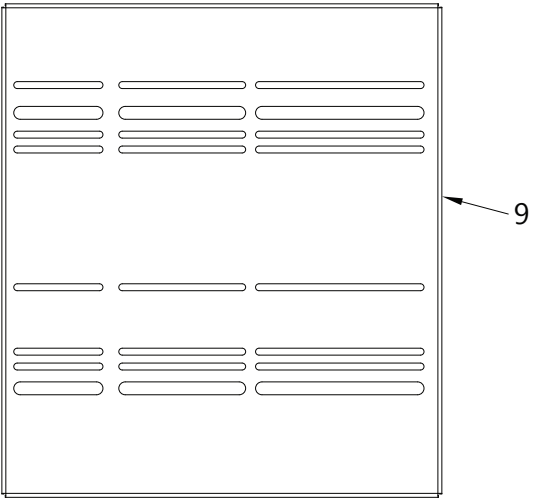
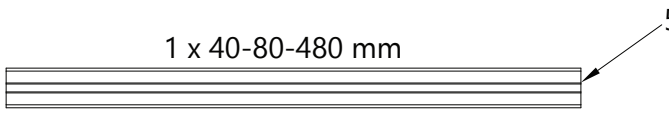
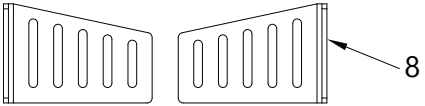
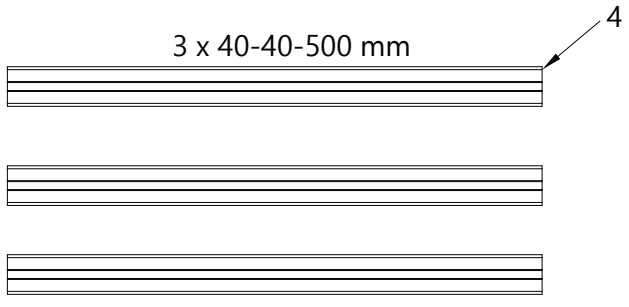
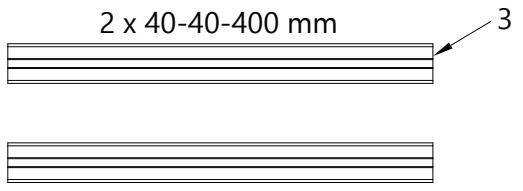
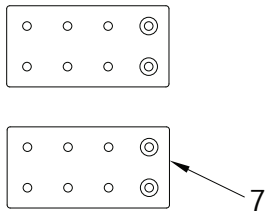
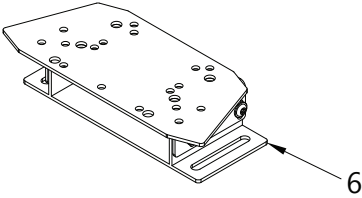
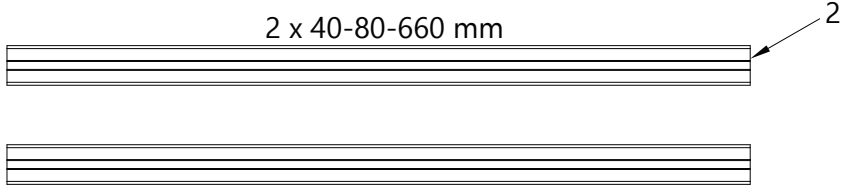
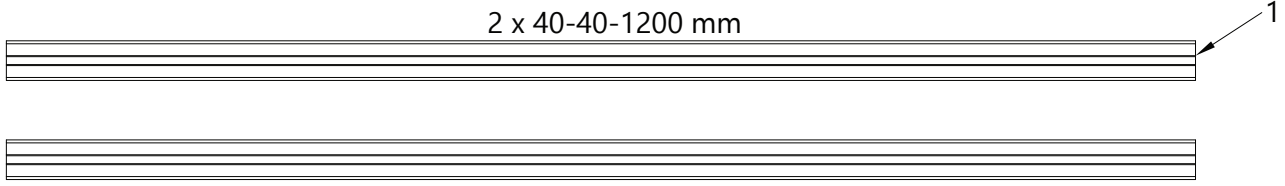

# NOTES

## Safety First

Be mindful of any sharp edges. Use safety goggles whenever removing tabs from angle brackets.



## Protect From Scratches

Hard surfaces can damage the surfaces of the aluminum extrusions.

Use a towel or blanket when assembling on hard surfaces to protect the finishes.

## How to measure screws

Flat head screws are measured based on their overall length.

Socket head cap screws are measured based on the length under the head of the screw.

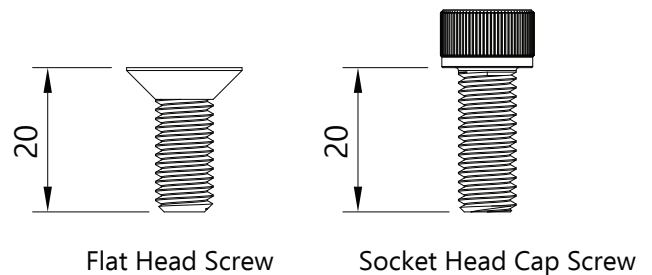

## Metric Conversions

25.4 mm = 1"

16 mm = 5/8"

20 mm = 25/32"

320 mm = 12 5/8"

400 mm = 15 3/4"

480 mm = 18 7/8"

500 mm = 19 11/16"

660 mm = 26"

1200 mm = 47 1/4"

## T-Nut Installation

Be mindful of the order of installation and plan out the insertion of T-nuts.

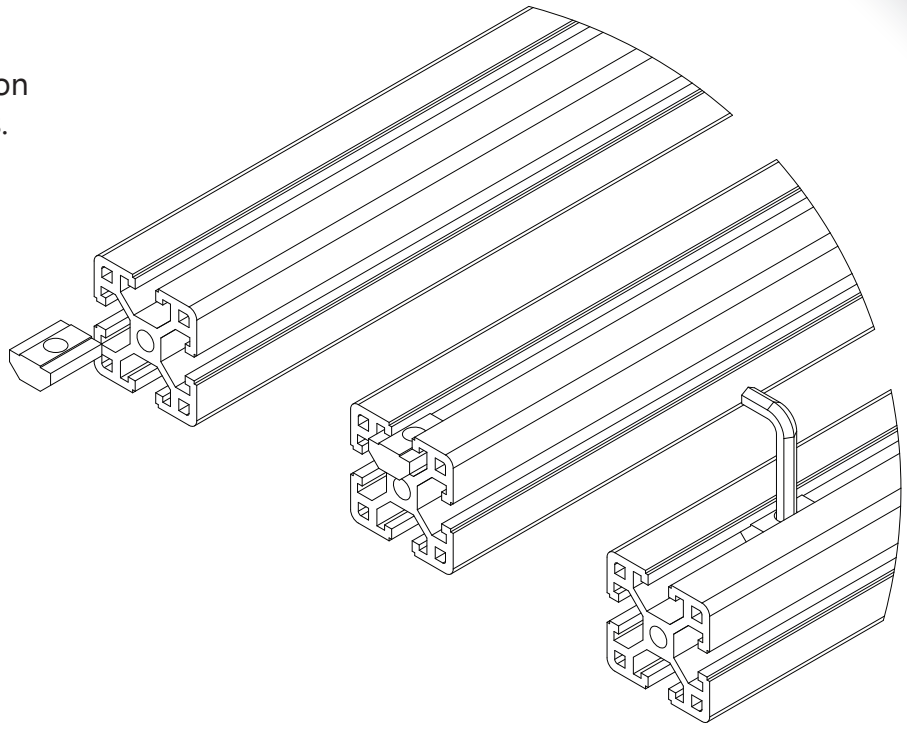

## Alignment Tab Removal

Tabs on brackets may need to be removed if they interfere with the installation of an extrusion as shown to the right.

2 - tabs need to be removed from 4 brackets

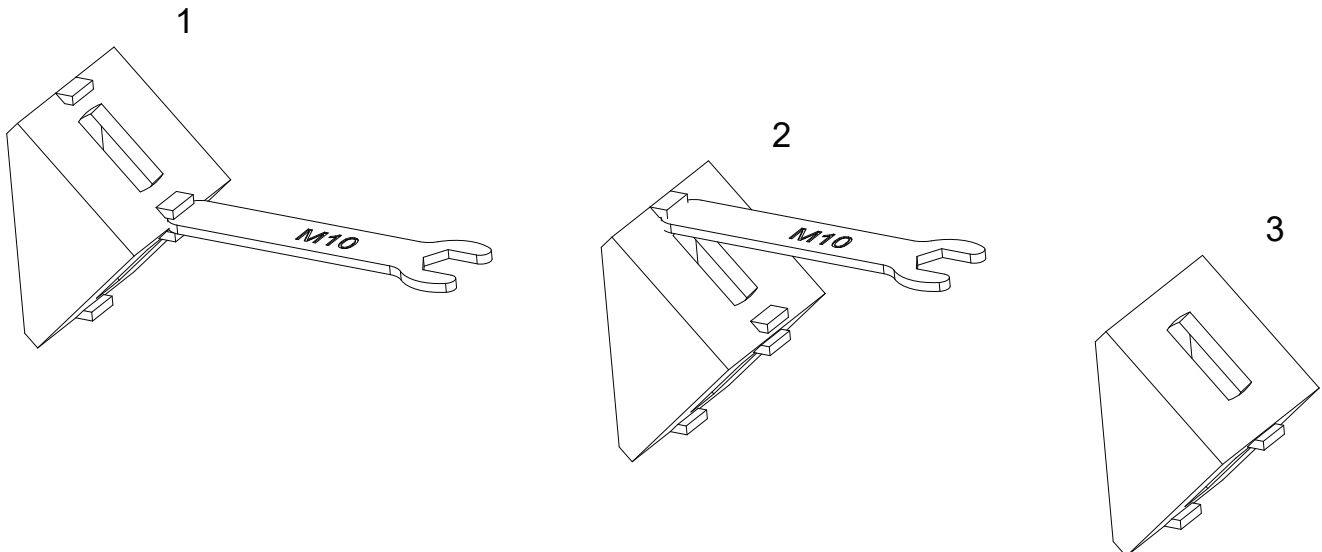
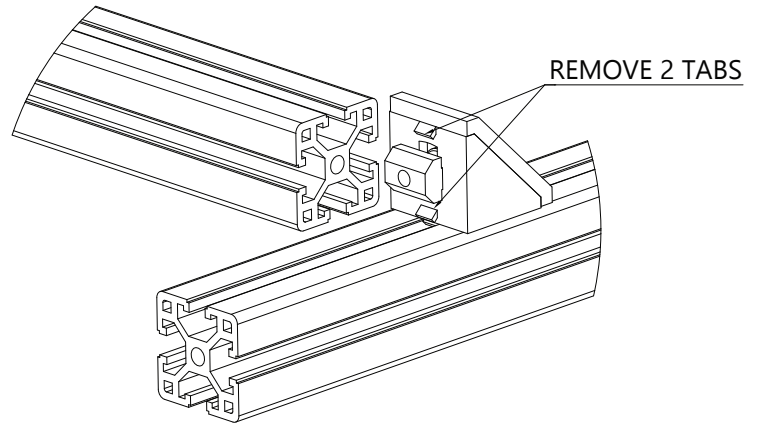

# STEP 1

16-40x40 ANGLE

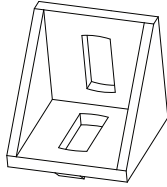

32-M8 T-NUT



32-M8x16



## NOTE:

Leave screws loose enough to slide the T-Nuts into the aluminum extrusion profiles.

x 16

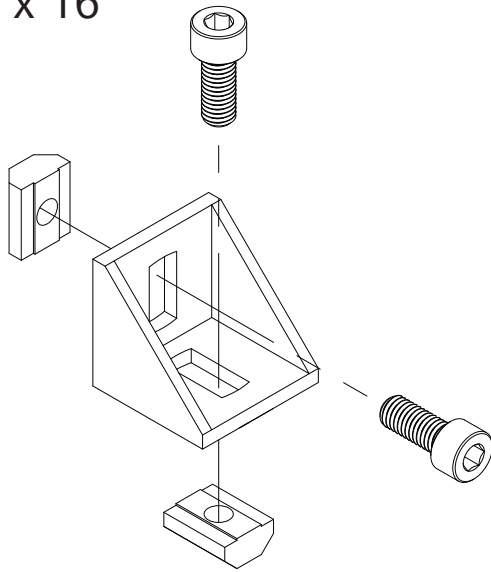

x 12

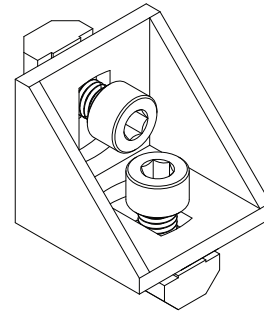

x 4 - TABS REMOVED

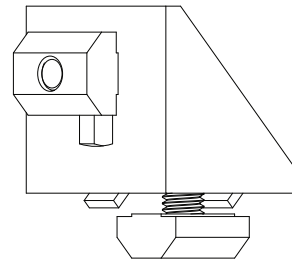

# STEP 2

3-40x40x500

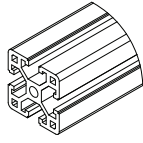

x 4 - TABS REMOVED

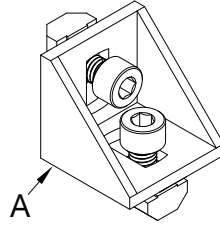

x 6

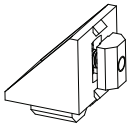
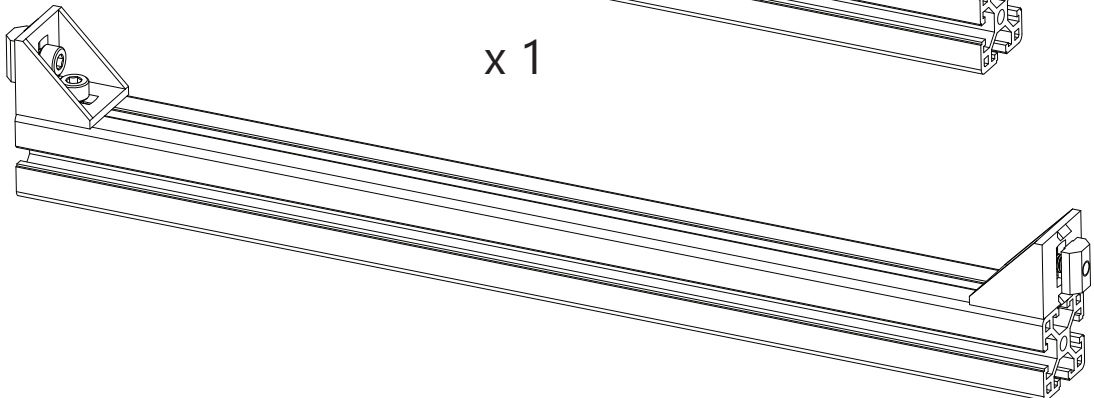
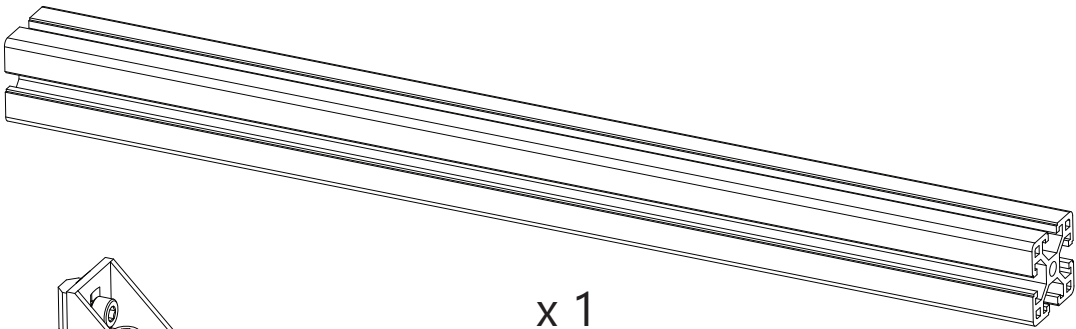
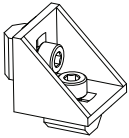
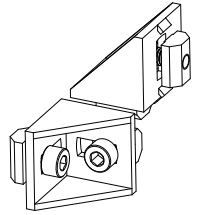
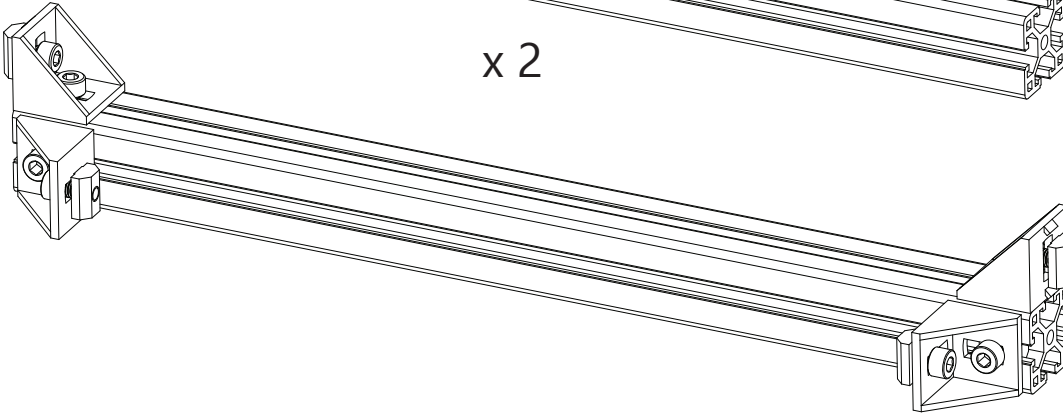
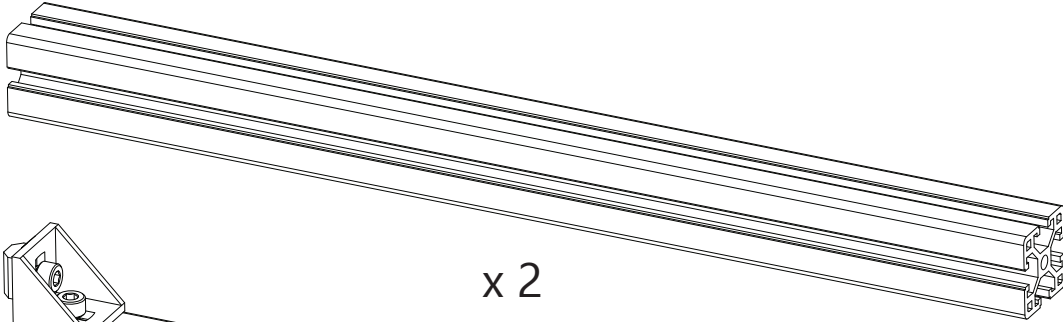
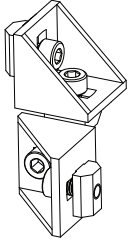
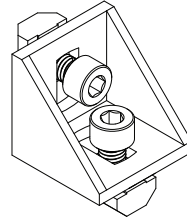

# STEP 3

2-40x40x1200

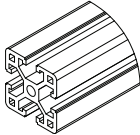

6-FOOT PAD

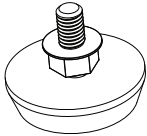

6-M8 T-NUT

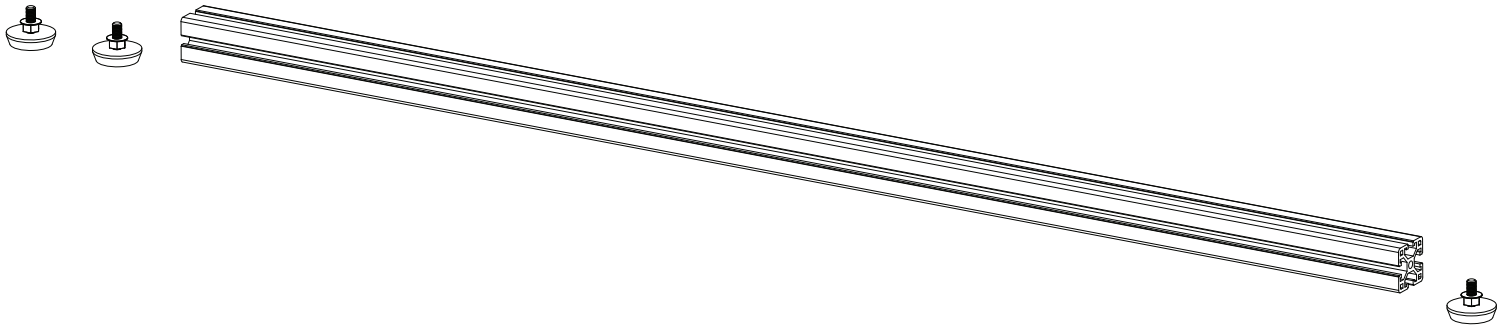
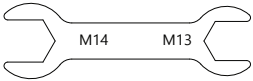

x 2

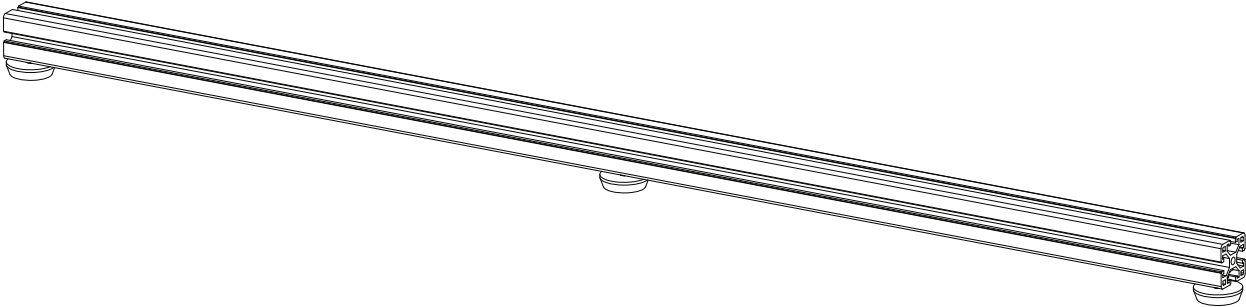



# STEP 4

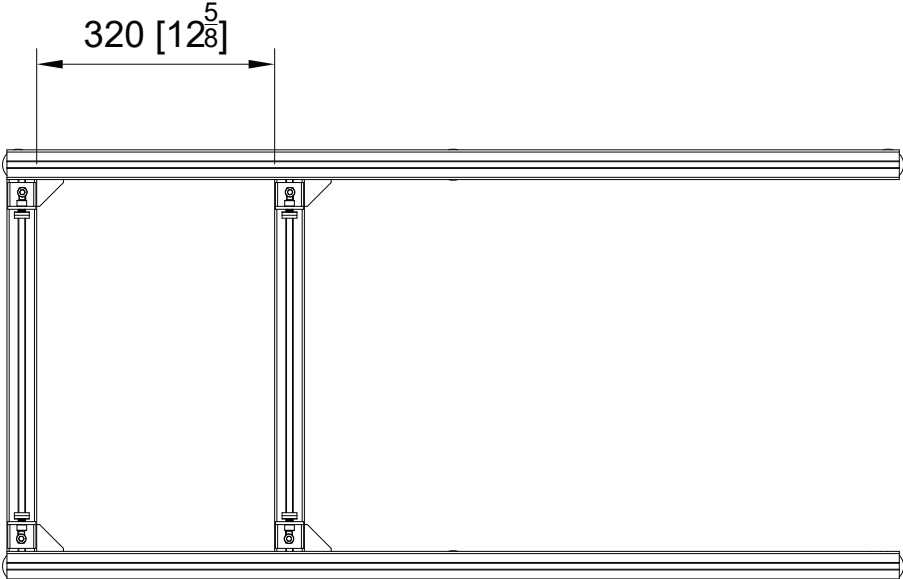
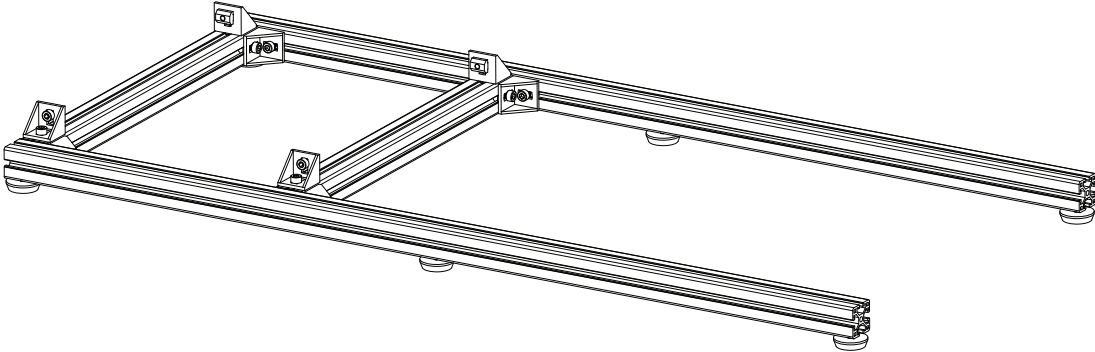
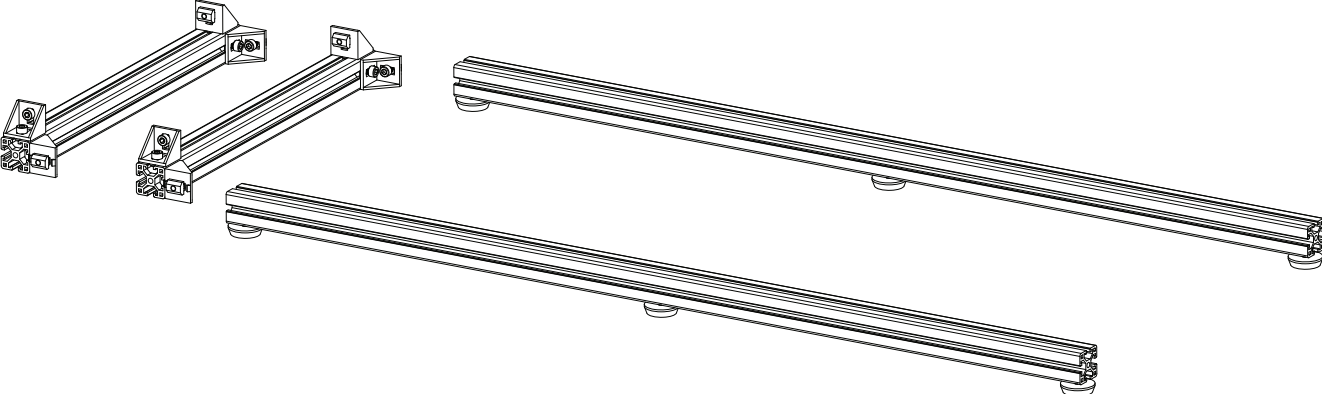

# STEP 5

2-40x40x400

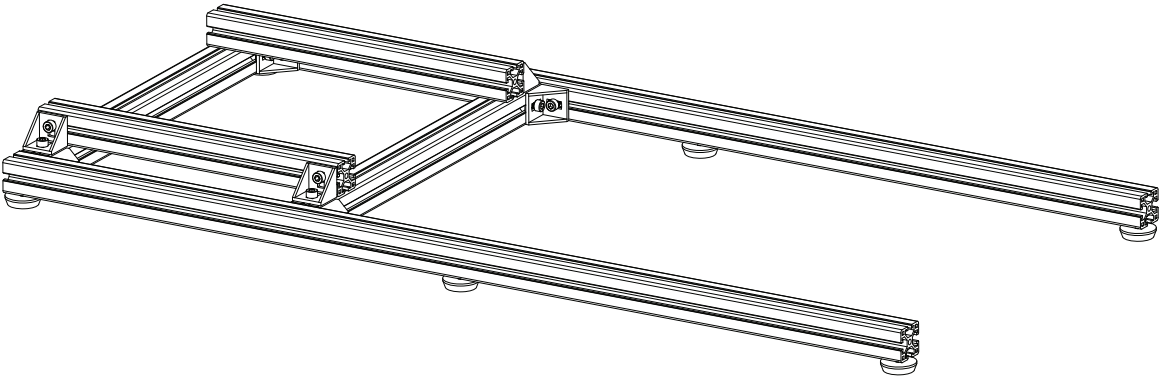
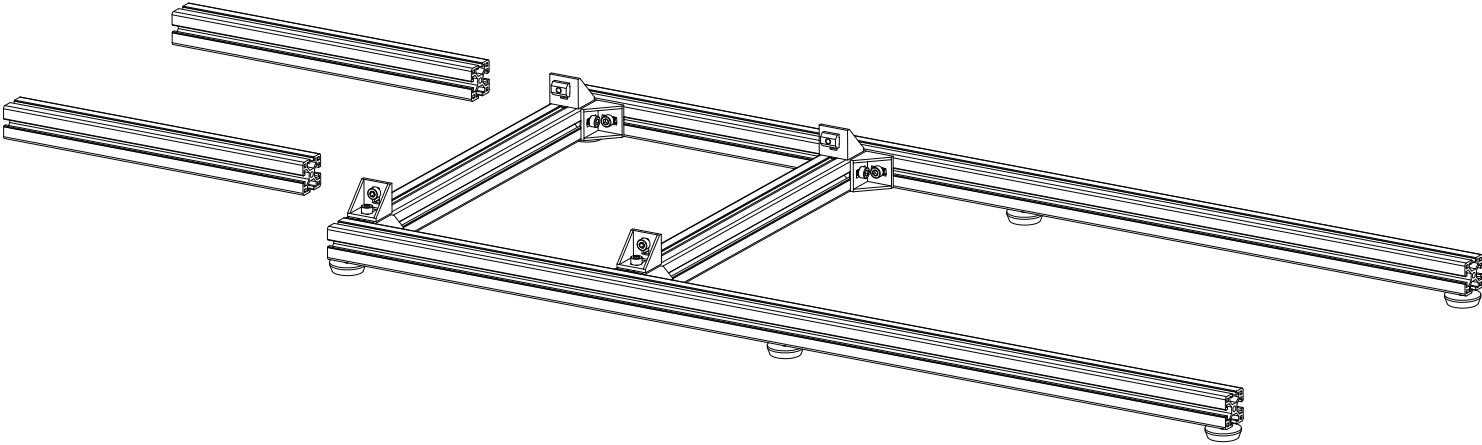
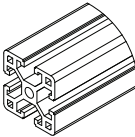

# STEP 6

2-M8 NUT



8-M8 T-NUT



8-M8x20



4-8x30

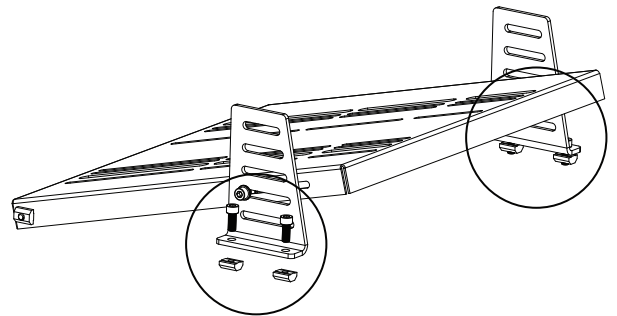
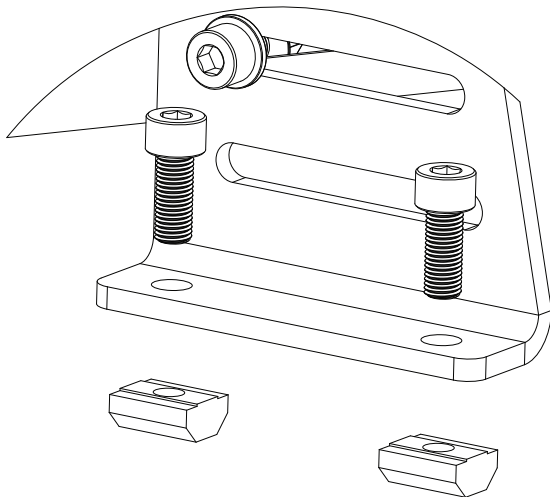
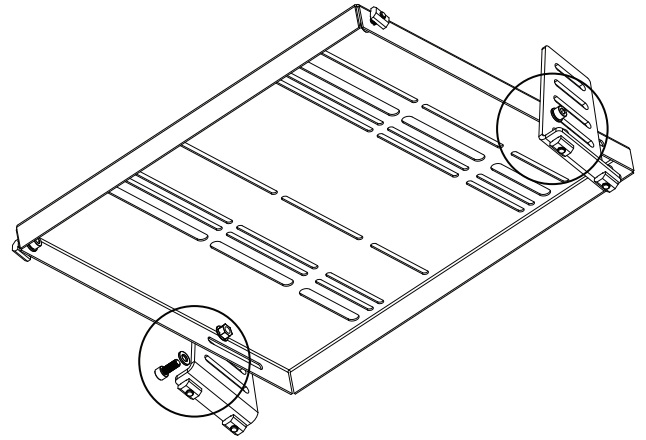
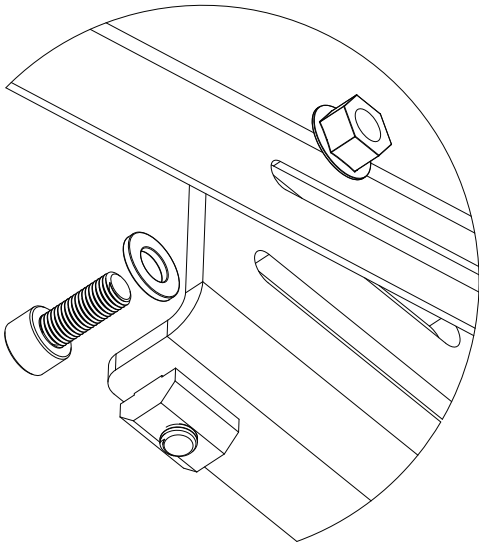
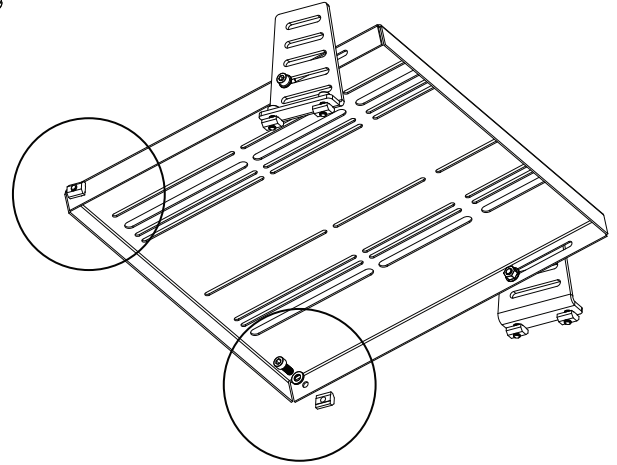
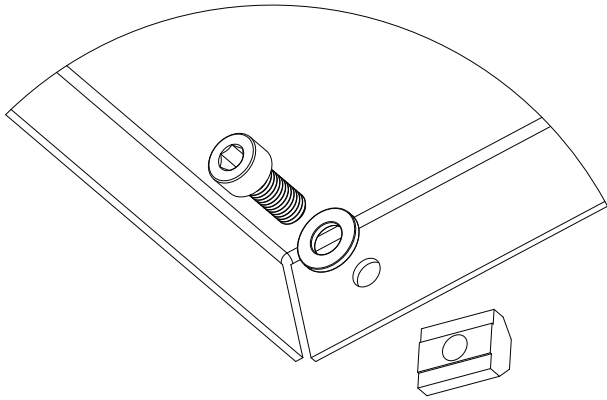
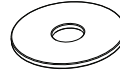

# STEP 7

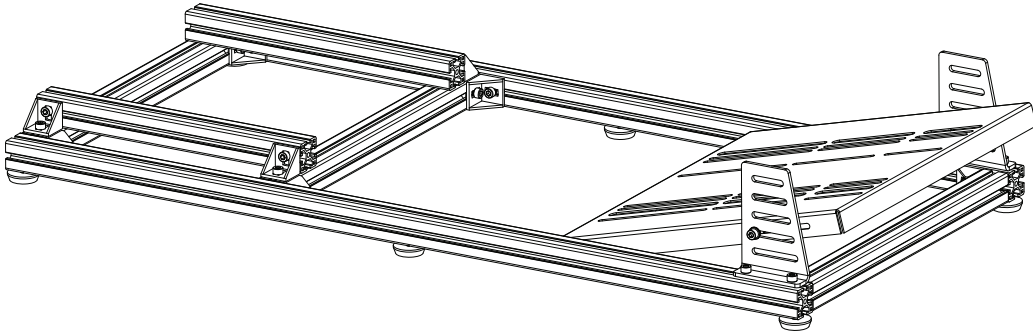
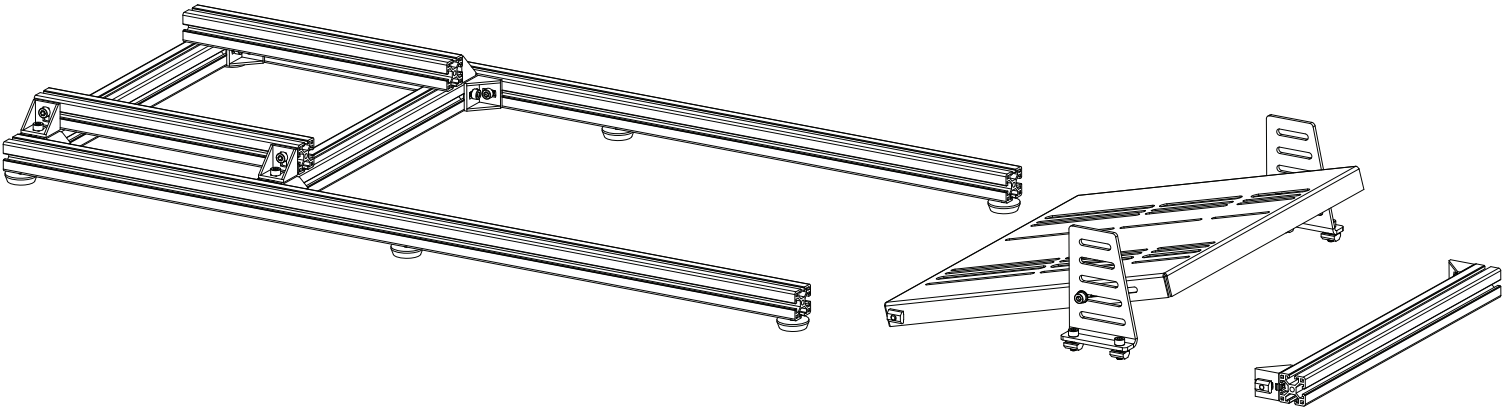

# STEP 8

2-40x80x660

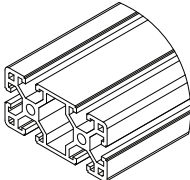

x 4

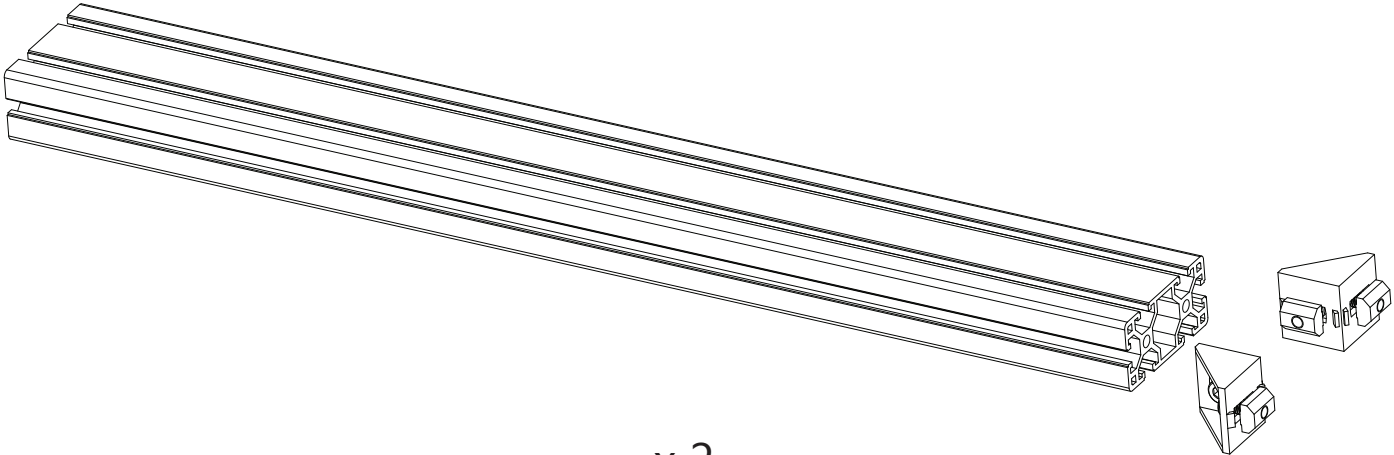
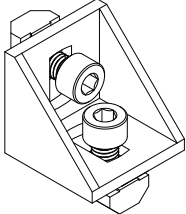

x 2

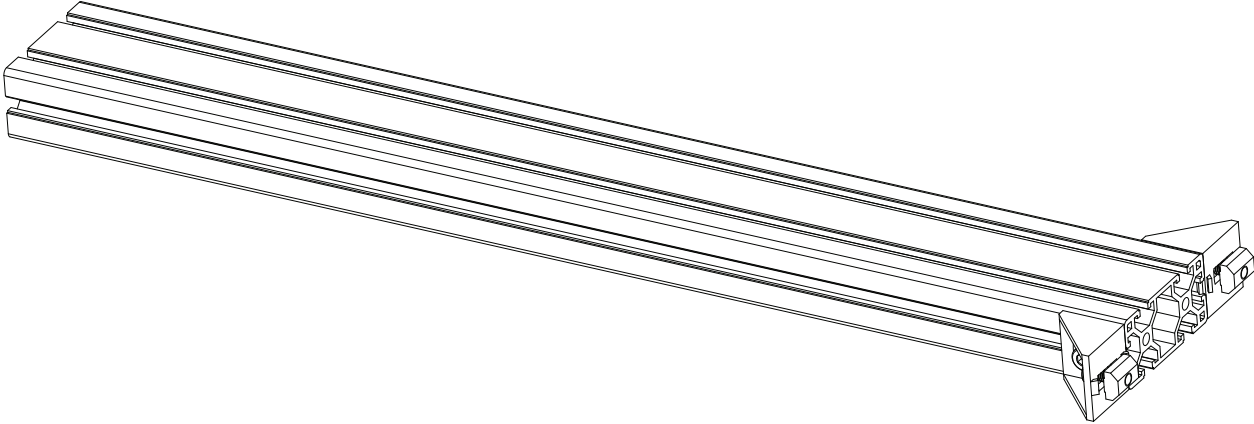

# STEP 9

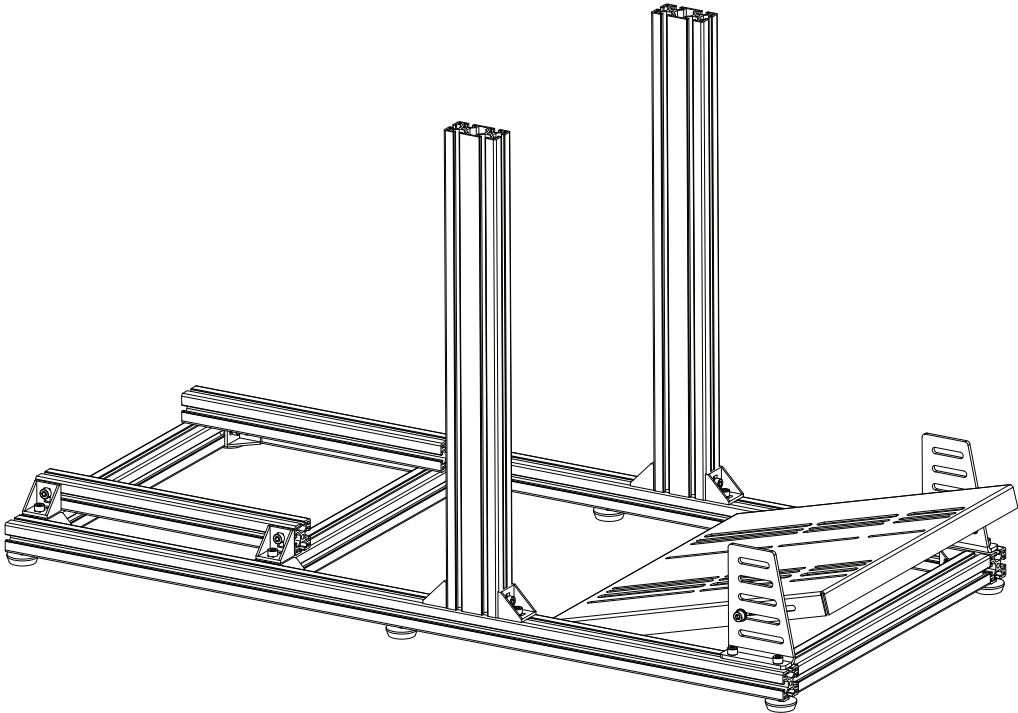
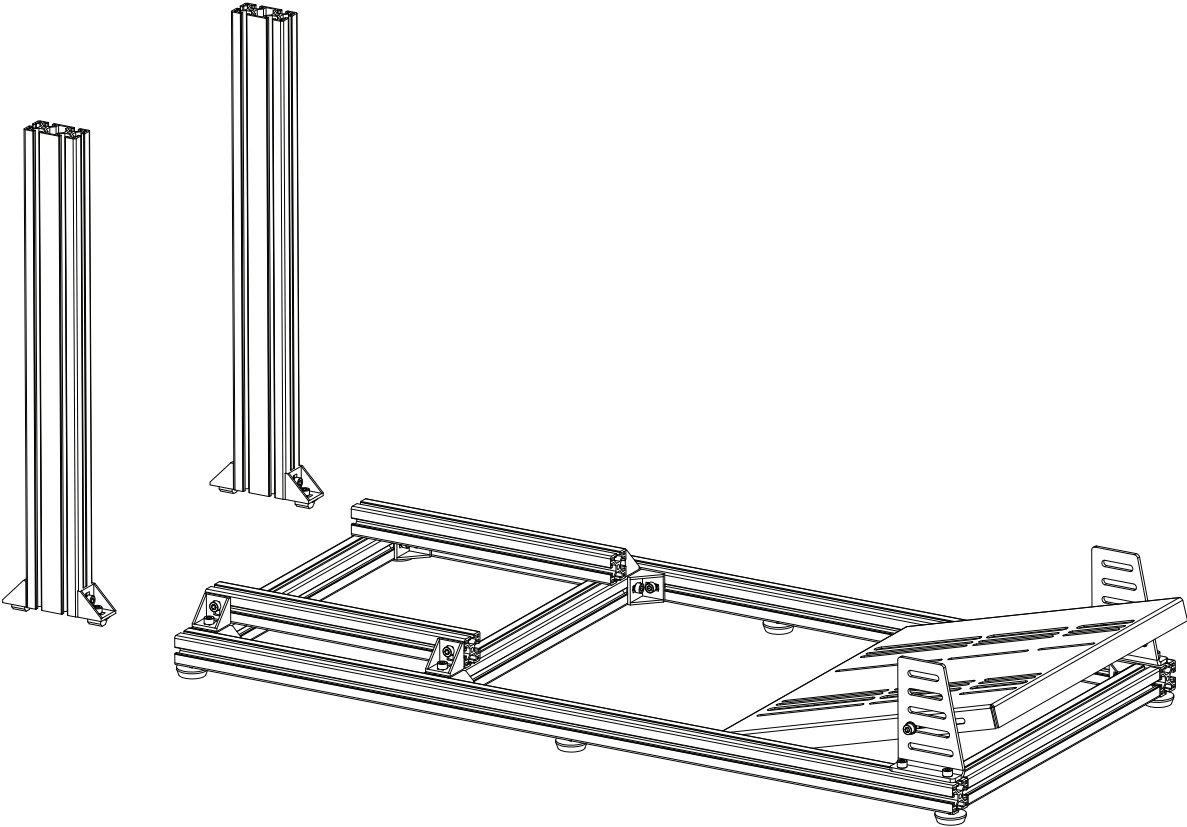

# STEP 10

1-40x80x480

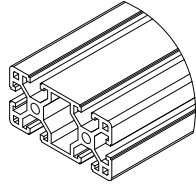

12-M8 T-NUT



4-M8x20



12-8x20



4-M8x12



8-M8x20

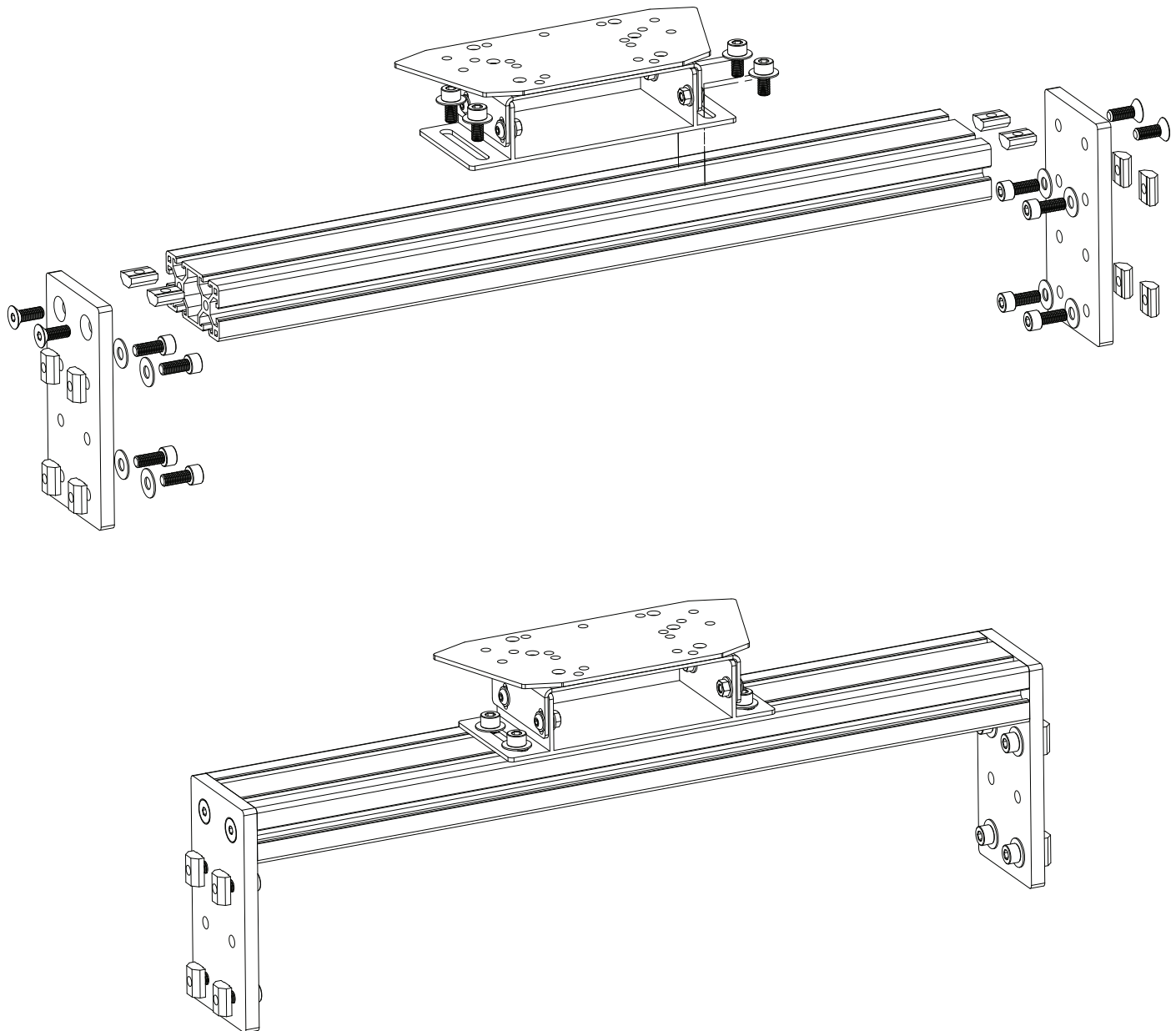

# STEP 11

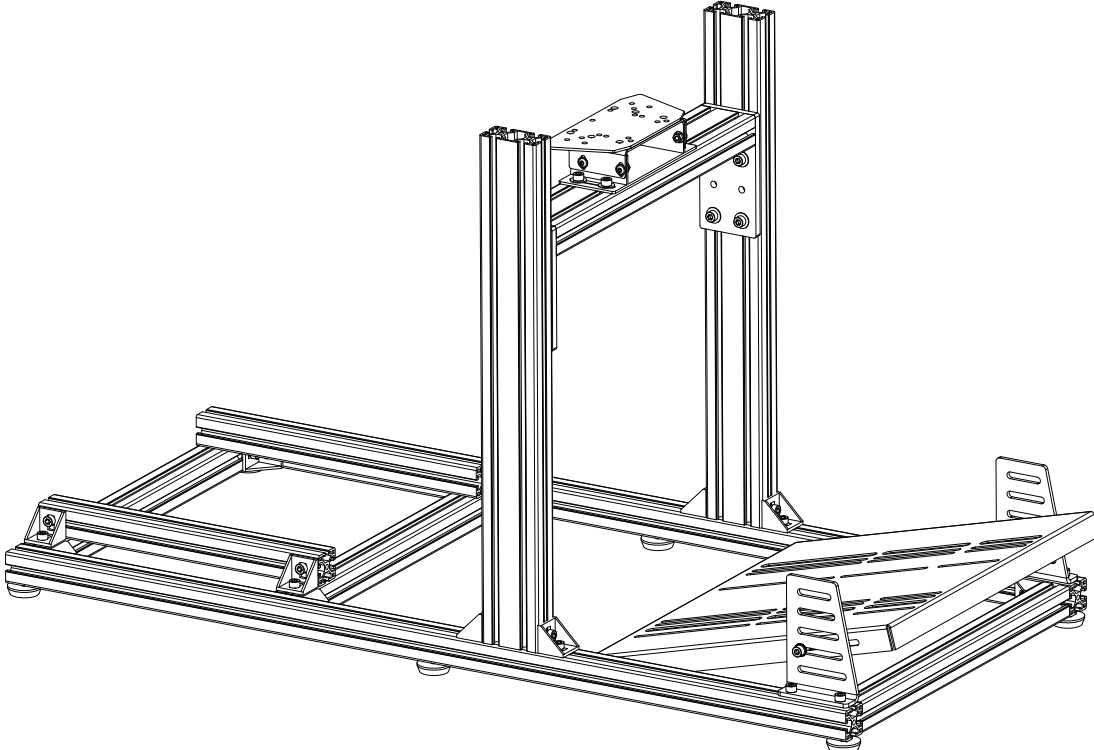
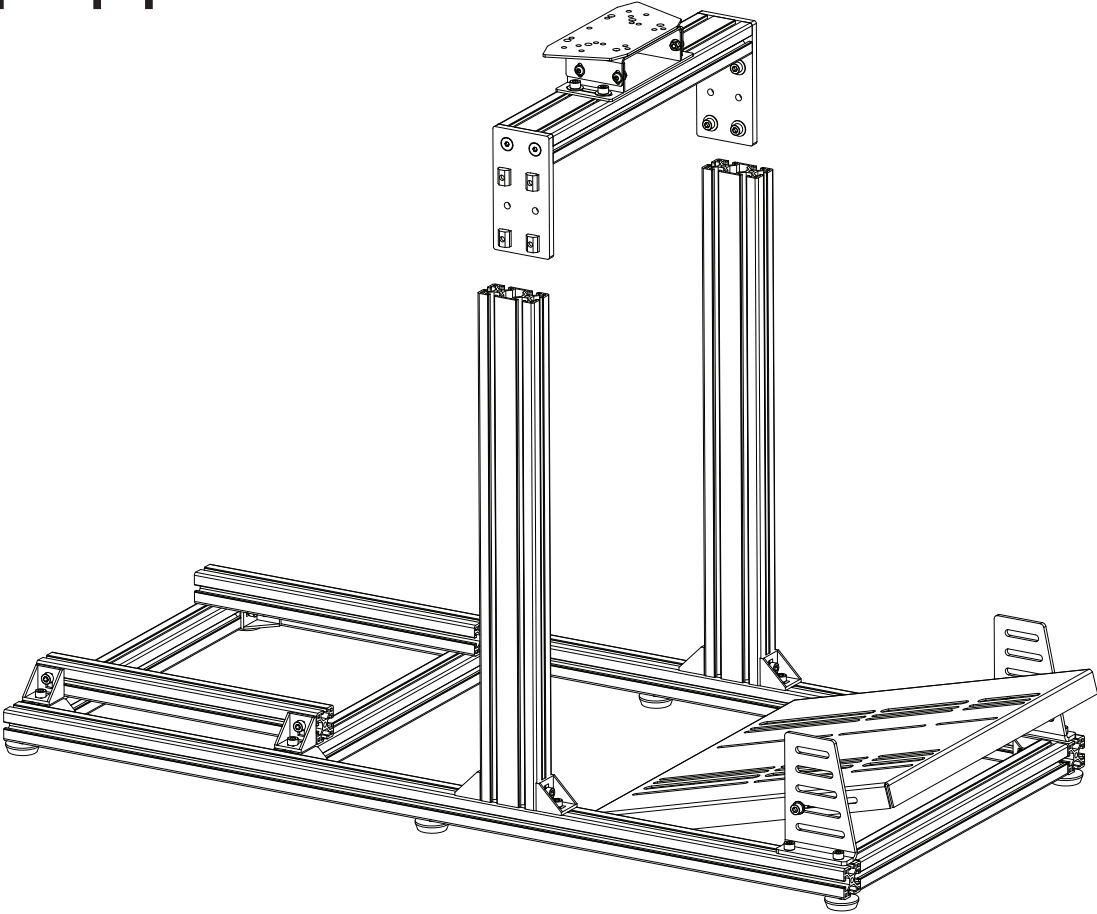



# STEP 12

4-ANGLE CAP

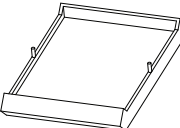

12-40x80 CAP

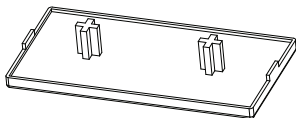

8-40x40 CAP

