

www.mubview.com



support@mubview.com



+1 (978)3092611

PK 320

Warranty Service

Thanks for your shopping and trust.

We have been optimizing our products and improve our lifetime customer service to offer you a better shopping experience.

If you have any problems, please feel free to write us e-mail We will solve your problems within 24 hours.

In addition, your advice or suggestions will be much appreciated and welcomed.

Register via link below to get 3 Years
Warranty Extension. (Or scan the QR code)
<https://bit.ly/3zBSB2y>



Product Service

Email: support@mubview.com

Distributor: business@mubview.com

Tel: +1 (978)3092611 (Mon-Fri 9:00 AM-5:00 PM EST)

More About Us

Web: www.mubview.com

Facebook: www.facebook.com/mubview

Camera Introduction

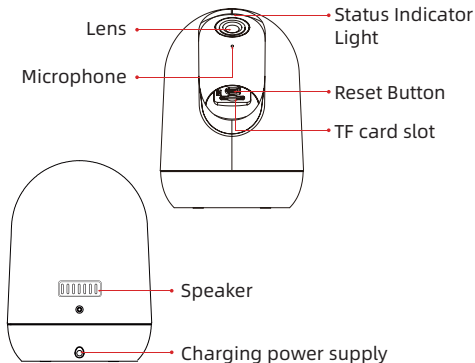

***Please reset the camera before connecting to APP.**

Reset Button	Press and hold for 5 seconds until hearing 'Boo gu' sound to reset
TF card slot	Support local TF card storage (up to 128G)
Lens	Support QHD resolution
LED Indicator Status	Solid in red : Device is abnormal (Network problem)
	Flashing red slowly : Ready for Wi-Fi connection
	Flashing red quickly : Wi-Fi connecting
	Solid blue : Wi-Fi connected Successfully

Download & Install App

The camera supports Android and iOS system.

Please scan the QR code below or search 'MUBVIEW' in App store to download the App, and follow the instruction to register account. If you encounter any problems during the installation process, please feel free to contact us via support@mubview.com



Account Registration

- Sign up in App with your email address.
- Choose your region and correct country code
(Users from different regions cannot share the camera).

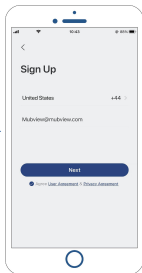
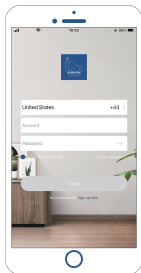

Preparations for Connection

1. Allow 'MUBVIEW' App to access mobile cellular data and wireless LAN, or it will fail to add camera.
2. Allow 'MUBVIEW' App to receive pop-up messages, otherwise the smart phone will not receive notification when motion is detected.

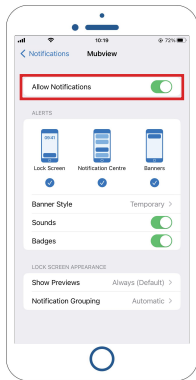
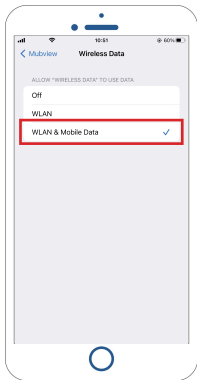

- ① MUBVIEW offers a free 7-day cloud storage with the basic version, or you can insert a Micro SD card into the camera to store videos.
- ② The camera works with 2.4GHz and 5GHz Wi-Fi.
- ③ When connecting to network, please take the camera closer to your WiFi router, to ensure a stable network signal.

Connect the Camera to App



Tap to Add Device

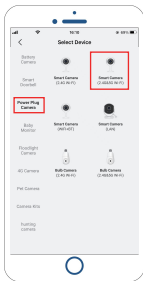

Select Bulb Camera



Check Power

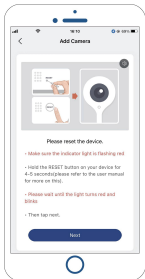

Reset Camera

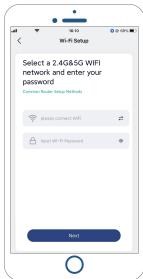

Input Wi-Fi
Password



Prepare to Scan



Scan QR Code
With Device

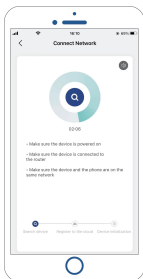

Wait For Connection

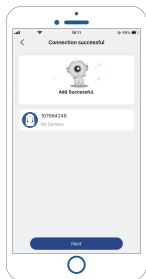

Add Successful



Click Next



Network Diagnostic

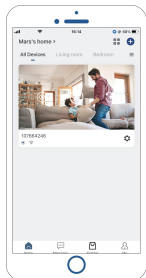

Add Device
Complete

Note: If the camera fails to connect to the network, press and hold the reset button for more than 5 seconds, and connect again after hearing the beep. If it still fails, please email us support@mubview.com

Multi-User Sharing

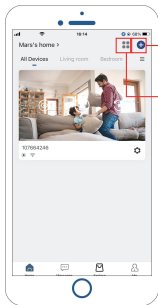

Click '+' to add more devices

Watch 4 cameras live at the same time

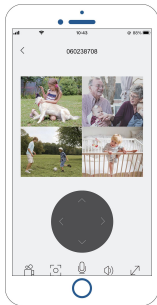

Camera can be shared to others in two ways:

1. Let her/him view but cannot control the camera.
2. Let her/him view and control the camera.

Share steps:

1. Camera User download App to his/her phone and register his new account in App.
2. Click 'Add' in App on Camera Owner's phone.
3. Camera Owner scan Camera User's QR Code or input Camera User's account ID.
4. Camera User accept share.

FAQ

Q: Failed to add during network configuration?

A: Please turn on the camera and power it on, press and hold the Reset button for more than 5 seconds, after the camera is reset successfully, reconnect the camera, if it still fails, please contact us at support@mubview.com

Q: After scan adding is still unsuccessful?

A: Restart the device or power off the device after scan adding is still unsuccessful, and then try to add it again.

Q: The device cannot preview normally?

A: Please check if the network signal is too weak, please put the camera close to the router, if still cannot preview, reset the camera and add it again.

Q: After resetting the device, why is the camera still in the device list?

A: Resetting the device only to reset the camera's network configuration but cannot change the configuration on the APP, to delete the camera you must log in the APP to delete.

Q: How to switch the camera network to another router?

A: First remove and reset the device on the APP, and then configure the network for the device again through the APP.

THANK YOU

User guide videos
Benutzerhandbuch Videos
Vidéos de guide de l'utilisateur
Video di guida per l'utente
Videos de la guía del usuario

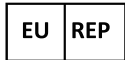

SUCCESS COURIER SL

Calle de RIO TORMES 13A, oficina 1,
Fuenlabrada, Madrid, 28947 Spain

Email: support@mubview.com



GOAL REACH CONSULTING LTD

OFFICE 1029 3 HARDMAN STREET 10TH FLOOR,
SPINNINGFIELDS MANCHESTER, UK M3 3HF

Email: support@mubview.com



Made In China

FCC ID: 2AYJN-QB320



Web

Subscribe to MUBVIEW Official Website



Facebook

Follow MUBVIEW on Facebook



YouTube

Watch more MUBVIEW videos on Youtube