



FXRP FAIRING FOR ROAD KING

QUESTIONS?
 EMAIL: info@getklocked.com
 CALL: (605) 996.3700

TOOLS NEEDED:

- | | | | |
|----------------|----------------|------------------------|-----------------------------|
| - Ratchet | - 7/16" Wrench | - 3/8" Wrench | - Phillips Head Screwdriver |
| - 4" Extension | - 9/16" Socket | - 3/16" Hex Bit Socket | - Fender Cover/Towel |
| - 7/16" Socket | - 9/16" Wrench | - Torque Wrench | |

We highly recommend a complete installation for test fit prior to paint. The test fit is also important to test for handlebar clearance that may need to be adjusted or replaced.

1. Verify all the contents of the Fairing Fit Kit (FIG 1):

- a. Fairing
- b. Neck Bracket
- c. Lower Support
- d. Crash Bar Plate
- e. Crash Bar Support
- f. Crash Bar Clamp
- g. Fairing Mount Adapter
- h. 7" Headlight Ring Mount
- i. Hardware Kit
 - i. Hardware Bag "B" – Windshield
 - ii. Hardware Bag "C" – 7" Headlight Ring Mount
 - iii. Hardware Bag "D" – Fairing to Neck
 - iv. Hardware Bag "E" – Lower Support to Fairing
 - v. Hardware Bag "F" – Neck to Frame
 - vi. Hardware Bag "G" – Nacelle
 - vii. Hardware Bag "H" – Lower Support w/o Crash Bar
 - viii. Hardware Bag "J" – Lower Support w/ Crash Bar
- j. Headlight Cover Kit
 - i. Headlight Cover
 - ii. Headlight Cover Trim
 - iii. Hardware Bag "A" - Headlight Cover
 - iv. Headlight Cover Instructions
- k. FXRP 9" Dark Smoke



INSTRUCTIONS CONTINUED



2. Cover the front fender to help protect against damage (FIG 2).
3. Remove windshield if equipped.
4. Remove headlight trim ring (FIG 3).

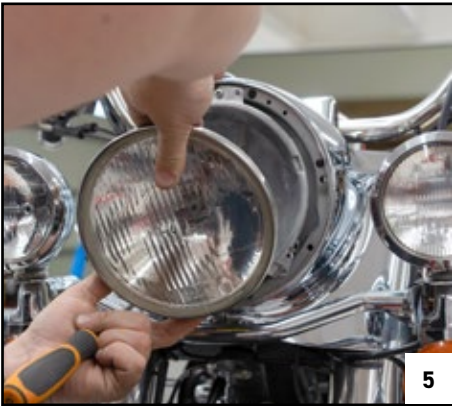

5. Remove headlight retainer ring (FIG 4) and headlight (FIG 5).
6. Remove headlight mount (FIG 6).
7. Remove driving lights/turn signals if mounted to the side of the nacelle (FIG 7).

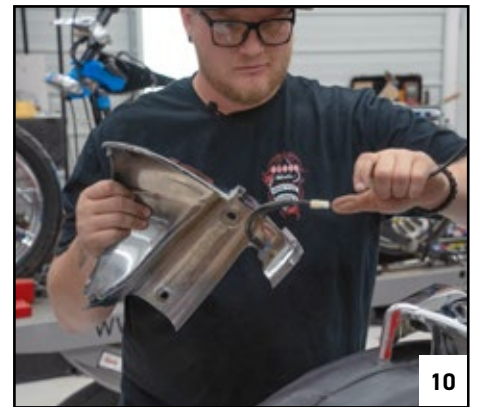
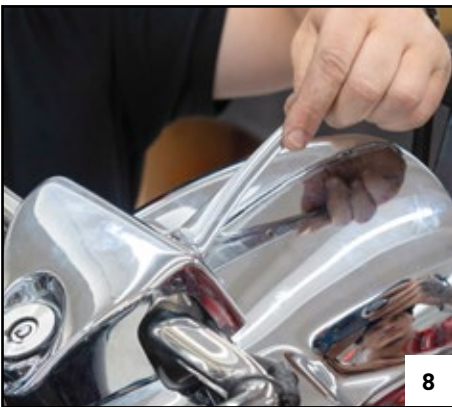

8. Remove nacelle trim (FIG 8).
9. Remove the handlebar cover (FIG 9).
10. Remove both halves of the nacelle (FIG 10).

INSTRUCTIONS CONTINUED

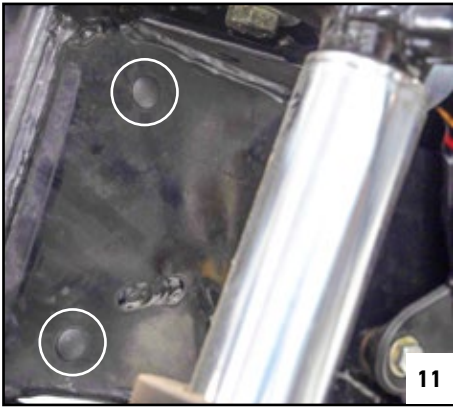

11. Locate mounting holes in the frame and remove the black plastic plugs (FIG 11).
12. Using **Hardware Bag "F"**, install the **Neck Bracket** onto the frame and torque bolts to 26 ft-lbs (FIG 12).
13. Reinstall nacelle halves using **Hardware Bag "G"** and tighten to factory recommended torque (FIG 13).

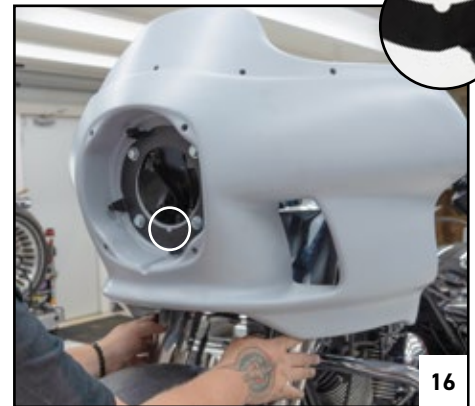
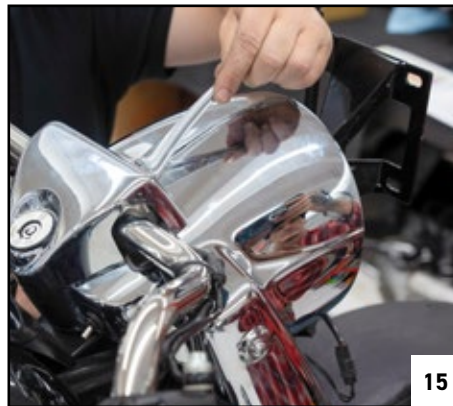

14. Reinstall the handlebar cover (FIG 14). (Not required for test fit purposes)
15. Reinstall the nacelle trim (FIG 15). (Not required for test fit purposes)
16. Using **Hardware Bag "D"**, install **Fairing** and **Fairing Mount Adapter**. Position the **Fairing Mount Adapter** so the notch is at 6 o'clock. With the **Fairing** level, side to side and centered, left to right snug the bolts just enough to hold the fairing but still allow adjustments during **Lower Support** install (FIG 16).
17. Install **Fairing Support**. There are two options for installation found on page 4. Options include:
 - A. With Crash Bar
 - B. Without Crash Bar

WITH CRASH BAR



WITHOUT CRASH BAR



A

WITH CRASH BAR



1. Using the 3/8" diameter bolts from **Hardware Bag "J"**, loosely install the **Crash Bar Plate** to the **Crash Bar Support**, one for the left side and one for the right (**FIG a**).



2. Using **Hardware Bag "E"**, loosely install the **Crash Bar Plates** to the bottom of the fairing, the plates should be inside the fairing and not below it (**FIG b**).



3. Using the 1/4" hardware from **Hardware Bag "J"**, loosely install the **Crash Bar Clamps** to the **Crash Bar Support** over the crash bar (**FIG c**).
4. Tighten all loosely installed hardware in order below to torque values listed:
 - a. **Hardware Bag "E"** - 1/4" Hardware Crash Bar Plate to Fairing - 45 in-lbs.
 - b. **Hardware Bag "J"** - 1/4" Hardware Crash Bar Clamp - 45 in-lbs.
 - c. **Hardware Bag "J"** - 3/8" Hardware Crash Bar Plate to Support - 18 ft-lbs.
 - d. **Hardware Bag "D"** - 3/8" Hardware Fairing to Neck - 18 ft-lbs.

B

WITHOUT CRASH BAR



1. Using **Hardware Bag "H"**, loosely install the **Lower Support** to the frame. The mounting plates at the end should be inside the fairing, not underneath (**FIG d**).



2. Using **Hardware Bag "E"**, loosely install the **Lower Support** to the **Fairing** (**FIG e**).
3. Tighten all loosely installed hardware in order below to torque values listed:
 - a. **Hardware Bag "E"** - 1/4" Hardware Lower Support to Fairing - 45 in-lbs.
 - b. **Hardware Bag "G"** - 3/8" Hardware Lower Support to Frame - 26 ft-lbs.
 - c. **Hardware Bag "D"** - 3/8" Hardware Fairing to Neck - 18 ft-lbs.

INSTRUCTIONS CONTINUED

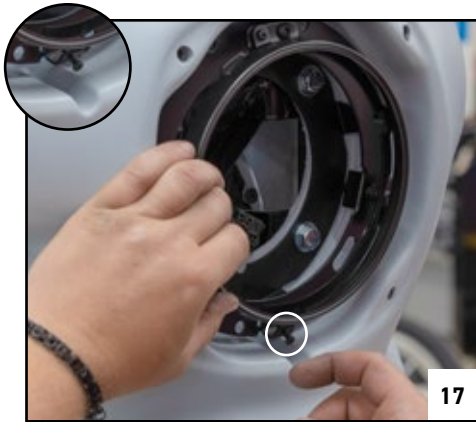

18. Using **Hardware Bag "C"** install **7" Headlight Ring Mount to Fairing Mount Adapter** 45 in-lbs positioning the threaded tab at 6 o'clock (**FIG 17**) If not using trim ring, remove screw from threaded tab.
19. Remove the headlight retaining ring, install the headlight (**FIG 18**), and reinstall the retaining ring (**FIG 19**).

NOTE: Headlight adjustment screws with springs may require thread locking compound after adjustments are made.

20. Using **Hardware Bag "B"** insert the seven well nuts into the fairing and install your new **Flare™ Windshield** torquing screws to 10 in-lbs (**FIG 20**).
21. Refer to instructions in FXR Fairing Headlight Cover Kit (white box) for Cover install.



Klock Werks is not held responsible for any damage resulting from improper installation performed by the consumer or their dealer.