



FXRP STYLE FAIRING FOR FXR

QUESTIONS?
 EMAIL: info@getklocked.com
 CALL: (605) 996.3700

TOOLS NEEDED:

- | | | | | |
|----------------|----------------|------------------------|-----------------------|------------------------|
| - Ratchet | - 7/16" Wrench | - 3/16" Hex Bit Socket | - 1/2" Wrench | - Phillips Screwdriver |
| - 4" Extension | - 9/16" Socket | - Torque Wrench | - 1/2" Socket | |
| - 7/16" Socket | - 9/16" Wrench | - Fender Cover/Towel | - 1/4" Hex Bit Socket | |

We highly recommend a complete installation for test fit prior to paint. The test fit is also important to test for handlebar clearance that may need to be adjusted or replaced.

1. Verify all the contents of the Fairing Fit Kit (FIG 1):

- a. Fairing
- b. Neck Bracket
- c. Lower Support
- d. Fairing Mount Adapter
- e. 7" Headlight Mount Ring
- f. Hardware Kit
 - i. Hardware Bag "B" - Windshield
 - ii. Hardware Bag "C" - 7" Headlight Ring Mount
 - iii. Hardware Bag "D" - Fairing to Neck
 - iv. Hardware Bag "E" - Lower Support to Fairing
 - v. Hardware Bag "F" - Neck to Frame
 - vi. Hardware Bag "G" - Lower Support to Frame
- g. Headlight Cover Kit
 - i. Headlight Cover
 - ii. Headlight Cover Trim
 - iii. Headlight Cover Hardware
 - iv. Headlight Cover Instructions
- h. FXRP 9" Dark Smoke Flare™ Windshield

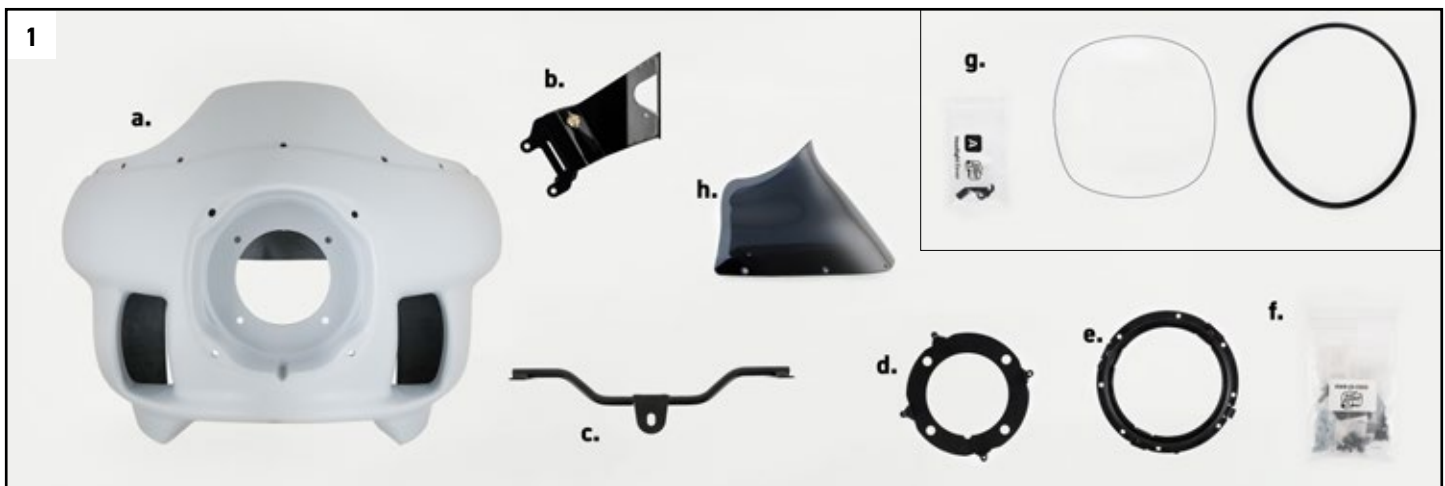

INSTRUCTIONS CONTINUED

2. Cover the front fender to help protect against damage (FIG 2).
3. Disconnect negative battery cable.



4. Remove windshield and fairing if equipped.
5. Remove headlight and mount (FIG 3).
6. Locate mounting holes in the frame and remove black plastic plugs (FIG 4). If threaded holes need cleaned out, the thread pitch is 5/16"-18.

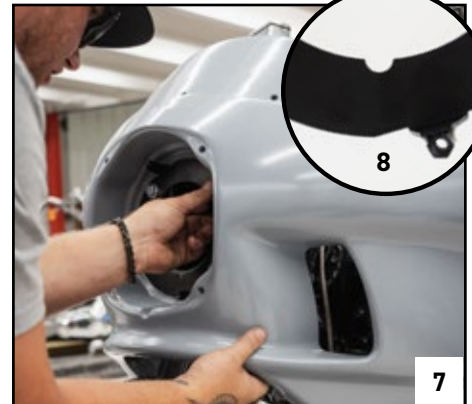
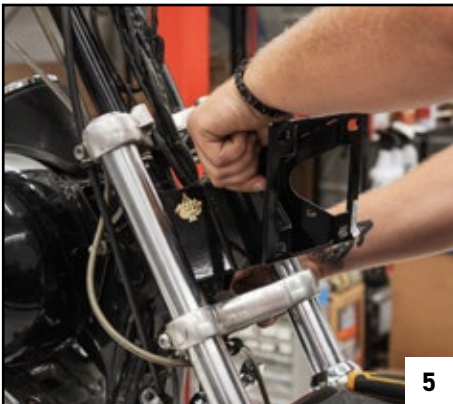

7. Using **Hardware Bag "F"** install the **Neck Bracket** onto frame (FIG 5). Lightly snug bolts down, still allowing for adjustment.
8. Using **Hardware Bag "D"** install **Fairing** (FIG 6) and **Fairing Mount Adapter** to the **Neck Bracket** (FIG 7). Position the **Fairing Mount Adapter** (FIG 8) so the notch is at the 6 o'clock down position. Snug bolts down, still allowing for side-to-side adjustments.
9. Locate **Lower Support** mounting hole in the frame (FIG 9). If threaded hole needs to be cleaned out, the thread pitch is 3/8-16. Using **Hardware Bag "E" & "G"** install the Lower Support. The mounting plates should be inside the fairing, not underneath (FIG 10).

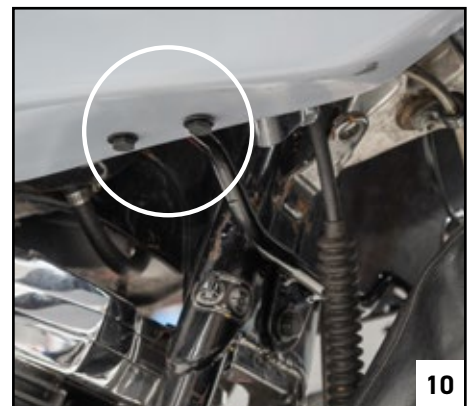
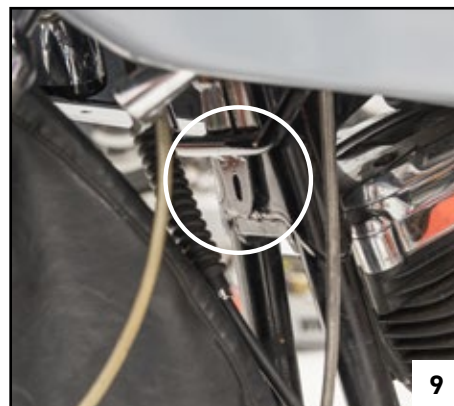

INSTRUCTIONS CONTINUED

10. Tighten all loosely installed hardware in order of torque values listed:
 - a. Hardware Bag "G" - 3/8" Hardware - Lower Support to Frame - 18 ft-lbs.
 - b. Hardware Bag "E" - 1/4" Hardware - Lower Support to Fairing - **45 in-lbs.**
 - c. Hardware Bag "D" - 3/8" Hardware - Fairing to Neck - 18 ft-lbs.
 - d. Hardware Bag "F" - 5/16" Hardware - Neck to Frame - 13 ft-lbs.
11. Using **Hardware Bag "C"** install **7" Headlight Ring Mount to Fairing Mount Adapter** positioning the threaded tab at 6 o'clock down and torquing to **45 in-lbs (FIG 11)**. If not using a trim ring, remove screw from threaded tab.



12. Remove the headlight retaining ring (**FIG 12**), install the headlight, and reinstall the retaining ring (**FIG 13**).
NOTE: Headlight adjustment screws with springs may require thread locking compound after adjustments are made.
13. Using **Hardware Bag "B"** insert the seven well nuts into the fairing (**FIG 14**) and install your new **Flare™ Windshield**, torquing screws to 10 in-lbs (**FIG 15**).
14. Refer to instructions in **FXR Fairing Headlight Cover Kit** (white box) for cover install.



Klock Werks is not held responsible for any damage resulting from improper installation performed by the consumer or their dealer.