

## INSTRUCTION SHEET





# REAR ACCESSORY ELECTRICAL HARNESS FOR 2019+ HONDA TALON

**INCLUDED IN BOX:**  
(1) Power Harness  
(1) Instruction Sheet

**WARNING!**  
Do not overload the vehicle's  
electrical system!

**QUESTIONS?**

 **EMAIL:**  
info@getklocked.com  
 **CALL:** (605) 996.3700



1. Release the rear access panel from the front of the cargo area (FIG 1)
2. Release the taillight wiring connector from its anchor by squeezing the barb together (FIG 2)
3. Disconnect the connector and install the Klock Werks accessory harness inline with the stock wiring (FIG 3)
4. Secure the taillight harness with a zip tie and reinstall the barb into the anchor point as shown (FIG 4)
5. Finish installing the harness and secure the wiring with zip ties to ensure there is no interference along any part of the chassis.

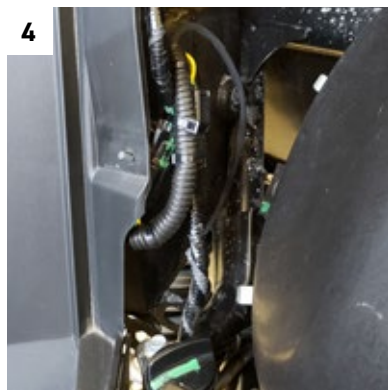
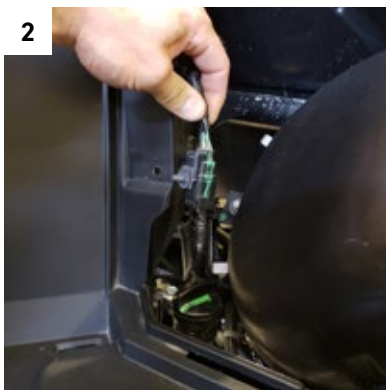

**Warning!** Do not overload the vehicle's electrical system!