

**WORKLIGHTS WITH SPEAKERS**  
Stereo | Wireless | Rechargeable

**700**  
LUMENS



**Infinity X1**  
SMARTER INSIDE. BRIGHTER OUTSIDE.



IMPORTANT!  
RETAIN FOR FUTURE  
REFERENCE.  
READ CAREFULLY

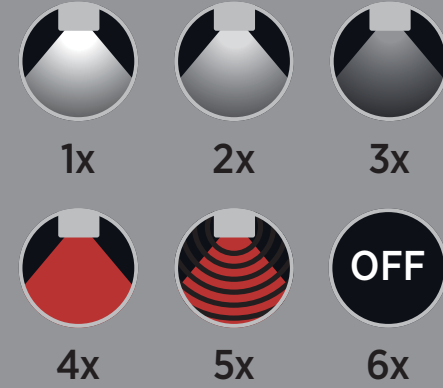
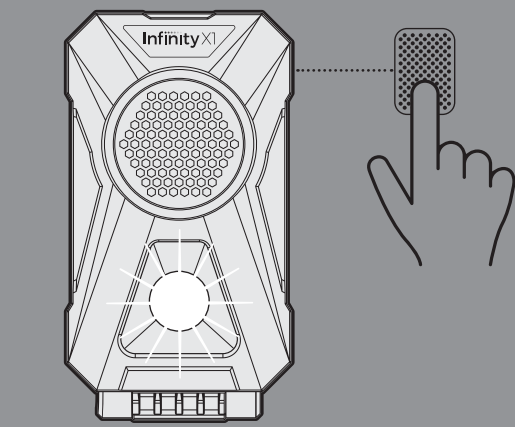

**STEP 1**

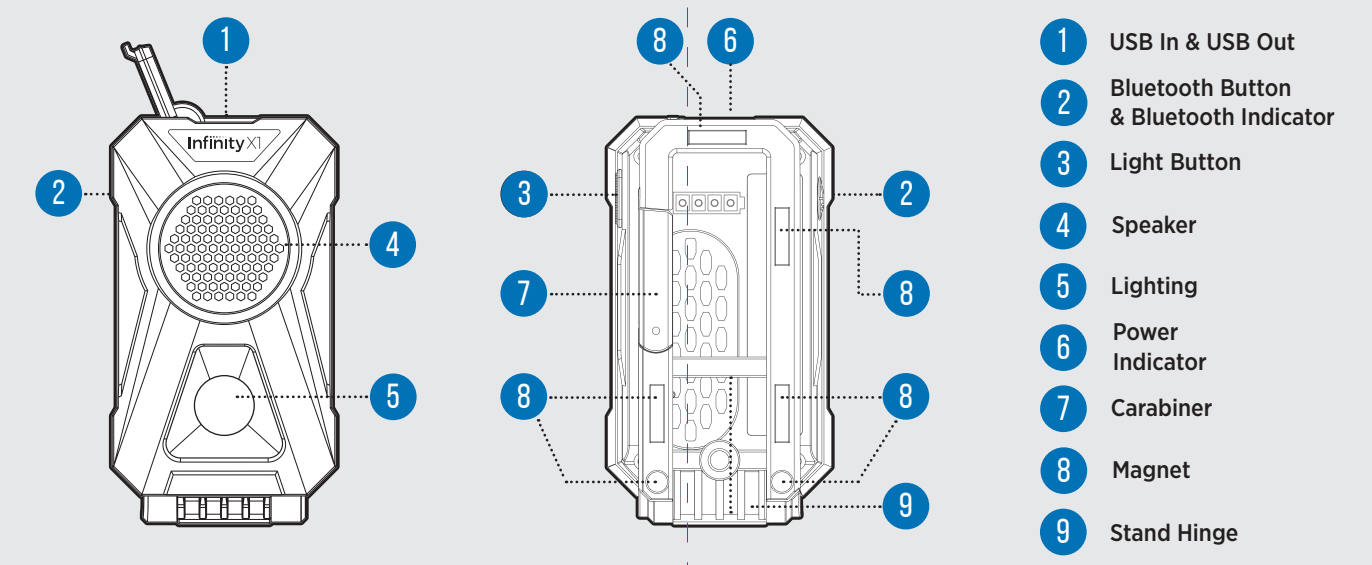
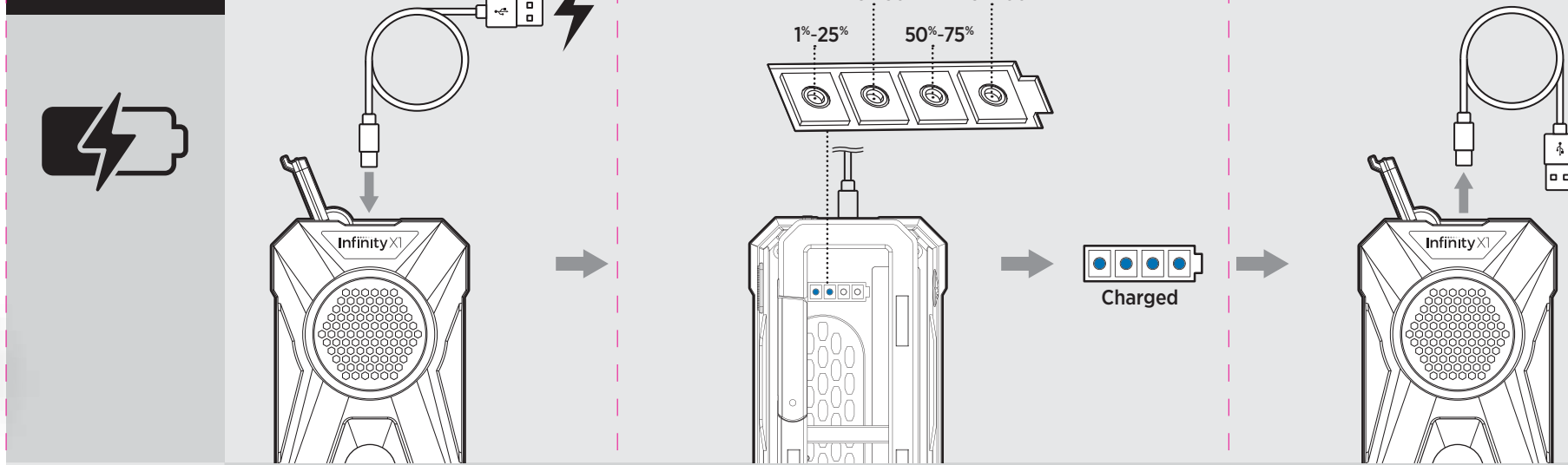

**STEP 2**

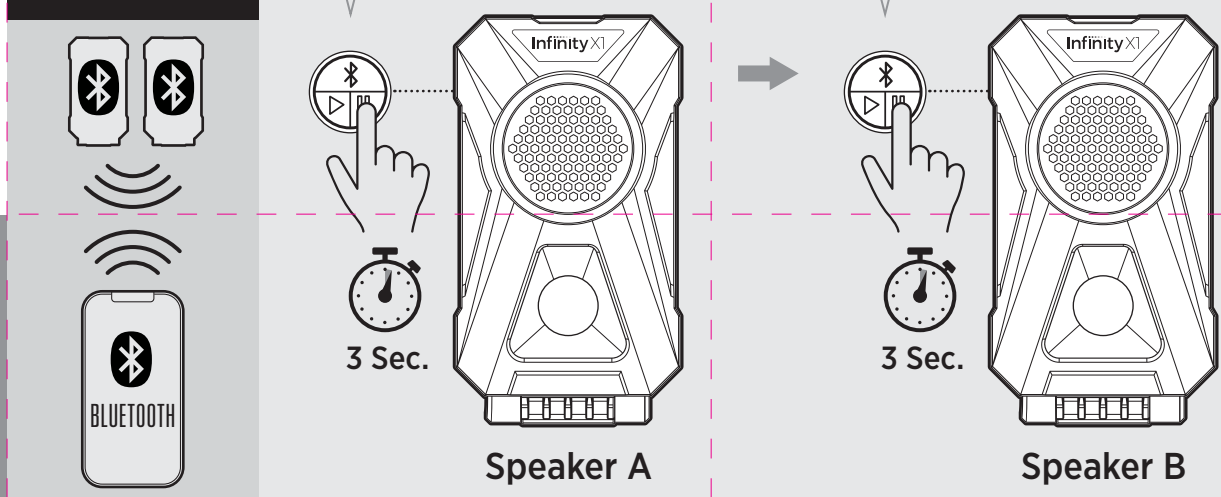

**CONNECTING 2 PHONES**

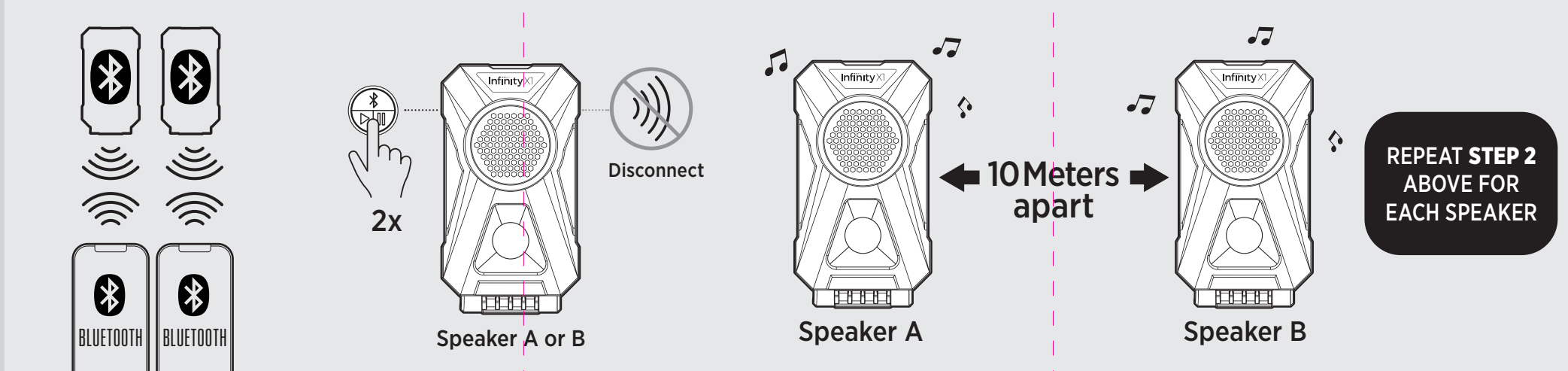

Client: INFINITY X1  
File: ITM. / ART. 1600276  
NON-COSTCO BLUETOOTH SPEAKER MANUAL-ENGLISH-v.19  
Start Date: FEB. 23, 2021 End Date: JULY 18, 2022

NOASOUND PRODUCTIONS  
noasound.com  
514-235-6603  
info@noasound.com



**CURRENT CHECKLIST / STATUS:**  
As of OCT.17 - 2022

**ALTHOUGH THIS ARTWORK HAS BEEN CHECKED FOR ACCURACY, IT IS THE RESPONSIBILITY OF THE CUSTOMER TO MAKE ALL FINAL APPROVALS. PLEASE DOUBLE-CHECK ACCURACY OF ALL TEXT, THE COLORS, ARTWORK DIMENSIONS, IMAGE AND COPY POSITIONS. ANY CHANGES MADE TO THE ART AFTER YOU APPROVE MAY RESULT IN ADDITIONAL CHARGES.**

Approved by: \_\_\_\_\_ Title \_\_\_\_\_ Date \_\_\_\_\_  
 OK AS IS  PLEASE REVISE

COSTCO ENGLISH APPROVAL: YES ✓ KELSEY PATRICK - APR.29-2021  
ITM. / ART. #: YES ITM. / ART. 1600276  
WARNINGS: YES ✓  
CUSTOMER SERVICE INFO: PLACED - PENDING  
CERTIFICATION MARKS: ADDED  
MAR. 29 - ADDED MISSING GRAPHICS  
MAR. 31 - CHANGED DISCONNECT FUNCTION TO (CLICK TWICE)  
APR. 5 - Revised another image to click twice  
Apr. 7 - Added new CHINA Address  
-Made Robinson's changes  
-Apr. 13 - Changed Japan address  
APR. 29 - ENGLISH APPROVED  
MAY 13 - CHANGED FL1 INFO  
MAY 17 - ADDED AUSTRALIAN GUARANTEE  
JULY 20 - ADDED SWEDISH ADDRESS & FREQUENCY STATEMENT  
AUG. 10 /2021- ADDED PEAK BEAM  
MAY 9-2022 - RUNNING CHANGE TO COSTCO ADDRESSES  
JULY 18- ADDED SORTING LABEL TO MANUAL - v.17  
JULY 25 - UPDATED ADDRESSES (04-13-22) - V.18  
OCT. 17- REMOVE COSTCO INFO - ADD QR CODE -v.19

FL1 STANDARD NORME FL1 NORMA FL1	HIGH HAUTE ALTA	MED MOY MEDIO	LOW FAIBLE BAJA
	<b>700</b> LUMENS LUMENES	<b>300</b> LUMENS LUMENES	<b>100</b> LUMENS LUMENES
	<b>2h 30min</b>	<b>5h</b>	<b>12h</b>
	<b>28 m</b>	<b>18 m</b>	<b>10 m</b>
	<b>196cd</b>	<b>81cd</b>	<b>25cd</b>
<b>1m</b> 			

#### BATTERY LIFE

**LIGHT ONLY**  
2.5 Hours  
700 Lumens

**MUSIC ONLY**  
12 Hours

**LIGHT & MUSIC**  
3.5 Hours  
400 Lumens

#### FCC STATEMENT OF COMPLIANCE

WARNING: Changes or modifications not expressly approved by the party responsible for compliance could void the user's authority to operate the equipment. This equipment has been tested and found to comply with the limits for a Class B digital device, pursuant to part 15 of the FCC Rules. These limits are designed to provide reasonable protection against harmful interference in a residential installation. This equipment generates, uses and can radiate radio frequency energy and, if not installed and used in accordance with the instructions, may cause harmful interference to radio communications. However, there is no guarantee that interference will not occur in a particular installation. If this equipment does cause harmful interference to radio or television reception, which can be determined by turning the equipment off and on, the user is encouraged to try to correct the interference by one or more of the following measures:

- Reorient or relocate the receiving antenna.
- Increase the separation between the equipment and receiver.
- Connect the equipment into an outlet on a circuit different from that to which the receiver is connected.
- Consult the dealer or an experienced radio/TV

technician for help.

Note: This device complies with Part 15 of the FCC Rules. Operation is subject to the following two conditions: (1) this device may not cause harmful interference, and (2) this device must accept any interference received, including interference that may cause undesired operation.

Note: (a) frequency band(s) in which the radio equipment operates: 2.4 - 2.4835 GHz.

(b) maximum radio-frequency power transmitted in the frequency band(s) in which the radio equipment operates: 4.30 dBm (E.I.R.P.).

#### PRECAUTIONS

- Please store and use this product at room temperature.
- Do not expose this product to rain or damp surroundings.
- Prevent this product from falling as that could result in serious damage.
- Do not dismantle, repair or modify this product on your own.
- In order to avoid any risk, do not dispose this product inappropriately or expose it to fire as there is a built-in, non-replaceable lithium battery.

#### TIPS

1. Do not turn up the volume to maximum for a long time as this could shorten the service life of this product or impair your hearing.
2. When encountering any fault during operation, please cut off the power supply and disconnect the USB cable to prevent further damage to the speaker or other components.
3. The Bluetooth transmission range or connectivity could be affected by low battery power. In that case, please recharge immediately.



**CAUTION:** Possible hazardous optical radiation emitted from this product. The luminaire should be positioned so that prolonged staring into the luminaire at a distance closer than 1.5 m / 5.1 ft is not expected.



**WARNING:** The ventilation should not be impeded by covering the ventilation openings with items such as newspapers, tablecloths and curtains. Allow at least a 10 cm gap all around the product.



**WARNING:** No naked flame sources, such as lighted candles, should be placed on the speaker.



**WARNING:** This appliance is intended for domestic household use only and should not be used for any other purpose or in any other application, such as for non-domestic use or in a commercial environment.

#### PRODUCT INFORMATION

Product Model	1600276
Bluetooth Specifications	Bluetooth 5.0
Transmission Distance	≤10m (depending on operation environment and devices to which it connects)
USB Rechargeable Voltage	DC 5V 1A
Built-in Battery	2600 mAh
Output Power	5 W
Product Dimensions	5.5 x 3.0 x 2.5 inch

#### PROBLEM

Unable to pair up with other devices

The sound is rather low or distorted

The music stops from time to time

The Bluetooth indicator remains off

#### SOLUTIONS

1. Check whether the speaker is still in the process of search or switch it off and then on.
2. Too many Bluetooth devices in the proximity that cause difficulty in connection. Please turn them off.

1. Check the Bluetooth device's volume and then adjust it to a proper level.
2. Recharge the battery.

1. Check whether the speaker's effective transmission range is exceeded or there is an obstacle standing between the speaker and other Bluetooth devices.

1. It suggests the battery power drops quite low and retry once being recharged.
2. Turn it on again.

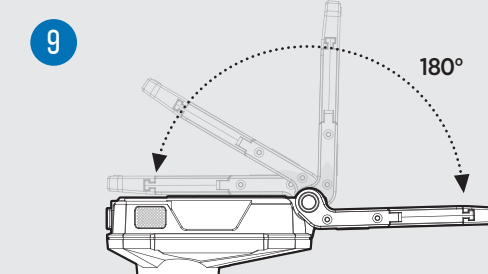
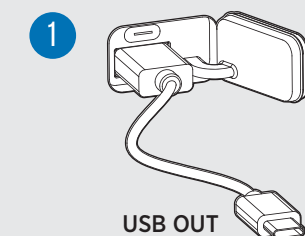
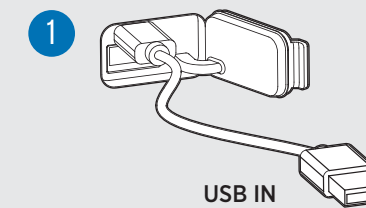

#### DISCONNECT FROM PHONE BEFORE CONNECTING NEW PHONE

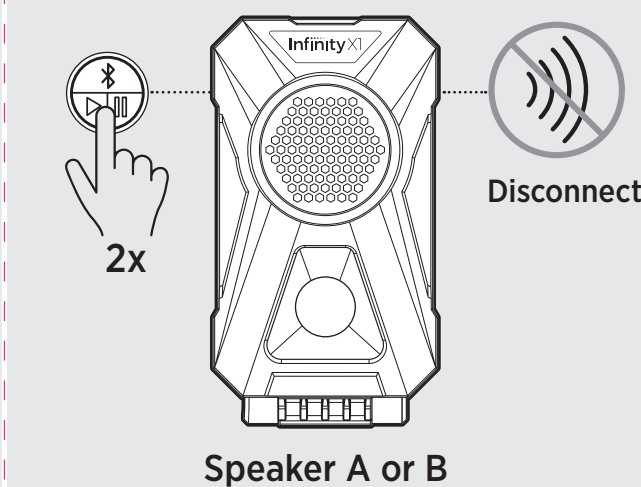

# Infinity X1

SMARTER INSIDE. BRIGHTER OUTSIDE.

**Manufacturer / Fabricant / Fabricante:**  
©2021 INFINITY X1 LLC  
3525 Del Mar Heights Rd, Suite 867  
San Diego, CA 92130, USA  
www.infinityx1.com

Questions, problems missing parts?  
Before returning to your retailer,  
call Customer Service:

#### CUSTOMER SERVICE

USA: 1-866-544-4891  
International: 1-760-230-5611  
Hours: M-F 9AM to 5PM Pacific Time  
Web: www.infinityx1.com/support  
Email: support@infinityx1.com



MADE IN CHINA