



"We keep our clients compliant with OSHA fall protection regulations. It's our business!"

LOADING DOCK ROLLING SAFETY GATE

Installation and Operations Manual

Please Read!

Workers installing or using the *Loading Dock Rolling Safety Gate*

"Must read and understand all instructions".

THIS INSTALLATION MANUAL EXPLAINS HOW TO

CORRECTLY INSTALL AND USE the *Loading Dock Rolling Safety Gate*

Follow the instructions outlined in this manual.

FAILURE TO CAREFULLY FOLLOW THESE INSTRUCTIONS POSES A DIRECT THREAT TO SAFETY OR HEALTH AND MAY RESULT IN DEATH OR SERIOUS INJURY TO USERS OR INSTALLERS OF THE LOADING DOCK ROLLING SAFETY GATE AND/OR TO THIRD PARTIES. DIVERSIFIED FALL PROTECTION EXPRESSLY DISCLAIMS ANY LIABILITY FROM INJURY, DAMAGE, OR OTHER LOSS RESULTING FROM THE IMPROPER OR UNAUTHORIZED INSTALLATION OR USE OF THE LOADING DOCK ROLLING SAFETY GATE.

Thank you for the purchase of our *Loading Dock Rolling Safety Gate*

When to use the *Loading Dock Rolling Safety Gate*

Assemble and use the *Loading Dock Rolling Safety Gate* as specified in the instructions manual to meet OSHA compliance regulations, as stated, under Standards -29 CFR, 1910.23 & Standards - 29 CFR, 1926.502,

As stated by OSHA :

- **1910.23(b)(1):** Every wall opening from which there is a drop of more than 4 feet shall be guarded.
- **Subpart M**
Fall Protection Systems Criteria and Practices - Guardrail Systems
The guardrail system must be capable of withstanding a force of at least 200 pounds, the top edge of the guardrail must be 42 inches and must not deflect to a height less than 39 inches. Midrails shall be capable of withstanding a force of at least 150 pounds applied in any direction.

CONTENTS OF KIT:

- Rolling Safety Gate: 6', 8' or 10' size with pivot caster pre-assembled to rail
- Pivot Base
- Sleeve Bushing
- (5) Concrete Anchors: which include (4) anchors for installation and (1) spare
- Gate Pin
- Optional Masonry Drill kit (includes (1) 1/4"Ø x 6 and (1) 3/4"Ø x 12 carbide tipped drills - P/N: 7100090) if purchased

Required Tools for Proper Installation

- **Safety Glasses:** Must be worn through out every step of Installation.
- Hammer Drill (Corded or cord-less can be purchased through DFP at additional cost)
- 1/4" Diameter by 6" long masonry drill bit
- 3/4" Diameter by 12" long masonry drill bit
- 7/16" Wrench or Socket with ratchet or impact wrench
- Vacuum: Capable of picking up concrete dust

Replacement Parts

(See figure 9 for a visual reference of the replacement parts)

Part Number	Color	Description
1. 7100095-SY...	...Safety Yellow...	...Gate Pin (fits all sizes).
7100095-G...	...Galvanized...	...Gate Pin (fits all sizes)
7100095-C...	...Custom Finish...	...Gate Pin (fits all sizes)
2. 7100094...	...Zinc Plated...	...Pivot Caster Wheel (fits all sizes)
3. 710093-SY...	...Safety Yellow...	...Floor Mounted Swivel Base Assembly (fits all sizes)
7100093-G...	...Galvanized...	...Floor Mounted Swivel Base Assembly (fits all sizes)
7100093-C...	...Custom Finish...	...Floor Mounted Swivel Base Assembly (fits all sizes)
4. 7100092...	...White...	...Sleeve Bushing for Floor Mounted Swivel Base (fits all sizes)
5. 7100091...	...Zinc Plated...	...Screw Anchor Kit (includes (5) 1/4" anchors (fits all sizes)
6. Per Request...	...SY, Galv. or Custom Finish...	... 6 ft, 8 ft, 10 ft or 12 ft Replacement Gates

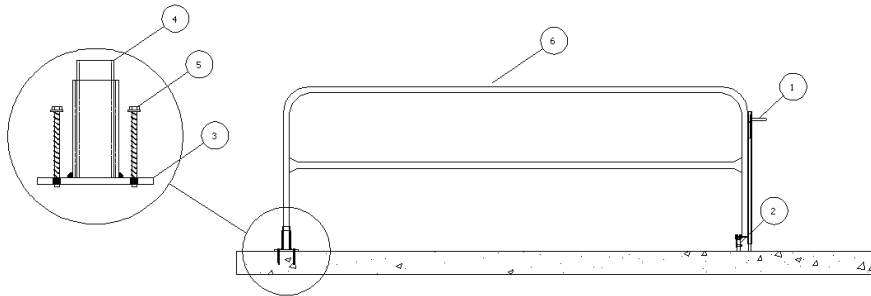

Figure 9

LOADING DOCK ROLLING SAFETY GATE

www.FallProtect.com

LOADING DOCK ROLLING SAFETY GATE KIT

Loading Dock Rolling Safety Gate comes fully assembled. The only requirement is anchoring the mounting base to a concrete floor by drilling (4) ¼" diameter holes and putting in the anchor bolts, (1) ¾" diameter hole for the locking pin, and placing the safety gate into the mounting base.

For any other installation inquiries, please contact us (Diversified Fall Protection) at (440)-348-9460, website www.FALLPROTECT.com or by email at info@fallprotect.com

Instructions:

1. Remove contents from box
2. Insert sleeve bushing into pivot base see figure 1
3. Insert floor mounted pivot base to non caster leg of gate.
4. Position Rolling Safety Gate across opening of dock door see figure 2.

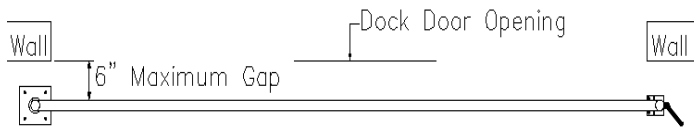

Figure 2

5. Layout pivot base location and mark on floor with Sharpie marker (4) locations for concrete anchors. The installer must ensure that the gate is wider than the opening of the dock and the gaps must be less than 6 inches on both sides see figure 2 and figure 4.
6. Drill (4) ¼" diameter by 4 inch deep holes into the concrete. Concrete must be a 4 inches thick or greater.
7. Clean out holes using a vacuum before installing concrete anchors.
8. Set pivot base over drilled holes. Align holes in pivot base with drilled holes in concrete.
9. Insert ¼" anchor bolt and use a 7/16" socket or wrench to tighten anchor bolt to 18 ft-lbf torque. Repeat this step with the remaining anchor bolts until (4) anchor bolts are securely fastened to the concrete floor.
10. Visually inspect all (4) concrete anchors verifying that each anchor is tight to pivot base.
11. Insert end of the Rolling Safety Gate into the sleeve bushing.
12. Align gate parallel to the dock door opening see figure 3.



Figure 3

13. Mark floor with Sharpie marker where locking pin rests on the concrete floor see figure 4.

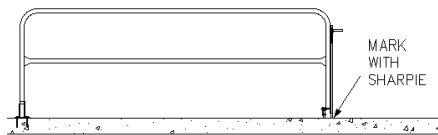

Figure 4

14. Roll gate away to clear area for drilling gate pin receiver hole see figure 5



Figure 5

15. Drill (1) ¾" Diameter hole by 4" deep into the concrete floor for gate pin receiver hole vacuum free of dust prior to inserting gate pin.
16. Align gate to closed position insert gate pin into the receiver hole in concrete.

THE INSTALLATION IS NOW COMPLETE

DIVERSIFIED FALL PROTECTION LTD.

division of Lorad LLC
24400 Sperry Drive
Cleveland, OH 44145
www.fallprotect.com

info@fallprotect.com - (440)-348-9460
Loading Dock Rolling Safety Gate 2of4

Copyright © 2012 Diversified Fall Protection

LOADING DOCK ROLLING SAFETY GATE

www.FallProtect.com

Operating procedures:

1. Gate is to be in closed position (figure 6) any time dock door is in the open position and dock is empty (no trucks parked)



Figure 6

2. With truck in dock and dock door open
3. Grab dock gate pin, pull upward to release from receiver hole in floor, rotate 135 degrees counterclockwise and release to travel position see figure 7.
4. Grab top rail of the Loading Dock Rolling Safety Gate and roll away from the dock door to clear dock door opening for safe loading/unloading of the truck see figure 8.
5. After loading/unloading of truck, prior to truck leaving the dock, Grab the top rail of the Loading Dock Rolling Safety Gate roll back into the closed position as illustrated in figure 8 always behind the gate.

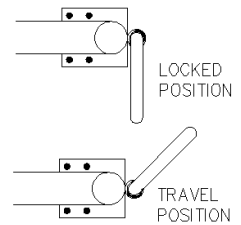

Figure 7

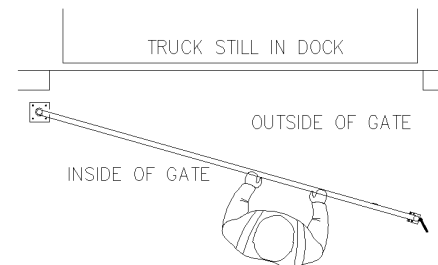

Figure 8

6. Grab the gate pin rotate 135 degrees clockwise to align gate pin with gate pin guide in tube slot see figure 8.
7. Push the gate pin downward to engage the gate pin with drilled receiver hole in concrete floor.

DIVERSIFIED FALL PROTECTION LTD.

division of Lorad LLC
24400 Sperry Drive
Cleveland, OH 44145
www.fallprotect.com

info@fallprotect.com - (440)-348-9460
Loading Dock Rolling Safety Gate 3of4

Copyright © 2012 Diversified Fall Protection