



## SPARTAN WATER

5.0 kW | Water Heater

<b>Power:</b>	1500-5000 kW / 5,100-17,000 BTU
<b>Operating Voltage:</b>	12 V DC
<b>Fuel Consumption:</b>	0,16-0,5 l/h / 5.4-16.9 oz/hr
<b>Electricity Consumption:</b>	0,5-1,2 A
<b>Dimensions:</b>	L 424 mm / 16 11/16" W 165 mm / 6 1/2" H 309 mm / 12 3/16"
<b>Weight:</b>	10,6 kg / 23 lbs.
<b>Recommended Boat Size:</b>	9-12 m / 29-40 ft



New Wallas Spartan Water is a water heating system, which can be used solely for heating domestic fresh water or it can also be used to power up floor and radiator heating. Underfloor heating provides a consistent temperature profile around the cabin and the warm feeling when your bare feet are in direct contact with the floor. High levels of moisture and humidity at floor level can often be a breeding ground for dust mites and mold, but switching to an underfloor heating system allows you to drastically improve the hygiene all around. Additionally, Spartan Water can be turned on remotely with the Wallas App even from the comfort of your home, which saves a tremendous amount of time. Spartan Water is an excellent option for other off-grid applications as well, for instance, camper vans, cottages, office/break room containers, or construction trailers.

## 3008 ADVANCED

THERMO | Control Panel

- If Spartan Water is used solely as a fresh water tank heater, the only function needed is ON/OFF.
- If a second water pump is installed for floor heating, the control panel allows you to set a target room temperature and the thermostat maintains a smooth ambient temperature in the space.
- The simple display shows all the pertinent information at one glance.





**ENERGY EFFICIENT**

**LOW RUNNING COSTS**

**ULTRA-LOW EMISSIONS**

**BETTER INDOOR AIR QUALITY**

## SPARTAN WATER

Small solar panel charges the 12 V battery.

Spartan Water heats up the fresh water tank providing hot water even in distant off-grid locations.

Boat WiFi modem is needed for long distance remote access with the Wallas App.

12 V battery as a power source.

With a second water pump installed, Spartan Water can also be used for underfloor and radiator heating.

Coolant expansion tank for safety.

Fuel for the heater can be drawn from the main fuel tank.

Coolant circulation hoses heat water in the hot water tank.

## FEATURES

- Advanced Control Panel enables intelligent temperature control.
- Wireless temperature sensing for improved accuracy.
- Fully enclosed laminar combustion is a safe burning process with no exposed flame.
- Brushless motors have a very long life-cycle, supporting reliably long service intervals.
- Delivers heat to a hot water tank and/or for floor and radiator heating.
- Floor heating dispenses even heat to the indoor space and provides the added comfort of warm floors under your feet.
- No burning hot heater grilles for everyone's safety.
- Made of stainless steel, high-grade aluminum, and other corrosion-resistant materials.



*Wireless temperature sensor monitors cabin temperature with improved accuracy and flexibility.*

# SPARTAN WATER

5.0 kW | Water Heater

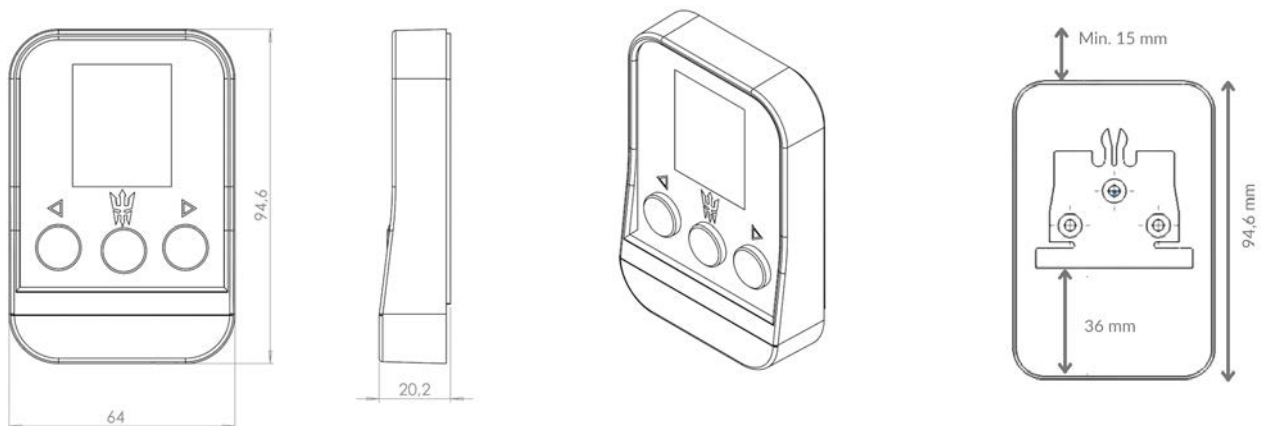
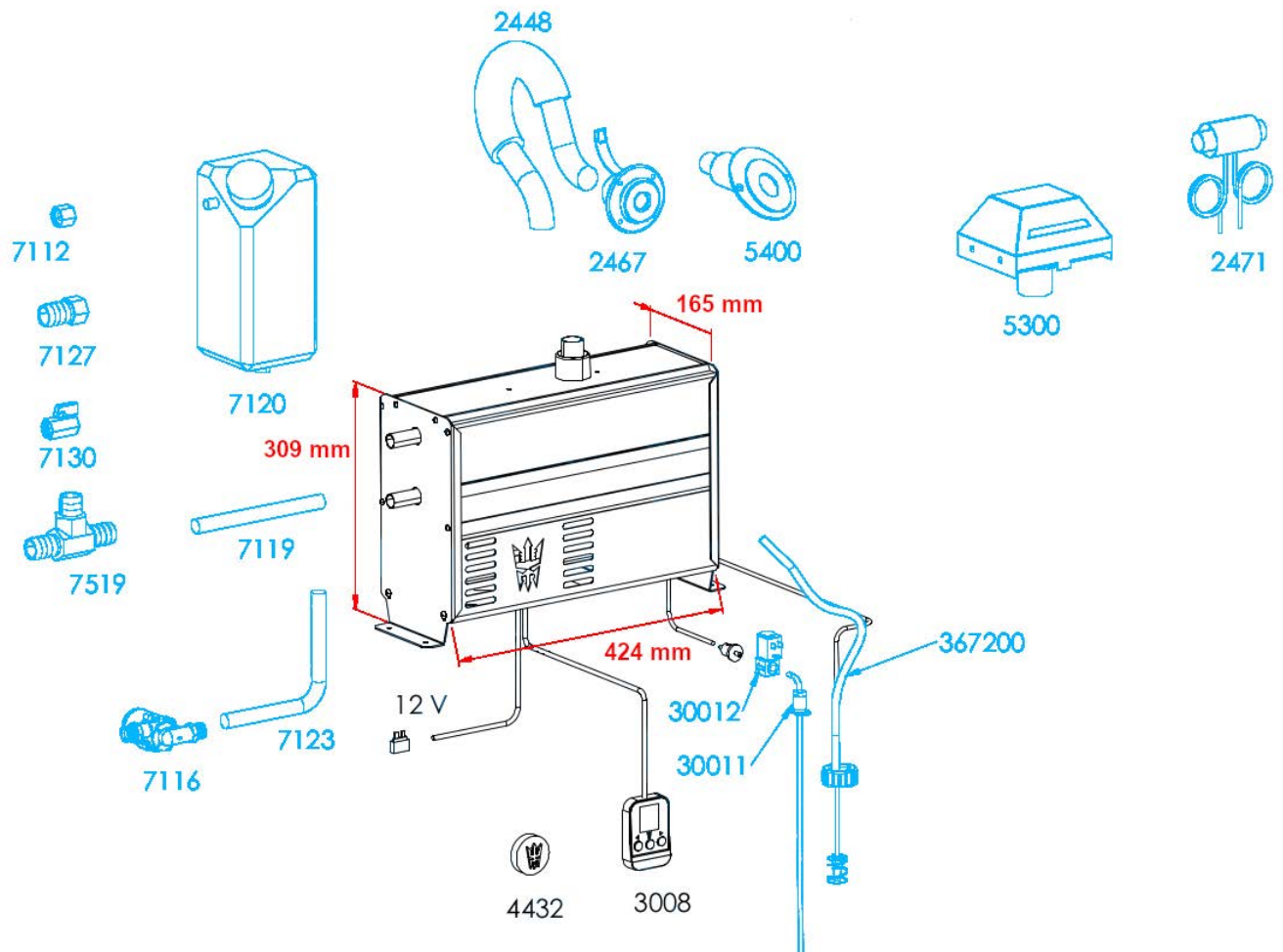

Accessories in black come with the standard package. Accessories in blue are additional/optional.  
 The calculated values are measured in a reference measurement wall, which is constructed to represent a typical boat installation. The technical values have been measured with the maximum length of ducting, exhaust pipe, fuel line, and power cord.  
 The figures allow for 10 % reserve - yours may vary.