

13ft x 13ft x 86in (3.96m x 3.05m x 2.18m)

CP-1313OS Octagon Screen House

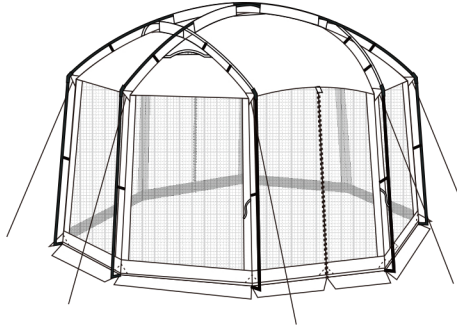

We offer every customer 12-Month Warranty,
please send us your order number to activate your warranty.

hicamper@unipros.com.cn

Parts list:

 **A** Roof Poles
(**Black**) x 2

 **B** Roof Middle poles
(**Burgandy/Yellow**) x 2

 **C** Steel Leg Poles
(**Black**) x 8



D Skin

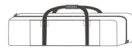

E Carry bag



F Stake x 18

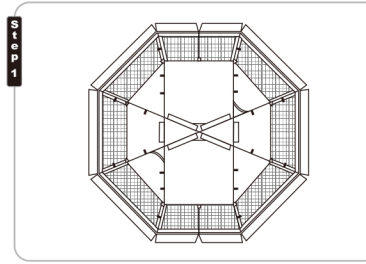

1) Empty the bag and confirm all parts are included and undamaged.

✈ Do this at home before leaving on the trip.

2) Select a smooth level site. Lay all parts of the structure out on a flat open area. Extend poles and sort into groups, ie. roof poles, leg poles. This will simplify the assembly process.

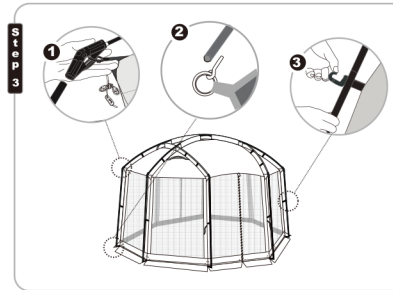

1) Insert a steel leg pole into the smooth end of each elbow connector.

2) secure the other end of pole onto the pin-rings at base of screen house. Repeat for all leg poles.

3) Attach clips along the edges of tent to body poles.

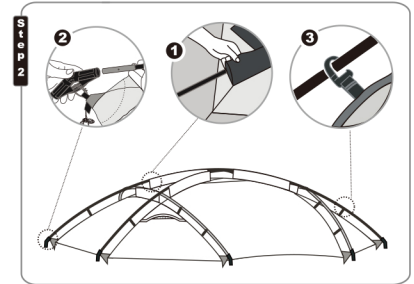

1) Take the longer roof poles and push them through the center pole sleeves, creating an "X". Gently flex each pole and place ends into ribbed openings of elbow connectors.

2) Slide the remaining shorter middle roof poles through the pole sleeves, again insert ends into ribbed openings of all remaining elbow connectors.

3) Snap J-hooks which are sewn on the screen house body over each roof pole to shape the screen house roof.

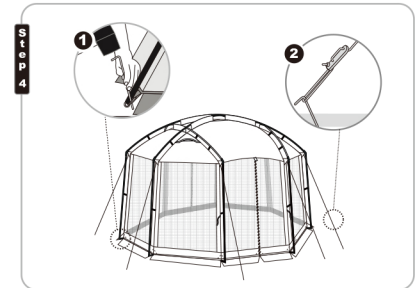

1) Stake down the screen house corners through the stake rings.

2) Adjust the sliders to make sure the guy lines are tight.