

12ft x 12ft x 92in (3.66m x 3.66m x 2.34m)

CP-1212S Screen House

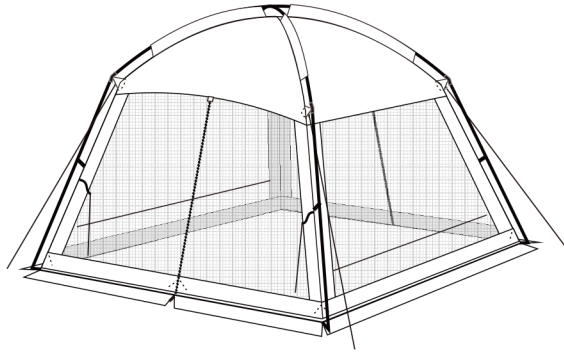

We offer every customer 12-Month Warranty,
please send us your order number to activate your warranty.

hicamper@unipros.com.cn

Parts list:

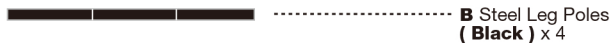

C Skin

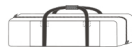

D Carry bag



E Stake x 12

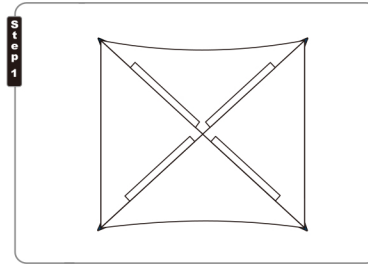

1) Empty the bag and confirm all parts are included and undamaged.

Do this at home before leaving on the trip.

2) Select a smooth level site. Lay all parts of the structure out on a flat open area. Extend poles and sort into groups, ie. roof poles, leg poles. This will simplify the assembly process.

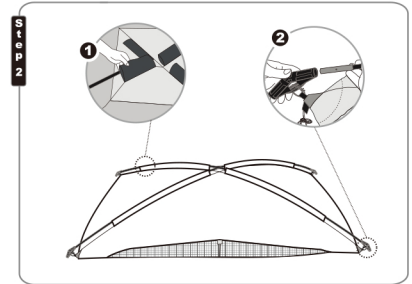

1) Take the longer roof poles and push them through the center pole sleeves.
2) Slide the remaining shorter middle roof poles through the khaki pole sleeves, again insert ends into ribbed openings of all remaining elbow connectors.



1) Insert a steel leg pole into the smooth end of each elbow connector.

2) secure the other end of pole onto the pin-rings at base of screen house. Repeat for all leg poles.

3) Attach clips along the edges of tent to body poles.

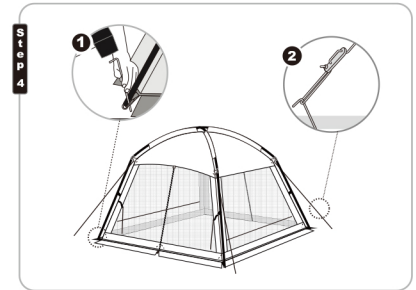

1) Stake down the screen house corners through the stake rings.

2) Adjust the sliders to make sure the guy lines are tight.