

10ft x 10ft x 86in (3.05m x 3.05m x 2.18m)

CP-101086S Screen House

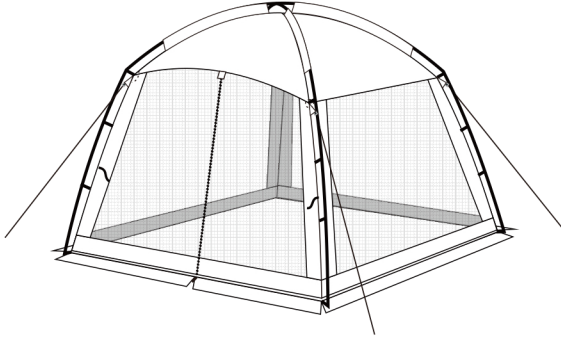

We offer every customer 12-Month Warranty,
please send us your order number to activate your warranty.

hicamper@unipros.com.cn

Parts list:

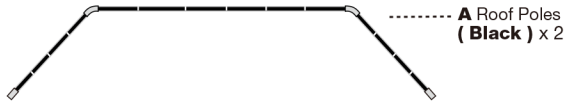

B Skin



C Carry bag



D Stake x 10

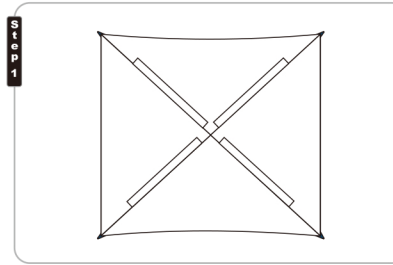

- 1) Empty the bag and confirm all parts are included and undamaged.
Do this at home before leaving on the trip.
- 2) Select a smooth level site. Lay all parts of the structure out on a flat open area. Extend poles and sort into groups, ie. roof poles, leg poles. This will simplify the assembly process.

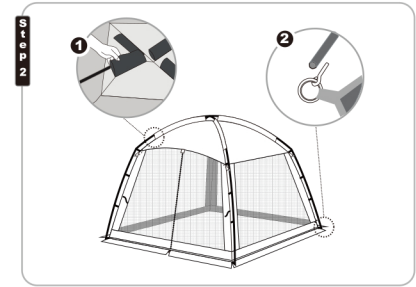

- 1) Insert the poles first, then insert the pole into the pole sleeves.
- 2) Connect poles to the tent with the pins of the grommets. Repeat for all poles.

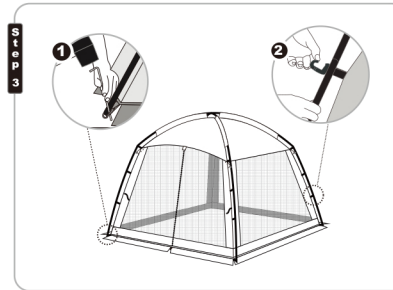

- 1) Stake down the screen house corners through the stake rings.
- 2) Attach clips along the edges of tent to body poles.



- 1) Adjust the sliders to make sure the guy lines are tight.

Sewing here

15cm