

# CADENCE

**Our Mission:**

To design and build exciting products that make your audio system look and perform at its absolute best, whether you are an SPL competitor, sound quality fanatic or just looking to upgrade your car or home system. To supply handcrafted US made and overseas products that last a lifetime. Products we are proud to own, sell and recommend to our families and friends. To do that, at the lowest prices we can, while supplying our customer the most value. To never manufacture products, that we would not be proud to ship.

P: 800-477-2328

P: 626-465-3383

918 Canada Court, City of Industry, CA 91748 USA



**Facebook**



**Official Website**



**2019**  
MOBILE AUDIO



# CADENCE

## Table of Contents

<b>Amplifier</b>	<b>3 - 6</b>
<b>Speaker &amp; Component Kit</b>	<b>7-14</b>
<b>Tweeter</b>	<b>15</b>
<b>Woofers</b>	<b>16 - 22</b>
<b>Enclosure</b>	<b>23 - 26</b>
<b>Pro Series</b>	
Woofer & Midbass	<b>28 - 29</b>
Midrange & Components Kit	<b>30 - 32</b>
Horn Driver / Horn & Driver	<b>33 - 34</b>
Compression Tweeter	<b>35</b>
<b>Processors &amp; Controller</b>	<b>36</b>
<b>EQs / Signal Processor</b>	<b>37 - 38</b>

### Performance Key

LEVEL 1

**PERFORMANCE**

#### The OEM Upgrade

Tired of the flat, boring, OEM sound? Add life back to your music by upgrading your stock equipment.

LEVEL 2

**ADVANCED PERFORMANCE**

#### Designed for the Music Lover

Where performance and value meet. Crank it up without stressing your speakers or your ears.

LEVEL 3

**ULTRA PERFORMANCE**

#### Designed for the Enthusiast

Bring the concert hall to your car. Smooth highs, clear accurate vocals, and deep thunderous bass.

LEVEL 4

**PROFESSIONAL**

#### Designed for Competitors

Designed, built, and tested for the competitor and serious audiophile.

# **CADENCE *C2* INTRODUCTION**

Over the years, Cadence has introduced Mobile Electronic Aftermarket products that not only excel in their ability to reproduce the dynamics of music accurately, but also in their ability to integrate within the confines of today's vehicles.

## **Newest Technology and Outstanding Service**

As we introduce the new Series of **C2** products from Cadence, we want to emphasize that the commitment of building outstanding products designed for the enthusiast who will not accept any compromise yet recognizes true value has not changed.

The new Cadence **C2** Series will deliver an outstanding product with exceptional value, that also will show our dedication and commitment to the brick and mortar independent retailer. With a 60 day over the counter exchange, an additional 1-year warranty, and the knowledge of a trained authorized dealer installing your product, so you secured the best value for your dollar.

## **Terminate your Internet Nightmare**

All product is Serialized and Trackable, has a higher MAP Policy and will not be sold to unauthorized distributors who supply the chains of "the internet seller".

If you purchase Cadence **C2** products on the internet be forewarned: Cadence will not honor any warranty claim(s) on products purchased from unauthorized sellers. Purchasing Cadence **C2** products from an authorized retailer means you are guaranteed. Contact Cadence at (626) 465-3383 for more information.

## Q 2404

Model Pictured

Q Series Amplifiers taking you to a new standard for both Novice and Experienced audio aficionado, with a full feature set and state-of-art electronics and > 80% efficiency on D Class Mono Blocks, our newest circuit design dramatically improves both output power and sound.

# 600W

### Chassis

Aluminum Extruded Chassis

### End Caps

Custom Molded Plastic End Caps



### Inputs

Low Level RCA Inputs

### LED Indicators

Power and Diagnostic



### Dashboard Bass Remote

Monoblock & 5CH Included



50 Hz - 250Hz



50Hz - 250Hz



Bass Boost



Full Range



### Class D Monoblock

Q 3001D	750W
Q 5001D	1250W
Q 10001D	2500W

### Class AB Full Range

(2CH) Q 1202	300W
(2CH) Q 1602	400W
(4CH) Q 2404	600W
(5CH) Q 4705	1175W

	MONO BLOCK			2 CHANNEL		4 CHANNEL	5 CHANNEL
MODEL /SPECIFICATION	Q 3001D	Q 5001D	Q 10001D	Q 1202	Q 1602	Q 2404	Q 4705
Channel/Class	Mono / D	Mono / D	Mono / D	2 / AB	2 / AB	4 / AB	5 / AB
RMS Power @1 Ohm-14.4V	300W x 1	500W x 1	1000W x 1	-	-	-	-
RMS Power @2 Ohm-14.4V	230W x 1	300W x 1	600W x 1	90W x 2	125W x 2	60Wx2+90Wx2	60W x 4
RMS Power @4 Ohm-14.4V	140W x 1	200W x 1	350W x 1	60W x 2	80W x 2	60W x 4	-
Bridged RMS Power @4 Ohm-14.4V	-	-	-	130W x 1	170W x 1	60Wx2+130Wx1	-
Subwoofer Channel @2 Ohm-14.4V	-	-	-	-	-	-	230W
Fuse Rating	20A x 2	30A x 2	35A x 3	25A x 1	35A x 1	20A x 2	30A x 3
Dimensions (L *W *H) inch	11.9x7.1x2.05	13.07x7.1x2.05	14.65x7.1x2.05	11.02x7.1x2.05	11.89x7.1x2.05	12.68x7.1x2.05	17.91x7.1x2.05
Unit Weight	2.02KG	2.30KG	2.8KG	1.77KG	1.9KG	2.22KG	3.4KG

# QR 1000.1

Model Pictured

The all new Mid-size QR Class of amplifiers, with > 80% efficiency full Range Class D design there is less of a strain on your vehicles charging system. Fully protected from all types of faults including short circuit, low voltage, and low impedance protection, Thermal protection utilizes and thermal rollback to help with annoying thermal shutdowns. Small footprint design for easy installation in tight areas. A wide range of crossover setting along with bass EQ enhancement circuits all easily controlled, also a remote level control knob for control (mono blocks) High level auto start technology for easy OEM amp replacement and systems in without a remote turn on circuit.

# 1000 W

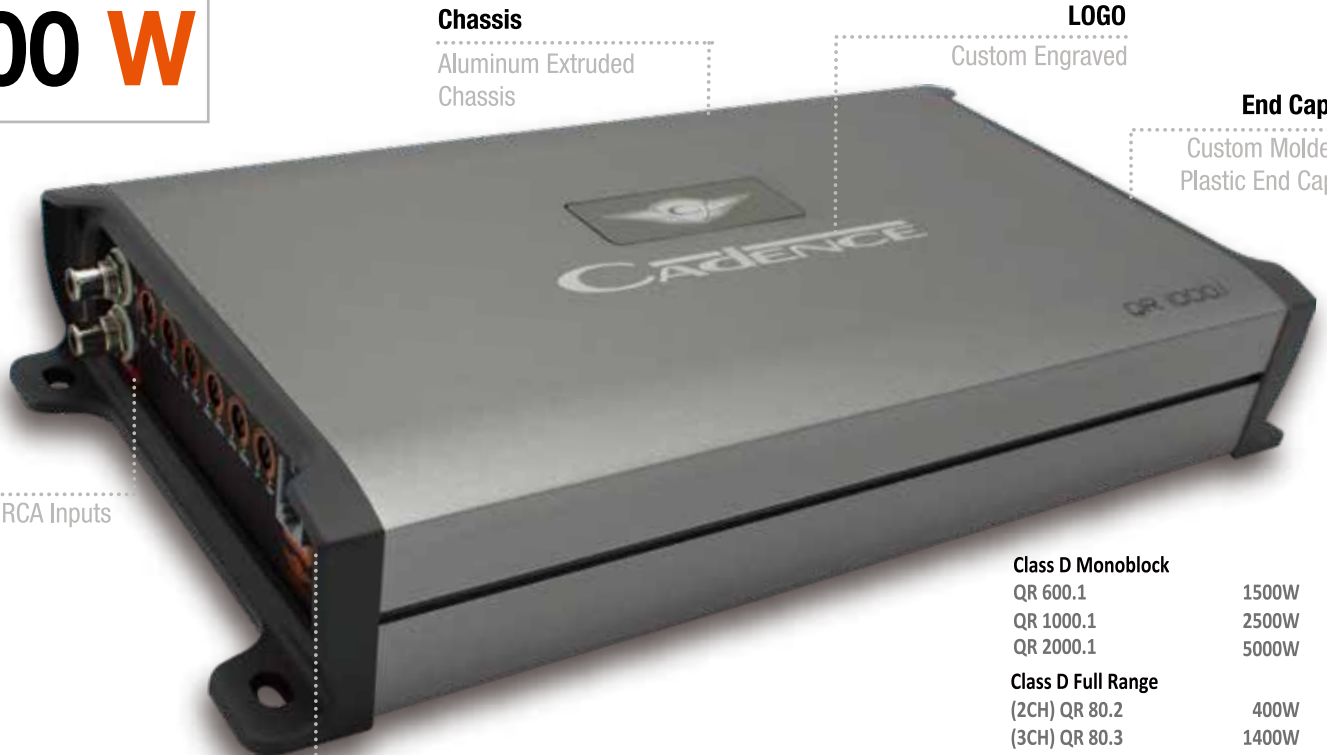

**Inputs**

Low Level RCA Inputs

**LED Indicators**

Power and Diagnostic



**Dashboard Bass Remote**

Monoblock & 3CH & 5CH Included

**Class D Monoblock**

QR 600.1	1500W
QR 1000.1	2500W
QR 2000.1	5000W

**Class D Full Range**

(2CH) QR 80.2	400W
(3CH) QR 80.3	1400W
(4CH) QR 80.4	1000W
(5CH) QR 80.5	1800W



50Hz - 250Hz



Bass EQ



Bass Boost



Sub Sonic Filter



MODEL / SPECIFICATION	MONO BLOCK			2 CHANNEL	3 CHANNEL	4 CHANNEL	5 CHANNEL
	QR600.1	QR1000.1	QR2000.1	QR80.2	QR80.3	QR80.4	QR80.5
Channel / Class	Mono / D	Mono / D	Mono / D	2 / D	3 / D	4 / D	5 / D
RMS Power @1 Ohm -14.4V	600W x 1	1000W x 1	2000W x 1	-	-	-	-
RMS Power @2 Ohm -14.4V	400W x 1	650W x 1	1250W x 1	120W x 2	-	80Wx2+125x2	125W x 4
RMS Power @4 Ohm -14.4V	250W x 1	400W x 1	800W x 1	80W x 2	80W x 2	80W x 4	80W x 4
Bridged RMS Power @4 Ohm -14.4V	-	-	-	240W x 1	-	80Wx2+240x1	-
Subwoofer Channel @2 Ohm -14.4V	-	-	-	-	400W x 1	-	400W x 1
Fuse Rating	35A x 2	40A x 3	External	10A x 2	Ext. 60A x 1	25A x 2	Ext. 80A x 1
Dimensions(LxWxH) inch	10.63x6.3x2.05	12.20x6.3x2.05	17.72x6.3x2.05	7.48x6.3x2.05	12.20x6.3x2.05	9.21x6.3x2.05	13.94x6.3x2.05
Unit	2.07KG	2.5KG	4.1KG	1.28KG	2.3KG	1.7KG	2.8KG



The new QRS amplifiers bring's back Sound Quality and Dynamics in one package with their H class design not only are you getting great Sound Quality, you also get better power efficiency throughout the power range. Let the NEW QRS amplifiers bring out the Blues. Country. Hip hop. Jazz. Pop. Reggae. R&B. Rock. Alternative. Metal. Punk. Electronica. Techno and even the Psychedelic in you.

# QRS4.125GH

Model Pictured

**1250W**

**LOGO**  
Custom Engraved



**Dashboard Bass Remote**  
Monoblock & 5CH Included



**Inputs**  
Low Level RCA

**Controls**  
Crossovers, Input Level and EQ

**LED Indicators**  
Power and Diagnostic

**MONO BLOCK**

MODEL / SPECIFICATION	QRS1.1800D	QRS1.3000D
Channel Class	Mono / D	Mono / D
RMS Power @1 Ohm -14.4V	1800W x1	3000W x1
RMS Power @2 Ohm -14.4V	1200W x1	1950W x1
RMS Power @4 Ohm -14.4V	800W x1	1400W x1
Bridged RMS Power @4 Ohm -14.4V	-	-
Subwoofer Channel @4 Ohm -14.4V	-	-
Subwoofer Channel @2 Ohm -14.4V	-	-
Minimum THD	0.05%	0.05%
S/N Ratio	>86dB	>86dB
Fuse Rating	External	External
Dimensions(LxWxH) inch	15.75x7.56x2.32	22.64x7.56x2.32

Class D Monoblock	
QRS 1.1800D	4500W
QRS 1.3000D	7500W

**PROFESSIONAL**



### Chassis

Aluminum Extruded Chassis

## 1 CHANNEL



## 2 CHANNEL



## 4 CHANNEL



## 5 CHANNEL



<b>Class G/H Monoblock</b>	
QRS 1.600GH	1500W
QRS 1.1500GH	3750W
<b>Class G/H Full Range</b>	
(2CH) QRS 2.180GH	900W
(2CH) QRS 2.300GH	1500W
(4CH) QRS 4.125GH	1250W
(4CH) QRS 4.900GH	900W
(5CH) QRS 5.905GH	2150W

MODEL / SPECIFICATION	MONO BLOCK		2 CHANNEL		4 CHANNEL		5 CHANNEL
	QRS1,600GH	QRS1,1500GH	QRS2,180GH	QRS2,300GH	QRS4,125GH	QRS4,90GH	QRS5,905GH
Channel Class	Mono G / H	Mono G / H	2 G / H	2 G / H	4 G / H	4 G / H	5 G / H
RMS Power @1 Ohm -14.4V	-	1500W x 1	-	-	-	-	-
RMS Power @2 Ohm -14.4V	600W x 1	1000W x 1	300W x 2	450W x 2	200W x 4	135W x 4	135W x 4
RMS Power @4 Ohm -14.4V	400W x 1	660W x 1	180W x 2	300W x 2	125W x 4	90W x 4	90W x 4
Bridged RMS Power @4 Ohm -14.4V	-	-	600W x 1	900W x 1	400W x 2	270W x 2	-
Subwoofer Channel @4 Ohm -14.4V	-	-	-	-	-	-	260W x 1
Subwoofer Channel @2 Ohm -14.4V	-	-	-	-	-	-	500W x 1
Minimum THD	0.05%	0.05%	0.05%	0.05%	0.05%	0.05%	0.05%
S/N Ratio	>86dB	>86dB	>86dB	>86dB	>86dB	>86dB	>86dB
Fuse Rating	30A x 2	External	35A x 2	35A x 3	35A x 3	35A x 2	External
Dimensions(LxWxH) inch	13.78x7.56x2.32	21.06x7.56x2.32	13.78x7.56x2.32	16.93x7.56x2.32	17.60x7.56x2.32	14.29x7.56x2.32	21.39x7.56x2.32



### Full Range Speakers

- **Basket:** Rolled Steel
- **Bridge:** Black and Orange Plated Finish
- **Cone:** PP Mica
- **Surround:** Cloth Surround
- **Tweeter:** Extended Frequency Dome



**IQ 422GE**



**IQ 652GE**



**IQ 552GE**



**IQ 653GE**



**IQ 462GE**



**IQ 673GE**



**IQ 573GE**

	2-WAY				3-WAY			
<b>Model Number</b>	<b>IQ 422GE</b>	<b>IQ 462GE</b>	<b>IQ 552GE</b>	<b>IQ 652GE</b>	<b>IQ 573GE</b>	<b>IQ 653GE</b>	<b>IQ 673GE</b>	<b>IQ 693GE</b>
<b>Size</b>	4 in.	4x6 in.	5.25 in.	6.5 in.	5x7 in.	6.5 in.	6.75 in.	6x9 in.
<b>RMS/Peak Power</b>	30/75 Watts	35/80 Watts	40/100 Watts	50/125 Watts	50/125 Watts	55/140 Watts	55/140 Watts	60/150 Watts
<b>Frequency Response</b>	100Hz-20KHz	85Hz-20KHz	80Hz-20KHz	70Hz-20KHz	70Hz-20KHz	70Hz-20KHz	70Hz-20KHz	55Hz-20KHz
<b>SPL@1w/1m</b>	87dB @ 1w/1m	87dB @ 1w/1m	88dB @ 1w/1m	89dB @ 1w/1m	89dB @ 1w/1m	90dB @ 1w/1m	90dB @ 1w/1m	90dB @ 1w/1m
<b>Magnet</b>	11 oz.	11 oz.	11 oz.	16 oz.	16 oz.	20 oz.	20 oz.	24 oz.
<b>System Impedance</b>	4 Ohms	4 Ohms	4 Ohms	4 Ohms	4 Ohms	4 Ohms	4 Ohms	4 Ohms
<b>Mounting Depth</b>	1.69 in.	1.93 in.	1.73 in.	2.13 in.	2.13 in.	2.13 in.	2.13 in.	2.87 in.







**IQ 693GE**



**IQ 65KGE**

**2-Way Component Speaker**

<b>Model Number</b>	<b>IQ 65KGE</b>
Size	6.5 in.
RMS/MAX Power	60/150 Watts
Frequency Response	60Hz-20KHz
SPL@1w/1m	89dB @ 1w/1m
Magnet	20 oz.
System Impedance	4 Ohms
Mounting Depth	2.45 in. 2.13 in. ( Woofer ) 0.77 in. ( Tweeter )



**PERFORMANCE**



**Q 942**



**Q 965**



**Q 952**



**Q 968**

**Full Range Speakers**

- **Basket:** Rolled Steel
- **Bridge:** Black and Orange Plated Finish
- **Cone:** Metallic Black Polypropylene
- **Surround:** Butyl Rubber
- **Tweeter:** Extended Frequency Dome

	2-WAY				3-WAY
Model Number	<b>Q 942</b>	<b>Q 952</b>	<b>Q 965</b>	<b>Q 968</b>	<b>Q 969</b>
Size	4 in.	5.25 in.	6.5 in.	6x8/5x7 in.	6x9 in.
RMS/MAX Power	35/85 Watts	45/115 Watts	55/140 Watts	55/140 Watts	65/170 Watts
Frequency Response	85Hz-20KHz	80Hz-20KHz	70Hz-20KHz	70Hz-20KHz	55Hz-20KHz
SPL@1w/1m	87dB @ 1w/1m	88dB @ 1w/1m	89dB @ 1w/1m	89dB @ 1w/1m	90dB @ 1w/1m
Magnet	11 oz.	11 oz.	18 oz.	18 oz.	26oz.
System Impedance	4 Ohms	4 Ohms	4 Ohms	4 Ohms	4 Ohms
Mounting Depth	1.69 in.	1.69 in.	2.21 in.	2.30 in.	3.25 in.







**Q 969**



**Q 965K**

**2-Way Component Speaker**

<b>Model Number</b>	<b>Q 965K</b>
<b>Size</b>	6.5 in.
<b>RMS/MAX Power</b>	65/150 Watts
<b>Frequency Response</b>	65Hz-21KHz
<b>SPL@1w/1m</b>	89dB @ 1w/1m
<b>Magnet</b>	22 oz.
<b>System Impedance</b>	4 Ohms
<b>Mounting Depth</b>	2.45 in.



**QR 942**



**QR 952**



**QR 965**



**QR 957**

**Full Range Speakers**

- **Basket:** Rolled Steel
- **Bridge:** Black and Orange Plated Finish
- **Cone:** Poly Mica Coated Paper
- **Surround:** TPU Rubber
- **Tweeter:** Extended Frequency Dome

	2-WAY				3-WAY
Model Number	QR 942	QR 952	QR 957	QR 965	QR 969
Size	4 in.	5.25 in.	5x7/6x8 in.	6.5 in.	6x9 in.
RMS/Peak Power	40/100 Watts	50/125 Watts	65/160 Watts	65/160 Watts	80/200 Watts
Frequency Response	80Hz-20KHz	65Hz-20KHz	60Hz-20KHz	60Hz-20KHz	50Hz-20KHz
SPL@1w/1m	88dB @ 1w/1m	89dB @ 1w/1m	90dB @ 1w/1m	90dB @ 1w/1m	92dB @ 1w/1m
Magnet	11 oz.	18 oz.	22 oz.	22 oz.	30 oz.
System Impedance	4 Ohms	4 Ohms	4 Ohms	4 Ohms	4 Ohms
Mounting Depth	1.93 in.	2.13 in.	2.51 in.	2.60 in.	3.19 in.







**QR 969**

**2-Way Component Speaker**

**Model Number**

**2-WAY Component**

	<b>QR 965K</b>	<b>QR 967K</b>
Size	6.5 in.	5x7/6x8 in.
RMS/Peak Power	70/180 Watts	70/180 Watts
Frequency Response	65Hz-20KHz	65Hz-20KHz
SPL@1w/1m	89dB @ 1w/1m	90dB @ 1w/1m
Magnet	22 oz.	22 oz.
System Impedance	4 Ohms	4 Ohms
Mounting Depth	2.60 in.(Woofer) .75 in.(Tweeter)	2.40 in.(Woofer) .75 in.(Tweeter)



**QR 957K**

**QR 965K**





**QRS 69C2**

**QRS 52C2**

**QRS 65C2**

**QRS 57C2**

**Full Range Speakers**

- **Basket:** Rolled Steel
- **Bridge:** Black and Orange Plated Finish
- **Cone:** Kevlar Composite Acrylic Woofer
- **Surround:** Butyl Rubber
- **Tweeter:** Extended Frequency Neodymium Dome

	2-WAY			3-WAY
<b>Model Number</b>	<b>QRS 52C2</b>	<b>QRS 65C2</b>	<b>QRS 57C2</b>	<b>QRS 69C2</b>
<b>Size</b>	5.25 in.	6.5 in.	5X7/6X8 in.	6X9 in.
<b>RMS/Peak Power</b>	65/150 Watts	80/180 Watts	80/180 Watts	100/250 Watts
<b>Frequency Response</b>	75Hz-20KHz	65Hz-20KHz	70Hz-20KHz	55Hz-20KHz
<b>SPL@1w/1m</b>	89dB @ 1w/1m	90dB @ 1w/1m	90dB @ 1w/1m	92dB @ 1w/1m
<b>Magnet</b>	22 oz.	22 oz.	22 oz.	41 oz.
<b>System Impedance</b>	4 Ohms	4 Ohms	4 Ohms	4 Ohms
<b>Mounting Depth</b>	2.56 in.	2.56 in.	2.4 in.	3.39 in.





QRS 6K2C2



Component Speaker

	2-WAY Component	3-WAY Component
<b>Model Number</b>	<b>QRS 6K2C2</b>	<b>QRS 6K3C2</b>
Size	6.5 in.	6.5 in.
RMS/Peak Power	85/200 Watts	100/250 Watts
Frequency Response	65Hz-20KHz	65Hz-20KHz
SPL@1w/1m	91dB @ 1w/1m	92dB @ 1w/1m
Magnet	26 oz.	26 oz.
System Impedance	4 Ohms	4 Ohms
Mounting Depth	2.56 in.(Woofer) .60 in.(Tweeter)	2.56 in.(Woofer) .60 in.(Tweeter) 1.38 in.(Midrange)

QRS 6K3C2

PROFESSIONAL



## Q 1TC2

1" High Performance Piezo Tweeter

\*Sold in Pairs

- **Tweeter:** 1" High Performance Piezo
- **Mount:** Surface Mount Only

**PERFORMANCE**



## Q 75TC2

1" Hybrid Tweeter

\*Sold in Pairs

- **Coil:** Built-In Diffuser and Step Up Transformer Coil
- **Housing:** Action Housing
- **Mounts:** Flush, Surface & Angle Mounts

**ADVANCED PERFORMANCE**



## QR 20TC2

3/4" Neodymium Dome Tweeter

\*Sold in Pairs

- **Housing:** Action Housing
- **Mounts:** Flush & Angle Mounts

**ADVANCED PERFORMANCE**



## QR 30T

1" High Performance Neodymium Tweeter

\*Sold in Pairs

- **Housing:** Swivel Action
- **Mounts:** Flush, Surface & Angle Mounts

**ULTRA PERFORMANCE**



### TWEETERS

Model Number	Q 1TC2	Q 75TC2	QR 20TC2	QR 30T
Size	1 in.	1 in.	3/4 in.	1 in.
RMS/MAX Power	50/100 Watts	100/200 Watts	30/60 Watts	30/60 Watts
Frequency Response	5KHz-22KHz	5KHz-22KHz	2.2KHz-22KHz	1.3KHz-24KHz
SPL@1w/1m	93dB @ 1w/1m	97dB @ 1w/1m	92dB @ 1w/1m	93dB @ 1w/1m
Magnet	Piezo	Piezo Hybrid	Neodymium	Neodymium
System Impedance	4 Ohms	4 Ohms	4 Ohms	4 Ohms
Mounting Depth	N/A	0.75 in.	0.65 in.	0.63 in.





**Cone**

Black Matte Finish  
Paper Cone

**Surround**

All natural rubber  
surround

**Dust Cap**

3-D Injected Poly  
Dust Cap

**Gasket**

Custom Molded  
with Cadence logo



**Basket**

Stamp Metal basket

**Voice Coil**

High Temp ASV voice coil

**Motor**

(CMD)technology for  
optimized magnetics

**MOMENTUM Subwoofers**

*The Performance of the Momentum Subwoofers has been taken up a notch from last year. With A new Magnet Motor Structure and 600 Watts MAX of Handling Power, the new Momentum Subwoofer will be the new standard for Performance and Value.*

SUBWOOFER

Model Number	CMW104S	CMW124S
Size	10 in.	12 in.
RMS/Peak Power	300/600 Watts	350/700 Watts
Frequency Response	33Hz-1.5KHz	30Hz-1.8KHz
SPL@1w/1m	89dB @ 1w/1m	91dB @ 1w/1m
System Impedance	4 Ohms	4 Ohms
Mounting Depth	5.01 in.	5.49 in.
Voice Coil	2" VC	2" VC
Magnet	72 oz.	72 oz.

## Ultra Drive Subwoofers

The New Ultra Drive Subwoofers have been revised for dramatically improved output and sound quality. The improved performance was achieved by revising both suspension, and motor structure. These improvements result in longer linear excursion and lower distortion with improved durability.

### Suspension Improvements:

The surround is now a rugged Santoprene rubber surround that will support long linear excursions with improved reliability. The high flex life Conex spider/damper has been revised in roll shape and material to compliment the improved surround.

### Motor Structure Improvements:

The motor structure has been revised using FEA analysis to provide low distortion output at both high and low power levels. This results in more linear motor force within the subwoofers normal operating excursion and power levels for both negative and positive current through the voice coil.



### SUBWOOFER

Model Number	UD 8D2/D4	UD 10D2/D4	UD 12D2/D4	UD 15D2/D4
Size	8 in.	10 in.	12 in.	15 in.
RMS/Peak Power	250/500 Watts	350/700 Watts	450/900 Watts	600/1200 Watts
Frequency Response	38Hz-500Hz	33Hz-500Hz	28Hz-500Hz	25Hz-500Hz
SPL@1w/1m	92dB @ 1w/1m	91dB @ 1w/1m	93dB @ 1w/1m	94dB @ 1w/1m
System Impedance	2/4 Ohm DVC	2/4 Ohm DVC	2/4 Ohm DVC	2/4 Ohm DVC
Mounting Depth	5.0 in.	5.56 in.	6.18 in.	8.35 in.
Voice Coil	2" VC	2" VC	2" VC	2.5" VC
Magnet	37 oz.	53 oz.	64 oz.	72 oz.



### Ultra Shock Subwoofers

Ultra Shock Subwoofers have been re-engineered for improved output performance and sound quality. No part was left untouched, new materials used for surround and spider, revised stronger baskets, improved stronger and larger motor structures.

#### Suspension Improvements:

The surround is now a rugged Santoprene rubber surround that will support long linear excursions with improved reliability. The high flex life Conex spider/damper has been revised in roll shape and material to compliment the improved surround.

#### Motor Structure Improvements:

Magnet sizes and voice coil winding lengths have all been adjusted for improved performance output and sound quality. The motor structures were engineered using FEA analysis to provide low distortion output at both high and low power levels. This results in more linear motor force within the subwoofers normal operating excursion and power levels for both negative and positive current through the voice coil.



SUBWOOFER

Model Number	US 8D2/D4	US 10D2/D4	US 12D2/D4	US15D2/D4
Size	8 in.	10 in.	12 in.	15 in.
RMS/Peak Power	300/600 Watts	600/1200 Watts	750/1500 Watts	1000/2000 Watts
Frequency Response	38Hz-500Hz	31Hz-500Hz	28Hz-500Hz	25Hz-500Hz
SPL@1w/1m	92dB @ 1w/1m	91dB @ 1w/1m	93dB @ 1w/1m	94dB @ 1w/1m
System Impedance	2/4 Ohm DVC	2/4 Ohm DVC	2/4 Ohm DVC	2/4 Ohm DVC
Mounting Depth	5.0 in.	6.0 in.	6.6 in.	8.15 in.
Voice Coil	2" VC	2.5" VC	2.5" VC	3" VC
Magnet	80 oz.	100 oz.	126 oz.	196 oz.





## SL Subwoofers

New SL Subwoofers have dramatically improved output and sound quality over the previous S5 Subwoofers. The improved performance was achieved by revising both suspension, and motor structure. These improvements result in longer linear excursion and lower distortion with improved durability.

### Suspension Improvements:

The surround is now a rugged tall half roll surround that will support long linear excursion with improved reliability. The high flex life Conex spider/damper has been revised in roll shape and material to compliment the improved surround.

### Motor Structure Improvements:

The motor structure has been revised using FEA analysis to provide low distortion output at both high and low power levels. This results in more linear motor force within the sub woofers normal operating excursion and power levels for both negative and positive current through the voice coil



#### SUBWOOFER

Model Number	SLW10S2/S4	SLW12S2/S4
Size	10 in.	12 in.
RMS/Peak Power	250/500 Watts	250/500 Watts
Frequency Response	36Hz-500Hz	31Hz-500KHz
SPL@1w/1m	86dB @ 1w/1m	88dB @ 1w/1m
System Impedance	2/4 Ohm SVC	2/4 Ohm SVC
Mounting Depth	3.46 in.	3.86 in.
Voice Coil	2" VC	2" VC
Magnet	40 oz.	50 oz.





## BEAST Subwoofers

**SIMPLY ONE OF THE BEST  
BALANCED DESIGNED WOOFER  
THAT CADENCE CAN MAKE.  
THE BEAST BRINGS  
TECHNOLOGY TO FOREFRONT  
FOR SOUND PERFORMANCE  
AND OUTPUT FOR SIMPLY  
ONE OF THE BEST  
SQL DESIGNS.**



### Surround

High Excursion Natural Rubber Surround

### Motor

Magnet Motor with Heat Pump Cooling Technology

### Vents

Aero Style Magnet Motor Vent

### Voice Coil

Aluminum 4-Layer Voice Coil

### Spider

Dual Layer Linear Progressive Conex Spiders

### Cone

Reinforced Ultra-Stiff Paper Composite Cone



### Basket

Cast Aluminum Frame

### SUBWOOFER

Model Number	BT 10D2/D4	BT12D2/D4	BT 15D2D4
Size	10 in.	12 in.	15 in.
RMS/Peak Power	750/1500 Watts	800/1600 Watts	1000/2000 Watts
Frequency Response	28Hz-800Hz	26Hz-800Hz	23Hz-800Hz
SPL@1w/1m	87dB @ 1w/1m	88dB @ 1w/1m	90dB @ 1w/1m
System Impedance	D2/D4 Ohms	D2/D4 Ohms	D2/D4 Ohms
Mounting Depth	6.30 in.	6.89 in.	7.95 in.
Voice Coil	2.5" VC	3" VC	3" VC
Magnet	111 oz.	132 oz.	153 oz.

ULTRA PERFORMANCE

### Wild Beast Subwoofers

New Wild Beast Subwoofers have been completely re-engineered. With longer linear excursion, improved power handling and excellent sound quality, they offer the ultimate performance in SQL Subwoofers. New from the bottom up: the new materials compliment the improved design, new high strength aramid fiber reinforced pulp cone with high strength black fiberglass dust cap, new die cast baskets, improved stronger & larger motor structures, and 10 Gauge High Current Push Pin Terminals.

#### Motor Structure Improvements:

Magnet sizes and voice coil winding lengths have all been adjusted for improved performance output and sound quality. The motor structures were engineered using FEA analysis to provide low distortion output at both high and low power levels. This results in more linear motor force within the subwoofers normal operating excursion and power levels for both negative and positive current through the voice coil



**Motor**

FEA Optimized High BL Motor Structure

**Voice Coil**

with Black Aluminum Former

**Basket**

Cast Aluminum Frame

**Cone**

Ultra Stiff Woven Fiber Glass Cone

#### SUBWOOFER

Model Number	WB 12D2	WB 12D4	WB 15D2	WB 15D4
Size	12 in.	12 in.	15 in.	15 in.
RMS/Peak Power	1200/2400 Watts	1200/2400 Watts	1500/3000 Watts	1500/3000 Watts
Frequency Response	20Hz-500Hz	20Hz-500Hz	20Hz-500Hz	20Hz-500Hz
SPL@1w/1m	87dB @ 1w/1m	87dB @ 1w/1m	89dB @ 1w/1m	89dB @ 1w/1m
System Impedance	2 Ohms DVC	4 Ohms DVC	2 Ohms DVC	4 Ohms DVC
Mounting Depth	7.52 in.	7.52 in.	8.39 in.	8.39 in.
Voice Coil	3" VC	3" VC	3" VC	3" VC
Magnet	233 oz.	233 oz.	260 oz.	260 oz.



**Motor**

Magnet Motor Heatsink with Heat Pump Cooling Technology and Peripheral Multivent System

**Washer Plate**

Double Thick Washer Plate with Energy Concentrating Angles

**Spider**

Quad Spider Suspension System with Flex-Back Technology and Dual Elevation Platforms for Excursion Control

**Basket**

Cast Aluminum with Composite Strength Design

**Magnet**

Ultra Saturated High BL Magnetic Motor Gap; Extended Pole Piece Technology

**Terminals**

10 gauge High Current Push Pin Terminals

**Voice Coil**

Made in the USA 4" Super High Power 4 Layer Flat Wire Dual Voice Coil

**Cone**

Ultra Stiff Complex Fiber Glass Spun Material

**Surround**

High Density Laminated Stitched Foam

**6,500W**

	SUBWOOFER			
Model Number	BM 12D1	BM 12D2	BM 15D1	BM 15D2
Size	12 in.	12 in.	15 in.	15 in.
RMS/Peak Power	2K/5K Watts	2K/5K Watts	2.5K/6.5K Watts	2.5K/6.5K Watts
Frequency Response	25Hz-500Hz	25Hz-500Hz	25Hz-500Hz	25Hz-500Hz
SPL@1w/1m	88dB @ 1w/1m	88dB @ 1w/1m	90dB @ 1w/1m	90dB @ 1w/1m
System Impedance	1 Ohms DVC	2 Ohms DVC	1 Ohms DVC	2 Ohms DVC
Mounting Depth	8.03 in.	8.03 in.	8.82 in.	8.82 in.
Voice Coil	4" VC	4" VC	4" VC	4" VC
Magnet	320 oz.	320 oz.	400 oz.	400 oz.



PROFESSIONAL

## FXB 12VA

12" Active Ported Box



**500W**

**Model Number**

**FXB 12VA**

<b>Enclosure Type</b>	Active, Ported
<b>Woofer Size</b>	Single 12 in.
<b>RMS/Peak Power</b>	250/500 Watts
<b>Port Style</b>	Bass Reflex
<b>Frequency Response</b>	40Hz-500Hz
<b>SPL@ 1w/1m</b>	93dB
<b>Impedance</b>	4 ohms
<b>Dimensions</b> (LxWxH inch)	17x14.75x15.25



**Cone Material**  
Black Acrylic Piano Finish

**Surround**  
Laminated Butyl Rubber

**Port**  
4th Order Bass Reflex  
Ported Design

**Dust Cap**  
3-D Injected Poly  
Dust Cap

**Surround**

Laminated Butyl Rubber

**Front Panel**

Aviation Grade Black Carpet



**Exterior**

Aviation Grade Black Carpet  
with Embroidered Logos

## FSB 12SP

12" Passive Sealed Box  
\*10" Also Available

**500W**

**Model Number**

**FSB 10SP**

**FSB 12SP**

<b>Enclosure Type</b>	Passive, Sealed	Passive, Sealed
<b>Woofer Size</b>	Single 10 in.	Single 12 in.
<b>RMS/Peak Power</b>	200/400 Watts	250/500 Watts
<b>Port Style</b>	Bass Reflex	Bass Reflex
<b>Frequency Response</b>	35Hz-500Hz	32Hz-500Hz
<b>SPL@ 1w/1m</b>	90dB	92dB
<b>Impedance</b>	4 ohms	4 ohms
<b>Dimensions</b> (LxWxH inch)	20.0x(5.2x7.3)x12.5	22.0x(5.2x7.3)x15.2

**Model Number**

**FSB 10SA**

**FSB 12SA**

<b>Enclosure Type</b>	Active, Sealed	Active, Sealed
<b>Woofer Size</b>	Single 10 in.	Single 12 in.
<b>RMS/Peak Power</b>	200/400 Watts	250/500 Watts
<b>Port Style</b>	Bass Reflex	Bass Reflex
<b>Frequency Response</b>	35Hz-500Hz	32Hz-500Hz
<b>SPL@ 1w/1m</b>	90dB	92dB
<b>Impedance</b>	2 ohms	2 ohms
<b>Dimensions</b> (LxWxH inch)	22.0x(5.2x7.3)x12.5	24.0x(5.2x7.3)x15.2





**700W**



**Port**  
4th Order Bass Reflex  
Ported Design

**Port**  
4th Order Bass Reflex  
Ported Design



**TUBE 12VP**

12" Passive Ported Box



**QUBE 12VA**

12" Active Ported Box

**Model Number**

**Enclosure Type**

**Woofer Size**

**RMS/Peak Power**

**Port Style**

**Frequency Response**

**SPL@ 1w/1m**

**Impedance**

**Amplifier**

**Dimensions**

(LxD inch)

**TUBE 12VA**

Active, Vented

Single 12 in.

350/700 Watts

Bass Reflex

32Hz-500Hz

92dB

2 ohms

300 Watts

26.0x13.1

**TUBE 12VP**

Passive, Vented

Single 12 in.

350/700 Watts

Bass Reflex

32Hz-500Hz

92dB

4 ohms

N/A

26.0x13.1

**QUBE 10VA**

Active, Vented

Single 10 in.

250/500 Watts

Bass Reflex

32Hz-500Hz

90dB

2 ohms

300 Watts

16.5x12.1x14.2

**QUBE 10VP**

Passive, Vented

Single 10 in.

250/500 Watts

Bass Reflex

32Hz-500Hz

90dB

4 ohms

N/A

16.5x12.1x14.2

**QUBE 12VA**

Active, Vented

Single 12 in.

350/700 Watts

Bass Reflex

28Hz-500Hz

91dB

2 ohms

300 Watts

17.7x14.1x15.4

**QUBE 12VP**

Passive, Vented

Single 12 in.

350/700 Watts

Bass Reflex

28Hz-500Hz

91dB

4 ohms

N/A

17.7x14.1x15.4

### XLERATOR80SA

8" Active Sealed Box

**360W**

#### Enclosure

Acoustically Matched Single Sealed Design with Passive Radiator

#### Embroidered Logo

Embroidered Color Cadence Logo



#### Amplifier

4-Ohm Class D  
Mono Block Amplifier

<b>Model Number</b>	<b>XLERATOR80SA</b>
<b>Enclosure Type</b>	Active, Sealed
<b>Woofer Size</b>	Single 8 in
<b>RMS/Peak Power</b>	180/360 Watts
<b>Frequency Response</b>	78Hz-5000Hz
<b>SPL @ 1w/1m</b>	93dB
<b>Impedance</b>	4 ohms
<b>Passive Radiator</b>	Woofer Enhancer
<b>Dimensions</b> (L x W x H inch)	10.5x10.0x10.0

# QSA-PR88

Double 8" Super Compact Bass Enclosures  
One Active + One Slave System

**720W**

**Double the Woofer !  
Double the Bass !  
Double the Output !  
Under Two seats!**



**SPECIFICATIONS**

	ACTIVE UNIT	SLAVE UNIT
Size	8 in.	8 in.
RMS/Peak Power	180 / 360 Watts	180 / 360 Watts
Frequency Response	20Hz-200Hz	20Hz-200Hz
S/N Ratio	> 90dB	N/A
Load	4 ohms	4 ohms
High Level Input Sensitivity	0.8 Volts	N/A
Low Level Input Sensitivity	180 mV	N/A
Low Pass Filter	30Hz-200Hz	N/A
Fuse Rating	25 Amps	N/A
Dimensions (L x W x H)	11.4" x 9.6" x 2.8"	11.4" x 9.6" x 2.8"

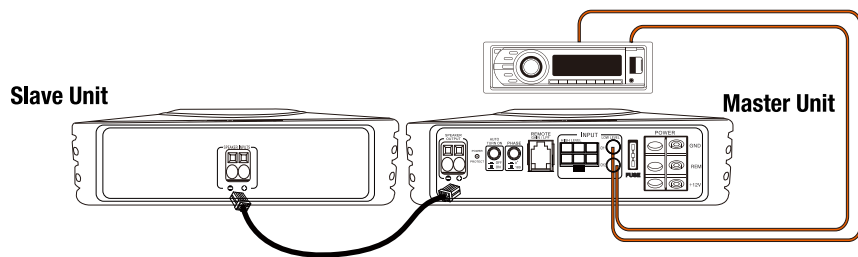

**PROFESSIONAL**



PRO



SERIES

Oldie  
Challenge

## DXW 12X

12" Pro Audio Woofer  
\*15" and 18" Also Available

**4 OHM**  
**8 OHM**

Models Available

### Basket

Die Cast Aluminum Basket

### Terminals

Nickel Plated Spring Loaded Push Style Terminals

### Voice Coil

4-Layer, CCAW Copper Wire on TIL Former



### Cone

Kevlar Reinforced Black Paper Cone

### Surround

Treated Cloth Accordion

### SUBWOOFER

Model Number	DXW 18X	DXW 15X	DXW 12X
Size	18 in.	15 in.	12 in.
RMS/MAX Power	1200/2400 Watts	800/1600 Watts	600/1200 Watts
Frequency Response	43Hz-2KHz	50Hz-2.3KHz	55Hz-3KHz
SPL@1w/1m	97dB @ 1w/1m	96dB @ 1w/1m	92dB @ 1w/1m
System Impedance	4/8 Ohms	4/8 Ohms	4/8 Ohms
Mounting Depth	8.07 in.	6.38 in.	6.12 in.
Voice Coil	4" VC	4" VC	3" VC
Magnet	100 oz. x 2	100 oz. x 2	80 oz. x 2



### Basket

Die Cast Aluminum Basket

### Cone

Kevlar Reinforced Black Paper Cone

### Surround

Treated Cloth Accordion

### MIDBASS

Model Number	DXM 6X	DXM 8X	DXM 10X
Size	6.5 in.	8 in.	10 in.
RMS/MAX Power	125/250 Watts	250/500 Watts	400/800 Watts
Frequency Response	90Hz-14KHz	85Hz-12KHz	70Hz-12KHz
SPL@1w/1m	93dB @ 1w/1m	95dB @ 1w/1m	97dB @ 1w/1m
System Impedance	4/8 Ohms	4/8 Ohms	4/8 Ohms
Mounting Depth	3.03 in.	3.06 in.	4.21 in.
Voice Coil	2" VC	2" VC	2.5" VC
Magnet	37 oz.	45 oz.	53 oz.

## DXM 6X

6.5" Pro Audio Midrange  
\*8" and 10" Also Available

**4 OHM**  
**8 OHM**

Models Available



## PXW 12X

12" Pro Audio Woofer

\*10", 15" and 18" Also Available



## PXM 6X

6.5" Pro Audio Midbass

\*8" and 8"x12" Also Available



## 4 OHM 8 OHM

Models Available

Model Number

Size  
RMS/Peak Power  
Frequency Response  
SPL@1w/1m  
System Impedance  
Mounting Depth  
Voice Coil  
Magnet

### SUBWOOFER

PXW 18X

PXW 15X

PXW 12X

PXW 10X

18 in.	15 in.	12 in.	10 in.
800/1600 Watts	600/1200 Watts	400/800 Watts	250/500 Watts
26Hz-2.7KHz	33Hz-3KHz	45Hz-3.2KHz	58Hz-4KHz
93dB @ 1w/1m	94dB @ 1w/1m	94dB @ 1w/1m	93dB @ 1w/1m
4/8 Ohms	4/8 Ohms	4/8 Ohms	4/8 Ohms
7.25 in.	6.46 in.	5.51 in.	4.73 in.
3" VC	3" VC	2.5" VC	2" VC
85 oz.	72 oz.	66 oz.	54 oz.

### MIDBASS

PXM 812X4C2

PXM 812X8C2

PXM 8X4C2

PXM 8X8C2

PXM 6X4C2

PXM 6X8C2

8 x 12 in.	8 in.	6.5 in.
400/800 Watts	150/300 Watts	100/200 Watts
55Hz-9KHz	87Hz-7.5KHz	83Hz-13KHz
95dB @ 1w/1m	94dB @ 1w/1m	92dB @ 1w/1m
4/8 Ohms	4/8 Ohms	4/8 Ohms
3.4 in.	3.4 in.	3.0 in.
2" VC	1.5" VC	1.5" VC
58 oz.	44 oz.	34 oz.





## XM 64HCiL

6.5" High Compression Midrange

8" Also Available

**Model Number**

	<b>XM 64HCiL</b>	<b>XM 84HCiL</b>
<b>Size</b>	6.5 in.	8 in.
<b>RMS/Peak Power</b>	75/150 Watts	125/250 Watts
<b>Frequency Response</b>	150Hz-15KHz	110Hz-17KHz
<b>SPL@1w/1m</b>	102dB @ 1w/1m	103dB @ 1w/1m
<b>System Impedance</b>	4 Ohms	4 Ohms
<b>Mounting Depth</b>	2.20 in.	2.60 in.
<b>Voice Coil</b>	1.5" VC	1.5" VC
<b>Magnet</b>	20 oz.	29 oz.

**HIGH COMPRESSION**

**Cone**

Carbon Treated Pulp

**Surround**

Treated Flat Foam  
Encourages a Smoother Hi-End  
Frequency Response



**LED**

Crystal Blue Light

**Cone**

Carbon Treated Pulp

**LED**

Crystal Blue Light

**Basket**

Super Slim Design  
for Easy Door  
Installation



**Surround**

Treated Cloth Accordion  
Allows for a Balanced, Warm Tonal Response

**Basket**

Super Slim Design  
for Easy Door  
Installation

## XM 64ViL

6.5" Vocal Midrange

8" and 6"x9" Also Available

**Model Number**

	<b>XM 64ViL</b>	<b>XM 84ViL</b>	<b>XM 694ViL</b>
<b>Size</b>	6.5 in.	8 in.	6x9 in.
<b>RMS/Peak Power</b>	75/150 Watts	125/250 Watts	125/250 Watts
<b>Frequency Response</b>	150Hz-8.5KHz	100Hz-11KHz	150Hz-10KHz
<b>SPL@1w/1m</b>	100dB @ 1w/1m	102dB @ 1w/1m	102dB @ 1w/1m
<b>System Impedance</b>	4 Ohms	4 Ohms	4 Ohms
<b>Mounting Depth</b>	2.20 in.	2.60 in.	3.15 in.
<b>Voice Coil</b>	1.5" VC	1.5" VC	1.5" VC
<b>Magnet</b>	20 oz.	29 oz.	29 oz.

**MID-HIGH**

\*All Midranges Sold Individually, Mounting  
Hardware & Grill Included

### XM 644HCi

6.5" High Compression Midrange  
8" Also Available

#### Model Number

	XM 644HCi	XM 844HCi
Size	6.5 in.	8 in.
RMS/Peak Power	75/150 Watts	125/250 Watts
Frequency Response	150Hz-15KHz	110Hz-17KHz
SPL@1w/1m	102dB @ 1w/1m	103dB @ 1w/1m
System Impedance	Dual 4 Ohms	Dual 4 Ohms
Mounting Depth	2.20 in.	2.60 in.
Voice Coil	1.5" DVC	1.5" DVC
Magnet	20 oz.	29 oz.

#### HIGH COMPRESSION

#### Cone

Carbon Treated Pulp

#### Surround

Treated Flat Foam  
Encourages a Smoother Hi-End  
Frequency Response



#### Cone

Carbon Treated Pulp

#### Basket

Super Slim Design  
for Easy Door  
Installation



#### Surround

Treated Cloth Accordion  
Allows for a Balanced, Warm Tonal Response

#### Basket

Super Slim Design  
for Easy Door  
Installation

### XM 644Vi

6.5" Vocal Midrange  
8" Also Available

#### Model Number

	XM 644Vi	XM 844Vi
Size	6.5 in.	8 in.
RMS/Peak Power	75/150 Watts	125/250 Watts
Frequency Response	150Hz-8.5KHz	100Hz-11KHz
SPL@1w/1m	100dB @ 1w/1m	102dB @ 1w/1m
System Impedance	Dual 4 Ohms	Dual 4 Ohms
Mounting Depth	2.20 in.	2.60 in.
Voice Coil	1.5" DVC	1.5" DVC
Magnet	20 oz.	29 oz.

#### MID-HIGH

\*All Midranges Sold Individually, Mounting  
Hardware & Grill Included



## XM 6KM

2 Way// 6.5 inch  
PureMidrange Component Kit

**PRO Components**

<b>Model Number</b>	<b>XM 6KM</b>
<b>Size</b>	6.5 in.
<b>RMS/Peak Power</b>	75/150 Watts
<b>Frequency Response</b>	250Hz-22KHz
<b>SPL@1w/1m</b>	98dB @ 1w/1m
<b>System Impedance</b>	4 Ohms
<b>Mounting Depth</b>	2.09 in.
<b>Voice Coil</b>	1.5" VC
<b>Magnet</b>	20 oz.



## XPRO 62CXC2

6.5" 2-Way Pro Audio Drivers

\*6"x9", 8", and 10" Also Available

**Full Range**

	<b>XPRO 62CXC2</b>	<b>XPRO 69CXC2</b>	<b>XPRO 82CXC2</b>	<b>XPRO 102CXC2</b>
<b>Model Number</b>	<b>XPRO 62CXC2</b>	<b>XPRO 69CXC2</b>	<b>XPRO 82CXC2</b>	<b>XPRO 102CXC2</b>
<b>Size</b>	6.5 in.	6x9 in.	8 in.	10 in.
<b>RMS/Peak Power</b>	75/200 Watts	100/250 Watts	100/250 Watts	125/300 Watts
<b>Frequency Response</b>	122Hz-20KHz	71Hz-20KHz	55Hz-20KHz	50Hz-20KHz
<b>SPL@1w/1m</b>	93dB @ 1w/1m	95dB @ 1w/1m	95dB @ 1w/1m	94dB @ 1w/1m
<b>System Impedance</b>	4 Ohms	4 Ohms	4 Ohms	4 Ohms
<b>Mounting Depth</b>	3.2 in.	4.2 in.	3.5 in.	3.9 in.
<b>Voice Coil</b>	1.5" VC	1.5" VC	1.5" VC	2" VC
<b>Magnet</b>	41 oz.	45 oz.	45 oz.	50 oz.







CHD301PL



CHD305PL



CHD307PL



CHD410AL



CHD420AL

Model	Size	Diaphragm	Magnet	V.C.	Power	Freq. Resp.	SPL	Depth of Horn
CHD301PL	5-3/4"	Aluminum	6.4 oz.	1"	60W / 120W	1K-20K Hz	98 dB	4-1/2"
CHD305PL	5-1/8"x10"	Titanium	23 oz.	1.75"	100W / 200W	1K-20K Hz	106 dB	5-3/4"
CHD307PL	6"x8"	Titanium	30 oz.	1.75"	150W / 300W	1K-20K Hz	108 dB	4-3/8"
CHD410AL	6"x8"	Titanium	30 oz.	1.75"	150W / 300W	1K-22K Hz	110 dB	4-1/8"
CHD420AL	7-3/4"	Titanium	59 oz.	3"	200W / 400W	900-24K Hz	112 dB	5-1/8"



# HORN



**H301PL**  
 · 5-3/4"  
 · Plastic  
 · 4-1/2" Depth



**H302PL**  
 · 6"  
 · Plastic  
 · 6-5/8" Depth



**H305PL**  
 · 5-1/8"x10"  
 · Plastic  
 · 5-3/4" Depth



**H307PL**  
 · 6"x8"  
 · Plastic  
 · 4-3/8" Depth

# DRIVER



**CWD 10**  
 · 6.4 oz. Magnet  
 · 1" Voice Coil  
 · 120 Watts MAX /  
 60 Watts RMS



**CWD 60**  
 · 12 oz. Magnet  
 · 1.5" Voice Coil  
 · 160 Watts MAX /  
 80 Watts RMS



**CWD 65**  
 · 22 oz. Magnet  
 · 1.75" Voice Coil  
 · 200 Watts MAX /  
 100 Watts RMS



**CWD 80**  
 · 30 oz. Magnet  
 · 1.75" Voice Coil  
 · 250 Watts MAX /  
 125 Watts RMS

## XT 20C2

2" Horn Titanium Tweeter  
\*Sold Individually

ADVANCED PERFORMANCE

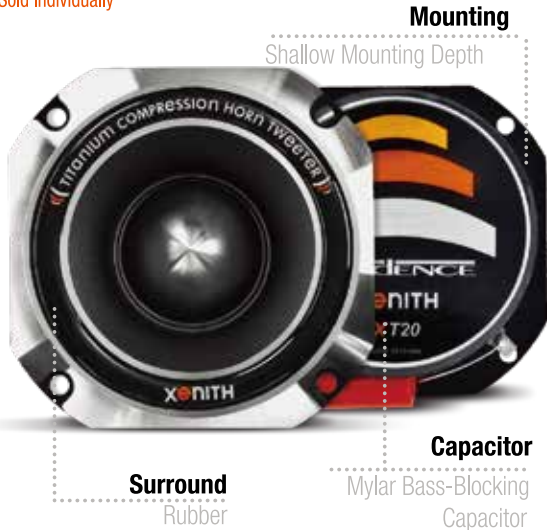

Mounting

Shallow Mounting Depth

Surround  
Rubber

Capacitor

Mylar Bass-Blocking  
Capacitor

## XT 45C2

1" Bullet Horn Tweeter  
\*Sold in Pairs

ADVANCED PERFORMANCE

Voice Coil

Aluminum Diaphragm

Frame

Cast Aluminum



Voice Coil

1" High-Temp Kapton  
Voice Coil

Capacitor

In cludes Mylar Bass  
Blocking Capacitor

## XT 21C2

1.5" Horn Titanium Tweeter  
\*Sold Individually

ULTRA PERFORMANCE

Voice Coil

1.5" High-Temp Kapton  
Voice Coil

Frame

Cast Aluminum



Surround  
Rubber

## XT 50C2

2" Titanium Bullet Horn Tweeter  
\*Sold Individually

ULTRA PERFORMANCE

Voice Coil

Oversized 2" High-Temp  
Kapton Voice Coil

Frame

Cast Aluminum

Dome

Titanium Dome  
Structure with  
Ferro-Fluid Cooling

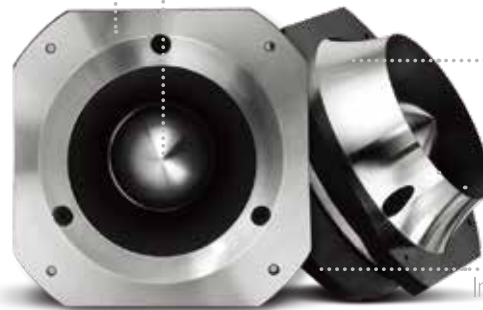

Capacitor

Includes Mylar Bass  
Blocking Capacitor

## XT 60C2

1" Titanium Bullet Tweeter  
\*Sold in Pairs

PROFESSIONAL

Voice Coil

1" High-Temp Kapton  
Voice Coil

Dome

Titanium Dome  
Structure with  
Ferro-Fluid Cooling

Frame

Cast Aluminum

Motor

High Density Neodymium  
Motor Structure



### TWEETERS

Model Number	XT 20C2	XT 21C2	XT 45C2	XT 50C2	XT 60C2
Size	2 in.	1.5 in.	1 in.	2 in.	1 in.
RMS/Peak Power	75/150 Watts	75/150 Watts	75/150 Watts	50/100 Watts	50/100 Watts
Frequency Response	3KHz-22KHz	2KHz-23KHz	3KHz-23KHz	2KHz-25KHz	3KHz-20KHz
SPL @ 1w/1m	110dB	108dB	102dB	107dB	109dB
System Impedance	6 ohms	8 ohms	4 ohms	6 ohms	3 ohms
Magnet Structure	24 oz.	30 oz.	22 oz.	36 oz.	Neo
Mounting Depth	2.4 in.	2.3 in.	1.50 in.	1.75 in.	1.60 in.





## CXR 7

3 Way Electronic Crossover

Fully Adjustable Frequencies  
Multi-Link Capability  
Self Powered Featuring Fully Isolated DC-to-DC Power Supply

Ground, Remote, and Power Connections

Crossover Slopes: 18dB or 12dB

Audio Stereo / Mono Selector  
Phase Shift Control  
Selectable Parametric 15dB Bass Boost

Model Number	CXR 7
Rear Low Pass	25Hz - 400Hz Subwoofer
Rear High Pass	25Hz - 400Hz Midrange
Front High Pass	25Hz - 400Hz Midrange
	500Hz - 8KHz Mid / High
Low Pass	18dB per Octave Slope, 3rd Order
High Pass	12dB per Octave Slope, 3rd Order
Equalization	0 - 15dB Boost
Frequency Response	10Hz - 30KHz (-3dB)
THD	<0.01%
S/N Ratio	95dB
Max Output	7 Volts
Dimensions (L x W x H inch)	7.5" x 5.5" x 1.75"

The CXR-7 is designed for sound quality audiophiles seeking to custom tailor their crossover functions and frequencies to multi-amp systems. The crossover slopes feature either a steep 18dB low pass or a gentle 12dB high pass roll-off. All frequencies are fully adjustable, and you can even multi-link two CXR-7's for an additional 6 channels of output. Other features include an adjustable parametric bass equalizer with a selectable bass boost, a phase shift-control, and an audio stereo / mono selector. The self powered unit features a fully isolated DC-to-DC power supply, which boasts a 7 volt line driver signal. The CXR-7 comes complete with a 14ft cable and dashboard bass remote control.

7 VOLT LINE DRIVER

Dashboard Bass Remote

Includes 14ft RJ11 cable



- Pairs with any Bluetooth enabled device and allows it to serve as the source unit in a mobile system
- Sealed for use in All terrain applications such as ATVs, Motorcycles, Marine and watercraft, Golf carts....etc.
- Easily mounts on handlebars, in dash, or consoles with easy push in mounting.
- Includes RCA output wires and power input wires.

\*Sold Individually

### BLUETOOTH ADAPTER BTM-1



Size  
3.82" (L)x2.13"(W)x 1.14"(D)

### AMPLIFIED BLUETOOTH ADAPTER BTM-2



Seamless Flush Mount

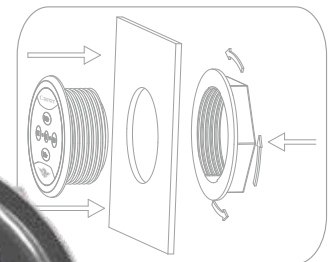

Size  
3.94"(Out Diameter)  
3.10" (Cutout Diameter)  
1.49" (Depth)



# BASS PROCESSOR CBP1

- Maximum Input Level: 15V RMS
- Maximum Output Level: 13.5V Peak
- Frequency Response: 10Hz-100KHz; +/-dB
- Total Harmonic Distortion: 0.003%
- Signal to Noise Ratio: 130dB
- Balanced Input Noise Rejection: > 60dB
- Input Impedance: 10K Ohms
- Output Impedance: 150 Ohms
- Power Supply: High headroom PWM
- Power draw: 150mA
- Recommend fuse rating: 1 Amp

Your music files remove Bass from your music. The New Cadence CBP1 Bass Processor restores the deep and powerful bass your subwoofers crave. The CBP1 has a Bass Equalization circuit that contours the restored Bass to your system. Give your system the power to hit harder and play lower.



# DIGITAL SIGNAL PROCESSOR DSP4.8

Cadence's new Digital Signal Processor is a 32 bit Core DSP with 24 bit / 192 khz AD and DA convertors. All functions and controls are easily controlled using the Cadence DSP 4.8 software.

- Cirrus Logic powered 32 Bit Core / 192kHz Digital Signal Processor
- 4 On board Memory locations to save your settings.
- Integrated 105dB Dynamic Range, -98dB THD+N Analog-to-Digital Converter
- Integrated 108dB Dynamic Range, -98dB THD+N Digital-to-Analog Converter
- 30V MAX 4-channel High Level / Speaker Level Input
- 8V MAX AUX RCA Input Voltage
- 192khz S/PDIF Optical Digital Input
- 192khz S/PDIF Coax Digital Input
- 8 Channel RCA Output
- Up to +12dB /-40dB Master Input Level
- Output level per Channel 0 to -40dB of attenuation
- Signal Delay per channel 0 to 15ms in 0.05ms Increments
- Phase Control per Channel 0 or 180 degrees
- Crossover selections for Full Range, High Pass , Low Pass or Bandpass
- Crossover Slope Selectable 6dB to 48dB/Octave
- Crossover Frequency Continuously Variable ,20Hz-20kHz
- Equalizer ,16 band Parametric for Each Channel
- EQ Center Frequency Continuously Variable 20Hz-20kHz
- EQ level+12dB Boost/ -18dB
- EQ Filter Q Adjustment,0.5-9 for each Band
- Dash Mount Remote Control(To be announced)



## Why does your system need a Signal Processor

Every car interior produces at least one sharp peak or dip in the frequency response that results in highly unnatural sound reproduction. But the exact frequency and its level of intensity depends on unpredictable factors such as the size and volume of the interior, type of material used for the interior (cloth, leather, vinyl), whether a window is open or how many passengers are onboard.

Because of these variables, even a multi-band graphic equalizer will not be able to control a particular frequency without unnecessarily affecting others. The listener is therefore faced with either unwanted alterations of frequencies or having unnatural peaks and dips, which might result in boomy bass, muddled vocal range or harsh treble response.

This series of Cadence Parametric and Parabolic Equalizers integrates signal line drivers with equalization and crossover functions, combining them all into one unit. Cadence signal processors create clean, noise-free, high voltage signals, while conserving valuable interior space and installation time.

## CEQ 777 7 VOLT LINE DRIVER Signal Processor

<b>Model Number</b>	<b>CEQ 777</b>
<b>High Control</b>	20 KHz
<b>Mid Control</b>	2 KHz
<b>Mid Base</b>	200 Hz
<b>Bass Control</b>	40 Hz
<b>Equalization Control</b>	Boost / Cut 9 dB
<b>Frequency Response</b>	40Hz - 250Hz
<b>THD</b>	<0.05%
<b>S/N Ratio</b>	>95dB
<b>Max Output Level</b>	7 Volts RMS
<b>Dimensions</b> (LxWxH inch)	6.98" x 4.25" x 1.125"

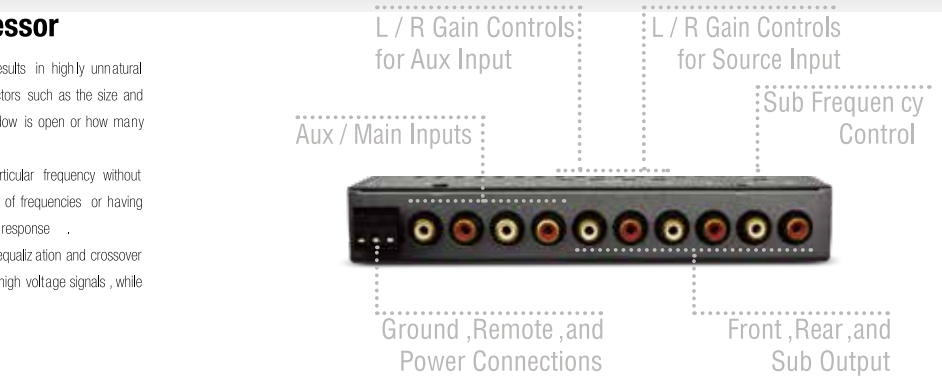

The CEQ-777 features an active gain equalizer with adjustable input sensitivity as well as a four band parametric equalizer with 12dB boost / cut. The USB 2.0 port and auxiliary jack (RCA to mini jack adapter required for auxiliary input) allow you to easily import music which can be controlled via the MP3 play control. Adjustable subwoofer level and frequency give you full control over output to your subwoofer. This unit also features front / rear fader controls and individual left / right sensitivity controls. Night Illumination provides easy viewing in low light conditions.



## CEQ 735 Signal Processor

<b>Model Number</b>	<b>CEQ 735</b>
<b>Band 1</b>	50Hz
<b>Band 2</b>	125Hz
<b>Band 3</b>	315Hz
<b>Band 4</b>	750Hz
<b>Band 5</b>	2.2KHz
<b>Band 6</b>	6KHz
<b>Band 7</b>	16KHz
<b>Equalization Control</b>	+/- 12dB
<b>Subwoofer Crossover</b>	60Hz/90Hz 12dB/oct.
<b>Frequency Response</b>	20Hz - 20KHz (-1 dB)
<b>THD</b>	.02% (1KHz @ 1 volt)
<b>S/N Ratio</b>	>95dB
<b>Maximum Output</b>	9.0 volts RMS
<b>Dimensions</b> (LxWxH inch)	7.0" x 4.5" x 1.18" 178 x 114 x 30 mm



The CEQ-735 provides the adjustments and controls to get the most from your stereo system. The automotive environment provides a challenging place to achieve good sound quality and the equalizer and sub-woofer crossover controls with fader and master volume level controls work together to overcome these common problems. The controls are easy to use with backlighting and rubber covered knobs. The adjustable input sensitivity allows you to match the level of both main and auxiliary inputs.