

# VYTRONIX

## HSV3 CORDED STICK VACUUM CLEANER INSTRUCTION MANUAL

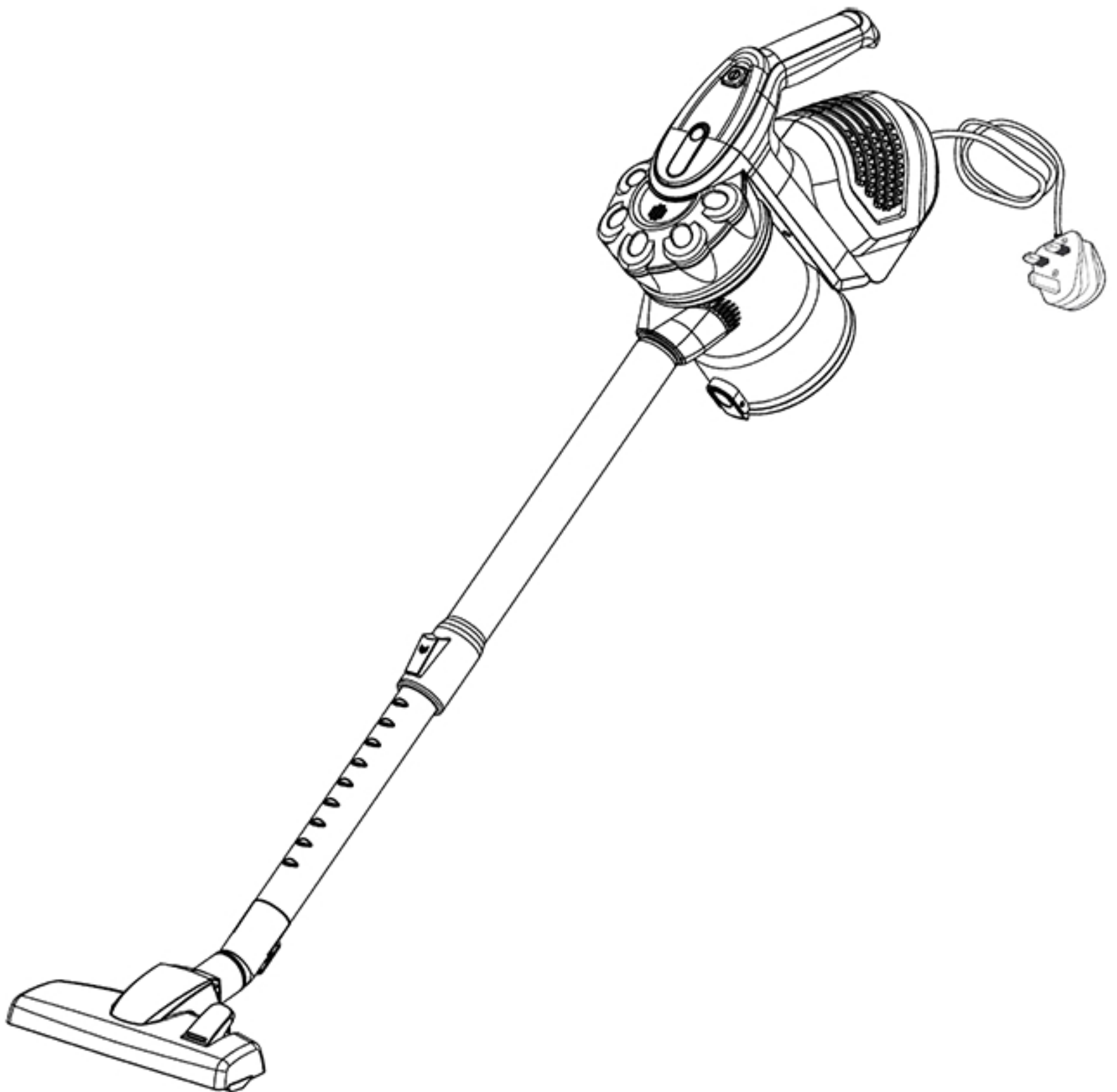

- BLANK PAGE -

# **IMPORTANT SAFETY INSTRUCTIONS**

When using an electrical appliance, basic precaution should always be followed, including the following:

## **READ ALL INSTRUCTIONS BEFORE USING (THIS APPLIANCE)**

**WARNING!** To reduce the risk of fire, electric shock, or injury:

1. Do not leave vacuum cleaner unattended when plugged in. Unplug from outlet when not in use and before servicing.
2. To reduce the risk of electric shock, do not use outdoors or on wet surfaces.
3. Use only as described in this manual. Use only manufacturer recommended attachments.
4. Do not use if the mains cable or plug is damaged. If the vacuum cleaner is not working as it should, has been dropped, damaged, left outdoors, or dropped into water, contact the manufacturer.
5. Do not pull on or carry by the mains cable, close door on cord, or pull cord around sharp edges or corners. Do not run vacuum cleaner over cord. Keep cord away from heated surfaces.
6. Do not unplug by pulling on mains cable. To unplug, grasp the plug, not the mains cable.
7. Do not handle plug or vacuum cleaner with wet hands.
8. Do not put any object into openings.
9. Keep hair, loose clothing, fingers and all parts of body away from openings and moving parts.
10. Turn all controls off before unplugging.
11. Take extra care when cleaning the stairs/using on the stairs.
12. Do not use to pick up any type of liquid or use in the vicinity of flammable liquids.
13. Do not pick up anything that is inflammable including cigarettes, matches, or hot ashes.
14. NEVER use without the filter in place.
15. If the mains cable is damaged, it must be replaced by the manufacturer.
16. This appliance is not intended for use by persons (including children under the age of 8 years old ) with reduced physical, sensory or mental capabilities, or lack of experience and knowledge, unless they have been given supervision or instruction concerning use of the appliance by a person responsible for their safety.
17. Children should not play with this appliance it is NOT a toy.

## **SAVE THESE INSTRUCTIONS!**

### **IMPORTANT!**

This Vacuum Cleaner is fitted with an internal safety thermal cut out system.

The Vacuum Cleaner will switch off automatically when it overheats.

The Vacuum Cleaner will overheat if the filters are clogged, or the dust tank is full.

If the Vacuum Cleaner cuts out, empty the dust tank, remove any blockages, and clean the filter out before using again.

The Vacuum Cleaner will need 30-60 minutes to cool down before using again.

## COMPONENTS AND EQUIPMENT

1. Floor head
2. Telescopic extension tube
3. Dust container release button
4. On/off button
5. Power cord
6. Dirt release clip / emptying clip
7. 2 in 1 crevice nozzle/dusting brush
8. Wall bracket
9. Fixing screws

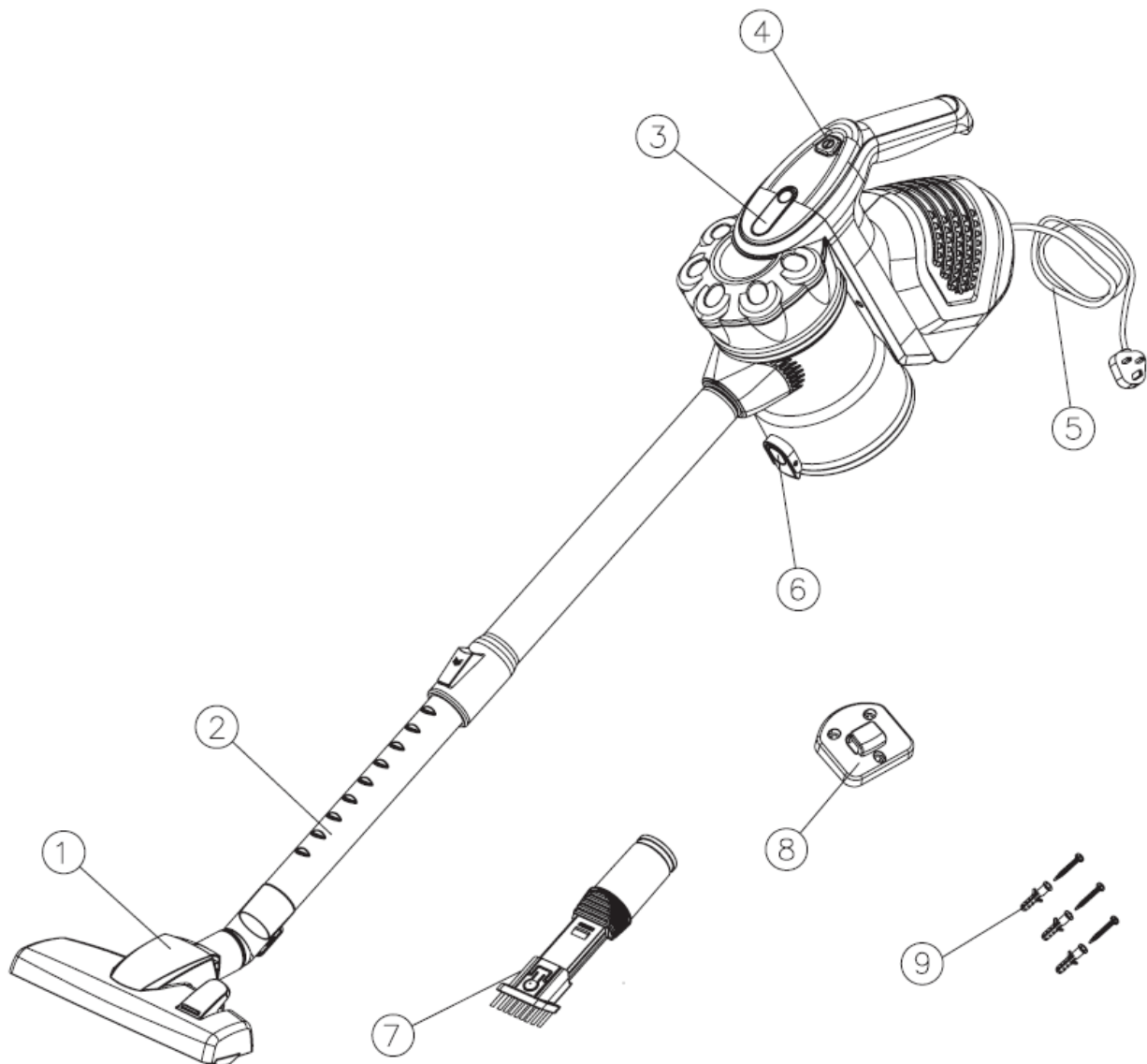

Don't forget to register for your 12 month guarantee at [www.vytronix.com](http://www.vytronix.com)  
using product code brandnew-vytronix-hsv3

## SAFETY ADVICE

**WARNING!** Switch off the vacuum cleaner immediately if the air intakes, the floor brush or the telescopic tube becomes blocked. Before starting the vacuum cleaner up again remove the substance causing the blockage:

1. Never use the vacuum cleaner in the immediate vicinity of fires or radiators or any other appliance emitting heat. Do not suck up hot objects such as cigarette ends or ashes.

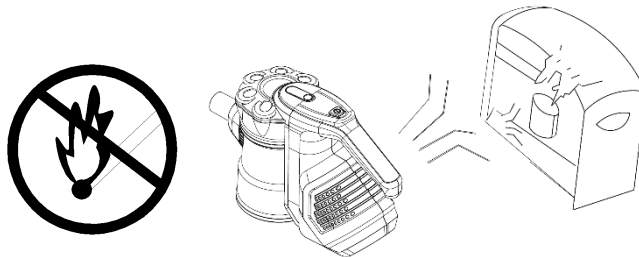

2. Only place the plug in the socket when your hands are dry.

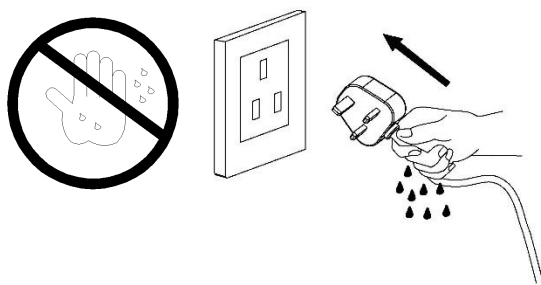

3. Please remove large or sharp objects from the floor before using the vacuum cleaner to avoid any possible damage to it.

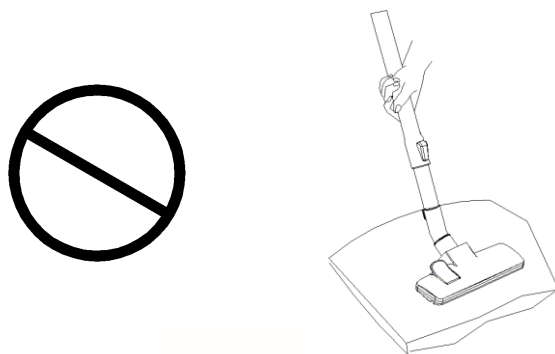

4. Do not pull by the mains cable when pulling out the plug.

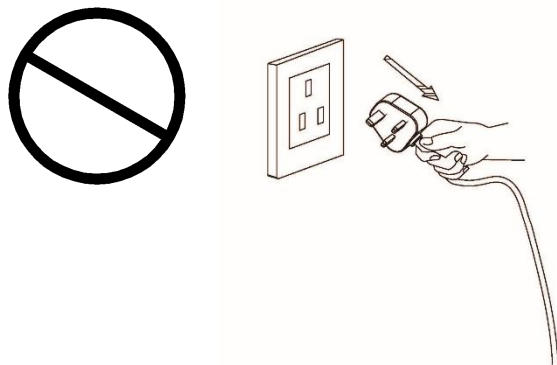

Don't forget to register for your 12 month guarantee at [www.vytronix.com](http://www.vytronix.com)  
using product code brandnew-vytronix-hsv3

# PREPARING TO USE THE VACUUM CLEANER

1. Push the telescopic extension tube into the inlet nozzle on the front of the vacuum.

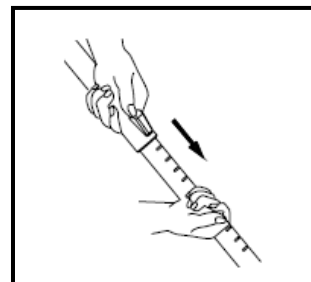
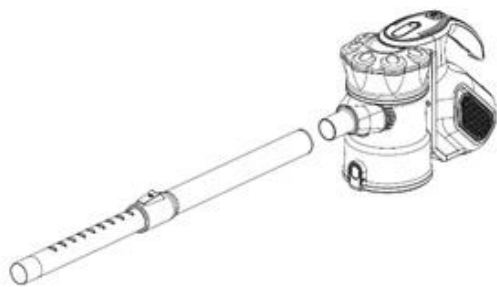

2. Adjust the length of the telescopic tube by pushing the locking mechanism down and pulling out the bottom section of the tube to a suitable length.

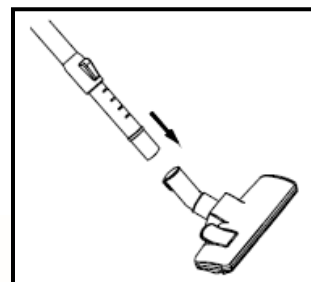

3. Fit the floor nozzle into the telescopic tube.

## **Floor Nozzle**

The floor nozzle has two settings. When cleaning hard surfaces (parquet flooring, flooring tiles, etc.), the nozzle brushes should be extended. When cleaning carpets and mats, the brushes should be retracted into the nozzle. Press the brush change button to switch between the two settings.

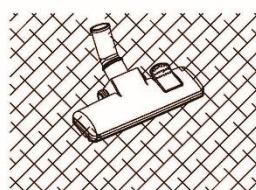

Cleaning carpet

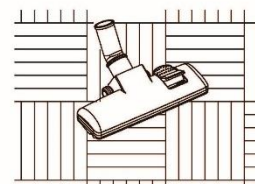

Cleaning wooden floor

## **2 in 1 crevice nozzle / dusting brush**

For radiators, corners, skirting, etc.

**TIP** This tool can be used either with the extension tube or directly onto the vacuum cleaner for closer cleaning.

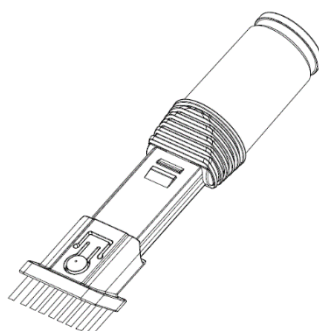
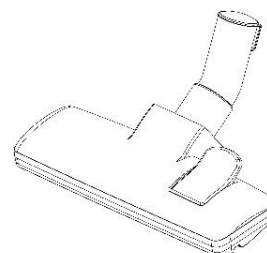

Don't forget to register for your 12 month guarantee at [www.vytronix.com](http://www.vytronix.com)  
using product code brandnew-vytronix-hsv3

## **USING THE VACUUM CLEANER**

Plug the cleaner into a socket and press on/off button. Care must be taken not to trap the mains cable under or in doors etc. during use.

## **TAKING CARE OF YOUR VACUUM CLEANER**

### **EMPTYING THE DUST CONTAINER**

Empty the dust container when either the dirt inside the dust container has reached the 'MAX' mark or if the suction has reduced in power.

1. Switch off the vacuum cleaner and disconnect the plug from the main socket. To do this, always pull on the plug and not on the cable.
2. Release the dust container by pressing down the dust container release button.
3. Lift the dust container forwards away from the vacuum cleaner body.
4. When emptying the dust container hold it over a dust bin.
5. Press the dirt release clip / emptying clip to allow the base to open and the contents to fall into the bin.

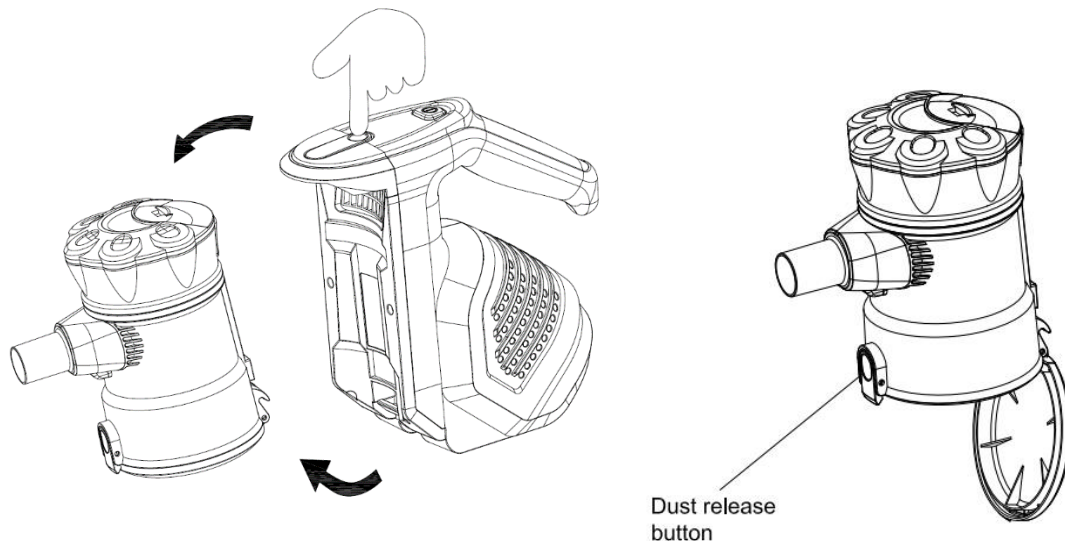

6. Carefully knock any remaining dust loose into the bin.
7. Close the base.
8. While holding down the dust container release button, place the container back onto the vacuum cleaner body.
9. Make sure the dust container is securely attached back on the cleaner body and release the button to lock into place.
10. Plug the cleaner back in and resume cleaning.

Don't forget to register for your 12 month guarantee at [www.vytronix.com](http://www.vytronix.com)  
using product code brandnew-vytronix-hsv3

# **TAKING CARE OF YOUR VACUUM CLEANER**

## **CLEANING THE FILTERS and CASSETTE SYSTEM**

1. Turn off and unplug the cleaner for carrying out any maintenance.
2. Remove the dust container.
3. Remove the dust container lid using the arrows as a guide and inner filter.
4. Remove the black sponge filter from the filter holder.
5. Clean both parts of the filter by gently tapping them into a dust bin.
6. Insert black sponge filter back into the filter holder.
7. Replace filter and holder back into the top of the dust container, using arrows as a guide where it was removed from.
8. Replace dust container back onto the cleaner body ready for use.

**IMPORTANT!** If the sponge filter is heavily soiled it can be rinsed in water but if you do this, you must allow it to dry for **24 hours** before reusing the cleaner.

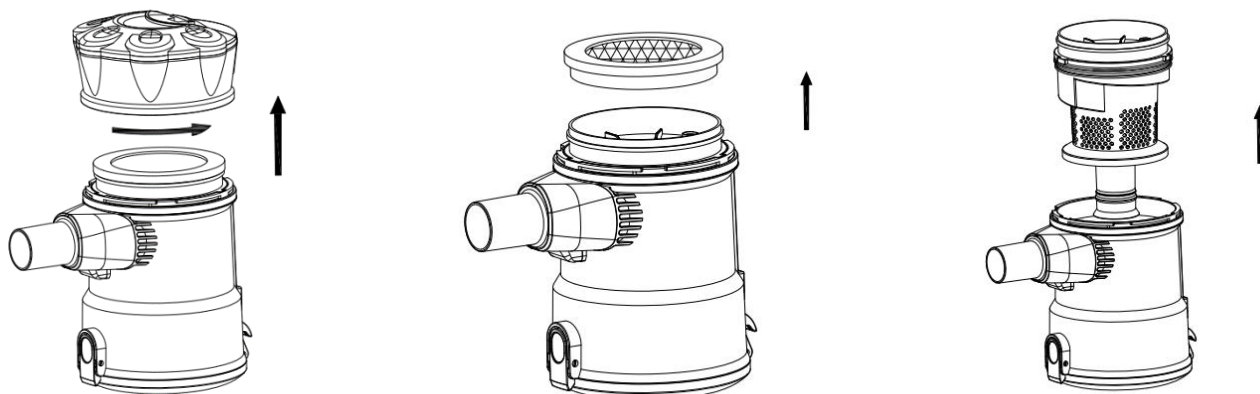

## **IMPORTANT!**

**All the above instructions are very important if you are experiencing a lack of suction or poor pick up when using you vacuum cleaner.**

**These symptoms are a clear indication that your filter system requires cleaning, if you follow the simple steps above you will maintain a constant strong suction/pickup.**

**NEVER use your vacuum cleaner without the filters fitted.**



## IMPORTANT!

This Vacuum Cleaner is fitted with an internal safety thermal cut out system.

The Vacuum Cleaner will switch off automatically when it overheats.

The Vacuum Cleaner will overheat if the filters are clogged, or the dust tank is full.

If the Vacuum Cleaner cuts out, empty the dust tank, remove any blockages and clean the filter out before using again.

The Vacuum Cleaner will need 30-60 minutes to cool down before using again.

## TRANSPORT AND STORAGE

1. You can lift and carry the vacuum cleaner using the carrying handle. Never pull or lift the vacuum cleaner by the cord.
2. Before putting the vacuum away, switch off the socket and unplug. The vacuum cleaner can be stored with or without the extension tube and floorhead on. **TIP** The vacuum will not stand alone, do not leave it stood in an upright position as it will fall over.
3. The supplied wall bracket needs to be affixed to a wall securely to use this feature for storage.

## CLEANING

Clean the vacuum cleaner by wiping it with a damp cloth making sure it's dry before using again.

You must not use any form of strong, solvent or abrasive cleaning agent. Regular maintenance is advised to prolong the life of your cleaner. Failure to carry out cleaning of the vacuum may result in loss of suction, poor performance or cause the vacuum motor to become blocked.

## WARRANTY REGISTRATION

To register your free one year Vytronix warranty visit [www.vytronix.com](http://www.vytronix.com) using product code: **brandnew-vytronix-hsv3**

## ENVIRONMENTAL TIPS

Once any electronic product is no longer functional, it should be disposed of in such a way as to cause minimum environmental impact, in accordance with the regulations of your local authority. In most cases you can take such products to your local recycling station.

## Safe Disposal



Don't forget to register for your 12 month guarantee at [www.vytronix.com](http://www.vytronix.com)  
using product code brandnew-vytronix-hsv3

# VYTRONIX

Register your warranty at [www.vytronix.com](http://www.vytronix.com)