

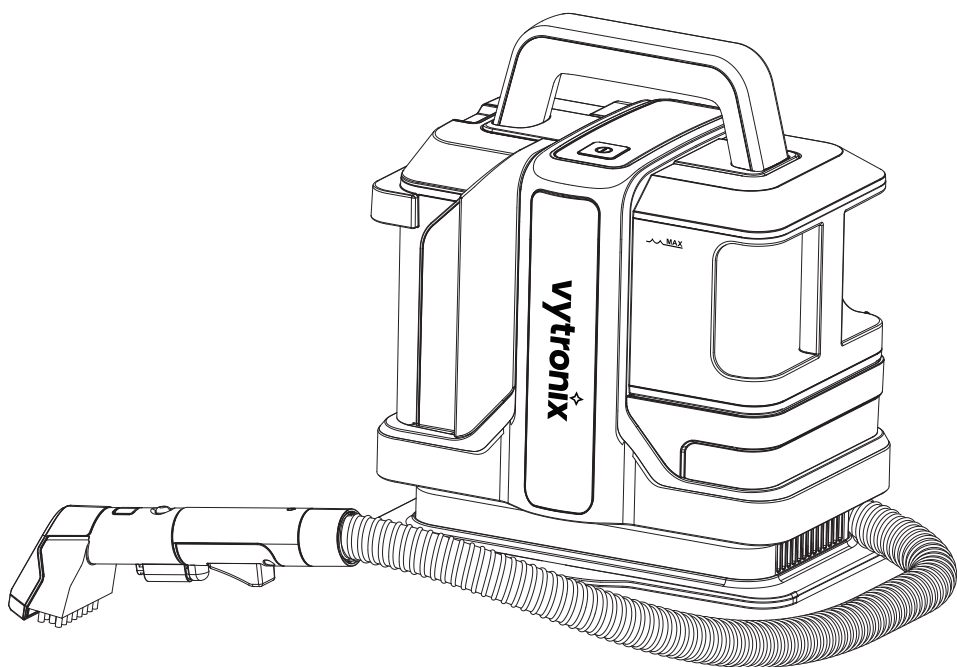

SWASH450P SPOT & STAIN
CARPET & UPHOLSTERY
CLEANER
USER GUIDE



READ CAREFULLY BEFORE USING THIS APPLIANCE

www.vytronix.com

IMPORTANT SAFETY INSTRUCTIONS

Read carefully before using this appliance and save for future use.

1. This appliance is intended for indoor cleaning and vehicle interiors only. **WARNING!** Do not use in wet weather conditions outdoors.
2. This appliance is not a vacuum cleaner. Do not use it to suck up dirt and debris, always vacuum the carpet or area first before using the appliance.
3. **WARNING!** Never touch the power cord or plug with wet hands.
4. Never leave the appliance plugged in when not in use.
5. **WARNING!** To avoid damage to the cleaner and invalidating your warranty never use this appliance to suck up loose materials or objects including large amounts of powder, sand, or food.
6. Do not use on flammable or combustible materials (lighter fluid, petrol, oil etc.) or use the appliance in an area with explosive vapours or liquids.
7. Do not leave the appliance unattended when plugged in.
8. **WARNING!** Always check the surface and care instructions before using and test an inconspicuous area of carpets/rugs/upholstery for colour fastness and pile distortion.
9. When using take care not to tip the appliance as water may escape the tank and leak out. **WARNING!** Never hold the cleaner upside down or on its side.
10. Stop the cleaner and empty the dirty water tank when the water reaches the max line.
11. The cleaner may stop when used on long pile carpet due to the air outlet becoming blocked. Switch off the cleaner if a large quantity of foam or dirty water is released and empty the dirty water tank before using it again.
12. Do not use foam detergent or carpet shampoo. Detergent designed for spot cleaners does not foam and is suitable for this appliance.
13. This appliance is not intended for use by persons with reduced physical, sensory, or mental capabilities, or lack of experience or knowledge, unless they have been given instructions concerning the safe use of the appliance by a person legally responsible for their safety. They should be supervised whilst using the appliance.
14. Children should not use, clean, or play with this appliance. **WARNING!** When not in use this appliance should be stored safely out of reach.
15. Do not use to pick up hot coals, cigarette butts or hot items or use in an area with harmful fluids including pesticides, hair dyes or bleach.
16. Do not use if the power cord or plug is damaged. If the power cord or plug is damaged it must be replaced by Vytronix Ltd or a person authorised to do so please contact our support team on support@vytronix.com. **CAUTION!** To avoid causing damage to the power cord and plug, do not pull the cord around corners or sharp edges or allow it to get trapped in doorways.
17. Do not use if the hose is damaged. **CAUTION!** To avoid causing damage to the hose ensure the hose is wrapped around the base correctly and stored into the hose hook when the appliance is not in use.

- 18. Keep all airways clear and free from debris to avoid blocking the air vents and causing a lack of suction/water collection.
- 19. **WARNING!** If the appliance produces an unusual noise or smell stop using it immediately and contact our support team.
- 20. The appliance should not be adjusted or repaired by anyone except properly qualified service personnel authorised to do so by Vytronix UK Ltd. Doing so may cause fire, injury or damage to the appliance that would invalidate the warranty.
- 21. **WARNING!** To avoid fire or injury do not immerse the cleaner in water.
- 22. Do not use without the dirty water tank in place.
- 23. **WARNING!** Do not attempt to remove blockages with sharp objects as this may cause damage to the cleaner and invalidate the warranty. Follow the cleaning and maintenance advice to remove blockages and prolong the life span of your cleaner.
- 24. Do not use the cleaner with the incorrect voltage as this may result in damage, fire, and/ or injury to the user.
- 25. Do not saturate your flooring / surfaces and always finish on a dry stroke.
- 26. Always fill the clean water tank with warm water (maximum temperature of 40°C) only. Filling the clean water tank with hot or boiling water will damage the appliance and invalidate the warranty.
- 27. Always use the cleaner with the tanks and filters in place.
- 28. To clean the dirty water tank, use warm water under 40°C.
- 29. **CAUTION!** Take care when using this cleaner on stairs, never leave the appliance on the stairs above where you are cleaning to avoid this falling and causing injury.
- 30. Turn off the appliance using the power button before unplugging from the mains.

SPECIFICATIONS

Voltage/Frequency	220-240V~ 50/60Hz
Rated power	450W
Max vacuity	≥11 kPa
Capacity of clean water tank/ Dirty water tank	1080ML / 800ML
IP rating	IPX4

GETTING TO KNOW YOUR APPLIANCE

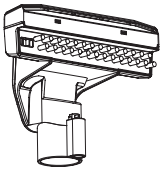
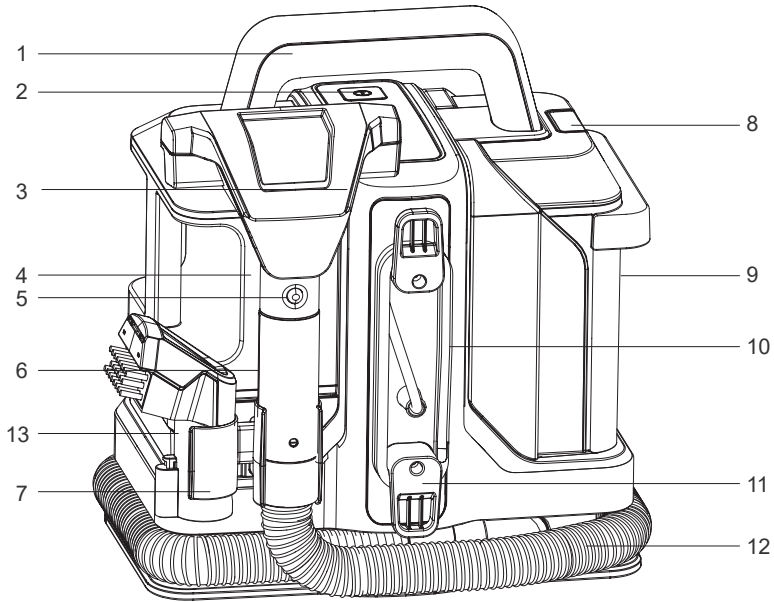

3



13



14

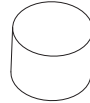

15

- 1. Carry handle
- 2. Power ON/OFF button
- 3. Large wash tool
- 4. Clean water tank
- 5. Release button for wash tool
- 6. Hose Handle
- 7. Wash tool retaining hook
- 8. Release button for dirty water tank
- 9. Dirty water tank

- 10. Power cord
- 11. Power cord storage hook
- 12. Hose
- 13. Small wash tool
- 14. Self cleaning nozzle
- 15. Foam filter

ASSEMBLY BEFORE USING YOUR CLEANER

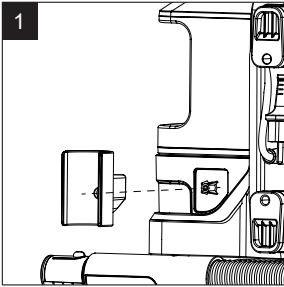

1 To assemble the wash tool retaining hook; insert into location below the clean water tank and screw it tightly using the screw provided.

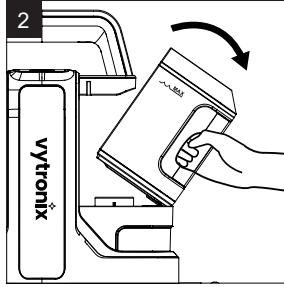

2 Remove the clean water tank. Note: pull the clean water tank at an angle of 30 degrees top to bottom.

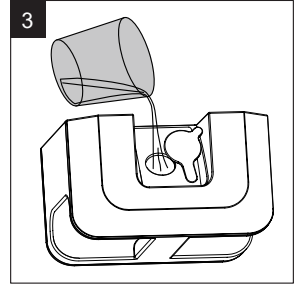

3 Slide open the water inlet filling seal, fill the tank with warm water and close the seal. *See below if you wish to add detergent

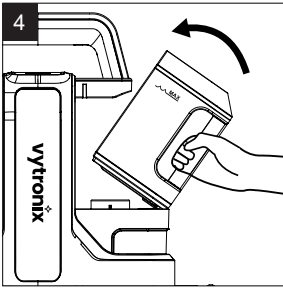

4 Relocate the clean water tank. Note: lock the bottom part to the machine, then push the clean water tank into place at the top.

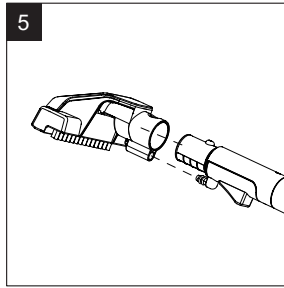

5 Attach the wash tool to the hose handle.

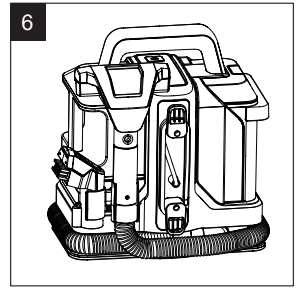

6 Wrap the hose around the base and insert the wash tool and hose handle into the wash tool retaining hook.

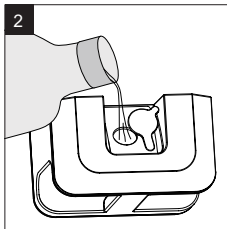
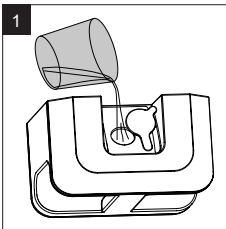

Use spot cleaning detergent to clean stubborn stains. Mix the water and detergent directly in the clean water tank following the detergent guidelines ensuring the max line is not exceeded.

CAUTION! Do not use carpet shampoo as this foams, and is not designed for use in this cleaner.

OPERATING YOUR SPOT & STAIN CLEANER

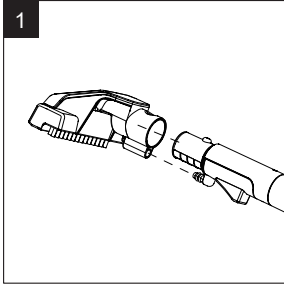

Select the desired wash tool suitable for the flooring/surface and attach this to the hose handle.



Unwrap the power cord and plug into the mains. Switch the cleaner on using the power ON/OFF button.

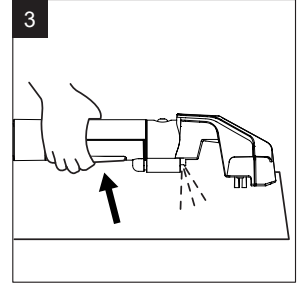

Press the water release button to spray water (and detergent) onto the surface.

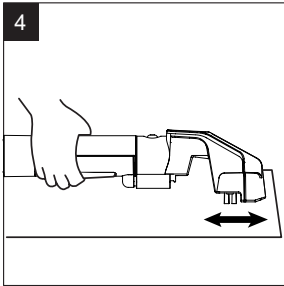

Use the brush to agitate stubborn stains.

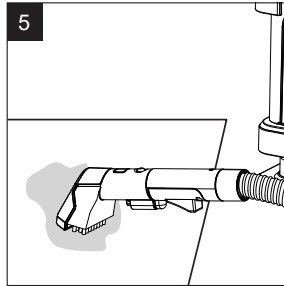

For spills always pick up the excess liquid before using water or solution.

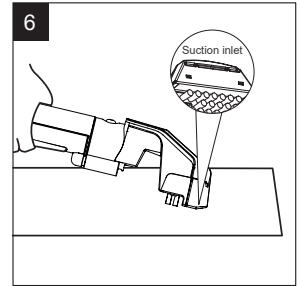

Release the button to stop spraying. Tilt the wash tool forward so the brushes are not in contact with the surface, to ensure the suction inlet collects the dirty water on the backward stroke.

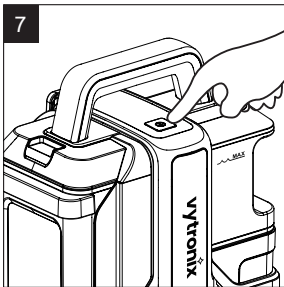

Power off after cleaning. Wrap the hose around the base and lock in the hook.

Note: Clean the dirty water tank after every use to avoid unpleasant smells.

IMPORTANT: Over or under tilting the hand tool may result in poor water pick up.

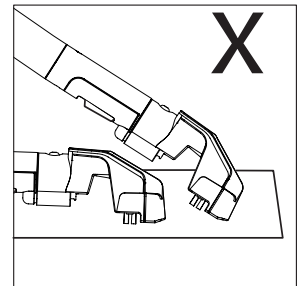
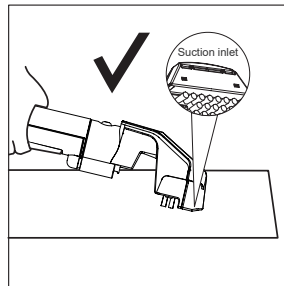

CLEANING CARE AND MAINTENANCE

To prolong the life of your spot & stain cleaner and prevent blockages or problems occurring follow this guide.

Always carry out cleaning when the product has been switched off for a short period of time.

CAUTION! never clean the cleaner or any parts of it whilst the plug is switched on at the mains.

This appliance can be cleaned by wiping a damp soft cloth to keep the outside free of dirt including dust. Use a dry cloth to clean the power cord.

To avoid unpleasant damp smells clean both tanks and ensure they are fully air dried before storing and after every use.

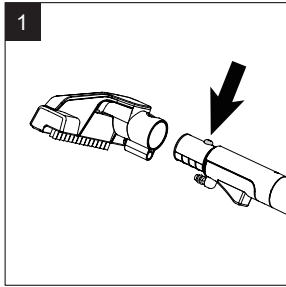

1 Press the wash tool release button and pull to remove the tool from the hose.

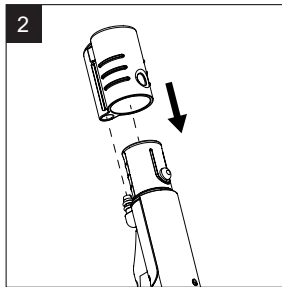

2 Half fill the clean water tank, insert the self-cleaning nozzle onto the handle, start the machine and press the water spray button. This process will 'self-clean' the hose.

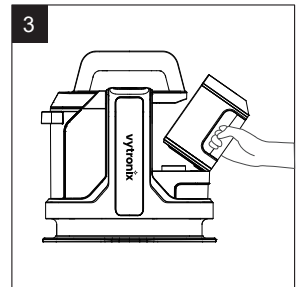

3 Remove the clean water tank from the main cleaner.

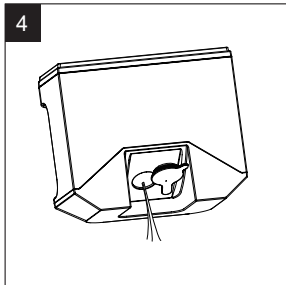

4 Pour water out of the tank.

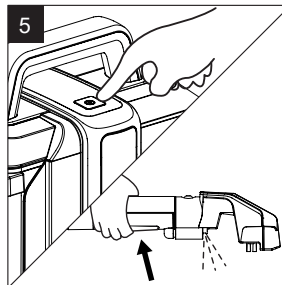

5 Re-install the empty clean water tank and power on, press the water-spray button to remove any excess water from the tank.

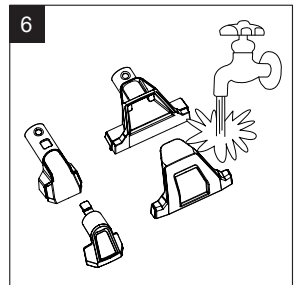

6 Remove the wash tool brush cover to clean by rinsing under the tap. To replace; place cover into position on the wash tool until it clicks into place.

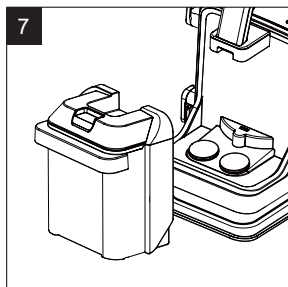

Remove the dirty water tank from the main cleaner.

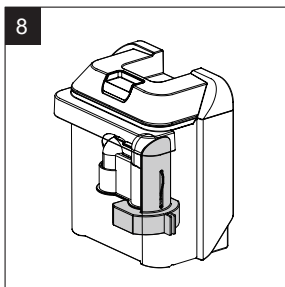

Empty the dirty water tank after every use or when the water level reaches the max fill line. The float inside will prevent suction if the tank is full.

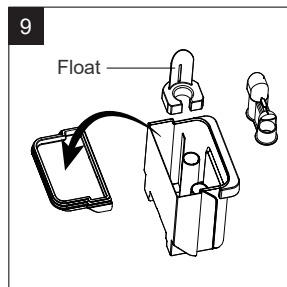

Remove the tank lid, remove the water fill guide and float.

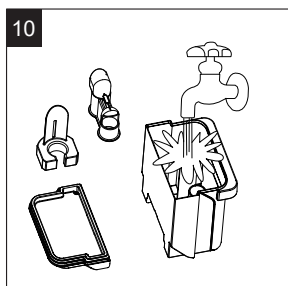

Clean all parts with warm water only. Do not use washing up liquids or other chemicals.

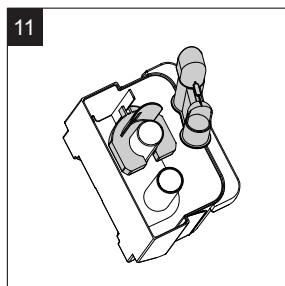

Thoroughly wash and dry the inside of the tank and refit the float and water fill guide and replace the tank lid.

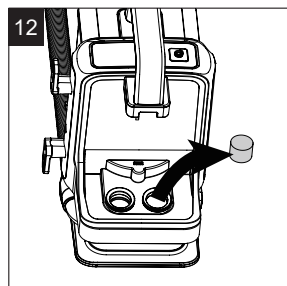

Remove small foam filter to clean by rinsing under the tap. Ensure this is fully dry before replacing and using in the appliance. TIP! Place on or near a radiator to dry.

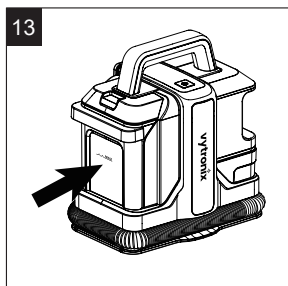

Reinstall the dirty water tank into place on the cleaner.

SAFE STORAGE

Always unplug from the mains when not in use.

Wrap the hose around the base for storage.

Ensure the tanks are empty, clean, and dried before storing, especially if storing in a cold area like a garage or garden shed. Cold weather may cause water residue to freeze inside the tank/s.

TROUBLESHOOTING

Problem	Possible cause	Solution
No power	<ul style="list-style-type: none"> ● The plug is not connected to the mains. ● Fuse needs replacing ● The cord is damaged. 	<ul style="list-style-type: none"> ● Check the mains socket and plug. ● Check and change fuse (13amp required) ● Contact vytronix support (support@vytronix.com)
No water releases when pressing the water release button	<ul style="list-style-type: none"> ● Water inlet tube is blocked. ● Wash tool is blocked. ● The clean water tank is not correctly fitted 	<ul style="list-style-type: none"> ● Remove the wash tool and check there is no obstruction. ● Check the connection between the wash tool and the hose handle and retry. ● Ensure the clean water tank is correctly fitted.
No suction / No water collecting into the dirty water tank	<ul style="list-style-type: none"> ● The cleaner is not on ● The dirty water tank is full. ● The hose is blocked. ● Floor nozzle inlet blocked. ● The water guide or float are not correctly fitted. 	<ul style="list-style-type: none"> ● Turn on the power. ● Clean the dirty water tank. ● Check and clean the hose. ● Detach floor nozzle from the hose and clean in warm water using a bottle brush or gentle scrub sponge to remove blockage. ● Clean or change the sponge filter located under the dirty water tank and check the float is correctly fitted in the tank.
Excessive noise – high pitched tone	<ul style="list-style-type: none"> ● The float in the dirty water tank has activated. ● The hose or wash tool is blocked. ● The dirty water tank is not correctly fitted. 	<ul style="list-style-type: none"> ● Empty the dirty water tank. ● Check and clean the hose to remove the blockage. ● Remove and check the wash tool for blockages. ● Refit the dirty water tank.
Foaming or soapy residue inside the tank or on the floor/surface	<ul style="list-style-type: none"> ● Incorrect detergent has been used. ● Incorrect amount of detergent has been used. 	<ul style="list-style-type: none"> ● Fully clean the tanks and refill with warm water only, pump the water through the machine using the hose cleaning tool to remove excess foam / residue. ● Spray additional water only onto the flooring or surface before collecting the water and solution residue into the tank



vytronix

Powerfully simple

If you have any queries or require assistance with using your product including set up, troubleshooting or registration, please email our customer care on support@vytronix.com.

Register your warranty at www.vytronix.com