

1 2 3 4

NOTES:

4" x 1 1/2 (1.5)" x 11 Gage (.12") Allum. Tube
All Measurements in Inches
Approx. Part Weight: 14. lbs.

Parts:	Qty:

A

A

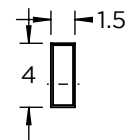
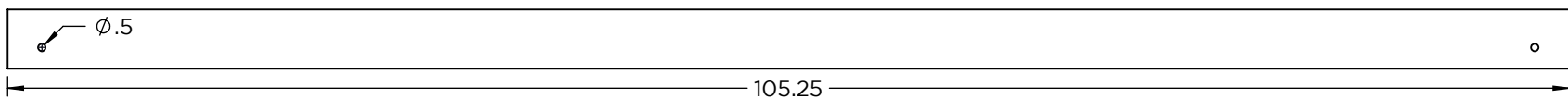

B

B



1345 TANEY STREET
NORTH KANSAS CITY, MO 64116
(T) 888-990-2990
(P) 816-471-1349
SALES@LEADINGEDGESAFETY.NET
Information in this drawing is for reference only.

Scale: 1/12" = 1" (8.5x11)
DWG: RB-07-TB-120-16

Cast Weighted Ballasted Base
Toe Board Tube, 10 Foot Rail
Cut and Drilled Layout

1 2 3 4