

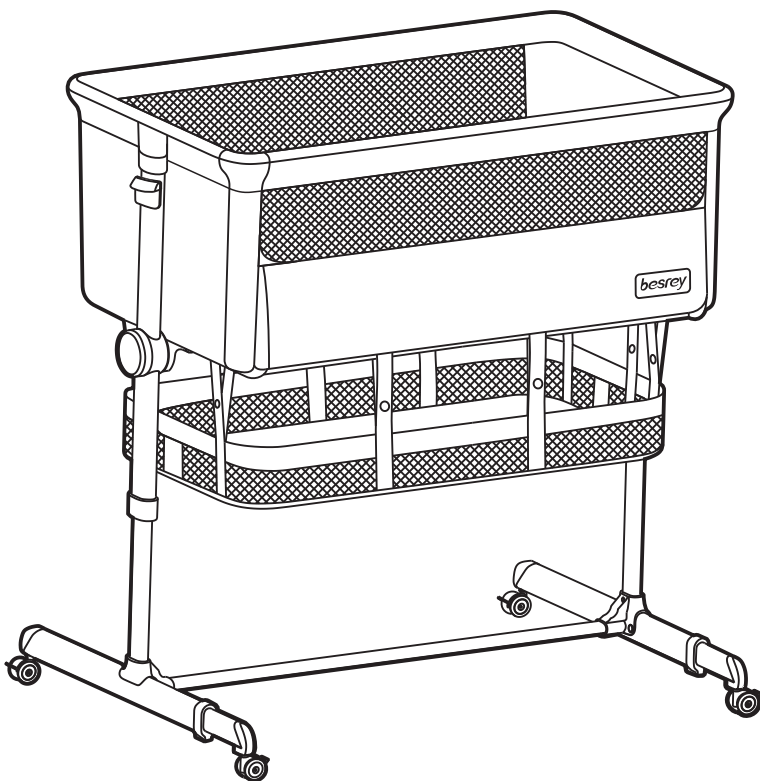

# Bedside Crib

## Instruction Manual



Model: BR-Y521

---

**IMPORTANT:**  
**KEEP FOR FUTURE REFERENCE READ CAREFULLY**

## Contents

---

Instruction Warning - - - - -	01
Specifications - - - - -	04
Parts List - - - - -	05
How to Assemble the Bedside Crib - - - - -	06
How to Lock the Wheels - - - - -	12
How to Adjust the Height - - - - -	13
How to Use the Bedside Sleeper Mode - - - - -	14
How to Use the Bedside Sleeper Mode with Ottoman Beds or Divan Beds - - - - -	17
Cleaning and Maintenance - - - - -	19

---

FOR YOUR CHILD'S SAFETY, READ THESE INSTRUCTIONS CAREFULLY BEFORE ASSEMBLY AND USING THE PRODUCT. FAILURE TO FOLLOW THESE WARNINGS AND INSTRUCTIONS COULD RESULT IN SERIOUS INJURY OR DEATH. KEEP THIS MANUAL FOR FUTURE REFERENCE.

## **WARNING**

**DO NOT MOVE THE PRODUCT WITH THE CHILD INSIDE.**

**DO NOT ADJUST THE PRODUCT WITH THE CHILD INSIDE.**

**DO NOT USE THE PRODUCT WITH MORE THAN ONE CHILD AT A TIME.**

**DO NOT USE THE PRODUCT IF ANY PART IS BROKEN, TORN, OR MISSING.**

**ONLY AN ADULT SHOULD ASSEMBLE, FOLD AND UNFOLD THE BEDSIDE SLEEPER.**

**ENSURE USERS OF THIS PRODUCT ARE KNOWLEDGEABLE ON ITS CORRECT OPERATION.**

- This product is intended for use for babies aged between 0 and 5 months, weighing up to a maximum of **15kg/33lb**.
- The bedside sleeper is designed for use only with adult beds that are between 23.2-31.8 inches (**59-81cm**) from floor to top of the adult mattress.
- Before assembly, check that the product and all of its components have not been damaged or missing during transportation.
- Should any part be damaged or missing, do not use and keep it out of reach of children. Contact besrey for replacement parts and instructions if needed.
- Be sure the product is completely set up before use, including rails fully erected, and the mattress/pad flat.
- The product is ready for use **ONLY** when all locking mechanisms are engaged. Check carefully that these are engaged before use.
- All assembly fittings should always be tightened properly and those fittings should be checked regularly and re-tightened as necessary. When not in use, keep it away from children.
- Never substitute parts. **DO NOT** use accessories, spare parts, or any component not supplied or approved by besrey, as they may make the product unsafe.
- Be aware of the risk of open fires and other sources of strong heat, such as electric bar heaters, gas fires, etc.

## **ENTRAPMENT/FALL HAZARD**

**ALWAYS USE ON A FLAT, LEVEL FLOOR.**

**DO NOT USE THE PRODUCT WITHOUT THE SUPPORT FRAME.**

**THIS BEDSIDE SLEEPER CANNOT BE USED WITH A RECESSED BED.**

**IT IS DANGEROUS TO PLACE THE PRODUCT ON A RAISED SURFACE SUCH AS A TABLE.**

**TO PREVENT SERIOUS OR FATAL INJURY FROM FALLS, NEVER LEAVE THE CHILD UNATTENDED.**

- When a child can sit, kneel or pull themselves up, the product should not be used anymore for this child. Move your child to another sleeping product when your child reaches this stage.
- To prevent serious or fatal injury from falls, always keep the child within arm's reach when using this product. NEVER leave your child unattended.
- NEVER leave your infant in the product without the GUARDRAIL installed in the uppermost position, unless securely attached to the adult bed.
- ALWAYS engage the brakes before placing your child in the product. BE SURE both sides are locked in position whenever a child is in the product.
- To reduce the risk of SIDS (Sudden Infant Death Syndrome), pediatricians recommend healthy infants be placed on their back to sleep unless otherwise advised by your physician.
- Before use in 'bedside sleeper mode' (fixed to the bed), make sure the brake system is engaged.
- When the product is used in 'bedside sleeper mode', make sure the securing straps are hooked and tensioned properly before laying the child in the product.
- It is recommended to make the straps shorter than the width of the mattress to ensure the product is pressed securely and tightly against the adult bed.
- There must be no more than a 1/2 inch (13mm) gap between the product and the adult's mattress. BE SURE that the product's GUARDRAIL is NOT higher than the adult's mattress.
- Failure to use the attachment system that prevents the product to move away from the adult bed could cause the infant to fall out of the product when using the "bedside sleeper mode".
- The tube of the Top Support Frame must be fully assembled when not using the 'bedside sleeper mode' as the child will fall out of the soft lining.

# **SUFFOCATION/STRANGULATION HAZARD**

**USE ONLY THE PAD/MATTRESS PROVIDED BY THE MANUFACTURER.**

**NEVER ADD A PILLOW, COMFORTER, OR ANOTHER MATTRESS FOR PADDING.**

**THE INFANT MAY SUFFOCATE IN GAPS BETWEEN EXTRA PADDING AND THE SIDE OF THE BASSINET.**

- NEVER add soft bedding like a water mattress or down feather cushions, etc. NEVER add a pillow, comforter, or another mattress for padding to reduce depth.
- Use ONLY the mattress provided by besrey. Using a thicker or a different sized mattress/pad may allow a child's head to get between mattress/pad and side of the product causing suffocation.
- Remove and dispose of all plastic bags and packaging materials, and keep them out of reach of children before use.
- NEVER use plastic shipping bags or other plastic films as mattress covers not sold and intended for that purpose. They can cause suffocation.
- The child can become entrapped and die when improvised netting or covers are placed on top of the product. Never add such items to confine the child in the product.
- NEVER place the product near a window where cords from blinds or drapes can strangle a child.
- Keep the securing straps out of reach of children when not using the 'bedside sleeper' mode.
- DO NOT place items with a string around the child's neck such as hood strings, pacifier cords, etc.
- DO NOT suspend strings over the product or attach strings to toys. Do not allow children to climb inside or play with the travel bag.

# Specifications

Model No.	BR-Y521
Product Name	Bedside Crib
Age Range	0-5Months
Height Adjustments	9 Heights
Max. Load	15kg/33lb
Product Weight	29.32lb
Height Range	31-39.4in / 78.5-100cm
Product Size	36.4x26.6x39.4in / 92.5x67.5x100cm

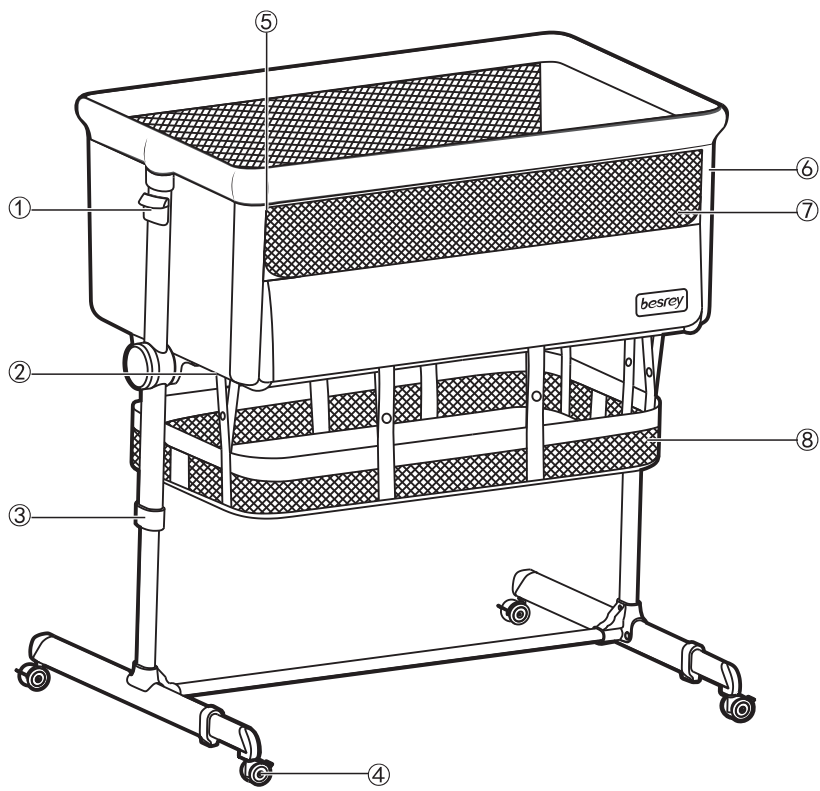

- ① Height Adjusting Handle

② Buckles for Securing Straps

③ 9 Adjustable Heights

④ Brakes
- ⑤ Co-sleeping Side Top Zippers

⑥ Foldable Co-sleeping Side

⑦ Breathable Mesh

⑧ Bottom Storage Basket

Parts List

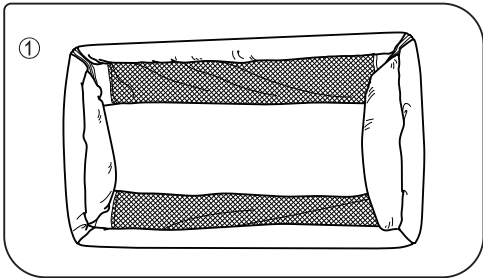

Top Support Frame with Lining x 1

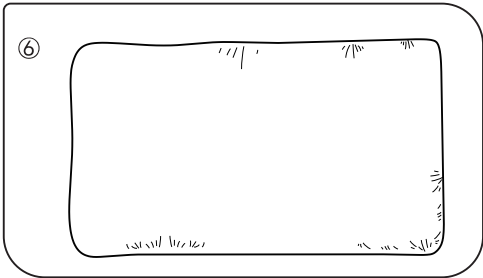

Mattress with Removable Cover x 1

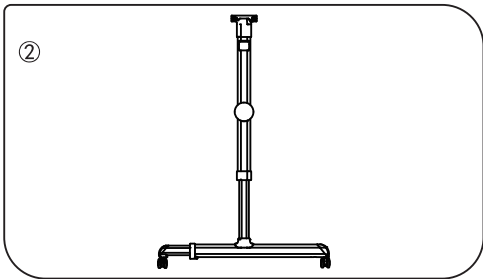

Side Support Bar x 2

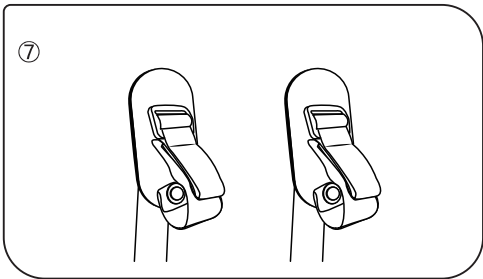

Securing Strap with Anchor Plate x 2

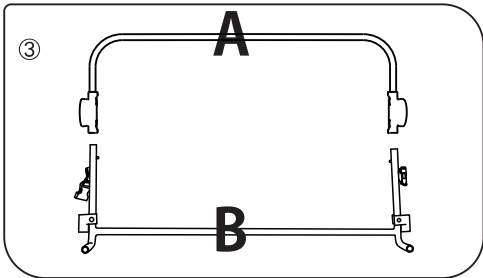

Middle Support Frame x 2

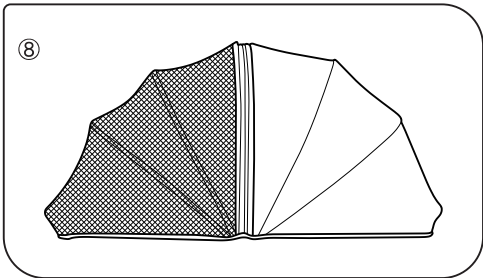

Detachable Mosquito Net x 1

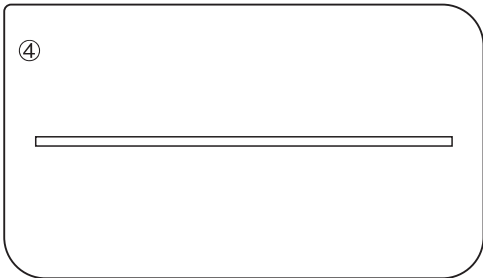

Bottom Cross-bar x 1

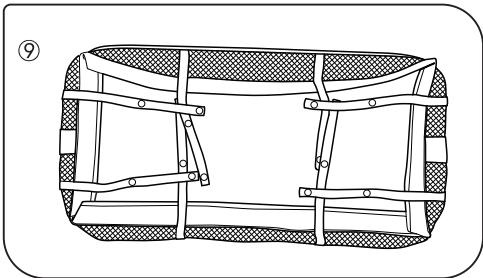

Bottom Storage Basket x 1

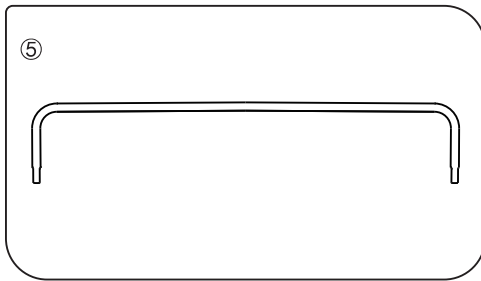

Guardrail x 1

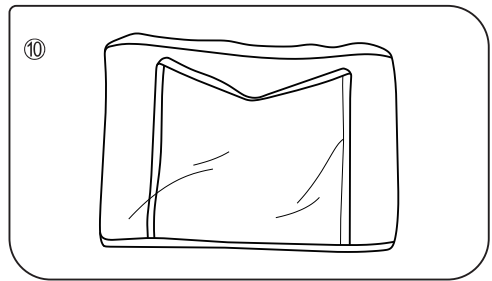

Travel Bag x 1

⚠ The product includes above parts, please check carefully before assembly, DO NOT use product if any part is missing. ⚠

## How to Assemble the Bedside Crib

### Step 1.

- A) Extend bottom tube of the Side Support Bars until you hear a “Click”.
- B) Lay one of the Side Support Bars on a flat surface. Securely insert the Bottom Cross-bar into the Side Support Bar until you hear a “Click”.
- C) Repeat the process for the other side.

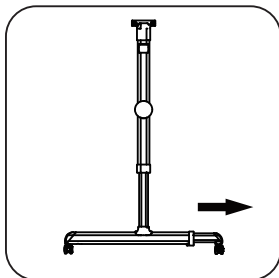

Step 1-A

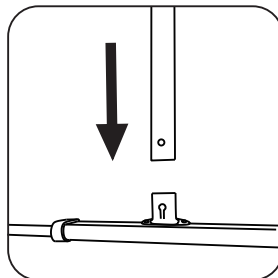

Step 1-B

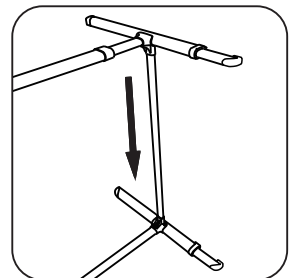

Step 1-C



## Step 2.

- A) Align the Guardrail and part B of the Middle Support Frame, push them together until you hear a "Click".
- B) Align the buttons and holes on two parts of the Middle Support Frame, push them together until you hear a "Click".
- C) Securely insert both sides of the assembled Middle Support Frame into the Side Support Bars until you hear a "Click".

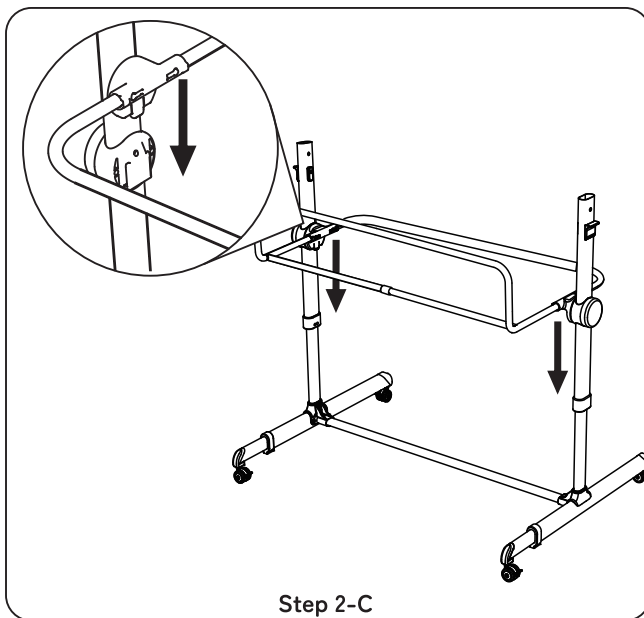
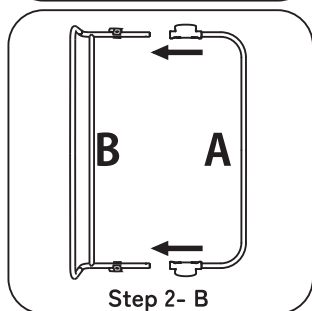
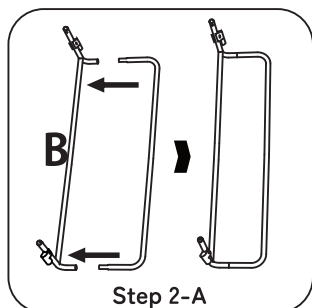

### Step 3.

- A) Align the Top Support Frame and the structure assembled in last step.
- B) Securely insert both sides of the Top Support Frame into the Side Support Bars until you hear a "Click". The co-sleeping side and the Guardrail should be on the same side.

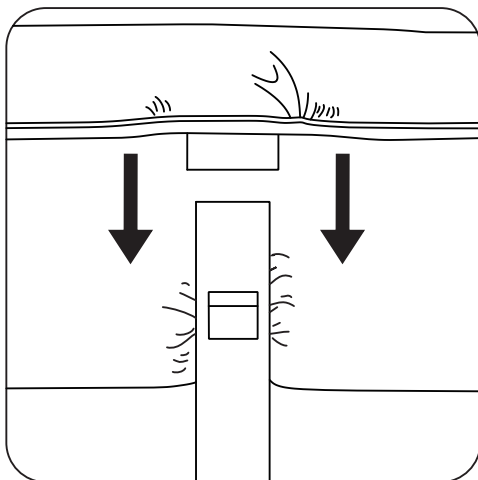

Step 3-A

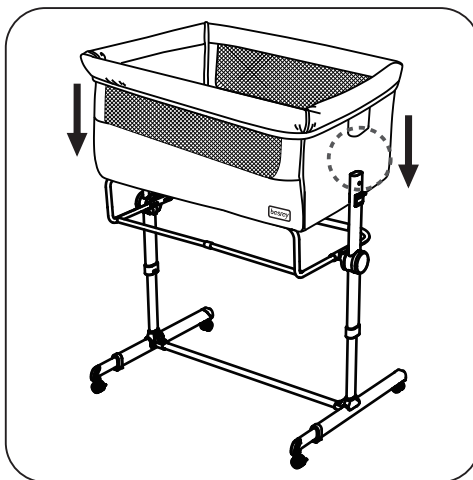

Step 3-B

⚠ Incorrect assembly might cause collapse while in use! Overloading, incorrect folding and the use of accessories, may cause damage to or break this crib. ⚠

#### Step 4.

- A) Make sure the lining is fully expanded.
- B) Zip the bottom of the lining after covering the Guardrail.
- C) Use the velcro under the lining to securely fasten the lining onto the Middle Support Frame.

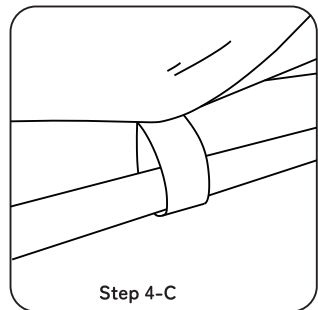
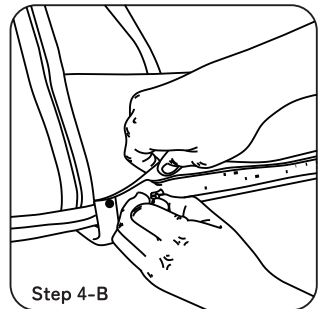
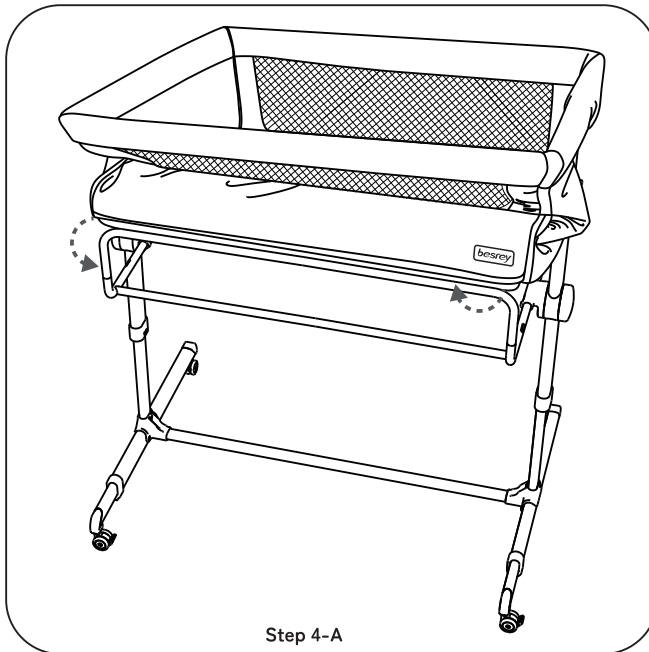

⚠ Make sure every velcro strip is attached securely. ⚠

#### Step 5.

Put the mattress inside the crib. Make sure it fits snugly into the bottom of the crib.

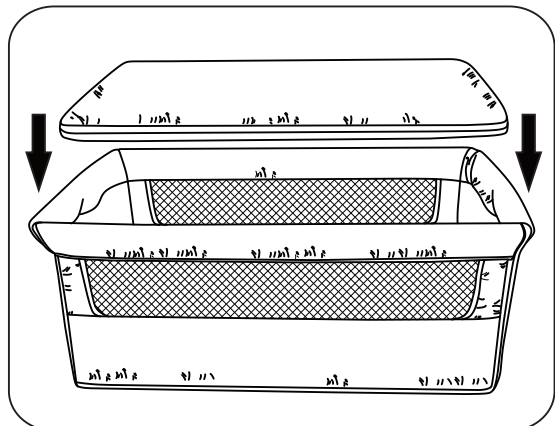

⚠ USE ONLY the mattress provided by besrey. ⚠

**Step 6.**

- A) Attach the Bottom Storage Basket with 8 snap fasteners.
- B) Make sure every fastener is snapped securely.

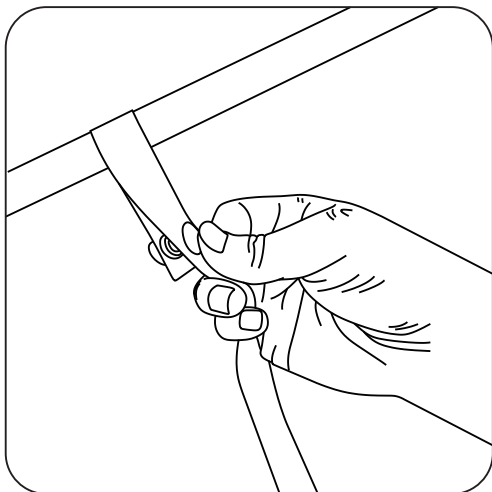

**Step 6-A**

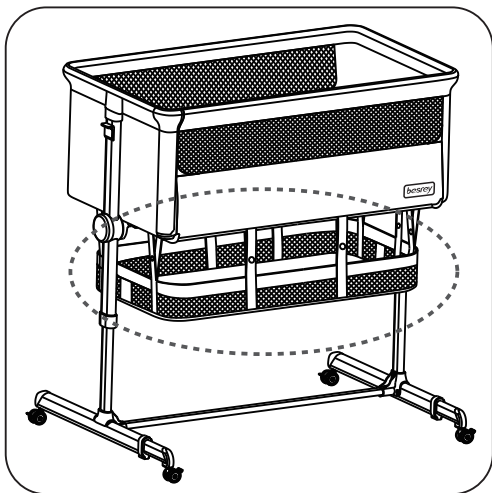

**Step 6-B**

⚠ The maximum load bearing capacity of the basket should not exceed 3kg/6.6lb. ⚠

### Step 7.

- A) Clasp the Mosquito Net at the middle of Top Support Frame.
- B) Stretch the 4 corners of the net to cover the crib. The edges of the Mosquito Net and the crib should be in a straight line.

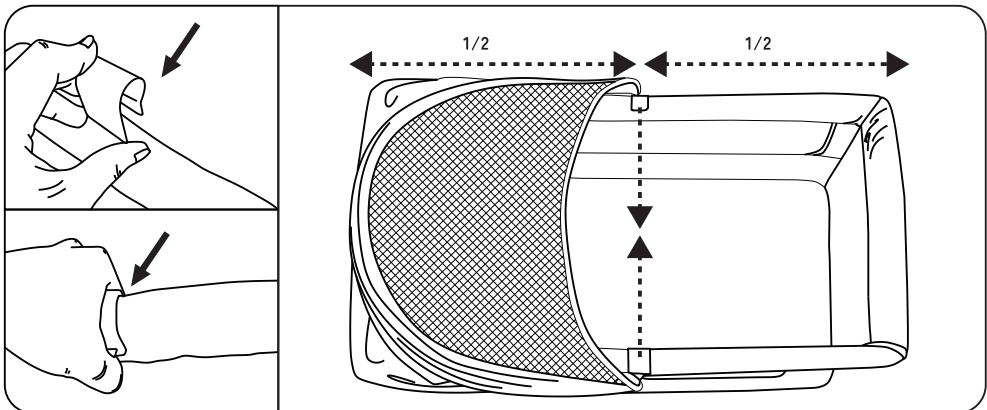

Step 7-A

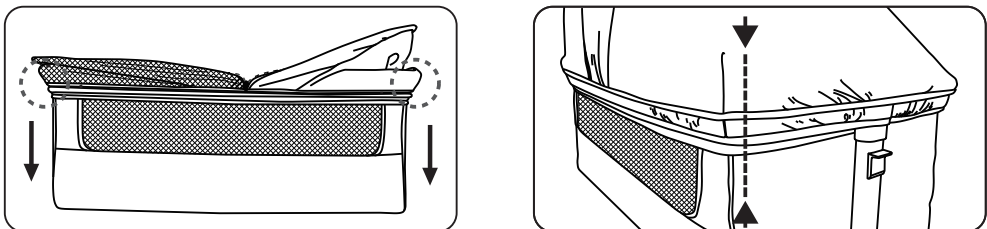

Step 7-B

### Step 8.

Zip the Mosquito Net. The assembled product should be as shown below.

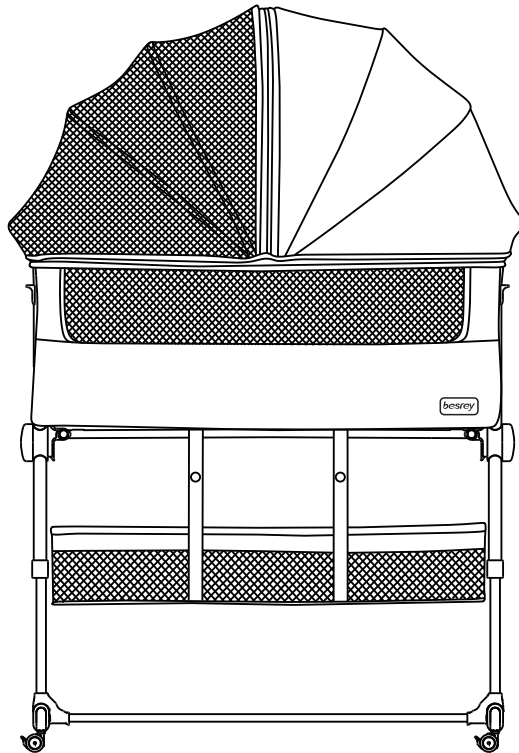

⚠ Check every part is tight and securely fitted before use. ⚠

### How to Lock the Wheels

A) Press the pedal on the wheel to lock.      B) Lift up the pedal on the wheel to release the lock.

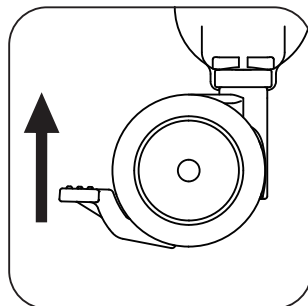
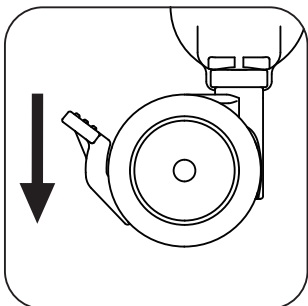

⚠ The wheels must be locked before the baby is put into the crib. ⚠

## How to Adjust the Height

The crib can be adjusted to 9 different heights. To adjust the height, you should:

- A) Pull up the handle on the two sides simultaneously.
- B) Set a safe height by raising or lowering the crib.
- C) Release the two handles to hear a “Click” which means it is locked.

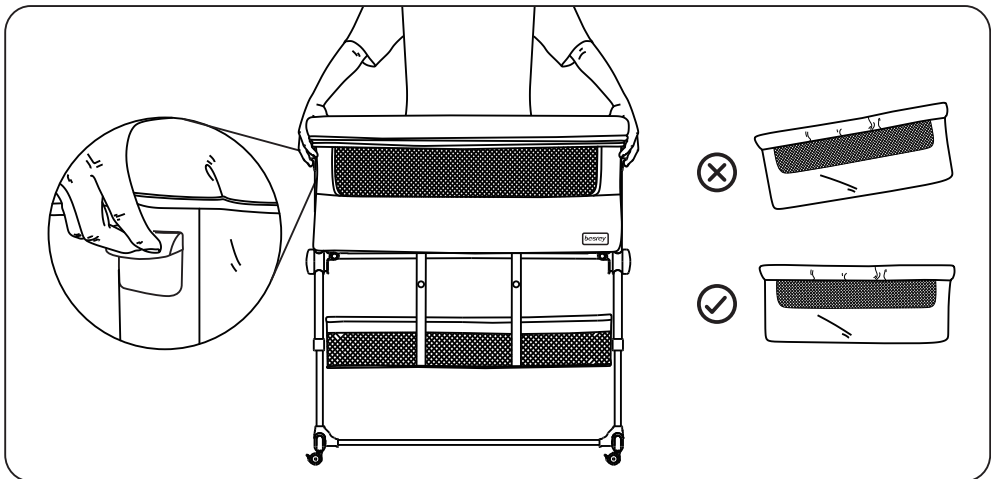

⚠ The two sides of the crib must always be set to the same height to ensure a flat and safe sleeping environment for your child. ⚠

⚠ Suitable only for adult beds with a height of 23.2–31.8 inches (59–81cm) from floor to top of mattress. ⚠

## How to Use the Bedside Sleeper Mode

### Step 1.

- A) Unzip both co-sleeping side zippers of the Top Support Frame after removing the Mosquito Net; Push the buttons and pull out the tube.
- B) Align the tube and the holes under the Middle Support Frame; Push them together until you hear a “Click”.

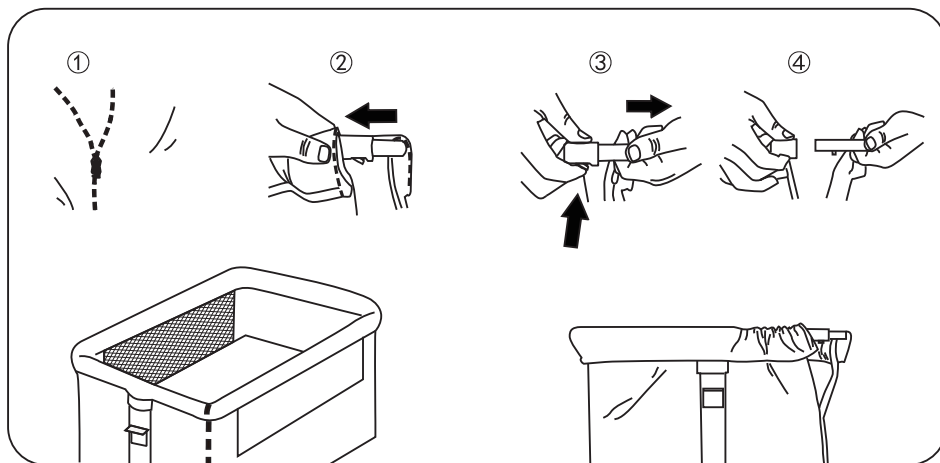

Step 1-A

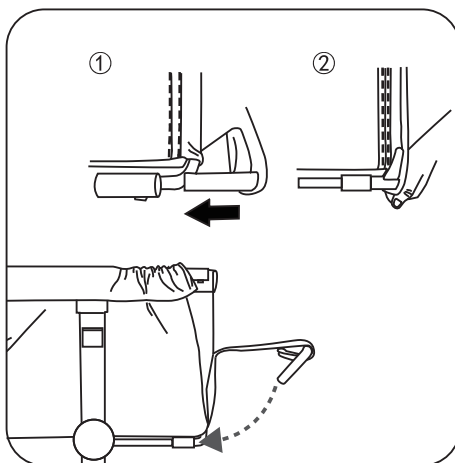

Step 1-B



## Step 2.

Securely attach the Securing Straps to the crib by connecting the buckles.

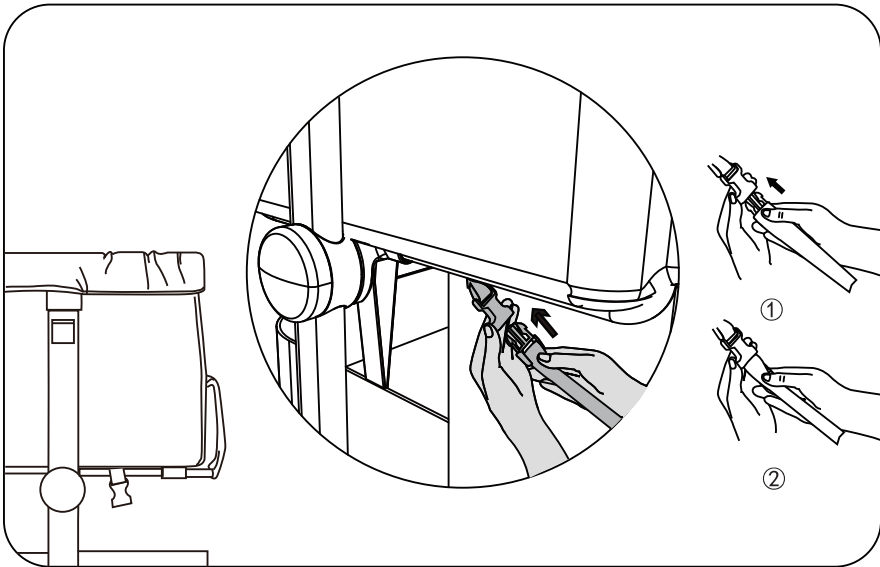

## Step 3.

Check the anchor plates of the Securing Straps and make sure they are secured tightly as below.

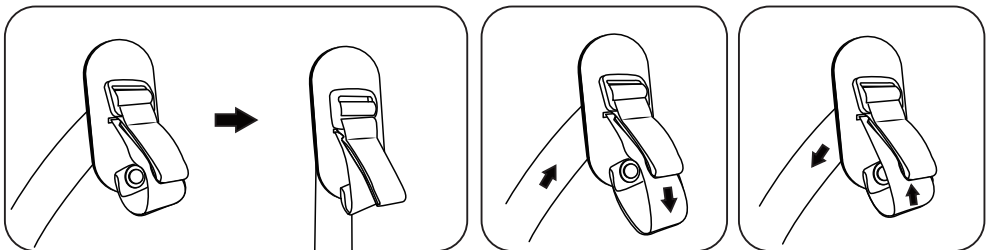

Tighten

Loosen

#### Step 4.

- A) Remove the mattress from the adult's bed and put the Securing Straps between the mattress and the bed like shown below.
- B) Repeat for the other side; Adjust the length of Securing Straps to make sure they are grabbing the adult's bed tightly.

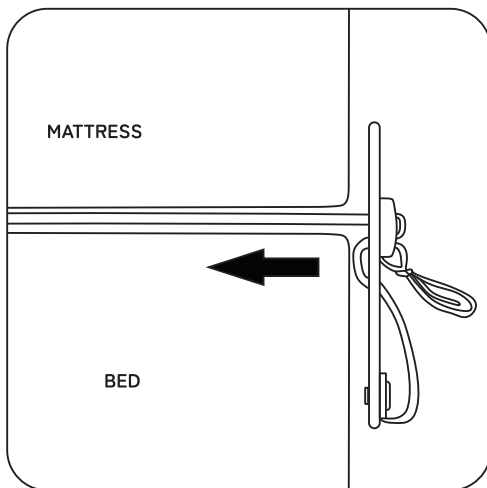

Step 4-A

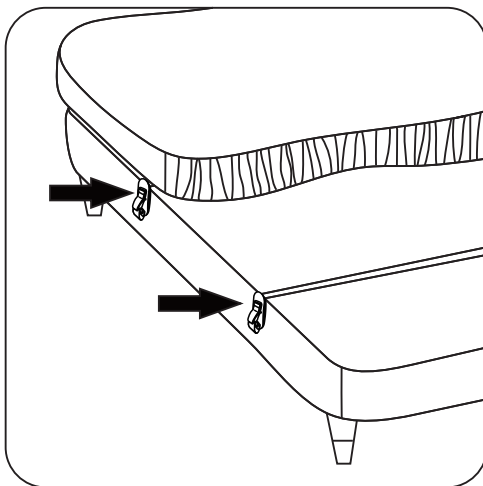

Step 4-B

#### Step 5.

- A) Make sure there is no more than 1/2 inch (13mm) gap between the adult's mattress and the crib.
- B) Reposition the adult's mattress.

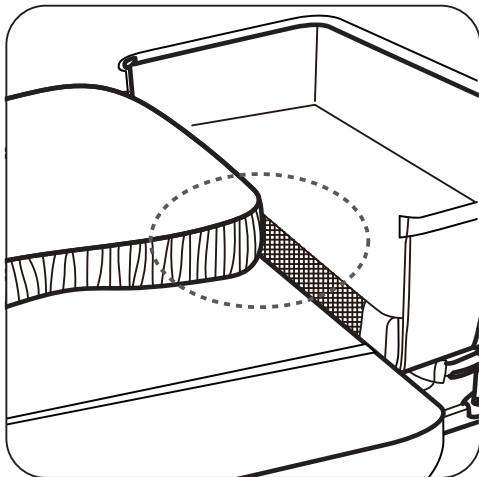

Step 5-A

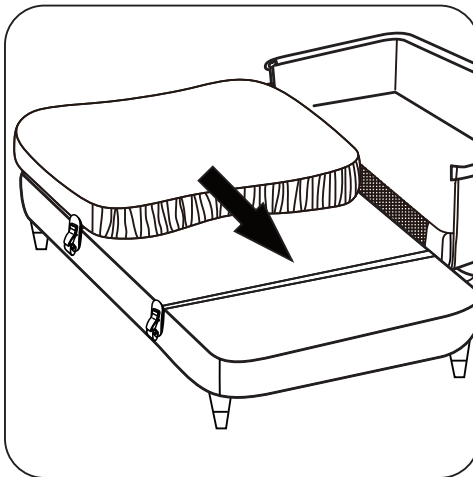

Step 5-B

⚠ Make sure the crib is attached securely to the adult's bed before putting the baby inside. ⚠

## How to Use the Bedside Sleeper Mode with Ottoman Beds or Divan Beds

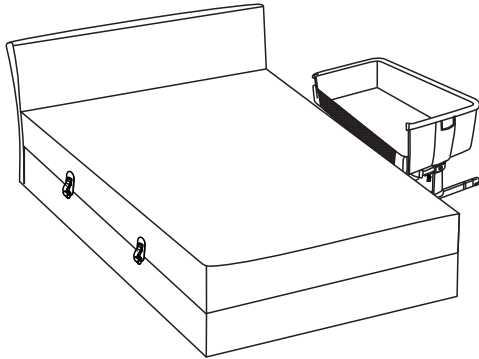

**Step 1.** Press the button underneath each Side Support Bar.

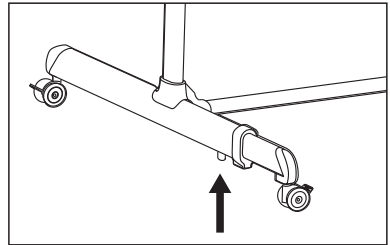

### Step 2.

- A) Push the Side Support Bar against the bed to retract the wheels on the co-sleeping side.
- B) Make sure there is no gap between the adult's mattress and the crib.

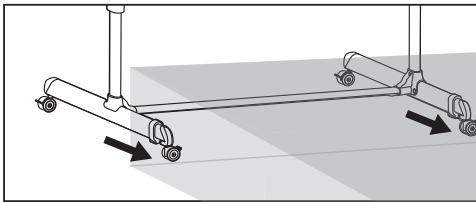

Step 2-A

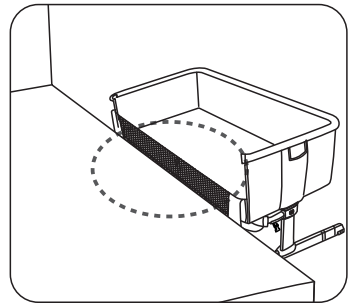

Step 2-B

### Step 3.

- A) Connect and secure the crib to the adult's bed in the same way that you would do with a regular bed.
- B) Engage the brake during use.

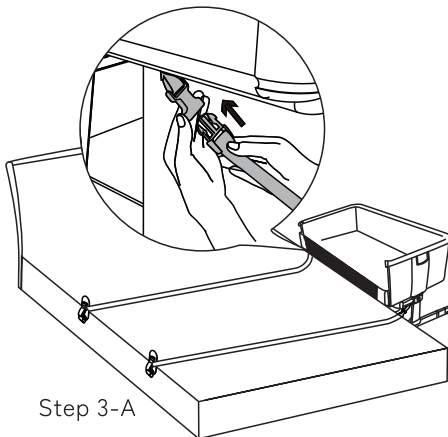

Step 3-A

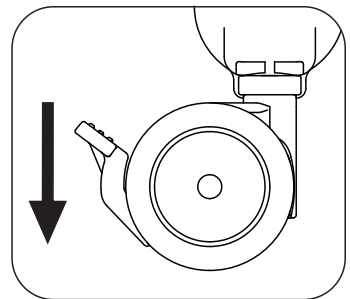

Step 3-B

- ⚠ After using the Bedside Sleeper Mode, always fully extend the wheels back to their original position until you hear a "click" to ensure stability. ⚠
- ⚠ After using the Bedside Sleeper Mode, always reattach the tube to the Top Support Frame and zip the co-sleeping side zippers. ⚠

## WARNING

- Make sure there is no more than 1/2inch (13mm) gap between the adult's mattress and the crib. If there is large gap, tighten the straps to narrow the gap.
- The height of the Guardrail must NOT be higher than the adult's mattress. If there is, adjust the crib to a suitable height.
- The securing straps should always be put between the mattress and the bed when using "bedside sleeper mode".
- The crib should always be attached to the long side of the parent's bed when using "bedside sleeper mode".
- Use of the product is only permitted with beds and/or mattresses with straight sides, use of the product with a round mattress or water bed is not permitted.

The attachment system must always be correctly used in bedside sleeper mode.

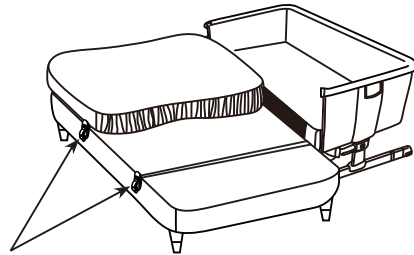
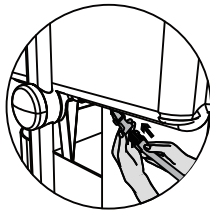

Never use this product in bedside sleeper mode without the anchor plates securely attached to the adult bed.

Mattress and bed frame aligned.

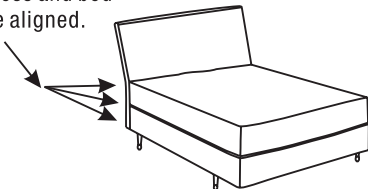

ACCEPTABLE FOR USE

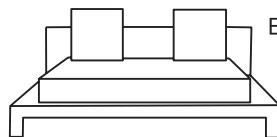

Extended bed frame

NOT ACCEPTABLE FOR USE

## Cleaning and Maintenance

This product requires regular maintenance. The crib and the mattress have a stain-resistant fabric cover which is completely removable and washable. The cleaning and maintenance of the crib must only be carried out by an adult.

### Clean the Lining

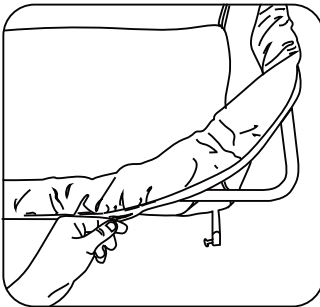

**Step 1:**  
Unzip the lining at top and  
detach from Top Support Frame

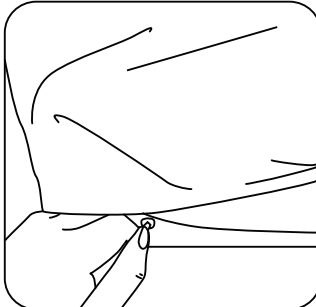

**Step 2:**  
Unzip the lining at bottom and  
remove from the Guardrail

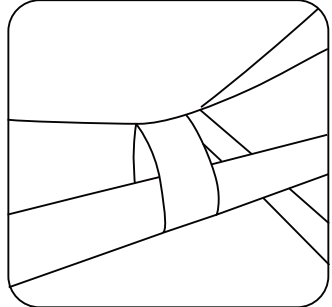

**Step 3:**  
Detach the velcro at the bottom of  
the lining

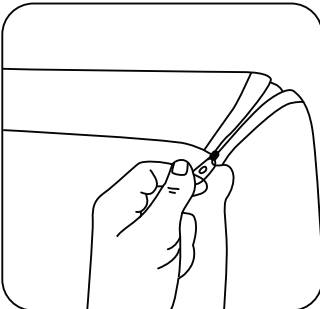

**Step 4:**  
Unzip both co-sleeping side zippers  
of the Top Support Frame

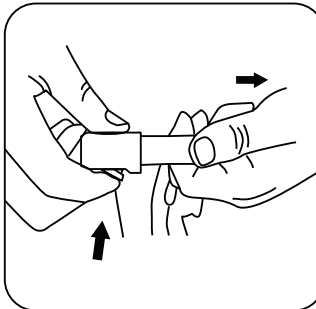

**Step 5:**  
Push the buttons on both sides

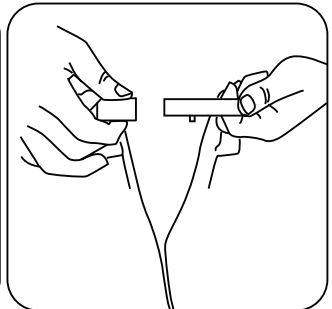

**Step 6:**  
Detach the tube

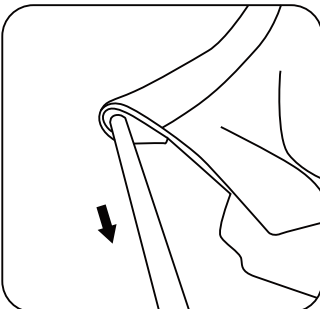

**Step 7:**  
Pull out the tube from the lining

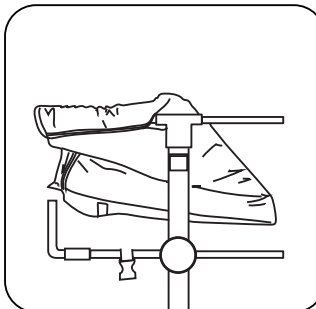

**Step 8:**  
Pull out the lining

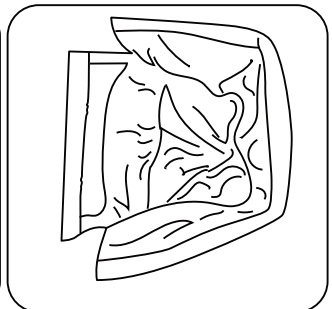

**Step 9:**  
The lining is ready for washing

## Clean the Cover

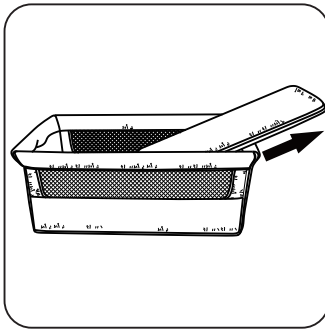

**Step 1:**  
Take out the mattress

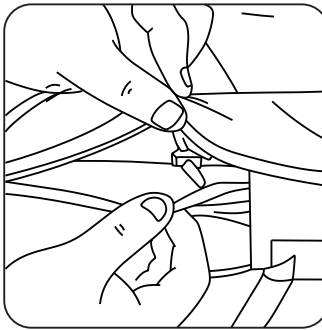

**Step 2:**  
Unzip the cover and take out the padding

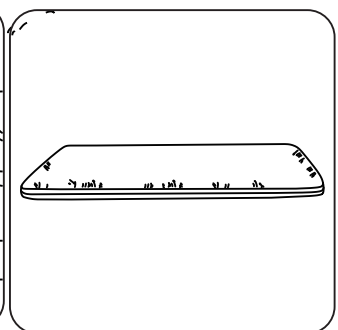

**Step 3:**  
The cover is ready for washing

## WARNING

### CLEANING

- Hand wash in cold water.
- DO NOT bleach and dry clean.
- DO NOT iron or tumble dry. Drip dry.
- The mattress padding CANNOT be washed.
- Periodically wipe clean plastic parts with a soft damp cloth.
- Always dry the metal parts to prevent the formation of rust if the crib has come into contact with water.
- After each wash check the resistance of the fabric and the stitching.

### MAINTENANCE

- Periodically check the crib for loose screws, worn parts, torn material or stitching. DO NOT use if any irreparable damage occurs.
- Use only the replacement parts provided by besrey.
- Keep the crib in a dry place. If crib gets wet, open crib and allow to dry completely.
- Prolonged exposure to direct sunlight may cause the fabric to fade and plastic parts to warp.

***besrey***<sup>®</sup>

**www.besrey.com**

**support@besrey.com**

**Mon-Fri, 8 am - 6 pm PST**

**FUJIAN BESREY BABY PRODUCTS CO., LTD.**

**Made in China**

---

**Importer:** STIGER, INC.

**Address:** 1370 VALLEY VISTA DR. STE 200-208 DIAMOND BAR,  
CALIFORNIA 91765-0208, UNITED STATES OF AMERICA