

Viaggio Wall

700WSVGO

1.1



GENERAL PRODUCT INFORMATION:

These fixtures are intended to be installed utilizing NEC compliant junction boxes.

This product is suitable for damp locations.

Incandescent version may be dimmed with a standard incandescent dimmer. LED version may be dimmed with a LED dimmer. Consult lamp manufacturer for additional information.

This product may be mounted horizontally or vertically.

This instruction shows a typical installation.

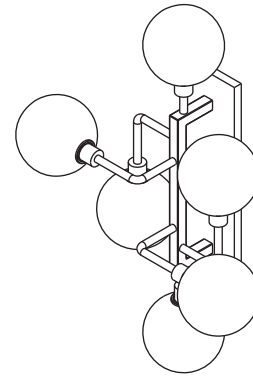

CAUTION - RISK OF FIRE

This product must be installed in accordance with the applicable installation code by a person familiar with the construction and operation of the product and the hazards involved.

Use minimum 90°C supply conductors.

Install the Fixture

1A

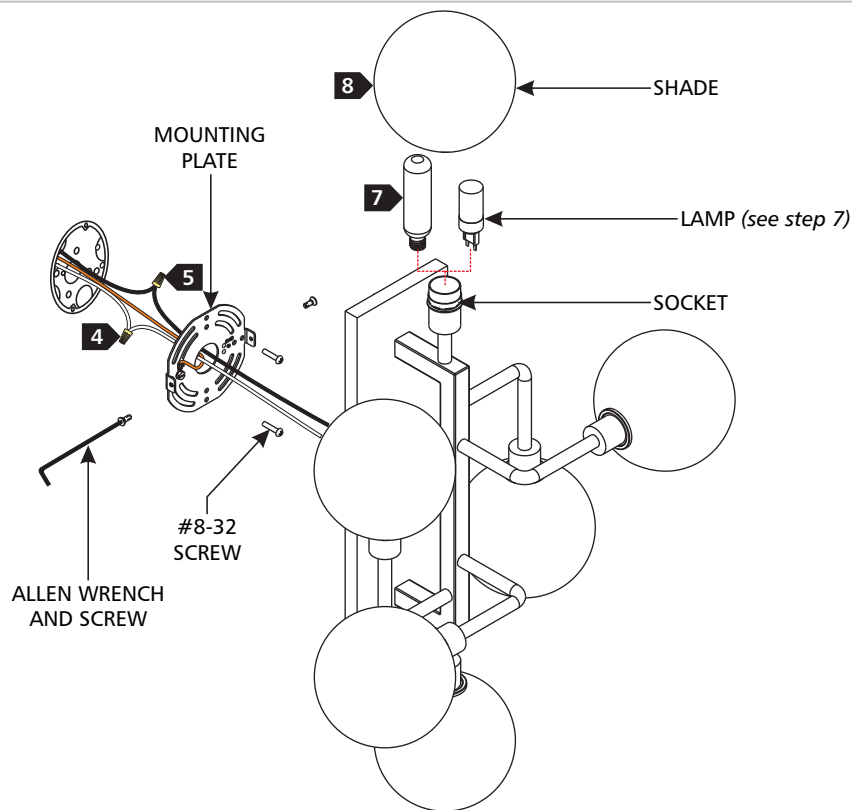

- 1 Remove the mounting plate from the fixture base by unscrewing the Allen screws on the sides of the base using the provided Allen wrench.
- 2 Install the mounting plate to the junction box with the two #8-32 screws (not shown) provided.
- 3 Connect the fixture to a suitable ground in accordance with local electrical codes.
- 4 Connect the white fixture wire to the neutral power line.
- 5 Connect the black fixture wire to the hot power line.
- 6 Properly place all wires and wire nut connections into the fixture base, then mount the fixture base back onto the mounting plate and secure it by installing the Allen screws (reversal of step 1).
- 7 Install the lamp according to fixture model. For Bi-Pin lamps, carefully insert the lamp pins into the holes on the socket. For E17 lamps, screw the lamp into the socket. Refer to the label on the socket for Max Wattage Information.
- 8 Install the shade by carefully screwing it onto the threads on the socket. Make sure the shade is secure before releasing. Repeat steps 7 and 8 for remaining sockets.

SAVE THESE INSTRUCTIONS!



7400 Linder Ave, Skokie, IL 60077
847.410.4400

www.techlighting.com

© 2019 Tech Lighting, L.L.C. All rights reserved. The "Tech Lighting" graphic is a registered trademark of Tech Lighting, L.L.C. Tech Lighting reserves the right to change specifications for product improvements without notification.

A Generation Brands Company