

Monroe Floor and Table Lamp

KST1041, KST1051 | 1.0

GENERATION LIGHTING PORTABLE

GENERAL PRODUCT INFORMATION:

This product is safety listed for dry locations.

This instruction shows a typical installation.

IMPORTANT SAFETY INSTRUCTIONS

This portable lamp has a polarized plug (one blade is wider than the other) as a safety feature to reduce the risk of electric shock. This plug will fit in a polarized outlet only one way. If the plug does not fit fully in the outlet, reverse the plug. If it still does not fit contact a qualified electrician. Never use with an extension cord unless plug can be fully inserted. Do not attempt to defeat this safety feature.

SAVE THESE INSTRUCTIONS!

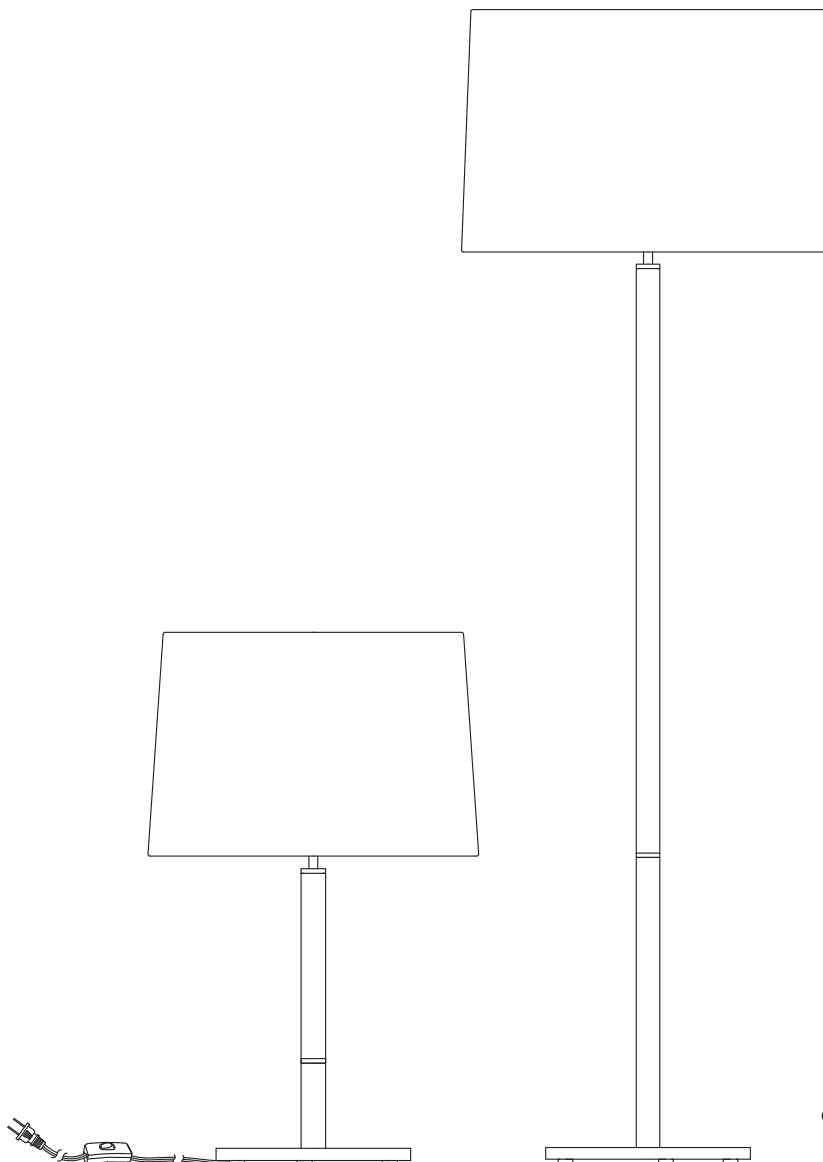

GENERATION LIGHTING
7400 Linder Ave., Skokie, IL 60077
T 847.410.4400 | F 847.410.4500
www.generationlighting.com

Install the Fixture

IA

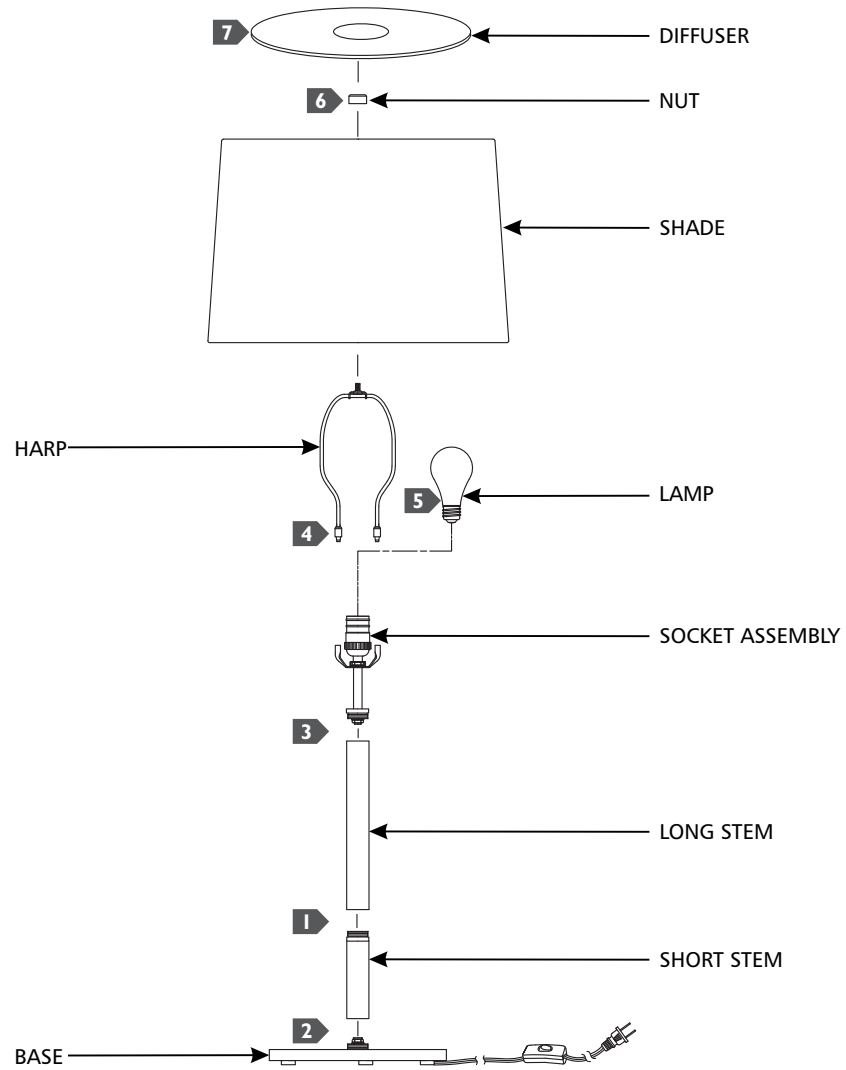

- 1 Screw the stems together to create the stem assembly.
- 2 Screw the stem assembly into the base.
- 3 Screw the socket assembly onto the stem assembly.
- 4 Insert the harp into the socket assembly.
- 5 Screw the lamp into the socket. Refer to the label on the lamp socket for Max Wattage information.
- 6 Place the shade on to the harp and secure it with the nut.
- 7 Place the diffuser on top of the shade.