

## ASSEMBLY INSTRUCTIONS

## Brigitte Samll Double Sconce

Item # PCD 2020

### NOTICE:

This light fixture should be installed in accordance with all applicable, local installation codes, and by a person familiar with the construction and operation of it, as well as the hazards involved. Inspect item and contents carefully. If any damage or defect is found, do not install. Retain all packaging material until installation is complete and approved.

### TOOLS REQUIRED (NOT INCLUDED):

Phillips Screwdriver

Slotted Screwdriver

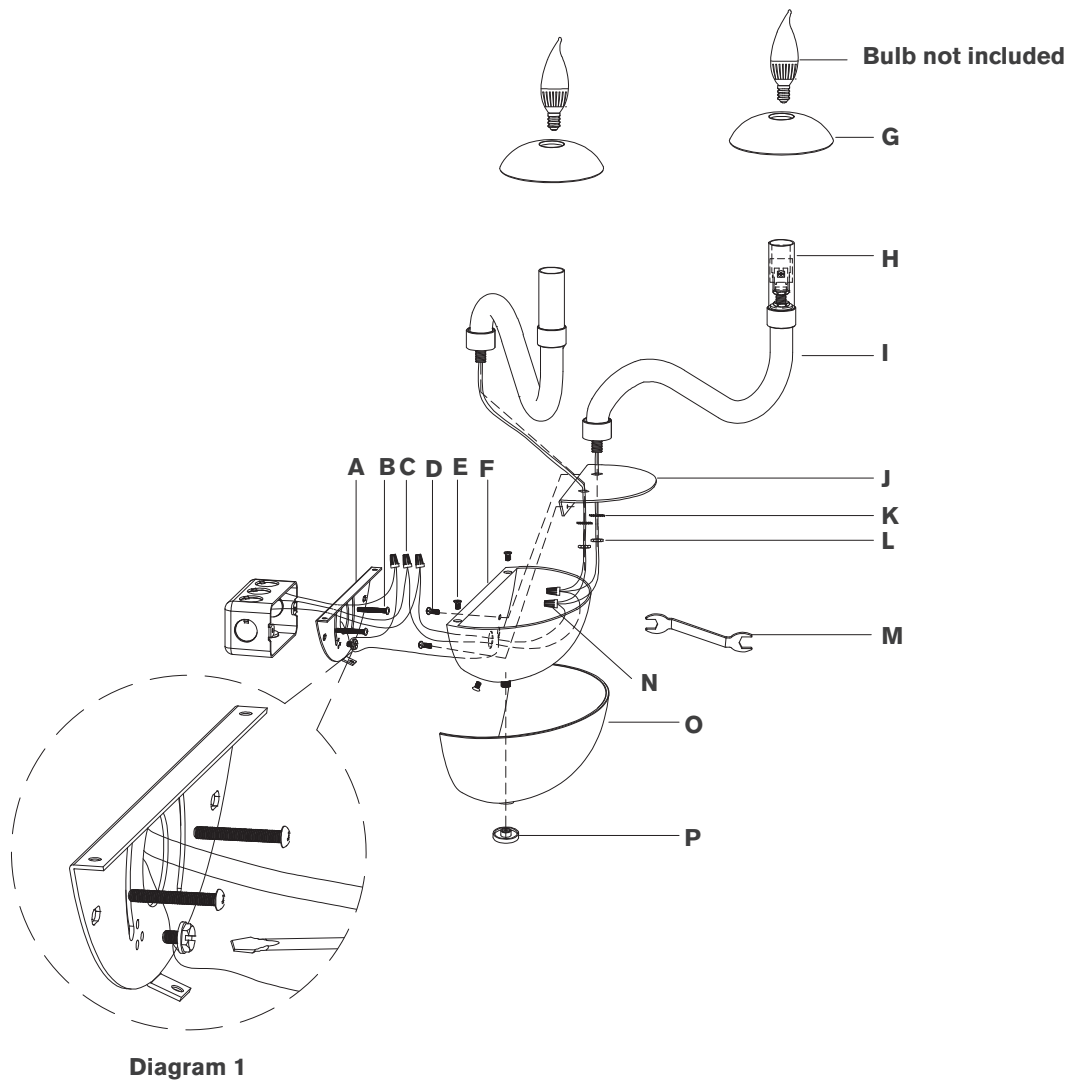

1. Carefully remove all parts from the box. Place on a clean, soft surface.
2. Remove mounting plate **(A)** and metal plate **(J)** from fixture **(F)** by removing screws **(D) & (E)**.
3. Install mounting plate **(A)** to the junction box and secure with the mounting screws **(B)**.
4. Install arms **(I)** to metal plate **(J)**, then secure with lock washers **(K)** and hex nuts **(L)** using provided wrench **(M)**.
5. Connect both arm neutral wires (white) to fixture neutral wire (white) using wire nut **(N)**.
6. Connect both arm hot wires (black) to the fixture hot wire (black) using wire nut **(N)**.
7. Bring the fixture wires through the hole of the fixture **(F)**, then connect metal plate **(J)** using screws **(D)**.
8. Wrap fixture ground wire (bare copper) around the green grounding screw (see diagram 1). Tighten. Continue fixture ground wire and connect to supply ground wire (usually green or bare copper) using wire nut **(C)**.
9. Connect fixture neutral wire (white) to the supply neutral wire (usually white) using wire nut **(C)**.
10. Connect fixture hot wire (black) to the supply hot wire (usually black) using wire nut **(C)**.

**NOTE:** It is imperative that the fixture is grounded.

**CAUTION:** Do not reverse the hot and neutral connections.

## ASSEMBLY INSTRUCTIONS

## Brigitte Samll Double Sconce

Item # PCD 2020

### NOTICE:

This light fixture should be installed in accordance with all applicable, local installation codes, and by a person familiar with the construction and operation of it, as well as the hazards involved. Inspect item and contents carefully. If any damage or defect is found, do not install. Retain all packaging material until installation is complete and approved.

11. Make sure all wire connections are tight, then carefully tuck into the junction box.
12. Install fixture (F) to mounting plate (A) by securing with screws (E).
13. Install glass (O) to fixture (F) and secure with finial (P).
14. Slip bobeches (G) over socket (H).
15. Install light bulbs into sockets.

**Care Instructions:** Clean only with a soft dry cloth or feather duster. Do not use abrasive or chemical agents.

