

Linkstyle

Door & Window
Entry Sensor
User Guide

If you need any support, don't hesitate to
reach out to us at:

contact@linkstyle.life

1-888-419-4888

Main unit

Reset button

LED indicator

Magnet

Anti-tamper switch

Mounting adhesive

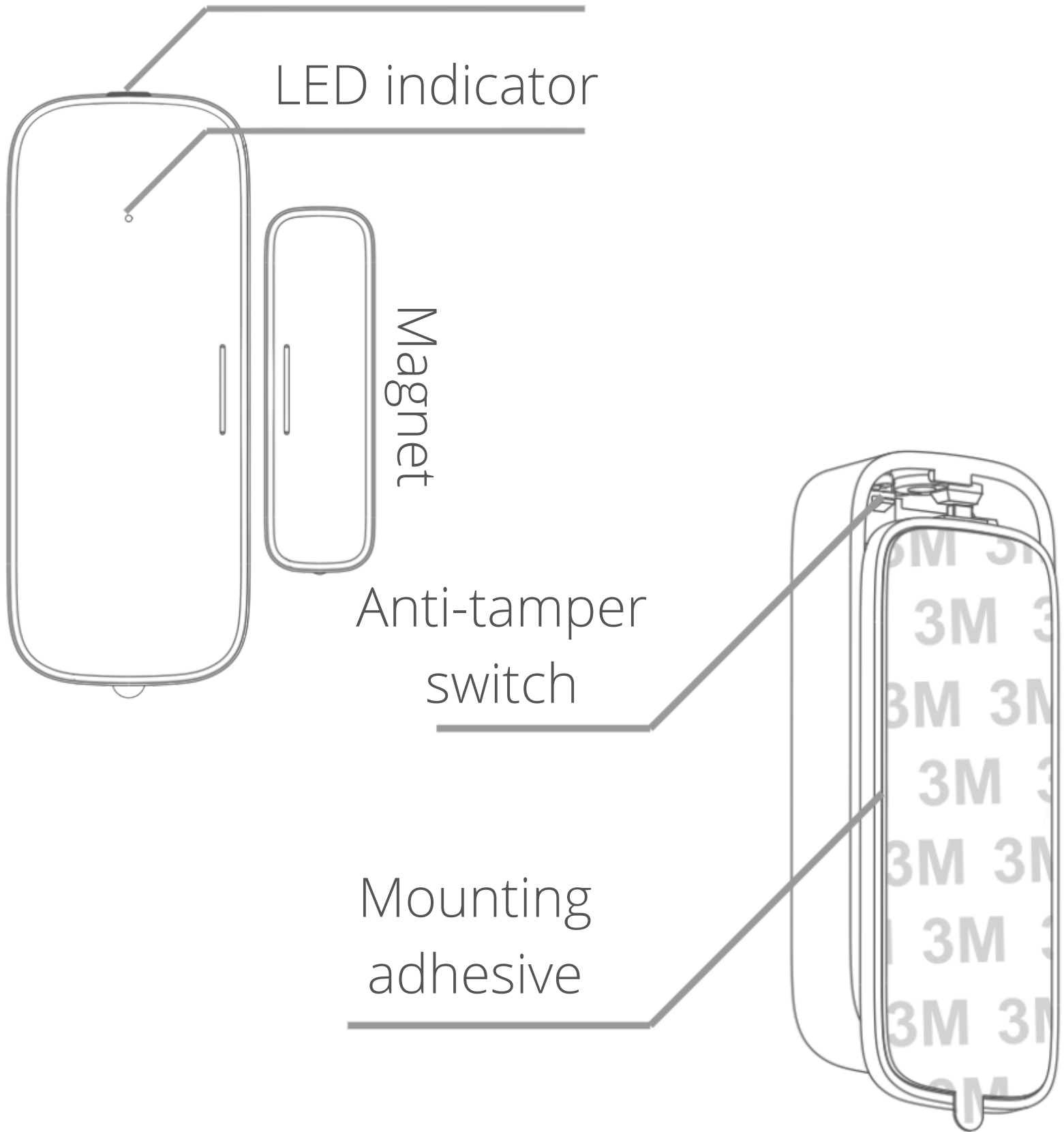

Overview

This entry sensor is triggered and emits a wireless signal when the Magnet module is separated from the Main Unit by 20mm (0.79in.) or more. Use this sensor to detect when a door or a window opens and closes. This device requires a Multi-Function Security Gateway to work.

Features:

- Included 3M mounting adhesive
- Anti-tampering alarm
- ~10mm buffer range

Smart Functions

Install the Linkstyle app

Scan the QR code below to download and install the Linkstyle app. Register a new account on the app if you do not have one.



*Alternatively, you can also search for “Linkstyle” on the Apple App Store or Google Play Store to find the app.

***Important Note:

When registering an account in the Linkstyle app, be sure to set the region to United States of America.



Register

United States of America ▼

Email Address

I Agree [Privacy Policy](#) and [User Agreement](#)

Get Verification Code

Quick Start Guide

Before setting up this device, be sure to have a Multi-Function Security Gateway added to the Linkstyle mobile app. Please refer to the user manual for the gateway if it is not yet set up.

1. In the Linkstyle mobile app, navigate to the “Devices” tab. Click the gateway device, then click the “+” button in the gateway page.
 2. On the next screen, choose “Sensor” from the list of devices, then follow the on-screen instructions to complete the setup.
- Keep the gateway and the entry sensor within close proximity during the setup process. You can relocate the device elsewhere within range for regular use after setup.

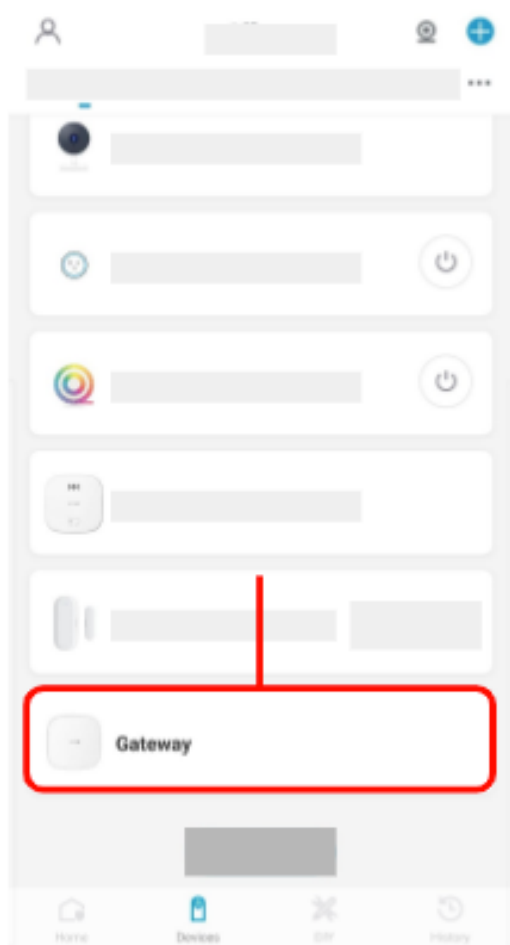

1. Select gateway in "Devices" tab.



2. Tap the add device button.

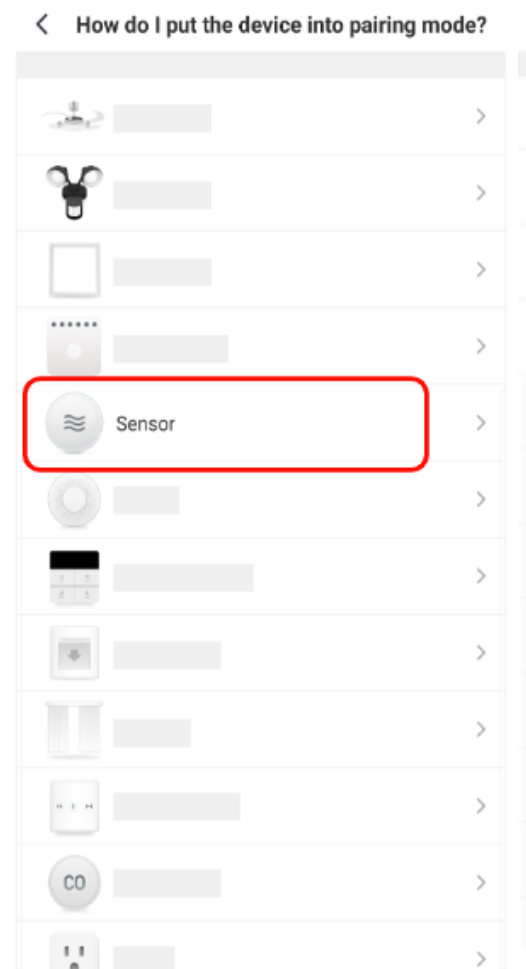

3. Select "Sensor"

When prompted by the on-screen instructions to reset the entry sensor:

1. Slide open the Main Unit by pushing its back cover away from the Reset Button.
2. Pull out the battery insulation strip. The entry sensor will enter setup mode, indicated by the blue flashing LED light on the front panel.

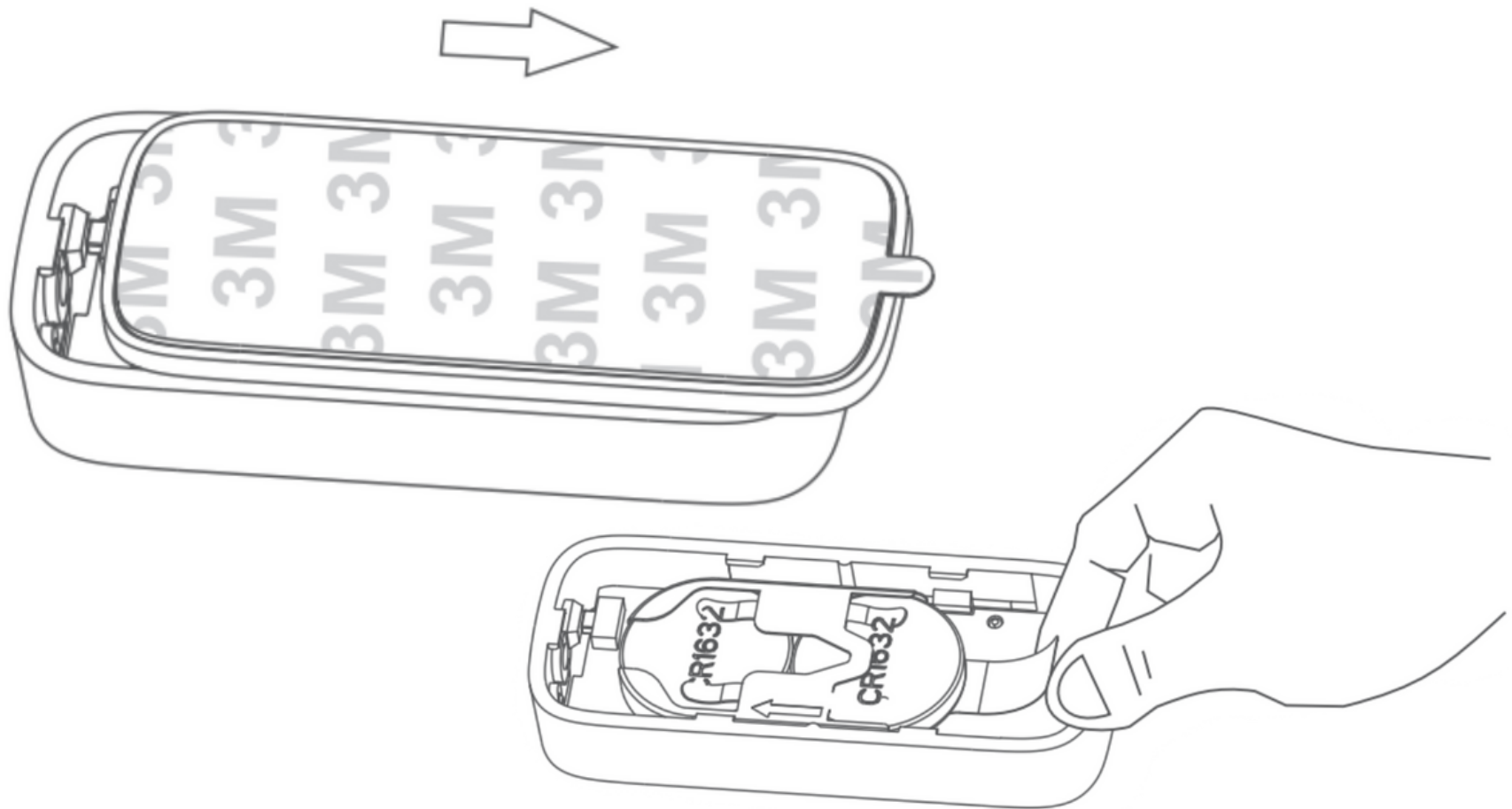

- If the sensor does not enter setup mode automatically, or if you need to manually reset the sensor, press and hold the Reset Button for 5 seconds and the sensor will enter setup mode.

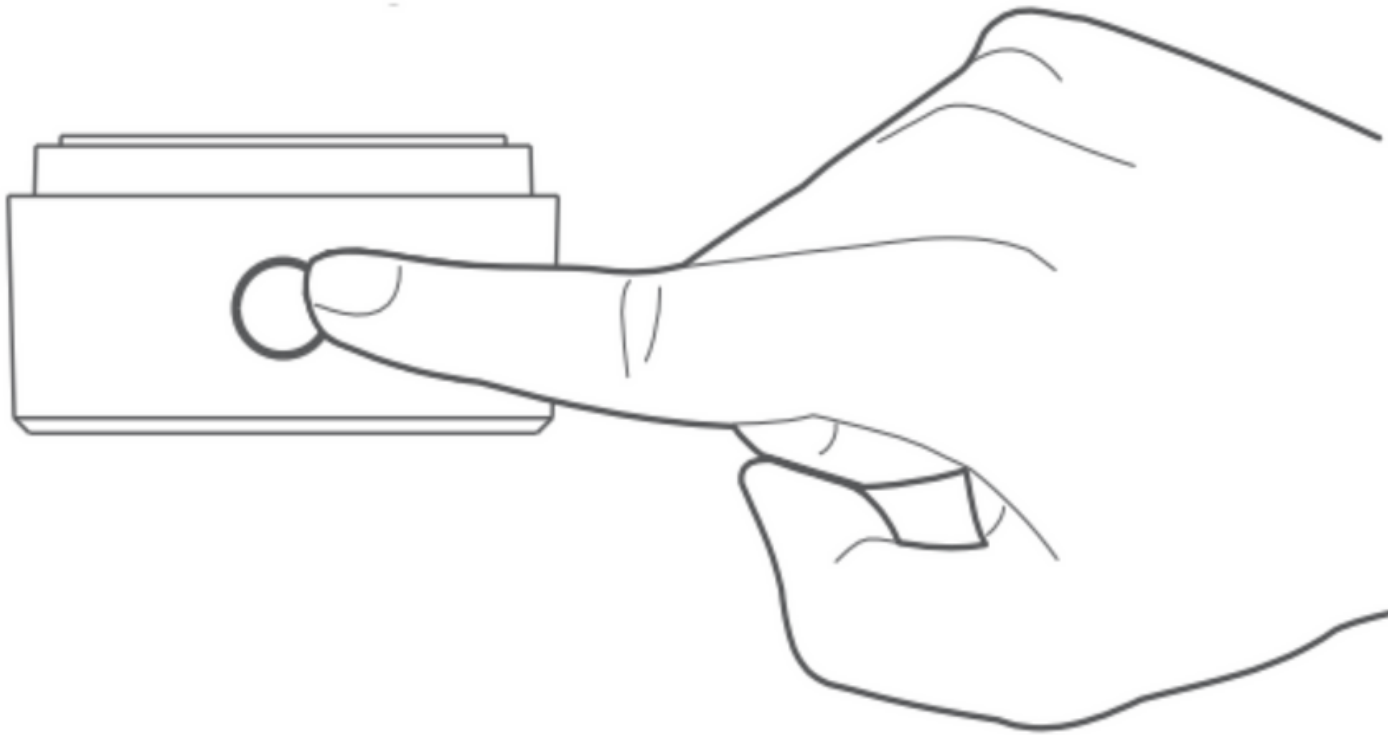

3. Now you can click the “Confirm the indicator is blinking rapidly” button in the app and continue with the on-screen instructions.

Mounting & Installation

The Door & Window Entry Sensor can be installed to any physically compatible non-metallic door, window, cabinet, or drawer. Be sure that the gap between the Main Unit and the Magnet is smaller than 10mm (0.39in).

To install the sensor, peel off the 3M adhesive protective film and press the sensor modules firmly to the desired location. See figures below for reference.

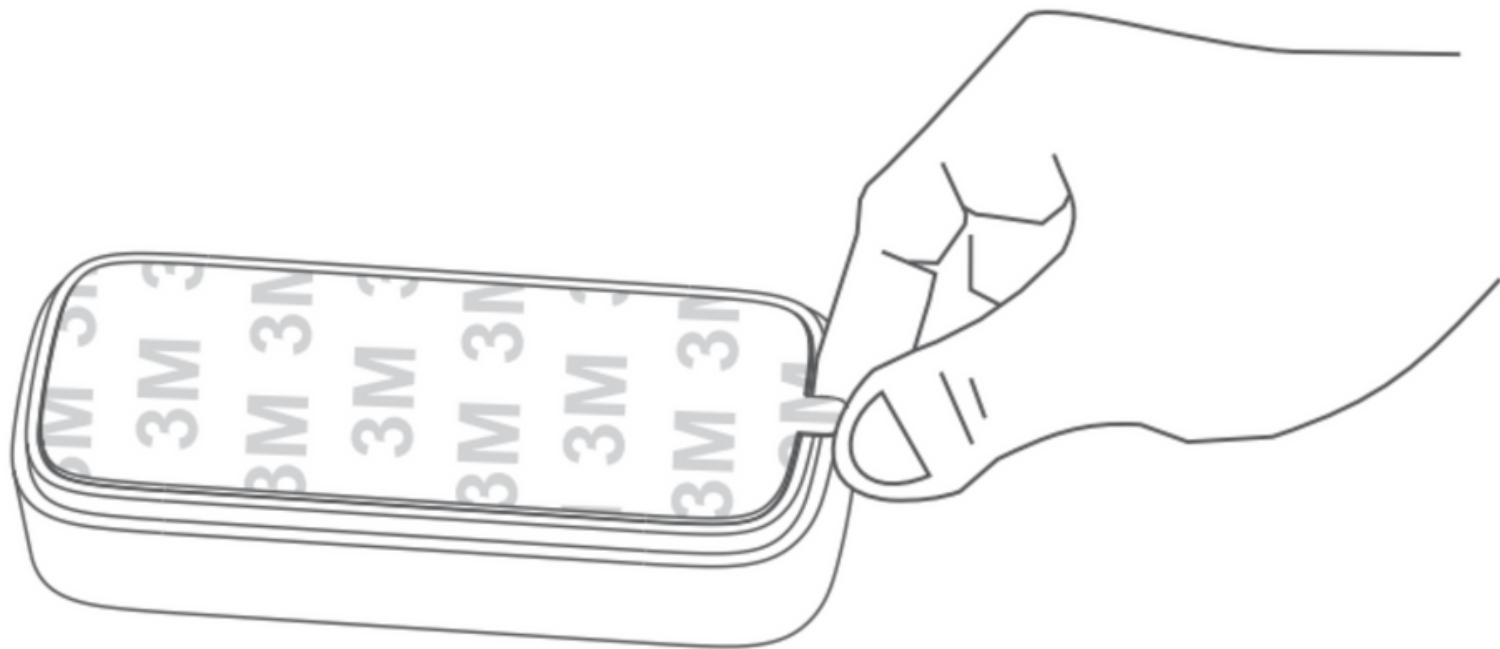

Installation site

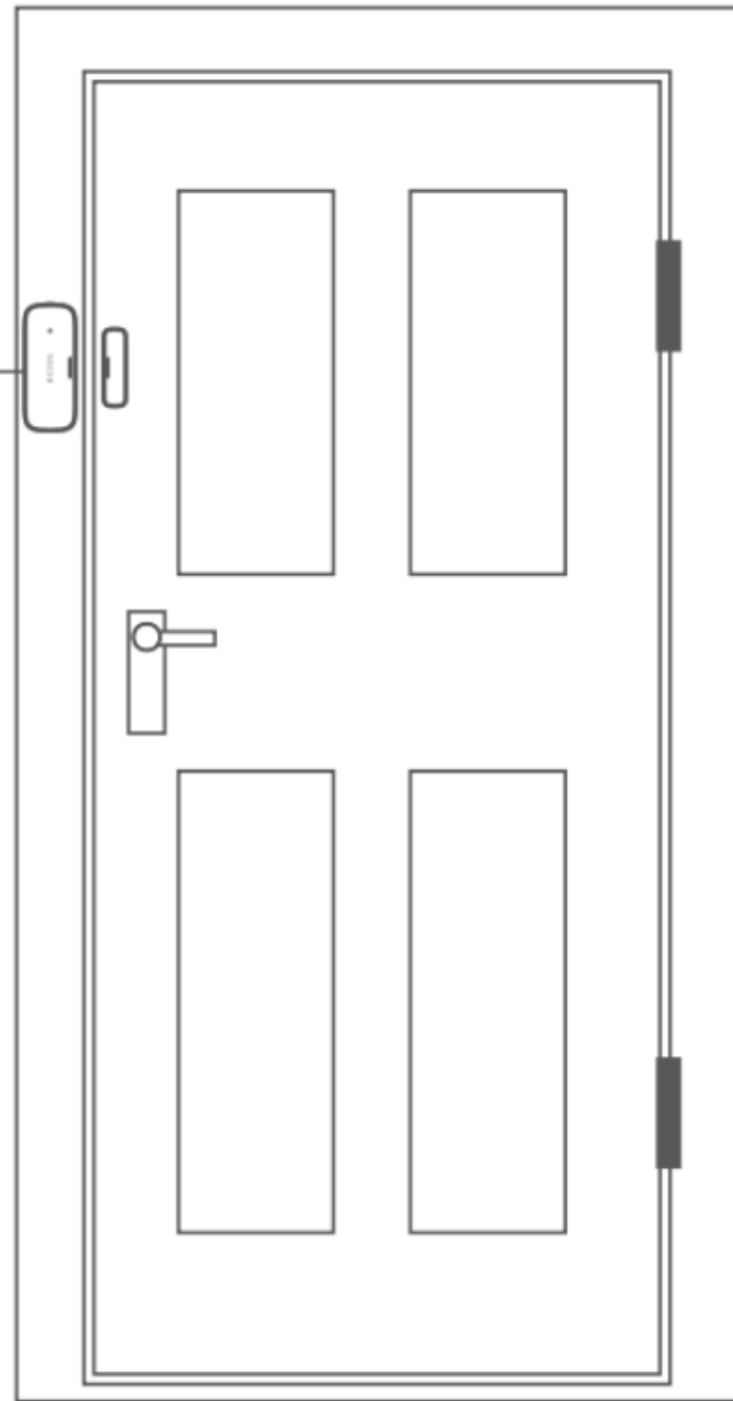
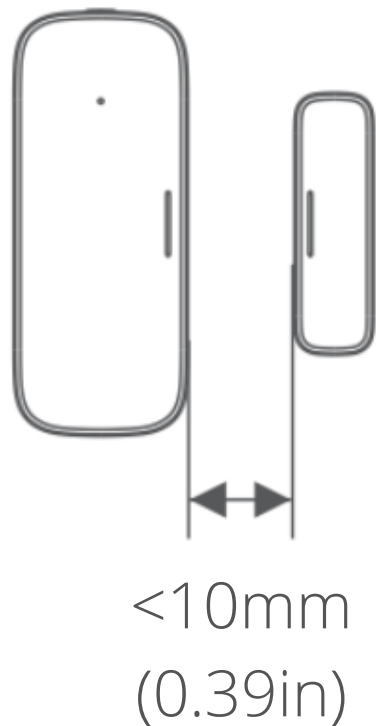

- Install the Main Unit on the unmoving part of the door or window (i.e. doorframe, window frame), and the Magnet on the moving part of the door or window.

Notes & Specifications

Note

1. Indoor use only.
2. Do not place magnetic objects near the sensor (besides the Magnet module of the sensor itself) to avoid interference with its normal operation.
3. The Main Unit and the Magnet should be installed on the same level, and the gap between them should be smaller than 10mm (0.39in).
4. Do not install the sensor on a metal door or window.
5. Do not install the sensor in a place where small children or animals have easy access.
6. Barriers between the sensor and its corresponding gateway may shorten the effective range of wireless communication.
7. Effective use of this motion sensor can help you protect your safety and property, but it does not guarantee complete protection against intruders. For your own safety and well-being, always employ precaution and safety best practices.
8. Do not touch the Reset Button when you do not intend to reset the device.
9. Before putting this device away for long-term storage, be sure to remove the batteries to prevent corrosion.

Technical Specifications

SKU	H0C0122
Communication	Zigbee 3.0
Wireless Frequency	2.4000 to 2.4835GHz
Battery Type	CR1632
Static Current	$\leq 5\mu\text{A}$
Operating Temperature	14° F ~ 131° F (-10°C ~ 55°C)
Operating Humidity	$\leq 95\% \text{RH}$
Main Unit Dimensions	2.13in x 0.87in x 0.49in (54mm x 22.2mm x 12.5mm)
Magnet Dimensions	1.31in x 0.40in x 0.49in (33.3mm x 10.2mm x 12.5mm)

Automation Conditions & Tasks

Condition	Description
Door and window sensor - ON	Activate task when the magnet becomes separated from the main unit (i.e. door is open)
Door and window sensor - off	Activate task when the magnet becomes adjacent to the main unit (i.e. door is closed)
Door and window sensor - ON:Duration	Activate task when the magnet has been separated from the main unit for a preset amount of time.
Door and window sensor - off:Duration	Activate task when the magnet has been adjacent to the main unit for a preset amount of time.
Temper alarm - Temper alarm	Activates task when the anti-tampering mechanism detects tampering
Temper alarm - Rectified	Activates task when the anti-tampering mechanism returns to normal state

Tasks

This device is primarily a sensor and does not have associated tasks that it can perform in an automation routine.

Apple and Apple logos are trademarks of Apple, Inc., registered in the U.S. and other countries. App Store is a service mark of Apple, Inc.

Amazon, Alexa, and all related logos are trademarks of Amazon.com Inc. or its affiliates.

Google and Google Play are trademarks of Google LLC. Other third-party brands and names are the property of their respective owners.

Linkstyle.life

Unlocking the enchanted life!