

# Linkstyle

Passive Infrared (PIR)  
Motion Sensor  
User Guide

If you need any support, don't hesitate to  
reach out to us at:

[contact@linkstyle.life](mailto:contact@linkstyle.life)

1-888-419-4888

Lens (LED inside)

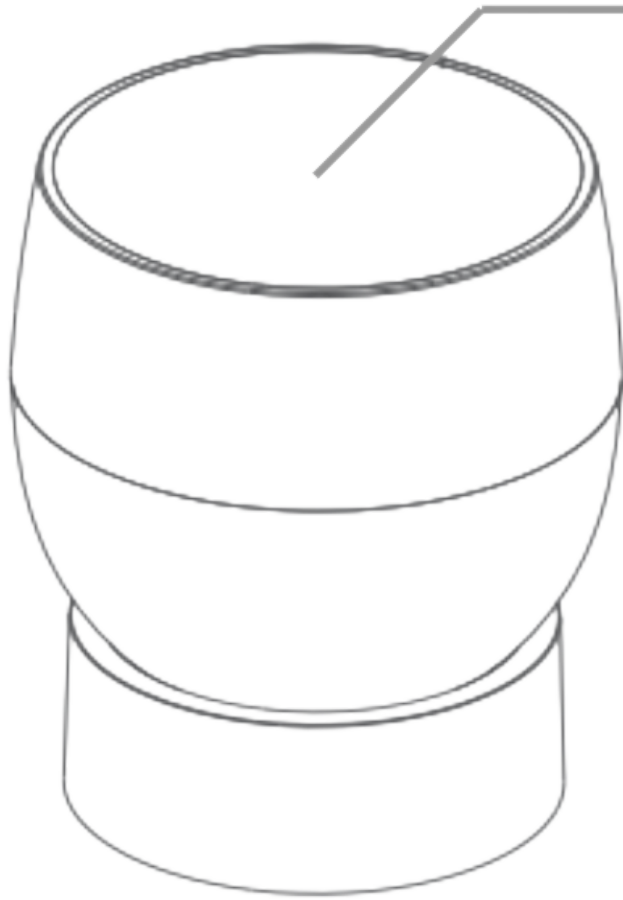

Insulation strip



Reset button



# Overview

This motion sensor detects motion by measuring infrared light radiating from objects (including people and animals) within its detection range. This device requires a Multi-Function Security Gateway to work.

## Features:

- Wireless transmission
- Magnetic mounting base
- Low battery warning
- Low power consumption improves battery life
- Digital temperature compensation improves detection accuracy

# Smart Functions

Install the Linkstyle app

Scan the QR code below to download and install the Linkstyle app. Register a new account on the app if you do not have one.



\*Alternatively, you can also search for “Linkstyle” on the Apple App Store or Google Play Store to find the app.

### \*\*\*Important Note:

When registering an account in the Linkstyle app, be sure to set the region to United States of America.



## Register

United States of America ▼

Email Address

I Agree [Privacy Policy](#) and [User Agreement](#)

Get Verification Code

# Quick Start Guide

Before setting up this device, be sure to have a Multi-Function Security Gateway added to the Linkstyle mobile app. Please refer to the user manual for the gateway if it is not yet set up.

1. In the Linkstyle mobile app, navigate to the “Devices” tab. Click the gateway device, then click the “+” button in the gateway page.
  2. On the next screen, choose “Motion Detector” from the list of devices, then follow the on-screen instructions to complete the setup.
- Keep the gateway and the PIR sensor within close proximity during the setup process. You can relocate the device elsewhere within range for regular use after setup.

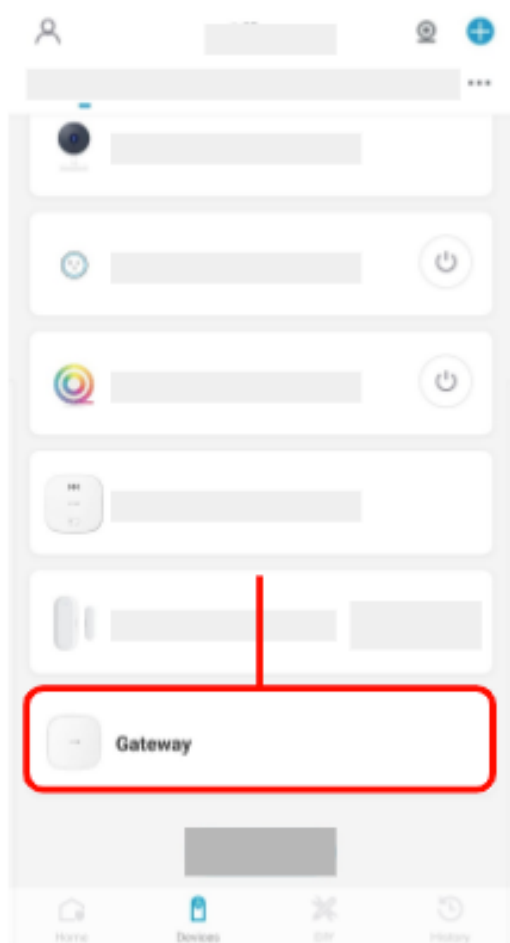

1. Select gateway in "Devices" tab.



2. Tap the add device button.

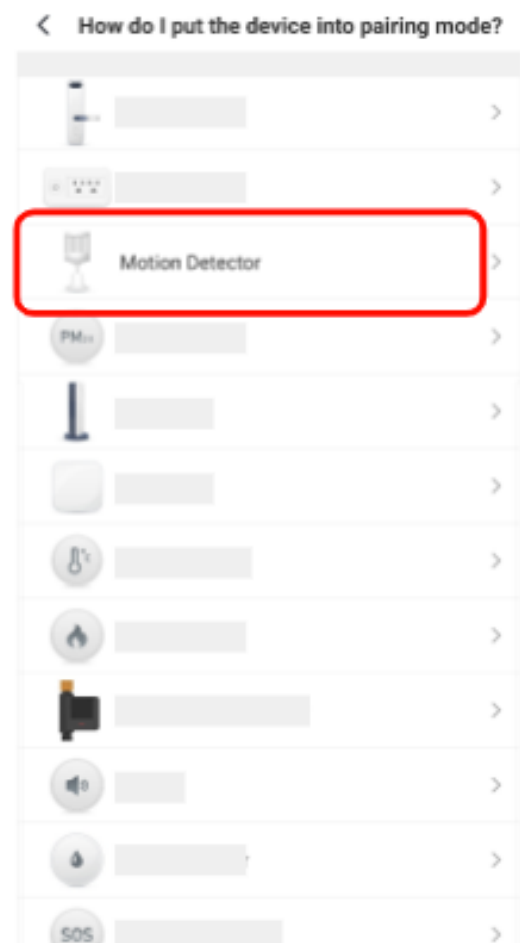

3. Select "Motion Detector"



When prompted by the on-screen instructions to reset the motion sensor:

1. Holding the back portion of the PIR sensor, turn the front cover portion counterclockwise slightly, then gently pull the two apart.
2. Pull out the battery insulation strip. The PIR sensor will enter setup mode, indicated by the blue flashing LED light under the lens.

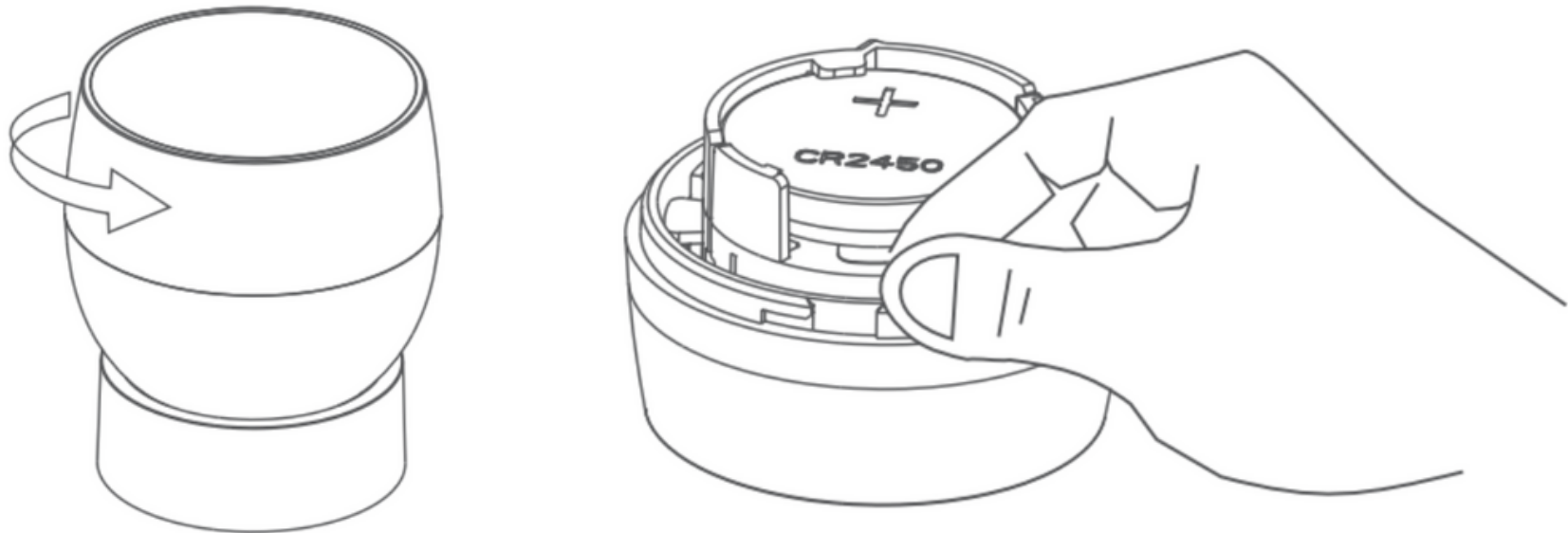

- If the sensor does not enter setup mode automatically, or if you need to manually reset the sensor, press and hold the Reset Button for 5 seconds and the sensor will enter setup mode.

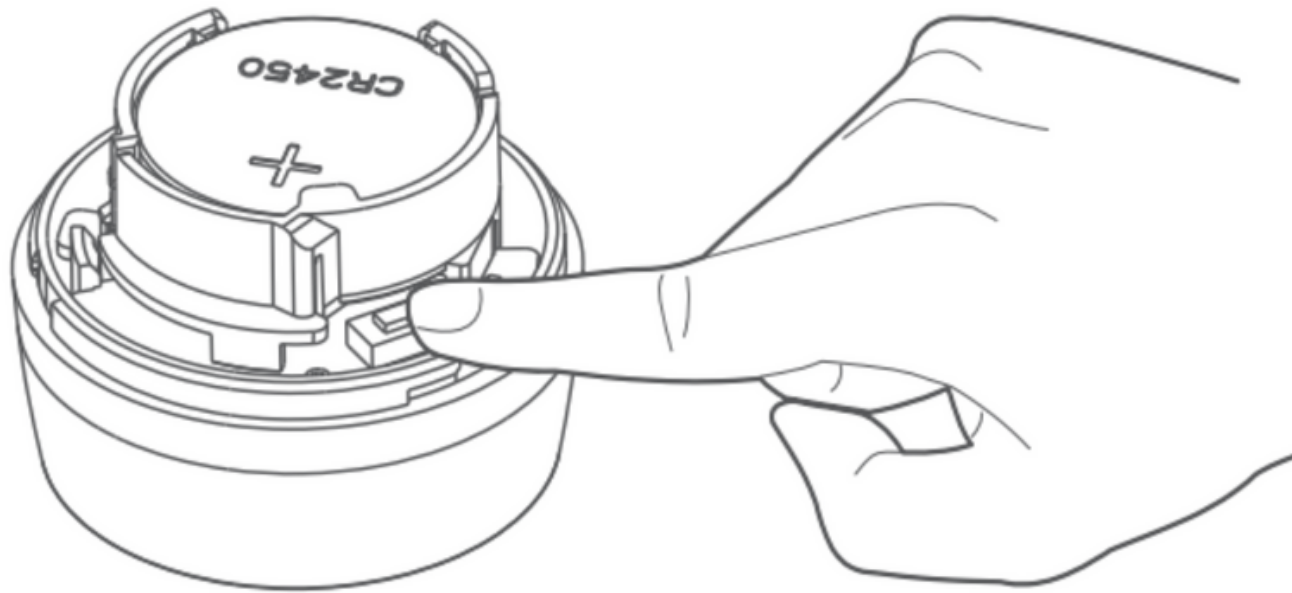

3. Now you can click the “Confirm the indicator is blinking rapidly” button in the app and continue with the on-screen instructions.

## Mounting & Installation

The PIR Motion Sensor can be mounted to a wall using the attached 3M adhesive or be placed on a flat surface. See figures below for reference.

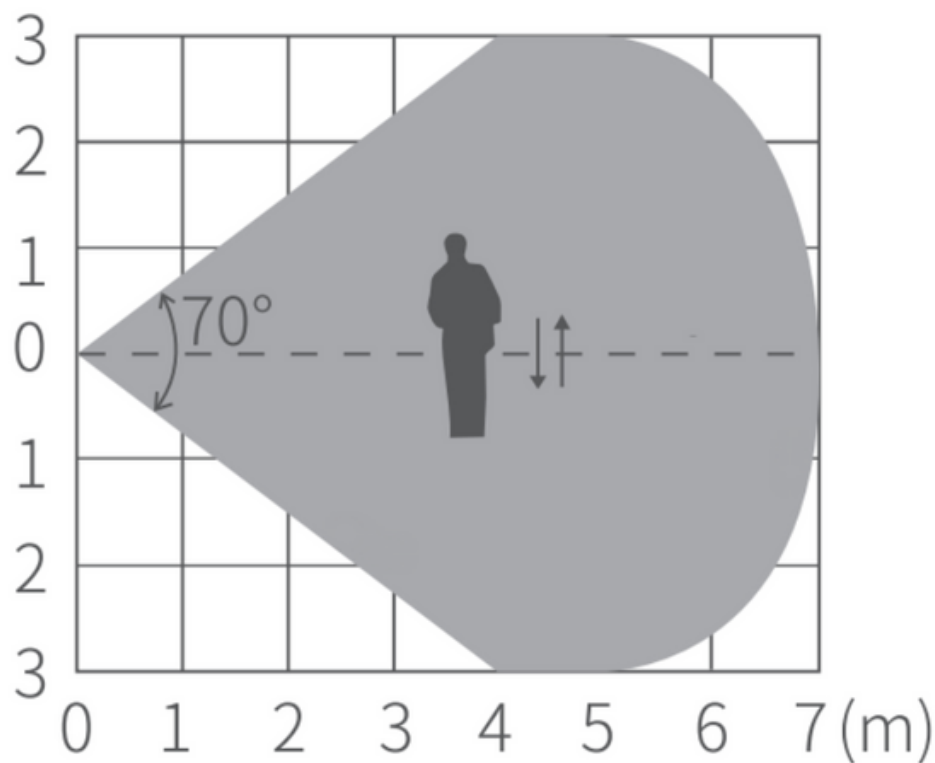

\* 1m  $\approx$  3.28ft

◀ Top View

Side View

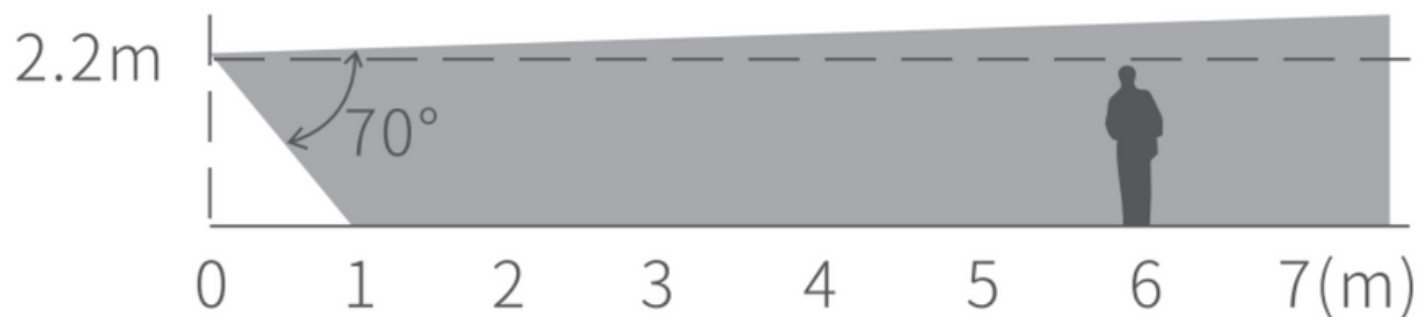

# Notes & Specifications

## Note

1. Indoor use only.
2. Avoid touching the sensor lens, as it may affect the sensor's detection sensitivity.
3. If the lens needs to be cleaned, remove the battery, then wipe the lens with a soft cloth and a small amount of rubbing alcohol.
4. Avoid placing the working device in a place where temperature may fluctuate by a lot. This includes places near air conditioners, electric fans, ovens, refrigerators, and other items that can cause a drastic change in temperature.
5. Avoid direct sunlight on the sensor.
6. Do not place obstructions between the sensor and the area in which it is meant to detect motion.
7. Barriers between the sensor and its corresponding gateway may shorten the effective range of wireless communication..
8. Effective use of this motion sensor can help you protect your safety and property, but it does not guarantee complete protection against intruders. For your own safety and well-being, always employ precaution and safety best practices.
9. Do not touch the Reset Button when you do not intend to reset the device.
10. Before putting this device away for long-term storage, be sure to remove the battery to prevent corrosion.

# Technical Specifications

SKU	H0C0121
Communication	Zigbee 3.0
Wireless Frequency	2.4000 to 2.4835GHz
Battery Type	CR2450
Static Current	$\leq 10\mu\text{A}$
Operating Temperature	14° F ~ 131°F (-10°C ~ 55°C)
Operating Humidity	$\leq 95\%RH$
Detection Range	70°, ~ 23ft (7m)
Recommended installation height	7 ft 2.6 in (2.2m)
Dimensions	1.57in diameter x 1.89in depth (40mm diameter x 48mm depth)

# Automation Conditions & Tasks

## Conditions

Condition	Description
battery	Activate task when the motion sensor battery is below, at, or above a preset threshold
PIR state - Motion detector	Activate task when motion is detected by the motion sensor
PIR state - Motion detector: Duration	Activate task when continuous motion is detected for a preset amount of time

## Tasks

This device is primarily a sensor and does not have associated tasks that it can perform in an automation routine.

Apple and Apple logos are trademarks of Apple, Inc., registered in the U.S. and other countries. App Store is a service mark of Apple, Inc.

Amazon, Alexa, and all related logos are trademarks of Amazon.com Inc. or its affiliates.

Google and Google Play are trademarks of Google LLC. Other third-party brands and names are the property of their respective owners.

Linkstyle.life

Unlocking the enchanted life!