

Function7 Billet Aluminum Rear Lower Control Arms

For 97-01 Integra Type-R

Part #: F7-DC2RLA-RB

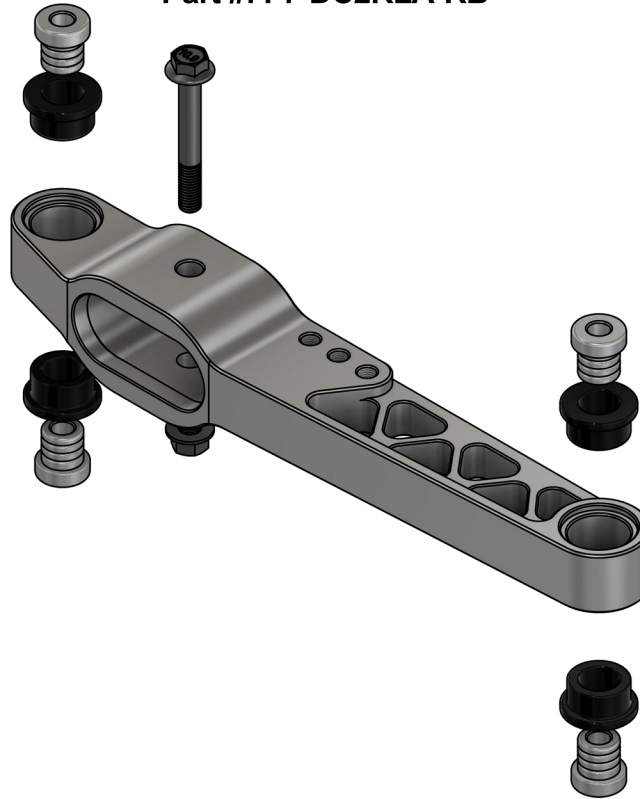

Thank you for choosing Function7 Products!

All Function7 Lower Control Arms come **unassembled**. A total of 2 bushings and 2 bushing pins are needed for each mounting point. Each bushing must be properly lubricated prior to installation to ensure optimal performance and prevent premature wear. While we do the utmost to ensure quality checks, please inspect all parts before installation.

Assembly Instructions:

- 1) Double Check to make sure the mounting holes are clear of any obstruction.
- 2) Insert the two polyurethane end bushings first by pushing them into place.
- 3) Apply grease as needed and install the two center billet aluminum bushing pins by thoroughly applying even pressure to the pins.

Package Contents:

- x2 Billet 6061-T6 Aluminum Rear Lower Control Arms
- x8 Billet 6061-T6 Aluminum Bushing Pins
- x8 Polyurethane End Bushings
- x1 Poly Grease
- x2 M10 55mm Bolts with Locking Nuts
- x1 Function 7 Decal



www.function7.com

For questions and/or concerns, please email us at: info@function7.com