

Kent

MODEL: 81692 RED
MODEL: 81694 GREEN

Li'l Farmer

TRIKE WITH WAGON



ASSEMBLY MANUAL

Operation and Maintenance

THIS INSTRUCTION BOOKLET CONTAINS IMPORTANT SAFETY INFORMATION. PLEASE READ AND KEEP FOR FUTURE REFERENCE.

WARNING! TO AVOID SERIOUS INJURY

1. This product should be used under the direct supervision of an adult at all times.
2. It is recommended that riders always wear a properly fitted helmet that complies with US Consumer product safety Commission (CPSC) Standards.
3. Only one rider should use this product at a time.
4. Riding barefoot is not recommended, user should always wear shoes.
5. This product is a toy, instruct your child how to use it correctly and draw attention to possible sources of danger. The product should be used with caution, as it requires skill, so as to avoid falls and collisions.
6. Recommended age is 2 years and older.
Maximum Weight for trike: 130 lbs; wagon: 100 lbs..
7. Always adjust the use of the product to conditions encountered.
8. This product should be used on safe level ground. It should NOT be used near steps, slopes, roadways, motor vehicles, swimming pools, driveways or inclines.
9. This product is an unlighted toy and should not be used in the dark.
10. In case of sudden and/or strong turns of the handlebar the product could tip over and cause injury to the rider.
11. Climbing or standing on the trike could cause the trike to tip over and cause injury to the rider.
12. Unpredicted situations may arise when children are at play, for which the manufacturer/distributor cannot be held liable for damage or injury.
13. This tricycle must not be connected with other vehicles or similar devices and not driven/pulled by them. Never subject your child (while on the trike) to speeds exceeding a walking pace!
14. This trike does not possess a continuously effective brake system. Therefore, safeguard the product against rolling away when parking it.
15. Never park the toy unattended with a child on it!
16. Regular safety checks should be carried out on the product to ensure integrity of assembly. Check for loose, damaged or missing components. Damaged components may endanger the safety of your child or shorten the lifespan of the product.

**ALWAYS WEAR A HELMET,
IT COULD SAVE YOUR LIFE.
DO NOT RIDE AT NIGHT.**

1-800-451-5368

WWW.KENT.BIKE

ASSEMBLY INSTRUCTIONS

HARDWARE IDENTIFICATION

No:	Description	Qty
1	Bolt 8mm	6
2	Washer 8mm	6
3	Nut 8mm	6
4	Washer	2
5	Wheel Cover	2
6	Stem Bolt	1
7	Spring Washer	6

TOOLS REQUIRED FOR ASSEMBLY

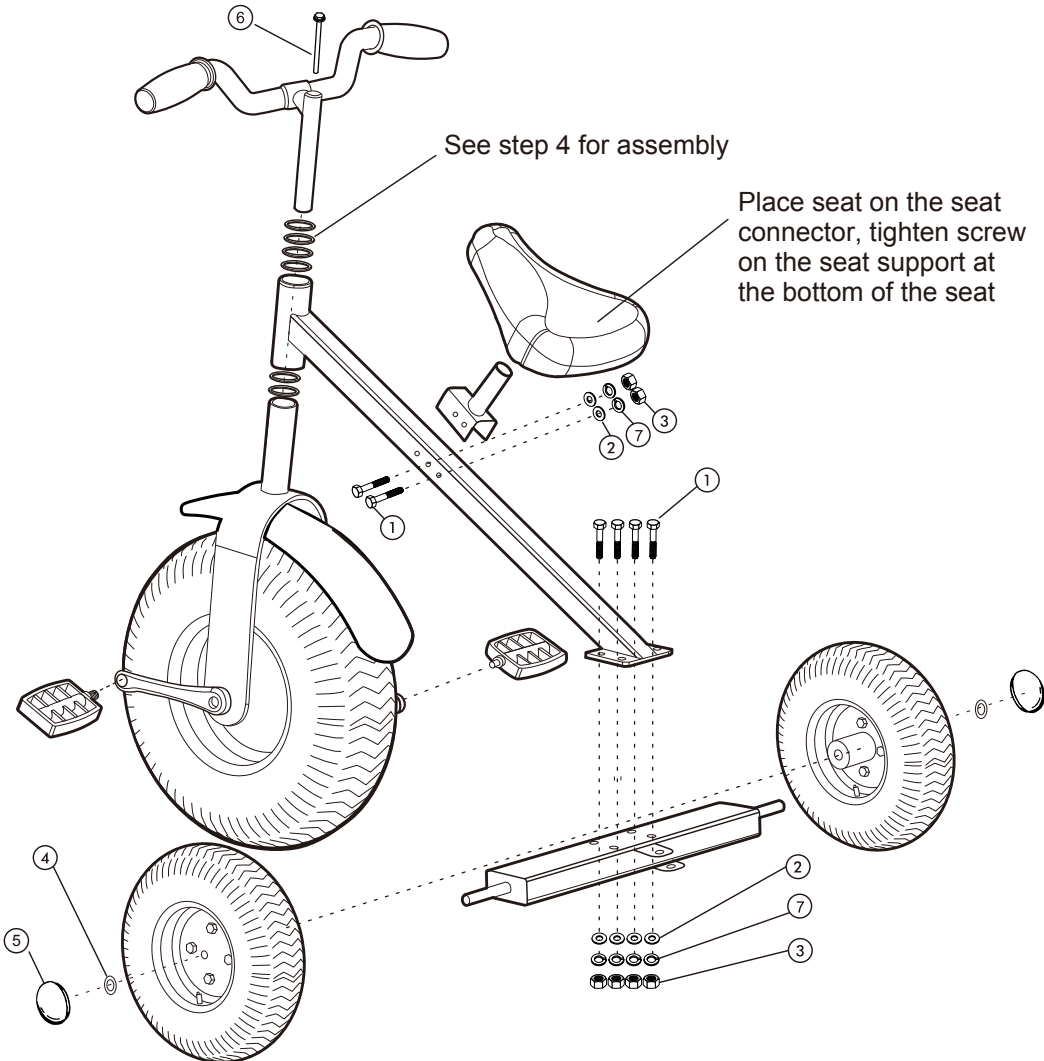
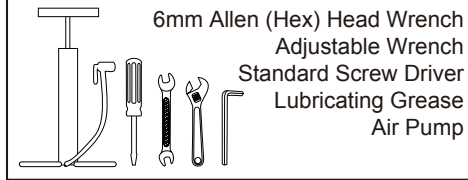

TRICYCLE PART LIST:

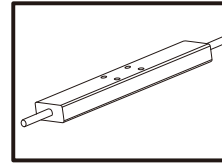

A. Back Axle x1

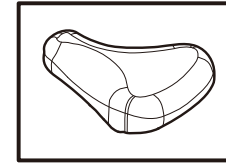

B. Seat x1

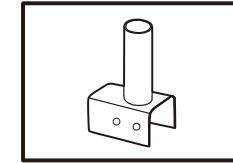

C. Seat Connector x1

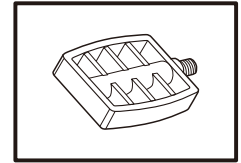

D. Pedals x2

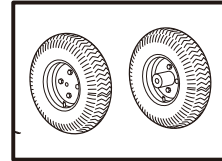

E. Back Wheels x2

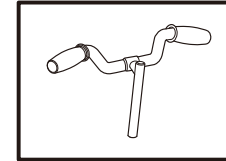

F. Handlebars x1

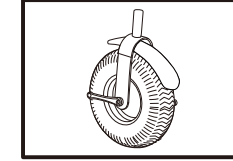

G. Front Wheel x1

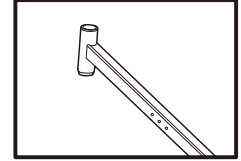

H. Fork and Frame x1

TRICYCLE ASSEMBLY INSTRUCTIONS

STEP 1:

Place the back wheel (E) onto the back axle (A), put a flatwasher (4) on the axle, use the wheel cover (5) to lock the back wheel in place. Repeat step 1 to assemble other back wheel.

STEP 2:

Attach the back axle (A) to the frame(H) using 8mm bolts (1), 8mm washers (2), spring washers (7) and 8mm nuts (3).

STEP 3:

Use an adjustable wrench to secure the pedal (D) onto the threaded crank attached to the front wheel (G). Repeat step 3 to install the pedal on the opposite side.

STEP 4:

Follow the diagram to the right, to secure nut, washer, rings, fork and frame in the proper order.

STEP 5:

To assemble the handlebars (F). Insert the stem bolt (6) into the opening at the top of the handlebar stem. Insert the handlebars (F) into the head of the frame (H). Please ensure handlebar is inserted past the minimum insertion marking on the handlebar stem. Tighten stem bolt (6) securely.

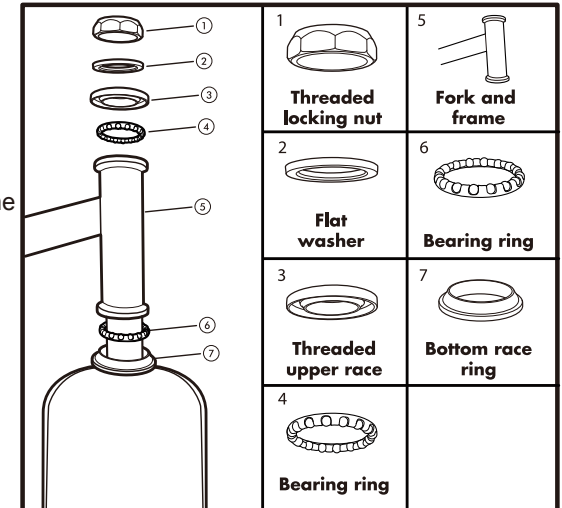

STEP 6:

To adjust the seat position, remove seat connector bolts, align seat connector with holes in frame at the desired position, re-insert bolts and tighten nuts to lock seat in place.

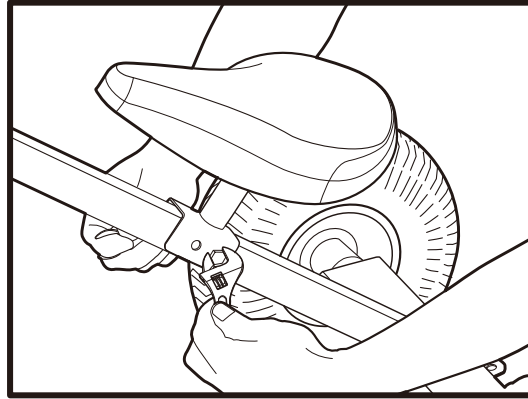

STEP 7:

After assembling your trike, it will be necessary to inflate the tires. Check the sidewall of the tire for the correct pressure (PSI) and inflate tires accordingly with a MANUAL BICYCLE PUMP. **Improper inflation is the biggest cause of tire failure. Due to their slightly porous nature, it is normal for your tires to lose pressure over time. For this reason it is critically important to maintain the proper tire inflation.** Do not exceed 35 PSI for the front tire and 30 PSI for the rear tires.



WARNING: NEVER INFLATE A TIRE BEYOND THE MAXIMUM PRESSURE MARKED ON THE TIRE'S SIDEWALL. EXCEEDING THE RECOMMENDED MAXIMUM PRESSURE MAY BLOW THE TIRE OFF THE RIM, WHICH COULD CAUSE DAMAGE TO THE TRIKE AND INJURY TO THE RIDER AND OTHERS. THE BEST WAY TO INFLATE A TRICYCLE TIRE TO THE CORRECT PRESSURE IS WITH A BICYCLE PUMP. GAS STATION AIR HOSES MOVE A LARGE VOLUME OF AIR VERY RAPIDLY, AND WILL RAISE THE PRESSURE IN YOUR TIRE VERY RAPIDLY. WE DO NOT RECOMMEND USING GAS STATION AIR HOSES OR ANY OTHER TYPE OF COMPRESSOR.

Test the tricycle by checking all bolts and fittings, make sure everything is securely tightened before allowing your child to ride the trike. Roll the tricycle to check for proper wheel operation and alignment.

WAGON PARTS LIST:

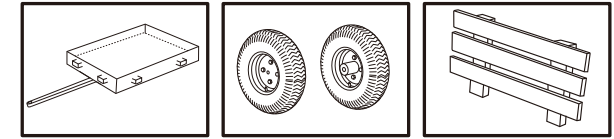

A. Deck x1

B. Wheels x2

C. Long Fence x2

WAGON HARDWARE:

No:	Description	Qty
1	Bolt M8 x 45mm	1
2	Washer 8mm	1
3	Spring Washer	1
4	Nut M8	1
5	Washer 16mm	2
6	Axle Cap	2

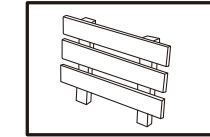

D. Short Fence x2

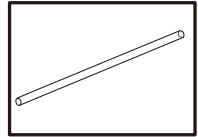

E. Axle x1

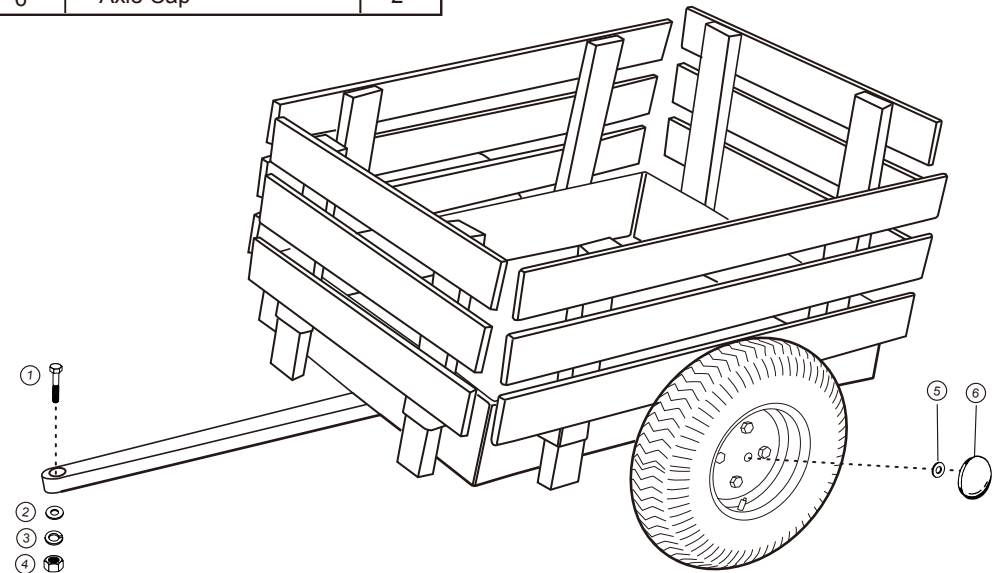

WAGON ASSEMBLY INSTRUCTIONS

STEP 1:

Insert the axle (E) into the bottom of the wagon deck (A). Slide the wheels (B) onto the ends of the axle (E). Attach using the 16mm washer (5) and axle cap (6). Tighten securely.

STEP 2:

Attach the wagon deck (A) to the back of the tricycle using the 45mm bolt (1), 8mm washer (2), Spring Washer (3), and the Nut (4). Tighten securely.

STEP 3:

Insert long fences (C) and short fences (D) into slots on each side of the wagon deck (A).

WARRANTY STATEMENT

WARRANTY STATEMENT

Kent international warrants only to the original purchaser-consumer of this product, that such product and parts thereof, when used for normal riding purposes by a two to four year old child, is free of defects in workmanship and material.

This warranty does not apply to any part thereof which may fail due to improper assembly, accident, abuse, neglect or normal wear and tear.

WARRANTY ON PARTS

For 6 months from date of purchase, when properly assembled as detailed in the owners manual, Kent International will replace any defective part which results when this cycle is used in a normal manner.

FULL WARRANTY ON FRAME

For the usable life of this cycle, Kent International will replace the frame and fork only, free of charge, should it fail in any weld point when the cycle has been used in a normal manner.

ALL WARRANTY CLAIMS ARE TO BE MADE TO:
Kent International, Parts Dept., 60 East Halsey Road,
Parsippany, NJ 07054 U.S.A.

This warranty gives you specific rights, and you may also have other rights which may vary from state to state.

(FOR QUICK PARTS SERVICE, USE PARTS SERVICE FORM, or call Toll Free number 1-800-451-5368 between the hours of 9:00 A.M. and 4:00 P.M. EST)

DO NOT RETURN TO STORE!

For Customer Service Call:

1-800-451-5368

**ALWAYS WEAR A HELMET,
IT COULD SAVE YOUR LIFE.
DO NOT RIDE AT NIGHT.**

1-800-451-5368

WWW.KENT.BIKE