

CO-PILOT ASSEMBLY

THIS INSTRUCTION BOOKLET CONTAINS IMPORTANT SAFETY, ASSEMBLY, USE,
AND MAINTENANCE INFORMATION. PLEASE READ AND KEEP FOR FUTURE REFERENCE.

FOR SERVICE ASSISTANCE CALL TOLL FREE 1.800.451.5368

Monday - Friday 8:00 a.m. to 4:00 p.m. Eastern Standard Time

Congratulations on the purchase of your new co-pilot! With proper assembly and maintenance it will offer your family years of enjoyable riding!

IMPORTANT:

Carefully read and follow this manual (and any other materials included with this co-pilot) before riding. Please retain this manual for future use. It is the responsibility of the purchaser to verify the co-pilot has been properly assembled, and that the user has been properly trained and instructed in use of the co-pilot.

This manual is provided to assist you and is not intended to be a comprehensive manual covering all aspects of using, maintaining and repairing your co-pilot. The co-pilot you have purchased is a complex piece of equipment that must be properly assembled and maintained in order to be ridden safely. **If you have any doubts about the assembly or your ability to properly assemble and maintain the co-pilot or the lead bicycle being used, you must have it assembled and maintained by a professional bicycle mechanic.**

 **DANGER! Failure to properly assemble and maintain your bicycle and this co-pilot could result in serious injury or death to the rider(s).**

Check and read this decal on your co-pilot before each ride:

WARNING!
ALWAYS WEAR A HELMET
Make Sure Stem And Pedals Are Tight.
Check Your Brakes.
Do Not Ride At Night.
Read Owners Manual.
For A Free Owner's Manual Or Questions Call 1-800-451-5368
MADE IN CHINA

**ATTENTION BICYCLE AND CO-PILOT RIDERS:
ALWAYS WEAR A PROPERLY FITTED HELMET
WHEN YOU RIDE. DO NOT RIDE AT NIGHT.
AVOID RIDING IN WET CONDITIONS.**

RESPONSIBILITY OF THE OWNER!

IMPORTANT: Reading and following the information and instructions in this manual are essential to the ability to ride safely.

1. It is the responsibility of the owner or in the case of a younger rider the parents of the rider to be certain all assembly instructions have been followed, even if the bike has been assembled by the seller or a professional assembly company.
2. Rules for bicycle use (bicycle laws) vary from location to location so be certain the rider knows and understands the rules that apply to bicycle usage in your area. Wearing a helmet and using lights and reflectors are two examples of rules which probably exist and which make sense as rider safety precautions at all times and in all locations.
3. Know how to operate the bicycle **with the co-pilot attached** and all equipment on it before first use and be certain anyone else allowed to use the bike knows how to properly and safely use the bike as well.

Any major service or adjustments on your co-pilot should be carried out by a competent adult or professional bike mechanic. If you wish to make adjustments yourself, this manual contains important tips on how to do it. **⚠CAUTION:** Any adjustments you make are entirely at your own risk. Do **NOT** use your co-pilot for freestyle and stunt riding, jumping or competitive events. Even if you are riding a mountain bike, you should know that off-road use or any similar activities can be dangerous, and you are warned that you assume the risk for personal injury, damages or losses to the bike and/or co-pilot incurred from such use. Do not ride your bike and/or co-pilot when any part is damaged or not working properly. If you are unsure how to carry out repairs or maintenance on your co-pilot, it is vital that you promptly consult a local bike mechanic for professional assistance and support.

⚠WARNING: As with all mechanical components, the bicycle and co-pilot are subjected to wear and high stresses. Different materials and components may react to wear or stress or fatigue in different ways. If the design life of a component has been exceeded, it may suddenly fail, possibly causing injuries to the rider. Any form of crack, scratches or change of coloring in highly stressed areas indicate that the life of the component has been reached and should be replaced.

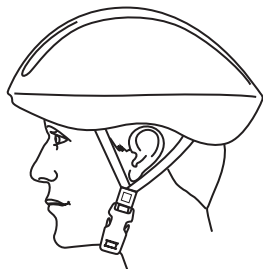

Correct
Forehead covered

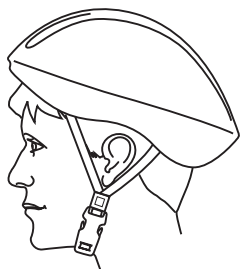

Incorrect
Forehead exposed



ALWAYS WEAR A HELMET- IT COULD SAVE YOUR LIFE!

A properly fitting, CPSC approved, bicycle helmet should be worn at all times when riding your bicycle and/or co-pilot. In addition, if you are carrying a passenger on the co-pilot **remember** the passenger must also be wearing a helmet and properly secured.

The correct helmet should:

- be comfortable
- be lightweight
- have good ventilation
- fit correctly
- cover the forehead
- be securely fastened on the rider

PARTS IDENTIFICATION

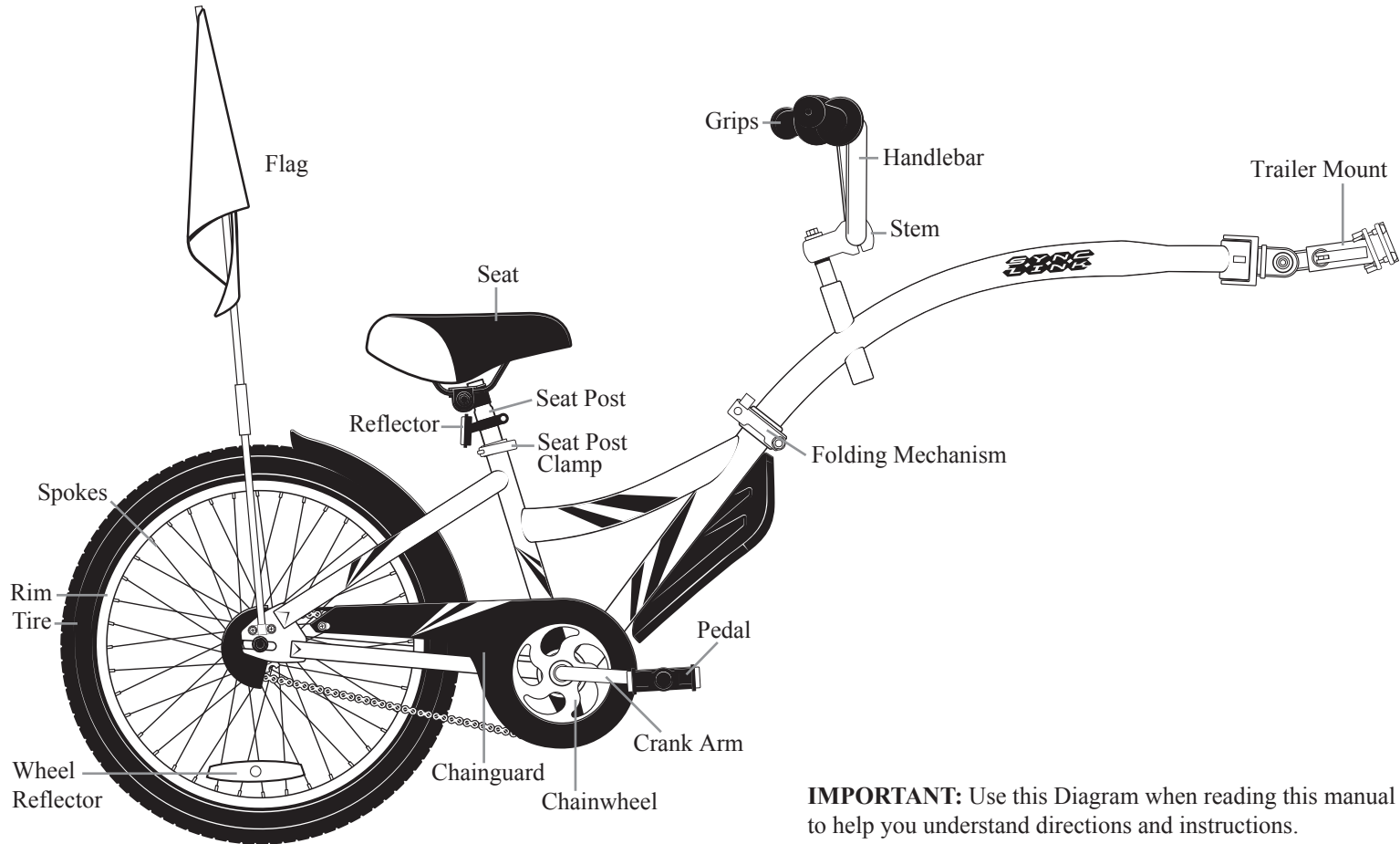

IMPORTANT: Use this Diagram when reading this manual to help you understand directions and instructions.

RULES OF THE ROAD

In the interest of safe cycling, make sure you read and understand the bike owner's manual and the co-pilot assembly manual.

In this manual you will find **DANGER**, **WARNING**, **CAUTION**, **IMPORTANT**, and **NOTE** or **NOTICE**. **These are important signal words telling you to pay special attention to that text as rider safety is involved.** **DANGER** and **WARNING**: Pay special attention to these since failure to do so could result in serious injury or death to the rider or others.

CAUTION: If not followed these instructions could result in injury or mechanical failure or damage to the bicycle and co-pilot .

NOTE or **NOTICE** or **IMPORTANT**: These specify something that is of special interest.

IMPORTANT **Before you ride bicycle with co-pilot attached, read this RULES OF THE ROAD section** and check that all parts are installed and working as per this manual. If you understand how the bicycle and co-pilot operates, you will get the best performance. When you read this instruction book, compare the illustrations to the bicycle and co-pilot. Learn the location of all the parts and how they work. **Keep this book for future reference.**

CAUTION: Before you ride, make sure all parts are tightened, assembled correctly and working properly. Take your first ride in a large open level area without a passenger in the co-pilot. If you have a problem, check the assembly instructions and follow the maintenance procedures in this book. If you do not feel comfortable with your skills in assembling, adjusting or operating the bike with the co-pilot attached, please take it to a professional bike repairman for help.

1. **WARNING - ON AND OFF ROAD CONDITIONS**: The condition of the riding surface is very important. If the surface is wet, or has sand, leaves, small rocks or other loose debris on the surface where you plan to ride, carefully decrease the speed of the bicycle and ride with extra caution. It will also take a longer time and more distance to stop. Apply the brake earlier than normal and with less force, rear brake first followed by the front brake if equipped, to help keep the bicycle and co-pilot from sliding, falling, or jackknifing. Avoid sharp turns.

2. **NOTICE**: Some local laws may require that your bike be equipped with a warning device, such as a horn or bell or light. Do NOT ride at night. Vision is quite limited at dawn, dusk and at night. If you must ride at night, take extra precautions, use front and rear lights, wear flashers on your arms, wear light colored clothing, and plan your route to ride in well lighted areas. Make sure the co-pilot flag and reflectors are present and not covered.

3. Always wear shoes when riding a bicycle or the co-pilot and avoid loose fitting clothes. Wear a cuff band or trouser clip to keep trousers from getting caught in the chainwheel. Long sleeves, long pants, gloves, eye protection, a good helmet, elbow and knee pads are recommended. **NOTE**: a helmet may be required.

RULES OF THE ROAD *continued*

4. **CAUTION: WET WEATHER WARNING:** Check your brakes frequently. The ability to stop is critical. Roads are slippery in wet weather so avoid sharp turns and allow more distance for stopping. Brakes may become less efficient when wet. Leaves, loose gravel and other debris on the road can also affect stopping distance. If at all possible, do not ride in wet weather. Vision and control are impaired, creating a greater risk of accidents and injury. Remember the co-pilot unit and rider add extra weight that can also slow stopping.
5. **CAUTION:** A bicycle rider's best defense against accidents is to be alert to road conditions and traffic in the area. Do not wear anything that restricts your vision or your hearing. Be alert for hazards and motorists at all times.
6. When riding, **ALWAYS WEAR AN APPROVED BIKE HELMET.**
7. Obey all traffic regulations. Most traffic regulations apply to bike riders as well as automobile operators. Observe all local traffic regulations, signs and signals. Check with your local police station on bicycle licensing and inspection which is required in some places as well as where it is legal to ride your bike.
8. Follow the traffic flow in a straight line close to the curb. Watch out for opening car doors, cars moving in and out of traffic, and cars exiting driveways. Use caution at intersections and keep both hands on the handlebars.
9. Never carry passengers unless in an approved child carrier or in the co-pilot unit. This is dangerous and it makes the bicycle harder to control. Never carry packages that can hinder your vision or control of the bike.
10. When riding in pairs or in larger groups, form a single line along the right side of the road. Set up a sensible distance between riders. Don't follow too closely.
11. Maintain a safe riding speed at all times, including during straight paths, curves, and turns. Maximum recommended riding speed is 5mph (8km/h).
12. Always be alert. Animals or people may dart in front of you. Give pedestrians the right-of-way. Don't ride too close to pedestrians, and don't park your bicycle where it can get in the way of foot/vehicle traffic.
13. Be careful at all crossroads. Slow down and look both ways before crossing.
14. Use hand signals. Always let other drivers and pedestrians know what you are going to do. Signal 100 ft. before turning unless your hand is needed to control the bike. Always ride at a slow reasonable and safe speed slowing significantly during turns.
15. **WARNING: NIGHT TIME OPERATION:** We do NOT recommend riding your bike at night. If you have an emergency that requires you to ride at night, you must have proper lights and reflectors. NEVER ride at night without a headlight, taillight, a white front reflector, a red rear reflector, pedal reflectors and white wheel reflectors. Also wear light color clothes to improve visibility to others.

RULES OF THE ROAD *continued*

16. Cover the stem, handlebar, and top tube of the bike and co-pilot with safety pads for additional protection when riding on rough surfaces.
17. Never hitch rides. Never hold onto moving vehicles while riding. Never stunt ride or jump on your bike especially when the co-pilot is attached.
18. **ON AND OFF ROAD OPERATION:** Avoid the following road hazards: drain grates, pot holes, ruts, soft road edges, gravel, leaves (especially when they are wet), uneven or broken pavement, railroad crossings, manhole covers, curbs, speed bumps, puddles, and debris can all have effect on your riding and result in loss of control.
19. Do not ride your bicycle or use the co-pilot if the chain cover is not attached.
20. **CAUTION:** Any load added to a bicycle will lessen the stability of the bicycle and alter its riding characteristics. Do not attempt to carry a load that is heavier than you can readily control. Match the load to your weight, strength, and size.

COMPATIBILITY:

- This co-pilot unit is designed to fit and attach securely to most adult bicycles using a wheel size of 26" (mountain bike size), 27" or 700C. It should not be fitted to bicycles with 20" or 24" wheels, as they may not have enough pedal clearance between the co-pilot's pedals and the ground when leaning or turning. Lead bicycle should only be operated by an adult.
- **It is recommended that the minimum height from the ground to the bottom of the hitch assembly is 76cm or 30" or 7.5cm or 3.5" between the bottom of the hitch and the rear tire of the towing bicycle. This same clearance should be kept if using a fender or pannier rack. This will ensure proper clearance for the co-pilot's pedals when cornering as well as clearance for the towing bicycle rear tire, rear fender, or rack under the hitch arm.**
- Before mounting co-pilot trailer bike, check the lead bike to verify all parts, including brakes, are in good working condition. Verify all parts are free of cracks and are not damaged or deformed.
- We recommend using only a high quality chromoly seat post to tow the co-pilot bike. Seat posts made of thin alloy, steel, aluminum, or carbon fiber could bend or break under the added weight.

Weight Limit: (Max. weight of rider=75lbs/34kg, weight of adult rider for lead bicycle should be at least twice the weight of the passenger.) These co-pilot bikes are intended for use in safe areas with riding surfaces that are in good condition and free of traffic. Children must know how to ride within their abilities and do so under adult supervision. Rider and passenger should both wear a safety helmet and use other safety equipment at all times. An adult should check the lead bike and co-pilot unit regularly and do required maintenance. Do not exceed recommended weight limits as this may result in injury. **WE DO NOT RECOMMEND RIDING WITH CHILDREN WHO ARE NOT ALREADY ABLE TO RIDE ON A SMALLER BICYCLE WITH OR WITHOUT TRAINING WHEELS.**

BEFORE RIDING:

Your new co-pilot was assembled and tuned in the factory and then partially disassembled for shipping. The following instructions will enable you to prepare your co-pilot for years of enjoyable cycling. For more details on inspection, lubrication, maintenance and adjustment of any area please refer to the relevant sections in this manual. If you have questions about your ability to properly assemble this co-pilot, please consult a professional bicycle mechanic before riding.



TO AVOID INJURY, THIS PRODUCT MUST BE PROPERLY ASSEMBLED BEFORE USE. WE STRONGLY RECOMMEND THAT YOU REVIEW THE COMPLETE ASSEMBLY GUIDE AND PERFORM CHECKS SPECIFIED IN THE OWNER'S MANUAL BEFORE RIDING.

- 5/6mm hex wrench
- Torque wrench
- Air pump & tire gauge to inflate tires
- Bicycle lubricant or grease

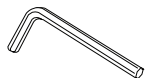

- 6" adjustable wrench
- Phillips & standard screwdrivers
- A pair of pliers with cable cutting ability

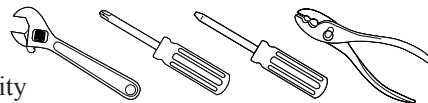

BEFORE EVERY RIDE:

Just a minute spent before each ride can significantly improve your safety and the enjoyment of your ride. So, each time before you ride make a habit of performing the following safety checks on the co-pilot and the bicycle to which it is attached.

- Try to lift, push down on and twist the seat to confirm that it is tight.
- Look at the connection of the pedals to the crank arm. You should see no pedal screw threads and the pedal should feel firm and be parallel to the ground.
- Apply your bike brake(s) and make sure that they feel firm to the touch, and then spin the wheel(s). Apply the brake(s). They should stop the wheel(s).
- Check to be sure that fenders and accessories are firmly attached and will not contact any moving parts. Make sure all reflectors are in position and not broken or missing. Replace any broken or missing reflectors before riding.

Now, put on your bicycle safety helmet, and the co-pilot's helmet as well, and enjoy your ride. Your safety and that of your passenger is well worth *just a minute*. Also, be sure to read and follow the warnings and instructions on the bicycle and in the Assembly, Maintenance and other sections of this manual.

BEFORE RIDING:

CAUTION: Added weight of the co-pilot unit, plus its passenger if applicable, will affect the riding and braking functions of the lead bicycle. Before riding make sure your bicycle is in good working condition. Be aware that braking, stopping, and turning may take longer or feel different due to extra load.

Remember that with a co-pilot unit attached to your bicycle, the unit is longer than before and the added weight will alter the stability and riding characteristics.

- Turning and maneuvering may require more skill. Avoid extremely sharp turns while towing a co-pilot as it will be very difficult to maneuver until you gain experience. Try to follow a smooth route; plan turns following a wide arc whenever possible.
- Take extra care to make your moves on the towing bicycle very slow and smooth. This will make it easier for the rider on the co-pilot. Look far ahead in order to move straight and plan your route.
- Before riding, ensure the co-pilot unit does not hamper braking, pedaling, or steering of the lead bicycle.

 **WARNING: DO NOT ATTACH ADDITIONAL TRAILERS OR VEHICLES TO THE REAR OF THE CO-PILOT BICYCLE.**

 **FOR SAFETY REASONS WHILE RIDING MAKE SURE ALL LOOSE CLOTHING, SHOE LACES, TOYS, AND/OR BODY PARTS OF DRIVER AND PASSENGER REMAIN CLEAR OF ALL MOVING PARTS.**

ASSEMBLY INSTRUCTIONS

STEP 1: HINGE ASSEMBLY

1. Grasp the bike frame (A) and rotate trailer arm (B) upwards until the two flat plates meet and the alignment pin clicks securely into place.
2. Rotate the quick release lever over and down into the slot. Adjust the quick release tension by rotating clockwise to tighten and counter clockwise to loosen. Set the quick release lever to the closed position.
3. Before you proceed, check to be sure all parts are securely fastened.

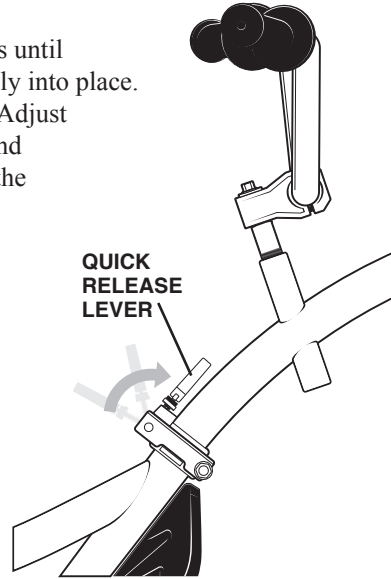
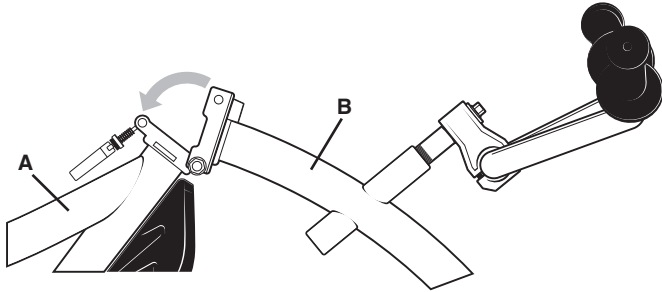

1. HINGE CLOSED AND IN LOCK POSITION

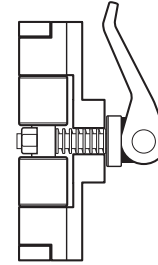

TOP VIEW

2. ROTATE QUICK RELEASE DOWN TO UNLOCK

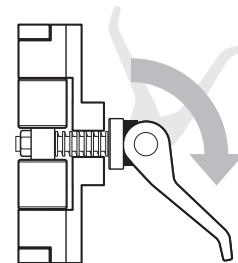

TOP VIEW

ASSEMBLY INSTRUCTIONS *continued*

STEP 2: HANDLEBAR ASSEMBLY

NOTE: The stem has been pre-assembled to the handlebar at the factory. Prior to assembly, check to be certain the handlebar is securely fastened to the stem.

1. Insert the handlebar stem (C) into the frame tube with the clamp portion, which holds the handlebar in place, toward the front. The stem must be inserted far enough into the frame tube to hide the minimum insertion line marked on the stem. (If necessary, loosen the expander bolt to allow the stem to fit into the fork tube.)
2. Place a drop of oil under the head of the expander bolt (D). Tighten the expander bolt just enough to hold the stem in place.
3. Raise or lower the handlebar stem until you have reached the desired height for the user of the co-pilot and then position the handlebar so it is perpendicular (90 degrees) to the front of the bike. Next, tighten the expander bolt to the required torque. Be sure to have inserted the handlebar steering tube at least 2 1/2" (65mm), making certain the minimum insertion line is no longer visible. **Torque 10-15 ft-lb / 13-20 N-m**

WARNING: Assembler is cautioned against the danger of damaging the handlebar stem assembly and possible injury to rider which can result from under-tightening or over-tightening the expander bolt and expander wedge.

4. Slightly loosen the clamp bolts (E) to allow the handlebar (F) to rotate easily. Rotate the handlebar into an upright position. After you have achieved a comfortable handlebar position for the intended user, then proceed to tighten all four clamp bolts to the torque specified below. Tighten each bolt only a few turns at a time, to get even clamping. **Torque 8-11 ft-lb / 11-15 N-m**

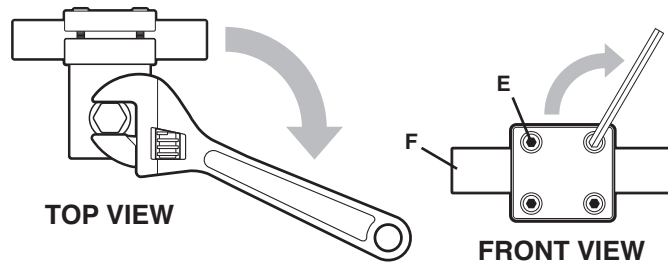
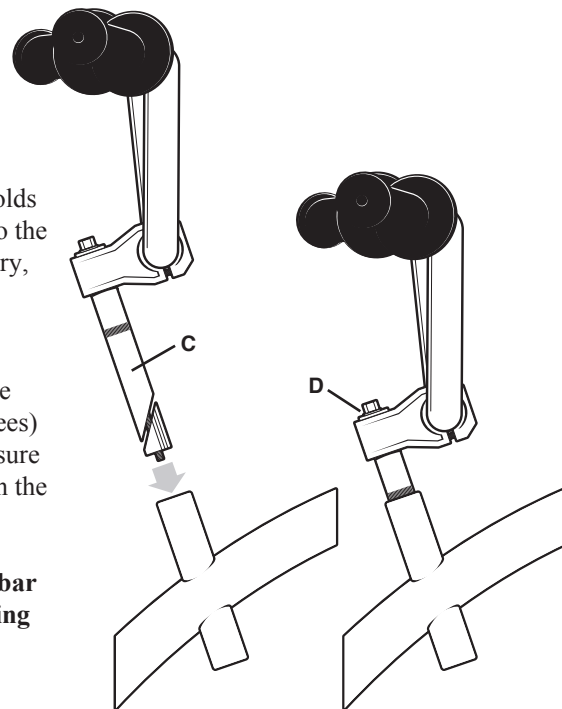

ASSEMBLY INSTRUCTIONS *continued*

STEP 3: INSTALL SEAT AND SEAT POST

FOR YOUR CONVENIENCE THE SEAT ON SOME UNITS MAY HAVE BEEN ASSEMBLED TO THE SEAT POST AT THE FACTORY.

SEAT ASSEMBLY:

1. Loosen seat clamp nut (G).
2. Insert the top portion of seat post (H) into the seat clamp (I). Be sure the seat post is completely inserted into the seat clamp and butted tight against the end stop.
3. Retighten seat clamp nut on both sides (hand tight). The nut will be securely tightened later with an adjustable wrench.

SEAT POST ASSEMBLY:

4. Insert seat post into bicycle frame. Be sure that seat post is inserted into frame at least 2 1/2" (65mm).

CAUTION: MINIMUM INSERTION LINE SHOULD BE COMPLETELY INSERTED INTO THE FRAME AND NOT VISIBLE ONCE INSERTED.

5. Tighten the seat post binder bolt (J) securely at desired height to fit the intended user.
6. Adjust angle of seat so that top of seat is parallel to the ground and comfortable for the rider.
7. Retighten seat clamp securely with an adjustable wrench to the torque specified below. PLEASE NOTE: Test the seat to pedal distance. The ball of the foot of the intended rider should rest comfortably on the pedal when it is in its lowest position. If it does not, adjust the seat height as necessary.

Check for tightness by attempting to move the seat up and down, then side to side. If the seat is loose, be sure to tighten the clamp nut and binder bolt nut securely. **Torque 12-16 ft-lb / 17-21 N-m**

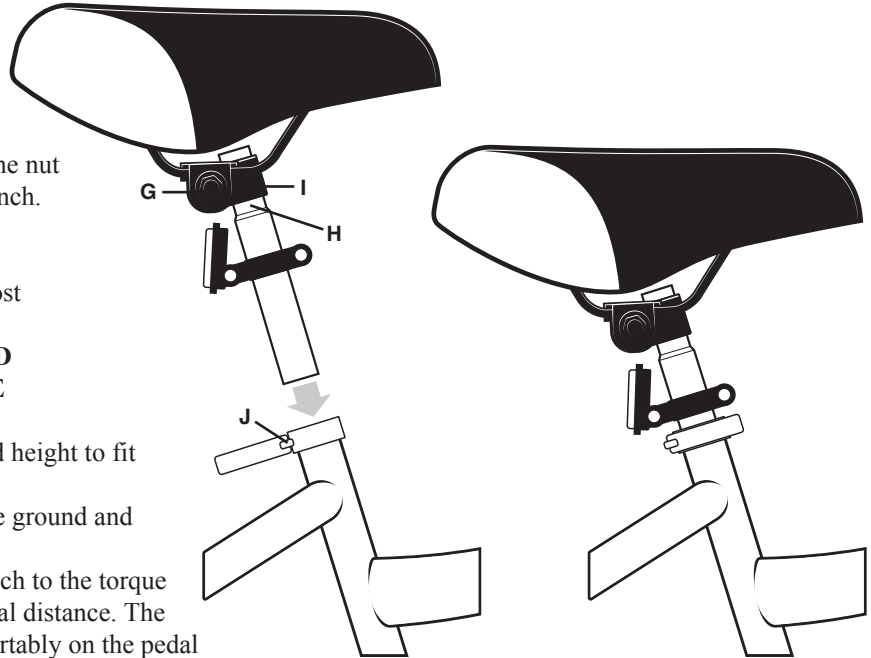

ASSEMBLY INSTRUCTIONS *continued*

STEP 4: INSTALL PEDALS

WARNING: For safe operation, the pedal spindle must be securely tightened against the crank arm. Always replace damaged pedals, and always wear shoes or sneakers when riding a bicycle.

NOTICE: Start each pedal spindle by hand to avoid stripping the threads.

1. Look for the letters “R” or “L” stamped on the end of the pedal spindle.
2. Thread the pedal marked “R” into the crank arm on the right or “chain side” of the bike. Turn the pedal spindle in a clockwise direction. Securely tighten the pedal spindle with a wrench.
3. Thread the pedal marked “L” into the crank on the left side of the bike. Turn the pedal spindle in a COUNTER CLOCKWISE direction. Securely tighten the pedal spindle with a wrench.

NOTE: Both pedals should be tightened towards the front of the bicycle.

Torque 15-18 ft-lb / 20-26 N-m

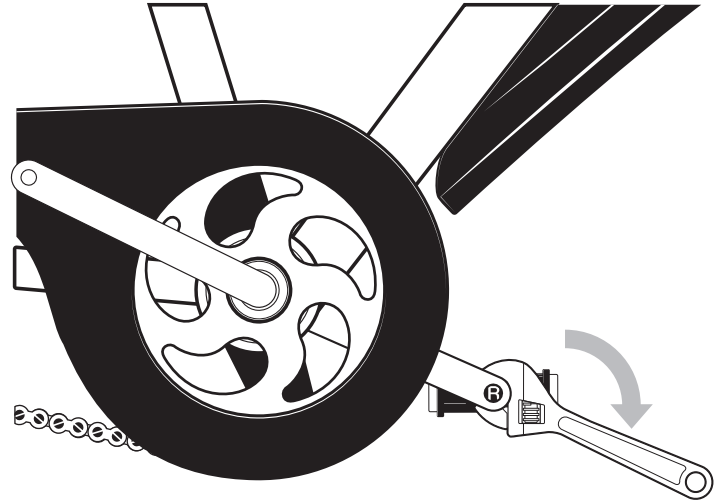
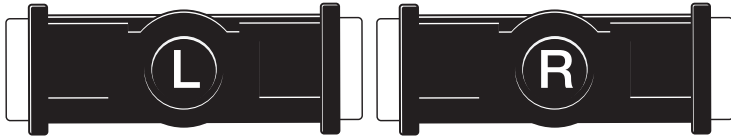

ASSEMBLY INSTRUCTIONS *continued*

STEP 5: ATTACH THE TRAILER MOUNT TO THE ADULT (LEAD) BICYCLE

CLAMP ATTACHMENT:

1. Loosen all 4 clamp bolts (K) and remove the front plate (L) from the trailer clamp.
2. Place the copilot mount behind the adult bike with the trailer clamp against the adult bike seat post (M). The seat post should rest in the valley of the trailer mount.
3. Place the trailer mount plate over the front of the seat post and tighten all four bolts by hand. Tighten each bolt two complete turns with an Allen wrench.
4. Tighten all four bolts in a crisscross pattern (1, 2, 3, 4 as shown below then repeat) until they are tightened equally and the gap between the clamp plate and the mount is even on both sides.

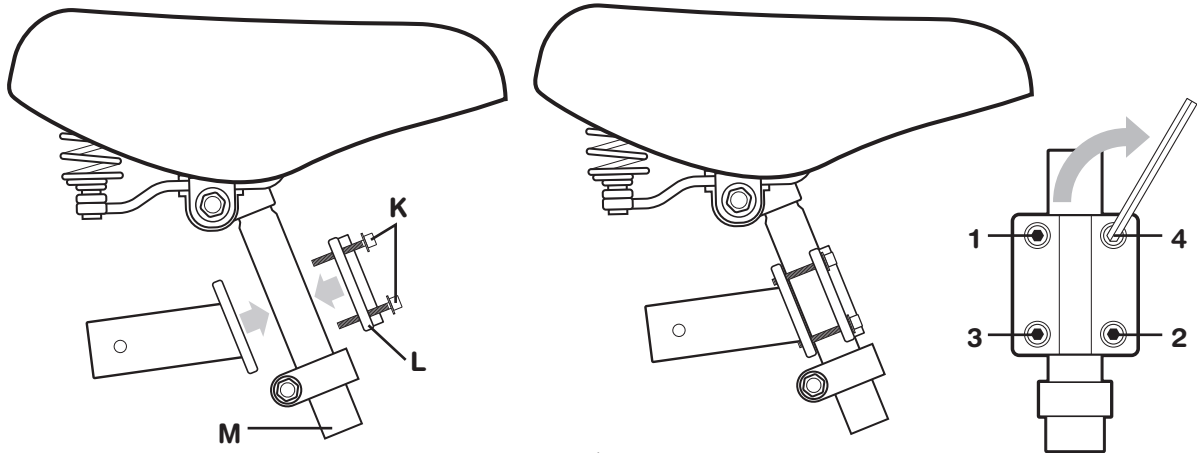

ASSEMBLY INSTRUCTIONS *continued*

STEP 6: ATTACHING THE TRAILER TO THE BICYCLE

1. Insert the co-pilot arm (N) into the mount (O) on the adult bicycle and align the holes on each part.
2. Remove the nut from quick release pin and insert the pin into the mount and push it all the way through the hole.
3. Now thread the nut onto the pin until it makes contact with the mount. Check to see that the quick release lever (P) is in the open position.
4. Adjust the nut counter clockwise until the quick release will tighten to the closed position.

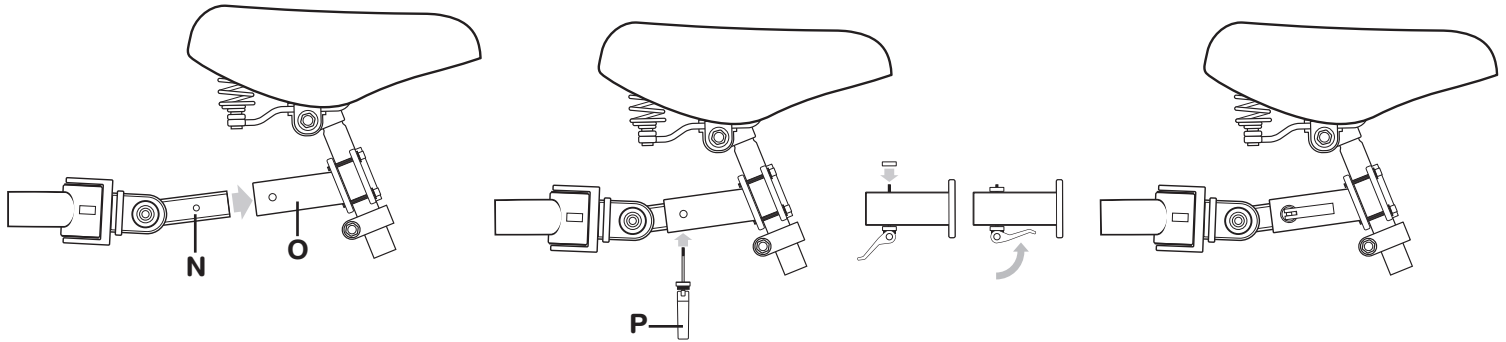

REMOVING THE CO-PILOT TRAILER BIKE

When you do not need the trailer bike attached, it is very simple to remove the bike without removing the trailer clamp.

1. Loosen the quick release lever (P) and remove the nut from the other side.
2. Slide the quick release bolt completely out.
3. Slide the co-pilot arm (N) out from the seat post mount (O). Replace the quick release pin and tighten.

ASSEMBLY INSTRUCTIONS *continued*

STEP 7: INSTALL SAFETY FLAG

ALWAYS USE THE SAFETY FLAG
WHEN RIDING YOUR TRAILER BIKE.

1. Locate the safety flag, poles, and plastic joiner.
Join the two poles by inserting one pole into each
end of the joiner.
2. Insert the safety flag assembly into the bracket
next to the trailer bike's rear hub nut.
3. The completed product should look as shown below.

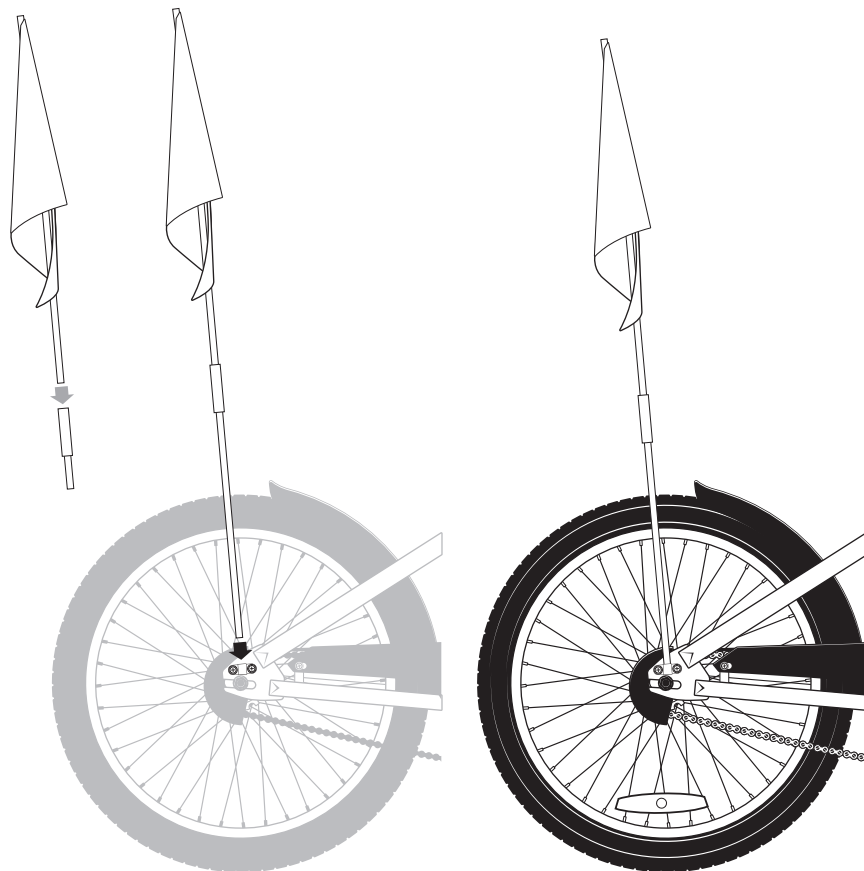

OPERATING THE CO-PILOT TRAILER BIKE

Before riding, check the tire pressure and recheck all fasteners.

WARNING: Always use the safety flag when riding with this product.

The adult should straddle the bike to hold it steady and upright while the child climbs onto the co-pilot.

WARNING! THE ADULT BIKE KICKSTAND IS NOT DESIGNED TO SUPPORT THE ADDITIONAL WEIGHT OF A CHILD SEATED ON THE TRAILER BIKE. THE ADULT PULLING THE CHILD SHOULD ALWAYS STRADDLE THE ADULT BIKE WHENEVER THE CHILD IS SEATED ON THE TRAILER BIKE, OR GETTING ON AND OFF THE TRAILER BIKE.

WARNING! Adult and child should always wear an approved safety helmet when riding! Do NOT ride at night.

STORING THE CO-PILOT TRAILER BIKE

When not in use for an extended period of time, the co-pilot should be removed from the lead bicycle and safely stored indoors in a dry, well-ventilated area away from elements which may compromise the reliability or structural integrity of the trailer. Remove the co-pilot bike using the instructions as described on page 14.

NOTE: During storage the tire on the co-pilot unit may lose air, so always check tire pressure before riding and check all fasteners for proper tightness.

REFLECTORS

Your co-pilot is supplied with a red rear reflector and a white wheel reflector as well as four orange pedal reflectors. These are an important safety and legal requirement, and should remain securely fitted and in good condition at all times. Periodically, inspect all reflectors, brackets and mounting hardware for signs of wear or damage. Replace immediately if damage is found. Some co-pilot units will require you to install your reflectors onto your bicycle. Please refer to the following section for instructions on all types of bicycle reflectors.

⚠ WARNING! REFLECTORS ARE IMPORTANT SAFETY DEVICES WHICH ARE DESIGNED AS AN INTEGRAL PART OF YOUR BICYCLE. FEDERAL REGULATIONS REQUIRE EVERY BICYCLE TO BE EQUIPPED WITH FRONT, REAR, WHEEL, AND PEDAL REFLECTORS. THESE REFLECTORS ARE DESIGNED TO PICK UP AND REFLECT STREET LIGHTS AND CAR LIGHTS IN A WAY THAT HELPS YOU TO BE SEEN AND RECOGNIZED AS A MOVING BICYCLIST. CHECK REFLECTORS AND THEIR MOUNTING BRACKETS REGULARLY TO MAKE SURE THEY ARE CLEAN, STRAIGHT, UNBROKEN AND SECURELY MOUNTED. HAVE YOUR DEALER REPLACE DAMAGED REFLECTORS AND STRAIGHTEN OR TIGHTEN ANY THAT ARE BENT OR LOOSE.

REAR REFLECTOR MOUNT ON SEAT POST

First attach the reflector to the bracket with the reflector screw, see the top diagram. Next, remove the clamp screw and open the clamping reflector bracket. Place clamping reflector bracket around the seat post. If the clamp is too loose, insert the shim inside the clamp. Tighten the clamp screw to hold the reflector assembly in place. Finally adjust the reflector assembly in place and ensure that it is upright and facing away from the bike.

CAUTION: Be sure the reflector is vertical to the ground. If the reflector is aimed up or down, oncoming headlights may not reflect properly in the reflector.

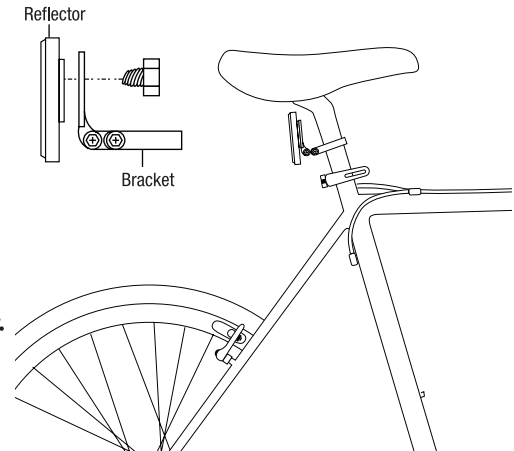

MAINTENANCE

1. Inflate tires with a hand or foot pump to correct PSI reading shown on the tire sidewall. Do not use a high volume/high pressure commercial inflation system to inflate tire as damage could result.
2. Lube the chain monthly, or as needed, with bicycle chain oil.
3. Check all fasteners before each use to make sure they are all secure.

When performing repairs and maintenance, only recommended replacement parts should be used. Call customer service at 800-451-5368 for a list of these verified replacement parts.

LIMITED WARRANTY

This limited warranty extends only to the original retail purchaser, who must produce proof of purchase in order to validate any claim and is not transferable to anyone else.

What does this Limited Warranty cover? This limited warranty covers all parts of the co-pilot to be free of defects in workmanship and materials. What must you do to keep the limited warranty in effect? This limited warranty is effective only if:

- The co-pilot is completely and correctly assembled.
- The co-pilot is used under normal conditions for its intended purpose, by a person that properly fits and is capable of controlling the bicycle and co-pilot unit.
- The co-pilot receives all necessary maintenance and adjustments.

What is not covered by this Limited Warranty? This limited warranty does not include labor and transportation charges. The co-pilot is designed for general transportation and recreational use only. This limited warranty does not cover normal wear and tear, paint, rust, normal maintenance items, personal injury, or any damage, failure, or loss that is caused by accident, improper assembly, lack of maintenance, incorrect adjustment, improper storage, or improper use of the co-pilot.

This limited warranty will be void if the co-pilot is ever:

- Used in any competitive sport or ridden off-road.
- Used for stunt riding, jumping, aerobatics or similar activity.
- Installed with a motor or modified in any other structural way.
- Ridden by more than one person at a time.
- Rented or used for commercial purposes.
- Used in a manner contrary to the instructions in this Owner's Assembly Manual. The manufacturer will not be liable for incidental or consequential loss or damage, due directly or indirectly from use of this product.

For how long does this Limited Warranty last? The frame will be covered under this limited warranty for the usable life of the co-pilot. All other components come with a 6 month warranty, this does not cover wear and tear, or faults deemed to have been a result of abuse or misuse.

How do you get service? Contact: 1-800-451-5368

What rights do you have? This limited warranty does not affect your legal or statutory rights. You may have other rights which vary from state to state.