

Round Threaded Brass Heat-Insert Nut

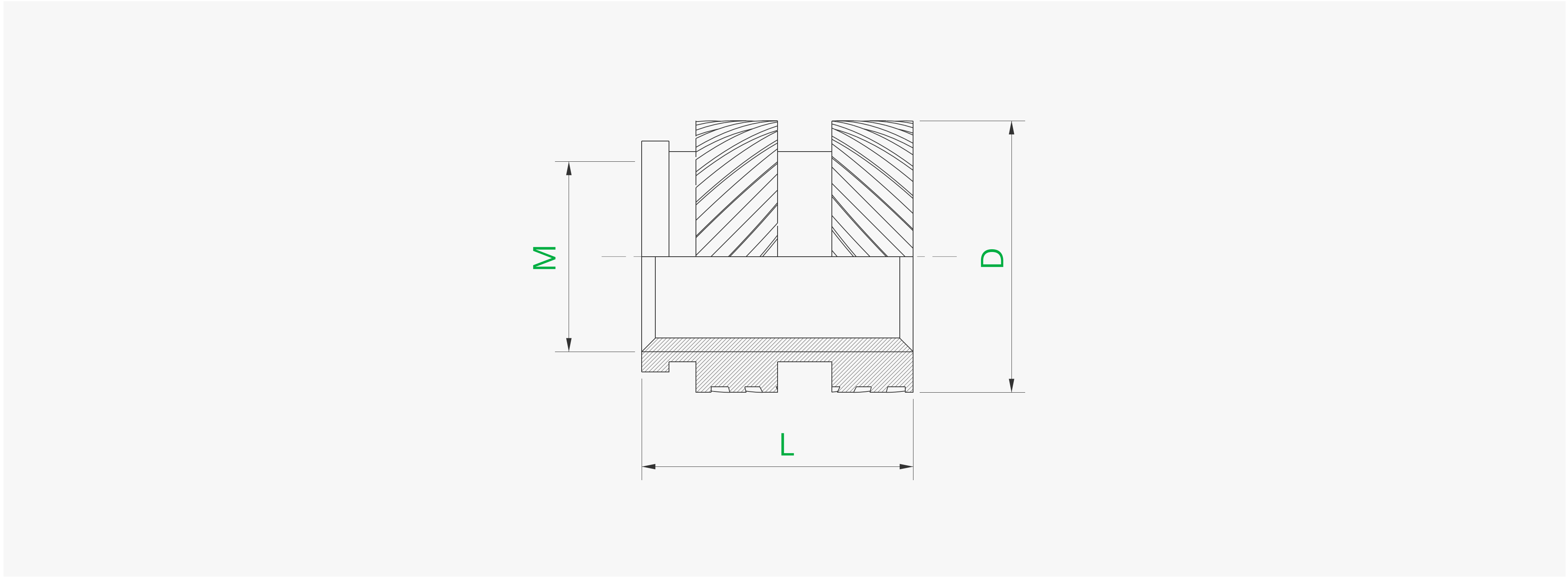

Product ID	M (mm) Nominal Diameter	D (mm) Outer Diameter	L (mm) Length
AB009	2.0	4.0	4.0
AB010	2.0	4.0	6.0
AB011	2.5	4.0	4.0
AB012	3.0	5.0	4.0
AB016	4.0	6.0	6.0

Basic Information

Surface Treatment	No	Material	Brass
Knurling type	Herringbone twill knurling	Thread Ridge Type	Metric coarse
Quantity	20 pcs	Color	Yellow

Product Feature

- Round Threaded Brass Heat-Insert Nut with Double Twill Knurling
- Stronger pull-out resistance than Diamond Knurling or Straight Knurling
- Better attachment to the plastic part compared to Diamond Knurling
- Easy to install in 3D printed parts with a heated soldering iron

双斜纹热熔螺母

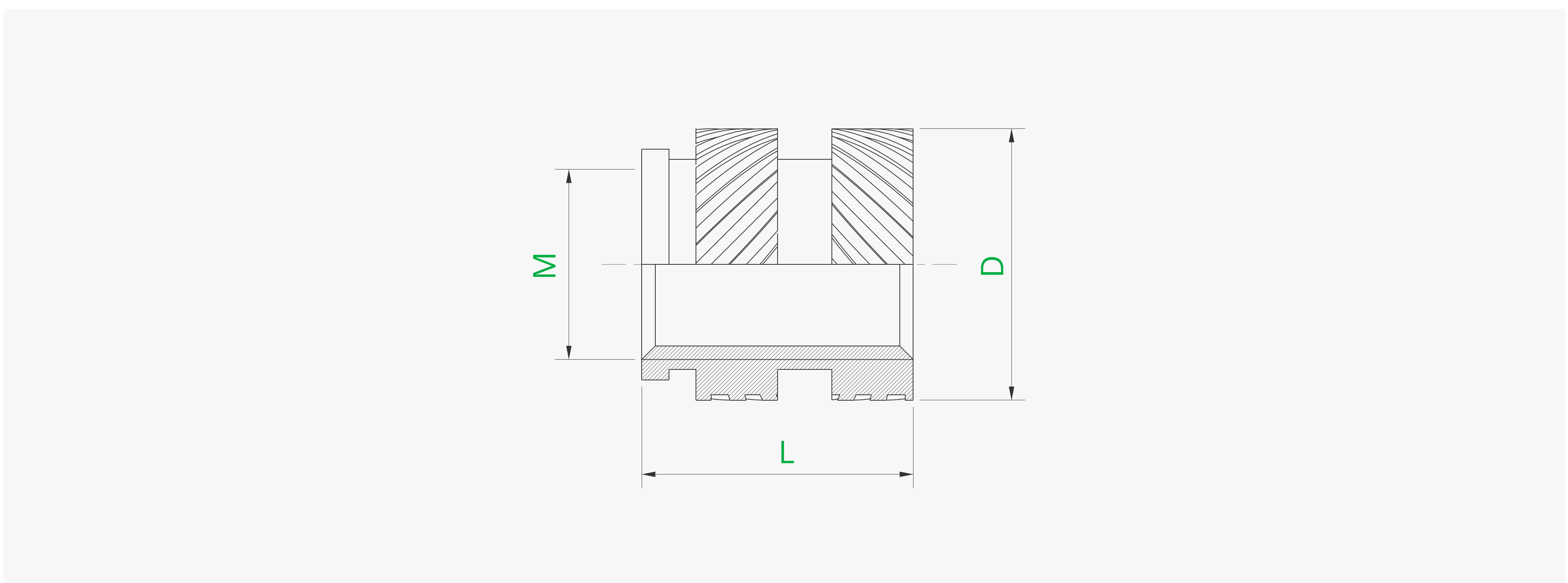

产品 ID	公称直径M (mm)	外径D (mm)	长度L (mm)
AB009	2.0	4.0	4.0
AB010	2.0	4.0	6.0
AB011	2.5	4.0	4.0
AB012	3.0	5.0	4.0
AB016	4.0	6.0	6.0

基本信息

表面处理	无	材质	黄铜
滚花类型	人字斜纹滚花	螺纹牙形	公制 粗牙
数量	20	表面颜色	金黄色

产品特点

- 双斜纹热熔螺母
- 相较直滚花和网纹滚花拥有更强的抗拉拔性能
- 相较网纹在安装时填充更佳效果更好
- 使用加热烙铁即可轻松安装到 3D 打印部件中