

M2.5 Socket Head Cap Machine Screws (SHCS)

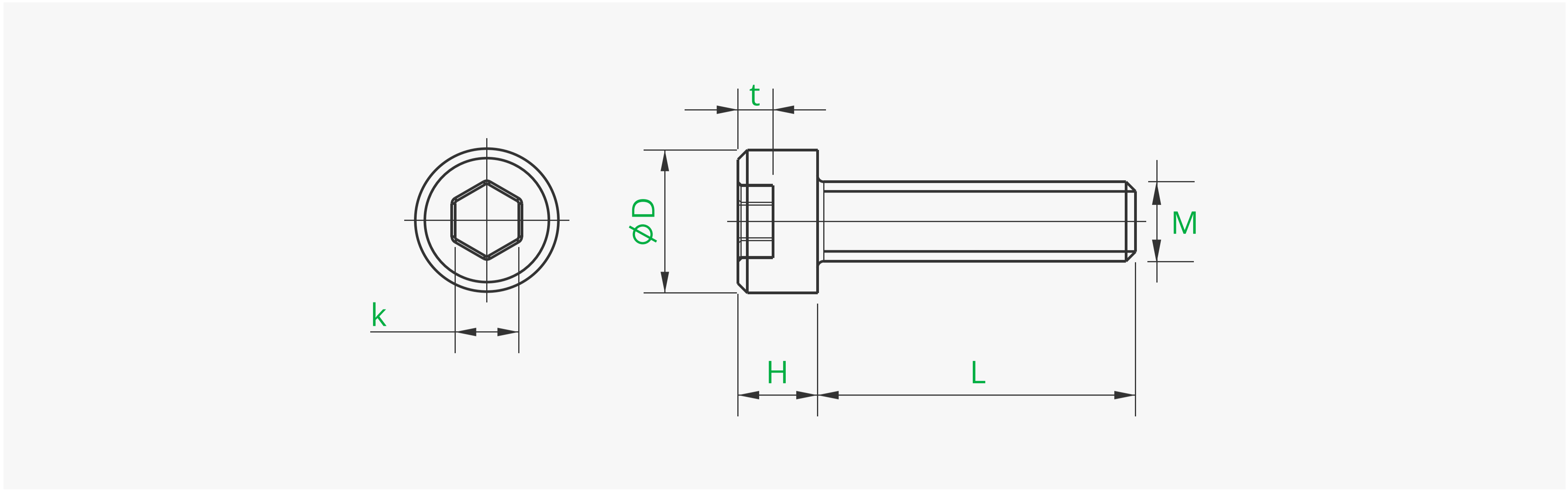

| Product ID | L (mm) Bolt Length | D (mm) Head Diameter | H (mm) Head Thickness | k (mm) Hexagon Across Flats | t (mm) Groove Depth | Screwdriver Bit Size |
|------------|-----------------------|-------------------------|--------------------------|--------------------------------|------------------------|----------------------|
| AA154 | 5 | 4.3 | 2.35 | 2.0 | 1.1 | H2 |
| AA029 | 6 | 4.3 | 2.35 | 2.0 | 1.1 | H2 |
| AA030 | 8 | 4.3 | 2.35 | 2.0 | 1.1 | H2 |
| AA155 | 10 | 4.3 | 2.35 | 2.0 | 1.1 | H2 |
| AA031 | 12 | 4.3 | 2.35 | 2.0 | 1.1 | H2 |
| AA156 | 14 | 4.3 | 2.35 | 2.0 | 1.1 | H2 |
| AA032 | 16 | 4.3 | 2.35 | 2.0 | 1.1 | H2 |
| AA157 | 18 | 4.3 | 2.35 | 2.0 | 1.1 | H2 |
| AA033 | 20 | 4.3 | 2.35 | 2.0 | 1.1 | H2 |
| AA034 | 25 | 4.3 | 2.35 | 2.0 | 1.1 | H2 |
| AA035 | 30 | 4.3 | 2.35 | 2.0 | 1.1 | H2 |

*Compliant with the requirements of GB/T 70.1-2008 standard [Equivalent standards: ISO 4762, ASME/ANSI B 18.3.1M - 1986 (R1993), DIN EN ISO 12474]

Basic Information

| | | | |
|---------------------|-----------------|-------------------|---------------|
| Surface Treatment | No | Material | Carbon steel |
| Mounting Hole Shape | Hex socket | Thread Ridge Type | Metric coarse |
| Screw Type | Complete thread | Color | Silver |

Product Feature

- Carbon Steel Socket Head Cap Machine Screws (SHCS)
- Nominal thread: M1.6-M5
- Strength grade: 4.8
- Full thread series
- Type of thread: Metric coarse thread

M2.5 圆柱头机牙螺丝

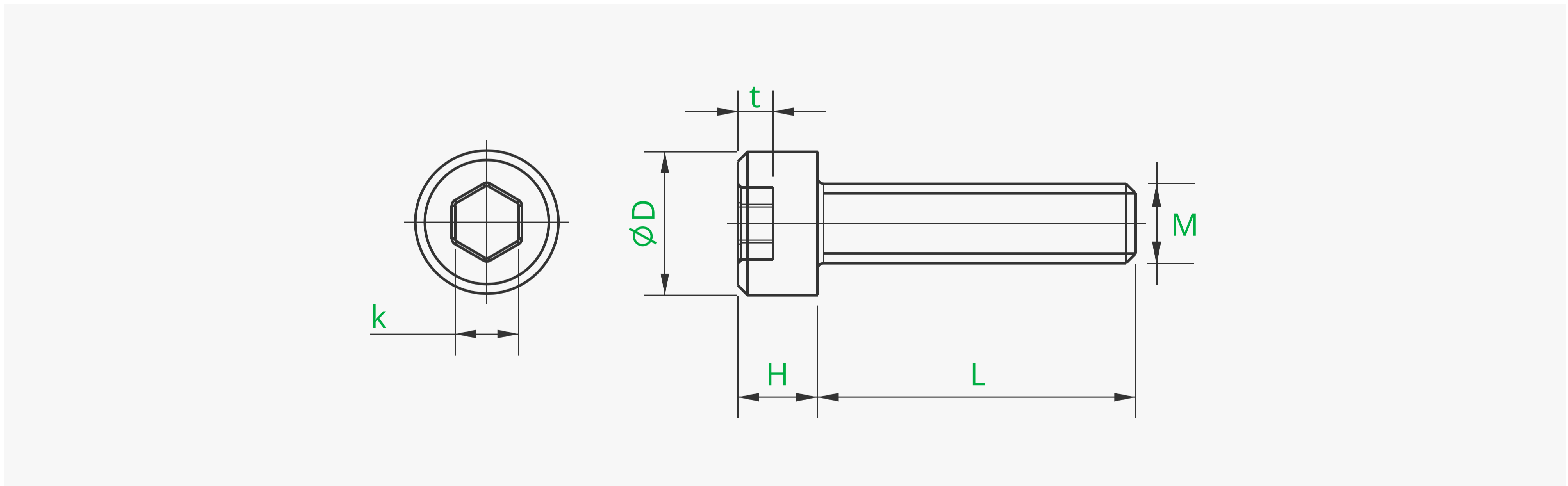

| 产品ID | 螺栓长度L (mm) | 头部直径D (mm) | 头部厚度H (mm) | 六角对边距k (mm) | 槽深t (mm) | 适配批头 |
|-------|------------|------------|------------|-------------|----------|------|
| AA154 | 5 | 4.3 | 2.35 | 2.0 | 1.1 | H2 |
| AA029 | 6 | 4.3 | 2.35 | 2.0 | 1.1 | H2 |
| AA155 | 8 | 4.3 | 2.35 | 2.0 | 1.1 | H2 |
| AA029 | 10 | 4.3 | 2.35 | 2.0 | 1.1 | H2 |
| AA031 | 12 | 4.3 | 2.35 | 2.0 | 1.1 | H2 |
| AA156 | 14 | 4.3 | 2.35 | 2.0 | 1.1 | H2 |
| AA032 | 16 | 4.3 | 2.35 | 2.0 | 1.1 | H2 |
| AA157 | 18 | 4.3 | 2.35 | 2.0 | 1.1 | H2 |
| AA033 | 20 | 4.3 | 2.35 | 2.0 | 1.1 | H2 |
| AA034 | 25 | 4.3 | 2.35 | 2.0 | 1.1 | H2 |
| AA035 | 30 | 4.3 | 2.35 | 2.0 | 1.1 | H2 |

*符合GB/T 70.1-2008标准要求 [等效标准: ISO 4762, ASME/ANSI B 18.3.1M - 1986 (R1993) 、DIN EN ISO 12474]

基本信息

| | | | |
|------|------|------|------|
| 表面处理 | 无 | 材质 | 碳钢 |
| 批头种类 | 内六角 | 螺纹牙形 | 公制粗牙 |
| 牙长 | 全螺纹型 | 表面颜色 | 银色 |

产品特点

- 碳钢半圆柱头机牙螺丝
- 螺纹公称: M2-M4
- 强度等级: 4.8
- 全牙系列
- 螺纹牙形种类: 公制粗牙