



gravity//conveyor



Pick Smarter. Pick Better. Pick UNEX.



Skatewheel Gravity Conveyor is ideally suited to convey lightweight packages and where operations require portable or temporary conveyor lines such as warehousing or shipping areas.

- 4 Widths
- Axles on 3" Centers
- Steel or Aluminum Frames & Wheels
- Wheels Set High (for wheels set low, add angle guard rail)

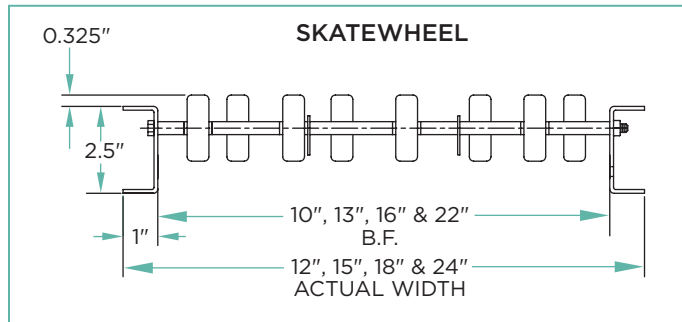

Straight Sections

Specifications

Width: 12", 15", 18" and 24" OAW

Frame: 2-1/2" deep x 1" flange x 12 ga. Galvanized Steel
0.112" extruded aluminum channel with bolt in cross braces

Couplings: Hooks one end, studs on opposite end.

NOTE: Steel conveyor available without couplings for permanent installations - Add "SE" suffix to conveyor part number for square cut side channels.

Lengths: 10 ft. and 5 ft. straight sections.

Special lengths available.

Wheels: 1-15/16" dia. with ball bearings in hardened raceway.
Zinc plated steel or corrosion resistant aluminum.

Axles: 1/4" dia. steel, threaded one end with locknut,
spaced on 3" centers. Spacers are zinc plated steel.

Capacity: See Load Capacity Chart.

MODEL NUMBER EXAMPLE - SKATEWHEEL STRAIGHT

12	SW	G or A	S or A	10	x10
OVERALL CONVEYOR WIDTH	CONVEYOR SERIES	G = GALVANIZED STEEL FRAME A = ALUMINUM FRAME	S = STEEL WHEEL A = ALUMINUM WHEEL	WHEELS PER FOOT	CONVEYOR LENGTH

LOAD CAPACITY CHART - SKATEWHEEL

FRAME MATERIAL	SUPPORT CENTERS	FRAME CAPACITY	WHEEL CAPACITY
STEEL	10 FT.	600 LBS.	50 LBS.
	5 FT.	2100 LBS.	
ALUMINUM	10 FT.	300 LBS.	25 LBS.
	5 FT.	1400 LBS.	

*Maximum uniformly distributed load

STEEL FRAME/STEEL WHEEL

12" OVERALL WIDTH				15" OVERALL WIDTH				18" OVERALL WIDTH				24" OVERALL WIDTH			
MODEL #	WHEELS PER FT.	WEIGHT (LBS) 10 FT.	WEIGHT (LBS) 5 FT.	MODEL #	WHEELS PER FT.	WEIGHT (LBS) 10 FT.	WEIGHT (LBS) 5 FT.	MODEL #	WHEELS PER FT.	WEIGHT (LBS) 10 FT.	WEIGHT (LBS) 5 FT.	MODEL #	WHEELS PER FT.	WEIGHT (LBS) 10 FT.	WEIGHT (LBS) 5 FT.
12SWGS10	10	67	34	15SWGS10	10	69	35	18SWGS14	14	79	40	24SWGS16	16	92	47
12SWGS12	12	70	36	15SWGS12	12	72	37	18SWGS16	16	83	42	24SWGS20	20	99	50
12SWGS16	16	77	39	15SWGS16	16	79	40	18SWGS18	18	86	44	24SWGS24	24	105	54

ALUMINUM FRAME/STEEL WHEEL

12" OVERALL WIDTH				15" OVERALL WIDTH				18" OVERALL WIDTH				24" OVERALL WIDTH			
MODEL #	WHEELS PER FT.	WEIGHT (LBS) 10 FT.	WEIGHT (LBS) 5 FT.	MODEL #	WHEELS PER FT.	WEIGHT (LBS) 10 FT.	WEIGHT (LBS) 5 FT.	MODEL #	WHEELS PER FT.	WEIGHT (LBS) 10 FT.	WEIGHT (LBS) 5 FT.	MODEL #	WHEELS PER FT.	WEIGHT (LBS) 10 FT.	WEIGHT (LBS) 5 FT.
12SWAS10	10	46	25	15SWAS10	10	50	26	18SWAS14	14	60	31	24SWAS16	16	73	37
12SWAS12	12	51	26	15SWAS12	12	52	27	18SWAS16	16	63	32	24SWAS20	20	80	41
12SWAS16	16	58	30	15SWAS16	16	60	31	18SWAS18	18	66	34	24SWAS24	24	86	44

ALUMINUM FRAME/ALUMINUM WHEEL

12" OVERALL WIDTH				15" OVERALL WIDTH				18" OVERALL WIDTH				24" OVERALL WIDTH			
MODEL #	WHEELS PER FT.	WEIGHT (LBS) 10 FT.	WEIGHT (LBS) 5 FT.	MODEL #	WHEELS PER FT.	WEIGHT (LBS) 10 FT.	WEIGHT (LBS) 5 FT.	MODEL #	WHEELS PER FT.	WEIGHT (LBS) 10 FT.	WEIGHT (LBS) 5 FT.	MODEL #	WHEELS PER FT.	WEIGHT (LBS) 10 FT.	WEIGHT (LBS) 5 FT.
12SWAA10	10	41	21	15SWAA10	10	43	22	18SWAA14	14	50	26	24SWAA16	16	62	31
12SWAA12	12	43	22	15SWAA12	12	45	23	18SWAA16	16	52	27	24SWAA20	20	66	34
12SWAA16	16	47	24	15SWAA16	16	49	25	18SWAA18	18	54	28	24SWAA24	24	70	36

Contents

Skatewheel Conveyor (SW)	2
1.38" Diameter Roller Conveyor (JRS)	4
1.9" Diameter Roller Conveyor (MRS)	6
Spurs	8
Gates	9
Supports	10
Accessories	11

QUICK SHIP ITEM



Skatewheel Curves are compatible with straight sections, allowing flexibility on conveyor lines. They maintain package orientation due to the differential action of the individual wheels.

- 4 Widths
- Steel or Aluminum Frames & Wheels
- Gravity Hooks & Studs Both Ends
- 45° and 90° Curves
- 36" Inside Radius

OUTSIDE RADIUS	
Overall Width	Outside Radius
12"	48"
15"	51"
18"	54"
24"	60"

Curved Sections

Specifications

Width: 12", 15", 18" and 24" OAW

Frame: 2-1/2" deep x 1" flange x 12 ga. Galvanized Steel
0.112" extruded aluminum channel with bolt in cross braces.

Couplings: Hooks and studs on both ends of curve.

Axes: 1/4" dia. steel, threaded one end with locknut, spaced on 3" equivalent centers. Spacers are zinc plated steel.

Capacity: Same per foot capacity as straight sections.

MODEL NUMBER EXAMPLE - SKATEWHEEL CURVED						
12	36	SW	G or A	S or A	12	90
OVERALL CONVEYOR WIDTH	INSIDE RADIUS	CONVEYOR SERIES	G = GALVANIZED STEEL FRAME A = ALUMINUM FRAME	S = STEEL WHEEL A = ALUMINUM WHEEL	WHEELS PER FOOT	DEGREE OF CURVE

STEEL FRAME/STEEL WHEEL							
12" OVERALL WIDTH				15" OVERALL WIDTH			
MODEL #	DEGREE	WHEELS PER FT.	WEIGHT (LBS)	MODEL #	DEGREE	WHEELS PER FT.	WEIGHT (LBS)
1236SWGS1290	90	12	44	1536SWGS1290	90	12	46
1236SWGS1245	45	12	24	1536SWGS1245	45	12	25
18" OVERALL WIDTH				24" OVERALL WIDTH			
MODEL #	DEGREE	WHEELS PER FT.	WEIGHT (LBS)	MODEL #	DEGREE	WHEELS PER FT.	WEIGHT (LBS)
1836SWGS1890	90	18	56	2436SWGS2490	90	24	70
1836SWGS1845	45	18	29	2436SWGS2445	45	24	36

ALUMINUM FRAME/STEEL WHEEL							
12" OVERALL WIDTH				15" OVERALL WIDTH			
MODEL #	DEGREE	WHEELS PER FT.	WEIGHT (LBS)	MODEL #	DEGREE	WHEELS PER FT.	WEIGHT (LBS)
1236SWAS1290	90	12	33	1536SWAS1290	90	12	36
1236SWAS1245	45	12	18	1536SWAS1245	45	12	19
18" OVERALL WIDTH				24" OVERALL WIDTH			
MODEL #	DEGREE	WHEELS PER FT.	WEIGHT (LBS)	MODEL #	DEGREE	WHEELS PER FT.	WEIGHT (LBS)
1836SWAS1890	90	18	45	2436SWAS2490	90	24	58
1836SWAS1845	45	18	24	2436SWAS2445	45	24	31

ALUMINUM FRAME/ALUMINUM WHEEL							
12" OVERALL WIDTH				15" OVERALL WIDTH			
MODEL #	DEGREE	WHEELS PER FT.	WEIGHT (LBS)	MODEL #	DEGREE	WHEELS PER FT.	WEIGHT (LBS)
1236SWAA1290	90	12	27	1536SWAA1290	90	12	29
1236SWAA1245	45	12	16	1536SWAA1245	45	12	17
18" OVERALL WIDTH				24" OVERALL WIDTH			
MODEL #	DEGREE	WHEELS PER FT.	WEIGHT (LBS)	MODEL #	DEGREE	WHEELS PER FT.	WEIGHT (LBS)
1836SWAA1890	90	18	37	2436SWAA2490	90	24	48
1836SWAA1845	45	18	19	2436SWAA2445	45	24	26

QUICK SHIP ITEM



UNEX **1.38" Diameter Roller Gravity Conveyor** is ideally suited to convey light weight packages and where operations require portable or temporary conveyor lines such as warehousing or shipping areas.

- 4 Widths
- 4 Roller Centers
- Steel or Aluminum Frames & Rollers
- Rollers Set High (for rollers set low, add angle guard rail)

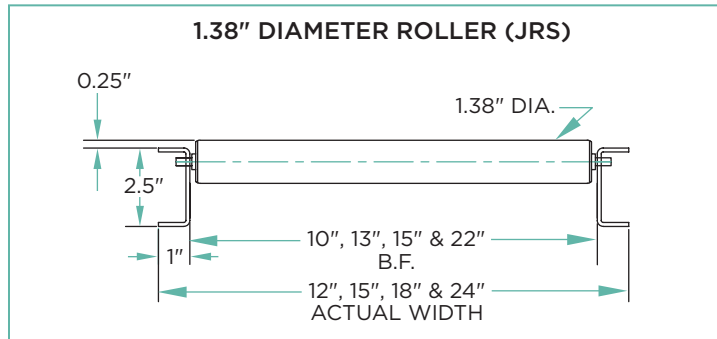

Straight Sections

Specifications

Width: 12", 15", 18" and 24" OAW

Frame: 2-1/2" deep x 1" flange x 12 ga. Galvanized Steel
0.112" extruded aluminum channel with bolt in cross braces

Couplings: Hooks one end, studs on opposite end.

NOTE: Steel conveyor available without couplings for permanent installations - Add "SE" suffix to conveyor part number for square cut side channels.

Lengths: 10 ft. and 5 ft. straight sections.
Special lengths available.

Rollers: 1-3/8" diameter x 18 gauge galvanized steel or .058 heat treated aluminum tubing. Oiled ball bearings both ends.

Axes: 1/4" diameter steel, spring loaded for easy installation or removal, spaced on 1-1/2", 3", 4-1/2" or 6" centers.

Capacity: See Load Capacity Chart.

MODEL NUMBER EXAMPLE - 1.38" DIAMETER ROLLER STRAIGHT

12	JRS	G or A	S or A	1.5	x10
OVERALL CONVEYOR WIDTH	CONVEYOR SERIES	G = GALVANIZED STEEL FRAME A = ALUMINUM FRAME	S = GALVANIZED STEEL ROLLER A = ALUMINUM ROLLER	ROLLER CENTERS	CONVEYOR LENGTH

LOAD CAPACITY CHART - 1.38" DIAMETER ROLLER

FRAME MATERIAL	SUPPORT CENTERS	FRAME CAPACITY*	ROLLER CAPACITY
STEEL	10 FT.	550 LBS.	45 LBS.
	5 FT.	2100 LBS.	
ALUMINUM	10 FT.	275 LBS.	30 LBS.
	5 FT.	1200 LBS.	

*Maximum uniformly distributed load

STEEL FRAME/STEEL ROLLER															
12" OVERALL WIDTH				15" OVERALL WIDTH				18" OVERALL WIDTH				24" OVERALL WIDTH			
MODEL #	ROLLER CENTERS	WEIGHT (LBS) 10 FT.	WEIGHT (LBS) 5 FT.	MODEL #	ROLLER CENTERS	WEIGHT (LBS) 10 FT.	WEIGHT (LBS) 5 FT.	MODEL #	ROLLER CENTERS	WEIGHT (LBS) 10 FT.	WEIGHT (LBS) 5 FT.	MODEL #	ROLLER CENTERS	WEIGHT (LBS) 10 FT.	WEIGHT (LBS) 5 FT.
12JRSGS1.5	1-1/2"	108	55	15JRSGS1.5	1-1/2"	126	64	18JRSGS1.5	1-1/2"	145	74	24JRSGS1.5	1-1/2"	182	93
12JRSGS30	3"	72	37	15JRSGS30	3"	82	42	18JRSGS30	3"	92	47	24JRSGS30	3"	112	58
12JRSGS4.5	4-1/2"	60	30	15JRSGS4.5	4-1/2"	66	34	18JRSGS4.5	4-1/2"	73	38	24JRSGS4.5	4-1/2"	87	46
12JRSGS60	6"	54	28	15JRSGS60	6"	60	31	18JRSGS60	6"	65	34	24JRSGS60	6"	77	40

ALUMINUM FRAME/ALUMINUM ROLLER															
12" OVERALL WIDTH				15" OVERALL WIDTH				18" OVERALL WIDTH				24" OVERALL WIDTH			
MODEL #	ROLLER CENTERS	WEIGHT (LBS) 10 FT.	WEIGHT (LBS) 5 FT.	MODEL #	ROLLER CENTERS	WEIGHT (LBS) 10 FT.	WEIGHT (LBS) 5 FT.	MODEL #	ROLLER CENTERS	WEIGHT (LBS) 10 FT.	WEIGHT (LBS) 5 FT.	MODEL #	ROLLER CENTERS	WEIGHT (LBS) 10 FT.	WEIGHT (LBS) 5 FT.
12JRSA1.5	1-1/2"	62	32	15JRSA1.5	1-1/2"	72	38	18JRSA1.5	1-1/2"	83	43	24JRSA1.5	1-1/2"	104	54
12JRSA30	3"	40	21	15JRSA30	3"	45	24	18JRSA30	3"	51	27	24JRSA30	3"	63	33
12JRSA4.5	4-1/2"	32	17	15JRSA4.5	4-1/2"	36	19	18JRSA4.5	4-1/2"	40	22	24JRSA4.5	4-1/2"	49	26
12JRSA60	6"	28	15	15JRSA60	6"	32	17	18JRSA60	6"	35	19	24JRSA60	6"	43	23

QUICK SHIP ITEM



1.38" Diameter Roller (JRS) Curves are compatible with straight sections, allowing flexibility on conveyor lines. Optional guard rail may be added for product protection.

- 4 Widths
- Steel or Aluminum Frames & Rollers
- Gravity Hooks & Studs Both Ends
- 45° and 90° Curves
- 36" Inside Radius

Curved Sections

Specifications

Width: 12", 15", 18" and 24" OAW

Frame: 2-1/2" deep x 1" flange x 12 ga. Galvanized Steel 0.112" extruded aluminum channel with bolt in cross braces.

Couplings: Hooks and studs on both ends of curve.

Rollers: 1-3/8" diameter x 18 gauge galvanized steel or .058 heat treated aluminum tubing. Oiled ball bearings both ends.

Axes: 1/4" dia. steel spring loaded for easy installation or removal, spaced on 1-1/2" or 3" equivalent centers.

Capacity: Same per foot capacity as straight sections.

OUTSIDE RADIUS	
Overall Width	Outside Radius
12"	48"
15"	51"
18"	54"
24"	60"

MODEL NUMBER EXAMPLE - 1.38" DIAMETER ROLLER CURVED						
12	36	JRS	G or A	S or A	1.5	90
OVERALL CONVEYOR WIDTH	INSIDE RADIUS	CONVEYOR SERIES	G = GALVANIZED STEEL FRAME A = ALUMINUM FRAME	S = STEEL ROLLER A = ALUMINUM ROLLER	ROLLER CENTERS	DEGREE OF CURVE

STEEL FRAME/STEEL ROLLER							
12" OVERALL WIDTH				15" OVERALL WIDTH			
MODEL #	DEGREE	ROLLER CENTERS	WEIGHT (LBS)	MODEL #	DEGREE	ROLLER CENTERS	WEIGHT (LBS)
1236JRSGS1.590	90	1-1/2"	56	1536JRSGS1.590	90	1-1/2"	66
1236JRSGS2.12590	90	3"	46	1536JRSGS2.12590	90	3"	53
1236JRSGS1.545	45	1-1/2"	29	1536JRSGS1.545	45	1-1/2"	34
1236JRSGS1.545	45	3"	24	1536JRSGS2.12545	45	3"	28
18" OVERALL WIDTH				24" OVERALL WIDTH			
MODEL #	DEGREE	ROLLER CENTERS	WEIGHT (LBS)	MODEL #	DEGREE	ROLLER CENTERS	WEIGHT (LBS)
1836JRSGS1.590	90	1-1/2"	76	2436JRSGS1.590	90	1-1/2"	96
1836JRSGS2.12590	90	3"	61	2436JRSGS2.12590	90	3"	76
1836JRSGS1.545	45	1-1/2"	39	2436JRSGS1.545	45	1-1/2"	49
1836JRSGS2.12545	45	3"	31	2436JRSGS2.12545	45	3"	39

ALUMINUM FRAME/ALUMINUM ROLLER							
12" OVERALL WIDTH				15" OVERALL WIDTH			
MODEL #	DEGREE	ROLLER CENTERS	WEIGHT (LBS)	MODEL #	DEGREE	ROLLER CENTERS	WEIGHT (LBS)
1236JRSA1.590	90	1-1/2"	32	1536JRSA1.590	90	1-1/2"	37
1236JRSA2.12590	90	3"	26	1536JRSA2.12590	90	3"	30
1236JRSA1.545	45	1-1/2"	17	1536JRSA1.545	45	1-1/2"	19
1236JRSA1.545	45	3"	14	1536JRSA2.12545	45	3"	16
18" OVERALL WIDTH				24" OVERALL WIDTH			
MODEL #	DEGREE	ROLLER CENTERS	WEIGHT (LBS)	MODEL #	DEGREE	ROLLER CENTERS	WEIGHT (LBS)
1836JRSA1.590	90	1-1/2"	42	2436JRSA1.590	90	1-1/2"	54
1836JRSA2.12590	90	3"	34	2436JRSA2.12590	90	3"	43
1836JRSA1.545	45	1-1/2"	22	2436JRSA1.545	45	1-1/2"	28
1836JRSA2.12545	45	3"	19	2436JRSA2.12545	45	3"	23

QUICK SHIP ITEM



1.9" Diameter Roller Gravity Conveyor

is used to convey medium weight packages in permanent installations.

- Rollers set high (for rollers set low, add angle guard rail)

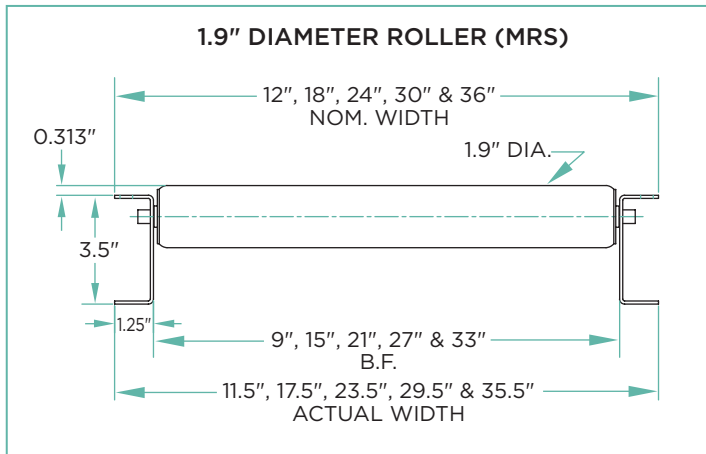

LOAD CAPACITY CHART - 1.9" DIAMETER ROLLER		
SUPPORT CENTERS	FRAME CAPACITY*	ROLLER CAPACITY MAXIMUM LOAD PER ROLLER
10 FT.	1000 LBS.	170 LBS.
5 FT.	4000 LBS.	

*Maximum uniformly distributed load

Straight Sections

Specifications

Width: 12", 18", 24", 30" and 36" nominal OAW. Actual OA Width is 1/2" less.

Frame: 3-1/2" deep x 1-1/4" flange x 12 gauge galvanized steel channel with bolt in cross braces

Couplings: Optional bolt-in butt couplers.

Lengths: 10 ft. and 5 ft. straight sections. Special lengths available.

Rollers: 1.9" diameter x 16 gauge galvanized steel tubing. Oiled ball bearings both ends.

Axes: 7/16" hex steel, spring loaded for easy installation or removal on 3", 4-1/2" or 6" centers.

Capacity: See Load Capacity Chart.

MODEL NUMBER EXAMPLE - 1.9" DIAMETER ROLLER STRAIGHT

12	MRS	G	4.5	x10
OVERALL CONVEYOR WIDTH	CONVEYOR SERIES	GALVANIZED STEEL FRAME AND ROLLERS	ROLLER CENTERS	CONVEYOR LENGTH

1.9" DIAMETER ROLLER (MRS)				
OVERALL WIDTH (NOMINAL)*	BETWEEN FRAME WIDTH	MODEL #	ROLLER CENTERS	WEIGHT (LBS) 10 FT.
12"	9"	12MRSG30	3"	114
		12MRSG4.5	4-1/2"	92
		12MRSG60	6"	80
18"	15"	18MRSG30	3"	155
		18MRSG4.5	4-1/2"	121
		18MRSG60	6"	102
24"	21"	24MRSG30	3"	196
		24MRSG4.5	4-1/2"	149
		24MRSG60	6"	124
30"	27"	30MRSG30	3"	231
		30MRSG4.5	4-1/2"	175
		30MRSG60	6"	144
36"	33"	36MRSG30	3"	278
		36MRSG4.5	4-1/2"	207
		36MRSG60	6"	164

*NOTE: Actual width is 1/2" less than nominal.

QUICK SHIP ITEM



1.9" Diameter Roller Gravity Conveyor (MRS) Curves are compatible with straight sections, allowing flexibility to conveyor lines. Optional guard rail may be added for product protection.

- 28-3/4" inside radius

Curved Sections

Specifications

Width: 12", 18", 24", 30" and 36" nominal OAW. Actual is 1/2" less.

Frame: 3-1/2" deep x 1-1/4" flange x 12 gauge galvanized steel channel with bolt in cross braces.

Couplings: Optional bolt-in butt couplers.

Curves: 90° and 45° with 28-3/4" inside radius.

Rollers: 1.9" diameter x 16 gauge galvanized steel tubing. Oiled ball bearings both ends.

Axles: 7/16" hex steel, spring loaded for easy installation or removal, spaced on 3" or 6" centers.

Capacity: Same per foot capacity as straight sections.

OUTSIDE RADIUS	
Overall Width	Outside Radius
12"	40-1/4"
18"	46-1/4"
24"	52-1/4"
30"	58-1/4"
36"	64-1/4"

MODEL NUMBER EXAMPLE - 1.9" DIAMETER ROLLER CURVED					
12	30	MRS	G	30	90
OVERALL CONVEYOR WIDTH	INSIDE RADIUS	CONVEYOR SERIES	GALVANIZED STEEL FRAME AND ROLLERS	ROLLER CENTERS	CONVEYOR LENGTH

1.9" DIAMETER ROLLER (MRS) CURVED					
OVERALL WIDTH (NOMINAL)*	BETWEEN FRAME WIDTH	MODEL #	DEGREE	ROLLER CENTERS	WEIGHT (LBS)
12"	9"	1230MRSG3090	90	3"	67
		1230MRSG6090		6"	49
		1230MRSG3045	45	3"	33
		1230MRSG6045		6"	24
18"	15"	1830MRSG3090	90	3"	90
		1830MRSG6090		6"	64
		1830MRSG3045	45	3"	46
		1830MRSG6045		6"	32
24"	21"	2430MRSG3090	90	3"	116
		2430MRSG6090		6"	79
		2430MRSG3045	45	3"	58
		2430MRSG6045		6"	40
30"	27"	3030MRSG3090	90	3"	134
		3030MRSG6090		6"	84
		3030MRSG3045	45	3"	68
		3030MRSG6045		6"	44
36"	33"	3630MRSG3090	90	3"	159
		3630MRSG6090		6"	103
		3630MRSG3045	45	3"	81
		3630MRSG6045		6"	53

*NOTE: Actual width is 1/2" less than nominal.

QUICK SHIP ITEM

Skatewheel Spurs are used to transfer product from one conveyor line to another. They may be used for merging or diverging applications.

- 4 Widths
- Right & Left Hand Assemblies
- Gravity Hooks & Studs One End
- 45° and 90° Spurs

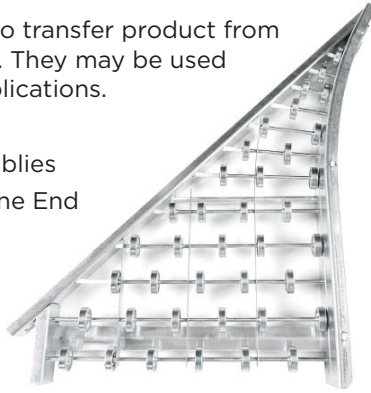

Specifications

Width: 12", 15", 18" and 24" OAW

Frame: 2-1/2" deep x 1" flange x 12 ga. Galvanized Steel with bolt in cross braces.

Couplings: Hooks and studs on one end, nesting channel on opposite end.

Spurs: 90° and 45° with 33" inside radius. Left or Right Hand, specify.

Wheels: 1-15/16" diameter with ball bearings in hardened raceway. Zinc plated steel.

Axles: 1/4" dia. steel, threaded one end with locknut, spaced on 3" equivalent centers. Spacers are zinc plated steel.

Capacity: Same per foot capacity as straight sections.

MODEL NUMBER EXAMPLE - SKATEWHEEL SPUR

12	33	SW	SP	12	90	R or L
OVERALL CONVEYOR WIDTH	INSIDE RADIUS	CONVEYOR SERIES	SPUR	WHEELS PER FOOT	DEGREE OF SPUR	RIGHT OR LEFT HAND

SKATEWHEEL SPURS

OVERALL WIDTH	90 DEGREE SPUR			45 DEGREE SPUR		
	MODEL#	WHEELS PER FOOT	WEIGHT (LBS)	MODEL #	WHEELS PER FOOT	WEIGHT (LBS)
12"	1233SWSP1290 (L or R)	12	30	1233SWSP1245 (L or R)	12	23
15"	1533SWSP1690 (L or R)	16	31	1533SWSP1645 (L or R)	16	24
18"	1833SWSP1890 (L or R)	18	37	1833SWSP1845 (L or R)	18	28
24"	2433SWSP2490 (L or R)	24	42	2433SWSP2445 (L or R)	24	32

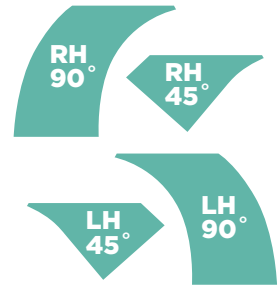

1.38" Diameter Gravity Roller Spurs

are used to transfer product from one conveyor line to another. They may be used for merging or diverging applications.

- 4 Widths
- Right & Left Hand Assemblies
- Gravity Hooks & Studs One End
- 45° and 90° Spurs



Specifications

Width: 12", 15", 18" and 24" OAW

Frame: 2-1/2" deep x 1" flange x 12 gauge galvanized steel channel with bolt in cross braces.

Couplings: Hooks and stud on one end, nesting channel on opposite end.

Spurs: 90° and 45° with 36" inside radius. Left or Right Hand, specify.

Rollers: 1-3/8" diameter x 18 gauge galvanized steel tubing. Oil ball bearings both ends.

Axles: 1/4" diameter steel, spring loaded for easy installation or removal, spaced on 3" equivalent centers.

Capacity: Same per foot capacity as straight sections.

MODEL NUMBER EXAMPLE - 1.38" DIAMETER ROLLER SPUR

12	36	JRS	SP	3	90	R or L
OVERALL CONVEYOR WIDTH	INSIDE RADIUS	CONVEYOR SERIES	SPUR	ROLLER CENTERS	DEGREE OF SPUR	RIGHT OR LEFT HAND

1.38" DIAMETER ROLLER SPURS (JRS)

OVERALL WIDTH	90 DEGREE SPUR			45 DEGREE SPUR		
	MODEL#	ROLLER CENTERS	WEIGHT (LBS)	MODEL #	ROLLER CENTERS	WEIGHT (LBS)
12"	1236JRSP2.1290 (L or R)	3"	45	1236JRSP2.1245 (L or R)	3"	30
15"	1536JRSP2.1290 (L or R)	3"	55	1536JRSP2.1245 (L or R)	3"	36
18"	1836JRSP2.1290 (L or R)	3"	66	1836JRSP2.1245 (L or R)	3"	42
24"	2436JRSP2.1290 (L or R)	3"	87	2436JRSP2.1245 (L or R)	3"	54



Gravity Gates are available for SW, JRS and MRS series conveyor. They provide a means for personnel or equipment to pass through your conveyor line. They are available in plain hinge (Type 1) or spring assisted (Type 2) versions. Type 2 gate springs are adjustable to provide minimal weight when lifting.

Type 2, spring assist gate shown

Manual Gate Type 1 & Spring Assisted Gate Type 2

For skatewheel (SW) conveyor & 1.38" diameter roller (JRS)

- 4 Widths - 12", 15", 18", 24" OAW
- 3 Ft., 4 ft. or 5 ft. lengths
- Steel or Aluminum frames, skatewheels and rollers
- 2-1/2" x 1" channel frame - 12 gauge galvanized steel or .112" extruded aluminum

For 1.9" diameter roller (MRS)

- 5 widths - 12", 18", 24", 30", 36" OAW
- 3 Ft., 4 ft. or 5 ft. lengths
- Galvanized steel frames and rollers
- 3-1/2" x 1-1/4" x 12 ga. galvanized steel frame



FOR USE WITH JRS & SW TYPE 1, MANUAL

OA CONVEYOR WIDTH	TYPE 1 GATE HINGE KIT	
	PART #	WEIGHT (LBS)
12", 15", 18", 24"	T1GJRS/SW	19

FOR USE WITH MRS TYPE 1, MANUAL

OA CONVEYOR WIDTH	TYPE 1 GATE HINGE KIT	
	PART #	WEIGHT (LBS)
12", 18", 24", 30", 36"	T1GMRS	20

FOR USE WITH JRS & SW TYPE 2, SPRING ASSIST

OA CONVEYOR WIDTH	TYPE 2 GATE HINGE KIT	
	PART #	WEIGHT (LBS)
12"	T2G12JRS/SW	39
15"	T2G15JRS/SW	41
18"	T2G18JRS/SW	42
24"	T2G24JRS/SW	45

FOR USE WITH MRS TYPE 2, SPRING ASSIST

OA CONVEYOR WIDTH	TYPE 2 GATE HINGE KIT	
	PART #	WEIGHT (LBS)
12"	T2G12MRS	40
18"	T2G18MRS	43
24"	T2G24MRS	46
30"	T2G30MRS	49
36"	T2G36MRS	52

NOTES: 1. Infeed section must be a minimum of 12" long and supports must be lagged to floor.
2. Gate part numbers are for hinge assemblies only and do not include conveyor section.

“H” Type Permanent Floor Supports - “CS” Series

For use with skatewheel (SW) or 1.38” diameter roller conveyor (JRS)

- Top bracket adjustable for pitch, boots for leveling with holes for lagging to floor.
- Formed 12 gauge galvanized steel construction.
- Supports shipped knocked down.
- Single leg outboard support for use on outside radius of 90° curves.

Note: Add 2-3/4” to support height for top of conveyor height.

“H” TYPE PERMANENT FLOOR SUPPORTS - “CS” SERIES										
SUPPORT MODEL #	SUPPORT HEIGHT		WEIGHT (LBS) OA CONVEYOR WIDTH					OUTBOARD SUPPORT MODEL #	WEIGHT (LBS)	
	MIN.	MAX.	12”	15”	18”	24”	30”			
CS511	5”	11”	6.4	6.4	6.4	6.4	6.4	SCS511	3.2	
CS1115	11”	15”	9.7	10	10.3	11	11.6	SCS1115	3.7	
CS1523	15”	23”	12.1	12.5	12.8	13.4	14.1	SCS1523	4.9	
CS2338	23”	38”	17.1	17.5	17.8	18.4	19	SCS2338	7.4	
CS3853	38”	53”	22.2	22.9	23.5	24.8	26.1	SCS3853	9.2	
CS5368	53”	68”	25.8	26.5	27.1	28.4	29.7	SCS5368	11	



Single leg outboard

MODEL NUMBER - CS SERIES SUPPORT		
CS	2338	12
SUPPORT SERIES	HEIGHT ADJUSTMENT	OA CONVEYOR WIDTH

“H” Type Permanent Floor Supports - “MCS” Series

For use with 1.9” diameter roller conveyor (MRS)

- Top bracket adjustable for pitch, boots for leveling with holes for lagging to floor.
- Formed 12 gauge galvanized steel construction.
- Supports shipped knocked down.
- Single leg outboard support for use on outside radius of 90° curves.

Note: Add 3-3/4” to support height for top of conveyor height.

“H” TYPE PERMANENT FLOOR SUPPORTS - “MCS” SERIES										
SUPPORT MODEL #	SUPPORT HEIGHT		WEIGHT (LBS) OA CONVEYOR WIDTH					OUTBOARD SUPPORT MODEL #	WEIGHT (LBS)	
	MIN.	MAX.	12”	18”	24”	30”	36”			
CS511	5”	11”	6.4	6.4	6.4	6.4	6.4	SCS511	3.2	
MCS1115	11”	15”	9.7	10.3	11	11.6	12.2	SCS1115	3.7	
MCS1523	15”	23”	12.1	12.8	13.4	14.1	14.7	SCS1523	4.9	
MCS2338	23”	38”	17.1	17.8	18.4	19	19.7	SCS2338	7.4	
MCS3853	38”	53”	22.2	23.5	24.8	26.1	27.3	SCS3853	9.2	
MCS5368	53”	68”	25.8	27.1	28.4	29.7	31	SCS5368	11	



MODEL NUMBER - MCS SERIES SUPPORT		
MCS	2338	12
SUPPORT SERIES	HEIGHT ADJUSTMENT	OA CONVEYOR WIDTH



Caster option
Contact factory

Portable Tripod Supports

For use with skatewheel (SW) or 1.38” diameter roller conveyor (JRS)

- Welded tubular construction with hand key adjustment locking.

Note: Add 2” to support height for top of conveyor height.

Option: Portable support available with 3” diameter swivel casters with wheel brake. (Adds 4” to support height)

PORTABLE TRIPOD SUPPORTS				
MODEL #	WIDTH	SUPPORT		WEIGHT (LBS)
		MIN.	MAX.	
T142412	12”	14”	24”	6
T244212	12”	24”	42”	11
T305012	12”	30”	50”	11
T427812	12”	42”	78”	17
T142415	15”	14”	24”	6
T244215	15”	24”	42”	11
T305015	15”	30”	50”	12
T427815	15”	42”	78”	17
T142418	18”	14”	24”	7
T244218	18”	24”	42”	11
T305018	18”	30”	50”	12
T427818	18”	42”	78”	17
T142424	24”	14”	24”	7
T244224	24”	24”	42”	11
T305024	24”	30”	50”	12
T427824	23”	42”	78”	17



MODEL NUMBER - PORTABLE TRIPOD SUPPORT		
T	3050	12
SUPPORT SERIES	HEIGHT ADJUSTMENT	OA CONVEYOR WIDTH

QUICK SHIP ITEM

PACKAGE STOP

OA CONVEYOR WIDTH	"A" WIDTH	MODEL #
12"	9-1/2"	12SSG
15"	12-1/2"	15SSG
18"	15-1/2"	18SSG
24"	21-1/2"	24SSG

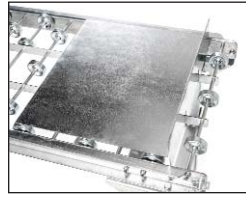

Stops

Package Stop

"Dead" type package stops are simply placed on skatewheel (SW) or 1.38" (JRS) conveyor sections. NOTE: Not for use with JRS series conveyor with rollers on 1-1/2" centers.

SW/JRS ANGLE STOP

OA CONVEYOR WIDTH	ANGLE SIZE	MODEL #
12"	1-1/4" X 1-1/4"	12FAES-JRS
15"	X 10 GAUGE	15FAES-JRS
18"	GALV. STEEL	18FAES-JRS
24"		24FAES-JRS



Fixed Angle End Stop

Angle end stop mounts to end of conveyor and bolts to top flange of conveyor side channels. Available in all standard conveyor widths.

MRS ANGLE STOP

OA CONVEYOR WIDTH	ANGLE SIZE	MODEL #
12"		12FAES-MRS
18"	1-1/4" X 1-1/4"	18FAES-MRS
24"	X 10 GAUGE	24FAES-MRS
30"	GALV. STEEL	30FAES-MRS
36"		36FAES-MRS



Roller Stop

Roller stops allow for loads to be supported while pulling product from end of conveyor section

Model # RRSTOPJRS for SW and JRS series conveyor

Model # RRSTOPMRS for MRS series conveyor

Note: kit uses a roller from conveyor section

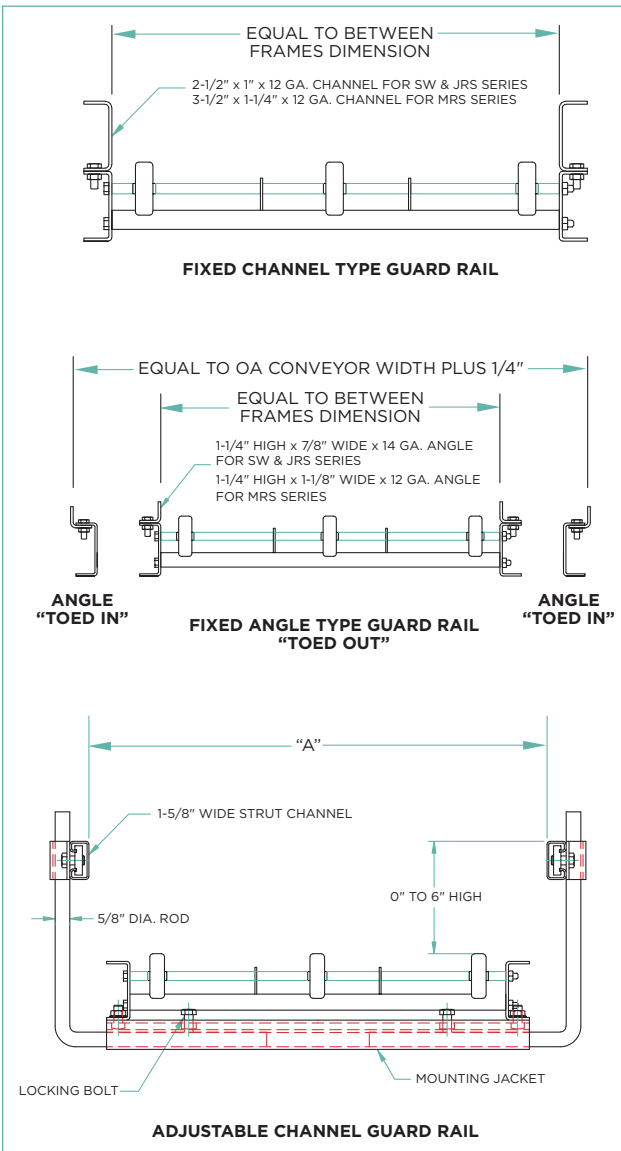

Guard Rail

For use with SW, JRS and MRS series conveyor

- All guard rail available for straight and curved sections.
- All guard rail available for one or both sides
- All guard rail is shipped loose for field mounting
- Fixed angle guard can be toed in or out



Adjustable Guard Rail



Fixed Angle Guard Rail

To order guard rail, please consult the factory.

INSIDE CLEARANCE RANGE FOR ADJUSTABLE GUARD RAIL			
OA WIDTH SW/JRS	"A" ADJUSTMENT	OA WIDTH MRS	"A" ADJUSTMENT
12"	11-1/2" TO 17-1/2"	12" (11-1/2" ACTUAL)	11" TO 18"
15"	14-1/2" TO 20-1/2"	18" (17-1/2" ACTUAL)	17" TO 29"
18"	17-1/2" TO 29-1/2"	24" (23-1/2" ACTUAL)	23" TO 35"
24"	23-1/2" TO 35-1/2"	30" (29-1/2" ACTUAL)	29" TO 41"
		36" (35-1/2" ACTUAL)	35" TO 47"

NOTE: If using fixed angle or channel style guard rail with a fixed angle end stop, order the guard rail 1-1/4" shorter per end stop.

72 HOUR GRAVITY CONVEYOR

QUICKSHIP

AVAILABLE FOR SELECTED SIZES OF:

- 1.38" Diameter Roller (JRS)
- 1.9" Diameter Roller (MRS)
- Skatewheel (SW)
- Supports

Look for the  inside

CUSTOM CAPABILITY

UNEX has the ability to provide custom variations of our products.

Special lengths, widths, roller centers, wheel patterns or modified standards can be provided to meet requirements of your particular applications.

Contact the UNEX factory for more information or to discuss specific needs.

Pick **Smarter.**
Pick **Better.**
Pick **UNEX.**

unex.com



UNEX MANUFACTURING, INC.
50 Progress Place, Jackson, NJ 08527

800.695.SPAN (7726)

732-928-2800 • fax: 732-928-2828 • e-mail: span@unex.com

