



AMBIENT ROUND FRONT MERCHANDISER (ARF)



A10107

COVERS MODELS:

**3133
3133A
3134
3134A
3135
3135A**

**Service
and
Parts
Manual**

Table of Contents

SERVICE

| | |
|---|----|
| SPECIFICATIONS | 2 |
| INTRODUCTION | 3 |
| UNPACKING | 4 |
| INSTALLATION | 5 |
| LOADING PRODUCTS | 6 |
| CHANGING AUGER TIMING, TRAY SPACING & TRAY CONFIGURATION | 9 |
| CONTROLLER FUNCTIONS | 12 |
| CARE & CLEANING | 27 |
| BEFORE CALLING FOR SERVICE | 27 |
| SCHEMATIC | 28 |

PARTS

| | |
|---------------------------|----|
| PARTS MANUAL | 30 |
| GENERAL INFORMATION | 31 |

Record the Model Number and Serial Number of your machine below.

The Model and Serial numbers are needed for you to obtain quick service and parts information for your machine. The numbers are given on the identification plate located on the back side of the cabinet of the machine.

MODEL NUMBER: _____

MODEL NUMBER: _____

SPECIFICATIONS

This Manual covers the following models:

| | MODEL NUMBERS | |
|--------|---------------|---------|
| | 115 VAC | 230 VAC |
| 3-Wide | 3133 | 3133A |
| 4-Wide | 3134 | 3134A |
| 5-Wide | 3135 | 3135A |

SPEC1

Physical Dimensions

| | WIDTH | | DEPTH | | HEIGHT | | WEIGHT | |
|--------|---------|-----|--------|----|--------|-----|--------|-----|
| | Inches | Cm | Inches | Cm | Inches | Cm | Pounds | Kg |
| 3-Wide | 29-5/16 | 74 | 35-1/2 | 87 | 72 | 183 | 501 | 227 |
| 4-Wide | 35-3/16 | 89 | 35-1/2 | 87 | 72 | 183 | 572 | 260 |
| 5-Wide | 41 | 104 | 35-1/2 | 87 | 72 | 183 | 702 | 318 |

SPEC2

Electrical

230 Volt AC, 50 Hz, 3.75 Amps or

115 Volt AC, 60 Hz, 7.5 Amps

Factory Configuration

| | NO. OF SELECTIONS | EXPANDABLE TO |
|--------|-------------------|---------------|
| 3-Wide | 24 | 36 |
| 4-Wide | 36 | 48 |
| 5-Wide | 40 | 60 |

SPEC3

Coinage

MDB version: any MDB peripheral device

INTRODUCTION

This manual contains instructions, service and installation guidelines for the Ambient Round Front Merchandiser Series product line.

All Round Front models are equipped with an electronic control system. Programming of the vend functions, pricing and features is done through the control system. Programming changes can be made without any additional accessories or remote parts.

Selections can be priced individually from \$.05 to \$99.95 in five cent increments (U.S. currency). When adapted to accept international or foreign currency, the maximum vend price will be 255 times the smallest denomination of coin being accepted.

Records for cash accountability, total cash transactions and total vend cycles are maintained. Data for individual selections, complete rows or total machine can be compiled and used for inventory and ordering.

Each selection has an individual motor. Functional selections continue to operate if other motors become nonfunctional. Electrical malfunctions are recorded and displayed when the machine is placed in the *Service Mode*. Non-functional motors are specified.

The vending sequence is “first-in, first-out” for each selection, eliminating the need for stock rotation to maintain fresh products in the vend area.

Each Glass Front vendor is capable of supporting a “satellite” vending machine, such as a Can Vendor or Food Merchandiser (Menu Mart II). The satellite vendor uses the Glass Front Vendor’s controller, coin mechanism, bill validator and keypad to perform the vend functions it requires. For details on the satellite vendor refer to the Service Manual for the specific vendor.

This manual should be read thoroughly to familiarize yourself with the functions of all components, along with the features that are available. The initial set-up of a vending machine is a very important step of insuring that the equipment operates in a trouble-free manner. Following the instructions at the initial installation of the machine will avoid service problems and minimize set-up time.

Should you have any questions pertaining to information in the manual, replacement parts or the operation of the vendor you should contact your local distributor or:

VendNet™
165 North 10th Street
Waukee, Iowa 50263 – USA
Phone: (515)-274-3641
Parts Fax: (515)-987-4447
Sales Fax: (515)-274-0390
E-Mail: VendNet@vendnet.com

UNPACKING

This machine was thoroughly inspected before leaving the factory and the delivering carrier has accepted this vendor as their responsibility. Note any damage or irregularities at the time of delivery and report them to the carrier. Request a written inspection report from the claims inspector to file any claim for damage. File the claim with the carrier (not the manufacturer) within 15 days after receipt of the machine.

Carefully remove the outside packing material so as not to damage the finish or exterior of the machine. Inspect the machine for concealed shipping damage. Report any damage hidden by the shipping material directly to the delivering carrier on a hidden damage report.

Record the model number and serial number of the vendor for your records. These numbers are given on the Serial Plate on the rear of the cabinet and/or inside the vendor. Refer to these numbers on all correspondence and inquiries pertaining to this vendor.

Remove the “Knock-A-Way” Support:

Place a 2x6 board under the vendor.

Split the Knock-A-Way support in two. Insert a screwdriver or prying tool into the groove.

Turn the leveling screws in as far as possible. See Figure 1.

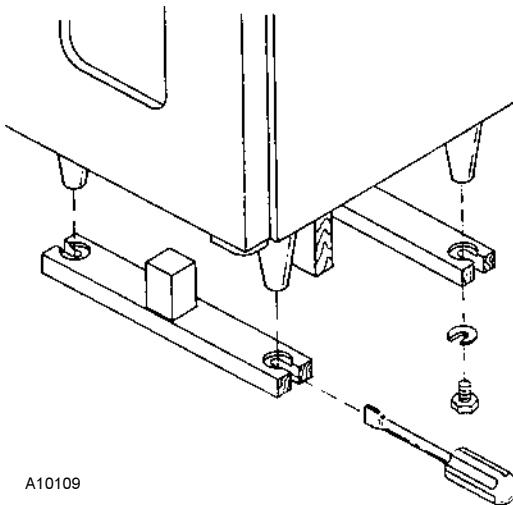

Figure 1. Removing the Knock-A-Way Support

INSTALLATION

Position the vendor no more than nine feet from the power outlet or receptacle and check that the door will open fully without interference. Leave at least six (6) inches of space between the back of the machine and any wall or obstruction for proper air circulation. Level the vendor, making sure all levelers are touching the floor. The vendor must be level for proper operation and acceptance of coins through the coin mechanism.

Retrieve the keys to the vendor from the coin return cup. Open outer door and remove all internal packing material.

Consult local, state and federal codes and regulations before installation of the vendor.

Grounding (Earthing) & Electrical

See Electrical Specifications for details.

Before connecting the vendor, the integrity of the main electrical supply must be checked for correct polarity, presence of ground (earth) and correct voltage. These checks should be repeated at 6-month intervals with the routine safety electrical testing of the vendor itself.

To verify that the receptacle is properly grounded and polarized, insert one probe of a Multi-Meter (set to check AC line voltage) or a test light in the ground terminal (hole) and the other probe into the hot terminal of the outlet.

If the receptacle is not properly grounded or polarized, you should contact a licensed electrician to correctly polarize and/or ground the receptacle to ensure safe operation.

A noise suppresser has been installed in this machine to compensate for any mains signal noise that could interfere with the normal operation of the controller.

WARNING:

**Extension cords cause problems.
DO NOT USE EXTENSION CORDS!**

For proper operation of any equipment utilizing electronically controlled components, the equipment should be placed on an isolated or dedicated noise-free circuit, properly polarized and grounded.

Shown in figure 2 and Figure 3 are two properly grounded and polarized outlets. Figure 2 shows two 230VAC outlets. Figure 3 shows a 115VAC, three-wire outlet.

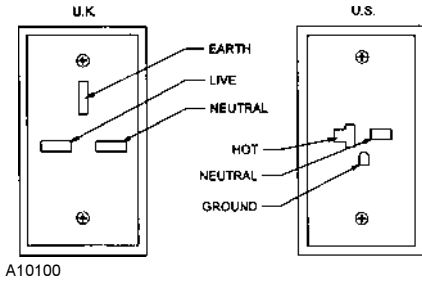

Figure 2. 230 VAC Outlets

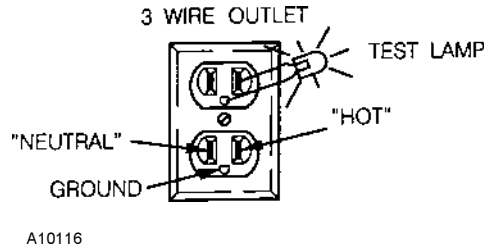

Figure 3. 115VAC Outlet

LOADING PRODUCTS

To load products, lift the tray slightly and pull forward until the tray stops. The upper-most trays tilt for easier loading.

Load products from front to back, making sure all items fit freely between the augers. Do not attempt to force oversize items or packages into the spaces. Do not skip a space. Place the product on the bottom of the compartment on the product augers, with the label facing the front of the machine for easy identification by the customer. See Figure 4.

When finished loading each tray, return the tray to its proper standby position. All trays must be pushed to the rear of the cabinet and properly seated in the "detent" position.

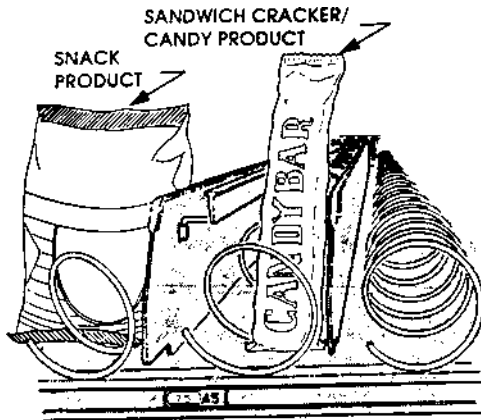

Figure 4. Loading Example

To vend properly, the size of the item being vended must be larger than the diameter of the auger being used. Undersize items could cause vend problems. If the product does not fit the auger properly, use a differently pitched auger. See Table 1 for augers available from your distributor or service entity.

Table 1. Available Augers

| PRODUCT SIZE | | | AUGER PART N |
|--------------|---------|-----|--------------|
| WIDTH " | THICK " | QTY | |
| CANDY | | | |
| 2-3/4 | 1-3/16 | 15 | 4200272-000 |
| 2-3/4 | 15/16 | 18 | 4200272-001 |
| 2-3/4 | 21/32 | 24 | 4200272-002 |
| 2-3/4 | 1/2 | 30 | 4200272-003 |
| 2-3/4 | 1-1/2 | 12 | 4200272-004 |
| 2-3/4 | 2-1/32 | 9 | 4200272-005 |
| 2-3/4 | 3-3/32 | 6 | 4200272-006 |
| SNACK | | | |
| 5-1/2 | 1-13/16 | 10 | 4200272-007 |
| 5-1/2 | 1-1/2 | 12 | 4200272-008 |
| 5-1/2 | 1-13/16 | 15 | 4200272-009 |
| 5-1/2 | 2-11/16 | 7 | 4200272-010 |
| 5-1/2 | 2-5/8 | 8 | 4200272-011 |

Scroll Locks (3 & 4-wide trays only)

Rubber scroll locks are included in the service packet and are used to lock the price scrolls in place so they will not move due to tray vibrations etc. Set the price to where needed and insert the scroll lock into the small hole beside the scroll port. See Figure 5.

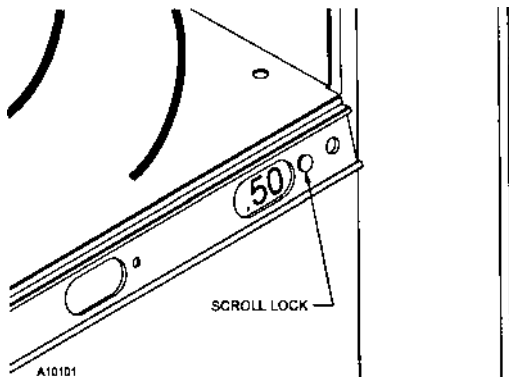

Figure 5. Scroll Locks

Product Ejectors

Product ejectors can be added to the end of the augers to assist the product out of the tray area (see figure 6). They can also be moved on the auger to adjust timing. Order P/N 4025748.

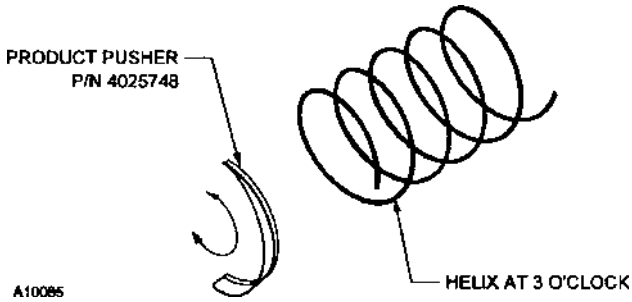

Figure 6. Product Ejectors

PRICE LABELS (5-wide tray only)

The 5-wide tray utilizes price labels for each selection. The tray label has selections A1 thru A0 etc. showing on the front rail. When a snack selection is configured in a tray, slide the price label over to cover the selection label (usually an even numbered selection). See Figure 7.

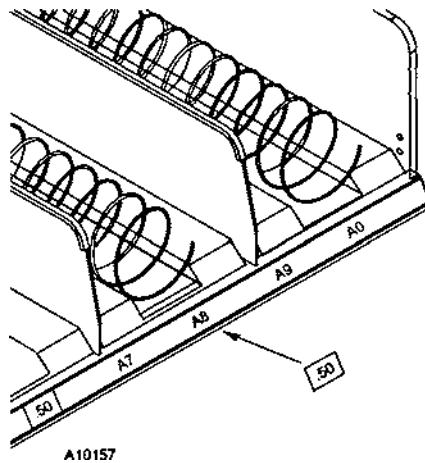

Figure 7. Price Labels

CHANGING AUGER TIMING, TRAY SPACING & TRAY CONFIGURATION

By re-timing the augers, difficult-to-vend items can be dispensed more dependably. By altering tray spacing, larger items can be vended. By changing the tray configuration, different product mixes can be accommodated.

Auger Timing

Each auger can be rotated in 20-degree increments for a different drop-off point. Most items can be vended successfully when the auger end is positioned at 6 o'clock.

To change the auger end position:

1. Remove the motor cover.
2. Raise the motor slightly and pull forward on the auger until it separates from the motor. See Figure 8.
3. Rotate the auger to the desired position and re-insert the auger coupling into the motor.
4. Make sure the auger coupling is seated over the vertical rail or retaining rib on the tray.
5. Replace the motor cover making sure it is securely tightened.

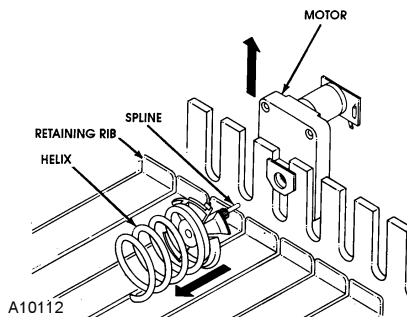

Figure 8. Retiming an Auger

Tray Configuration

Candy to Snack

1. Order the conversion kit from your local distributor or service entity.
2. Unplug and remove the tray assembly from the vendor. Place the tray harness in the tray before removal.
3. Remove the motor cover and retain any hardware.

4. Remove existing tray divider and store for possible future use.
5. Remove existing auger assemblies and store for possible future use.
6. Remove the existing “even” numbered motor. This motor will not be needed.
7. Dress terminals removed from the motor around the tray harness and tape in place.
8. Move the “odd” numbered motor to the center slot of the compartment.
9. Install the auger retainer furnished as part of the conversion kit.
10. Install auger assembly furnished as part of the conversion kit, making sure the motor coupling properly engages the motor and is securely snapped over the vertical rail or retaining rib on the tray.
11. Re-assemble the motor cover removed in step 3.
12. Replace the tray assembly into the vendor making sure that the tray is properly located and latched and connect the tray harness
13. Set the selection to the desired vend price and adjust the price scroll (3 & 4 wide) or price label (5-Wide) to agree.
14. Test vend the converted selections for proper operation and price settings.

NOTE:

| |
|---|
| In large item selections, the selection numbers will be the “odd” numbers. For example, selections C3 and C4 are converted to a single selection, C3. |
|---|

Snack to Candy

1. Order the conversion kit from your local distributor or service entity.
2. Unplug and remove the tray assembly from the vendor. Place the tray harness in the tray before removal.
3. Remove the motor cover and retain any hardware.
4. Remove the existing auger assembly and store for possible future use.
5. Remove the auger retainer and store for possible future use.
6. Move motor from the center slot to the left slot in the compartment.
7. Add the new motor furnished as part of the conversion kit in the right hand slot of the compartment.
8. Properly wire the motor and switch. (Refer to the Schematic section for wire colors and locations).
9. Add the divider furnished as part of the conversion kit.
10. Install new auger assemblies furnished as part of the conversion kit, making sure the motor couplings properly engage with the motor and are securely snapped over the vertical rail or retaining rib on the tray.
11. Re-assemble the motor cover removed in step 2.
12. Replace the tray assembly into the vendor making sure that the tray is properly located and latched and connect the tray harness.
13. Set the selections to the desired vend price and adjust the price scrolls (3 & 4 wide) or price label (5-Wide) to agree.
14. Test vend the converted selections for proper operation and price settings.

Tray Spacing

The trays can be raised or lowered in one-inch (2.5 cm) increments to provide additional headroom for vending taller items.

NOTE

When increasing the headroom between two trays, a corresponding decrease in headroom of an adjoining tray will result.

1. To change the vertical tray spacing, follow these steps:
2. Pull out the tray to be adjusted until it stops.
3. Disengage the tray harness from its snap-open harness clamp on the right-hand wall.
4. Disconnect the tray plug from its receptacle on the right sidewall.
5. Lift up on the front of the tray and pull slightly forward (approximately 1/2 inch/ 1.25 cm) to clear the tray stop.
6. Pull tray out until it tilts down. Lift the rear of the tray and remove it from the vendor.
7. Disengage both left and right tray rails from their slots on the sidewalls. Pull inward on the bottom of each rail and pull its flange out of the slot. Pull each rail forward to disengage its rear tab from the hole in the rear wall. See Figure 9.
8. Relocate both left and right rails by reversing step 7.

NOTE

Rails must be level front to back and right to left.

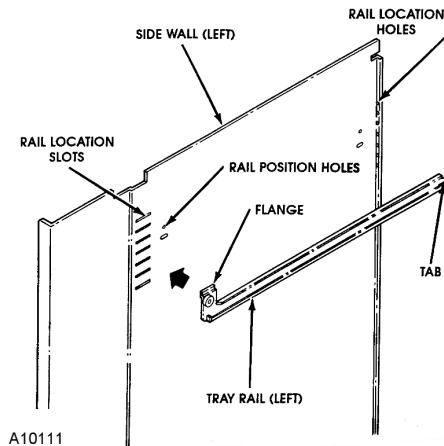

Figure 9. Removing a Tray Rail

9. Replace the tray by placing its rear rollers on the left and right rails and lifting up slightly on the front of the tray as you push it back until the tray latches in its detent position.
10. Plug the tray harness into its receptacle on the right side wall.
11. Re-engage the tray harness into its harness clamp and snap the clamp closed.
12. Test vend the tray in its new position to assure that the tray plug is properly seated.

CONTROLLER FUNCTIONS

Sales Mode

The *Sales Mode* is the normal operating mode of the vendor. While in the *Sales Mode* the following messages may display:

The scrolling Point of Sales (POS) message displays only if the coin mechanism has an adequate supply of coins in the change tubes.

The POS message is a programmable, 100-character message used to encourage a purchase.

The *EXACT CHANGE ONLY* message displays if the level of coins in the change tubes is below the low-level sensors.

When the change tubes are low, this message takes priority.

The *DISCOUNT AVAILABLE NOW* message displays when the *Discount Mode* is activated. Refer to Discount Mode section for instructions.

Service Mode

Use the *Service Mode* to alter programming, establish a new program, and retrieve diagnostic information.

In the *Service Mode* the function of the keys depends on the specific mode. Furnished in the Service Packet is a keypad overlay indicating the functions of keys while in the *Service Mode*.

To place the controller in the *Service Mode*, press the Service Mode Button on the control board. See Figure 10.

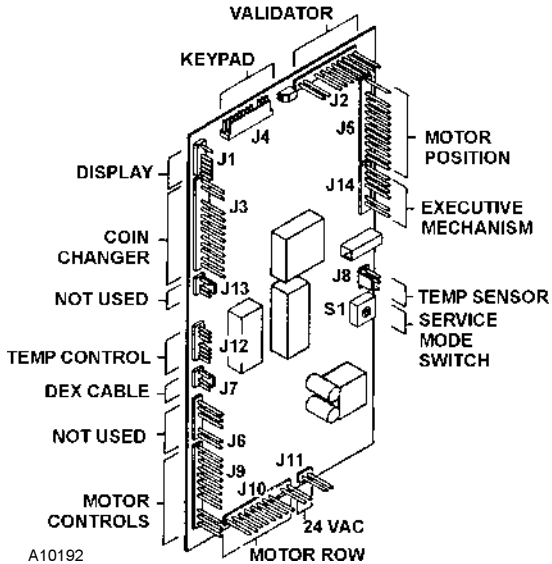

Figure 10. Service Mode Button Location

Error Messages

Each time the controller is placed in the *Service Mode*, the battery-backed-up RAM is checked and the motor circuits are scanned to determine the number of active (operational) motors.

Immediately write down any errors that display. All errors must be cleared before any changes can be made to the programming.

Possible error messages:

BATTERY BACKED RAM FAILURE displays if the system is unable to access the battery-backed-up RAM. Call your service entity or distributor for more information.

MOTOR= XX indicates jammed motors. The flagged motors were functional when the *Sales Mode* was last activated, but, due to failures or removal, are not in the circuit now.

If no motor numbers are displayed when the controller is placed into the *Service Mode*, no electrical problems with motors were detected since last entering the *Service Mode*.

TO CLEAR THE CONTROLLER OF ERRORS

Press key [A], then [C], then [K]. If defective motors were indicated, those motors must also be run successfully from the Test Vend mode of the *Service Mode* before the controller will recognize them as functional.

Service Mode – Low Level

Upon entering the *Service Mode* you are in the Low Level and can access the following modes: See Table 2.

To exit back to the *Sales Mode*, press [L] twice, or press the Service Mode Button once.

If no keypad input is detected after approximately 25 seconds, the *Service Mode* is exited automatically.

Table 2. Low Level Service Modes

| Press | To Access Mode |
|-------|------------------------|
| [1] | Dispense Coins |
| [2] | Display Motor Count |
| [3] | Alternate POS Message |
| [4] | Non-Resettable MIS |
| [5] | Set Price |
| [6] | Set Time |
| [7] | Enter High Level |
| [8] | Test Vend by Selection |
| [9] | Test Vend by Row |
| [0] | Test Vend Machine |

COIN DISPENSE MODE

In this mode coins stored in the coin mechanism change tubes can be removed.

To access the Coin Dispense Mode:

- 1 In the *Service Mode*, press key [1]. *DISPENSE COINS* displays.
- 2 Press [A]. The smallest denomination change tube is activated.
- 3 Press [B]. The second-smallest denomination change tube is activated.
- 4 Press [C]. The second-largest denomination change tube is activated.
- 5 Press [D]. The largest denomination change tube is activated.

Pressing a key once will pay out one coin. Pressing and holding a key will continuously pay out coins.

NOTE

If a coin mechanism does not use a certain coin tube, as may be the case of Coinco L+ International coin mechanisms, there will be no activity when the corresponding key is pressed.

Pressing any key other than **[A]**, **[B]**, **[C]** or **[D]**, will exit back into the *Service Mode*. To exit back to the *Sales Mode*, press **[L]** twice, or press the Service Mode Button once.

Tube Fill Mode

When an MDB coin mechanism is used, the coin change tubes must be filled via the coin mechanism so the controller records the exact number of coins in each coin tube.

To enter the Tube Fill Mode:

- 1 In the *Service Mode*, press **[1]**. *DISPENSE COINS* displays.
- 2 Press **[F]**.

Deposit the coins into the coin mechanism. They are recorded in the memory. Total cash and total vend records are not affected.

MOTOR COUNT MODE

This mode displays the total number of functional motors, which should be the same as the total number of selections in the machine. Individual selection numbers are not displayed.

To enter the *Motor Count Mode*, in the *Service Mode*, press key **[2]**. The number of functional motors displays briefly in the format *MOTORS XXX*.

EXAMPLE

If there are 24 functional motors, *MOTORS 024* displays.

If the motor count displayed is not equal to the total number of selections in the machine, the electrical circuit of all motors is not complete. To determine what motor(s) are not functioning:

Test vend all selections by pressing the Service Mode Button and pressing the **[0]** key. Refer to the Troubleshooting Flowcharts of this manual for further assistance.

To exit back to the *Sales Mode*, press the **[L]** key twice, or press the Service Mode Button once.

ALTERNATE POS MESSAGE MODE

In this mode, the scrolling message that is displayed while the machine is in the *Sales Mode* can be altered to include the *EXACT CHANGE ONLY* message.

To access the Alternate POS Message Mode:

- 1 In the *Service Mode*, press [3]. *POS/CORRECT CHANGE ALTERNATE, 1=ALTERNATE ON, 0=ALTERNATE OFF* displays followed by the current status (*ALT OFF* or *ALT ON*).
- 2 To change the status, press the corresponding key ([1] or [0]) and then press [L] to save.
- 3 To leave the status unchanged, press [L].

NOTE

To change the status, wait for the status to display before pressing a key.

NON-RESETTABLE TOTALS MODE

The total vends and total cash count are displayed for individual selections, entire rows, or the entire machine. This information can not be reset to zero.

To enter the Non-Resettable Totals Mode:

- 1 In the *Service Mode*, press [4]. *NON-RESETTABLE TOTALS* displays followed by *??=SEL*.
- 2 To display totals for an individual selection press the letter, then the number of the selection, such as [A] [1] for item A1.
- 3 To display totals for an entire row press the row letter twice, such as [A] [A]. for row A.
- 4 To display totals for the entire machine press [A] [4].

The total number of vends displays, followed by the total cash value for the specified item(s).

SET PRICE MODE

A vend price must be set for each selection. On items that will be vended at the same vend price, the Copy Price option can be used to duplicate the vend prices.

Make sure the price scrolls on the product shelves agree with the vend prices set, and that the selection labels are properly located below the items they identify.

NOTE

The "\$" sign is only displayed with the vend price when a U. S. coin mechanism is used.

To set vend prices:

- 1 In the *Service Mode*, press [5]. *SET PRICE-ENTER SELECTION* displays followed by *??=SEL*.
- 2 Enter the selection letter and number of the item to be priced. *XX \$44.ZZ* displays, with the most significant digit of the price flashing.

EXAMPLE

If you are pricing selection A1 and the current price is fifty cents, *AI \$00.50* displays, with the first zero flashing.

- 3 To leave the price unchanged, press [J]
- 4 To change the price, enter the four digits.

EXAMPLE

If the numbers 0, 1, 2 and 5 were pressed, that item would have a vend price of \$1.25.

- 5 Press [J] to save the new price,
- 6 Press [C] to copy the price to another selection (see the Copy Price Option section below), or
- 7 Press [L] to exit back to the *Service Mode* without saving the changed price.

Once a selection price is saved, *??=SEL* displays, enabling you to continue pricing other selections by repeating steps 3 & 4.

Copy Price Option

To copy the price of a selection to other selections, press [C] in Step 5, above. *COPY PRICE* displays briefly, followed by *??*.

Identify the selection to which you want the price copied. The selection number and the price displays briefly for verification.

To exit back to the *Sales Mode*, press [L] twice, or press the Service Mode Button once.

Verifying Vend Prices

In the *Sales Mode*, identify the selection. The current vend price displays briefly.

When the controller is in the *Discount Mode* and a time interval has been activated, the discounted price displays.

If that motor has been recorded as faulty or has been removed, *SELECT OTHER ITEM* displays, indicating that the selection is not functional.

TIME PROGRAMMING MODE

Use this function with the *Discount Mode* to set the correct time of day. If desired, the time of day can be displayed along with the POS message.

To set the correct time:

1. In the *Service Mode*, press key [6]. *TO SET CLOCK ENTER 'J'* displays continuously.
2. Press [J] The current time displays in the format *TIME XX:XX*, with the most significant digit flashing. The time is displayed in the 24-hour (military) format.

EXAMPLE

4:23 P.M. displays as *1623*. 8:30 P.M. displays as *2030*.

3. Enter the correct time, then press [J] to save the time, or press [L] to exit without saving the time.

To display the time during the *Sales Mode*, refer to the “Edit POS Message Mode” section of this manual.

To exit back to the *Sales Mode*, press [L] twice, or press the Service Mode Button once.

TEST VEND MODES

CAUTION:

Because this vendor utilizes DC motors, do not attempt to turn the helix manually or damage to the motor could occur.

The machine can be tested by individual selections, a complete row, or all selections in the entire machine.

The *Test Vend Modes* do not affect the total vends and total cash counts.

Use these modes to identify any faulty motors or motor circuits and, when used in tandem with the “Troubleshooting Flowcharts”, to quickly identify problem areas.

The controller will check the motor circuit and, if the circuit is complete and the motor is functional, run the selection through one complete vend cycle.

TEST VEND SINGLE SELECTION

To test vend a single selection:

1. In the Service Mode, press [8]. *TEST VEND-ENTER SELECTION* displays, followed by *?? = SEL*.
2. Identify the selection to be tested. If the motor is functional, it will run one complete cycle and the selection number and price of the motor being tested will display during the motor run.

If the test vend is successfully completed, *??= SEL* displays.

If the test vend is unsuccessful, *UNATTENDED* displays.

To test vend another selection, repeat step 2.

To exit back to the *Sales Mode*, press [L] twice, or press the Service Mode Button once.

TEST VEND COMPLETE ROW

You must watch the testing to verify the operation, as any motor(s) not sensed on the motor circuit prior to beginning the row test are skipped. If no motors are sensed when the test sequence starts, the controller will immediately return to the *Service Mode*.

To test vend a complete row of motors:

1. In the *Service Mode*, press key [**9**]. *TEST VEND - ENTER ROW* displays followed by *? = ROW*.
2. Press the letter of the row to test. Beginning with the first motor of that row, each motor runs in sequence. The selection number and the price display in the format *XX=SEL*. When all motors have been tested, the program returns to the *Service Mode*.

The row test may be stopped at any time by pressing and holding any key.

To test vend another row, repeat steps 2 and 3.

NOTE

A motor that will not function properly due to a fault or a bad connection will be skipped by the test procedure.

To exit back to the *Sales Mode*, press [**L**] twice, or press the Service Mode Button once.

TEST VEND COMPLETE MACHINE

You must watch the testing to verify the operation, as the controller will skip any motor(s) that is not sensed on the motor circuit prior to beginning the row test. If no motors are sensed when the test sequence starts, the controller will automatically return to the *Service Mode*.

To test vend the machine:

1. In the *Service Mode*, press key [**0**]. *PRESS THE 'J' KEY TO VEND ENTIRE MACHINE* displays.
2. Press [**J**] to start the test vend sequence. Beginning with the first motor of the first row, each motor runs in sequence. The selection number and vend price displays in the format *XX = SEL*. Once all motors have been tested, the program returns to the *Service Mode*.

The machine test may be stopped at any time by pressing and holding any key.

To exit back to the *Sales Mode*, press [**L**] twice, or press the Service Mode Button once.

Service Mode - High Level

To access the High Level of the *Service Mode*:

1. In the *Service Mode*, press [7]. *ENTER CODE* displays followed by *CODE=????*.
2. Enter the fixed access code (1,2,3,4). If the access code is entered correctly, *ACCEPTED* displays, then *HIGH LEVEL*. If the access code is entered incorrectly, *REJECTED* displays, then *SERVICE*.

Once the *Service Mode-High Level* has been accessed, the following functions are available:

Table 3. High Level Service Modes

| Press | To Access Mode |
|-------|---------------------------------|
| [1] | No Change |
| [2] | Forced Vend |
| [3] | Discount |
| [4] | Language |
| [5] | Lottery Odds |
| [6] | Not Used |
| [7] | Resettable Totals |
| [8] | MIS Totals |
| [9] | Stop Clock |
| [0] | All Options Off |
| [A] | Multi-Vend |
| [B] | Edit Point Of Sale Message |
| [C] | Auto Reinstatement |
| [D] | Promo-Vend |
| [E] | Reset MIS Totals |
| [F] | Not Used |
| [G] | Not Used |
| [H] | Menu Mart (Satellite) Interface |

NO CHANGE MODE

If an MDB coin mechanism is used and the coins in the change tubes are below the low-level sensors, full credit sometimes might not be refunded on an over-deposit. Activating the *No Change Mode* prevents a vend from being made if the coin mechanism does not have the exact change combination necessary to refund credit on an over-deposit. In the *Service Mode* – High Level,

1. Press [1] to display the current status (*NC ON* or *NC OFF*).
2. Press [1] to turn No Change ON or press [0] to turn No Change OFF.
3. Press [1] to save changes or press [L] to exit to the *Service Mode* without changing the option.

When the *No Change Mode* is off and a refund is required on over-deposit, the coin mechanism will refund as much change as possible. The remaining credit displays. After 20 seconds the credit will be removed. The only way the customer can receive the credit is to deposit the exact change equal to another vend.

FORCED VEND MODE

When the *Forced Vend Mode* is on, the customer must make a purchase when a dollar bill is inserted, overriding the “coin return” command. Return of 5¢, 10¢, and 25¢ coins is not affected.

To display the current status of the *Forced Vend Mode*, press [2]. (*FV ON* or *FV OFF*).

To turn Forced Vend on press [1] or to turn it off press [0].

To save changes press [J] or to exit to the *Service Mode* without changing the option press [L].

DISCOUNT MODE

A group of selections can be discounted by a set amount during three time periods. If a discounting interval is on, the *DISCOUNT AVAILABLE NOW* message alternates with the POS message during the *Sales Mode*.

| |
|---|
| WARNING: Any selection with a vend price equal to or less than the discount amount will be free vended. |
|---|

1. Press [3] *DISCOUNT GROUP=1 2 3* displays. Discount groups that are ON will be flashing.
2. Press [1], [2], or [3] to select the group to edit. After a group is selected, the status of that group displays along with *GRP # OFF*.
3. To turn that group on press [1] or to turn that group off press [0]. *ROW - /* displays.
4. Press the letter corresponding to the beginning row for the discount group and then press [0]. *TO - /* displays.
5. Press the letter corresponding to the ending row and then press [0]. *DISC \$00:00* displays.
6. Enter the amount for the discount.
7. Press [J] to save the price, or press [L] to exit without saving. *TIME 00:00* displays.
8. Enter the discount start time. Press [J] to save the time, or press [L] to exit without saving. *TO 00:00* displays.
9. Enter the discount end time. Press [J] to save the time, or press [L] to exit without saving.
10. Additional discounts can now be edited.
11. Press [L] to exit to the *High Level Service Mode*.

LANGUAGE MODE

There are five pre-programmed languages and one auxiliary (user defined) option. Only one of these language choices may be used:

A = Auxiliary (user-defined) B = DUTCH
D = ITALIAN E = ENGLISH
F = FRENCH G = GERMAN
H = SPANISH

Press [**4**] to display the language. To change the language, press the appropriate letter, followed by [**J**] to save. Press [**L**] to exit.

If the auxiliary language [**A**] is chosen, the equivalent of the following six messages can be entered.

"USE CORRECT CHANGE"
"USE COINS ONLY"
"TAKE ANOTHER SELECTION"
"SELECT FREE ITEM"
"DISCOUNT AVAILABLE NOW"
"YOU WIN"

Thirty (30) characters are available for each message. The messages are viewed or edited using the same method as the POS message, described under the "Edit POS Message" section of this manual.

LOTTERY ODDS MODE

This mode awards a free vend to the customer during the *Sales Mode*, *YOU WIN* displays, and five beeps sound.

Press [**5**]. *ODDS=0000* displays.

Enter the desired odds. The number represents the fixed number of vends between lottery winners.

EXAMPLE

| |
|---|
| If the odds are set at <i>0100</i> , the controller would award a free vend every 100th vend. |
|---|

Press the [**J**] key to save or press [**L**] to exit without saving.

RESETTABLE TOTALS MODE

The MIS (Management Information System) total vends and total cash count can be displayed by individual selections, entire row, or entire machine

1. Press [7]. *RESETTABLE TOTALS* displays followed by *??=SEL.*
2. Enter an individual selection, such as [A] [1], to display the total vends and total cash for that selection.
3. Totals for an entire row can be shown by pressing [A] [A] to display row A totals, [B] [B] for B, etc.
4. To display the entire machine totals, press [A] [L].
5. The sales information can be reset to zero by following the instructions outlined in the High Level “Reset Totals to Zero Mode” section.

MIS MODE

Press [8]. *(A)=TOTAL VENDS (B)=TOTAL CASH (C)=TOTAL VALUE CARD (D)=TOTAL LOTTO/PROMO (E)=TOTAL BILLS (F)=TOTAL DISCOUNTS* displays followed by *?=CHOICE.*

1. Press a letter once to display the total message and amount.
2. Press a letter twice to skip the total message and only display the amount.
3. Press [L] to exit to the High Level.

STOP CLOCK MODE

If the machine is to be placed in storage or out of operation for an extended period of time, the clock should be stopped to preserve the life of the battery.

Press [9]. *TO STOP CLOCK ENTER 'U'* displays. Press [J] to stop the clock and exit. Press any other key to exit with the clock running.

ALL OPTIONS OFF MODE

Press [0] to turn off *Forced Vend, Multi-Vend* and *Discount modes* without having to access each option individually.

MULTI-VEND MODE

When on, this mode retains credit for about 25 seconds. If a coin return is not requested within 25 seconds the change is then returned.

1. Press [A]. The status displays (*MIV ON* or *MIV OFF*).
2. Press [1] to turn Multi-Vend on.
3. Press [0] to turn Multi-Vend off.
4. Press [J] to save changes or press [L] to exit to without changing the option.

DIT POS MESSAGE MODE

The Point of Sales (POS) message can be used as advertising or as an encouragement to the customer to purchase products. The POS message displays continuously while the machine is in the *Sales Mode* as long as the coin mechanism has an adequate supply of coins in the change tubes.

Messages can be up to 100 characters including spaces. While in this mode the keypad functions similar to a typewriter keyboard.

A Keypad Overlay is furnished in the Service Packet defining the positioning of the characters. See Figure 11. By placing the overlay over the selection panel, the owner/operator can “type” the new message.

Each key can be used to type in two different characters. To type the “upper” character, press the key; to type the “lower” character, press [**NEXT MENU**], then the key.

To enter a new message or edit an existing message:

Press [**B**].

Type in the new message. For special effects, see Table 4.

Use the keypad overlay for the location of characters on the keypad.

Press the [**NEXT MENU**] key twice to save the message.

NOTE

If the [**NEXT MENU**] key is not pressed twice, portions of the previous message may remain.

| | | | |
|-------|-----------|------------|--------------------|
| A | G | N | UPPER CHARACTER |
| K | Y | 4 | |
| B | H | O | LOWER CHARACTER |
| Q | Z | 5 | |
| C | I | P | |
| U | 0 | 6 | |
| D | J | R | |
| V | 1 | 7 | |
| E | L | S | |
| W | 2 | 8 | |
| F | M | T | |
| X | 3 | 9 | |
| SPACE | NEXT MENU | BACK SPACE | |
| ☆ | ENTER | \$ | |

Figure 9. Keyboard Overlay

Table 4. Available Special Effects

| Press | To |
|----------------------|--|
| [*] + [B] | Beep once |
| [*] + [H] | Scroll message horizontally (default) |
| [*] + [P] | Pause the display 0.5 seconds per occurrence |
| [*] + [T] | Display time in 12-hour format |
| [*] + [V] | Scroll the following portion of the message vertically |

AUTO REINSTATEMENT MODE

Use this feature for a satellite can drink or similar vendor utilizing a sold-out or empty switch. Normally, when an empty selection is detected during an attempted vend, that selection is flagged inoperative and requires resetting before it can be vended again. The satellite units use a range of selections within the controller and use a switch in series with the motor as a sold-out switch. Programming this range of selections into the auto reinstatement will eliminate the necessity of resetting the controller after re-loading a selection that had went into an empty condition.

Press **[C]**. *INPUT AUTO-REINSTATEMENT RANGE* displays followed by *1=ON 0=OFF*.

To turn off this feature and exit to the High Level, press **[0]** or

to turn on this feature, press **[1]**. *BEGIN --* displays .

Identify the beginning selection.

Press **[0]** to save the setting. *END --* displays.

Identify the ending selection.

Press **[0]** to save the setting and exit.

PROMO VEND MODE

Use this mode to promote new items. It enables the customer to buy one item and get a second item free.

When a customer purchases an item from a promo group, *SELECT FREE ITEM* displays followed by *XX TO YY*, indicating the range of free items. This will scroll continuously for 25 seconds or until a free item is selected. If a selection outside the free range is selected, or if a free vend fails, the vendor will beep and display *PLEASE MAKE ANOTHER SELECTION* once before returning to *XX TO YY*.

Press [**D**]. *PROMO GROUP = 1 2 3* displays. Promo groups that are on are flashing.

Press [**1**], [**2**], or [**3**] to select a group to edit. The status of that group is displayed with *GRP X OFF*, where X is the group number.

Press [**1**] to turn group X on, or press [**0**] to turn group X off. *BUY-* displays.

Enter the beginning selection in the buy range and press [**0**] to save the setting. *TO -* displays.

Enter the ending selection in the buy range and press [**0**] to save the setting. *FREE -* displays.

Enter the beginning selection in the free range and press [**0**] to save the setting. *TO -* displays.

Enter the ending selection in the free range. Press [**0**] to save an exit.

RESET TOTALS MODE

This function resets to zero all resettable individual motor counters. The information stored in the non-resettable counters will not be affected.

Press [**E**]. *RESET THIS?* displays.

To reset MIS and exit, press [**J**]. Press any other key to exit without resetting the MIS.

CARE & CLEANING

WARNING:

Always disconnect the power source before cleaning.

Cabinet Exterior

Wash with a mild detergent and water, rinse and dry thoroughly. Wipe occasionally with a quality car wax. Plastic exterior parts may be cleaned with a quality plastic cleaner.

Cabinet Interior

Wash with mild detergent and water. Eliminate odors by including baking soda or ammonia in the cleaning solution. Remove and clean drain hose to eliminate any deposits that may restrict condensate water flow.

The vend mechanisms must be kept clean. Any build-up can cause the mechanisms to malfunction. Use soap and water with great care so as not to get water into the electrical components.

To insure proper vending keep delivery slide area free of dirt and sticky substances.

BEFORE CALLING FOR SERVICE

Please check the following:

- Does your machine have at least 6-in (15cm) of clear air space behind it?
- Is the circuit breaker at the fuse box reset?
- If the power is turned on at the fuse box, is the machine the only thing that doesn't work?
- Is the machine plugged directly into the outlet?

WARNING:

Extension cords cause problems.
DO NOT USE EXTENSION CORDS!

SCHEMATIC

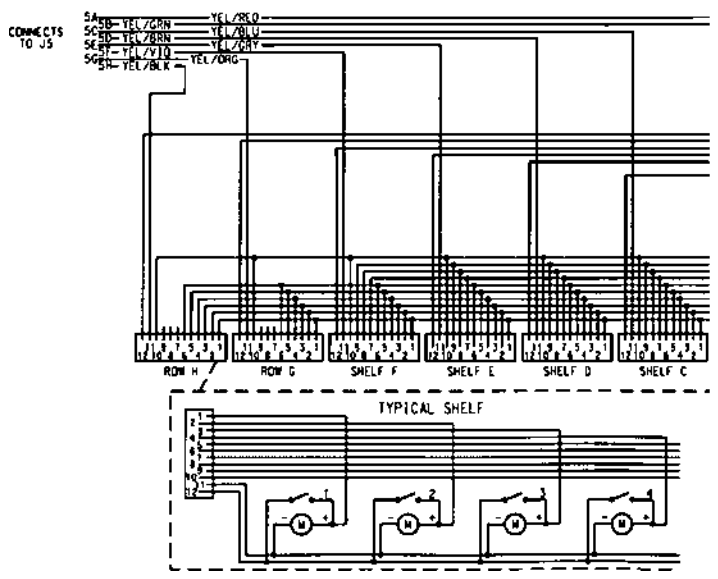
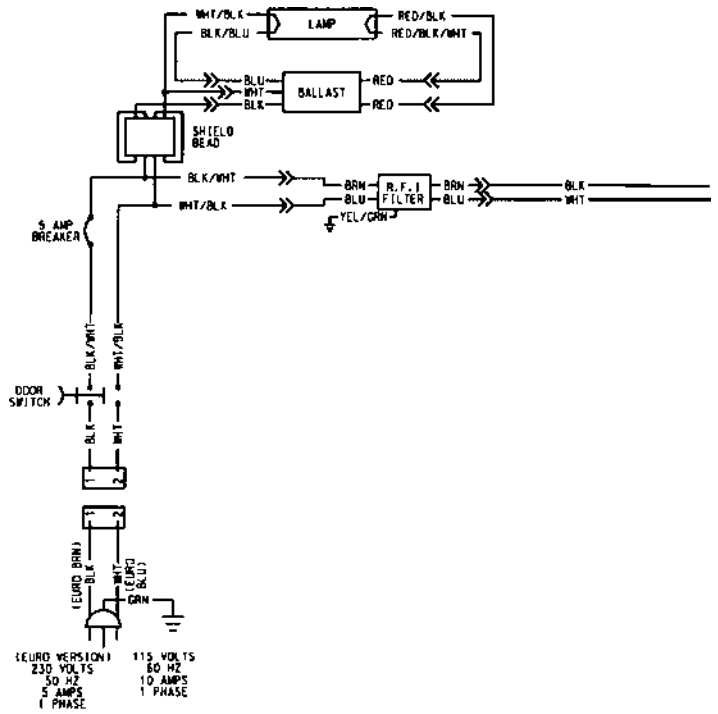

AMBIENT ROUND FRONT
SCHEMATIC—P/N 4210323
REV A

- * ON MDB VERSIONS J6 IS USED AND J2, J3 AND J14 ARE NOT USED.
- ** J12 CAN USE OPTIONAL DEX HARNESS P/N#1212230

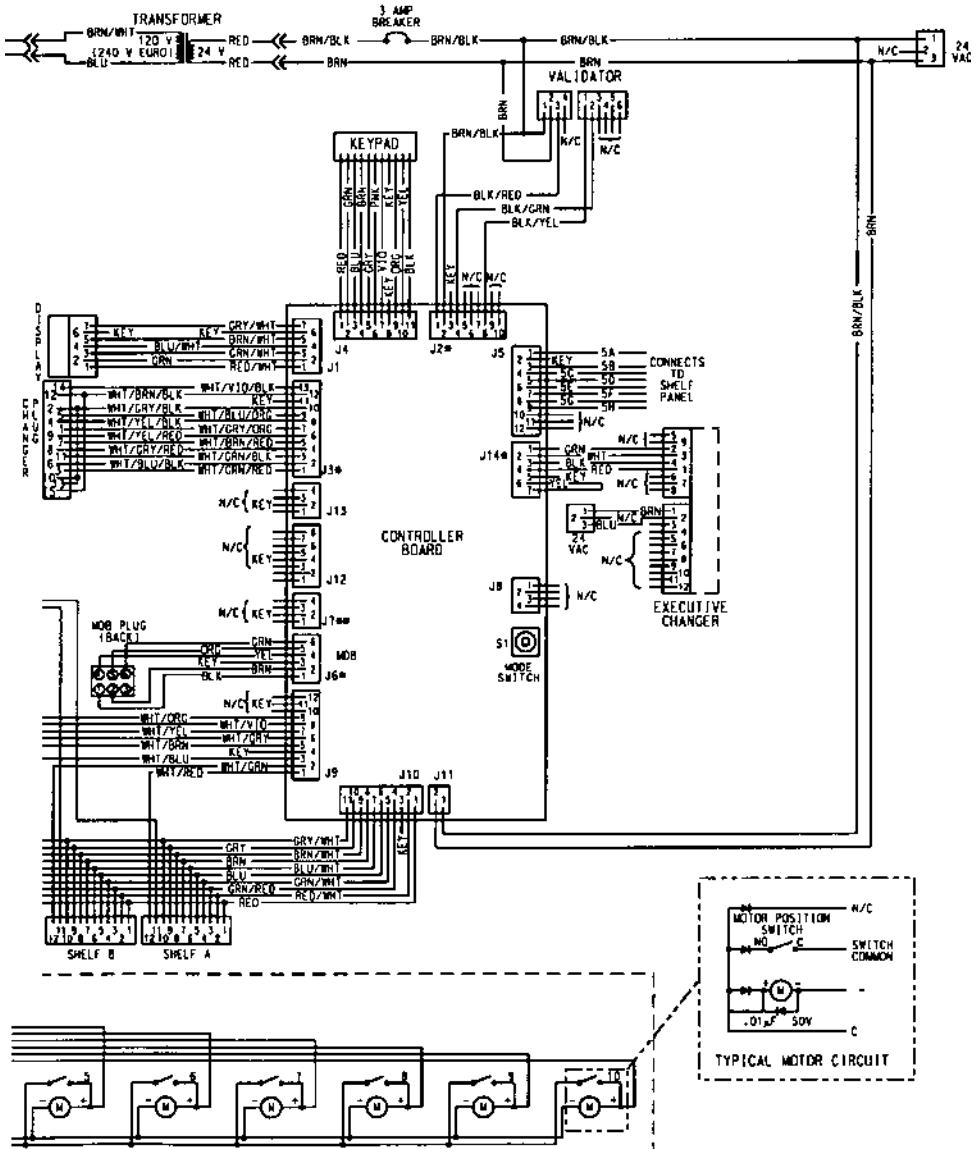

PARTS MANUAL

Table of Contents

| | |
|--|-----------|
| GENERAL INFORMATION | 31 |
| FINAL ASSEMBLY | 34 |
| DOOR ASSEMBLY | 36 |
| Selector Panel Assembly | 38 |
| Delivery Assembly | 40 |
| Light Assembly | 42 |
| CABINET ASSEMBLY | 44 |
| Control Panel Assembly | 46 |
| Coin Box and Holder Assembly | 48 |
| Tray Configuration | 49 |
| Tray Assembly- 3 & 4-Wide | 50 |
| Tray Assembly - 5-Wide | 52 |

GENERAL INFORMATION

You may order parts from your distributor or from VendNet™. If you have any questions when placing your order, please call and we'll be happy to assist you. Please provide the following information when placing your order:

- Quantity Required
- Part Number
- Description of part

NOTE

WHEN "RIGHT" AND "LEFT" ARE USED WITH A PART NAME, IT IS TAKEN TO MEAN THAT THE PERSON IS FACING THE MACHINE WITH THE DOOR CLOSED.

- Vendor Model Number
- Vendor Serial Number
- Shipping and Billing Address
- Preferred Method of Shipment
- Customer Account Number

Minimum Order:

You may wish to inquire on prices of parts and minimum order amount at the time of your order. If you order less than the minimum, please check our catalog for other parts you may require to bring your order up to the minimum amount.

VendNet™ reserves the right to change these requirements without notice.

Payment:

OPEN ACCOUNT with approved credit. MASTER CARD – VISA – DISCOVER – C.O.D.

To Order by Mail:

You may mail your order for replacement parts by providing the necessary information as requested above to:

VendNet™
165 North 10th Street
Waukee, Iowa 50263-0488 - USA

Order forms are available upon request or you may use your own purchase order form.

To Order by Fax

You may Fax your order for replacement parts by providing the necessary information as requested above to: VendNet™.
1-515-987-4447

To Order by Phone

You may call in your order for replacement parts by providing the necessary information as requested above to VendNet™ Parts Department.

USA 1-800-833-4411

Canada 1-800-858-4730

Other locations 1-515-274-3641

Returns

RESTOCKING CHARGE 20%. A restocking charge of 20% will apply to merchandise accepted by VendNet™ for return, except items processed as warranty.

A Return Form clearly stating the reason for return must accompany all items returned. Returns are to be shipped freight prepaid to VendNet™, 165 North 10th Street, Waukee, Iowa 50263-0488. (Return Forms are available upon request from VendNet™.)

Limitation of Liability

VendNet™ shall not be liable for any injury, loss or damage, whether direct, incidental or consequential arising out of the use of or the inability to use any part, parts or products sold by VendNet™. The remedies of the buyer set forth herein are exclusive, and the liability of VendNet™. With respect to any contract or sale or anything done in connection herewith, whether in contract, in tort, under any warranty, or otherwise, shall not, except as expressly provided herein, exceed the price of the part, parts or products on which such liability is based. Any statements or representations about the parts or product, other than those contained herein, do not constitute warranties and shall not be relied on by the buyer and shall have no force of effect unless contained in a written agreement signed by officers of VendNet™.

If you have any questions, check out our Website

<http://www.vendnet.com>

or please call VendNet™.

Ask for the Parts Department.

We will be happy to assist you.

E-Mail: vendnet@vendnet.com

Key

| | |
|------------|-----------------------------|
| ADHV | ADHESIVE |
| AP | ATTACHING PART |
| CC | COMMODITY CODE |
| ETW | External Lock Washer |
| HWH | Hex Washer Head Screw |
| MS | MACHINE SCREW |
| PH | PAN HEAD SCREW |
| TH | TRUSS HEAD SCREW |
| VAC | VOLT -- ALTERNATING CURRENT |
| VDC | VOLT – DIRECT CURRENT |
| W/ | WITH |
| W/O | WITHOUT |

Commodity Codes

| | | | |
|----|----------------------|----|------------------------------------|
| AS | ASSEMBLY | RA | RAILS |
| BU | BUSHING | RC | REFRIGERATION COMPONENT |
| CB | CONTROL BOARD | RE | RELAY |
| CL | CLIP | RI | RIVET |
| CO | COMPRESSOR | RU | RUBBER |
| CP | CLAMP | SC | FASTENER |
| EL | ELECTRICAL COMPONENT | SF | SIGN FACE |
| FA | FAN | SL | SLIDE |
| FU | FUSE, BREAKER | SM | SCREW-MACHINE |
| GA | GASKET | SP | SPRING, AUGER |
| GR | GROMMET | ST | STAMPING, BRACKET |
| HA | HARNESS | SW | SWITCH |
| HI | HINGE | TA | TAPE |
| IN | INSULATION | TC | TEMPERATURE CONTROL, THERMOSTAT |
| LA | LABEL, TAG | TU | TUBING |
| LE | LEG, LEVELER | WA | WASHER |
| LO | LOCK | WD | WOOD |
| LP | LAMP | WE | WELDED ASSEMBLY |
| MA | MANUAL | WT | WIRE TIE |
| NU | NUT | XF | TRANSFORMER, BALLAST |
| PI | PIN | | |
| PL | PLASTICS | | |

FINAL ASSEMBLY

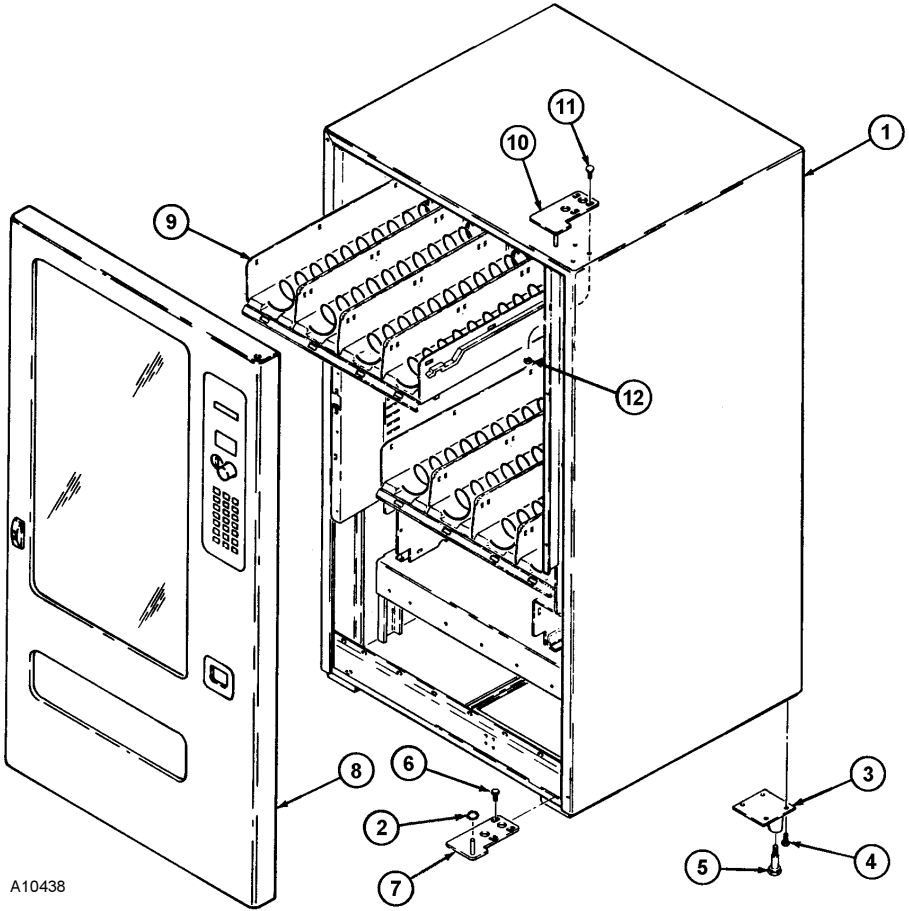

A10438

FINAL ASSEMBLY

| ITEM | PART NO. | DESCRIPTION | QTY | CC |
|-------|-------------|--|-----|----|
| 1 | 1214781-xxx | Cabinet Assembly - See Page 42 | 1 | AS |
| 2 | 4050767 | 3/8 Nylon Flat Washer | 1 | WA |
| 3 | 1131275-001 | Leg Weld Assembly | 4 | WE |
| 4 | 8801388 | 5/16-18x3/4 HWH Type D Screw | 16 | SC |
| 5 | 8363374 | Leg Leveler | 4 | LE |
| 6 | 8801388 | 5/16-18 x 3/4 HWH Type D | 3 | SC |
| 7 | 1212060-005 | Hinge Stake - Lower | 1 | RA |
| 8 | 1214780-xxx | Door Assembly - See Page 34 | 1 | AS |
| 9 | | Tray Configuration - See Pages 47 | 1 | AS |
| 10 | 1212060-006 | Hinge Stake - Upper | 1 | RA |
| 11 | 4050099 | 5/16-18X3/4 Carriage Bolt | 3 | SC |
| 12 | 8810015 | Flange Lock Nut - 5/16-18 | 3 | NU |
| Not | 4208506 | Air Deflector (Optional) | 1 | |
| Shown | 4206694-014 | Coin Mechanism - Globola 230V | 1 | CM |
| | 7202038-998 | Lock and Key - Shown on Door Assembly | 1 | LO |
| | | Validator - Contact your Local Distributor | 1 | CM |
| | 1214783 | Service Package | 1 | AS |
| | 4205749 | Bumper | A/R | RU |
| | 4203793-001 | \$1 Labels | 1 | LA |
| | 4203793-002 | \$2 Labels | 1 | LA |
| | 4209635 | Service and Parts Manual | 1 | MA |
| | 4206816 | Safety Manual | 1 | MA |
| | 7250135-002 | Hole Plug 1-in. | 4 | PL |
| | 4205466 | Keypad Overlay | 1 | LA |
| | 8370998 | Spacer Support | 12 | WF |
| | 4200281 | Spring Clip | 12 | CL |
| | 8370660-5 | Spacer | 4 | PL |

PT001

DOOR ASSEMBLY

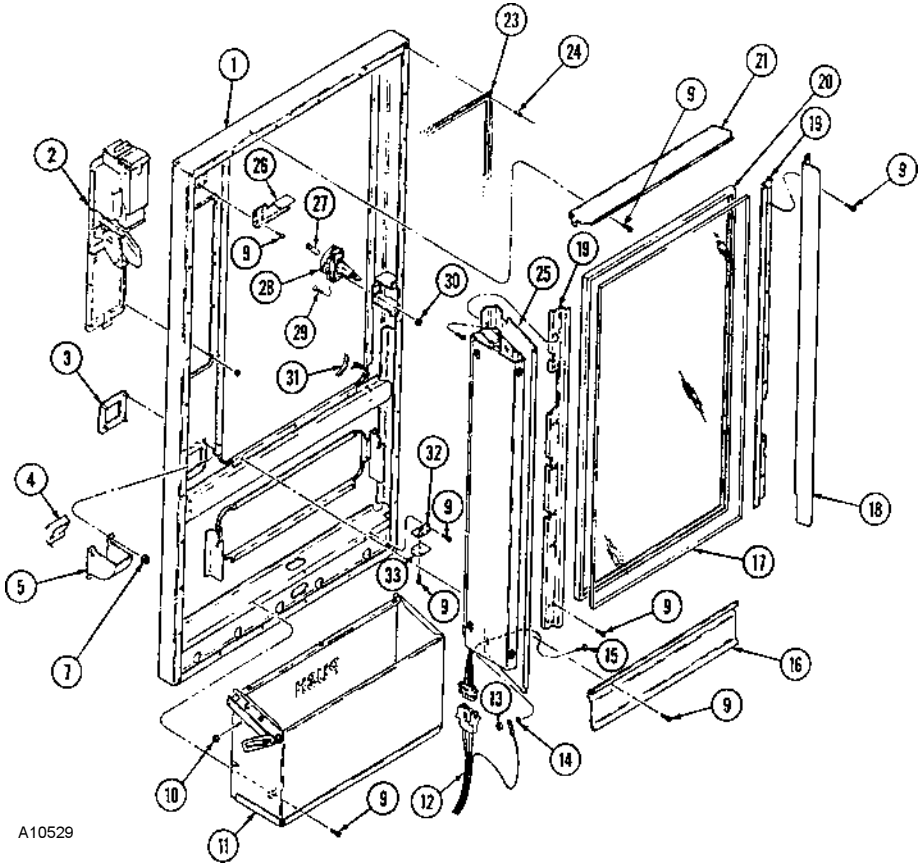

A10529

| ITEM | PART NO. | DESCRIPTION | 3-W | 4-W | 5-W | CC |
|------|-------------|-------------------------------------|-----|-----|-----|----|
| 1 | 1212026-xxx | Door Weldment - Column 1 | 1 | 1 | 1 | WE |
| 2 | 1214784 | Selector Panel Assembly - See P. 36 | 1 | 1 | 1 | AS |
| 3 | 4203209 | Coin Cup Bezel | 1 | 1 | 1 | PL |
| 4 | 4203208 | Coin Cup Door | 1 | 1 | 1 | PL |
| 5 | 4203207 | Coin Cup | 1 | 1 | 1 | PL |
| 7 | 4050747 | 1/4" Stamped Hex Nut | 4 | 4 | 4 | NU |

PT003

Door Assembly

| ITEM | PART NO. | DESCRIPTION | 3-W |
|-----------|-------------|---------------------------------|-----|
| 9 | 4050202 | 8-18 x 1/2 HWH Tek | 30 |
| 10 | 4050513 | 8-32 Nut (AP for Item 11) | 2 |
| 11 | 1214362-xxx | Delivery Assembly - See Page 38 | 1 |
| 12 | 4208480 | Power Harness | 1 |
| 13 | 4050513 | 8-32 Twin Whiz Nut | A/R |
| 14 | 4050585 | 8 Ext. Tooth Lockwasher | 1 |
| 15 | 4050240 | 8-32 x 3/8 Phil PH MS | 1 |
| 16 | 4208414-xxx | Product Deflector - Column 2 | 1 |
| 17 | 4203478-xxx | Display Window - Column 3 | 1 |
| 18 | 4203485-002 | Left Door Partition | 1 |
| 19 | 4203566-003 | Window Retainer | 2 |
| 20 | 4209025-xxx | Window Gasket - Column 4 | 1 |
| 21 | 4203479-xxx | Top Door Deflector - Column 5 | 1 |
| 23 | 4203466-xxx | Door Gasket - Column 6 | 1 |
| 24 | 7201418-006 | Pop Rivet | A/R |
| 25 | 1212034 | Light Assembly - See Page 40 | 1 |
| 26 | 4205036-002 | Switch Plate | 1 |
| 27 | 7202038-998 | Lock Cylinder W/Keys | 1 |
| 28 | 4203486 | 1/4 Turn Handle - Black | 1 |
| 29 | 4050338 | 10-32 X 1/2 Phil FH MS | 2 |
| 30 | 4050546 | 10-32 Twin Whiz Nut | 2 |
| 31 | 4203263 | 1/4 X 1/2 Foam Tape - 3-in. | 4 |
| 32 | 4203387 | Door Lift Mount | 1 |
| 33 | 4025610 | Door Glide | 1 |
| Not Shown | 4203994-001 | Keypad/Display Harness | 1 |
| | 4207548 | Cable Tie W/Hole | 1 |

| | COLUMN 1 Door Weld | COLUMN 2 Product Deflector | | COLUMN Display Win |
|-----|-----------------------|----------------------------------|-------------|-----------------------|
| 3-W | 1212026-025 | 4208414-003 | 4203478-006 | 1/8" T x 17-11 |
| 4-W | 1212026-026 | 4208414-004 | 4203478-007 | 1/8" T x 23-1 |
| 5-W | 1212026-027 | 4208414-005 | 4203478-008 | 1/8" T x 29- |

| | COLUMN 4 Window Gasket | COLUMN 5 Top Door Deflector | COLUMN 6 Door Gasket |
|-----|---------------------------|-----------------------------------|-------------------------|
| 3-W | 4209025-006 | 4203479-007 | 4203466-003 |
| 4-W | 4209025-007 | 4203479-008 | 4203466-004 |
| 5-W | 4209025-008 | 4203479-005 | 4203466-005 |

P1004

DOOR ASSEMBLY

Selector Panel Assembly

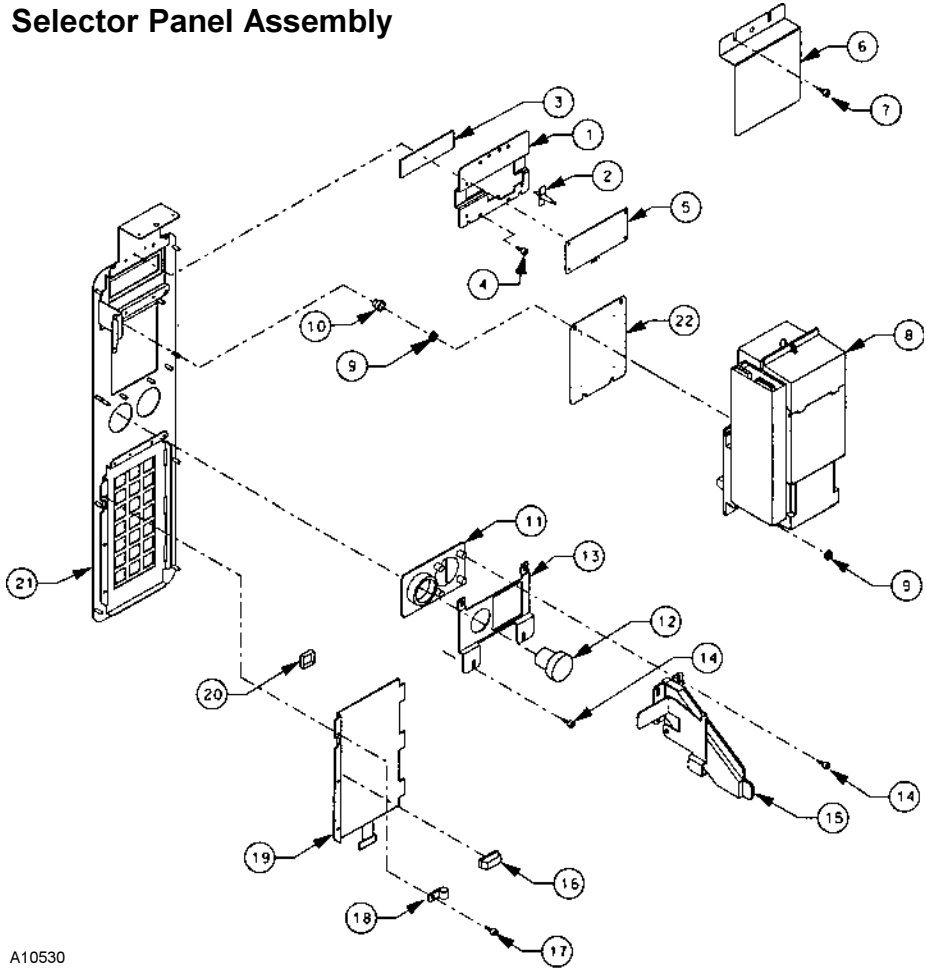

A10530

| ITEM | PART NO. | DESCRIPTION | 3-W |
|------|-------------|--|-----|
| 1 | 4203644-002 | Display Mounting Bracket | X |
| 2 | 4025723 | Controller Stand-Off | X |
| 3 | 4200659 | Readout Window | X |
| 4 | 4050420 | 8-18 x ¼ Phil HWH Type B | X |
| 5 | 4203037 | Display Board - SMIV | X |
| 6 | 4207765 | Display Cover | X |
| 7 | 4050420 | 8-18 x ¼ Phil HWH Type B | X |
| 8 | | Validator - Contact your local distributor | X |

Selector Panel Assembly

| ITEM | PART NO. | DESCRIPTION | 3-W |
|-----------|-------------|---|-----|
| 9 | 8800956 | 8 - 32 Hex Nut w/ ETW for CBV Validator | |
| 10 | 8330164 | 8 - 32 Thumb Nut for CBV Validator - Brass | |
| 11 | 4203186-001 | Coin Insert | X |
| 12 | 4203187 | Coin Return Button | X |
| 13 | 4207279-001 | Coin Insert Retainer | X |
| 14 | 4050423 | 8-18 x 3/8 Phil PH Type AB | X |
| 15 | 1212227-001 | Coin Insert Assembly | X |
| | 1212030-004 | Coin Insert Weldment | X |
| | 4030100-001 | Bushing Spacer | X |
| | 4050240 | 8-32X3/8 Phi PH MS | X |
| | 4050511 | 8-32 Nut - Two way lock | X |
| | 8376074 | Spring .375 x 2 5/16 | X |
| 16 | 4203696 | Ribbon Cable Clamp | X |
| 17 | 4050423 | 8-18 x 3/8 Phil PH Type AB | X |
| 18 | 4060116 | Plastic Wire Clamp 3/8 | X |
| 19 | 1212028-002 | Keypad Assembly | X |
| 20 | 4025741 | Push Button | X |
| 21 | 1214152-007 | Selection Panel Weldment for CBV Validator | X |
| | 1214152-009 | Selection Panel Weldment w/o Validator | X |
| | 1214152-006 | Selection Panel Weldment for BA32SA Validator | X |
| 22 | 1214495 | Validator Filler Weldment | X |
| | 4209639 | Validator Filler Plate (Plastic) | X |
| | 4209656 | Slip in Plate (Used with Plastic Filler) | X |
| | 4210396 | Label (Used on Slip in Plate) | X |
| Not Shown | 4203994-001 | Keypad and Display Harness | |
| | 4207504-xxx | Selector Panel Decal (See Table 1) | X |

TABLE 1. SELECTOR PANEL DECAL (Optional)

| PART NUMBER | LANGUAGE |
|-------------|------------|
| 4207504 | English |
| 4207504-001 | Spanish |
| 4207504-002 | French |
| 4207504-003 | Dutch |
| 4207504-004 | German |
| 4207504-005 | Portuguese |
| 4207504-006 | Italian |

PT025

DOOR ASSEMBLY

Delivery Assembly

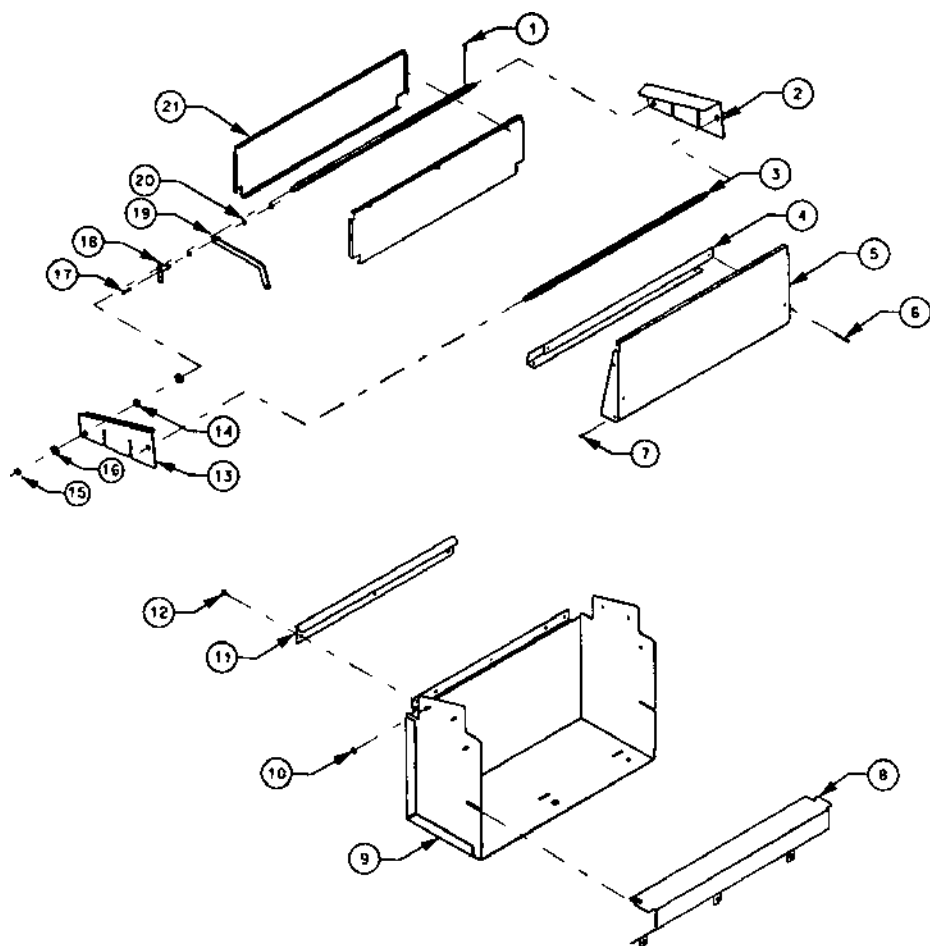

A10051

Delivery Assembly

| ITEM | PART NO. | DESCRIPTION |
|--------------|-------------|------------------------------------|
| | 1214362-003 | Delivery Assembly - 3-W |
| | 1214362-004 | Delivery Assembly - 4-W |
| | 1214362-005 | Delivery Assembly - 5-W |
| 1 | 4050239 | 8-32x3/8 Phil PH Type T |
| 2 | 4207772-002 | Side Deflector - Right |
| 3 | | Delivery Shaft - Column 1 |
| 4 | 4208365-xxx | Door Back - Column 2 |
| 5 | 4208364-xxx | Delivery Door - Column 3 |
| 6 | 4050663 | Rivet |
| 7 | 4205329 | Arrow Clip |
| 8 | 4208363-xxx | False Box - Column 4 |
| 9 | 1214361-xxx | Wrapper Weldment - Column 5 |
| 10 | 8800956 | 8-32 Hex Nut w/ ETW |
| 11 | 4208362-xxx | Wrapper Back - Column 6 |
| 12 | 4050423 | 8-18 x 3/8 Phil PH Type AB |
| 13 | 4207772-003 | Side Deflector - Left |
| 14 | 4025263-001 | Type 5 Nyliner 5/16 ID Bushing |
| 15 | 8801080 | E Ring 5/16 |
| 16 | 8324353 | 5/16 Flat Washer |
| 17 | 4203386-044 | 8-32 x 5/8 Captive Stud |
| 18 | 4207697 | Anti-Cheat Link |
| 19 | 4207695 | Delivery Link |
| 20 | 4030100 | Bushing - Spacer |
| 21 | 4208366-xxx | Anti-Cheat - Column 7 |
| Not Shown | 4205705-xxx | Delivery Pad (Optional) - Column 8 |

| | COLUMN 1 Delivery Shaft | COLUMN 2 Door Back | COLUMN 3 Delivery Door |
|-----|----------------------------|-----------------------|---------------------------|
| 3-W | 4208376-003 | 4208365-003 | 4208364-003 |
| 4-W | 4207698-004 | 4208365-004 | 4208364-004 |
| 5-W | 4207698-005 | 4208365-005 | 4208364-005 |

| | COLUMN 5 Wrapper Weld | COLUMN 6 Wrapper Back | COLUMN 7 Anti Cheat |
|-----|--------------------------|--------------------------|------------------------|
| 3-W | 1214361-003 | 4208362-003 | 4208366-003 |
| 4-W | 1214361-004 | 4208362-004 | 4208366-004 |
| 5-W | 1214361-005 | 4208362-005 | 4208366-005 |

DOOR ASSEMBLY

Light Assembly

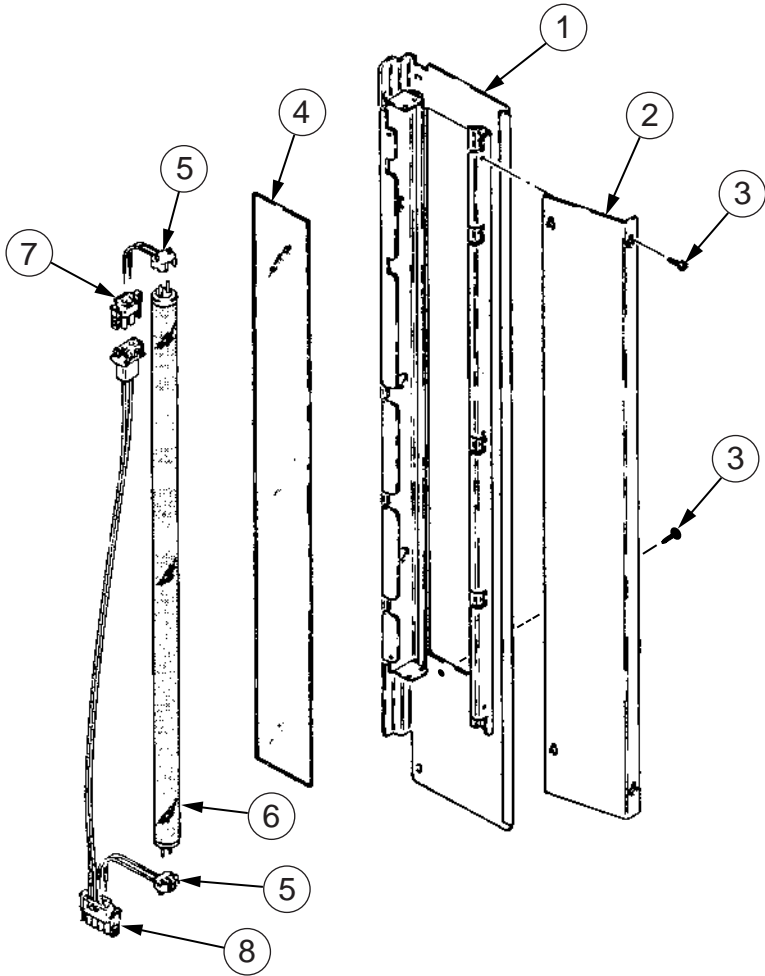

A10531

Light Assembly

| ITEM | PART NO. | DESCRIPTION |
|------|-------------|----------------------------|
| | 1212034 | Light Assembly |
| 1 | 1211462-002 | Light Weld |
| 2 | 4203463 | Light Door - White |
| 3 | 4050423 | 8-18 x 3/8 Phil PH Type AB |
| 4 | 4203464 | Light Diffuser |
| 5 | 4203637 | Lamp Socket |
| 6 | 4203131 | Lamp - F30 T12 - 34" |
| 7 | 4203682 | Terminal Housing |
| 8 | 4203465 | Lamp Harness |

CABINET ASSEMBLY

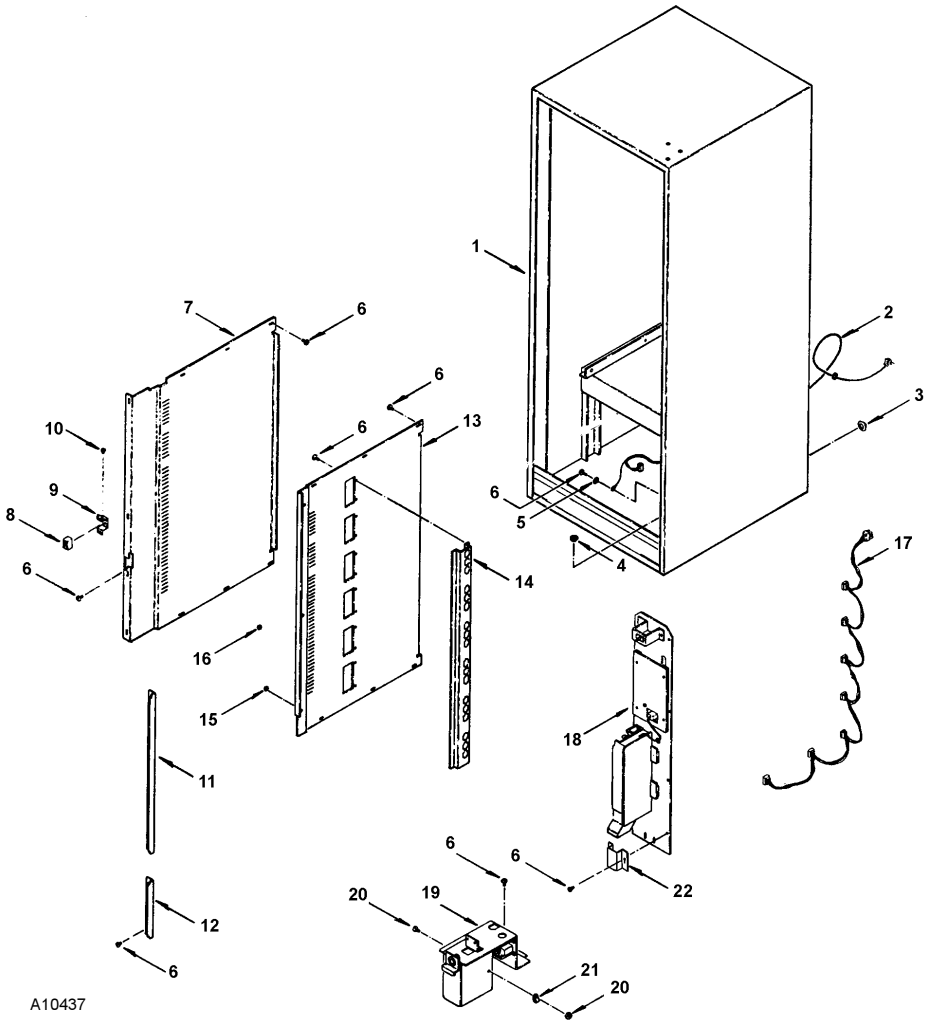

A10437

Cabinet Assembly

| ITEM | PART NO. | DESCRIPTION | QTY | CC |
|--------------|-------------|--|-----|----|
| 1 | 1214480-xxx | Cabinet Weldment - See Column 1 | 1 | WE |
| 2 | 4208462-001 | Power Cord - 230V | 1 | HA |
| | 4203520 | Power Cord - 115V | 1 | HA |
| 3 | 7250135-007 | Hole Plug - 2 ¼" BPF | 2 | PL |
| 4 | 7250135-000 | Hole Plug - 1 3/8" BP | 2 | PL |
| 5 | 4050585 | #8 Ext Tooth Lockwasher | 4 | WA |
| 6 | 4050423 | 8-18 x 3/8 Phil PH Type AB | A/R | SC |
| 7 | 1214489-003 | Left Panel Weldment | 1 | AS |
| 8 | 4203634 | Split Nut Assembly | 1 | NU |
| 9 | 4203255 | Nut Mount Bracket | 1 | ST |
| 10 | 8800638 | 10-16 x 3/8 Phil PH Type B | 2 | SC |
| 11 | 4203645 | Anti-Cheat - (Long) | 1 | ST |
| 12 | 4203645-001 | Anti-Cheat - (Short) | 1 | ST |
| 13 | 4208681-002 | Right Side Panel | 1 | ST |
| 14 | 4203143 | Tray Receptacle | 1 | ST |
| 15 | 7250135-001 | Hole Plug - ½" BPF | 3 | PL |
| 16 | 4203468 | Snap In Clip | 6 | CL |
| 17 | 4205090 | 8-Plug Main Harness | 1 | HA |
| 18 | 1214786 | Control Panel Assembly - See Page 36 | 1 | EL |
| 19 | | Coin Box and Holder Assembly - See Page 42 | 1 | AS |
| 20 | 4050240 | 8-32 x 3/8 Phil PH MS | 2 | CL |
| 21 | 4060116 | Plastic Wire Clamp | 1 | ST |
| 22 | 4203199 | Box Chute Bottom | 1 | ST |
| Not Shown | 4201333-002 | Cover Plate for Power Cord | 1 | ST |
| | 4033527 | Connector-Line Splice | 2 | EL |
| | 4033712 | Cable Tie - 7 3/8" | 2 | WT |
| | 4208505-xxx | Kick Panel (Optional) See Column 2 | 1 | ST |

PT011

| | COLUMN 1 Cabinet Weld | COLUMN 2 Kick Panel |
|-----|--------------------------|------------------------|
| 3-W | 1214480-009 | 4208505-003 |
| 4-W | 1214480-010 | 4208505-004 |
| 5-W | 1214480-011 | 4208505-005 |

PT012

CABINET ASSEMBLY

Control Panel Assembly

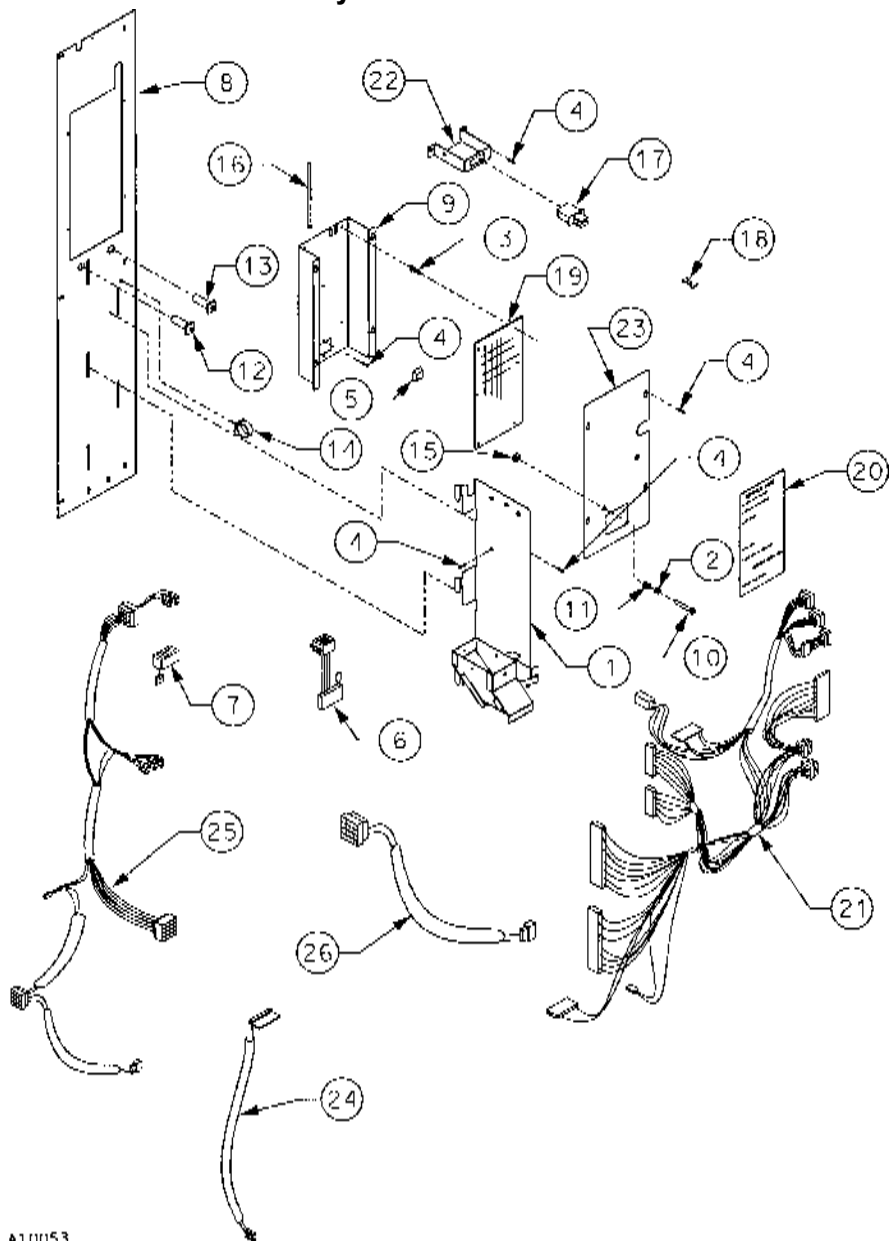

A1 005.3

Control Panel Assembly

| ITEM | PART NO. | DESCRIPTION |
|------|-------------|--|
| | 1214786 | Control Panel Assembly |
| 1 | 1212104-002 | Coinage Weld |
| 2 | 4021017 | Spring |
| 3 | 4025723 | Controller Stand-Off |
| 4 | 4050423 | 8-18 X 3/8 Phil PH Type AB |
| 5 | 4200238 | Self Adhesive Feet |
| 6 | 4200705 | MS 1600 Data Harness (Executive Controller |
| 7 | 4200709 | MS 1600 Power Harness (Executive Controll |
| 8 | 4203136-013 | Control Panel |
| 9 | 4203137-002 | Controller Mount |
| 10 | 4203144 | Mode Button |
| 11 | 4203181 | 1/4 I.D. Snap Bushing |
| 12 | 4203467-003 | 3 Amp Circuit Breaker |
| 13 | 4203467-005 | 5 Amp Circuit Breaker |
| 14 | 4203468 | Snap-In Clip |
| 15 | 4203477 | 1/4 Nut |
| 16 | 4203509 | Cable Tie |
| 17 | 4203639 | Door Interlock Switch |
| 18 | 4203640 | Interlock Cheat |
| 19 | 4203864-004 | MDB Controller Board |
| | 4203864-002 | Controller - L+ With DEX (Optional) |
| | 4203864-006 | Controller - Domestic SMIV (Optional) |
| 20 | 4203870 | Service Mode Label |
| 21 | 4205091-001 | 8 Plug Controller Harness |
| 22 | 4203591 | Door Switch Mount |
| 23 | 4205314-002 | Controller Cover |
| 25 | 4208480 | Power Harness |
| 26 | 4206648 | Coin Mech Harness - MDB |

CABINET ASSEMBLY

Coin Box and Holder Assembly

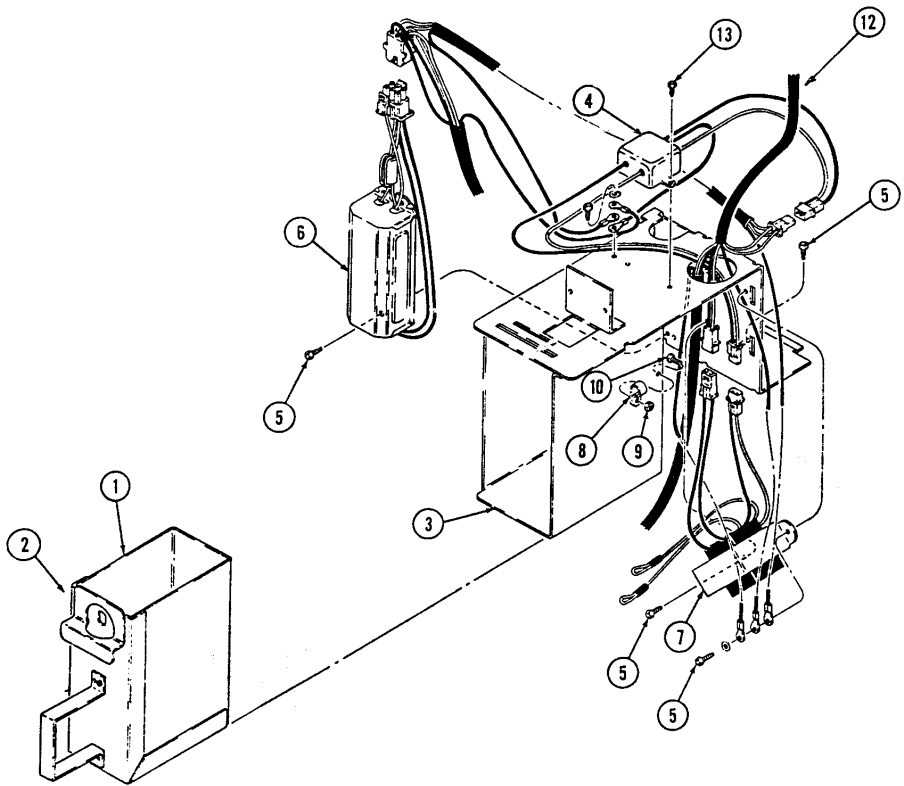

A10244

Coin Box and Holder Assembly

| ITEM | PART NO. | DESCRIPTION | 115V | 230V | QTY | CC |
|------|-------------|---------------------------------|------|------|-----|----|
| 1 | 4208890 | Coin Box | X | X | 1 | PL |
| 2 | 4060318 | Cash Box Lock & Keys (Optional) | X | X | 1 | LO |
| 3 | 1214785-002 | Box Mount Weld | X | X | 1 | WE |
| - | 1212052-003 | Coin Box Holder Assembly | | X | | AS |
| 4 | 4203730-003 | RFI Filter | X | X | 1 | EL |
| 5 | 8800612 | 8-18 X 1/2 Phil PH Type AB | X | X | 2 | SC |
| 6 | 4203625-001 | Ballast Assembly - 230 V | | X | 1 | AS |
| | 4203625 | Ballast Assembly - 115 V | X | | 1 | AS |
| 7 | 4203134 | Transformer - 230 V | | X | 1 | XF |
| | 4206570-000 | Transformer - 115 V | X | | 1 | XF |
| 11 | 4050585 | #8 Ext. Tooth Lockwasher | X | X | 4 | WA |
| 12 | 4208480 | Power Harness | X | X | 1 | HA |
| 13 | 4050423 | 8-18x3/8 Phil PH Type AB | X | X | 2 | SC |

PT0014

CABINET ASSEMBLY

Tray Configuration

| PART NO. | DESCRIPTION |
|-------------|--|
| 1214790 | 3-Wide Tray Configuration - See Page 48 |
| 1212284-301 | 12 Select Tray Assembly |
| 1212284-303 | 18 Select Tray Assembly |
| 1212284-304 | 15/24 Gum & Mint Tray Assembly |
| 1214790-004 | 4-Wide Tray Configuration - See Page 48 |
| 1212284-401 | 12 Select Tray Assembly |
| 1212284-403 | 18 Select Tray Assembly |
| 1212284-404 | 15/24 Gum & Mint Tray Assembly |
| 1214790-005 | 5-Wide Tray Configuration - See Page 50 |
| 1214877 | 10 Select Snack Tray Assembly |
| 1214877-001 | 12 Select Snack Tray Assembly |
| 1214877-002 | 15 Select Snack Tray Assembly |
| 1214877-003 | 18/30/36 Select Candy/Gum & Mint Tray Assembly |
| 1214877-004 | 15/24 Select Candy Tray Assembly |

PT0015

CABINET ASSEMBLY

Tray Assembly - 3 & 4-Wide

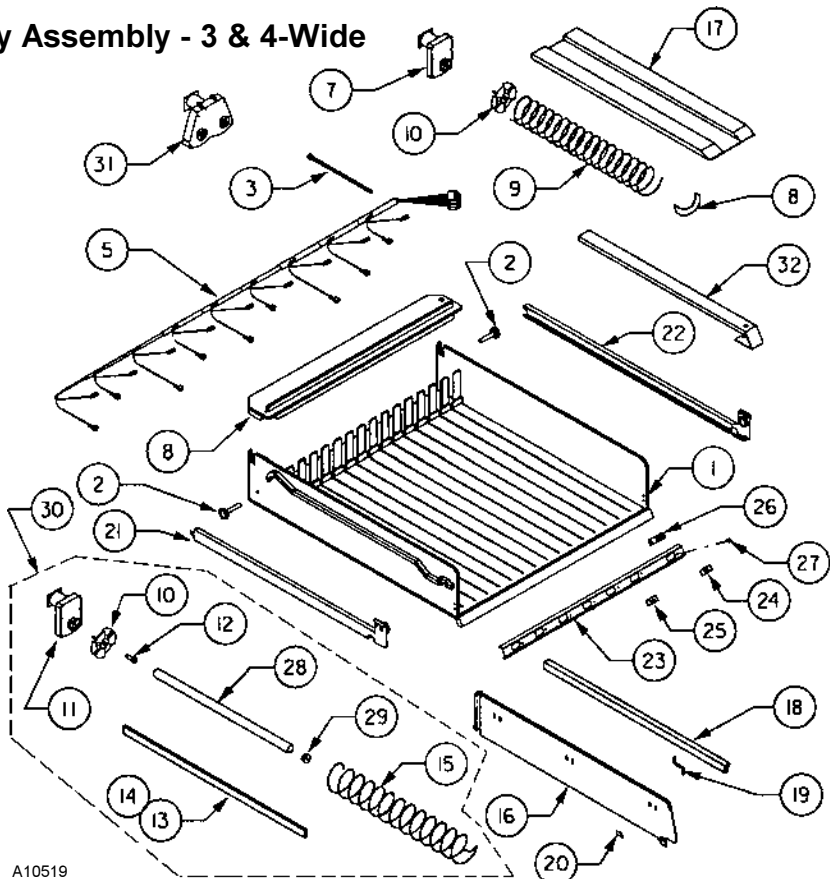

A10519

| ITEM | PART NO. | DESCRIPTION | QTY | CC |
|------|-------------|---------------------------|-----|----|
| 1 | 4203275 | Tray - 3W | 1 | PL |
| | 4203276 | Tray - 4W | 1 | PL |
| 2 | 4060670-004 | Roller | 2 | PL |
| 3 | 4203509 | Cable Tie | 1 | WT |
| 5 | 4203989-003 | Tray Harness - 3W | 1 | HA |
| | 4203989-004 | Tray Harness - 4W | 1 | HA |
| 6 | 4203277-003 | Motor Cover - 3W | 1 | PL |
| | 4203277-004 | Motor Cover - 4W | 1 | PL |
| 7 | 4203432-002 | 24VDC Motor - 360 Degree | A/R | MO |
| 8 | 4025748 | Product Ejector | A/R | PL |
| 9 | | Augers - See Table 1 | A/R | WF |
| 10 | 4202015 | Auger Coupling | A/R | PL |
| 11 | 4203432-003 | 24VDC Motor - 180 Degree | 2 | MO |
| 12 | 4200164-000 | 8-32x1 1/4 Shoulder Screw | 2 | SC |

PT016

Tray Assembly - 3 & 4-Wide

| ITEM | PART NO. | DESCRIPTION | QTY | CC |
|------|-------------|-------------------------------------|-----|----|
| 13 | 4202624-001 | Spacer Strip | 2 | PL |
| 14 | 4202013 | Foam Tape | A/R | TA |
| 15 | 4202313-007 | Auger - 40 Select Gum & Mint | 2 | AS |
| 16 | 4025797 | Divider | A/R | PL |
| 17 | 4200340 | Helix Retainer | A/R | PL |
| 18 | 8370660-5 | Product Spacer (In Service Package) | A/R | PL |
| 19 | 8370998 | Spacer Support (In Service Package) | A/R | WF |
| 20 | 4200281 | Spring Clip (In Service Package) | A/R | CL |
| 21 | 1200321-002 | Side Rivet Rail Assembly, Left | 1 | RA |
| 22 | 1200321-003 | Side Rivet Rail Assembly, Right | 1 | RA |
| 23 | 4203229-003 | Label Holder - 3W | 1 | PL |
| | 4203229-004 | Label Holder - 4W | 1 | PL |
| 24 | 4203707 | Selection Identification Label | A/R | LA |
| 25 | 4203793-xxx | Dollar Pricing Label - See Table 2 | A/R | LA |
| 26 | 4203341-xxx | Price Scroll - See Table 3 | A/R | LA |
| 27 | 4205749 | Scroll Lock - Bumpers | A/R | RU |
| 28 | 4202625-001 | Helix Tube | 2 | TU |
| 29 | 4203101 | End Cap | 2 | RU |
| 30 | 1200137-147 | Gum & Mint Assembly | 1 | AS |
| 31 | 4205436-001 | Dual Helix Motor | 1 | MO |
| 32 | 4206251 | Product Tray Spacer | A/R | ST |

PT017

TABLE 1. STANDARD AUGERS

| SNACK AUGER | | CANDY AUGER | |
|-------------|-------------|-------------|-------------|
| SELECT | PART NO. | SELECT | PART NO. |
| 10 | 4200272-007 | 15 | 4200272-000 |
| 12 | 4200272-008 | 18 | 4200272-001 |
| 15 | 4200272-009 | 24 | 4200272-002 |
| 7 | 4200272-010 | 30 | 4200272-003 |
| 8 | 4200272-011 | 12 | 4200272-004 |
| | | 9 | 4200272-005 |
| | | 6 | 4200272-006 |
| | | 36 | 4202313 |

PT019

TABLE 2. DOLLER PRICE LABELS (Optional)

| PART NUMBER | DESCRIPTION |
|-------------|-------------|
| 4203793-000 | 0. |
| 4203793-001 | 1. |
| 4203793-002 | 2. |
| 4203793-003 | 3. |
| 4203793-004 | 4. |
| 4203793-005 | 5. |
| 4203793-006 | 6. |
| 4203793-007 | 7. |
| 4203793-008 | 8. |
| 4203793-009 | 9. |

PT026

TABLE 3. PRICE SCROLLS (Optional)

| PART NUMBER | DESCRIPTION |
|-------------|------------------------------------|
| 4203341 | 00 - 95 by 5's |
| 4203341-001 | 10 - 30 by 1's |
| 4203341-002 | 31 - 51 by 1's |
| 4203341-003 | 52 - 75 by 1's |
| 4203341-004 | 76 - 99 by 1's |
| 4203341-005 | 03 - 15 by 1's |
| 4203341-006 | 3 - 12 by 1's + 15, 30, 35 & 36 |
| 4206118 | 1. - 9. by 1's |

PT023

CABINET ASSEMBLY

Tray Assembly - 5-Wide

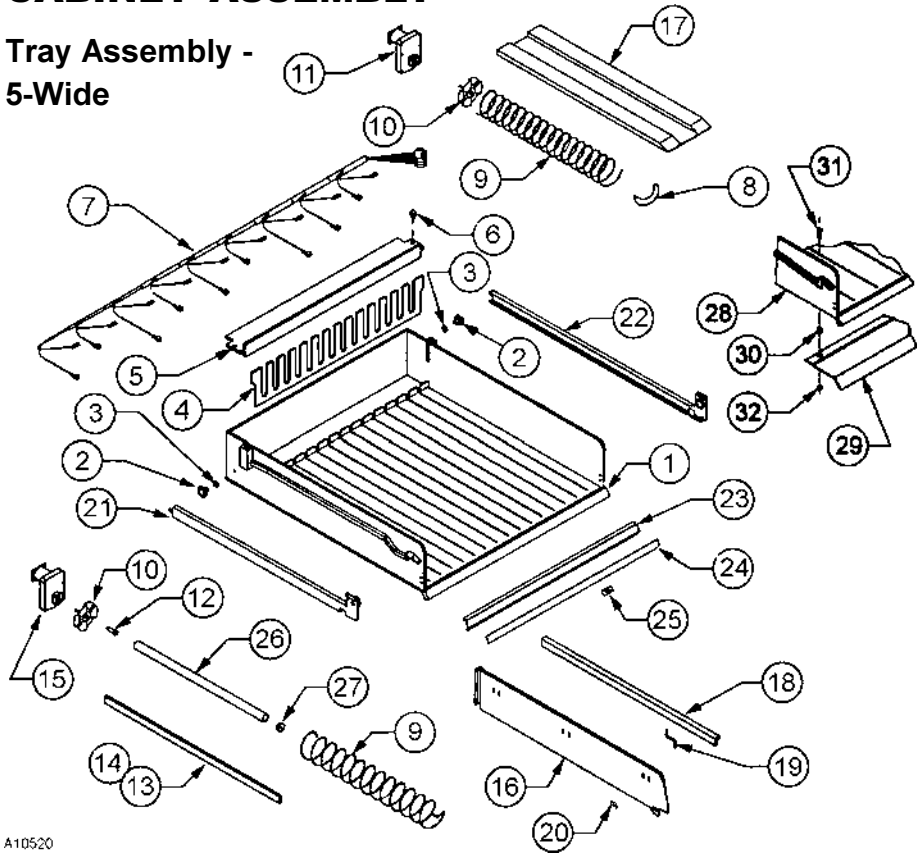

A10520

| ITEM | PART NO. | DESCRIPTION |
|------|-------------|-------------------------------------|
| 1 | 4025798 | Tray Shelf |
| 2 | 4060670-001 | Roller |
| 3 | 8331913 | .254ID x 5/8 OD Washer - for item 2 |
| 4 | 4025799 | Motor Mounting Plate |
| 5 | 4025802-003 | Motor Cover |
| 6 | 8045133 | 8-32 X 3/8 Thumb Screw |
| 7 | 4203989-005 | Tray Harness - 5-W |
| 8 | 4025748 | Product Ejector |
| 9 | 4200272-xxx | Auger -See Table 1 |
| 10 | 4202015 | Auger Coupling |
| 11 | 4203432-002 | 24 VDC Motor - 360 Degree |
| 12 | 4200164-000 | 8-32 X 1 1/4 Shoulder Screw |
| 13 | 4202624-001 | Gum & Mint Spacer Strip |
| 14 | 4202013 | Foam Tape - AP for Item No. 13 |

Tray Assembly - 5-Wide

| ITEM | PART NO. | DESCRIPTION | QTY | CC |
|------|-------------|--|-----|----|
| 15 | 4203432-003 | 24 VDC Motor - 180 Degree - G/M | A/R | MO |
| 16 | 4025797 | Divider | A/R | PL |
| 17 | 4200340 | Auger Retainer | A/R | PL |
| 18 | 8370660-5 | Spacer - (in Service Package) | 4 | PL |
| 19 | 8370998 | Spacer Support - (in Service Package) | 12 | WF |
| 20 | 4200281 | Spring Clip - (in Service Package) | 12 | CL |
| 21 | 1200321-003 | Side Rail - Left Side | 1 | RA |
| 22 | 1200321-002 | Side Rail - Right Side | 1 | RA |
| 23 | 4022408-000 | Label Holder | A/R | PL |
| 24 | 4201209-xxx | Selection Strip - See Table 2 | A/R | LA |
| 25 | | Price Label - See Table 3 | A/R | LA |
| 26 | 4202625-001 | G & M Helix Tube | A/R | TU |
| 27 | 4203101 | End Cap | A/R | RU |
| 28 | 4025798-001 | Tray Shelf (Used as bottom Tray only) | 1 | PL |
| 29 | 4209146 | Tray Deflector - (Used on Bottom Tray only) | 1 | ST |
| 30 | 4209759 | Bushing - (Used on Bottom Tray only) | 4 | BU |
| 31 | 8810034 | 8-32x1 FH MS - (Used on Bottom Tray only) | 4 | SC |
| 32 | 8800956 | 8-32 Hex Nut w/ ETW - (Used on Bottom Tray only) | 4 | NU |

PT020

TABLE 1. STANDARD AUGERS

| SNACK AUGER | | CANDY AUGER | |
|-------------|-------------|-------------|-------------|
| SELECT | PART NO. | SELECT | PART NO. |
| 10 | 4200272-007 | 15 | 4200272-000 |
| 12 | 4200272-008 | 18 | 4200272-001 |
| 15 | 4200272-009 | 24 | 4200272-002 |
| 7 | 4200272-010 | 30 | 4200272-003 |
| 8 | 4200272-011 | 12 | 4200272-004 |
| | | 9 | 4200272-005 |
| | | 6 | 4200272-006 |
| | | 36 | 4202313 |

PT0

TABLE 2. SELECTION STRIPS

| LETTER | PART NUMBER |
|--------|-------------|
| A | 4201209-001 |
| B | 4201209-002 |
| C | 4201209-003 |
| D | 4201209-004 |
| E | 4201209-005 |
| F | 4201209-006 |

PT021

TABLE 3. PRICE LABELS (Optional)

| PART NUMBER | DESCRIPTION |
|-------------------------------|-------------------|
| 4200051 | 1.50 - 3.15 by .5 |
| 4200052 | 10 - 1.50 by .5 |
| 4200052-001 | S/.0.30 - S/.3.00 |
| 4200052-002 | 1500 - 8000 |
| 4203793-000 to 4203793-009 | 0. to 9. |
| 4208548 | \$1 - \$100 |
| 4208548-001 | \$2 - \$10 |
| 4208548-002 | \$1.50 - \$2.00 |
| 4203648 | N\$1.00 - N\$4.50 |
| 4202520-001 | 75Pts - 125Pts |

PT024

