

# **ELECTRO-MECHANICAL CIGARETTE VENDOR**

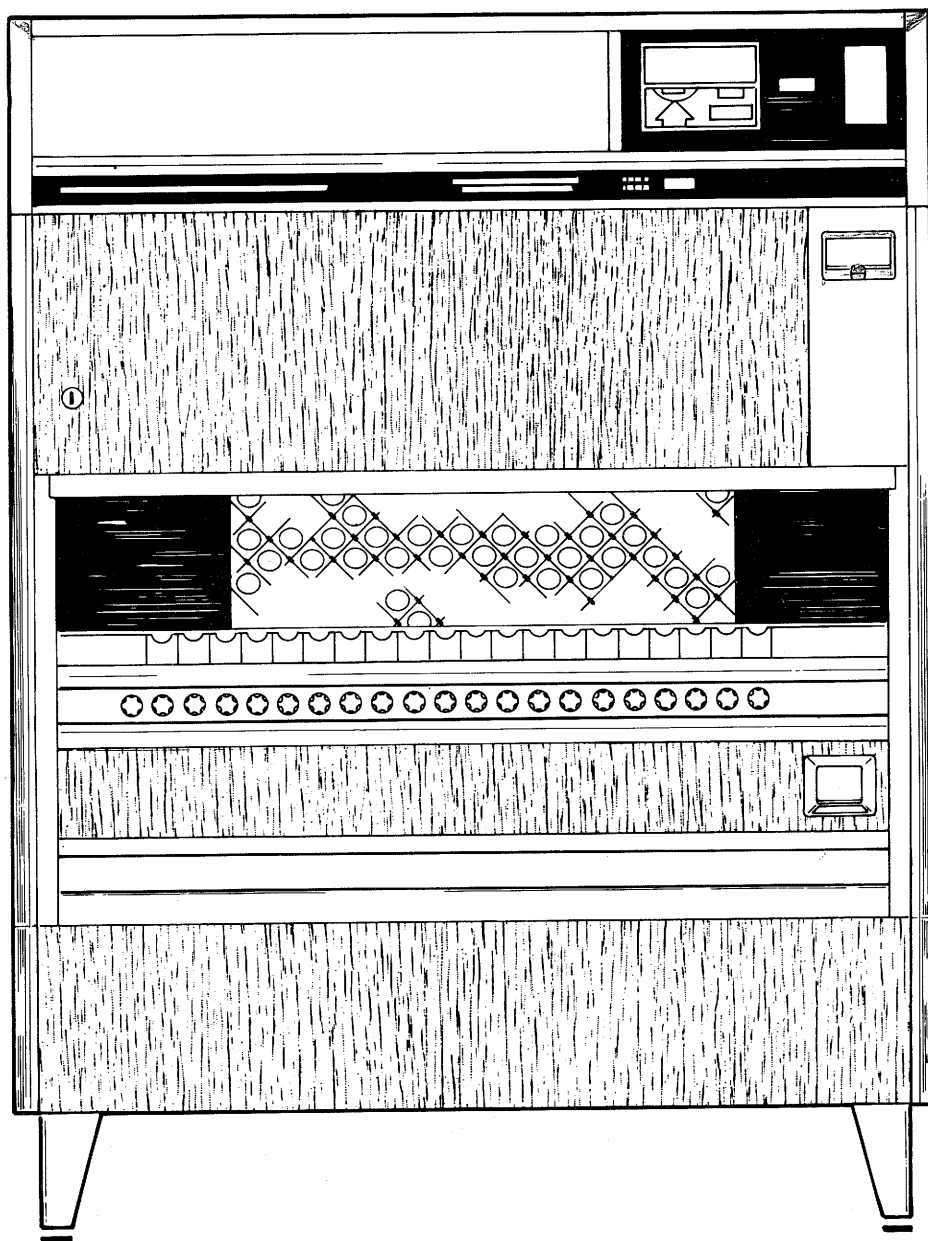

## **SERVICE & PARTS MANUAL**

P/N 20755

# TABLE OF CONTENTS

Introduction .....	3
Specifications .....	3
Installation Instructions .....	3
Grounding .....	4
Level .....	4
Price Setting Instructions .....	5
Loading Instructions .....	
Product Loading .....	6
Selection Labels .....	6
Installation Check List .....	6
Care and Cleaning .....	7
Trouble Shooting .....	7,8
Dollar Bill Validator Service Guide .....	8,9,10
Electrical Functions & Operation .....	11
Wiring Diagram .....	
Electric Cigarette without Validator .....	12
Electric Cigarette w/Validator Interface .....	13
Parts List .....	
Unit Final Assembly .....	14
Unit Final Assembly Parts List .....	15
Complete Vend Mechanism Assembly .....	16
Complete Vend Mechanism Assembly Parts List .....	17
Picture Display Assembly .....	18
Picture Display Assembly Parts List .....	19
Complete Light Assembly .....	20
Complete Light Assembly Parts List .....	20
Wire Harnesses .....	21
Kit & Accessories .....	21
Complete Door Assembly .....	22
Complete Door Assembly Parts List .....	23
Complete Match Stack Dispenser Linkage Assembly .....	24
Match Stack Dispenser .....	25
Installation Instructions for Match Dispensing .....	26

## INTRODUCTION:

This is a combination Service and Parts Manual, containing information on various models and options offered in the 21 Column Electro-Mechanical Cigarette Vendors. One variation is a single price machine, accepting nickels, dimes and quarters, with credit escrow until delivery. Another variation includes a Dollar Bill Validator, which allows acceptance of Dollar Bills, along with nickels, dimes and quarters. All vendors include a lighted credit display which indicates the amount of money deposited during each vend. The capability of vending 21 varieties of cigarettes, Regular, Kings, Hundreds and 120 Lengths, is standard on all machines. Ease of loading and accessibility to the product is due to the "tilt-out" design of the columns and the vend mechanism features a "first-in", "first-out" delivery of the products being dispensed, which insures fresh products in the machine at all times.

## SPECIFICATIONS:

### DIMENSIONS:

51" High  
38" Wide  
21½" Deep

### ELECTRICAL:

115 Volts  
60 Hertz  
.9 Amps

### WEIGHT:

341 pounds

### SELECTIONS:

21 Varieties

### CAPACITY:

525 Packs in Vend Area  
30 to 40 Cartons in Storage

### COINAGE:

Single Price, accepting nickels, dimes and quarters, with a maximum of \$6.35 accumulation for each vend. Vend price is adjustable in 5¢ increments, change pay-back on over deposit when adequate change is available in change tubes. Escrow until vend (Coin Return can be requested at any time prior to actual delivery of product).

Single Price with Dollar Bill Validator. Accepts nickels, dimes, quarters and dollar bills, with a maximum of \$6.35 accumulation for each vend. Vend price is adjustable in 5¢ increments, change payback on over deposit when adequate change is available in change tubes. Escrow until vend (Coin Return can be requested at any time prior to actual delivery of product).

## INSTALLATION INSTRUCTIONS:

### UNPACK:

1. Remove all packing material in a manner not to damage the finish or exterior of the Vendor. To unlock the door, the keys will be found taped inside the Coin Return Cup. Remove all shipping brackets, inner packing material, and tape from the Vendor. To try to operate the vendor without removing the tape from the moving parts may result in damage.
2. Record the Model Number and Serial Number of the Vendor and refer to these numbers on all inquiries and correspondence pertaining to that Vendor.
3. This Vendor was thoroughly inspected before leaving the Factory and the Carrier has accepted this Vendor as their responsibility. Any damages or irregularities should be noted at the time of delivery and immediately reported to the Delivering Carrier. Request a written Inspection Report from the Claims Inspector to file any freight claims for damage. File claim with **CARRIER—NOT with MANUFACTURER.**

## GROUNDING:

To insure safe operation of an electrically equipped vendor, the vendor must be grounded. To verify that the receptacle is properly grounded, connect one probe of the test light to the screw holding the receptacle cover. Insert the other probe into the opening of each outlet. If the test light does not light when placed in either side of the receptacle, the receptacle is not grounded. To provide a proper ground use an adapter which has a ground wire attached. The wire should be connected to a ground such as a water pipe. If the receptacle is grounded, but is not the three-prong type, the adapter may be used. Attach the wire to a ground or to the receptacle cover securing screw. (See Figure 1)

**Receptacle with three (3) female openings;** To verify that the receptacle is properly grounded and polarized, insert one probe of a voltmeter (set to check AC line voltage) or test light, in the ground terminal position "hole" of the 3-position receptacle, insert the other probe (of voltmeter or test light) in the L.H. slot (if ground "hole" is up) or in the R.H. slot (if ground "hole" is down). You should read 115 VAC on the voltmeter, or the light should light. (See Figure 2)

If you find this is not the result, you should contact a licensed electrician to correctly polarize and/or ground the receptacle to insure safe operation.

Consult Local, State and Federal Codes for compliance before installation of the vendor.

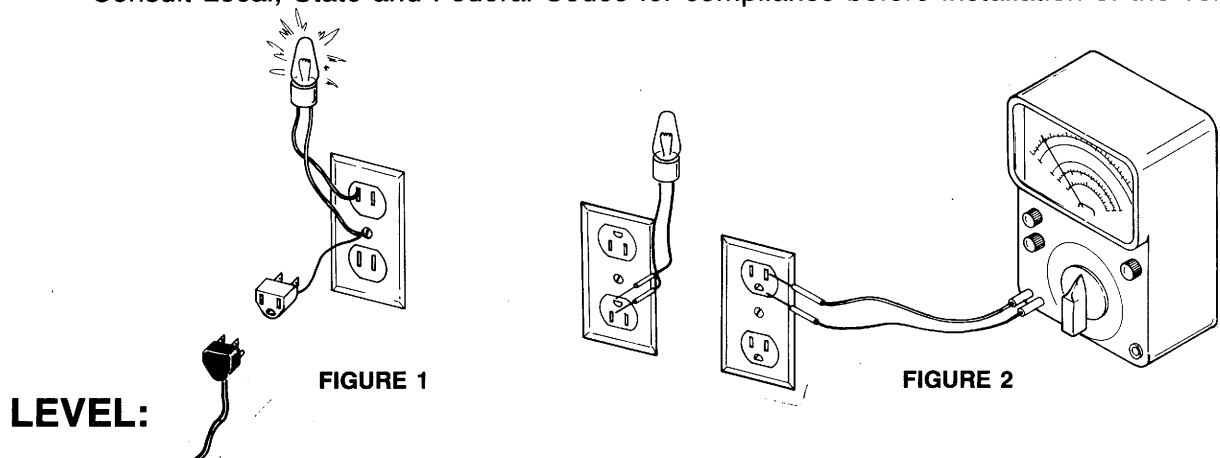

Shipped in the Storage Compartment are two (2) sets of legs. To mount the legs, tilt the machine so that one side is raised off the floor approximately eight (8) inches. Place one set of legs under the machine with the legs to the outside and secure with the fasteners provided. Repeat this procedure for the opposite side.

Position the Vendor in its place of operation. Level the Vendor, making sure all levelers are touching the floor. The Vendor **MUST** be level for proper operation and acceptance of coins through the Coin Mechanism. If the Vendor is properly leveled, it should not rock or teeter on any of the Levelers. (See Figure 3)

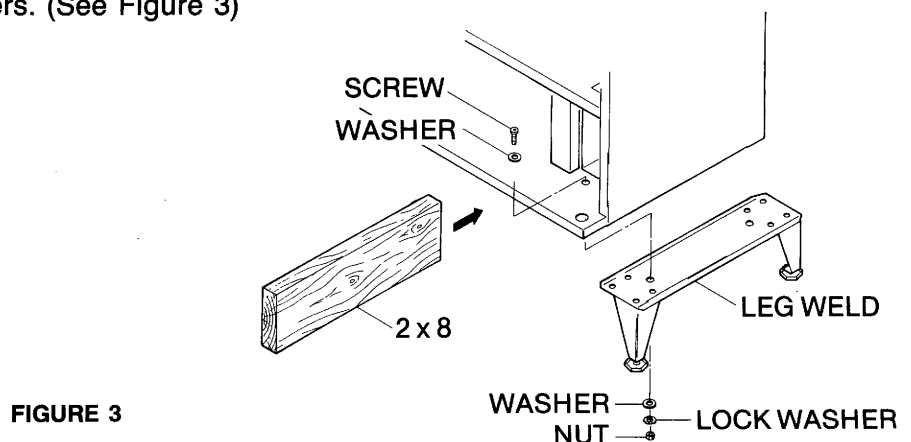

# PRICE SETTING INSTRUCTIONS:

## MARS COIN MECHANISM: (See Figure 4)

1. Unplug Coin Mechanism.
2. Lower Acceptor assembly by depressing both spring clips and rotating Acceptor forward and down.
3. The Price Switch Module has seven miniature slide switches, numbered one (1) thru seven (7). Make sure all switches are in the "OFF" position (down). These switches correspond to prices as follows: 1 = 5¢, 2 = 10¢, 3 = 20¢, 4 = 40¢, 5 = 80¢, 6 = \$1.60, 7 = \$3.20. Set the Vend price by adding the value of the switches in the "ON" (up) position.

**EXAMPLE:** Switches #1 and #3 are "ON" = 25¢ Vend Price. To set switches, use a retracted ball point pen or a small screwdriver. **DO NOT USE A GRAPHITE PENCIL POINT.**

4. Set Coin Control Switches on Acceptor, using a retracted ball point pen or small screwdriver. **DO NOT USE A GRAPHITE PENCIL POINT.** The functions of these switches are as follows:
  - CAN/US - Accepts both Canadian & U.S. Coins
  - U.S. ONLY - Accepts U.S. Coins only.
  - HI 25¢ - Stores 66 Quarters in Change Tube.
  - LO 25¢ - Stores 6 Quarters in Change Tube.
  - NO \$ ACPT - Rejects Dollar Coin.
  - \$ ACPT - Accepts Dollar Coin.
5. Set Escrow Control Switches located on the Control Board/Back Plate assembly:
  - CIGARETTE MODE** = Allows Escrow until Delivery (Coin Return can be requested at anytime prior to actual delivery of product).
  - STANDARD MODE** = Allows Escrow until Vend (Coin Return can be requested at anytime prior to reaching the Vend Price).
6. Connect power plug. Position or clamp clear of coin cup and coin return lever. Check to see that the "Blocker" light is illuminated indicating that the vendor C.R.E.M. Circuit is completed and the changer is ready to accept coins.
7. Install Acceptor assembly in coin changer housing. Check to insure **ACCEPTOR IS PROPERLY SEATED WITH BOTH SPRING CLIPS ENGAGED.**
8. Fill coin tubes to desired levels by inserting coins into coin tube loading slots located on the front of the coin tubes. Minimum coin levels:
  - 6 Nickels – 7 Dimes – 6 Quarters (**NOTE:** When used with a Dollar Bill Validator, the Quarter Level Switch should be at the "HI 25¢" position).

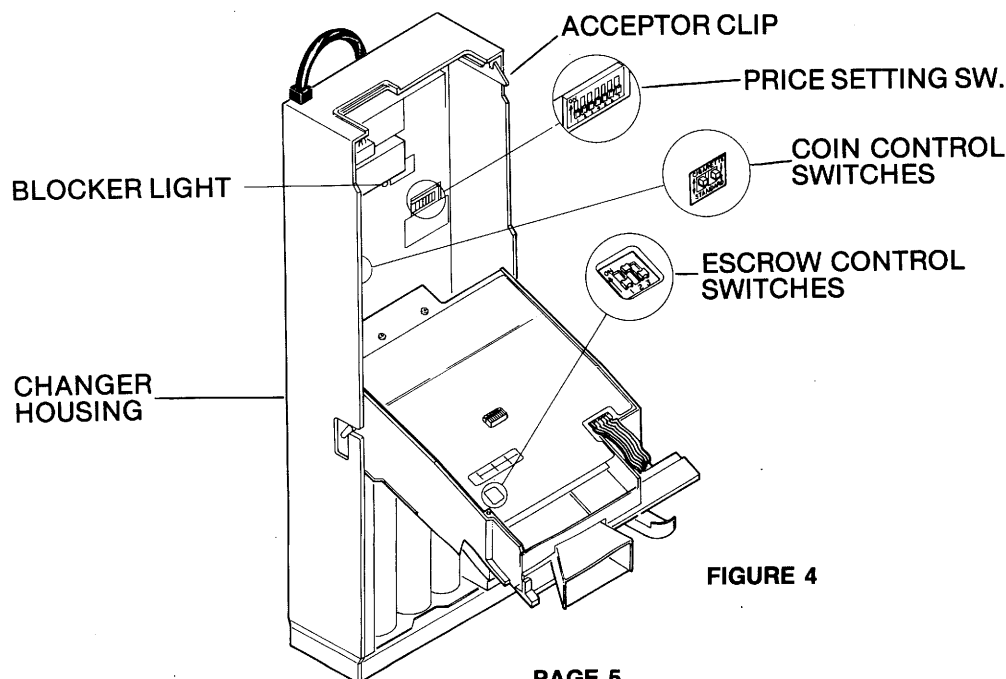

FIGURE 4

## LOADING INSTRUCTIONS:

Load each column or selection with the brand of cigarettes desired. The selections alternate from the back stack to the front stack, starting from either side of the vendor. The Pull Knobs alternately operate the front and back columns, beginning from either side. To tilt the stacks forward for loading, push in on the bottom of the stack latches (Item 71, Page 18) and pull forward on the stack. Regulars or Kings can be loaded in the front stacks. In the eight (8) left rear stacks, Kings or 100's are required. The three (3) right rear stacks are for 100's or 120's.

Price tabs, cigarette identification labels, etc. are packed in the coin box. Insert the cigarette identification labels in the holders on the door. The Pull Knob of each selection lines up with the specific display window, the identification label slips into the slot behind the display window (See Figure 5a).

Insert the correct Vend Price Label in the price label window directly below the coin insert casting.

Be **SURE** to place the right Selection Label in the correct holder in the door and that the correct price decal has been placed in the Pricing Window.

**WARNING:** The Vendor will not accept 25 Count packages.

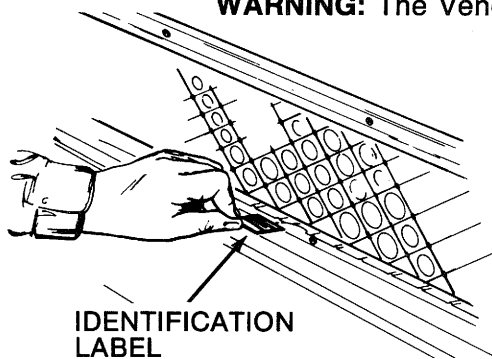

FIGURE 5a

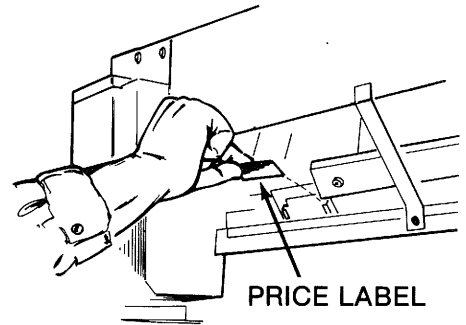

FIGURE 5b

## IMPORTANT:

After loading, make sure that the products in each selection corresponds to the Selection Label and the Vend Price is set correctly.

## INSTALLATION CHECK LIST:

Make certain the following steps have been taken or these conditions exist before starting the vendor in operation:

1. All shipping brackets, packing material and tape have been removed.
2. Vendor is properly located for access to power source outlet and Vendor is level.
3. All components are installed on the Vendor and are in good condition.
4. Service Cord plug-in receptacle is grounded, or ground adapter has been installed.
5. Coin Mechanism adjustments have been made, is necessary, and Vend Price has been properly set.
6. Vendor has been properly loaded and the Brand in each selection corresponds to the Vend Price and the Selection Label.

## WARNING:

This Vendor is equipped with a 5 Amp circuit breaker to protect the Vending Circuit only. Refer to Wiring Diagram for the position of this Circuit Breaker.

## CARE AND CLEANING:

Disconnect Vendor from power source.

- Cabinet Exterior: Wash with warm water and soap. Occasionally wax with a good auto wax.
- Cabinet Interior: Clear out any foreign particles from the delivery pan. If needed, use a damp sponge and wipe dry.
- Windows: Use any type of plastic window cleaner.
- Acceptor-Micro-Mech: Coin Ramp and the back of the Acceptor Lid should be kept clean at all times. Use a damp cloth only. For problem cleaning, use a cloth dampened with water and soap.

**WARNING:** Do not use solvents, steel wool, scouring pads, etc., or a metal bristle brush. Do not spray with any type of lubricant.

## TROUBLE SHOOTING:

- I. Vendor rejects all coins – Display Lamp off.
  - A. Vendor unplugged – plug in vendor.
  - B. Fuse or Circuit Breaker tripped in supply (building) outlet - Replace or reset Circuit Breaker.
  - C. Damaged or defective Power Cord – Repair or replace power cord.
  - D. White and/or Black wire unplugged by Circuit Breaker – Plug in wires.
  - E. Door Harness unplugged at Cabinet – Make sure the plugs are securely locked together.
  - F. Circuit Breaker in vendor tripped or defective – Reset or replace Circuit Breaker.
  - G. Circuit Breaker in vendor unplugged – Plug in Circuit Breaker.
  - H. White and/or Black/White wire is damaged – Repair wire or replace harness.
- II. Vendor rejects all coins - Display Lamp on.
  - A. Control Bar is not in standby position – Return control bar to standby position by eliminating any bind or drag.
  - B. Loose or broken wire on Coin Mechanism Reset Control Switch (See wiring diagram) – Repair wire or replace harness.
  - C. Defective Coin Mechanism – Repair or replace Coin Mechanism.
  - D. Vendor is not level – Level Vendor.
  - E. Coin Acceptor dirty – Clean Acceptor.
- III. Vendor accepts coins, but does not vend any selection.
  - A. Loose or broken wire on solenoid switch (See wiring diagram) – Repair wire or replace harness.
  - B. Solenoid Switch defective or out of adjustment - Adjust Switch or replace. (See Fig. )
  - C. Pull Bar Plate out of adjustment – Adjust Pull Bar Plate.
  - D. Vend Price set incorrectly – Check price setting in Coin Changer.
  - E. Defective Coin Mechanism – Repair or replace Coin Mechanism.
  - F. Loose or broken wire on Vend Solenoid – Repair wire or replace harness.
  - G. Defective Vend Solenoid – Replace Vend Solenoid.
- IV. Vendor accepts coins, but does not vend on one or more selections.
  - A. Selection SOLD-OUT – Load Selection.
  - B. Selection Pack Pusher not pivoting – Loosen Pack Pusher and adjust until it pivots freely up and down.
  - C. Shift Key for that selection locked up – Loosen Shift Key and adjust until it pivots freely back and forth.
  - D. Pull Bar bent – Straighten or replace Pull Bar.

- V. Vendor vends properly, but pays back improper or no change.
  - A. Vend Price set incorrectly – Check price setting in Coin Changer.
  - B. Coin Mechanism out of change – Fill changer tubes.
  - C. Defective Coin Mechanism – Repair or replace Coin Mechanism.
  - D. Reset Switch defective or out of adjustment (See wiring diagram) – Adjust switch or replace.
- VI. Product does not match selection pulled.
  - A. Product loaded incorrectly – Check columns for proper loading.
- VII. Vendor “Free” vends or vends more than one selection.
  - A. Defective Coin Mechanism – replace or repair Coin Mechanism.
  - B. By pulling two (2) Knobs at same time – Check to assure all Shift Keys move freely and are not jammed.
  - C. Broken Control Bar – Replace Control Bar.
  - D. Reset Switch defective or out of adjustment (See wiring diagram) – Adjust switch or replace.
- VIII. Pull Bar does not return correctly.
  - A. Rocker Arm Anti-Cheat out of adjustment – Adjust Anti-Cheat to clear Pull Bar Fingers.
  - B. Pull Bar rubs Pull Bar Plate – Loosen (4) screws holding Pull Bar Plate and adjust.
  - C. Control Bar is binding or dragging – Eliminate bind or drag.
  - D. Control Bar return springs are broken or disconnected – Reconnect or replace.
- IX. Vends with excessive force.
  - A. Pull Bar rubbing against Pull Bar Plate – Loosen (4) screws holding Pull Bar Plate and adjust.
  - B. Control Bar is binding or dragging – Eliminate bind or drag.
  - C. Shift Keys are binding – Free up Shift Key.

## DOLLAR BILL VALIDATOR:

When a bill is inserted, the carrier motor rotates and the bill is drawn in on the belt. The information detected by the photo sensor and magnetic sensor, when the bill is drawn in, is sent to the control board for discrimination.

If the bill is authentic, a vend signal is output and the bill is stacked. If the bill is counterfeit, the carrier motor rotates in reverse and the bill is returned.

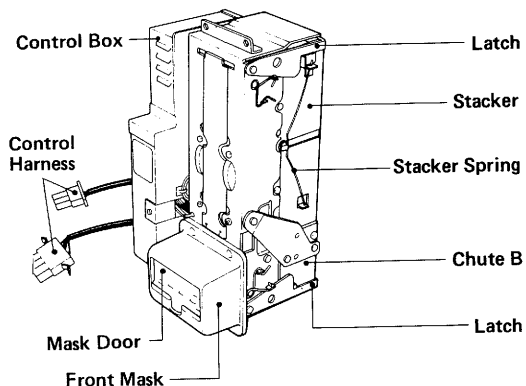

FIGURE 6a

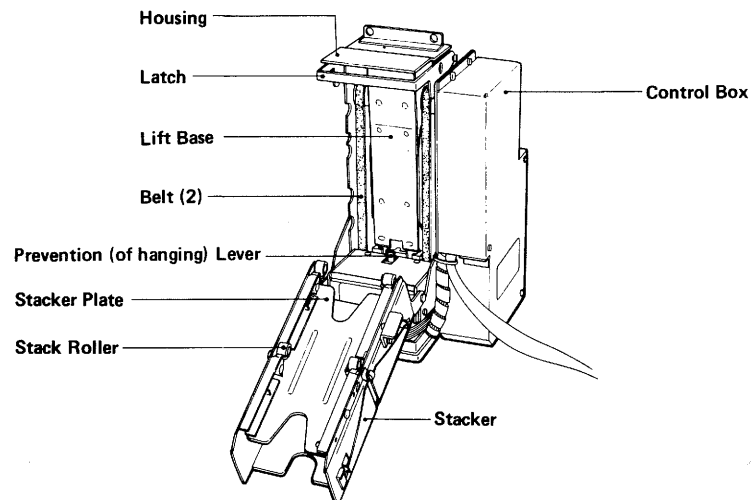

FIGURE 6b



## GENERAL SPECIFICATIONS:

1. Accepts U.S. \$1.00 Bills.
2. Cycle duration, approximately 2.1 seconds.
3. Power source or requirements – 117 VAC, 60 Hz.
4. Bills must be inserted “face” up.
5. When a \$1.00 bill is inserted, the bill is automatically drawn and discriminated.
6. If the bill is authentic, it will be automatically accepted and stacked; if judged to be counterfeit it will be returned.
7. Stacker capacity approximately 115 bills.

## OPERATION WARNING:

1. Use only 117 VAC, 60 Hz power source.
2. Exposure to dirt and rain will cause break-down.
3. Be sure the stacker is firmly engaged. Push in the stacker until it latches.
4. Do not place in a location where exposed to extremes of heat, humidity and dust.
5. Taking apart will result in breakdown and voiding the warranty. Refrain from taking apart.
6. Motion and movement of stacker must be free. If the working pieces are disturbed, they will not be able to stack bills.

## MAINTENANCE AND OPERATION:

### HOW TO USE:

1. The following instructions should be followed when removing bills from the stacker or removing foreign matter or jammed bills from the validator or stacker.

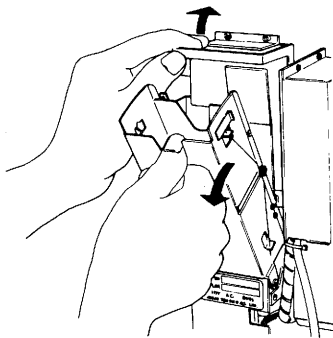

**FIGURE 7a**

Push up the latch and pull down the stacker.

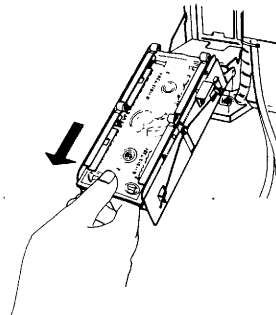
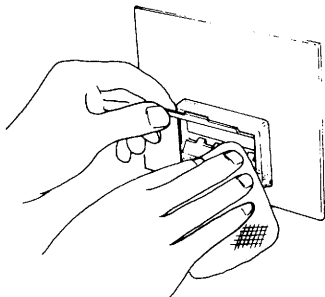

**FIGURE 7b**

Take hold of the bills and pull them out. (Warning: Be sure to re-set stacker to original position.)

### CLEANING:

If the moving parts become dirty, get wet, or stuck with foreign particles, proper operation cannot be maintained. Clean according to the requirements of the situation. Do not use oils, lubricants, etc. The validator does not require any adjustments. To clean use a soft cloth or applicator with alcohol.



**FIGURE 8**

Wipe Bill Insertion Opening with a soft cloth.

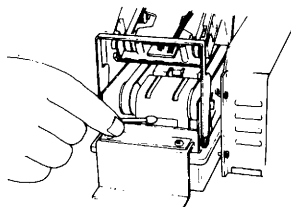

**FIGURE 9**

Clean the photo-sensor and magnetic heads with an applicator.

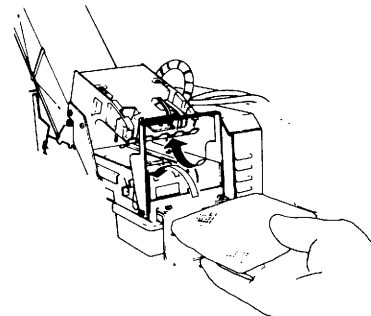

**FIGURE 10**

Wipe clean the chute roller, and belt with a soft cloth.

## OPERATION AND TROUBLE SHOOTING:

A. Bills will not accept or is rejected after insertion.

1. Is the stacker and/or Chute "B" (Fig. 6b) separated from the validator body? Re-attach them properly using the latch.

2. Are the photo-sensor and magnetic heads dirty? Clean them.

3. Is there a bill jammed in validator or stacker? Remove jam.

The following illustrations will assist in removing jammed bills or foreign matter from the validator or stacker.

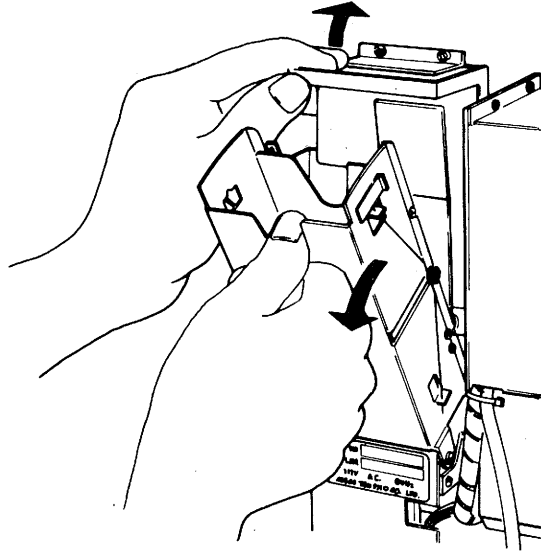

**FIGURE 11**

Push up the latch and pull down the stacker. If full of bills, withdraw them. Remove any bills or foreign matter clogging the stacker.

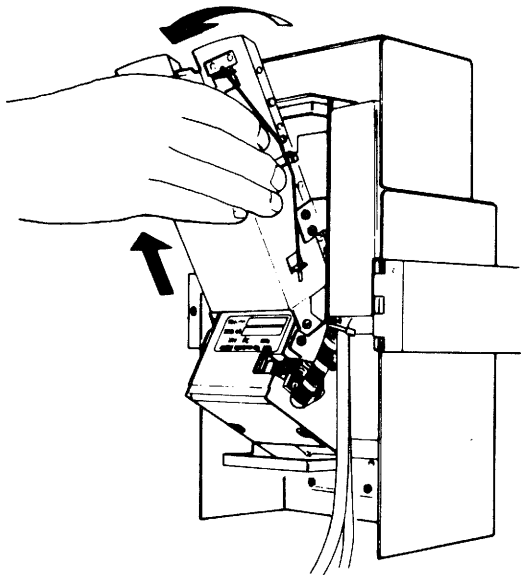

**FIGURE 13**

Press down the latch and pull up the stacker.

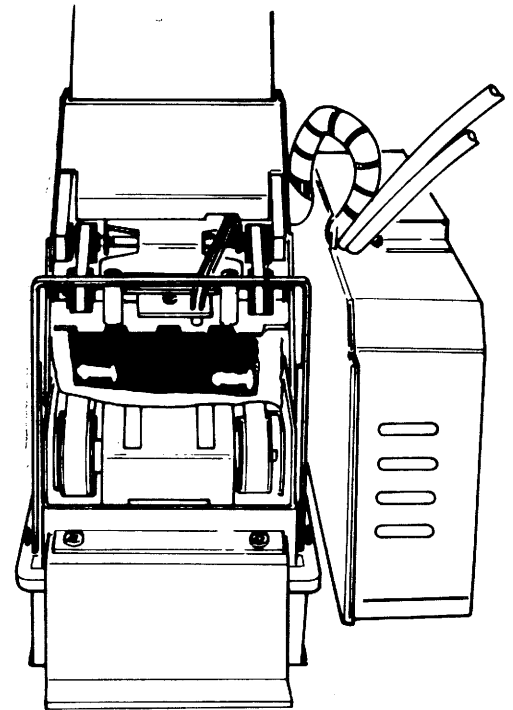

**FIGURE 12**

Remove any bills or foreign matter clogging the stacker. Cut the power off and turn it on again. (Warning: Be sure to return stacker to original position.)

# ELECTRICAL FUNCTIONS AND OPERATION:

## VEND SOLENOID:

The Vend Solenoid will be energized when any Selection Knob is "pulled" and adequate credit has been established in the Coin Mechanism. The solenoid will remain energized until the vend mechanism has traveled far enough to operate the Reset Switch. The Vend Solenoid must be energized before the Control Bar Assembly is locked. See Note #1 below for range.

## SOLENOID SWITCH:

The Solenoid Switch, when in the Normal Closed (N.C.) position, will complete the circuit to the Vend Solenoid. With adequate credit established, when a Selection Knob is "pulled", the Ratchet Extension Weld will be moved away from the Solenoid Switch actuator, allowing it to actuate (N.C.), completing the circuit to the Vend Solenoid. See Note #1 below.

## COIN MECH RESET CONTROL SWITCH:

The Reset Switch will reset or cancel credit to the Coin Changer after the vend mechanism has traveled far enough into the vend cycle. This switch must actuate to the Normal Open (N.O.) position within the range shown in Figure . Also refer to Note #2 below.

### NOTE #1

Solenoid Switch must be actuated before a mechanical bind of Control Bar and Control Arm Ass'y.

### NOTE #2

Reset Switch must operate within shaded area.

FIGURE 13

## SOLENOID SWITCH ADJUSTMENT

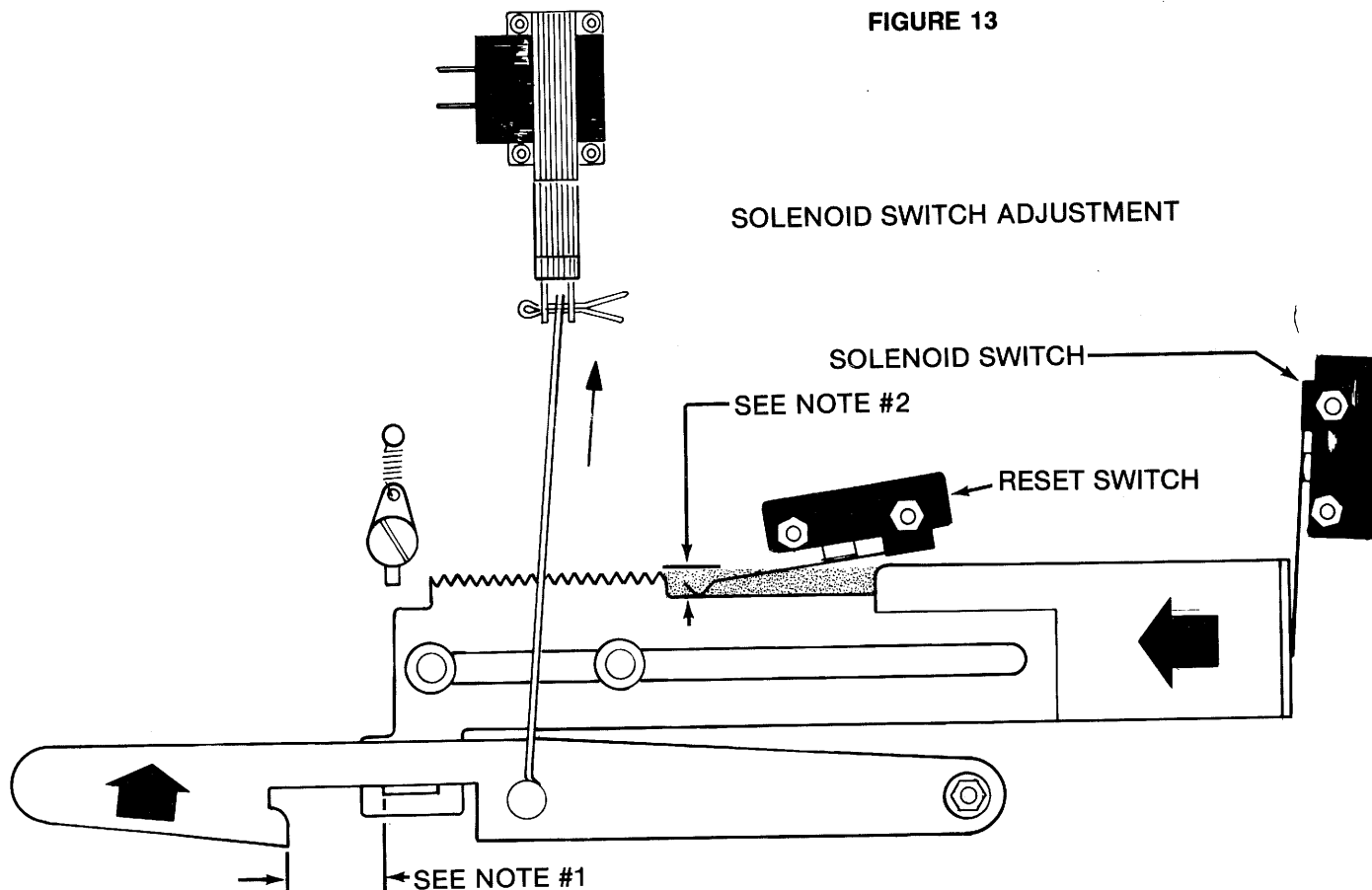

MOD. No. 2090  
**FLEETWOOD II**  
 PART NO. 20795

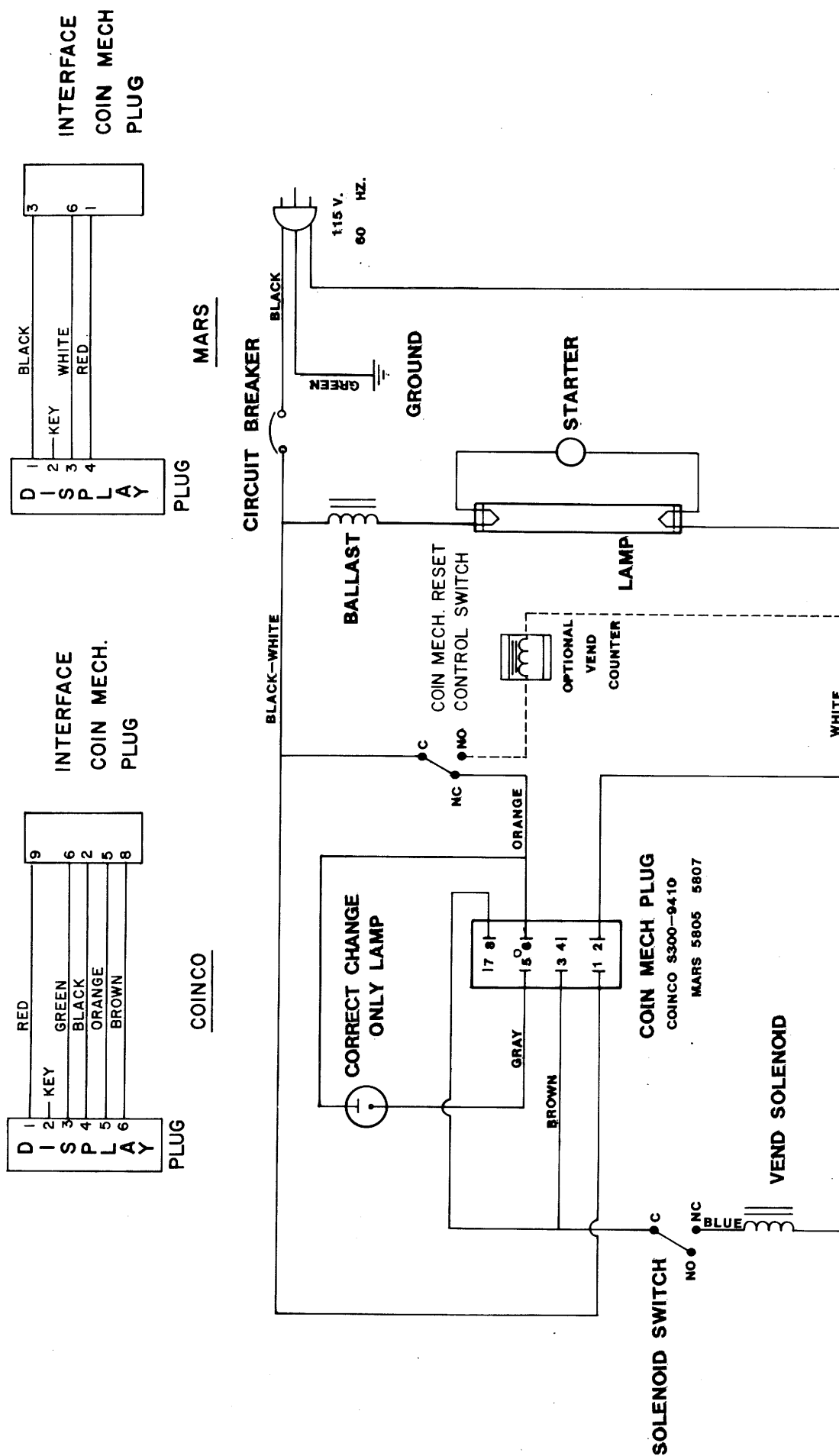

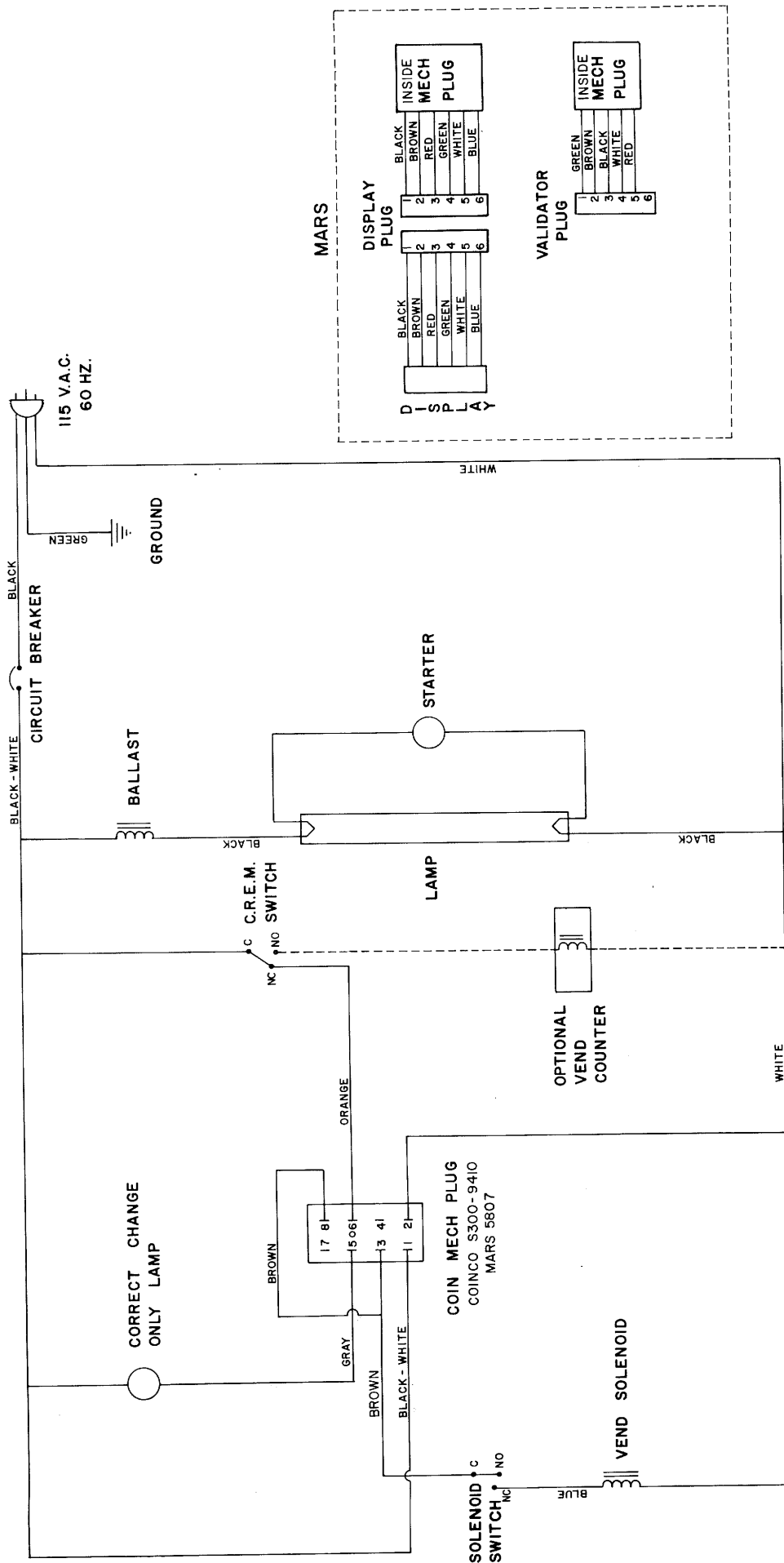

# WIRING DIAGRAM

Mod. No. 2096

P/N 20809

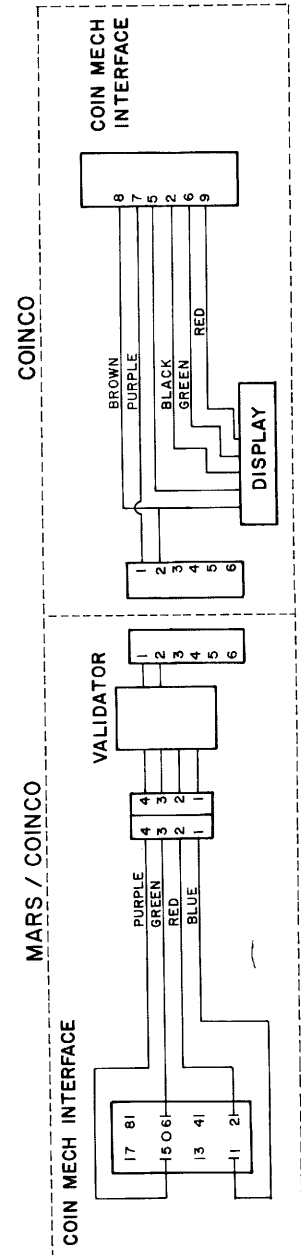

# UNIT FINAL ASSEMBLY

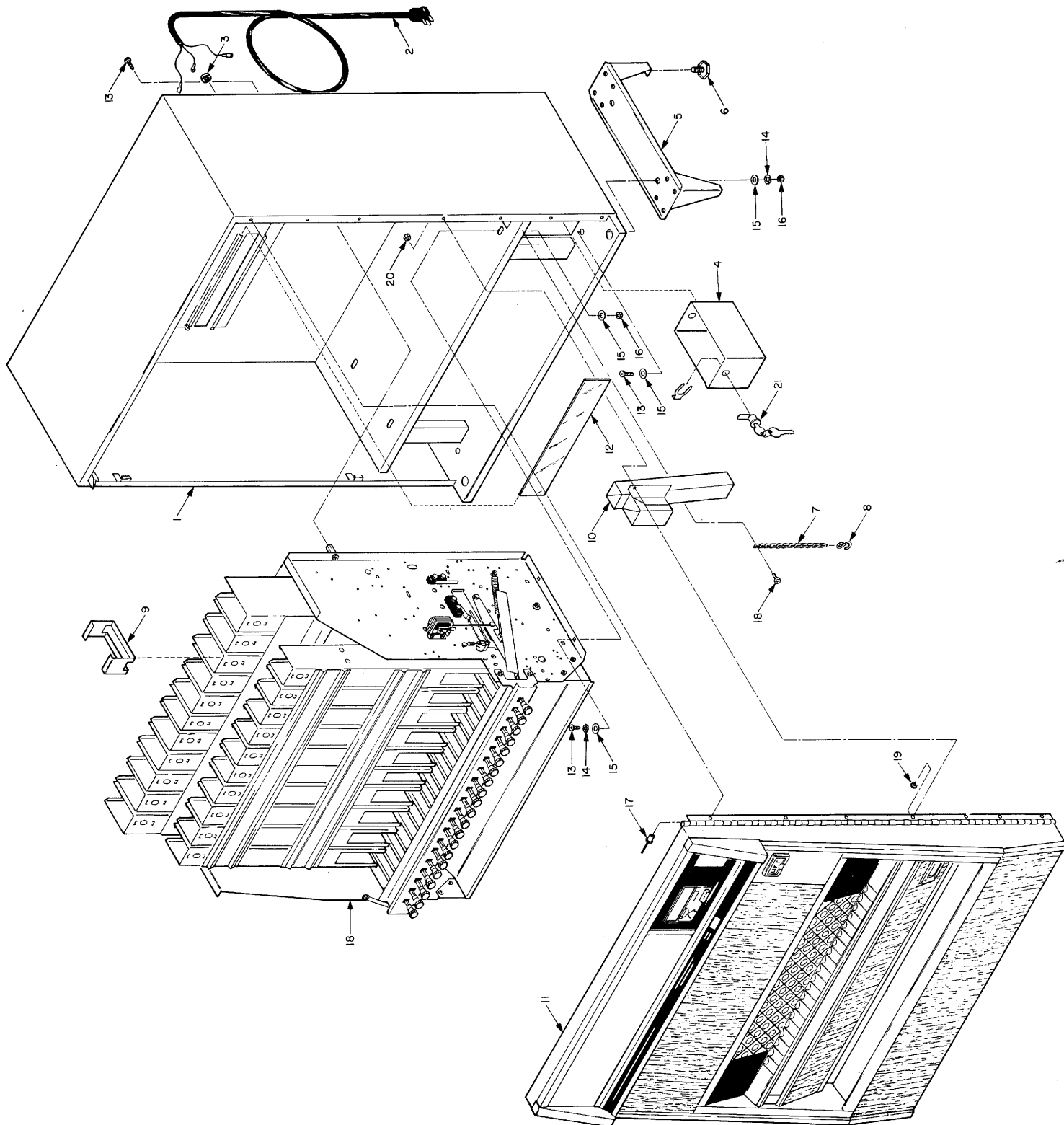

Item	Part No.	No. Req'd	Description
1	100051-001	1	Cabinet Weld Ass'y.
2	33631	1	Power Cord
3	33689	1	Cord Relief Bushing
4	102292	1	Cash Box Weld
5	100741	2	Leg Plate Weld Ass'y.
6	60202	4	Leg Leveler
7	60082	6"	#30 Sash Chain
8	60073	2	"S" Hook
9	9976	3	Stack Weight
10	102469	1	Coin Chute Weld Ass'y.
11	102497	1	Door Final Ass'y.
12	25002	2	Back Inspection Window

Item	Part No.	No. Req'd	Description
13	50361	2	1/4-20 x Slit. Round Hd.
14	50593	2	1/4-Ext. Shake Proof Lockwasher
15	50594	2	1/4 Flat Washer
16	50531	AS REQ'D	1/4-20 Nut
17	50663	6	Pop Rivet
18	50240	AS REQ'D	8-32 x 3/8 Phil Pan HD M.S.
19	50423	AS REQ'D	#8-3/8 Phil Pan HD S.M.S.
20	50513	AS REQ'D	8-32 Twin Whiz Nut
21	60366-XXX	1	Lock
22	20034		Label - "Mech Must Be Level"

# COMPLETE UNIT MECHANISM ASSEMBLY

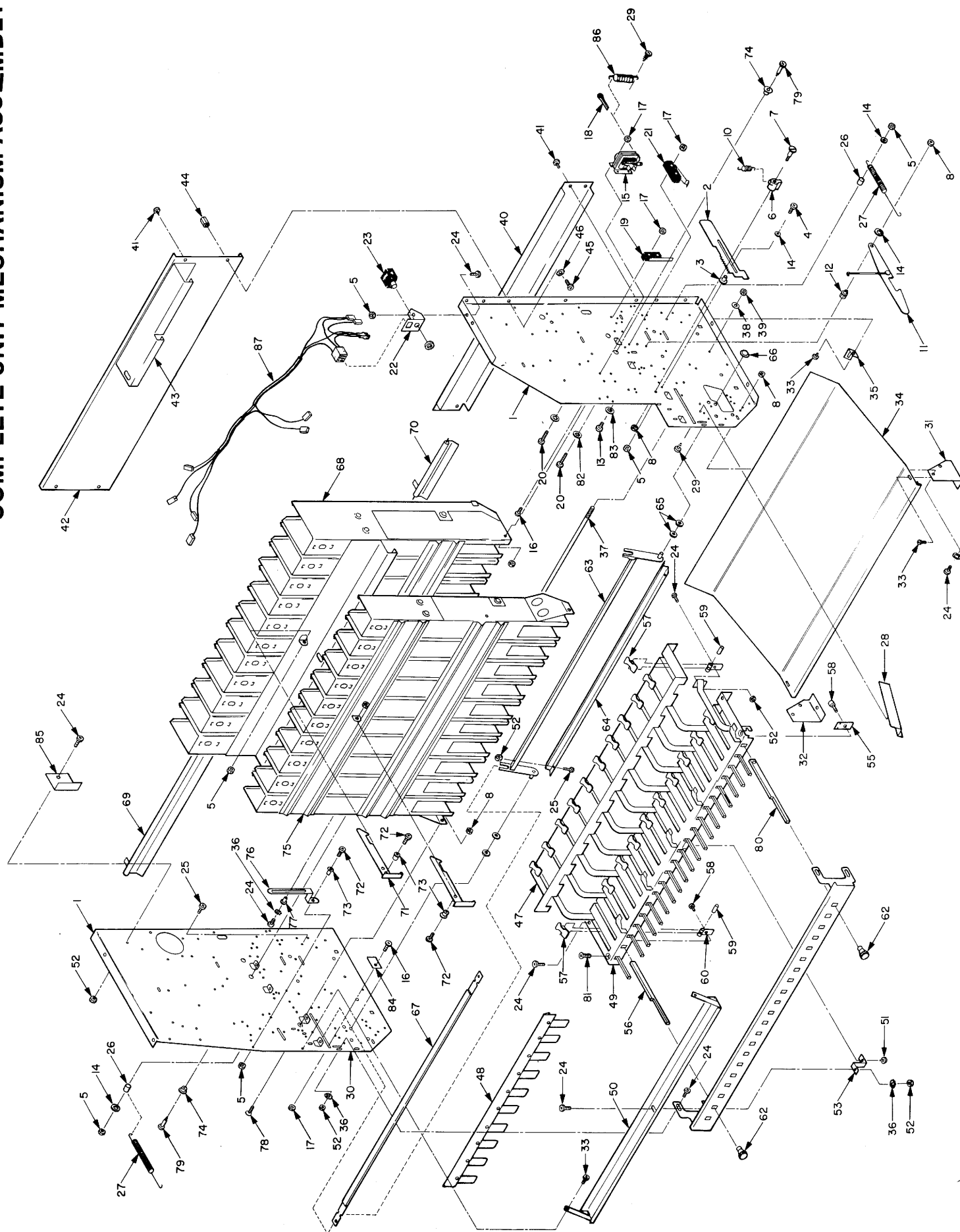



Item	Part No.	No. Req'd	Description
1	3796	1	End Plate Right
2	102618	1	Ratchet Extension Weld
3	30390	2	Ratchet Slide Bushing
4	50251	2	#8-32 x 5/8 Phil Pan Hd M.S.
5	50494	2	#8-32 Unitorque Locknut
6	6483	1	Ratchet Pawl
7	30038	1	Ratchet Pawl Stud
8	50495	AS REQ'D	#10-32 Unitorque Locknut
9			
10	21021	1	Ratchet Pawl Spring
11	102678	1	Control Bar Stake Ass'y.
12	30007	1	Control Bar Latch Bushing
13	50344	1	#10-32 x 1" Phil. Rd. Hd. M.S.
14	50575	2	Watkins Washer
15	33635	1	Solenoid
16	50122	4	#6-32 x 3/8 Phil. Pan Hd. M.S.
17	50493	AS REQ'D	#6-32 Unitorque Lock Nut
18	50650	1	1/8 x 1" Steel Cotter Key
19	34259	1	Cherry Switch
20	50149	AS REQ'D	#6-32 x 1" Phil. Rd. Hd. M.S.
21	34260	1	Cherry Switch (Formed)
22	3621	1	Circuit Breaker Brk't.
23	33620	1	Circuit Breaker 5 Amp
24	50240	AS REQ'D	#8-32 x 3/8 Phil Pan Hd. M.S.
25	5027	1	#8-32 x 1" Phil. Pan Hd. M.S.
26	30079	1	Spacer
27	21039	1	Control Bar Spring
28	3848	1	Anit-Cheat
29	50202	AS REQ'D	#8-18 Phil Hd. Trek
30	8705	1	End Plate - Left
31	7344-000	1	Delivery Pan Brk't. - Right
32	7344-001	1	Delivery Pan Brk't. - Left
33	50426	AS REQ'D	#10 x 1/4 Ind. Phil Hex Type "g" S.M.S.
34	6589	1	Delivery Pan
35	9993	2	Delivery Pan Brk't.
36	50585	AS REQ'D	#8-Ext. Shakeproof
37	30088	1	Tie Rod
38	50594	2	1/4 Flat Washer
39	50546	3	#10-32 Twin Whiz Nut
40	5099	1	Bottom Back Brace
41	50434	4	#14 x 3/8 Hex Hd. Type "B" S.M.S.
42	5091	1	Top Back Brace
43	9990	1	Back Brace Spacer

Item	Part No.	No. Req'd	Description
44	30035	2	Tie Down Space
45	50361	2	1/4-20 x 1/2 Slt. Rd. Hd.
46	50593	2	1/4-Ext. Shake Proof Lockwasher
47	51212	1	Back Mech
48	100190	1	Pack Deflector Rivet Ass'y.
49	102031	1	Mech Plate Stake Ass'y.
50	100089	1	Anti-Cheat Channel Welf Ass'y.
51	50420	1	#8-32 x 1/4 Ind. Phil Hex Type "B"
52	50513	2	#8-32 Twin Whiz Locknut
53	6851	1	Anti-Cheat Center Support
54	5105	11	Pull Bar Extension
55	5107	11	Pull Bar Guide
56	6125	10	Pull Bar
57	5087	21	Pusher
58	50236	21	#8-32 x 3/8 Socket Hd.
59	50725	21	Roll Pin
60	5117	21	Pull Bar Clevis
61	101347	1	Pull Bar Plate Ass'y.
62	30205	21	Pull Bar Knob
63	100198	1	Rocker Arm Bar Weld Ass'y.
64	5094	1	Rocker Arm Anti Cheat
65	50608	4	Rocker Arm Washer
66	50566	1	Tinnerman Cap Type Speed Nut
67	100225	1	Control Bar Weld Ass'y.
68	101560	1	Back Stack Ass'y. 100/120MM
69	100118	1	Pack Deflector Weld Ass'y. 100MM
70	101573	1	Pack Deflector Weld Ass'y.
71	100750	2	Stack Latch Weld Ass'y.
72	50247	1	#8-32 x 1/2 Phil Pan Hd. M.S.
73	30053	AS REQ'D	Shoulder Bushing
74	30032	2	Bushing for Rear Stack Hinge
75	100199	1	Front Stack Weld Ass'y.
76	5106	2	Front Stack Slide Stop
77	30050	2	Stack Holding Arm Bushing
78	50336	2	#10 - 32 x 7/8 Flat Head Phil Head Cap Screw
79			
80	100112	11	Rear Pull Bar Ass'y.
81	50232	2	#8-32 x 3/8 Phil Flat Hd. M.S.
82	50580	2	#6 Internal Lockwasher
83	50589	1	#10 Internal Lockwasher
84	9704	2	Plate-Control Bar Stop
85	4286	1	Rear Stack Stop
86	50202	1	#8-18 Hex Hd. Trek
87	34266		Chassis Harness

# PICTURE DISPLAY ASSEMBLY P/N 102670

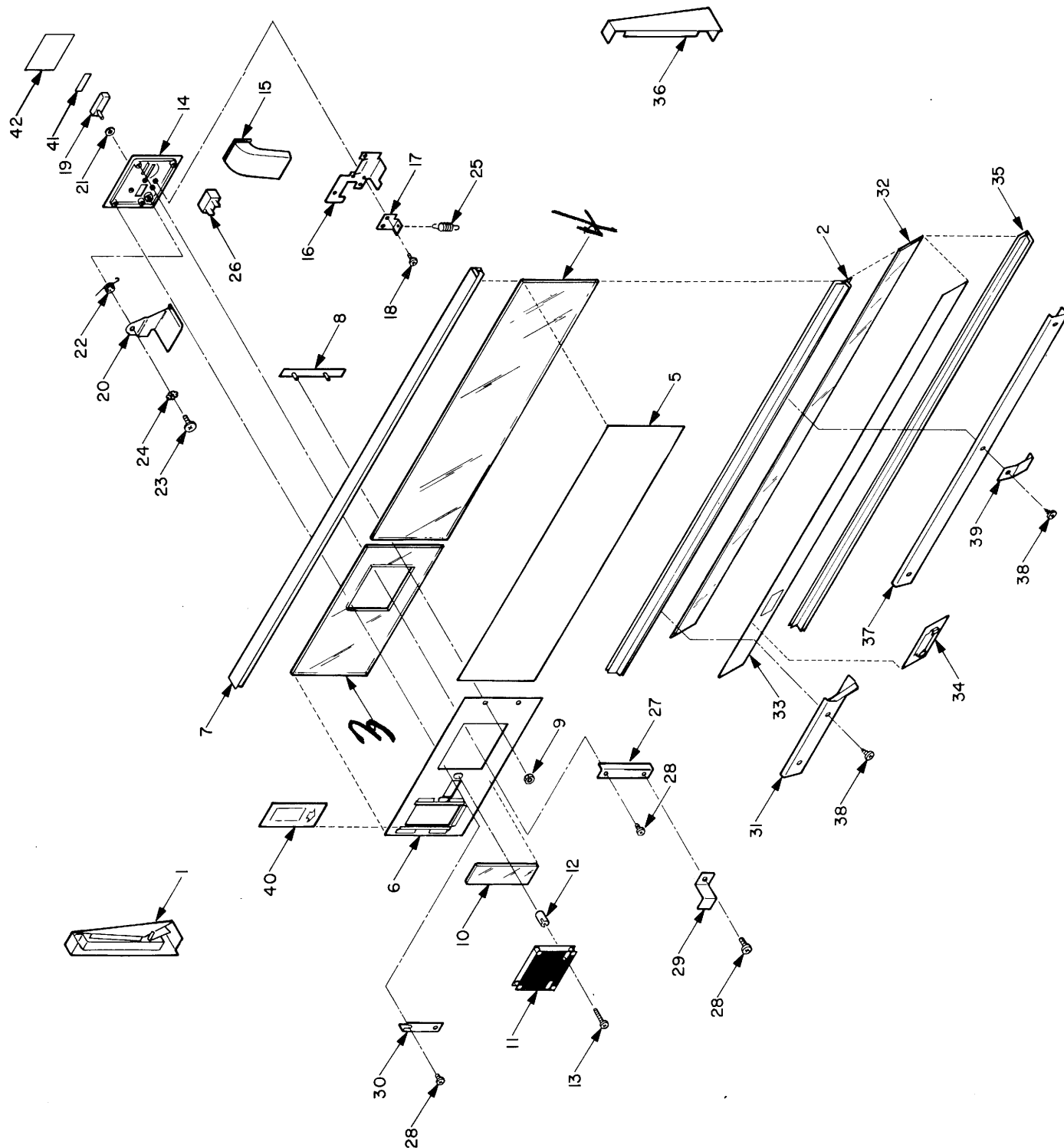

Item	Part No.	No. Req'd	Description
1	100013-000	1	Picture End Ass'y.
2	22196	1	Middle Picture Molding
3	25686	1	Picture Window
4	25701	1	Insert Panel
5	20797	1	Cigarette Picture
6	102617	1	Logo Support Weld
7	22372-000	1	Top Picture Molding
8	102467	1	Header Divider Weld Ass'y.
9	50513	2	#8-32 Twin Whiz Nut
10	25695	1	L.E.D. Display Lens
11	34246	1	L.E.D. Read Out Display
12	34228	2	Electric Read Out Stand Off
13	50124	2	Screw 6-32 x 3/4 Phil
14	60372-001	1	Coin Insert Casting
15	20-1748-000	1	Coin Intake Chute
16	8715	1	Retainer – Coin Chute & Change Light
17	3830	1	Coin Rejector Lever Stop
18	20-0470-008	5	#6-32 x 3/16 Phil Pan Hd. S.M.S.
19	33-4283-000	1	Coin Release Handle
20	3770	1	Coin Release Lever
21	10-0816-000	1	Coin Release Washer
22	09-1076-100	1	Torsion Spring

Item	Part No.	No. Req'd	Description
23	20-0469-020	1	1/4-28 x / Phil Truss Hd. M.S.
24	20-0717-008	1	Lock Washer – Int/Ext Tooth
25	21024	1	Spring
26	33911	1	Correct Change Light
27	3802	1	Retainer – Coin Insert Casting (Left)
28	50212	AS REQ'D	#8-32 x 1/4 Phil Pan Hd. Type "23"
29	4281	1	Coin Chute Retainer
30	3803	1	Retainer – Coin Insert Casting (Right)
31	3613	1	Price Tab Retainer
32	25131	1	Name Window
33	25707 or 25684	1	Instruction Strip
34	3608	1	Price Holder
35	22195	1	Bottom Picture Moulding
36	100013-001	1	Picture End Ass'y. Left
37	3806	1	Name Plate Retainer
38	50423	5	#8 x 3/8 Phil Pan Hd. Type "A" S.M.S.
39	6612	2	Name Plate Support
40	34265	1	Door Harness
41	33-4370-001	1	Decal – Coin Release
42	20787	1	Decal – Instruction w/o Validator
	20786	1	Decal – Instruction w/Validator

# COMPLETE LIGHT ASSEMBLY

P/N 102672

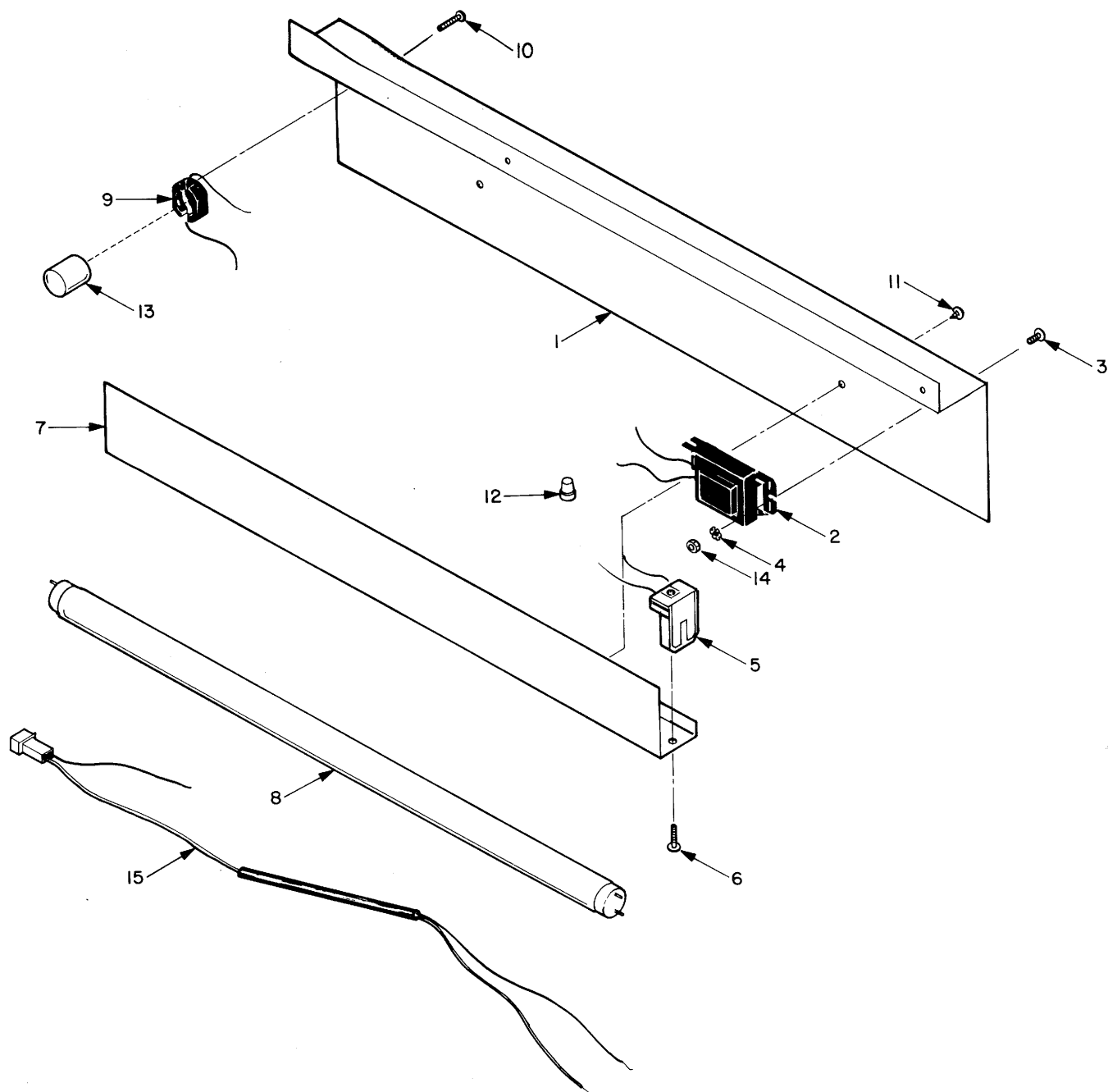

Item	Part No.	No. Req'd	Description
1	3893	1	Light Reflector
2	33669	1	Ballast (SP19)
3	50240	2	#8-32 x 3/8 Phil Pan Hd. M.S.
4	50585	4	#8 Ext. Lock Washer
5	33548	2	Fluorescent Lamp Holders
6	50113	2	#6-32 x 1/2 Phil Pan Hd. Type "A" S.M.S.
7	3894	1	Light Brk't.
8	34135	1	Fluorescent Lamp

Item	Part No.	No. Req'd	Description
9	33617	1	Starter Socker
10	50018	2	#4-40 x 3/8 Phil Pan Hd. M.S.
11	50423	2	#8 x 3/8 Phil Pan Hd. Type "A" S.M.S.
12	33505	1	Splice Cap - Small
13	33661	1	Starter FS 25
14	50513	2	#8-32 Twin Whiz Nut
15	34264	1	Light Harness

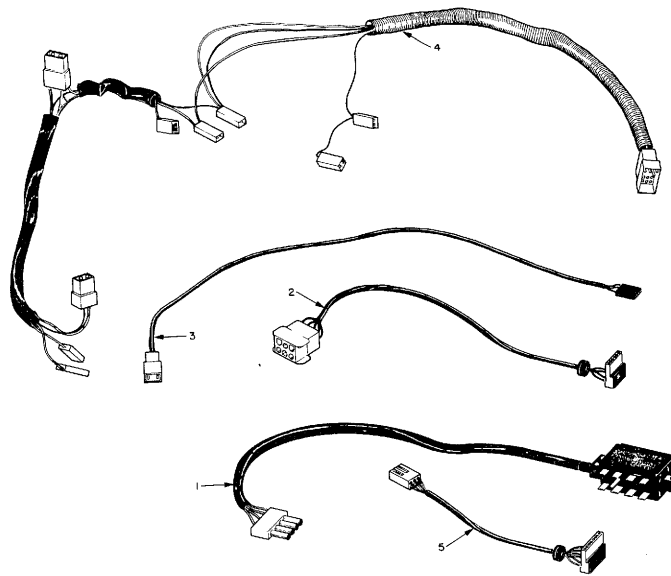

Item	Part No.	Description
1	34320	Validator Harness
2	34319	Coin Mech Validator Harness (Mars)
3	34318	Display Harness (Mars)
4	34265	Door Harness
5	34321	Coin Mech Readout Harness (Mars)
	34266	Chassis Harness
	34264	Lamp Harness

## KITS & ACCESSORIES

LISTED BELOW ARE THE BASIC KITS BEING OFFERED FOR  
BOTH VARIATIONS OF THE ELECTRO-MECHANICAL CIGARETTE VENDORS.

Kit	Purpose	Part Number
Match Stack Kit	Dispense Matches	102311
Counter Kit	Record Total – Items Vended	265021
Caster – Swivel	Make Machine Mobile	101326
Selection Label Kit	The Different Brands	102263
Price Label Kit	Different Prices	25791
Caster – Stationary	Make Machine Mobile	101325
Anti-Cheat Shield	Prevent Theft	101232

# COMPLETE DOOR ASSEMBLY

P/N 102497

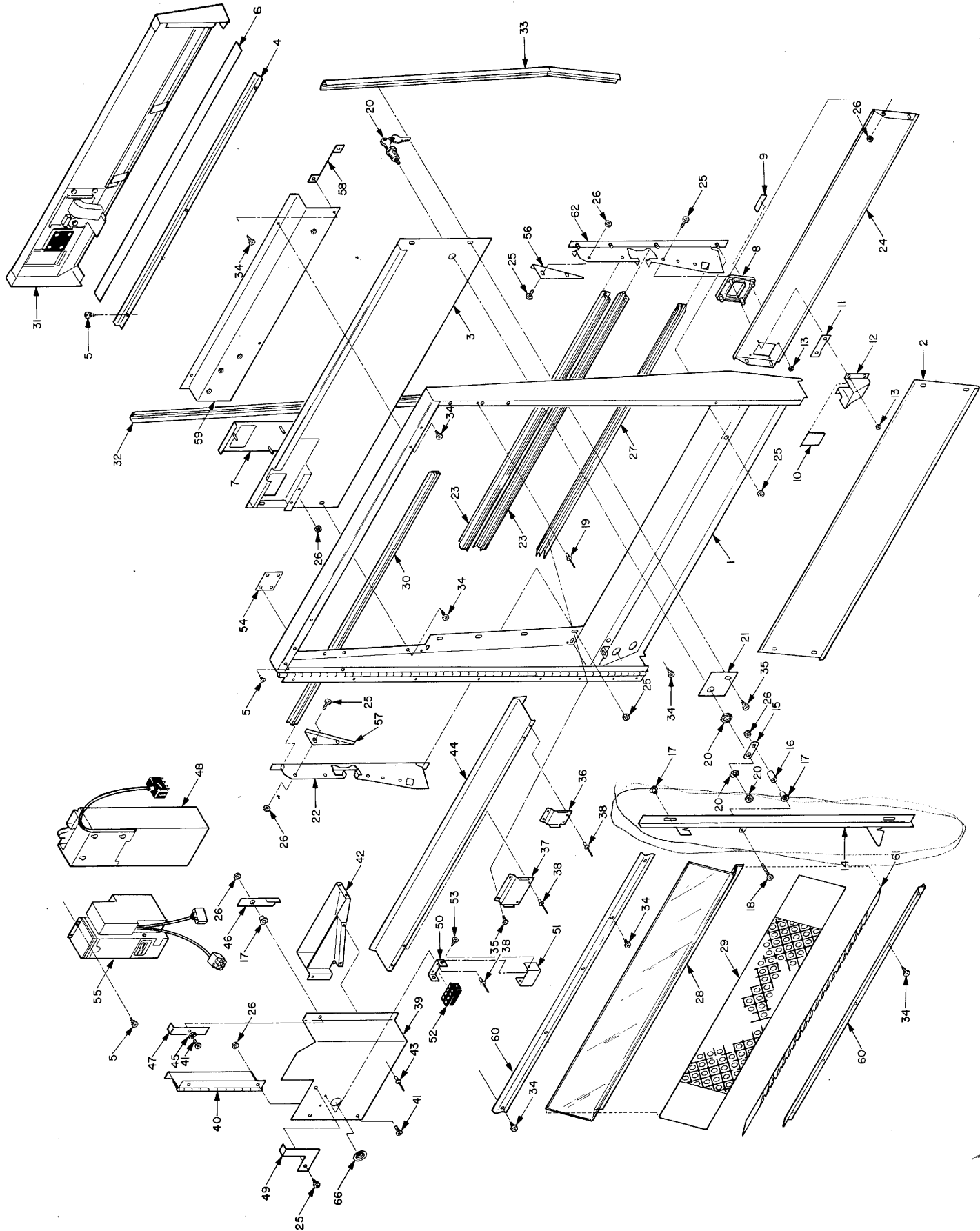

Item	Part No.	No. Req'd	Description
1	100937	1	Door Frame Weld Ass'y.
2	9963	1	Base Door Front
3	102680	1	Front Panel Ass'y. w/o Validator
4	3626	1	Diffuser Retainer
5	50202	AS REQ'D	#8-18 x 1/2 Hex Hd. Tek
6	25134	1	Mach. Front Diffuser Display Plast w/o Validator
7	102739	1	Display Plate w/o Validator
8	102740	1	Display Plate w/Validator
9	33-4281-000	1	Change Bezel
10	33-4984-000	1	Decal Change
11	20-0102-000	1	Door Coin Return
12	20-1422-000	1	Tab Anti Pay Switch
13	20-1649-000	1	Cup Coin Return
14	50587	4	Tinnerman Push-on C12043-017
15	101909	1	Locking Bar Stake & Weld Ass'y.
16	60026	1	Locking Bar Cam (Single)
17	30083	1	Pusher Spacer
18	30053	3	Shoulder Bushing
19	50286	1	#8-32 x 1 1/4 Phil Rd. Hd. M.S.
20	50692	2	Pop Rivet
21	60025	1	Lock w/5 Key Changes
22	8709	1	Door Lock Plate
23	100003-000	1	Extrusion Holder Ass'y.
24	22374-001	2	Pull Bar Molding
25	3768	1	Lower Front Panel
26	50240	AS REQ'D	#8-32 x 3/8 Phil Pan Hd. M.S.
27	50513	AS REQ'D	#8-32 Twin Whiz Nut
28	22372-002	1	Bottom Display Molding
29	25598	1	Display Window
30	20552	1	Window Panel
31	22375-001	1	Top Display Molding
32	102670	1	Picture Display Ass'y.
33	22348-000	1	Door Trim - Right
34	22348-001	1	Door Trim - Left
	50423	6	#8-3/8 Phil. Pan Hd. Type "A" S.M.S.

Item	Part No.	No. Req'd	Description
35	50426	AS REQ'D	#10 x 1/4 Phil. Hex Hd. Type "B" S.M.S.
36	7328	1	Delivery Pan Spacer Left
37	7327	1	Delivery Pan Spacer Right
38	50663	2	Pop Rivet
39	102476	1	Coin Mech Brk't. Stake Ass'y.
40	102475	1	Coin Mech Hinge Brk't. Weld
41	50247	AS REQ'D	#8-32 x 1/2 Phil. Pan Hd. M.S.
42	102468	1	Coin Chute Weld Ass'y. Upper
43	50081	5	Pop Rivet
44	22377		Door Sill
45	50585	1	Ext. Shakeproof Lock Washer
46	3800	1	Housing Latch-Coin Mech
47	3385	1	Coin Mech Brk't. Support
48	60466	1	Coin Mech 5807 Mars w/Nippon Interface
49	3449	1	Coin Mech Hold Down
50	7127	1	Coin Mech Plug Brk't.
51	33526		Jones Plug Insulator
52	33607	1	Female Plug
53	50112	2	#6-32 x 1/4 Phil. Pan Hd. M.S.
54	3607	1	Upper Validator Mtg. Brk't.
55	34277	1	Nippon Validator
56	8039-001	1	Window Panel Holder (Left)
57	8039-000	1	Window Panel Holder (Right)
58			
59	102672	1	Complete Light Ass'y.
60	8707	2	Retainer Strip
61	9959	1	Facsimile Display Panel
62	100003-001	1	Extrusion Holder Ass'y.
63			
64			
65			
66	25682-000	1	Grommet Plug Button w/Hole

# MATCH STACK DISPENSER LINKAGE ASSEMBLY

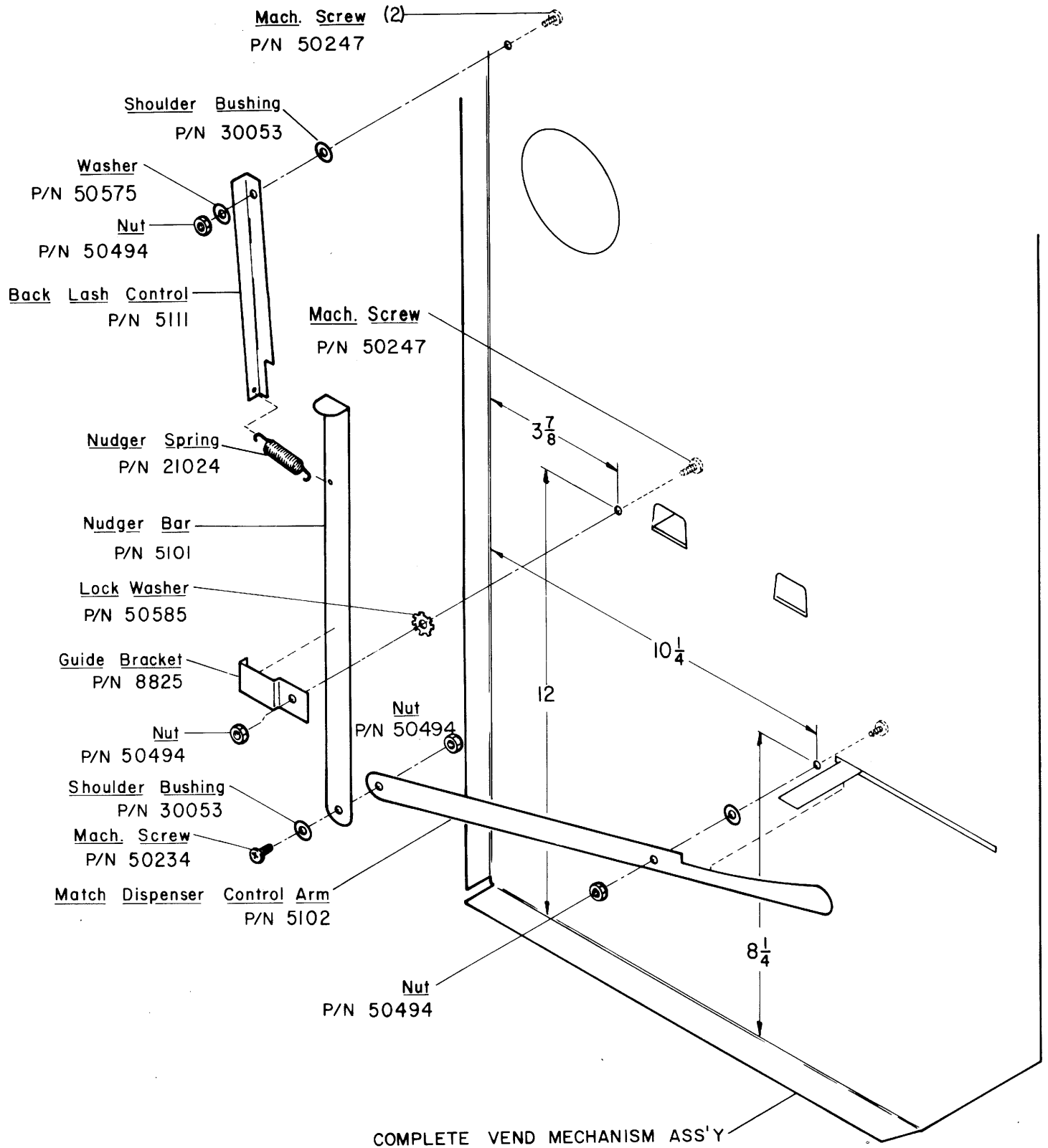



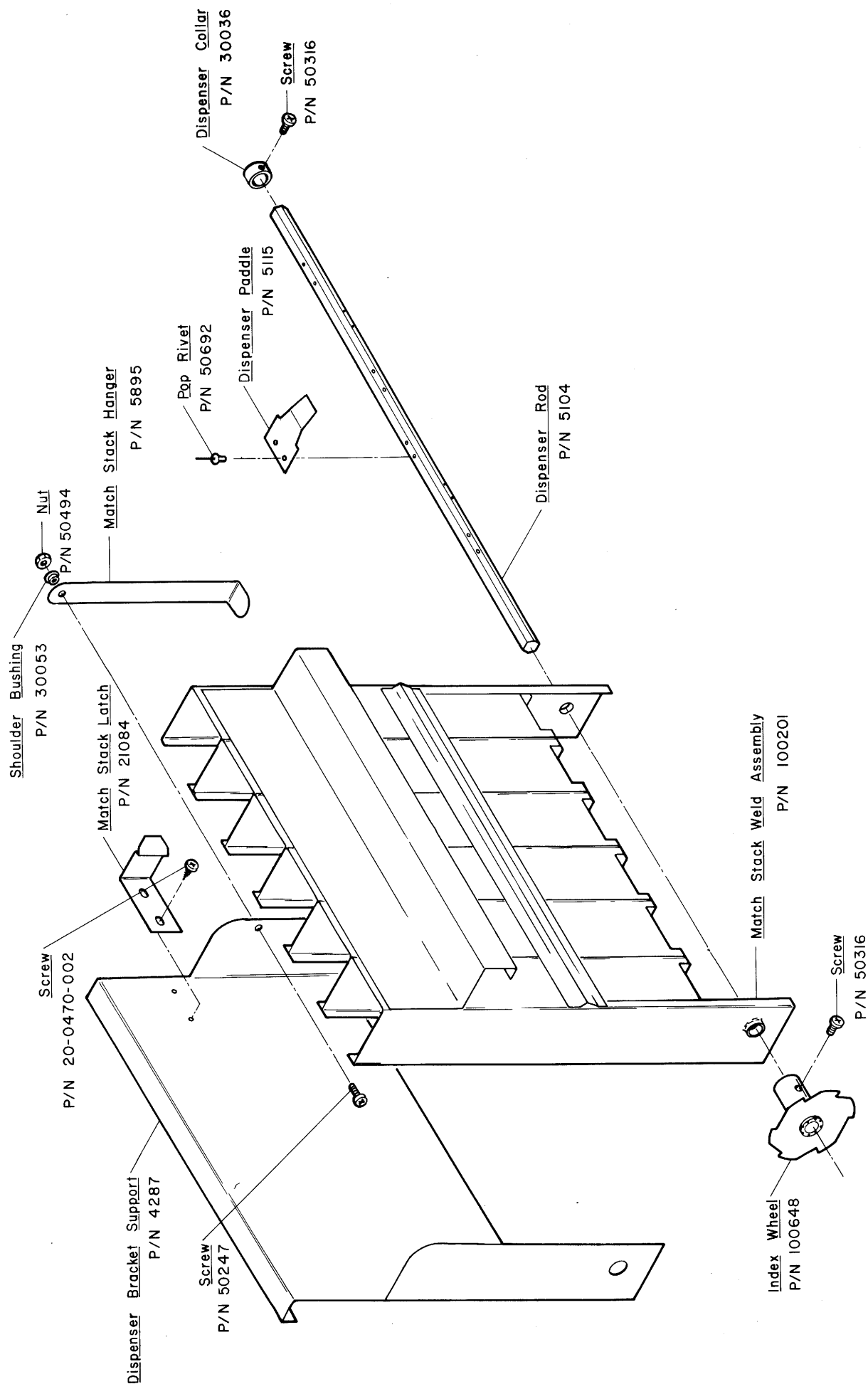

## INSTALLATION INSTRUCTIONS FOR MATCH DISPENSERS

1. Remove mech assembly from the cabinet.
2. Assemble nudger bar (P/N 5101) to match dispenser control arm (P/N 5102) using shoulder bushing (P/N 30053) and machine screw (P/N 50234). See Page
3. Attach guide bracket (P/N 8225) to mech assembly with lock washer (P/N 50585) between the two parts. Secure with machine screw (P/N 50247) and nut (P/N 50494) as shown in the illustration on Page
4. Locate hole for match dispenser control arm (P/N 5102). Assemble as shown in the illustration using machine screw (P/N 50247), nut (P/N 50494) with the shoulder bushing (P/N 30053) between the mech assembly and the control arm (P/N 5102). See Page
5. Hang backlash control from mech assembly as shown in the illustration, using machine screw (P/N 50247) with shoulder bushing between mech assembly and backlash control. Place washer (P/N 50575) and nut (50494) on machine screw (50247). See Page
6. Attach nudger spring (P/N 21024) to backlash control (P/N 5111) and nudger bar (P/N 5101) as shown in the illustration on page
7. Place index wheel through hole in the side of the mech assembly. Hang match stack assembly on the back of the mech assembly as shown in the illustration on page
8. Make sure index wheel is in the center of backlash control (P/N 102312) to the back of the mach assembly with screw (P/N 50202). See Page
9. Place mech assembly back into cabinet and check for proper operation of the installed match dispensing assembly.

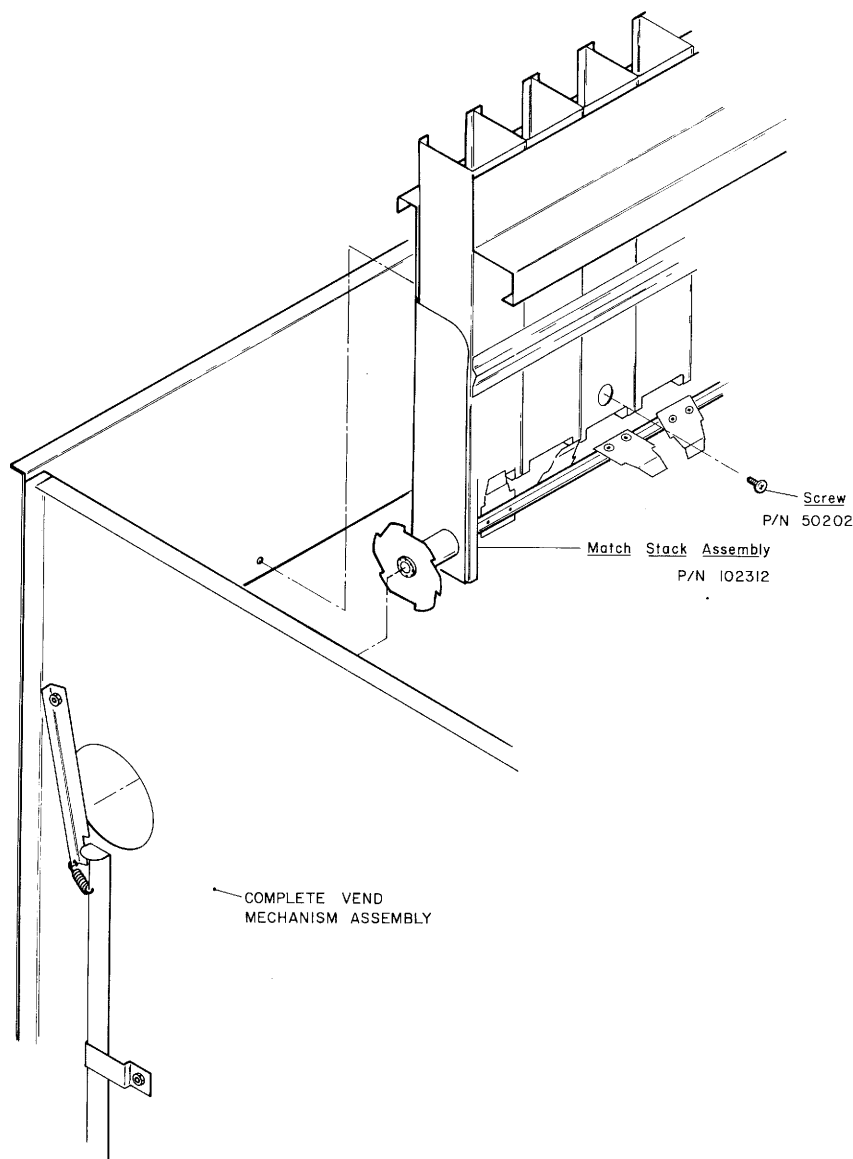

## NOTES:

