

# Accessory Pack

## User Guide

### Metal Plates

### Installation Steps

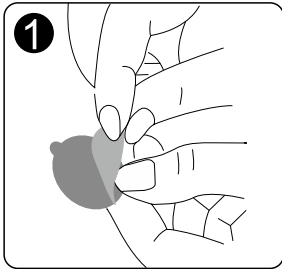

1 Remove the White Transparent film.

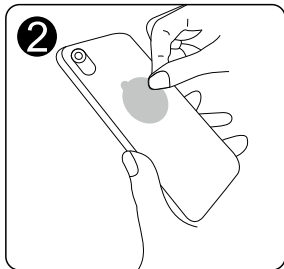

2 Apply the clear transparent sticker to the back of your phone.

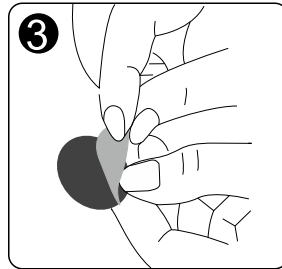

3 Remove the white sticker from the metal plates.

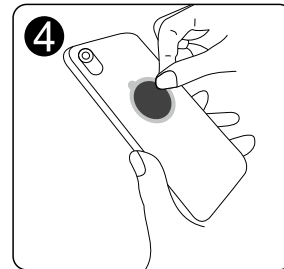

4 Paste the metal plate at the backside of your phone or phone cover.

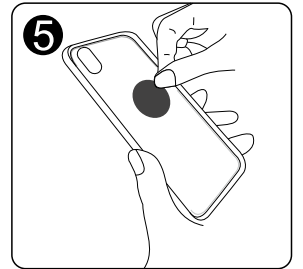

5 (Or) Install it inside your phone cover.

### Use Different Ways

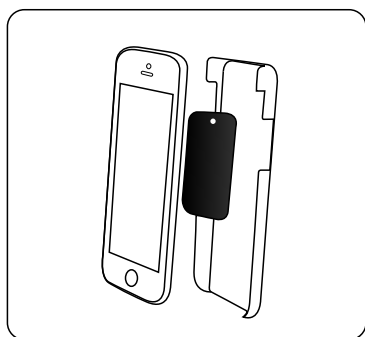

Between Phone & Cover

or

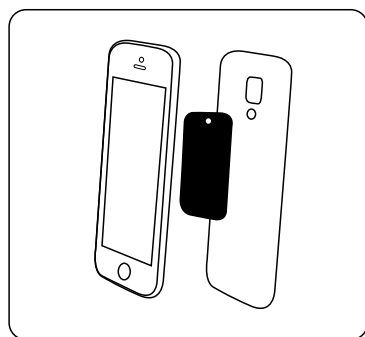

Inside Mobile Cover

or

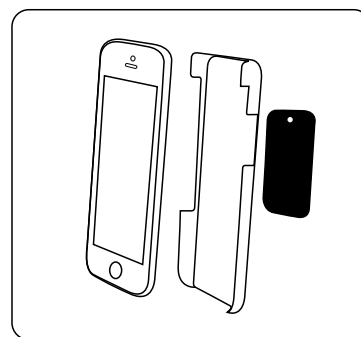

Behind Mobile Cover

or

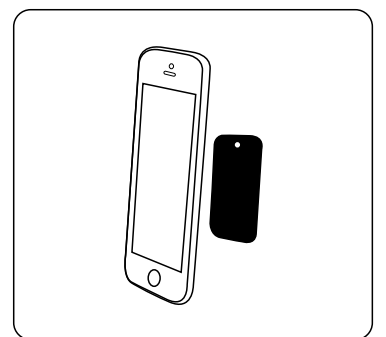

Behind Mobile Device

### 3M Adhesive Sticker

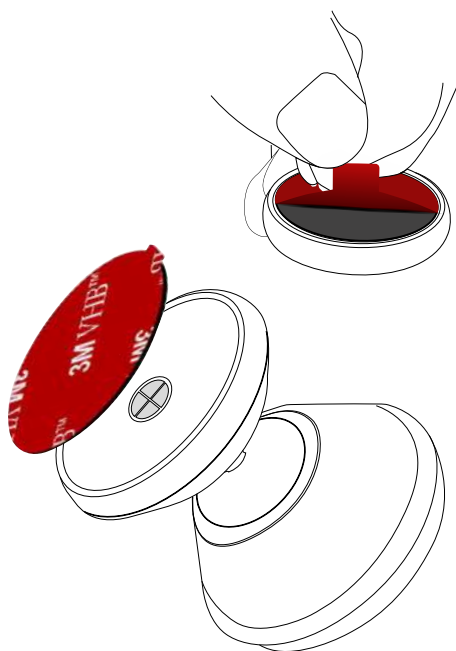

1 Peel off the white sticker & apply it on the holder base.

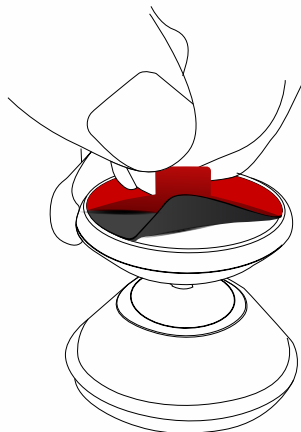

2 Peel off the red film to install the holder.

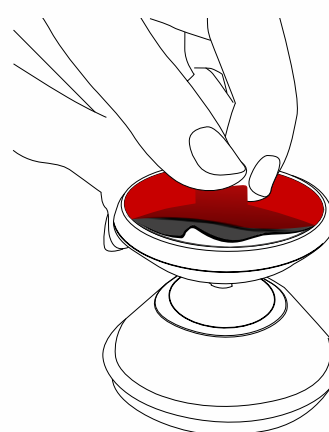

3 If hard to peel off press it back & try peel again. Repeat this act.

