

Installation and operating instructions

VIESSMANN

Wireless room temperature controller,
LCD with clock and 7-day program

VITOPLANAR wireless thermostat LCD clock



Safety instructions

Please follow these safety instructions closely to prevent hazards, injury and material losses.

Safety instructions explained

.. **Danger**

This symbol warns against the risk of injury.



Caution

This symbol warns against the risk of material losses and environmental pollution.

Note

Text with the word Note contains additional information.

Installation, commissioning, inspection, maintenance and repairs must only be carried out by an authorised, competent person (heating engineer/installation contractor).

Before working on the appliance/heating system, isolate it from the power supply (e.g. by removing a separate fuse or by means of a mains isolator) and safeguard against unauthorised reconnection.

Repairing components that fulfil a safety function can compromise the safe operation of the system.

For replacements, use only original spare parts supplied or approved by Viessmann.

Product information

The appliance is a wireless room temperature controller with clock for capturing the temperature in residential, office and hotel rooms. Simple to install – no time-consuming chase cutting and plastering for cable routing. The controller can be installed on a flush mounted or surface mounted box on the wall. A support arm also enables freestanding operation. The controller has a freely programmable 7-day program, frost protection function, manual operation and on/off function.

Installation

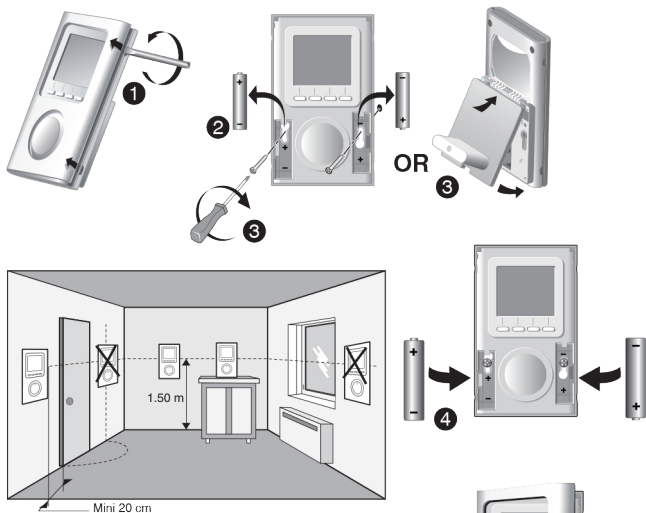

Install the thermostat as follows:

- In the main living room (e.g. living/dining room) or in the centre of the apartment/house
- Fixed to a wall or accessible on a shelf or piece of furniture, at a height of 1.50 m
- Protected from heat (chimney, sunlight) and draughts (windows, doors)

IMPORTANT: Do not install the thermostat on a wall that connects to the outside or in an unheated room (e.g. garage).

Operating and display elements

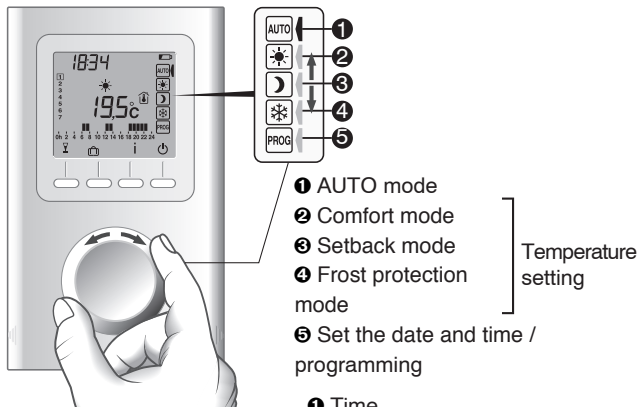

- ❶ AUTO mode
 - ❷ Comfort mode
 - ❸ Setback mode
 - ❹ Frost protection mode
 - ❺ Set the date and time / programming
- } Temperature setting

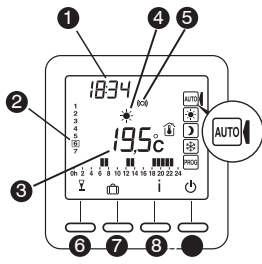

- ❶ Time
- ❷ Day
- ❸ Measured temperature or set temperature
- ❹ Current set temperature
- ❺ Wireless transmission
- ❻ "Party" mode
- ❼ Absence mode
- ❽ Info button
- ❾ Off mode

Standby mode:

After a certain period of inactivity, the thermostat switches to standby mode. To exit this mode, press a button or turn the selector switch

Assigning wireless receivers

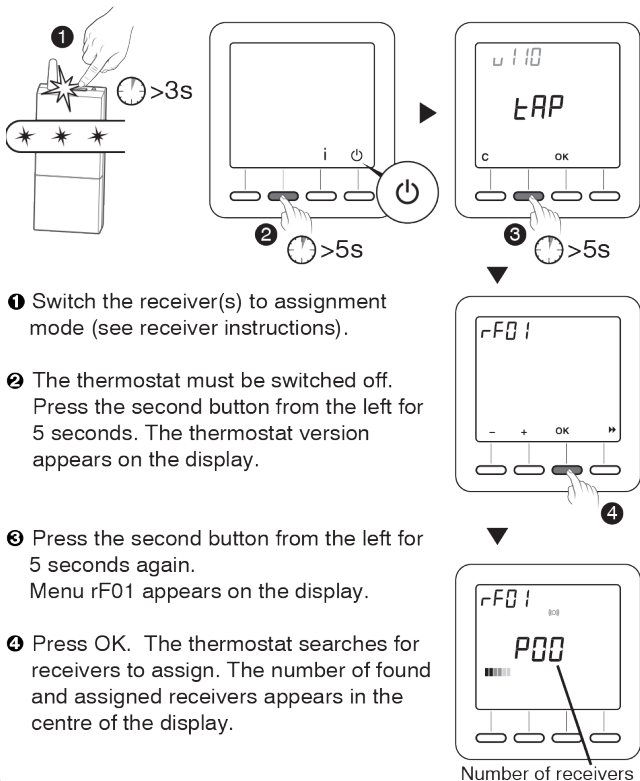

Configuration

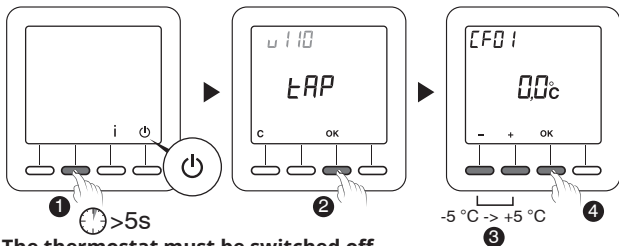

The thermostat must be switched off.

- Press the second button from the left for 5 seconds.
The thermostat version appears on the display.
- Press OK.
Menu CF01 appears on the display.
- Select the required setting with + and -.
Press OK to confirm the setting and move to the next setting.

Turn the selector switch to exit the mode.

Note: The fields with a grey background correspond to the pre-configured factory settings.

CF01 – Correction of measured temperature

Adjustable from $-5^{\circ}C$ to $+5^{\circ}C$.

Example: If the temperature displayed by the appliance is $19^{\circ}C$ and the temperature measured (by thermometer) is $20^{\circ}C$, $+1^{\circ}C$ must be set.

CF02 – Displayed temperature in AUTO mode

0	Set temperature
1	Measured temperature 

Configuration (continued)

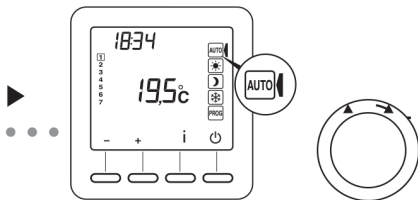



CF04 – Type of control

0	PI control (integral proportional control)
1	2-point control

CF05 – Energy saving mode

0	Display switched off after 10 seconds where no button is pressed
1	Display switched off between midnight and 5a.m.
2	Display always switched on

CF06 – Show ON/OFF button in standby mode

0	Symbol  not shown in standby mode
1	Symbol  shown in standby mode

CF07 – Display illumination

0	Deactivated
1	Activated (switched off after waiting time)

CF08 – Open detection function

0	Deactivated
1	Activated

If the receiver is combined with an open detector (e.g. for a window), the heating is switched to frost protection mode when the window is opened.

CF09 – Presence detection function

0	Deactivated
1	Activated

If the receiver is combined with a motion detector, the temperature is automatically reduced during long periods of absence:

- 1.5 hours -> current set temperature -1.5 °C
- 3.5 hours -> current set temperature -3.5 °C
- 48 hours -> set frost protection temperature

CF10 – Max. set comfort temperature

Adjustable from 22 °C to 30 °C.

Standard value: 28 °C

CF11 – Programming format

0	Programming in 1-hourly steps
1	Programming in 1/2-hourly steps

Configuration (continued)

CF12 – Time format

0	12 h (a.m./p.m.)
1	24 h

CF13 – Automatic summer/wintertime changeover

0	Deactivated
1	Activated

If CF13 = 0, the option to set the date is not offered.

CF15 – Display of window symbol (open detection)

If CF08 = 1:

0	Non-flashing symbol
1	Flashing symbol

CF16 – Display of symbol (heat demand)

0	Symbol not shown
1	Symbol shown

CF17 – Display of symbol (presence detection)



0	Fixed symbol
1	Flashing symbol

CF18 – Power consumption display

0	Deactivated
1	Activated

If the power consumption display is activated, the wattage of the heating elements must be specified.



- 1 Select the heating element
- 2 Confirm with OK.



- 3 Specify the power in watts.
- 4 Confirm with OK.

CF 28 – "Adaptive start control" function

Thanks to this function, the required temperature is reached at the scheduled time.

0	Function deactivated
1	Function activated

Press +/- to activate or deactivate the function.

Confirm with OK.

You will be taken to menu CF29.

CF29 – Setting the temperature/time curve for adaptive start control

The temperature/time curve depends on the heating system.

Adjustable from 1 to 6 °C in steps of 0.1 °C.

Factory setting: 3 °C.

If the required temperature is reached too quickly, a lower value should be set.

If the required temperature is reached too slowly, a higher value should be set.

Change with +/-.

Confirm with OK.

Entering the date and time

1) Turn the selector switch to PROG.

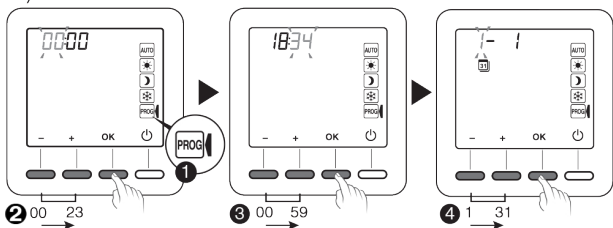

2 Set the time and confirm with OK.

3 Set the minutes and confirm with OK.

4 Set the day of the week and confirm with OK.

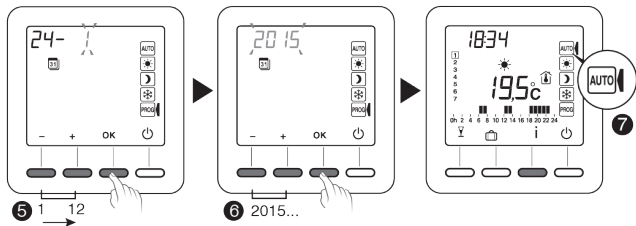

5 Set the month and confirm with OK.

6 Set the year and confirm with OK.

7 Turn the selector switch to AUTO to exit the mode

The date setting can be optional (see configuration CF13).

Defining set temperatures

If you remain in one of these operating modes, the thermostat is permanently set to this temperature range (no programming).

6.1 Selecting the set comfort value

- 1 Turn the selector switch to (configuration CF10). 
- 2 Set the comfort temperature (from 5 °C to max. comfort).
- 3 Confirm with OK.

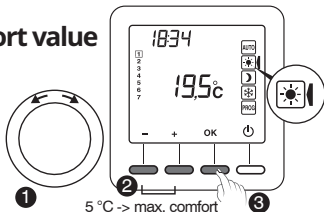

6.2 Selecting the set economy mode value

- 1 Turn the selector switch to .
- 2 Select the setback temperature (from 5 °C to 19 °C).
- 3 Confirm with OK.

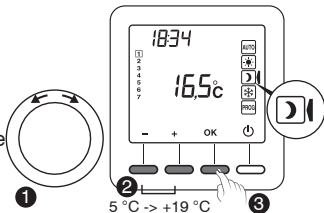

6.3 Selecting the set frost protection value

- 1 Turn the selector switch to .
- 2 Set the frost protection temperature (from 5 °C to 10 °C).
- 3 Confirm with OK.

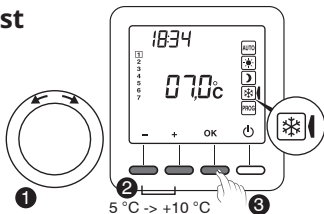

6.4 Display features

When selecting the set values, depending on the thermostat model and the selected set temperature, the screen colour may change, or a set of different colours may be shown.

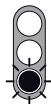
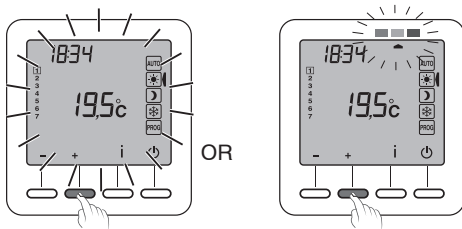

Green up to 19 °C (low consumption)



Orange from 19.5 °C to 24°C (average consumption)



Red from 24.5 °C to max. comfort (high consumption)

Activate display illumination (CF05) to use this function, depending on the thermostat model.

Programming

❶ Turn the selector switch to **PROG.**

During commissioning, the programming for each day of the week corresponds to comfort mode from 6 a.m. to 11 p.m.

You can set different setback and comfort runtimes using the ☀️ and 🌙 buttons.

Example: Comfort mode from 6 a.m. to 8 a.m. and from 5 p.m. to 11 p.m.

0h 6h 8h 17h 23h 24h

❷ Press 🌙 until 06:00

❸ Press ☀️ until 08:00

❹ Press 🌙 until 17:00

Programming can be carried out in hourly or 30-minute steps (configuration menu CF11).

Programming (continued)

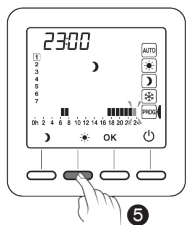
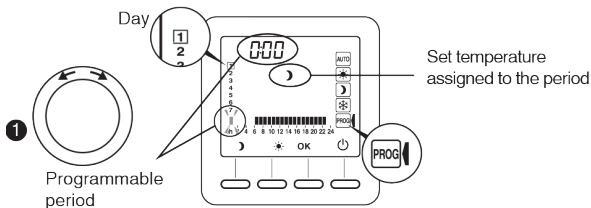

5 Press ☀ until 23:00

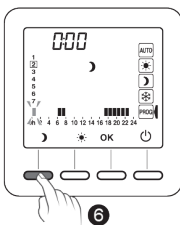

6 Press ☾ until 00:00

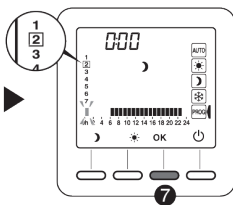

7 Press OK to confirm the setting and move to the next day .

7 Press OK for 3 seconds to confirm the program and transfer it to the next day (COPY function).

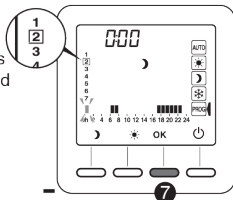

Repeat this step for each day of the week.

Automatic mode

In AUTO mode, the thermostat is controlled according to the day program.

The symbol  indicates a heat demand (configuration CF16).

The automatic program can be temporarily cancelled through:

- "Party mode" – special enabling ()

- Absence mode ()

- Detection of open windows (symbol ), if this function has been activated (configuration CF08). The heating then switches to frost protection mode.

- Detection of absence (symbol  flashes), if this function has been activated (configuration CF09).

The heating then switches to setback mode:

- Absence of 1.5 hours -> current set temperature -1.5 °C
- Absence of 3.5 hours -> current set temperature -3.5 °C
- Absence of 48 hours -> set frost protection temperature

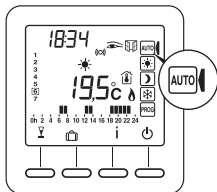

 : Heat demand

 : Party mode

 : Absence mode

 : Measured temperature

 : Outside temperature

 : Open detection activated

 : Presence is detected

 : External special enabling

 : Battery spent

 : Wireless transmission

Party mode

Party mode allows the automatic program to be temporarily cancelled by setting a specific temperature for a programmed period (30 minutes to 12 hours).

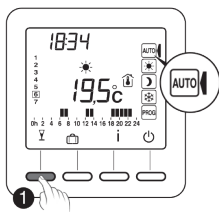

- 1** In AUTO mode, press .



- 2** Set the required temperature. Confirm with OK.

5 °C -> max. comfort

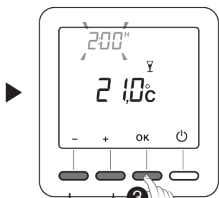

- 3** Set the required duration. Confirm with OK.

30 min -> 12 h

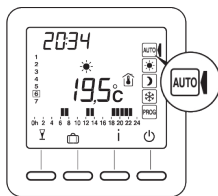



- 4** The countdown begins. Return to AUTO mode and the corresponding settings after the countdown has finished or by pressing C.

Absence mode

This operating mode enables frost protection mode to be activated in the event of an absence of several days.

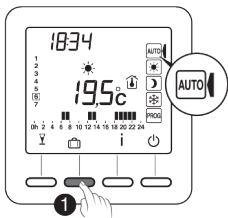
Example: Departure on Friday 10th – return planned for Sunday 19th: program 9 days of absence.



- 1** Turn the selector switch to AUTO and press .

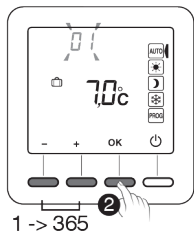

- 2** Enter the number of days you will be away. Confirm with OK.

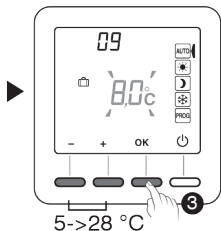

- 3** Set the absence temperature. Confirm with OK.

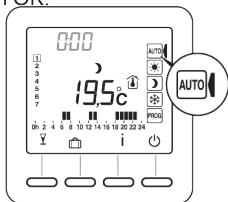

- 4** Return to AUTO mode and the corresponding settings after the countdown has finished or by pressing C.

External program interruption

The external program interruption enables an external wireless transmitter, which also has this program interruption function, to interrupt the automatic operation of the thermostat.

If the program is interrupted externally, the symbol  and the new set temperature are displayed.

The thermostat is controlled according to the parameters required by the external wireless transmitter.

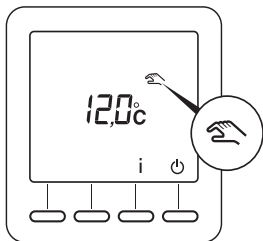



If, in the event of an external program interruption, the symbol  is not displayed, you can refresh the display by pressing the i button or turning the selector switch.

Adaptive start control

You have programmed the temperatures for comfort and setback mode. Adaptive start control (configuration menus CF28 and CF29) enable the required comfort temperature to be reached at the required time.

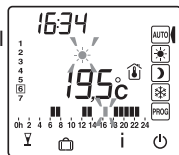
Example: You have programmed comfort mode for 6 p.m. Adaptive start control begins heating earlier (e.g. at 4.30 p.m.).



In automatic mode, you can see that adaptive start control is active by the flashing symbol .

Displaying information

The Info button **I** serves to display the following information:

- Current measured temperature or current set temperature (depending on configuration)
- Outdoor temperature (if an outdoor temperature sensor has been assigned to the receiver)
- Total consumption of assigned heating elements (configuration CF18)

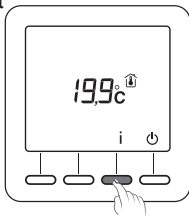

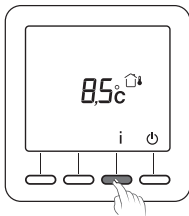

Press the **I** button repeatedly to display the relevant information.

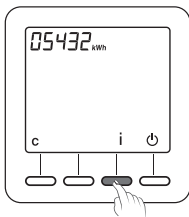

To reset the consumption meter to zero, press the **C** button for 3 seconds.



Locking settings

From one of the operating modes AUTO, , ,  :

Press the **i** button for 5 seconds.

The following symbol  appears on the display.

In locked mode, only the buttons On/Off () and Info (**i**) are accessible.

To unlock, press the **i** button for 5 seconds again.

The symbol  disappears.

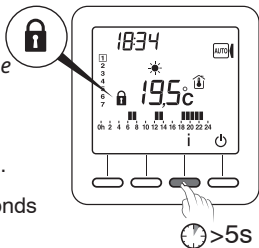

Off mode

Press  .

The thermostat emits 3 beeps.

Heating is switched off in this operating mode.

To exit Off mode, press the following button again:  .

The thermostat beeps once.

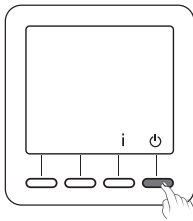

Heating is switched off in this operating mode.
Only the **i** button is accessible.

Resetting settings

15.1 Restoring factory settings automatically

In Off mode (⏻).

❶ Press the button on the left and the *i* button simultaneously for 10 seconds until "Init" is displayed.

❷ Press OK for 3 seconds. "Init" flashes on the display.

List of initialised settings:

- Set temperatures (comfort 19 °C, setback 15.5 °C, frost protection 7 °C)
- Open detection function (CF08=1)
- Presence detection function (CF09=0)

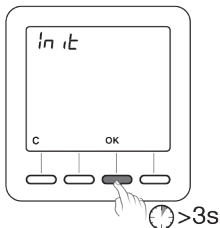
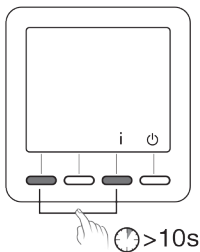

Resetting settings (continued)

In this operating mode, all configuration parameters, set temperatures and programming are reset. Only the date and time are retained.

In Off mode (⏻).

❶ Press the button on the left and the *i* button simultaneously for 20 seconds. After 10 seconds, "Init" is displayed. Keep the button depressed until "ALL" appears.

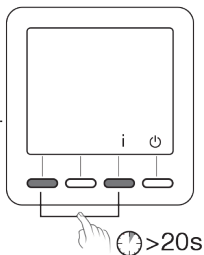

❷ Press OK for 3 seconds. "Init" and "ALL" flash. The values and settings have been initialised.

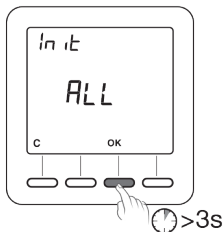

Deleting wireless assignment

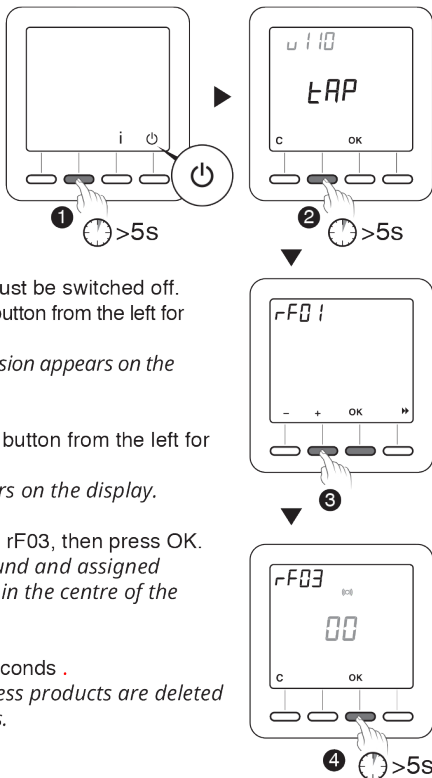

- 1** The thermostat must be switched off. Press the second button from the left for 5 seconds.
The thermostat version appears on the display.
- 2** Press the second button from the left for 5 seconds again.
Menu rF01 appears on the display.
- 3** Press + to display rF03, then press OK.
The number of found and assigned receivers appears in the centre of the display.
- 4** Press OK for 5 seconds .
All assigned wireless products are deleted until "00" appears.

Changing the batteries

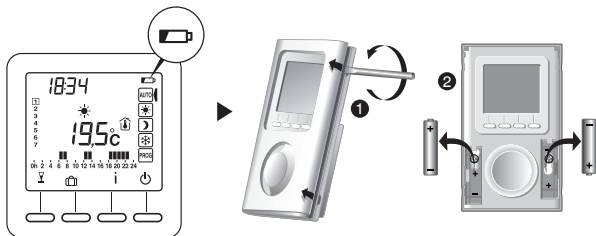

If this symbol is displayed, you have about 3 months until the battery will need changing (see technical information).

Help

- The following symbol appears on the display  .
The batteries have run out. Replace the batteries
- Receiver does not receive data from the thermostat.
The wireless range may be insufficient.
 - 1) Disconnect all receivers except the faulty receiver.
 - 2) The thermostat must be switched off.
 - 3) Press the second button from the left for 5 seconds. The thermostat version appears on the display.
 - 4) Press the second button from the left for 5 seconds again. Menu rF01 appears on the display.
 - 5) Press + to display rF02.
The display shows a digit between 0 and 4 (4 corresponds to the maximum range).
If the digit is too low, the installation must be adjusted.

Specification

Power supply	2 batteries 1.5 V type LR03/AAA (CF05=0) Service life under normal use: Alkaline: 5 years Lithium: 10 years
Protection class	III
Radio frequency	868 MHz, class I (EN 300 220 standard)
Wireless range	100 to 300 m in a free field, depending on appliance combination (subject to installation location and possible electromagnetic interference)
Dimensions	81 x 135 x 22 mm
IP rating	IP 30
Ambient conditions	Normal level of cleanliness; mounting on wall or base
Storage temperature	-10 to +70 °C
Operating temperature	0 to +40 °C

Energy consumption data

The product data corresponds to the EU regulations of the directive on the environmentally sound design of energy related products (ErP).

Disposal of packaging

Your contractor will dispose of the packaging from your Viessmann product.

- DE:** Packaging waste is sent to a certified disposal contractor for recycling in line with statutory regulations.
- AT:** Packaging waste is sent to a certified disposal contractor for recycling in line with statutory regulations. Use the ARA statutory disposal system (Altstoff Recycling Austria AG, licence number 5766).

Declaration of Conformity

Using the serial number, the Declaration of Conformity can be found on the following website:

DE: www.viessmann.de/eu-conformity

AT: www.viessmann.at/eu-conformity

CH: www.viessmann.ch/eu-conformity-de

or

www.viessmann.ch/eu-conformity-fr

Viessmann Ges.m.b.H.
A-4641 Steinhaus bei Wels
Telephone: 07242 62381-110
Fax: 07242 62381-440
www.viessmann.at

Viessmann Werke GmbH & Co. KG
D-35107 Allendorf
Telephone: +49 (0)6452 70-0
Fax: +49 (0)6452 70-2780
www.viessmann.de