

senelux

INSTRUCTION MANUAL

Air Purifier



Model: DEMI

ENGLISH

TABLE OF CONTENTS

(i) Danger Warning	02
(ii) Product Overview	05
(iii) Instruction	06
(iv) Replacing The Filter	09
(v) Maintenance	09
(vi) Faq's	11
(vii) Warranty	12
(viii) Information	12

1. IMPORTANT

Before you use your device, please read this user manual carefully and keep it for future reference. Our website has digital guides, and we can provide them in other languages if required. We also have a YouTube page that has many helpful guides.

Danger warning

1. Do not allow water, liquid, or any flammable detergent to get onto your product to avoid electric shock and fire. The product is for indoor use only.
2. Do not spray insecticide, perfume, or another flammable spray around your product.

Safety warning

1. Before connecting the power supply, please check whether the product's voltage is consistent with the local power supply voltage.
2. If the power cable is damaged, it must be replaced by a qualified electrical technician, service agent, or manufacturer.
3. Do not use the product when the plug, power cable, or the product shows any visible sign of damage,
4. Do not block the air inlet or outlet. Do not place objects on or in front of the air outlet.
5. Do not insert foreign items into the product through the air inlet.
6. Young children should only use this product if they are given instructions by the person responsible for their safety. Do not allow children to play with the product or clean and maintain it unsupervised.

Notice

1. This product is not a substitute for normal ventilation, daily vacuuming, or kitchen ventilation hoods.
2. The plug of the product may become very hot If the power socket connected to the product is not in good contact. Ensure to connect the product is to the power socket properly.
3. Do not place anything on the product.
4. Ensure the product is placed on a stable and horizontal surface.
5. Please leave at least 30cm of space on the back and sides of the product and at least 50cm above the product.
6. Do not put the product directly under the air conditioner to prevent condensation from dripping into the product.
7. Ensure the filter and filter cover are installed correctly before turning on the power supply.
8. Do not use any other filters except the filters produced by Senelux.
9. Burning the filter may cause irreversible human harm or endanger other lives. Do not use the filter for fuel or similar purposes.
10. Do not hit the product with solid objects (especially the air outlet and inlet).
11. Do not insert a finger or other objects into the air outlet/inlet to prevent physical damage.
12. Do not use this product when using indoor aerosol repellent or in places filled with oil, flammable gas, or chemical fumes.
13. Ensure the device is power-off and unplugged before cleaning, maintaining, and replacing a filter.
14. Please unplug the product before moving it. Do not move the product by pulling the power cable.

Safety warning

This manual and all our instruction manuals are available for download from www.senelux.co.uk. If you require another language besides English, please email us at support@senelux.co.uk or contact us through our live chat.

Children should be supervised using this product to avoid playing with the appliance. This appliance can be used by children aged 8 years and above and persons with reduced physical, sensory, or mental capabilities or lack of experience and knowledge if given supervision or instruction concerning using the appliance safely and understanding the hazards. Children shall not play with the device. Children shall only make cleaning and user maintenance with supervision.

If the supply cable is damaged, it must be replaced by the manufacturer, its service agent, or similarly qualified persons to avoid a hazard.

Environmental Protection



Electrical appliances are recyclable and should not be discarded in domestic waste! Please actively support us in conserving resources and protecting the environment by returning this appliance to the collection centres. The outer cardboard boxing is fully recyclable in most countries.

2. PRODUCT OVERVIEW

Components

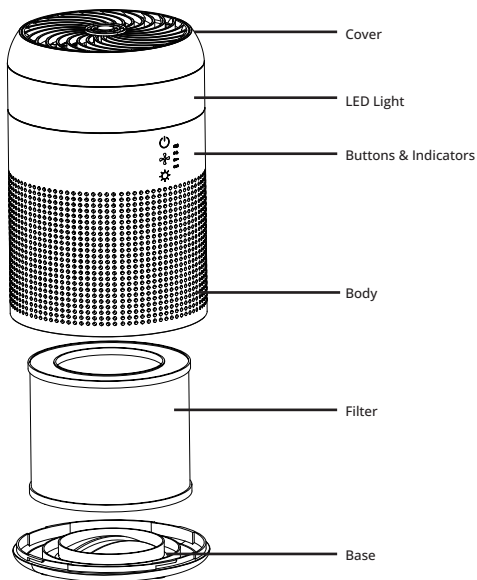

Specification

Product Model	Demi
Rated voltage	Adapter input: 100-240V 50/60Hz Output: 12V/1A
Rated Power	10W
Noise	44dB
Coverage area	25m ²
Dimension	Φ160 X 263.75 mm
Weight	1.15kg

3. INSTRUCTION

Please remove the packaging of the filter before using the new product. Unplug the air purifier from the power outlet before removing/installing the filter.

1. Turn the air purifier upside down and turn the base counter-clockwise to open the appliance.

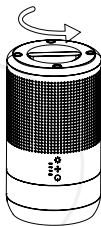

2. Remove the filter from the air purifier.

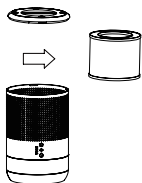

3. Remove the packaging of the filter.

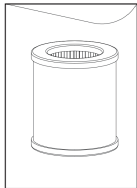

4. Install the filter.

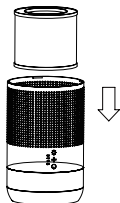

5. Turn the base clockwise to reset the appliance.

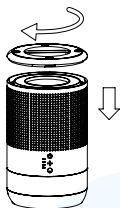

Function Instructions

Insert the plug of the air purifier into the power socket, the air purifier will make a “beep” sound, and all the indicators will light up once and then turn off. The appliance enters the standby state.

Power Button

Every time you press the power button, the appliance will beep once. Press the power button to turn on/off the air purifier. When the air purifier is operating, it will run in low fan speed mode by default, and the LED light will be white in this mode.

Notice: If you turn off the air purifier without unplugging it, the next time you turn it on, it will remain running in the last chosen setting before shutting down.

Fan Speed Button

While the device is turned on and operating, you will hear a “beep” sound each time you press the fan speed button and can select the fan speed mode between Sleep mode, Low speed, and High speed.

Light Button

While the device is running, press this button to turn on the ambient light. By default, the light will change colour in the sequence of purple - blue - cyan - green - yellow - orange -red. Press the button again, and the light will stop changing and remain at the current colour. Press the button again to exit the lighting mode.

UV

When the machine is on, the UV function will work in 2-hour intervals (2 hours on, then 2 hours off).

4. REPLACING THE FILTER

When the filter indicator keeps flashing red, it indicates that it needs replacing. Please use an original filter produced by Senelux.

Notice:

- Please clean the dust on the filter regularly. Do not wash or reuse the filter.
- Ensure to turn off and unplug the appliance before replacing the filter.
- Do not use the vacuum cleaner to clean the filter. Please place the filter in direct sunlight regularly for sterilisation.

When the air purifier has run over 2200h, the filter indicator will flash red, indicating the filter needs to be replaced. After replacing a new filter, hold the power button for 7 seconds to turn on the appliance again, and the filter indicator light will turn off.

5. MAINTENANCE

Notice:

- Ensure the appliance is unplugged before maintenance.
- Do not immerse the air purifier in water or any liquid.
- Do not use abrasive, corrosive, or flammable cleansers (such as bleach or alcohol) to clean any appliance part.

Cleaning:

1. Ensure the appliance is power-off and unplugged.
2. Remove the filter, clean the dust adsorbed on the outer surface of the filter (gently pat the filter outside the house);
3. Use a soft cloth with a neutral cleanser to clean away any dust or debris from the surface of the appliance and air inlet/outlet.
4. After the appliance and filter completely dry out, install the filter into the device then the machine can work again. Ensure no water drops into the apparatus when cleaning the air outlet.

Storing Your Device:

1. Turn off the appliance and unplug the power supply and arrange and bundle the mains cord.
2. Remove the filter, and clean the dust adsorbed on the outer surface of the filter
3. Clean the air inlet/outlet and wipe the body with a neutral detergent and a soft cloth.
4. After the appliance is completely dried, put on a dust cover/ bay and place it in a well-ventilated place not exposed to direct sunlight.
5. If you do not use it for a long time, please turn on the appliance for a few minutes from time to time to ensure good performance.

6. FAQ'S

Situation	Reason
Not operating	<ul style="list-style-type: none"> • Is it plugged into a power socket? Is there a power outage? • Is the home electricity on, or has the fuse blown, or the electrical mains tripped? • Does the filter indicator light keep flashing? You may need to change your filter.
The airflow has decreased	<ul style="list-style-type: none"> • Is there any dust on the surface of the filter? • Does something block the appliance's air inlet/outlet?
Making an unusual Noise	<ul style="list-style-type: none"> • Is there anything stuck on the fan in the air outlet? • Is the appliance tilted or not on a flat, stable surface?
Emitting a strange smell	<ul style="list-style-type: none"> • Usually, air purifiers smell of plastic the first few times they are used. • If the filter is dirty. Immediately clean or replace the filter. • If a burning smell emits from the appliance, please unplug the power socket, and contact the seller or customer service.
The indicator of replacing the filter keeps flashing after replacing the new filter.	<ul style="list-style-type: none"> • Is the filter original? • After replacing a new filter, hold the power button for 7 seconds to turn on the appliance again, and the filter indicator light will turn off.

Thank you very much for using our products.

Please read the user manual carefully before use and keep it for future reference.

Notice:

Feel free to contact your customer service centre or us if you need more than the above sheet to solve your problems and maintenance. Our website has a live chat, and you will find many instruction guides on YouTube.

Do not disassemble the appliance to fix it yourself; doing so will invalidate warranties.

7. WARRANTY

All Senelux products are covered from the original purchase date by a standard 2-year warranty. To register your warranty, please visit www.senelux.co.uk.

If, in the unlikely event that your product has any manufacturing defect, please get in touch with our customer service team at support@senelux.co.uk. Please quote your order number and any other relevant details regarding your issues. FAQs and help regarding all our products are available on our website and YouTube channel.

Any unauthorised repair of this product invalidates your warranty.

8 INFORMATION

If you want further information regarding using this product or any of our products, don't hesitate to contact us via the details below.

Senelux Ltd
Unit 5-6 105 Boundary Street
Liverpool L5 9YJ
United Kingdom
Email – info@senelux.co.uk
Website – www.senelux.co.uk



Be sure to tag us in your photos on social media using #seneluxathome to be featured



@senelux



@senelux



@Senelux



Thank you very much for using our products.
Please read the user manual carefully before use and keep it for future reference.